

Soils Map

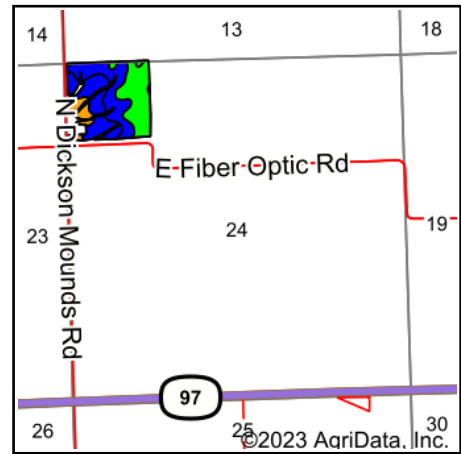
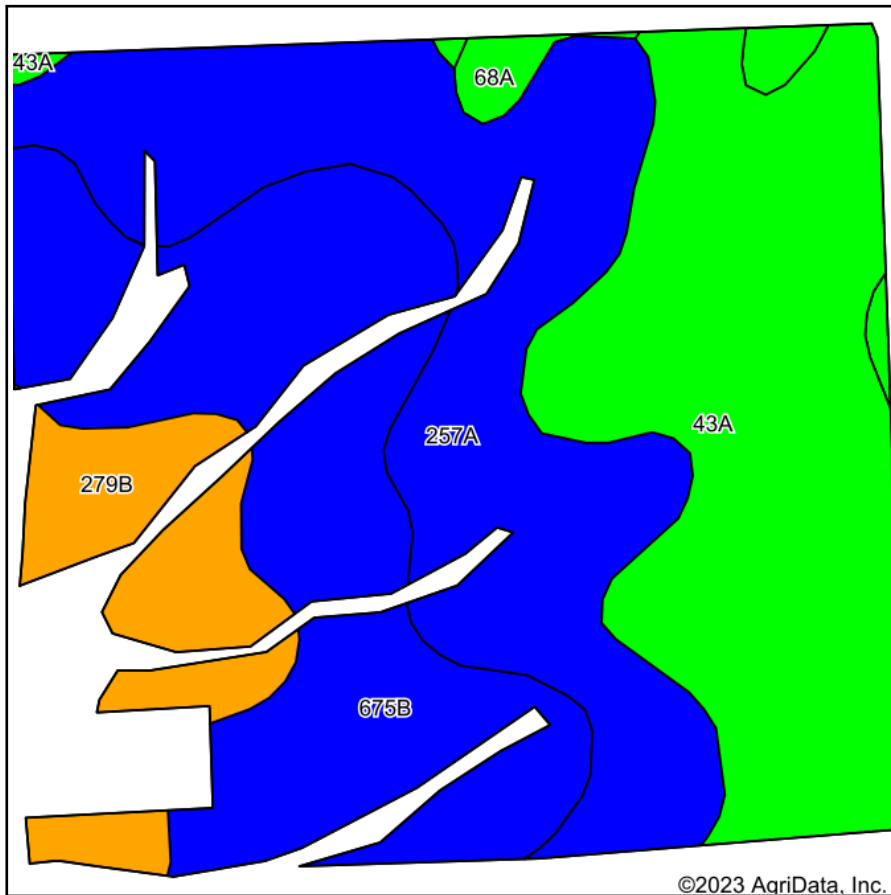

State: **Illinois**
 County: **Fulton**
 Location: **24-5N-3E**
 Township: **Lewistown**
 Acres: **31.63**
 Date: **3/8/2023**

Gorsuch
 Realty & Auction
FOR SALE
 www.gotogorsuch.com
 309-647-7777

Maps Provided By:

 CUSTOMIZED ONLINE MAPPING
 © AgriData, Inc. 2023 www.AgriDataInc.com



Soils data provided by USDA and NRCS.

Area Symbol: IL057, Soil Area Version: 17

Code	Soil Description	Acres	Percent of field	Il. State Productivity Index Legend	Subsoil rooting ^a	Corn Bu/A	Soybeans Bu/A	Wheat Bu/A	Oats Bu/A ^b	Sorghum ^c Bu/A	Alfalfa ^d hay, T/A	Grass-legume ^e hay, T/A	Crop productivity index for optimum management
43A	Ipava silt loam, 0 to 2 percent slopes	9.82	31.0%		FAV	191	62	77	100	0	0.00	5.90	142
257A	Clarksdale silt loam, 0 to 2 percent slopes	9.53	30.1%		FAV	174	56	69	89	0	0.00	5.27	128
**675B	Greenbush silt loam, 2 to 5 percent slopes	8.86	28.0%		FAV	**182	**57	**69	**96	0	0.00	**5.34	**133
**279B	Rozetta silt loam, 2 to 5 percent slopes	2.82	8.9%		FAV	**162	**50	**64	**83	0	**5.22	0.00	**119
68A	Sable silty clay loam, 0 to 2 percent slopes	0.60	1.9%		FAV	192	63	74	99	0	0.00	5.77	143
Weighted Average						180.8	57.7	71.1	94	*.	0.47	5.02	133.2

Table: Optimum Crop Productivity Ratings for Illinois Soil by K.R. Olson and J.M. Lang, Office of Research, ACES, University of Illinois at Champaign-Urbana. Version: 1/2/2012 Amended Table S2 B811

Crop yields and productivity indices for optimum management (B811) are maintained at the following NRES web site: <http://soilproductivity.nres.illinois.edu/>

** Indexes adjusted for slope and erosion according to Bulletin 811 Table S3

^a UNF = unfavorable; FAV = favorable

^b Soils in the southern region were not rated for oats and are shown with a zero "0".

^c Soils in the northern region or in both regions were not rated for grain sorghum and are shown with a zero "0".

^d Soils in the poorly drained group were not rated for alfalfa and are shown with a zero "0".

^e Soils in the well drained group were not rated for grass-legume and are shown with a zero "0".

Soils data provided by USDA and NRCS. Soils data provided by University of Illinois at Champaign-Urbana.