

JMA CONVEYOR PRODUCTS



2024-25





CONVEYOR PRODUCTS

JMA CONVEYOR PRODUCTS



"Small enough to care, big enough to deliver"

Established in 2017, JMA Conveyor Products is dedicated to providing high-quality professional conveyor belt engineering for the Australian mining industry. We offer comprehensive services including design, selection, sales, storage, inspection, maintenance, and repair to customers nationwide. Since relocating to Melbourne in 2020, we have expanded our range to include various types of conveying equipment for industries such as factories, logistics, farms, and recycling processing. Our offerings now include light duty conveyor belts, plastic modular belts, chain belts, and professional non-destructive testing services for conveyor belts.

Our rubber conveyor belting factory and technical staff have nearly 30 years of experience supplying high-quality conveyor belts to industries such as mining, ports and terminals, recycling, metallurgy, and quarrying. Our range includes fabric ply belts, steel cord belts, solid woven belts, sidewall belts, chevron belts, and other specialized belts, all meeting or exceeding stringent Australian and international standards.

JMA is committed to establishing a dedicated emergency maintenance service team to provide 24-hour response emergency maintenance services across Victoria, catering to industries including mining, concrete plants, manufacturing, cement, food processing, and grain. We also offer spare parts inventory management and comprehensive conveying design solutions.

Our team pride ourselves in providing superior, tailored, products and services to our clients.



IMPORTANT NOTE FOR ALL DESIGNERS AND DRAFTSPERSONS

The information contained in this catalogue is dimensional only

To ensure any product selection performed provides the end users with the lowest total cost of ownership we have provided at the last page of this catalogue a design submission sheet. If you require us to design/select equipment, please complete the submission sheet and forward to our technical engineer. This selection process may result in some dimensions of the selected equipment differing from those stated in this catalogue.

CONVEYOR PRODUCTS



CONVEYOR PRODUCTS



JMA BELTING List

- JMA Conveyor Belting8
 - Fabric Ply Belt9
 - Steel Cord Belt10
 - Solid Woven Belt.....11
 - Sidewall Belt12
 - Heat Resistant belt13
 - Flame Resistant belt.....13
 - Chevron Belt14
 - Roughtop Belt15
 - Vacuum Filter Belt.....16
 - Slinger Belt.....17
- Bulk Material Conveyor Systems18
- JMA Idler19
 - JMA UHMWPE Roller22
- JMA Pulley24
- JMA Conveyor Associates.....27
 - Conveyor Belt Cleaning System27
 - Conveyor Belt Fastener29
 - Fast-Screw Splice.....30
 - Other Conveyor Parts and Accessories31
- JMA Conveyor System Inspection.....34

JMA CONVEYOR PRODUCTS

Quality Assurance

ISO 9001 and ISO 14001 certification at our factory ensures that the JMA product range is of the highest quality in meeting Australian Customer demands. Through continuous improvement, research, development, and technical innovation, the JMA product range is manufactured to suit specific application and performance requirements. We also offer design and innovation solutions to meet our customer specified requirements, prevent damage in transit and for secure storage.

Any JMA Conveyor Product is available independently tested in Australia, meeting and exceeding the AS1332 and AS1333 requirements. We are also able to manufacture to DIN, BS, JIS and SANS standards.

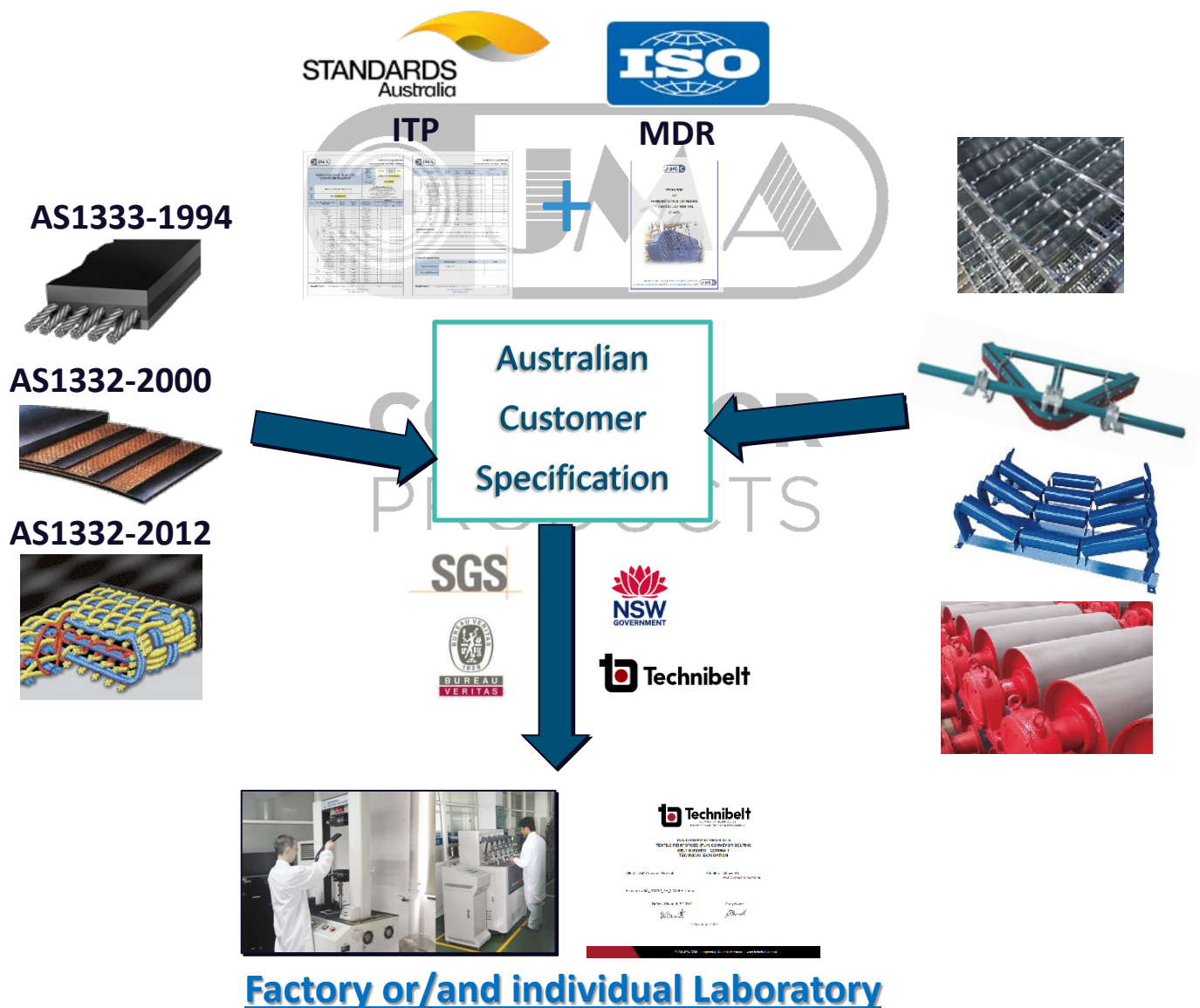



JMA CONVEYOR PRODUCTS

JMA Conveyor Belting

Production capacity of 3.4million lineal meters of conveyor belt per annum

Belt Type	Production Lines (pcs)	Belt Width (mm)	Max. Roll Weight (tons)	Belt Class Range (rank)	Max Length Per Roll or each (m)	Output Capacity (km per month)
Steel Cord	5	400 - 2,600	25	ST630 - ST7500	800	60
Fabric	11	400 - 2,500+	25	EP160 - EP3150	500	213
Solid Woven	3	800 - 2,200	25	680S - 2000S	200	26
Sidewall	5	300 - 2,400	25	250N/mm - 6000N/mm	500	5

Gotech Tensile Strength Test Device	Pipe Belt Test Device	Abrasion Test Device
		

The longest Press in China
20m length x 2.4m width
20m length x 1.4m width



The widest Press in China
14m width x 1.5m length
Wider belt, Filter belt



JMA CONVEYOR PRODUCTS

Fabric Ply Belt

JMA guarantees that the troughability of fabric ply conveyor belts with a belt width greater than 1050mm is at least 0.28, and the adhesion between the plies of carcass is greater than 10N/mm. Additionally, the performance of its cover rubber significantly exceeds the requirements of AS1332. Specific details are provided in the table below. JMA fabric ply conveyor belts are widely used in mining, metallurgy, construction, ports, power plants, the chemical industry, and other sectors.

Nominal strength (kN/m)	No. of Plies	Belt Width (mm)																		
		300	400	500	600	750	800	900	1000	1050	1200	1400	1600	1800	2000	2200	2400	2500	2500+	
160	2	NN / EP																		
250	2-3	NN / EP																		
315	2-4	NN / EP																		
400	2-4	NN / EP																		
500	2-5	NN / EP																		
630	3-6	NN / EP																		
800	3-6	NN / EP																		
1000	3-6	NN / EP																		
1250	3-6	NN / EP																		
1400	3-6	NN / EP																		
1600	4-6	NN / EP																		
2000	4-6	NN / EP																		
2500	5-6	NN / EP																		
Cover rubber Grade	Conforms to and exceeds AS 1332, AS4606																			
	Minimum Tensile Strength Mpa					Minimum elongation at break %					Maximum abrasion loss mm ³									
AS-A	19					450					60									
AS-M	25					450					115									
AS-N	17					400					180									
XCG	21					500					90									
AS-S	17					350					150									
KSOR	14					350					200									
DIN K	20					400					200									
Note: The belt length per roll can be customized as per customer requirements, with a maximum length of 500m, and without any longitudinal or transverse ply joints. We also offer various packaging solutions. For specific requirements, please contact our professional team for assistance.		<div></div>																		

JMA CONVEYOR PRODUCTS

Steel Cord Belt

Steel cord conveyor belt is extensively applied in coal mining, Port, metallurgy, power, chemical industries for long distance, heavy duty and high-speed conveying of materials.

No.	Tensile Strength (kN/m)	Dia. of cord (mm)	Cord Min. Breaking Force (KN)	Pitch of cord (mm)	Min. Cover Thickness	
					Top	Bottom
ST-630	630	3.0	9.3	13.8	4	4
ST-900	900	3.7	14.7	15.3	4	4
ST-1000	1000	3.9	16.5	15.3	4	4
ST-1120	1120	4.1	18.5	15.3	4	4
ST-1250	1250	4.4	20.6	15.3	4	4
ST-1400	1400	4.7	23.1	15.3	4	4
ST-1600	1600	5.3	29.1	17.3	5	5
ST-1800	1800	5.6	32.7	17.3	5	5
ST-2000	2000	6.2	36.4	17.3	6	6
ST-2240	2240	6.6	41.0	17.3	6.5	6.5
ST-2500	2500	7.4	51.1	19.4	6.5	6.5
ST-2800	2800	7.8	57.4	19.4	7	7
ST-3150	3150	8.3	64.6	19.4	8	8
ST-3550	3500	8.8	72.8	19.4	8	8
ST-4000	4000	9.3	82.0	19.4	9	9
ST-4500	4500	9.8	92.3	19.4	10	10
ST-5000	5000	10.3	102.0	19.4	10	10
ST-5600	5400	11.7	113.5	19.4	11	11
ST-6300	6300	12.9	133.0	20.0	12	12

Cover rubber Grade	Conforms to and exceeds AS 1333, AS4606		
	Minimum Tensile Strength Mpa	Minimum elongation at break %	Maximum abrasion loss mm ³
AS-A	19	450	60
AS-M	25	450	115
XCG	21	500	90
AS-S	17	350	150
KSOR	14	350	200
DIN K	20	400	200

Note:

The belt length per roll can be customized as per customer requirements, with a maximum length of 500m, and without any longitudinal or transverse ply joints. We also offer various packaging solutions. For specific requirements, please contact our professional team for assistance.



JMA CONVEYOR PRODUCTS

Solid Woven Belt

The Solid Woven conveyor belt is a fabric reinforced, PVC impregnated, PVC / PVG covered, fire retardant and antistatic belting, which is used primarily for industrial and mining applications. And whatever the cover rubber is PVC and PVG, both solid woven belts provide armored protection for long service life, improved tear strength and reduces the ingress of moisture, oils and chemicals.

Belt Carcass Designation	Carcass thickness (mm)		Cover grade and thickness (mm)		Belt Width (mm)
	warp	waft	PVC	PVG	
T250S	2.5	3.5	1.19 + 0	-	800-2000
T400S	4.0	5.5	1.19 + 0	-	
T680S	6.5	8.5	1.5 + 1.5	1.5 + 1.5	
T800S	6.9	9	1.5 + 1.5	1.5 + 1.5	
T1000S	7.5	9.7	2 + 1	2 + 1.5	
T1250S	8.5	11	2 + 1	2 + 1.5	
T1400S	9	11.5	2.5 + 1.5	2.5 + 1.5	
T1600S	9.5	12.3	3 + 2	2.5 + 1.5	
T1800S	10	13	3 + 2	3 + 2	
T2000S	10.5	13.6	3 + 2	4 + 2	
Cover rubber Grade	Conforms to and exceeds AS 1332, AS4606				
	Minimum Tensile Strength Mpa	Minimum elongation at break %	Maximum abrasion loss mm ³		
PVC	12	330	220		
PVG	14	350	180		

Note:

Belt's length can be produced according to client's requirement, and the maximum length is 500m.

Our Standard cover compound properties well surpass the specification requirements, any further information is available on request.

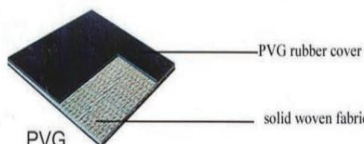

PVG

PVG rubber cover

solid woven fabric

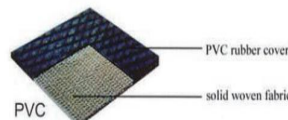

PVC

PVC rubber cover

solid woven fabric

JMA CONVEYOR PRODUCTS

Sidewall Belt

JMA offers textile or steel cord construction base belts that are cross stabilized using either polyester

Cross Rigid Base Belt (others available on requests)				
Type	Strength (N/mm)	Cover Thickness (mm)	Weight (kg/m ²)	Diameter of min pulley (mm)
 XE	250/2	4+2	9.4	200
	400 / 3	4+2	13.5	315
	500 / 3	4+2	13.75	400
	630 / 4	4+2	15.2	500
	800 / 5	4+2	16.85	630
 XE+2	400 / 3 +2	4+2	12.1	315
	500 / 3 +2	4+2	12.6	400
	630 / 4 +2	4+2	14.4	500
	800 / 5 +2	4+2	16.1	630
	1000 / 5 +2	4+2	17.8	800
 XE-SC+2	1250 / 5 +2	4+2	18.25	1000
	315 / 2 +2	4+2	13.7	315
	400 / 3 +2	4+2	14.5	315
	500 / 3 +2	4+2	15.2	400
	630 / 4 +2	4+2	16.7	500
 XST-SC	800 / 5 +2	4+2	18	630
	1000 / 5 +2	4+2	19.5	800
	1250 / 5 +2	4+2	21.4	1000
	1600	8+8	Please Inquire	1250
	2000	8+8		1250
	2500	8+8		1400
	3150	8+8		1400
	4500	8+8		1600
	5000	8+8		1600
	5400	8+8		1600
	6000	8+8		1600

Range of production	
Sidewall Height	40mm - 630mm
Cleat Height	35mm – 600mm
Vertical Lift Height	1-50m
Capacity Range	Up to 6,000 m ³ / h

monofilaments or steel rods, which is varied in construction depending on application requirements. Ideal for vertical incline conveying, the fabric reinforced flexible sidewalls and cross cleats are through twice low-temperature hot vulcanized, which ensures high adhesion value, flatten and no fall off, onto a cross stabilized base belt, providing pocket protection for the material being conveyed.

Type 'XE': This belt incorporates the cross-stabilising ply in the tensioning ply, mainly used for medium duty applications.

Type 'XE+2': The cross-stabilising ply and tensioning plies are separate, in this case the belt has 2 cross-stabilising plies, application

areas are medium to heavy.

Type 'XE-SC+2': This belt incorporates textile tensioning plies with Steel cord cross-stabilising members. The high lateral stiffness means the belt can be used in application areas where rigidity is an important factor, i.e., high lift heights and wide belts.

Type 'XST-SC': This belt incorporates Steel cord tensioning with Steel cord cross-stabilising members. High tensile strengths can be achieved making the belt ideal for high vertical lift applications

Note: Pulley diameters shown are for normal quality, and standard cover thickness. Please enquire for recommended diameters on belts with special quality covers or different tensile ratings as these many require larger diameters.

Cleats											
Type	Mold	Height (mm)	Width (mm)	Weight (kg/mm)	Min Pulley Dia. (mm)	Type	Mold	Height (mm)	Width (mm)	Weight (kg/mm)	Min Pulley Dia. (mm)
 C	NS	35	55	0.5	100	 T	HX	20	40	0.28	75
	HX	55	65	0.75	125		NS	20	40	0.28	75
	NS	55	75	1.5	125		HX	25	40	0.3	75
	HX	75	90	1.54	150		NS	25	40	0.3	75
	NS	75	95	2	150		HX	35	55	0.55	100
	NS	90	110	2.3	250		NS	35	55	0.55	100
	HX	110	100	2.59	315		HX	40	70	0.79	125
	NS	110	110	2.95	315		NS	40	70	0.79	125
 TC	HX	140	150	5.68	400	 TK	HX	55	80	1.48	125
	HX	35	55	1	100		NS	55	80	1.6	125
	HX	55	65	1.13	125		HX	75	65	1.52	150
	HX	75	65	1.23	150		NS	75	100	1.68	150
	NS	75	85	2.03	150		NS	90	110	2.5	250
	HX	90	100	1.8	250		HX	110	105	1.76	315
	NS	90	110	2.96	250		NS	110	110	2.63	315
	HX	110	100	2.32	315		HX	140	108	2.32	400
	NS	110	110	3.67	315		HX	180	110	4.63	500
	HX	140	110	3.33	400		NS	35	110	1.6	100
	NS	140	150	5.96	400		NS	40	110	1.76	100
	HX	180	110	4.53	500		HX	180	105	7.91	630
	NS	180	148	7	500		HX	220	105	8.87	800
	HX	220	140	7.73	500		NS	280	105	15.41	800
	HX	230	140	8.8	630		NS	360	225	22.6	1000
	NS	230	157	9	630		NS	470	225	30.3	1250
	HX	240	160	11.81	630		NS	500	225	32.2	1250
	NS	280	160	13.44	800		NS	600	225	38.7	1600

JMA CONVEYOR PRODUCTS

Heat Resistant belt

The belt carcass of this product is EP fabric of high modulus, low shrink, and high breaking tensile strength. Cover rubber of this product uses EPDM rubber or Chloro-butyl rubber that has very good high temperature resistance. the belt is made with extra care after mixing rubber with high temperature resistant materials, assembling and vulcanizing, and is suitable for use in cement, metallurgy, steel and other industries.

We also can produce the Burning Through Belt, the temperature can up to 800°C at short time. Working time can be in 300 °C

Cover Characteristic		GB20021				ISO 4195		
		T1	T2	T3	T4	1	2	3
		Test Temperature						
		≤100	≤125	≤150	≤175	≤100	≤125	≤150
		Permissible Range						
Hardness	Variation After Aging	+20	+20	+20	+20	+20	+20	+20
	Maximum After Aging	85	85	85	85	85	85	85
Tensile Strength	Variation After Aging	-25%	-30%	-40%	-40%	-25%	-30%	-40%
	Maximum After Aging	12	10	5	5	12	10	5
Elongation at break	Variation After Aging	-50%	-50%	-55%	-55%	-50%	-50%	-55%
	Maximum After Aging	200	200	180	180	200	200	180

Flame Resistant belt

The product is made of cotton canvas, nylon canvas or EP canvas and finished through the processes of calendaring, assembling, vulcanizing and etc, it is suitable for conveying various non-corrosive and thornless materials in blocks, in grains, or in powder, such as coal in bulk or in bales , under the condition of flammable or explosive environment above coalmine wells.

We also open the new Fire-Resistant grade Fabric belt used in underground.

Various Standards	Cover Type	Min. Tensile Strength (Mpa)	Min. Elongation (%)	Abrasion
SANS	F	17	350	180
ISO-340	FR	17	350	180
EN14973	A	15	350	200
AS-1332	F	14	300	200
DIN	S	17	350	180
MAHA	FR	17	350	200
Safety Property	Flame Retardant Grades			
	K2		K3	
Duration	The Total duration of flame of 6 test pieces with covers is less than 45s, any individual test piece does not exceed 15s.		Average value of duration of flame of 3 test pieces with covers does not exceed 60s	
Anti-static Property	≤ 3 × 108Ω			
Reappearance	There should be no reappearance of flame on any test pieces.			

JMA CONVEYOR PRODUCTS

Chevron Belt

JMA offers a wide range of cleat patterns, widths and heights of Chevron belting and profiled belting suitable for mining and other industries' conveying of various material according to customer's requirement.

Type of chevron	Name	Chevron width (mm)	Chevron spacing (mm)	Chevron height (mm)	Width of top chevron	Width of bottom chevron	Belt width (mm)
	U type	760	200	5	20	20	450 - 2200
	L type	440	330	17	10	17	
		630	330	17	14	20	
	V type	760	500	14	20	20	
	Y type	1200	338	30	10	20	
	Open V type	400	250	15	12	25	
		490		8	20	20	
		580		10			
		700		20			
		750		10			
	Closed V type	400	130	5	20	20	
		640	240	10	18	18	
		670	270	25	15	25	
	H type	469	330	32	12	24	
		580					
		580					
		630					
		750					
		900					

JMA CONVEYOR PRODUCTS

Roughtop Belt

JMA will solve your roughtop conveyor belting problem and challenges across applications, including recycled goods, fragile or deformed materials and glass, papers, bags, boxes conveying on inclines or declines up to 35 degrees. Roughtop conveyor belts cushion the load, absorbing vibrations and minimizing impacts.

Features

The bareback Rough Top Belt has a lower friction coefficient, suitable for running over tables and flat panels. The design of the mesh-like pattern on the top surface cover can generate the



relief effect, absorbing any vibrations and impacts exerted on the materials conveyed and simultaneously preventing the materials from slipping.

Construction and Properties

Items		Dimensions		Tolerances	
Width [mm]		400-3000		±1%	
Thickness		6-10		±1	
		11-12		±10%	
Length		On customers demand			
Specification - According to AS1332					
Tensile strength, (N/mm)		min 15			
Elongation at break, (%)		min 350			
Abrasion, (mm3)		max 200			
Ply Type	PN100	PN100	PN125	PN150	
Number of plies	2	3	2	3	
Drive pulley	160	200	250	315	
Tail pulley	160	200	200	250	

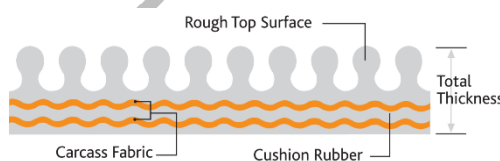

2 or 3-ply construction with cut edges and a carcass of synthetic PN fabric. The surface texture resists the tendency for the material to roll back down the conveyor. The black top cover is recommended for utility type incline or decline service.

Top cover is 3.2 – 5.0 mm thick SBR and the back is protected by either a durable friction AND oil-resistant

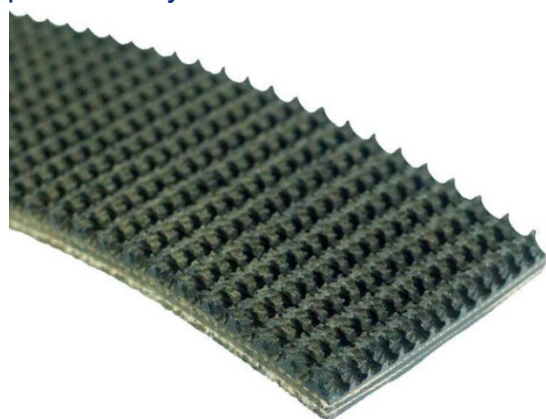

surface bottom or a synthetic bare-back for slider bed applications.

Recommend Inclined or declined Angle	
Materials	Angle
Jute sacks (Bag)	35°
Goods packed in paper	32°
Wooden Case	30°
Cartons	28°
Salt or powder	27°
Wheat (Bulk)	26°
Boxes of synthetic material	25°
Goods packed in plastics	22°
Soybean (Bulk)	20°

JMA CONVEYOR PRODUCTS

Vacuum Filter Belt

JMA has always focused on meeting the needs of the bulk material industry by supplying various types of conveyor belts to the industry and provide the premium belting to Australian Customer.

Features

Our products and solutions can fully meet your filtration requirements and consideration of cost budget.

JMA vacuum filter belt separates the goods from the liquid by acid or leaching or by rinsing the liquid out. As long as the fillet belt continuously circulating, with the help of gravity and the vacuum generated by the vacuum box below, the separated liquid passes through the holes of the belt and gathers into the vacuum box, at the same time the dry goods is taken away on the filter belt.

JMA deliver all dimensions of Filter belts from 500 mm to 6500 mm in width, according to client's requirement to splice the endless belt. And JMA also can provide the carcass from 2 ply to 5 plies. JMA's rubber compound and carcass are according or excess Australian Standard.

JMA Vacuum Filter belts can according to customer requirement to make different edge/wall profiles, wide selection of grooves patterns, size, and location of the drainage holes and according to Australian customer's needs and specification.

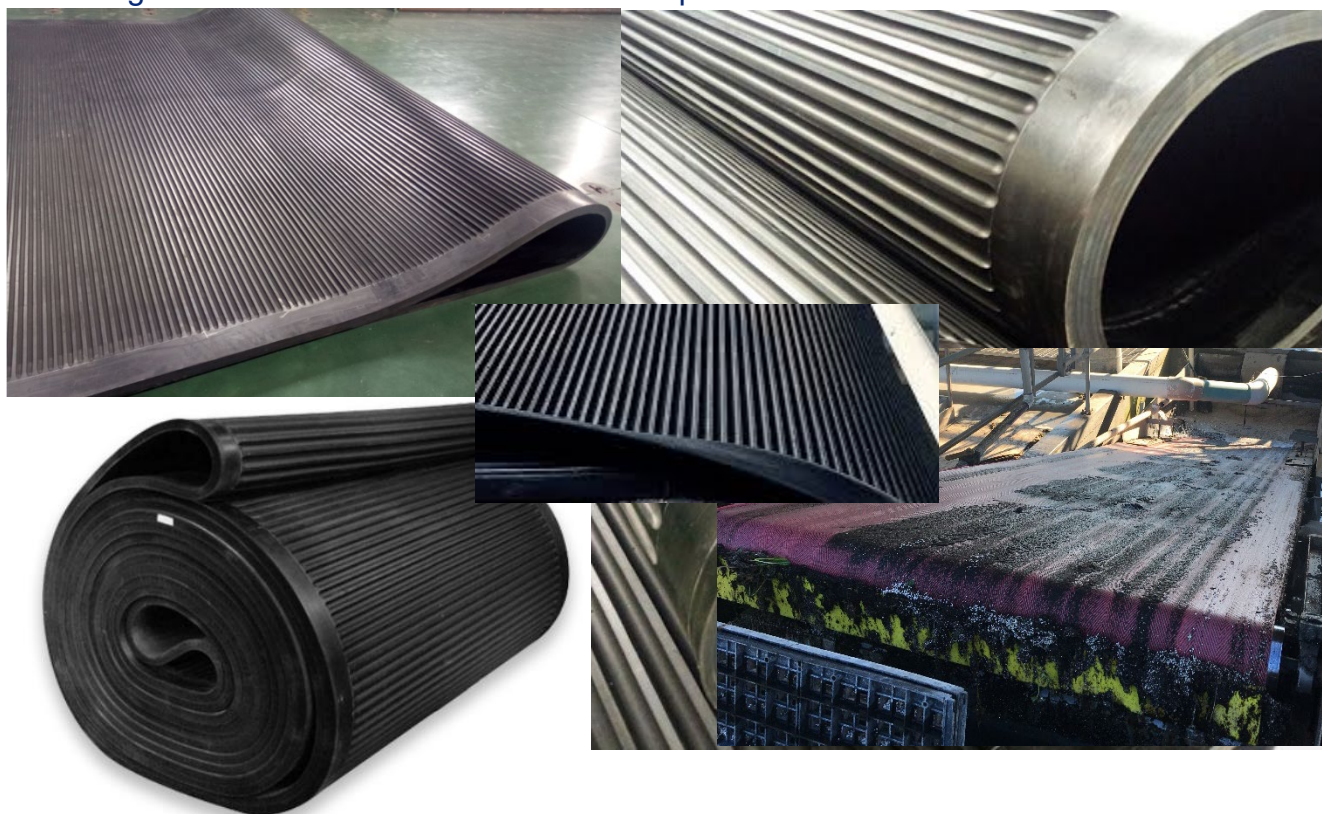
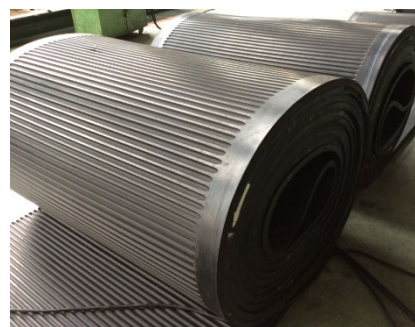

JMA CONVEYOR PRODUCTS

Slinger Belt

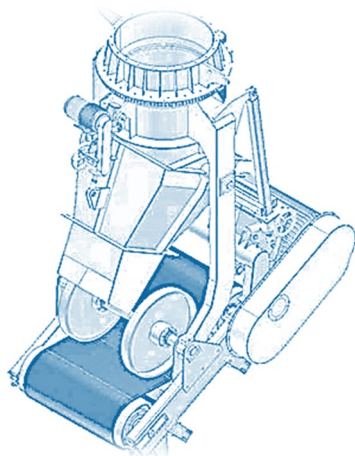

JMA specialized slinger belts will help customer low cost, while provide longer belt life, decrease the cover delamination, avoid the tracking and other belt problems. It is endless belt design without seams or splice. The tolerance of the belt thickness is much smaller than the requirement in AS1332, and we guarantee maximum uniformity in thickness and strength allowing for exceptional tracking and long life. The unique fabric design assures extremely low elongation, high tensile strength, and excellent transversal rigidity at high speed.

Main Features of JMA Slinger Belts:

- ✓ High Quality elastomer compounds
- ✓ High Strength fabrics
- ✓ Extremely strong ply adhesion
- ✓ Customized range of width and length available
- ✓ Truly endless construction
- ✓ Long Service Life
- ✓ Range of compound formulations
- ✓ Value for money



SLINGER BELT SELECTION

Belt Width:	Belt Length:	Belt Quantity:
Tons/Hour:	Hrs/Day:	Run Speed:
Minimum Pulley Dia. (Dr/Ta):	/	Material:
Temperature:	Humidity:	Material:
Oil:	Quantity:	Density:
Others:		
Current Provider / Manufacturer		Current Life:
Failure Reason:		

Bulk Material Conveyor Systems

With long-term collaboration with the University of Technology and other top-tier design institutes, JMA is capable of designing and manufacturing a wide range of fix / mobile stacking conveyors that comply with the safety standards of AS 1755 and AS 4024.1. Additionally, we offer comprehensive services from calculation and design to manufacturing, transportation, installation, and ongoing maintenance. This holistic approach helps to significantly reduce the overall cost of conveyors for our clients.



Production Specification

- ✓ Tonnage per Hour range: 0.1 tph – 1500 tph
- ✓ Cubic per Hour range: 0.8 to 8000 m³/h
- ✓ Belt Velocity: 0.1 – 3.5 m/s
- ✓ Lift Height range: 5 m – 80 m
- ✓ Incline angle range: 40° – 90°
- ✓ Conveyor system design as follows or customized:

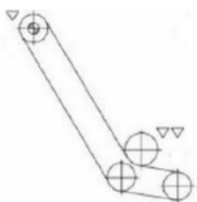
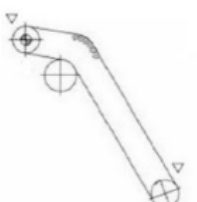
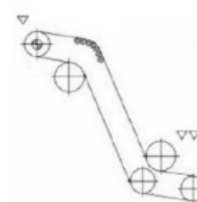
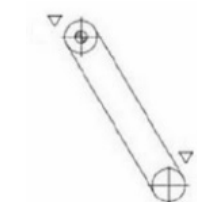
L type	RL type	Z type	I type
			

JMA CONVEYOR PRODUCTS

JMA Idler

JMA carry a large range of rollers to suit most conveying applications. This enables the customer to receive the most cost-effective solution. Installations include coal, gold, platinum, diamond and copper mines, cargo loading terminals and long high-capacity conveyors throughout Australia. The grease-free labyrinth seals ensure that bearings are able to achieve the design life, running in much lower friction values than conventional designs.

JMA manufactory capacity to produce over 500,000 conveyor idlers per annum customized to suit most specifications and requirements.

Steel Roller Series	Roller Diameter (mm)	Shell Wall Thickness (mm)	Nominal Shaft Diameter (mm)	Bearing	
				Bearing Type	Dynamic load Rating Cr (N)
Standard Duty (SD)	89	3.5	20	6204-zz	12,800
	114				
	127				
	133				
Heavy Duty (HD)	152	4	30	6306-zz	27,000
	127				
	152				
	178				
	219				
Extra-Heavy Duty (ED)	127	5	40	6308-zz	40,800
	152				
	178				
	152				
	178				
	219	5	45	6309-zz	52,800

JMA Conveyors Idler products to the following industry tolerances:

Typical Specification	Units	Criterion
O.D. Idler Shell	mm	±0.2
Rubber Disc O.D. Tolerance	mm	±1.0
Total Indicated Run-out of Shell	mm	±0.3
Face Length of Idler	mm	±0.8
Centre Idler Height to Base	mm	±2.0
Transverse Hole CRS	mm	±2.0
Longitudinal Hole CRS	mm	±2.0
Return Bracket Drop Height	mm	±1.5
Trough Angle	°	±2.0
Idler Corner Chamfer	mm	2 X 2
Corner Weld Penetration	%	min. 80%
Total Indicated Run-out - T.I.R. - Up to 750mm long	mm	< 0.5
Total Indicated Run-out - T.I.R. - > 750mm long	mm	0.0007 x Length
Dynamic Balnace	-	max. G40

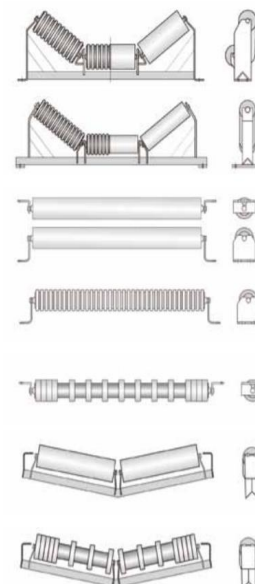

JMA CONVEYOR PRODUCTS

Idler Type

Carry Idler



Return Idler



Round edge idler



HDPE Idler



Impact Idler

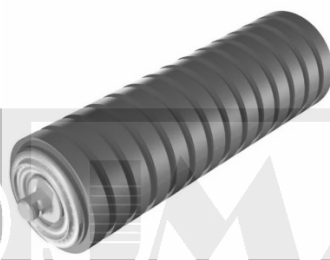

Guide Roller



Rubber Spiral Return Idler



Steel Screw Idler

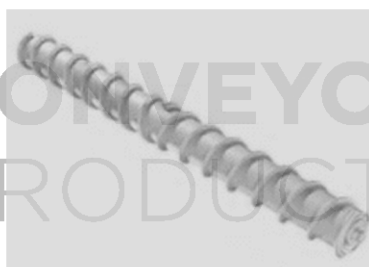

Disc Return Idler



Tapered Roller



Garland Roller



Training Roller



JMA CONVEYOR PRODUCTS

Wing Roller



Various coating roller



Stainless Steel Idler



Inline Trough Frame

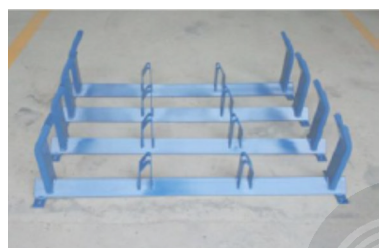

Self-Aligning Return Frame

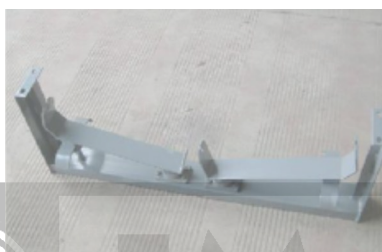

Offset Trough Frame



Self-Aligning Idler

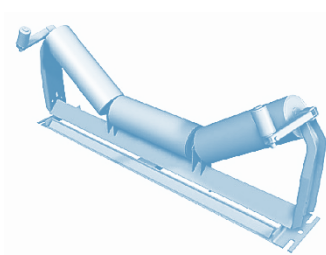

Vee Return idler



Reverse Vee Return Idler

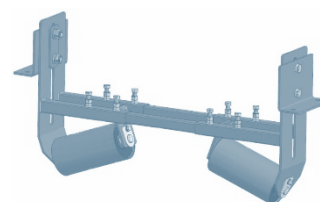

Double impact idler

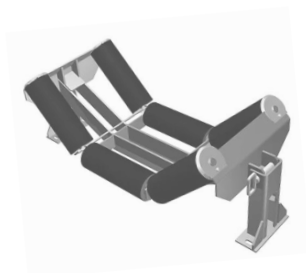

Impact bed



Gravity Roller Conveyor



JMA CONVEYOR PRODUCTS

JMA UHMWPE Roller



JMA's UHMWPE ROLLER adopts 100% genuine new UHMWPE material, no recycled material. And bearing is available from, HRB, SKF, NSK etc. Thanks to high-quality extrusion lines and high-precision machine, each JMA's UHMWPE roller can meet the quality requirements and ensure the competitiveness of the product cost.

The properties are high abrasion resistance and loading capability, premium anti-corrosion performance, low rotation resistance and maintenance, long service time, lighter weight, etc, which widely applied in the conveying system of various industries, such as coal, bauxite, iron ore and quarry sites, steel, electricity, chemistry factories, etc.

- ✓ The abrasion resistance of JMA's UHMWPE roller is 4-7 times of steel one, or 3-4 times of HDPE one.
- ✓ The lowest running temperature of JMA's UHMWPE roller is -50°C and still keep high impact strength.
- ✓ JMA's UHMWPE roller is not only provide high chemical resistance, but also fantastic UV protection.
- ✓ JMA's UHMWPE roller offers a smooth, non-wettable interior surface, that accounts for a Hazen-Williams Flow Coefficient of $C=160$, excellent self-Lubricating.

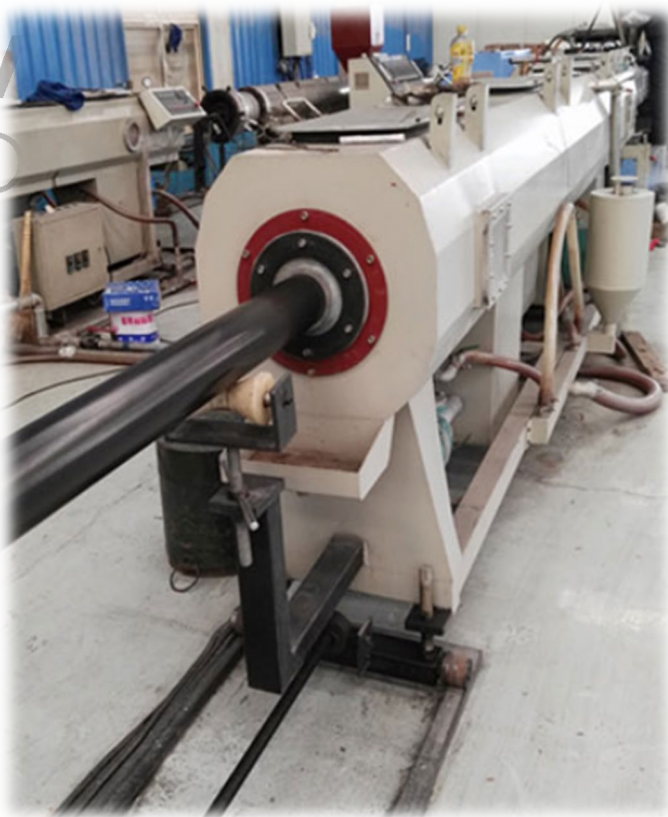

JMA CONVEYOR PRODUCTS

JMA Conveyor Idler Selection Technical Data Sheet

CLIENT: _____ **CONTACT:** _____
ENQUIRY _____ **DATE:** _____
NO.: _____

ITEMS	UNIT	CONV. NO.	CONV. NO.	CONV. NO.
BELT WITH	mm			
BELT SPEED	m/s			
BELT SPECIFICATION				
BELT MASS	Kg/m			
Material				
BULK DENSITY	Kg/m ³			
LUMP SIZE	mm			
DESIGN CAPACITY	Tph			
B10 LIFE	Hours			
FREE FALL HEIGHT	m			
SURCHARGE ANGLE	Degree			
TROUGH ANGLE	Degree			
IDLER SPACING				
THROUGH	mm			
RETURN	mm			
IMPACT	mm			
RUNNING BELT TENSION				
T1 (CARRY)	KN			
T2 (RETURN)	KN			
BELT DEVIATION				
CARRY SIDE	mm			
RETURN SIDE	mm			
CONVEX CURVE RADIUS	m			
NOMINAL QUANTITIES				
Trough	Φ			
IMPACT	Φ			
TRANSITION	Φ			
RETURN	Φ			
VEE RETURN	Φ			
RETURN TRAINER	Φ			
OTHER	Φ			

TECHNICAL CHECKING	YES	NO
CONVEX CURVE CONSIDERED		
FLOODED BELT CONSIDERED		
DEVIATION LOAD CONSIDERED		
ASSUMPTIONS IF NEEDED		

JMA Pulley

Features and Benefits

Manufactory Capability

- ✓ Capacity to produce over 4,500 conveyor pulleys per annum customized to suit most specifications and requirements
- ✓ The maximum pulley diameter can reach 1.5 meters, the shell thickness and the shaft diameter can reach 25mm and 500mm respectively
- ✓ All shafts are machined from certified high tensile material, which forging procedure and design is accordance with AS1403- 2004 for infinite fatigue life
- ✓ All plate is rolled and welded is according with AS/NZS1554.1-2004 SP and all pulley will pass ISO194.1-2003 Grade 40 or lower balance test, according to client requirement

Quick response and good Lead Times

- ✓ 24-hour response
- ✓ Help regular client to build a stock in Australia with standard products
- ✓ Australian wide distribution network

Comprehensive Product Line

- ✓ From light, portable applications to high tonnage, extreme heavy-duty jobs
- ✓ Standard duty, high duty, premium duty, and extreme duty Engineered Classes as per CEMA, GB
- ✓ Specialty: Spiral drums and wings, deflection wheels and dead shaft conveyor pulleys

Optimization Design and Performance

- ✓ Complete assembly under Qualified inspector supervision including bearings, couplings, gearing, etc.
- ✓ Available apply Finite Element Analysis (FEA) to build per application stress conditions
- ✓ Dynamic balance test up to 1250rpm, limited by the weight of pulley.

Quality Commitment

- ✓ Automatic welding machines for consistent, quality welds
- ✓ Qualified welders trained and registered.
- ✓ Complete WPS and Welding quality inspected by SGS or another equivalent institute.

JMA CONVEYOR PRODUCTS

Pulley Lagging



✓ Plain Vulcanized Lagging

Plain vulcanized lagging is suitable for any Pulley in the conveyor belt system where watershed is not necessary. It provides additional protection against belt wear and increases the life of the Pulley.

✓ Herringbone patten Vulcanized Lagging

Herringbone Grooved Lagging offers superior tractive properties and is desired on all Drive Pulley applications. Each groove offers a path for water and other liquids to escape between the Pulley face and the conveyor belt. Herringbone grooved Pulleys are directional and should be applied to the conveyor in a manner in which the grooves point toward the direction of belt travel.

✓ Diamond Grooved patten Vulcanized Lagging

Diamond Grooved Lagging also offers premium tractive properties and should be specified on all reversing conveyor applications.

✓ Ceramic (Hot Vulcanized)

Vulcanized Ceramic Lagging by has proven to be the best in the industry. JMA has worked closely with manufactory to study adhesion strengths of several bonding methods.

✓ Weld-On Strip Lagging

Weld-On Strip Lagging is available from our product range and is easily installed on Drum Pulleys either in our factory or in the field. Not only do we have standard 65 durometer SBR available, but we can provide special compounds, such as low durometer rubber, EPDM, Anti-Static, Oil resistant, Chemical Resistance, and so on.

✓ Cold Bond

Cold Bond Lagging is another product available from JMA. Our Cold Bond rubber is available in plain or diamond grooved pattern. This product is typically used when Pulleys on the conveyor must be re-lagged while still in operation and can reduce the change-out time required to install a new assembly.

JMA CONVEYOR PRODUCTS

JMA Conveyor Pulley Selection Technical Data Sheet

CLIENT:

CONTACT:

ENQUIRY NO.:

DATE:

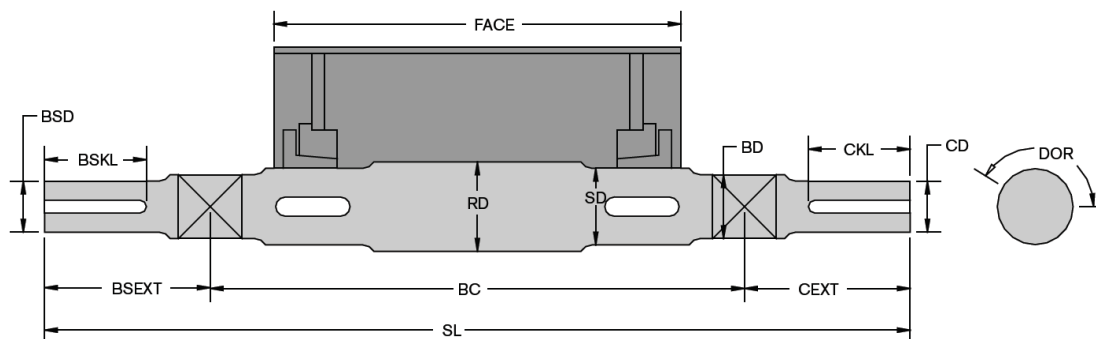

ITEMS	UNIT	NO.	NO.	NO.	NO.
QUANTITY	Pc				
LAGGING TYPE	Type				
TYPE	Wing/Drum				
DRIVE	Yes / No				
DIRECTION OF ROTATION					
STYLE	CF / FF				
OD (without lagging)					
Face					
SL					
RD					
SD					
BD					
BC					
CD					
CEXT					
CKL					
CKW					
BSD					
BSEXT					
BSKL					
BSKW					
LAGGING THICKNESS					
SHELL THCKNESS					

JMA Conveyor Associates

Conveyor Belt Cleaning System

Belt Width: 450 - 2400mm

Belt Speed: ≤ 3.5 m/s

Material Humidity: $\leq 15\%$

Working Temperature: $-40 \sim 90$ °C

Primary Polyurethane Belt Cleaner

JMA-CPSS (STANDARD)

JMA-CPHS (HEAVY DUTY)

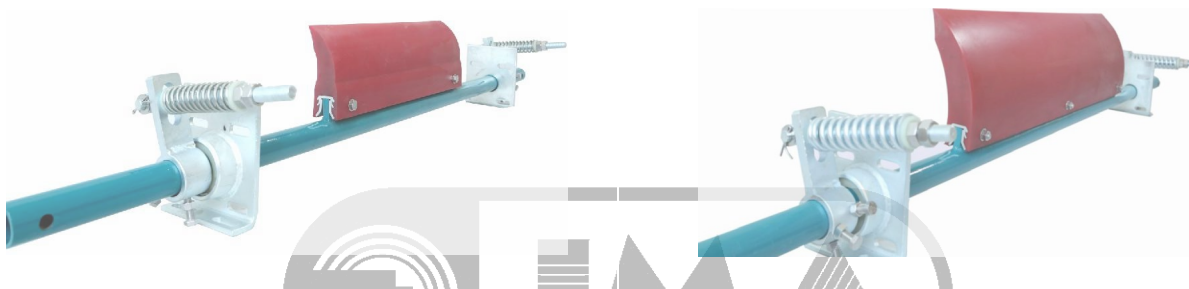

Secondary Polyurethane Belt Cleaner

JMA-CNSS (STANDARD)

JMA-CNHS (HEAVY DUTY)

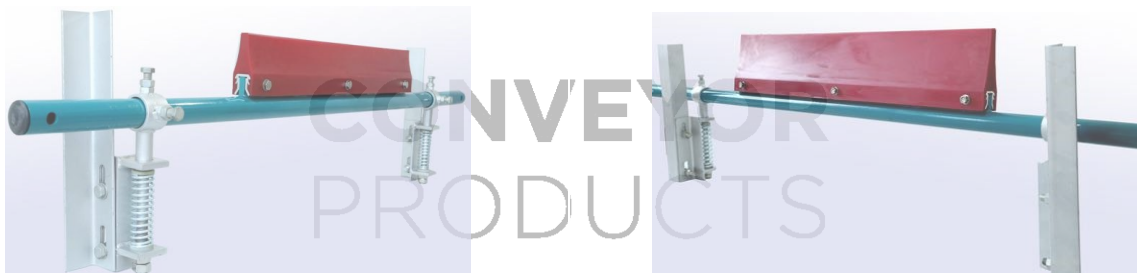

Vee Plough Belt Cleaner

JMA-CLSS (STANDARD)

JMA-CLHS (HEAVY DUTY)

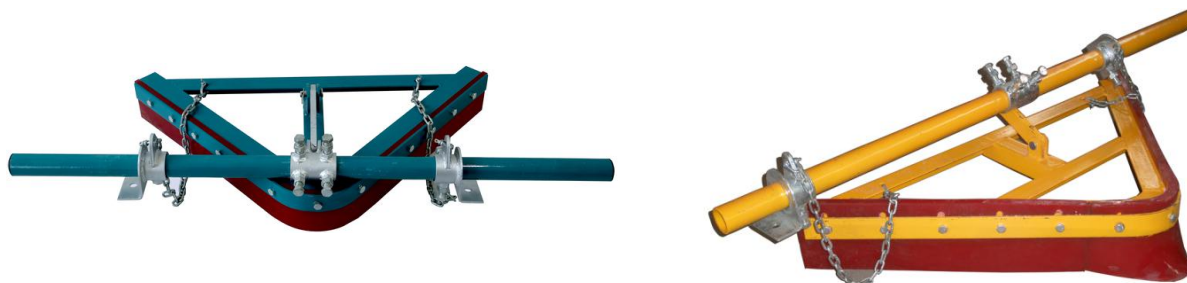

JMA CONVEYOR PRODUCTS

Alloy Belt Cleaner

H-Type Primary Alloy Belt Cleaner

P-Type Primary Alloy Belt Cleaner

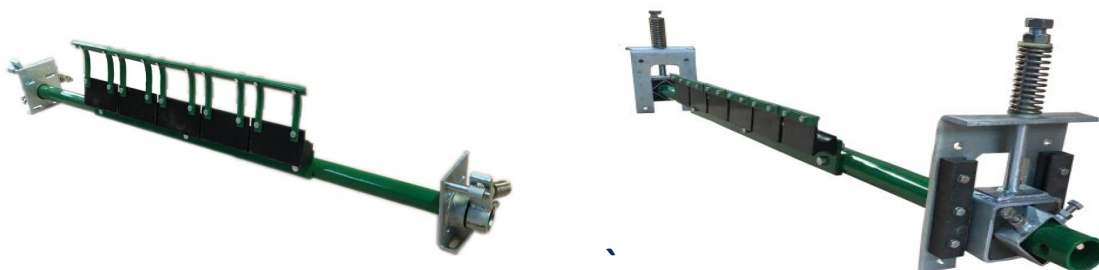

High Pressure Low Volume water jet Cleaner



Multi-phases vibration conveyor cleaner





Customized Rubber & Polyurethane Scraper



JMA CONVEYOR PRODUCTS

Conveyor Belt Fastener

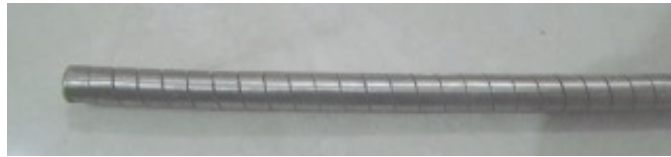
- ✓ Strong and impact-resistant splice.
- ✓ Abrasion resistant splice.
- ✓ The front edge of the fastener is bevelled to allow it to interface smoothly with conveyor components.
- ✓ Fasteners are shipped inside carton boxes as 4 sets/box. Connecting pins are included in the boxes.

Type		Belt thickness	Remarks
	MRA1	1.5 - 3.2 mm	Recommend using MRA lacer for installation of MRA series fasteners
	MRA2	3.2 – 4.8 mm	
	MRA3	4.8 – 6.4 mm	
	LGK0	1 – 2 mm	Recommend using LGK lacer for installation of LGK series fasteners
	LGK1	2 - 2.5 mm	
	LGK7	2.5 – 3.5 mm	
	LGK9	3.5 – 4.5 mm	
	PL Plate Fastener	Customize	Size: 1"
			Size: 1-1/2"
			Size: 2"
	Stainless steel string		6mm
			7mm
			8mm
			9mm
	stainless steel string with Nylon plastic coat		7mm
			9mm

JMA CONVEYOR PRODUCTS

Fast-Screw Splice

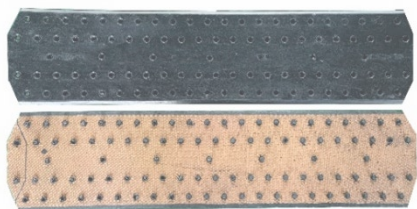

JMA-FS-120 Split Fast-Screw Splice

Appearance: lines of screws on each side, one line middle of the joint. All nuts are buried in the rubber joint. The top 6mm and bottom 5mm cover are split, can be both used for belt joint and belt damage repair.

There are top 3 and bottom 2 ply of Middle reinforcement layer in the joint, which can make the joint part strong enough like the conveyor belt.



JMA-FS-254 Standard Fast-Screw Splice

Appearance: lines of screws on each side. All nuts are buried in the rubber joint. The middle reinforcement layer is fabric.

There are top 3 and bottom 3 ply of Middle reinforcement layer in the joint, which can make the joint part strong enough like the conveyor belt.

Technical Data Sheet

Item Model Type	Width	Thickness	Strength	Belt thickness	Temperature	Weight
RIT-MJ-120	120mm	11mm	600-1200N/mm	10-20mm	-30 --- 180 ℃	2.8kg/m
RIT-MJ-254	254mm	15mm	800-1600N/mm	10-17mm	-30 --- 120 ℃	4.25kg/m

Easier and faster to install

- ✚ Installation without need of physical strength
- ✚ Installation during all-weather condition
- ✚ No need/use of expensive equipment
- ✚ No need of highly skilled operators
- ✚ Easier bias splicing
- ✚ Less screws for faster Installation
- ✚ Easier skiving and less downtime
- ✚ New spacers for equal skiving size on both sides

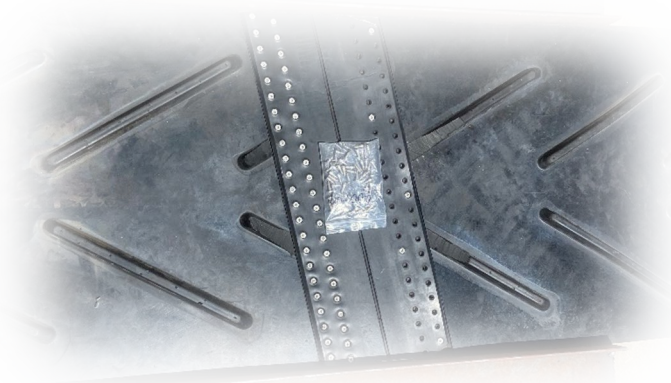

JMA CONVEYOR PRODUCTS

Other Conveyor Parts and Accessories

Steel floor Grating

Any other grating can manufacture according to the requirement of customers.

Forge Weld Grating



Serrated Steel Grating



Swage-Locked Grating



Wire mesh fence

Any type of wire mesh can manufacture according to the requirement of customers.

3D Panel Fence (Galvanized + Powder Coated) and associates



Barbed Wire

Concertina Razor Wire

Holland Wire Mesh Fence



JMA CONVEYOR PRODUCTS

Metal Mesh Plate

Any type of mesh plate can provide a reasonable solution according to the requirement of customers.

Expanded metal plate

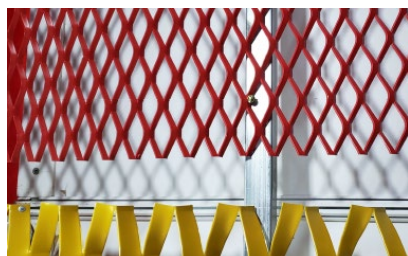

Perforated metal plate



Grip Strut

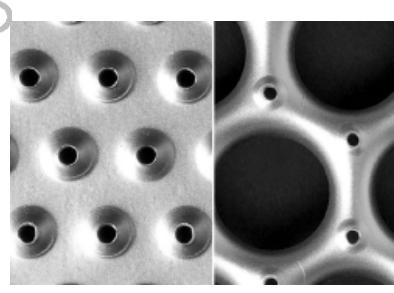
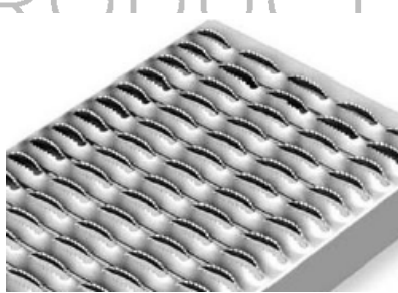
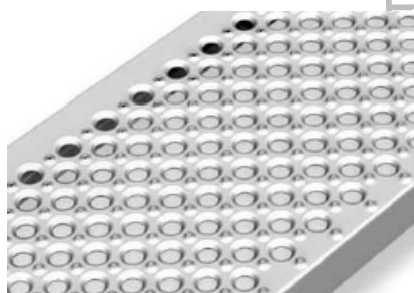

JMA CONVEYOR PRODUCTS

Other Associates

Any customized conveyor associates can provide the best solution.

Elevator Buckets



Rubber Floor Mat



Wear Liner



Openable Conveyor Cover



Conveyor Cover with Accessible Window



Conveyor Cover with Sight glass

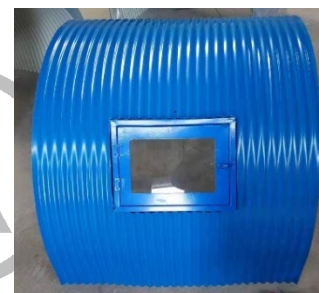

T-Type Skirt Board



Dual Seal Skirt Board



PE Skirt Rubber



JMA Conveyor System Inspection

BUSINESS CHALLENGE

Real-time Condition Monitoring and Proactive Maintenance as a Component of Minimizing Downtime.

Utilizing Historical Maintenance Data Analysis to Enhance Physical Performance and Reliability, Achieving Optimal Balance Between High Performance and Cost-effectiveness.

SOLUTION

For initial collaborations involving smaller conveying equipment, JMA conducts on-site visual inspections carried out by skilled professionals. This facilitates an initial understanding of equipment operation, culminating in the formulation of comprehensive reports submitted to the owner for archival and review purposes.

In the case of long-term partnerships and large-scale equipment, JMA engages in meticulous analysis and discussions regarding equipment maintenance status and requisites with the client. Subsequently, appropriate testing methodologies are specified, alongside tailored equipment enhancement recommendations.

For sizable equipment instances where direct observation proves challenging, JMA collaborates with proficient testing equipment teams to deliver automated robot inspection services.

Addressing the need for sustained vigilance in critical areas, such as core inspection of steel wire belts and canvas belts, JMA boasts a dedicated team equipped to provide randomized, routine, periodic, and round-the-clock inspection services.

WHY CHOOSE JMA

Recognition

JMA's factories excel in designing and improving conveyor belt equipment, including patrol inspection and human factors at port terminals. In China, JMA Factory leads in conveyor belt monitoring and R&D.

Knowledge & Expertise

JMA Factory's technical proficiency and ongoing training for its Australian team and dealers ensure timely and tailored information for our clientele.

Comprehensive Solutions

JMA offers complete solutions from conveyor belt selection to equipment design, enhancements, and Australian spare parts inventory management, swiftly resolving security concerns for our clients.

RELATED SERVICES

- JMA – 24hrs Continuous X-Ray
- JMA – Regular inspection X-ray
- JMA – Onsite Vision Inspection
- JMA – Inspection Reporting
- JMA – Remote Monitoring
- JMA – Conveyor System Inspection
- JMA – Cover Thickness Testing
- JMA – Patrol Monitor Robot



JMA Reporting

The purpose of this report is to clearly and accurately communicate events requiring attention, wear and tear, and potential hazards on conveyor systems, belts, and accessories. It serves to facilitate effective proactive maintenance planning and enables adjustments to be made within relevant budget cycles.

JMA reports are archived to identify immediate hazards since the last inspection and trends in potential risks. The report consists of three parts: a summary of each inspection item on the conveyor, action suggestions, and detailed photos of each inspection item. This comprehensive approach ensures that any potential risks are promptly addressed and mitigated.

Reports can be delivered to one or more relevant persons in a variety of formats, from electronic to formal mailed text, depending on your specific needs and preferences. This flexibility ensures that the information is accessible and actionable to those responsible for maintenance and

皮带钢丝绳锈蚀 Steel Cord Corrosion

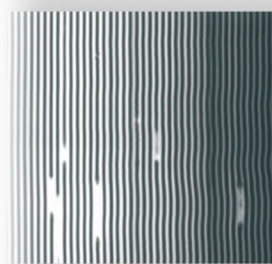

陕煤建新矿

带长2600米，带宽1.2米，带速3.0米/秒

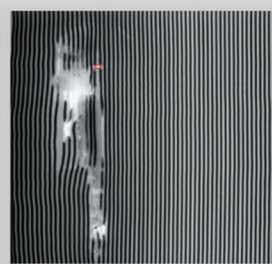

冀中能源陶二矿

带长3500米，带宽1.0米，带速3.5米/秒

输送带纵断后的横卡

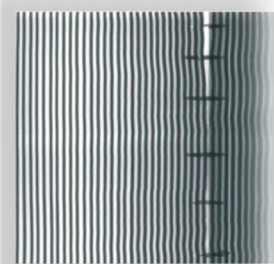

甘肃窑街煤矿

带长3200米，带宽1.2米，带速3.5米/秒

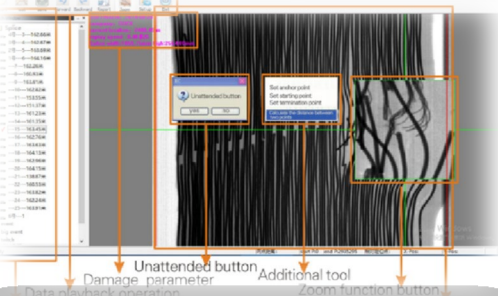

FAQ

Do I need to inspect all the conveyors?

Not at all, we will recommend to you a professional, reliable, and economical way to inspect conveyor belts for different uses.

What are the key benefits?

Proactive maintenance of conveyor equipment
Prevent and avoid catastrophic failures.

Who owns the Data?

You own the property rights to your data, and at the same time, we retain a backup of this data, which forms part of the database for our engineers to analyze and make recommendations.

Do I have to shut down the belt for the inspection?

Uncertain. Depending on the testing content and tools, we may require shutdown to install relevant non-destructive testing equipment. But most inspections can be done during operation, which is also beneficial because our technicians can identify the problem based on abnormal noises.



Metal Chain Plate Conveyor System

Metal chain plate conveyor system is a type of conveying device made of steel plates and hinge pins or connection rods, which provides a larger contacting area, flat and smooth surface for drying, sorting, and conveying. There are various types and customized specs of hinged steel belt can be chosen.

Features

Stable operation - The flat and smooth surface supplies large conveying surface and stable conveying.

Convenient installation - The installation of metal plate conveyor belt has simple structure, which can be installed and replaced conveniently and fast.

Suitable for medium and heavy load transportation - The metal plate conveyor belts have large conveying surface, and they can self-support in heavy duty applications.

Corrosion and rust resistance - Various anti-corrosive materials and surface treatments ensures the metal plate conveyor belts corrosion and rust resistance. It can be used in harsh environments and arduous conditions.

Durable and long service life - The material of metal plate conveyor belt is tough, which can be used in good condition for long service life.

Applications

- | | | |
|----------------|-------------------|-------------|
| ✓ Transporting | ✓ Elevating | ✓ Blanching |
| ✓ Drainage | ✓ De-elevating | ✓ Drying |
| ✓ Sorting | ✓ Waste treatment | |

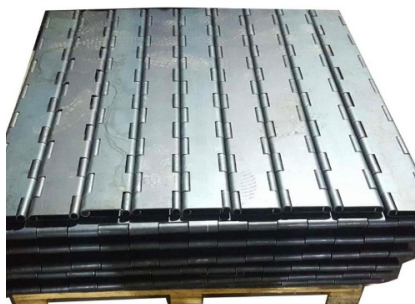



CONVEYOR PRODUCTS

EMAIL: Sales@jmaustralia.com.au

TEL: 1800 975 038

ADDRESS: 4 / 222 Fairbairn Rd,
Sunshine West VIC 3020

WEBSITE: www.jmaustralia.com.au
