

3m post height

TEL: 0114 242 4244

COMPONENTS

- FXB** GOALPOST SLOT FIXINGS (20 FIXINGS PER POST on 6m post) (12 FIXINGS PER POST on 3.6m post) **x30**
- NT** NET TIES **x16**
- TS** UNIQUE SECURE NET TENSIONING SYSTEM (1 PER POST) **x3**
- N** NET **x1**

POSTS

- P** 80mm OD ALUMINIUM POST (Various post heights available) **x3**
- GS** METAL GROUND SPIKE **x3**

Sectional posts also available

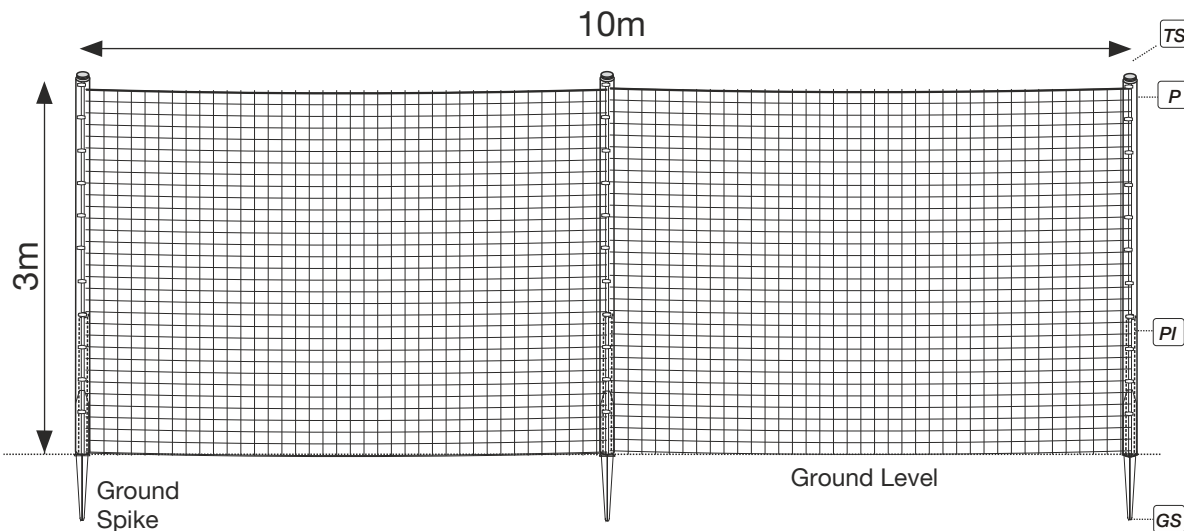

STEEL GROUND ANCHORS

HAMMER FULL DOWN INTO THE GROUND

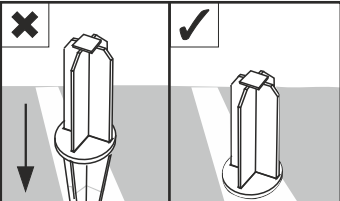

1. Make sure the Steel Ground Anchor is in line square with the posts and hammer fully into the ground.
2. To remove from ground tap lightly and wiggle left to right and lift up. This should leave the ground undisturbed.

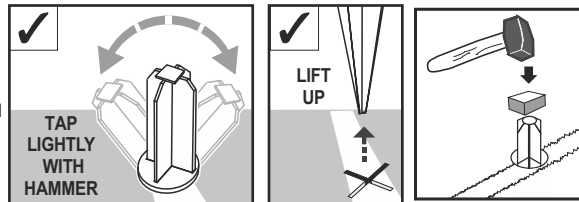

Note : If the ground is hard it is advisable to wet the ground and make a starting hole with a metal pole before hammering the ground anchor into the ground. Damage cause in this way will invalidate your warranty.

WARNING

Note it is the responsibility of the land owner or football ground site manager to make sure the ground spikes are fitted correctly in accordance with the instructions and the spikes are supporting the poles and ball stop netting system safely so that it can not topple. No one should ever swing on the poles and keep children away from the ball stop netting system at all times. If it is found the ground is not suitable to support the ball stop netting system using the metal spikes we also offer ground sockets that can be concreted in to support the system. visit www.itsagoal.co.uk for ground socket information.

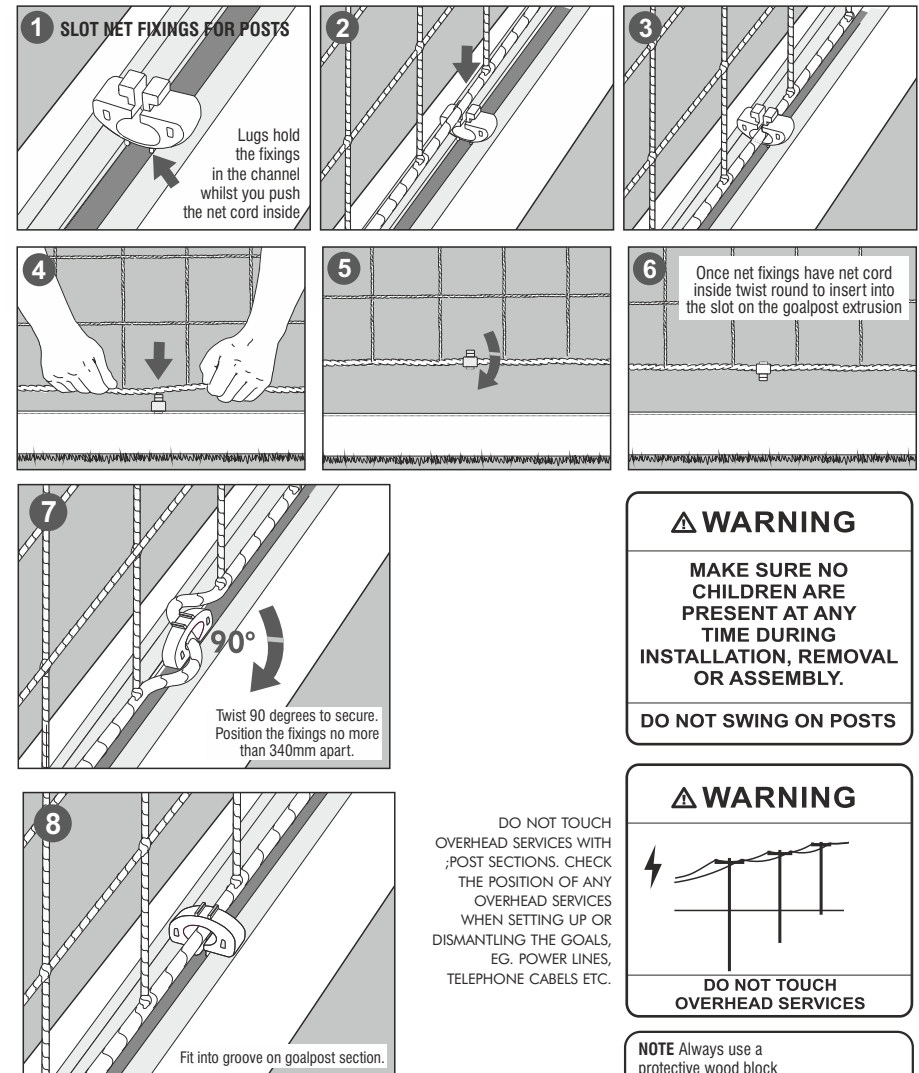

WARNING

MAKE SURE NO CHILDREN ARE PRESENT AT ANY TIME DURING INSTALLATION, REMOVAL OR ASSEMBLY.

DO NOT SWING ON POSTS

WARNING

DO NOT TOUCH OVERHEAD SERVICES

DO NOT TOUCH OVERHEAD SERVICES WITH POST SECTIONS. CHECK THE POSITION OF ANY OVERHEAD SERVICES WHEN SETTING UP OR DISMANTLING THE GOALS, EG. POWER LINES, TELEPHONE CABELS ETC.

NOTE Always use a protective wood block when hammering with a metal mallet to protect the shape of the ground anchor

WATER
GAS