



# **Designing Better Schools: The Four Dimensions of Human Ability**

# INTRODUCTIONS



**Marcus Adrian** | AIA, LEED AP  
*Principal*



**Kevin Symons**  
*Senior Associate*



**MACKEY MITCHELL**  
ARCHITECTS









# **DIMENSIONS OF HUMAN ABILITY**



# DIMENSIONS OF HUMAN ABILITY

**Physical**

Social

Cognitive

Sensory





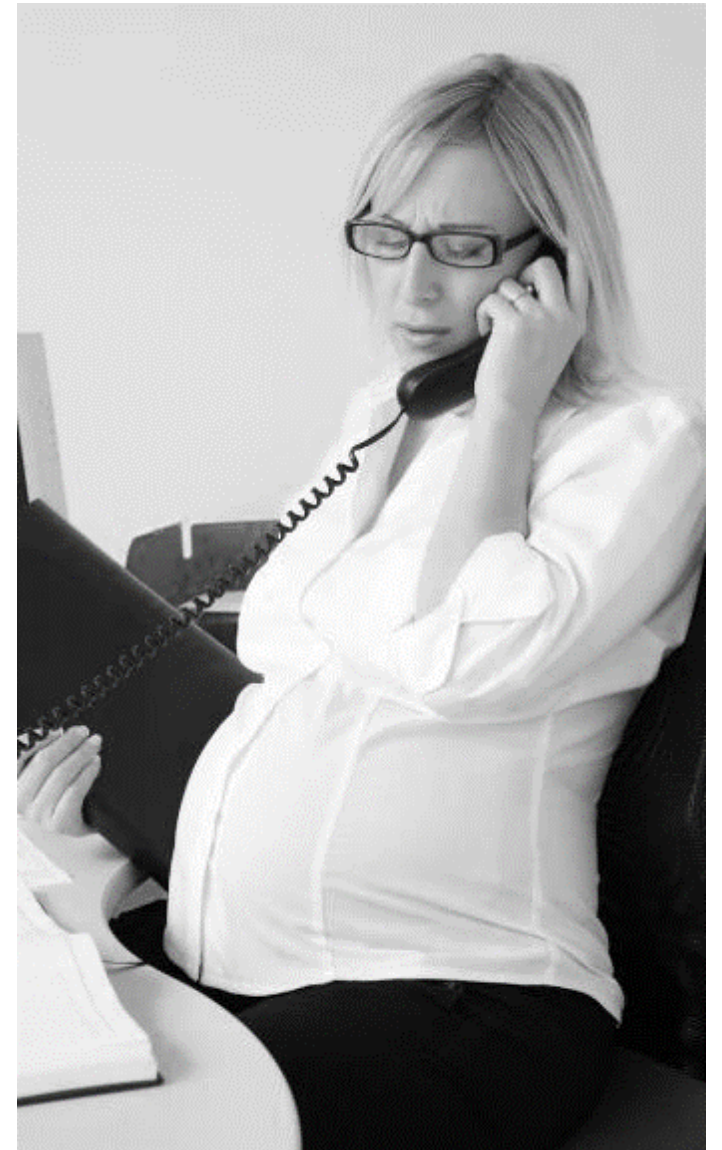
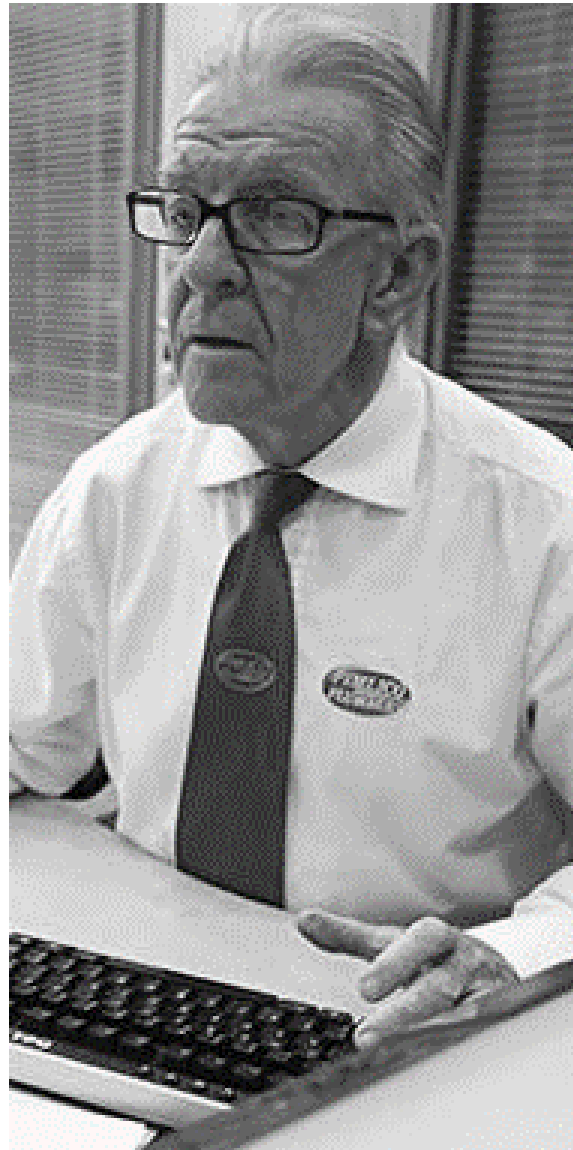



# DIMENSIONS OF HUMAN ABILITY

Physical

**Social**

Cognitive

Sensory















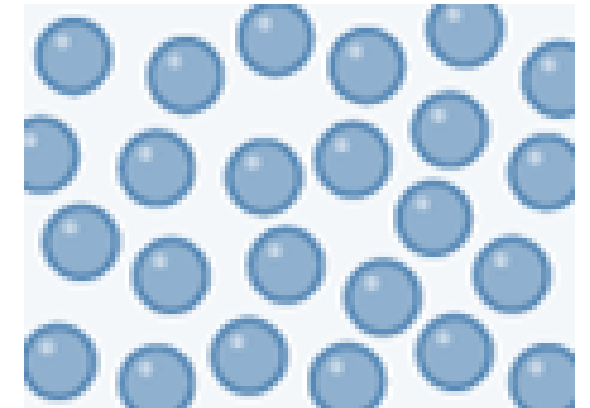
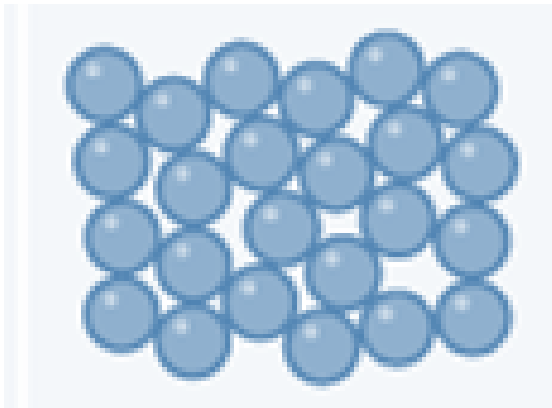
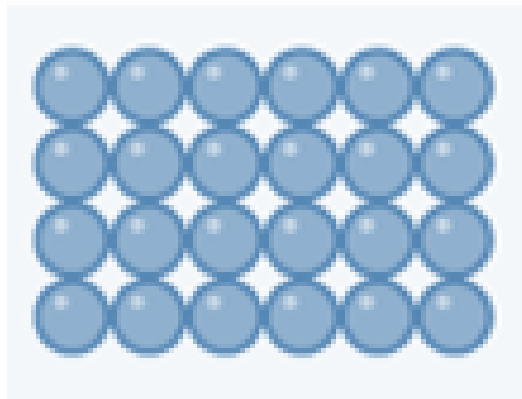









# DIMENSIONS OF HUMAN ABILITY

Physical

Social

**Cognitive**

Sensory

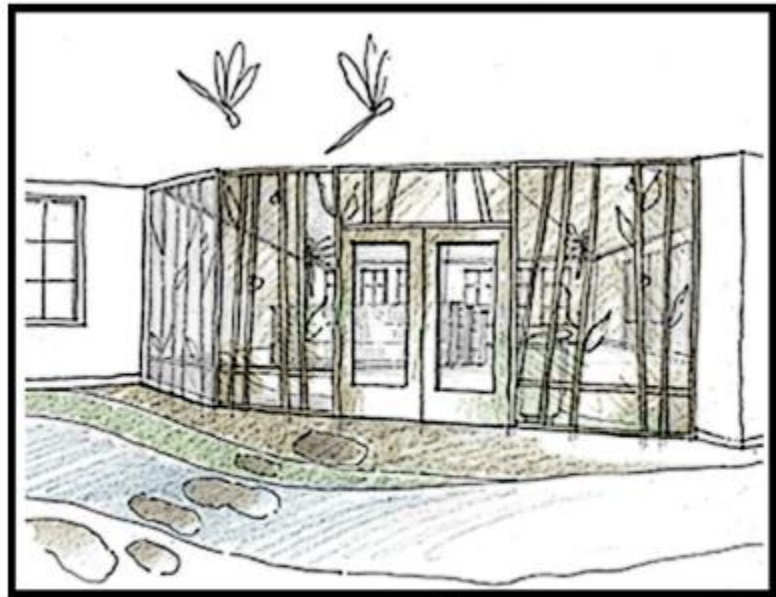
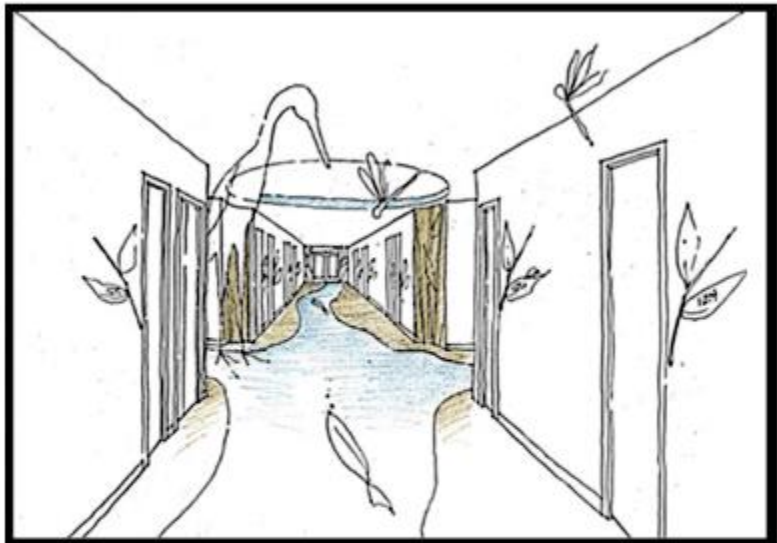
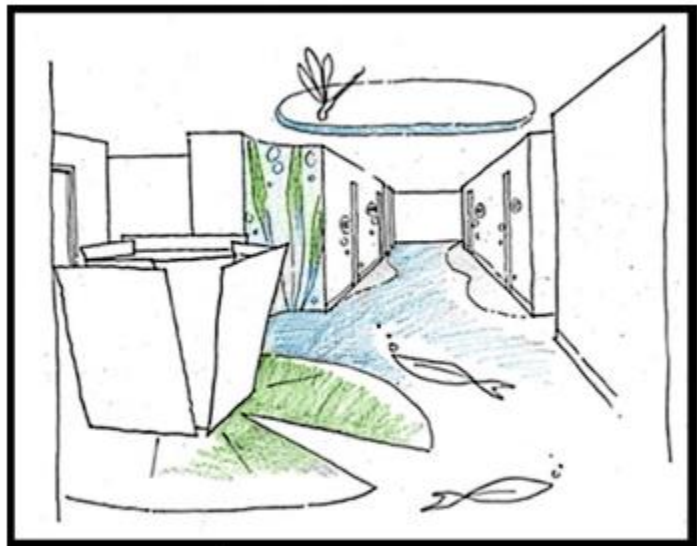





Handwritten notes and a small chart on a bulletin board.

Handwritten banner with the text "EAGLES" and decorative elements.



Digital display above the door showing the time and date: 8:58 AM, Mon 23. 2018.















# DIMENSIONS OF HUMAN ABILITY

Physical  
Social  
Cognitive  
**Sensory**





# SENSORY



The five senses you know:

- Sight, touch, taste, hearing, and smell

The two you may not know:

- Vestibular: ability to maintain balance and body posture.
- Proprioceptive: sense of movement and body position

All seven continually send information to the brain.

# WHAT IS ATTENTION?

Focus on  
**SIGNAL**  
in the presence of  
**NOISE**



# WHAT IS SIGNAL?

object, lesson, matter, substance, material,  
phenomenon, spectacle, information

These things reinforce learning.

# WHAT IS NOISE?

interference, obstruction, distraction,  
intrusion, glare, distortion

These things interrupt learning.























# **BIOPHILIC DESIGN**



# WHAT IS BIOPHILIC?

Connecting building occupants  
(i.e. children, caregivers, etc.)  
to **NATURE** to help foster a more  
**PRODUCTIVE** and **HEALTHY**  
environment



# NATURE'S PALETTE



Stone



Wood



Plants



Fire



Water

# COLOR PSYCHOLOGY



## Red

Celebrate, Love, Warmth,  
Glamour, Restful, Caution,  
Increases appetite



## Green

Calming, Nurture,  
Fertility, Reinforces  
attention and reading  
comprehensive



## Orange

Rich, Exotic,  
Appetizing



## Blue

Tranquil, Mystery,  
Refreshing, Promotes  
wakefulness



## Yellow

Cheer, Hope,  
Caution



## Purple

Unique, Regal,  
Bravery



# SUNSHINE COTTAGE













# **CASE STUDY:** **MARYLAND SCHOOL FOR THE DEAF**





































# **CASE STUDY: DELAWARE SCHOOL FOR THE DEAF**











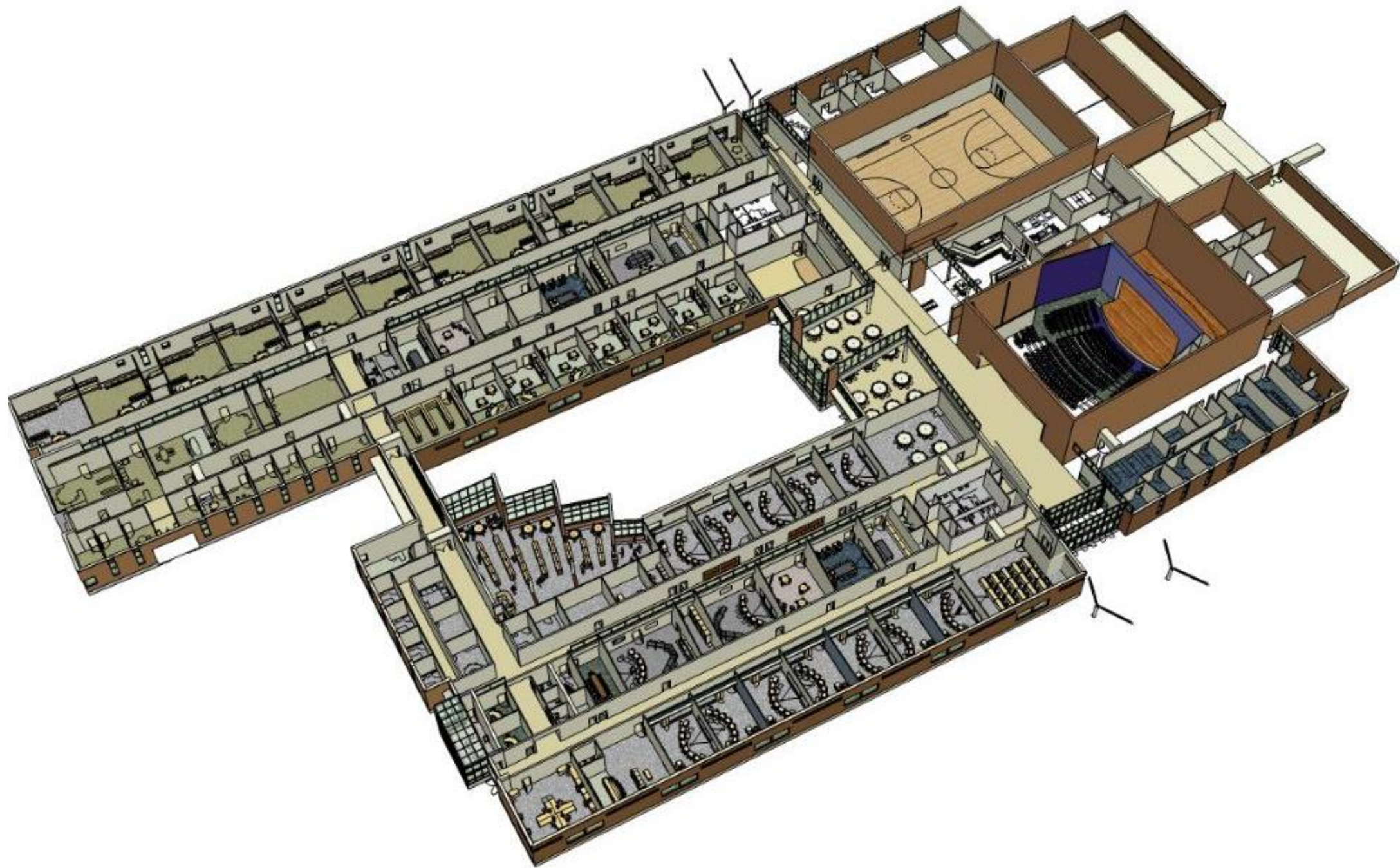

























# **CASE STUDY: CENTENE CHILDCARE CENTER**













# **CASE STUDY: MAGNOLIA SPEECH SCHOOL**





MORNING CIRCLE





k an  
ko ko ko  
ke ke ke  
ka ka ka  
kan kan kan  
kon kon kon  
can

consonant sounds

k w  
p b m  
t d n  
k g ng  
th sh  
ch

vowel sounds

oo oo o  
ee e  
ai a  
ou u  
oi o  
oy o

d ae  
do do do  
de de de  
da da da  
de de de  
day  
day









THANK YOU  
THURSDAY  
We won't have  
to stop thank the  
people who make a  
difference in our  
lives.  
-Sam F. Kennedy  
Pick one person in  
your life you  
are thankful  
for, and why.























**YOUR TURN ...**



# **CASE STUDY: BROWN SCHOOL OF SOCIAL WORK**







**Master Planning for Brown School of Social Work**



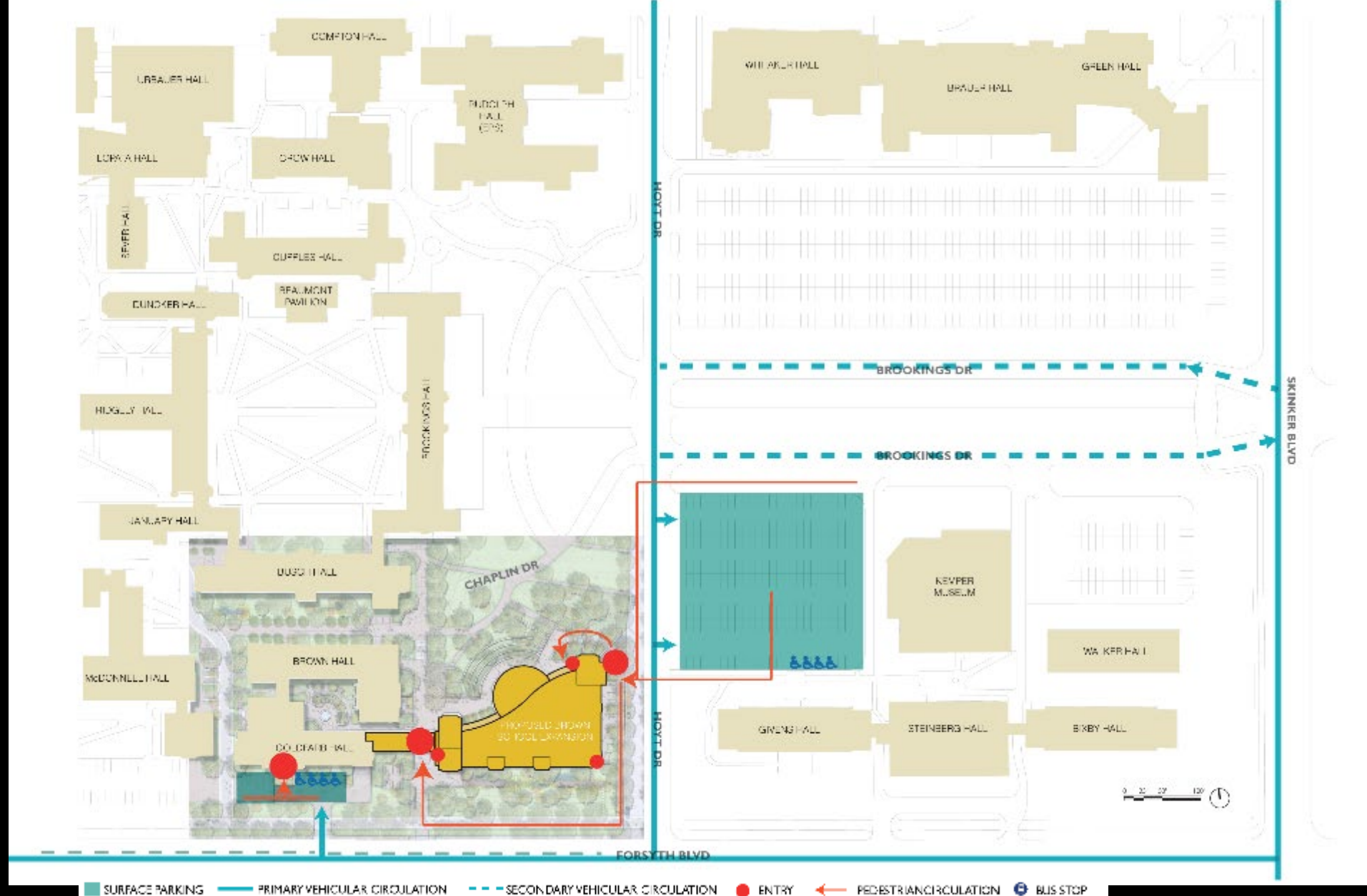

**Primary Vehicular & Pedestrian Circulation Patterns**











# Garden Level: Exterior and Interior Circulation Pattern

- |                      |                     |
|----------------------|---------------------|
| 1. North Plaza       | 7. North Grove      |
| 2. Terraced Garden   | 8. Gathering Garden |
| 3. East Entry        | 9. Bicycle Parking  |
| 4. South Grand Stair | 10. Service Entry   |
| 5. South Plaza       | 11. Social Stair    |
| 6. Rain Garden       |                     |

BUSCH

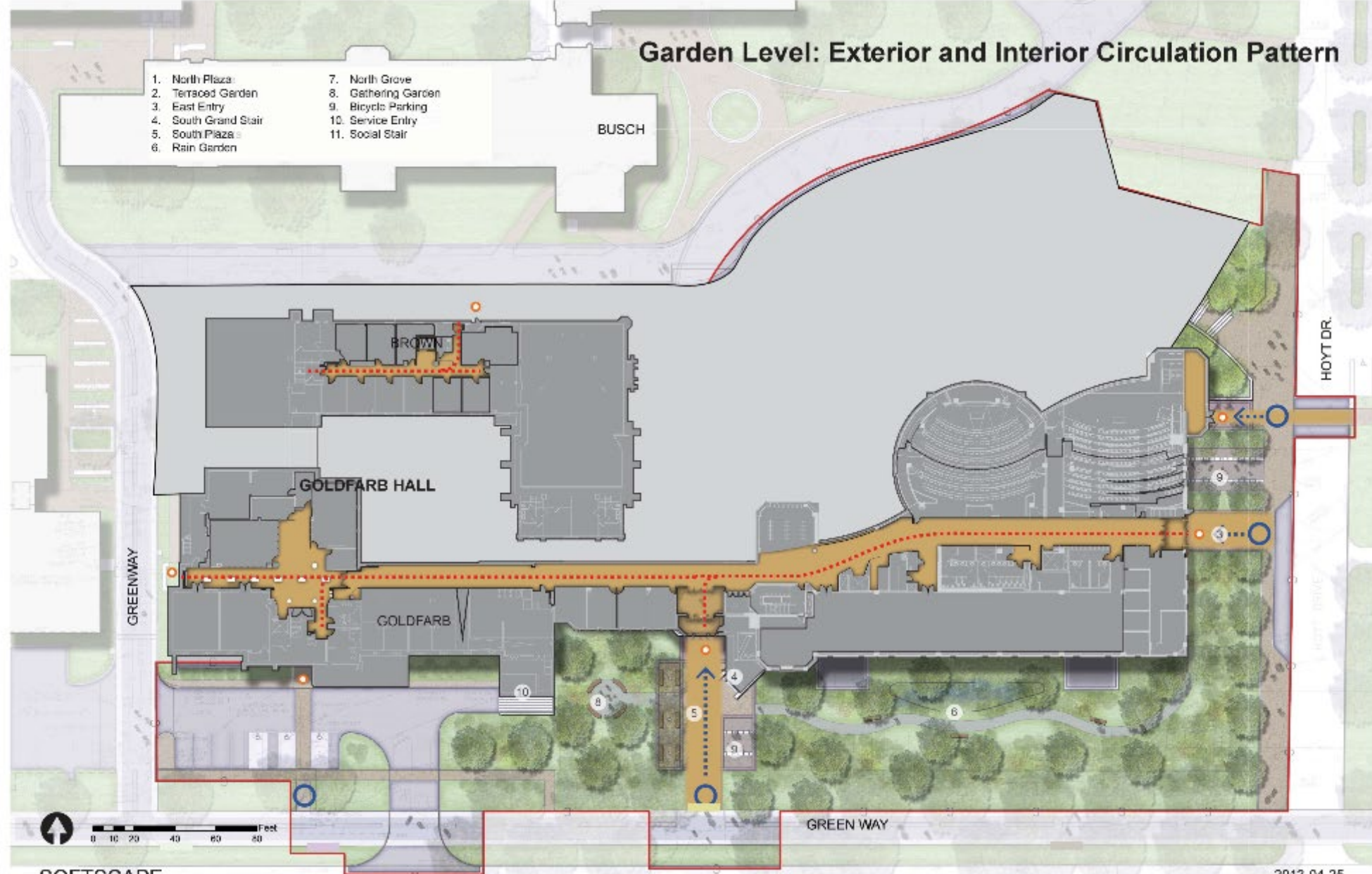

SOFTSCAPE

2013-04-25

# Level 1: Exterior and Interior Circulation Pattern

Alternate 1

- |                      |                     |
|----------------------|---------------------|
| 1. North Plaza       | 7. North Grove      |
| 2. Terraced Garden   | 8. Gathering Garden |
| 3. East Entry        | 9. Bicycle Parking  |
| 4. South Grand Stair | 10. Service Entry   |
| 5. South Plaza       | 11. Social Stair    |
| 6. Rain Garden       |                     |

BUSCH

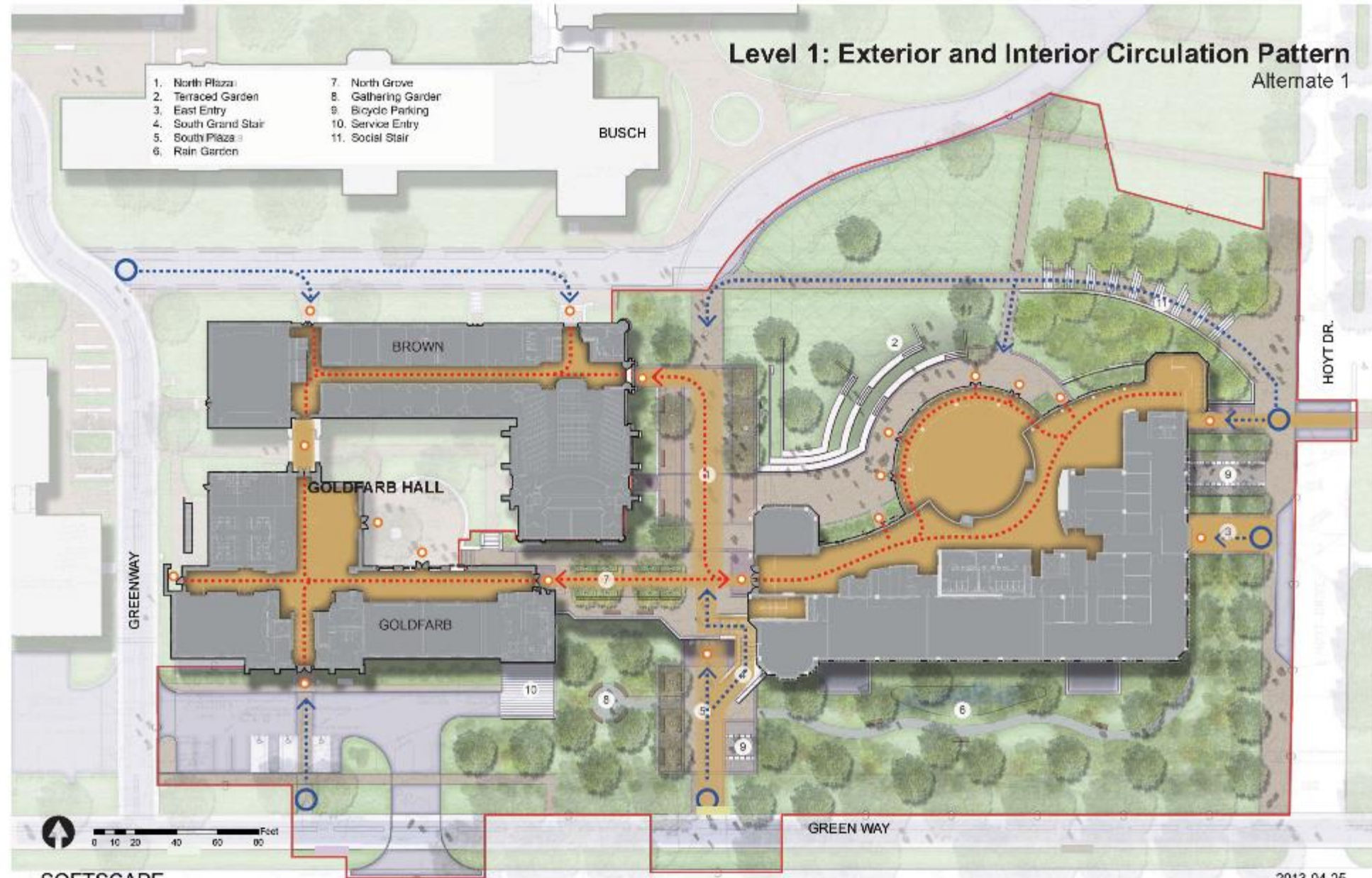

SOFTSCAPE

2013-04-25



## BROWN HALL

## PROPOSED BROWN EXPANSION

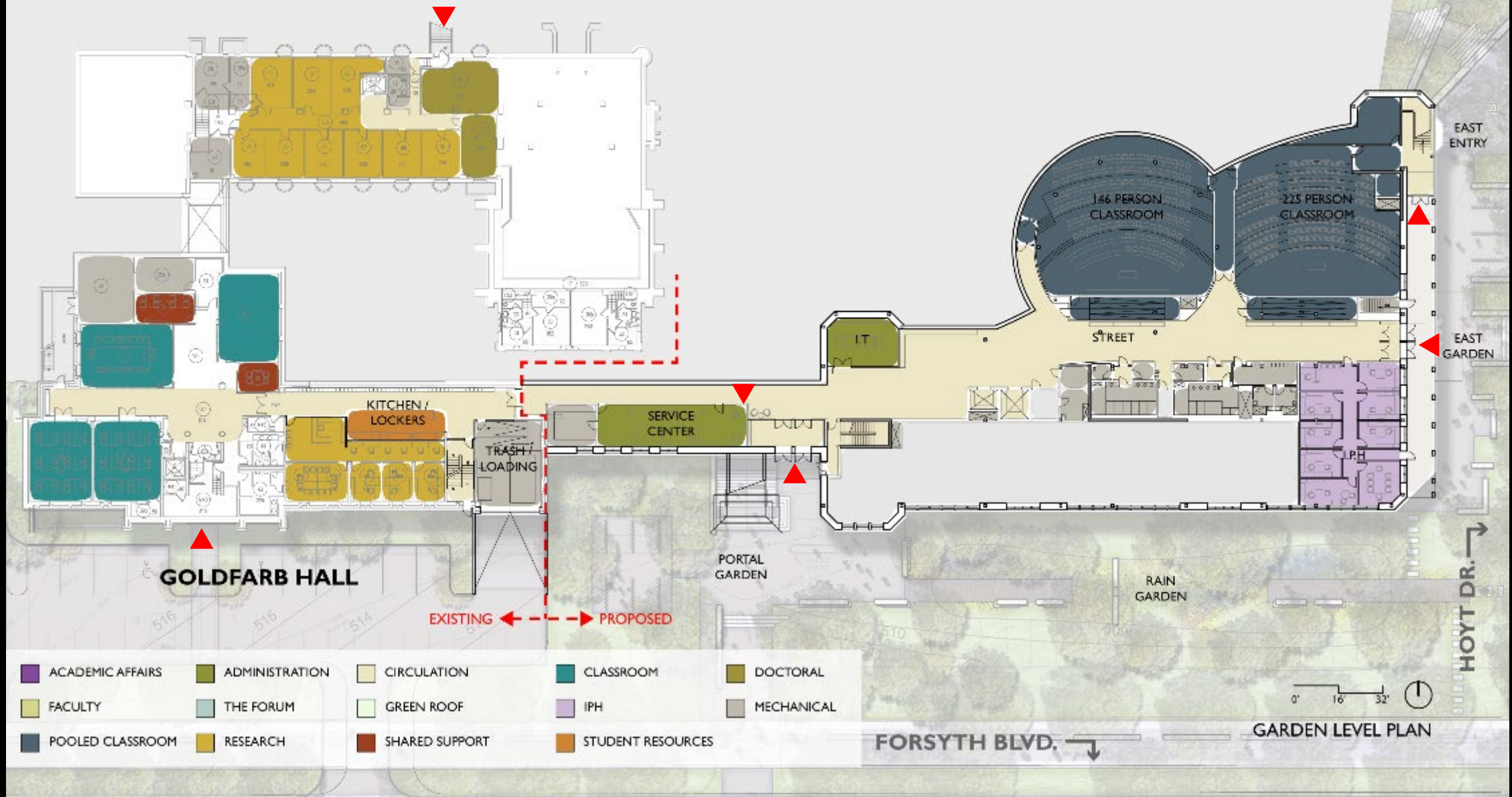

Garden Level



## BROWN HALL

## PROPOSED BROWN EXPANSION

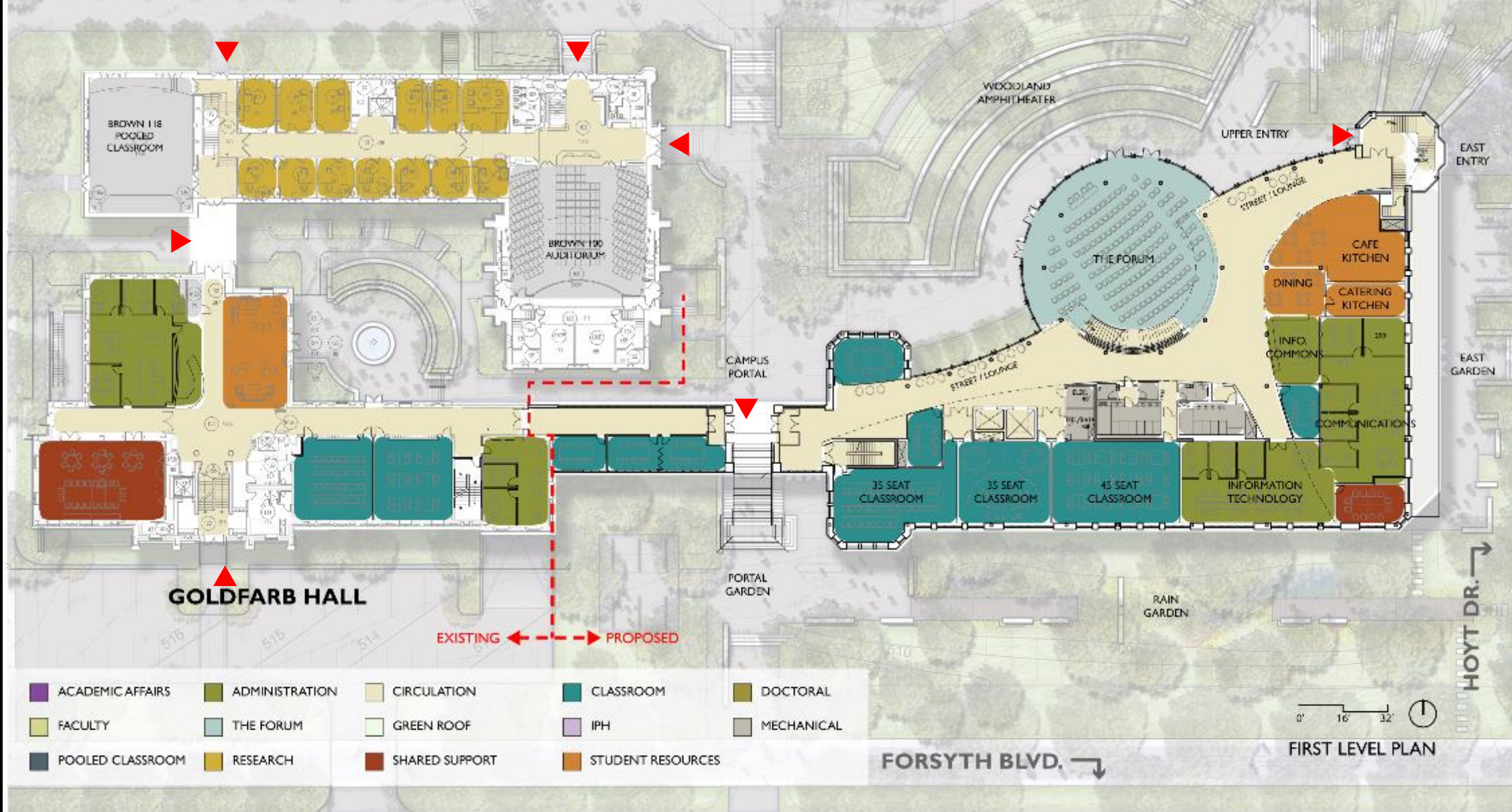

## LEVEL 1



## BROWN HALL

## PROPOSED BROWN EXPANSION

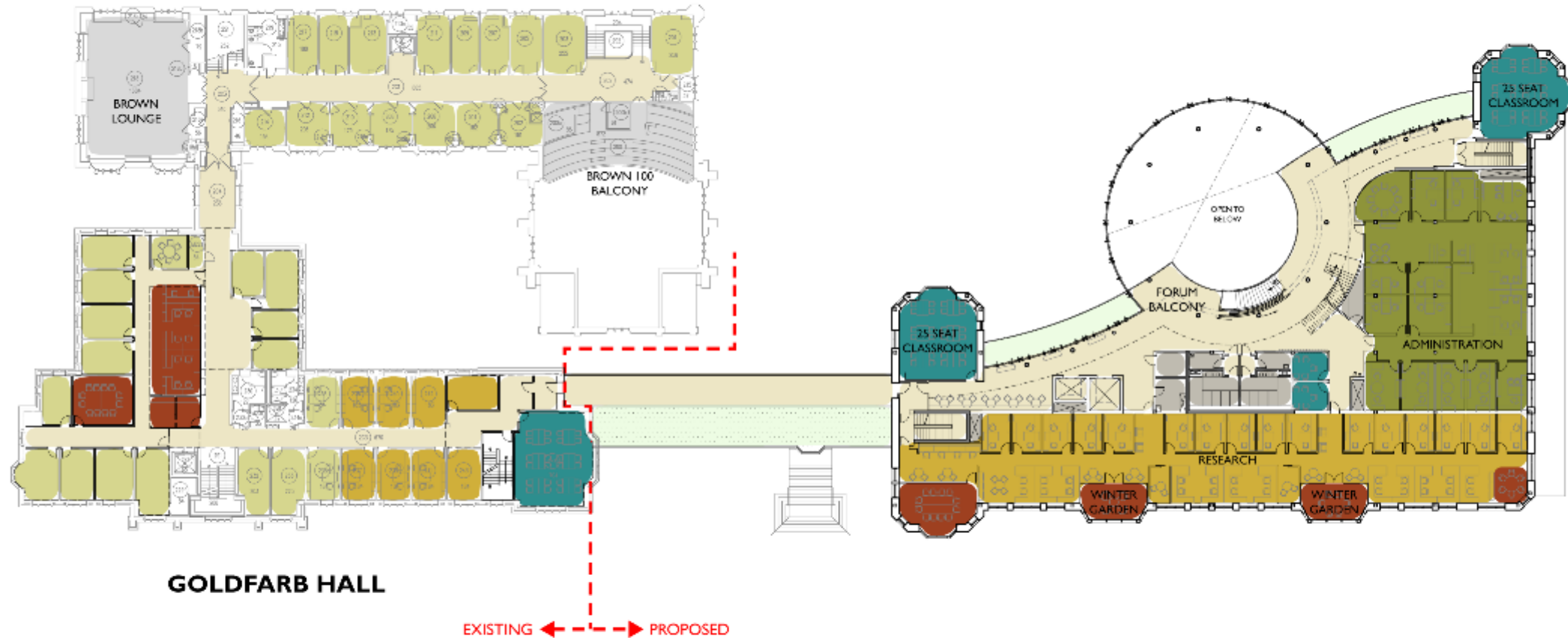

SECOND LEVEL PLAN

## LEVEL 2

## BROWN HALL

## PROPOSED BROWN EXPANSION

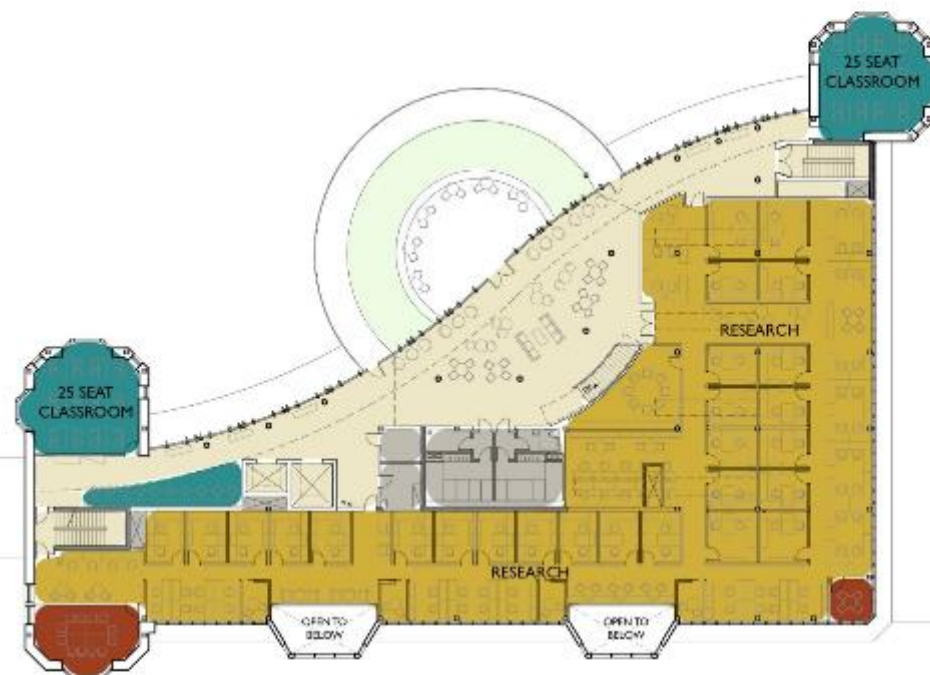

## GOLDFARB HALL

ACADEMIC AFFAIRS	ADMINISTRATION	CIRCULATION	CLASSROOM	DOCTORAL
FACULTY	THE FORUM	GREEN ROOF	IPH	MECHANICAL
POOLED CLASSROOM	RESEARCH	SHARED SUPPORT	STUDENT RESOURCES	

0' 16' 32'   
THIRD LEVEL PLAN

## LEVEL 3