

HOW TO REPLACE LOUVERS

Broken Louver

Broken louver within a shutter panel.

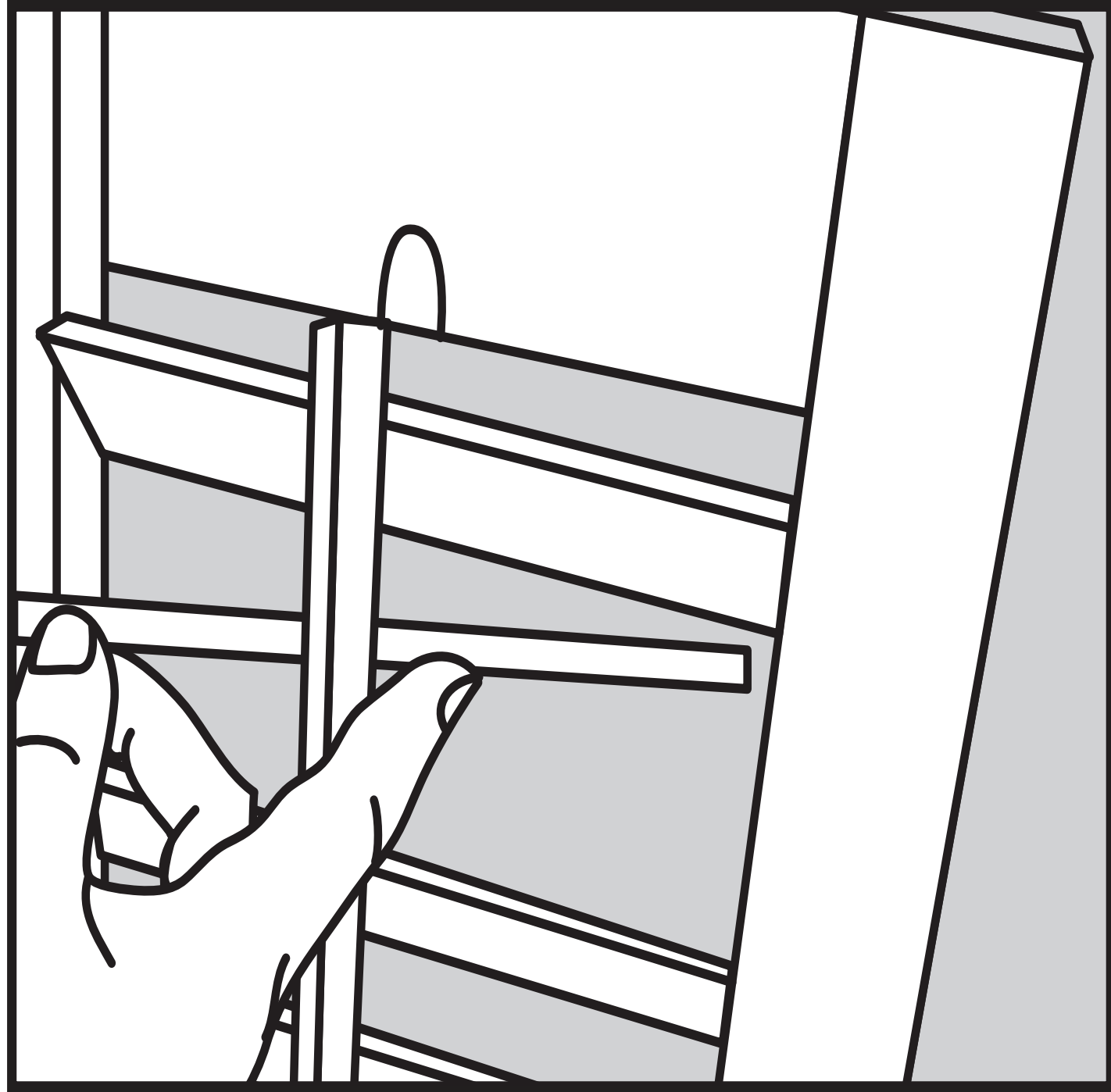

Tilt rod with hook and eye replacing staples



1

Cut Out Old Pins To Remove Louver

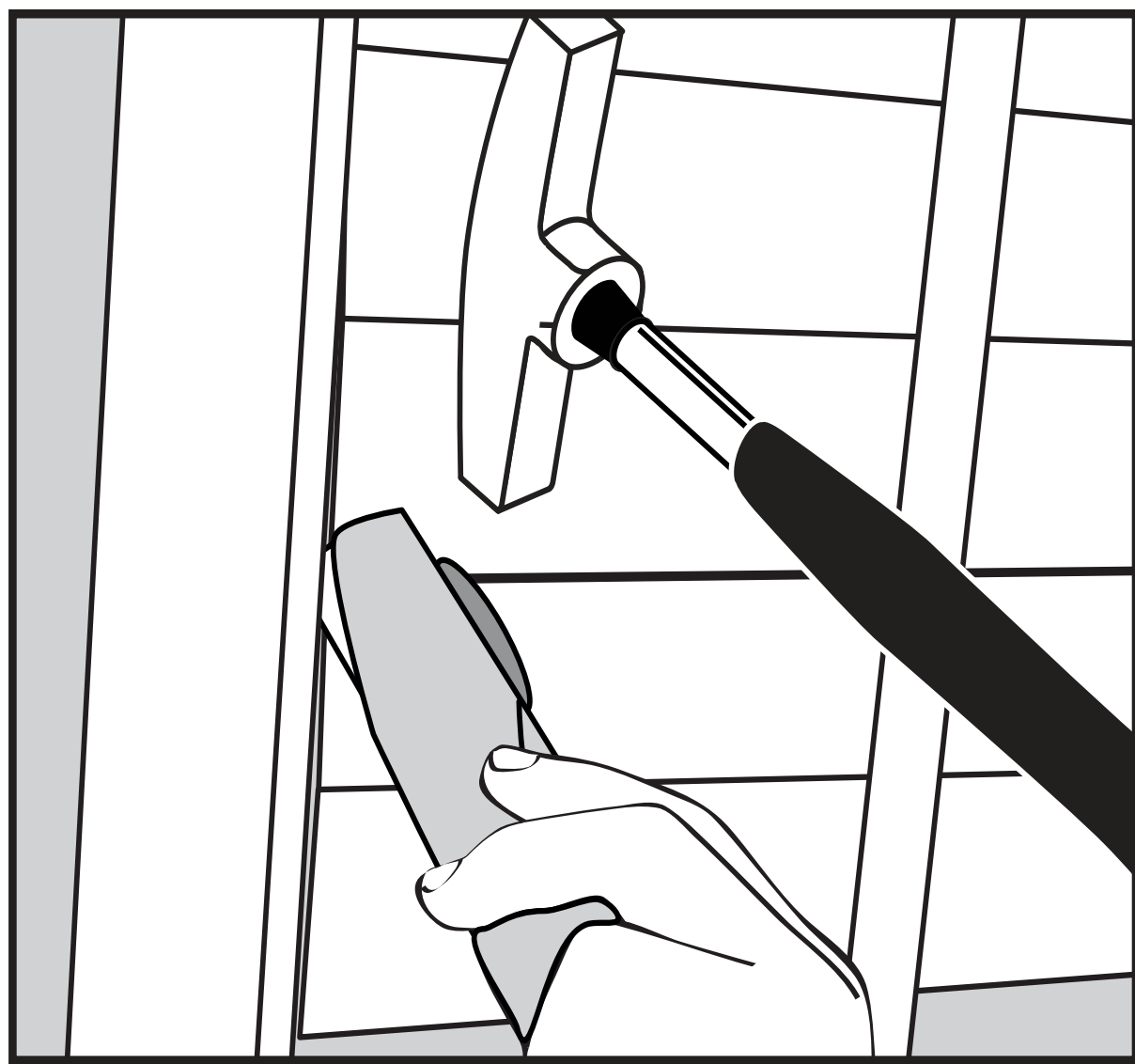

To remove louver, place utility knife blade between louver and panel edge. Lightly tap knife with hammer to cut through louver pin.

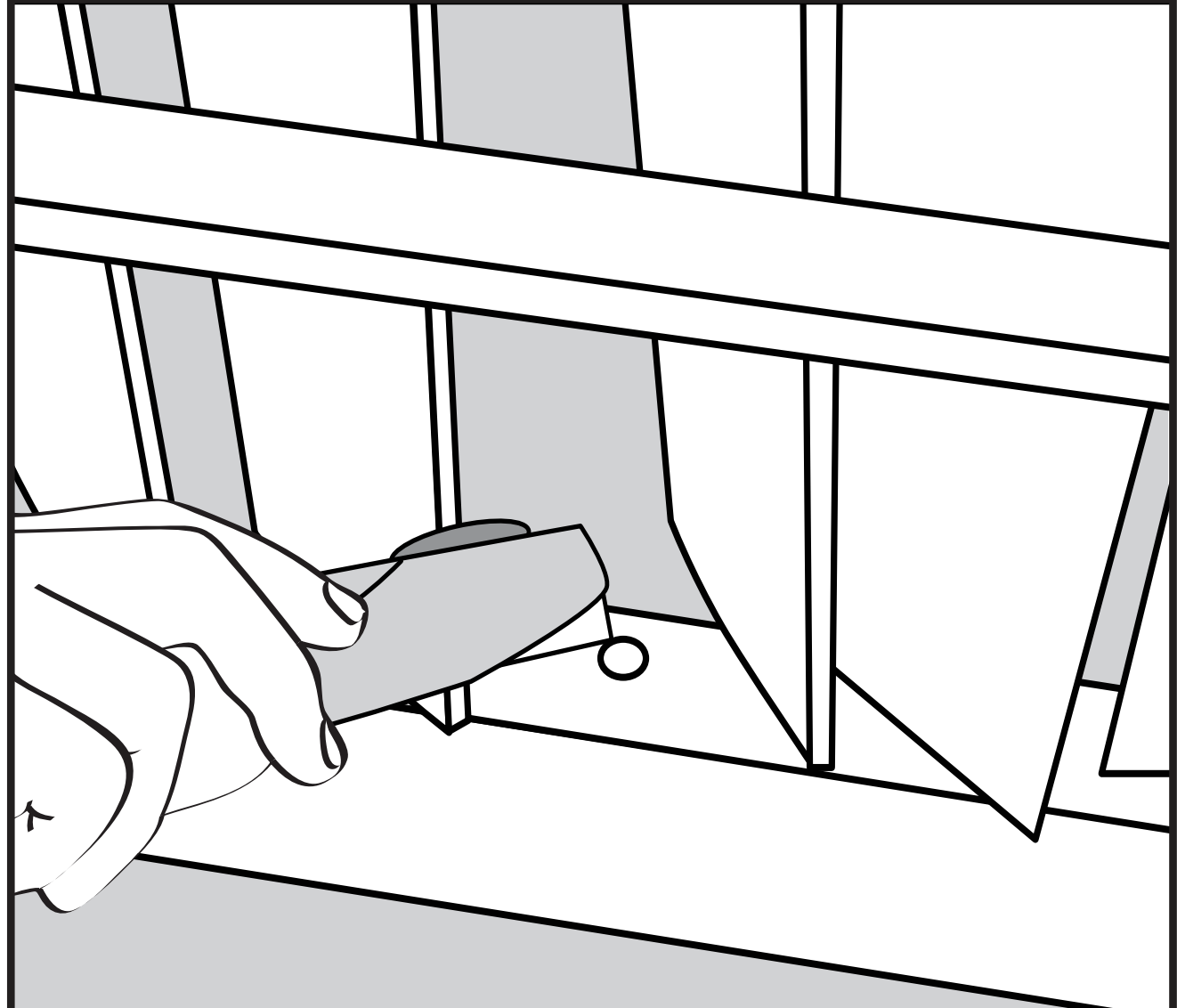

With utility knife remove portion of louver pin remaining in edge of panel. Be careful not to scratch or damage edge of panel.

2

Remove Tilt Mechanism From Louver

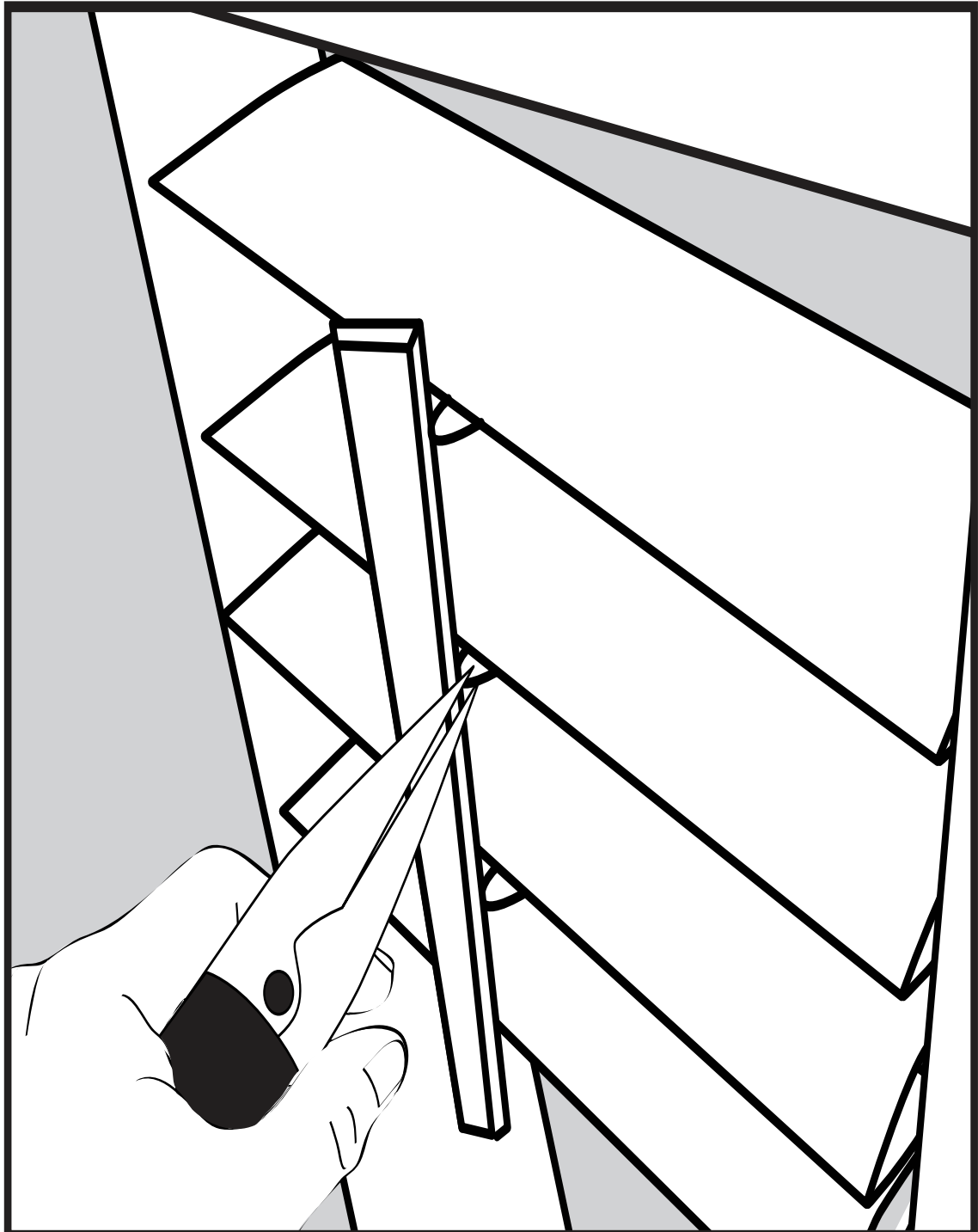

Use needle nose pliers to remove staple from tilt bar.

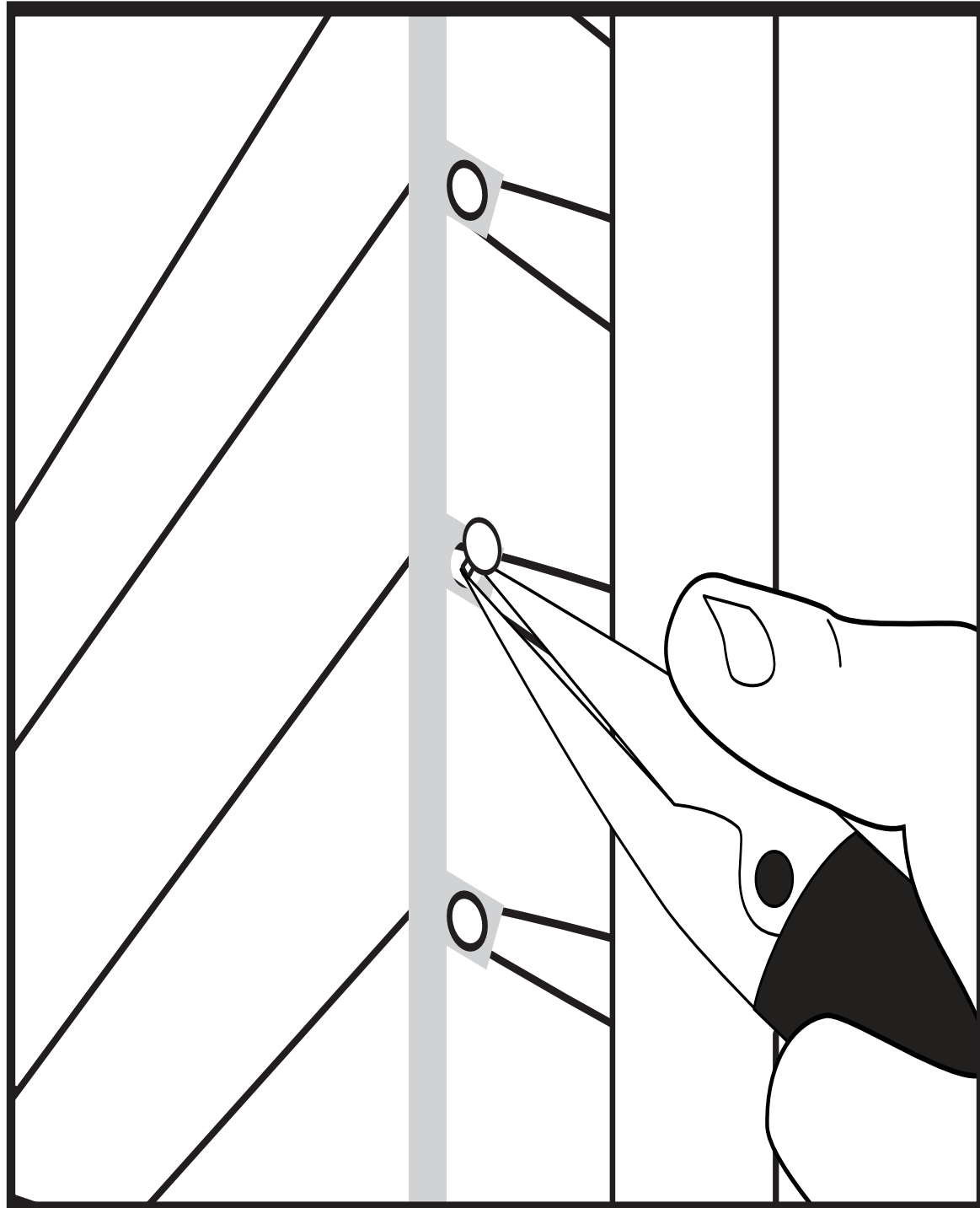

Use needle nose pliers to pry nail out of rear tilt. Also, remove louver pin from other edge of panel.

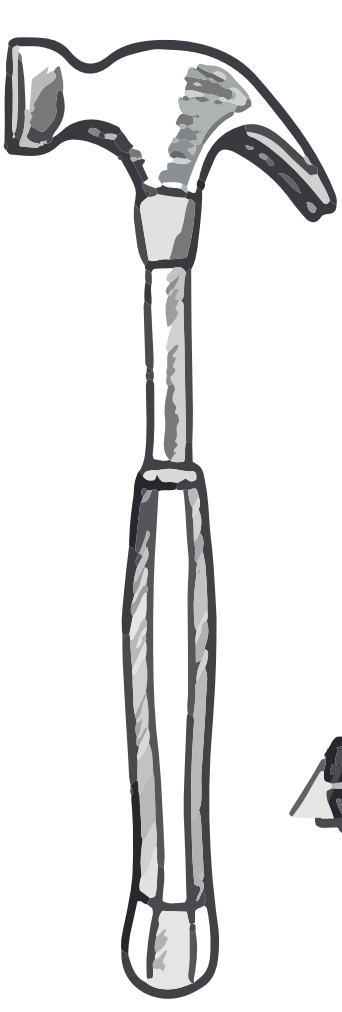

Hammer



Utility knife

Hand Held Drill

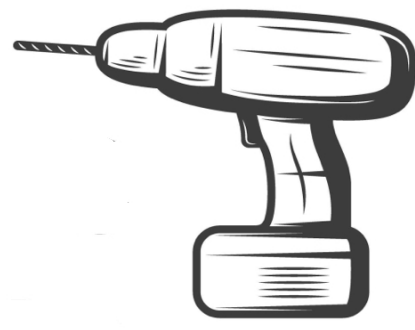

Power Saw

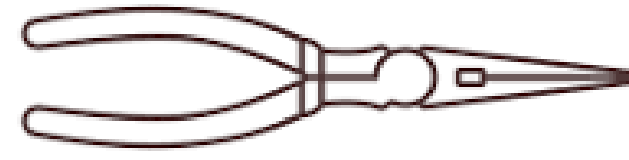

Needle Nose pliers



Flathead Screwdriver

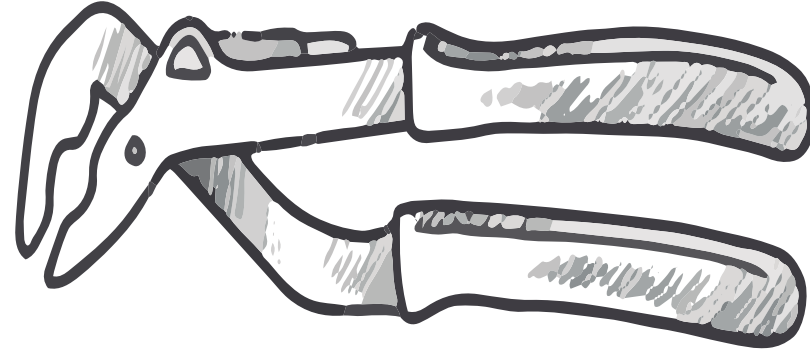

Channel Lock Pliers

Tools Needed

3

Replace Old Louver

Use new louvers from our multi pack using the old louver for reference, cut to length, drill both louver end centers to 9/64" for louver pins. Paint louvers to match before assembly. Please use a face mask while painting – HVLP or spray can, Krylon, Rust-Oleum, etc. Make sure to remove all pencil markings from louvers and do a light sanding. Wipe down with denatured alcohol before painting and wear rubberized gloves through the process including painting parts. If using front tilt rod, drill small staple holes into louvers or notch louver edge for rear tilt and drill 3/64" pilot hole. Use included spring-loaded and standard louver pin assemblies.

Push spring loaded pin into stile louver pin hole so it fit flush to collar of pin. Insert standard pin into louver hole.

Note location of hole for rear tilt before installing.

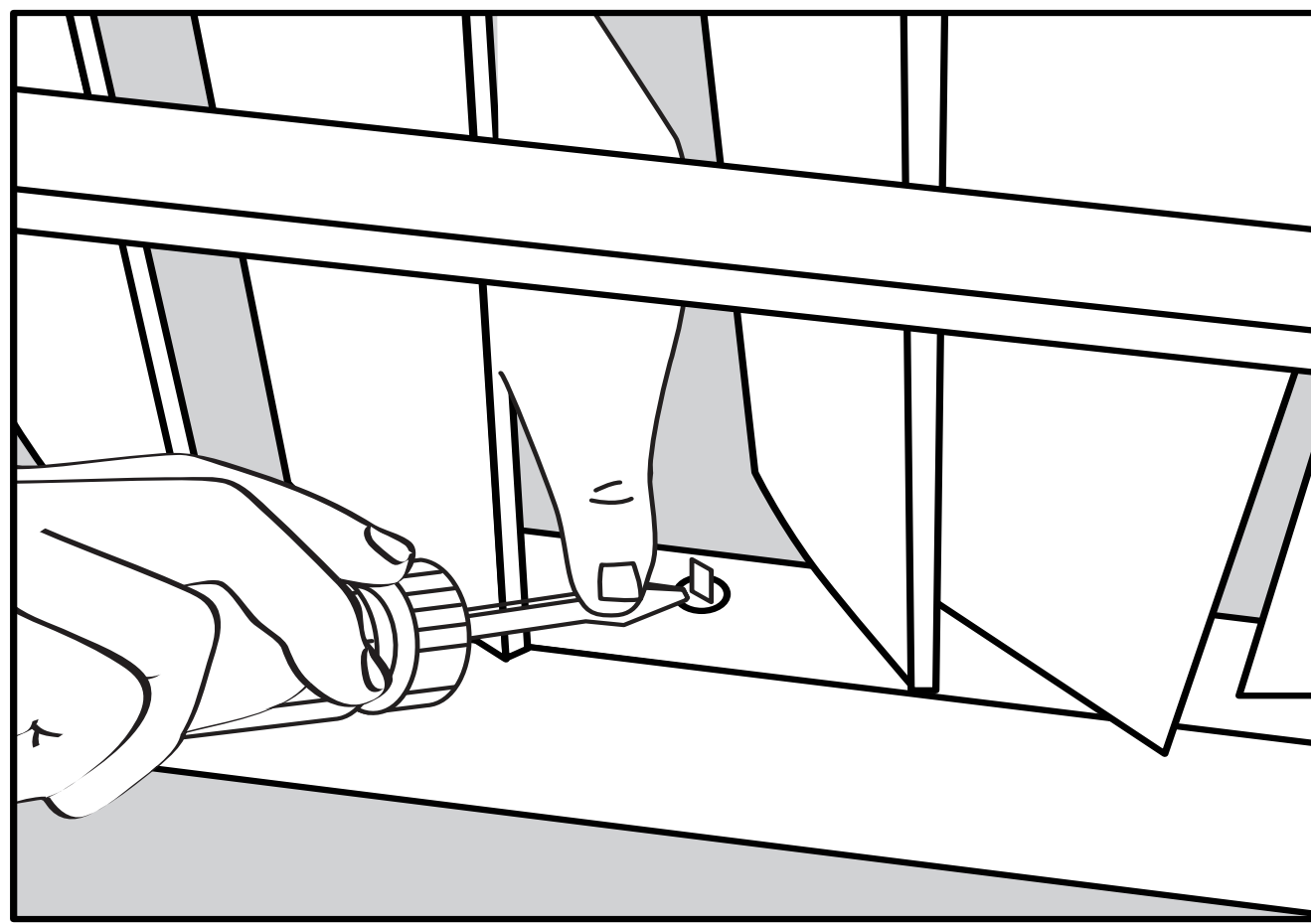

Install new louver by sliding end with pin into stile hole, then depress spring-loaded pin with edge of utility knife and align louver spring-loaded pin into louver pin hole.

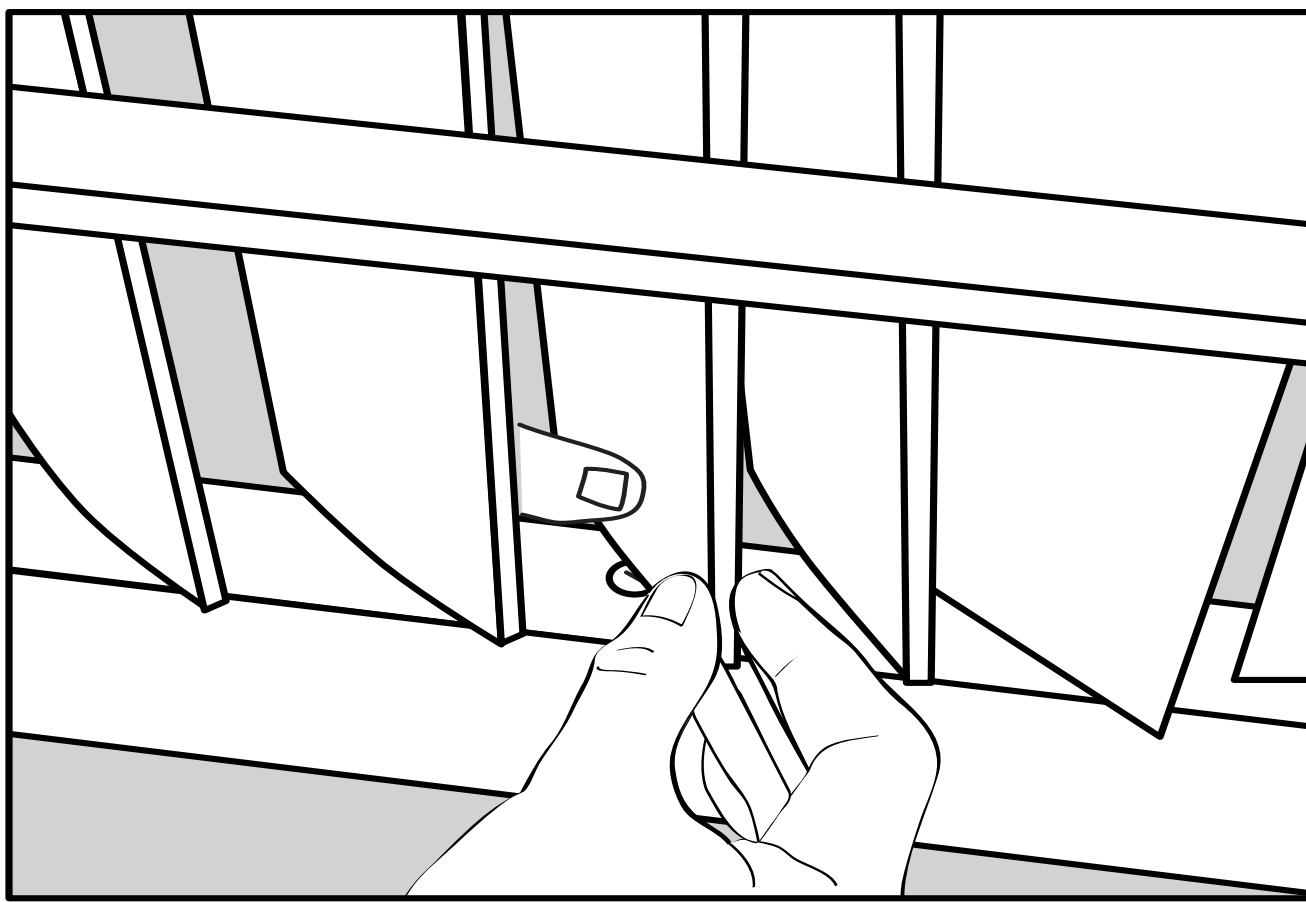

4

Attach Louver to Tilt Mechanism

Attach louver to tilt bar with new staple. First apply a small amount of glue to staple and insert into tilt bar through staple on louver edge.

Using channel lock pliers, squeeze staple so eyelet opening appears square. To attach louver to rear tilt bar, first apply a small amount of glue to staple and insert through tilt bar and into pre-drilled hole in end of louver. Lightly tap into position with hammer. *****we recommend*** Use screw brass, eye and hook for front tilt rods (replacing the staples). Centered into the edge of the louver before installing it, screw in an #0 size eye. Screw into to the tilt rod a 1/2" size cup hook were old staple was located. Connect the hook attached to tilt rod into the eye and with pliers close the hook. (see above pic)**

