

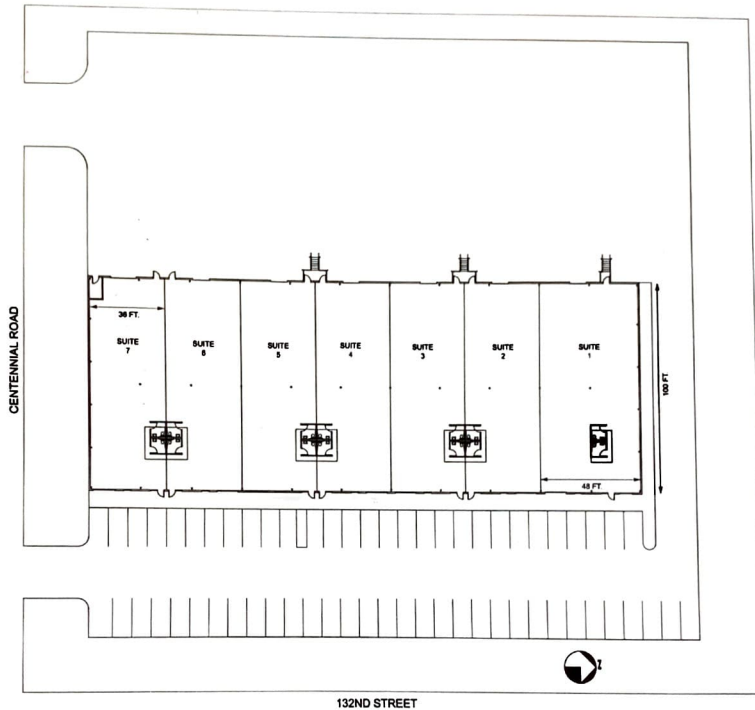

BAATZ
—PROPERTIES—

I-80 INDUSTRIAL PARK II

13210 CENTENNIAL ROAD



Building contains 26,400 square feet and has seven bays

- Suite 1 contains 4,800 square feet with dimensions of 48 feet wide by 100 feet deep
- Suites 2 thru 7 each contain 3,600 square feet with dimensions of 36 feet wide by 100 feet deep
- Bays may be combined for larger users

I-80 Industrial Park II

Location: Omaha, NE
South of Giles on 132nd Street

With immediate access to:

- *Interstate 80
- *Giles Road
- *132nd Street



STAN@BAATZPROPERTIES.COM
LUKE@BAATZPROPERTIES.COM

(402) 677-2987
(402) 657-1849

P.O. Box 391405
OMAHA, NE 68139

I-80 INDUSTRIAL PARK II

13210 CENTENNIAL ROAD



Building & Lot Features:

- Ideally suited for warehouse, sales, & service
- Masonry & steel construction
- 20 foot ceiling height
- Exterior lighting with photoelectric controls
- Pedestrian doors front & rear
- Gas heat
- Floor drain in each bay
- 120/208 volt 3-phase, 4-wire service, 200 AMP MLO panel
- 10' x 12' drive-in doors in front of each bay
- 12' x 14' drive-in door in rear of south bay
- 8' x 10' dock high doors in rear of north 6 bays
- Electric door openers on all drive-in doors

