

Ground Floor Plan 1:50

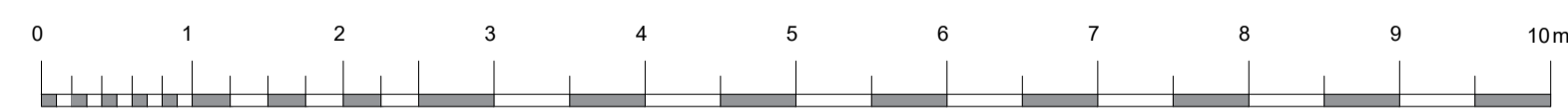

INTERNAL FLOOR AREA CRITERIA FINISH TO FINISH	
Bedroom 1	12.20m ²
Bedroom 2	11.55m ²
Bedroom 3	7.70m ²
Bedroom 4	7.70m ²
Built-in Storage	3.62m ²

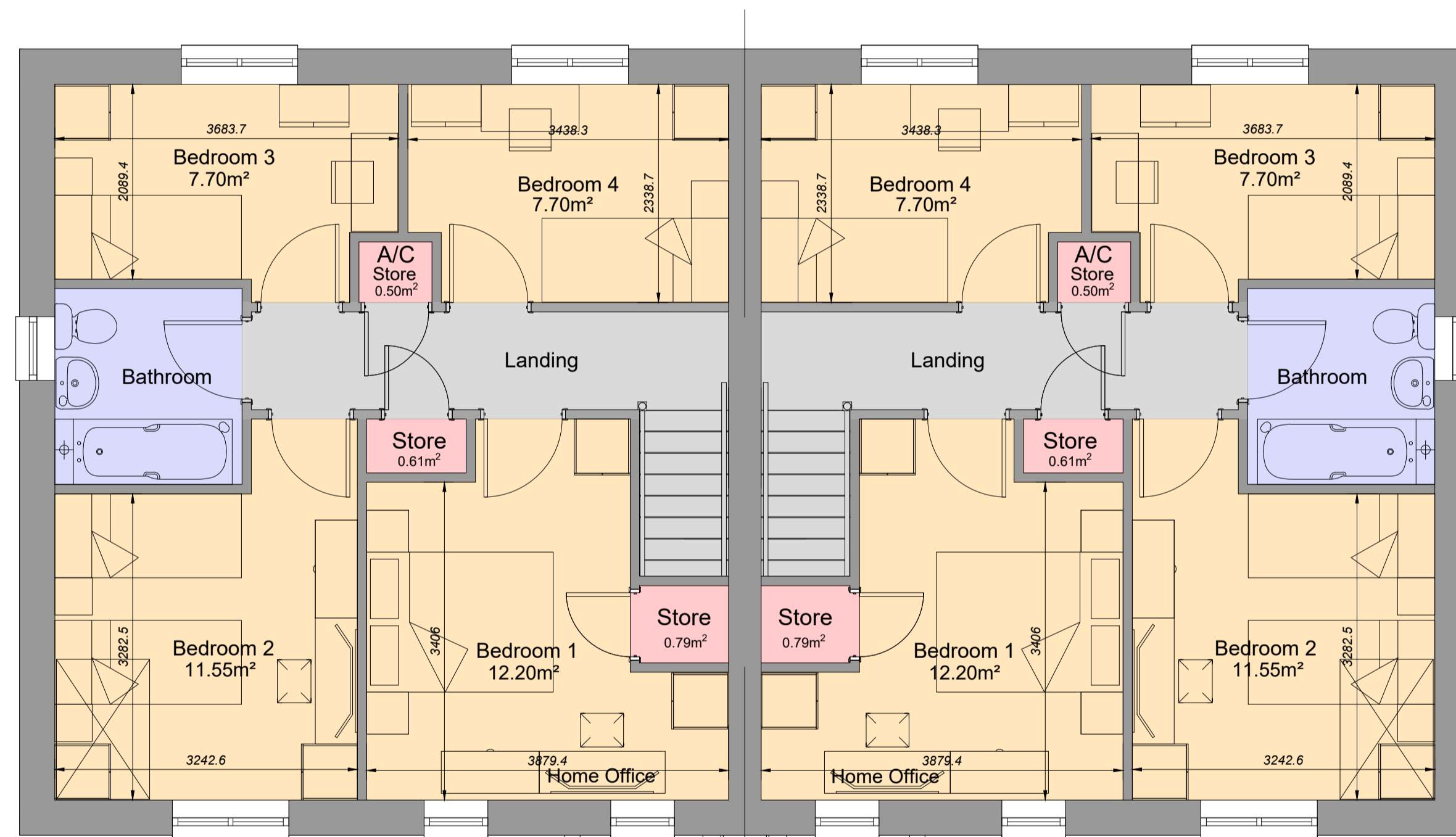

First Floor Plan 1:50

Plots
28, 29

HOUSE TYPE AREA
M² = 110 FP = 1184
Measured to finished
plasterboard face

REV.	DESCRIPTION	DATE
CLIENT Wales & West HA		
JOB TITLE New Mill Road		
DRAWING TITLE 4B-6P WDQR House [SEMI] Floor Plans Elevations		
SCALE @ A3	DATE	DRAWN BY
1:100	May '23	Hal
JOB NO.	DRAWING NO.	REVISION
2316	4B6P-WDQR-03	-



to Gold Tops
Newport
NP20 4PH
t. 01633 844970
e. info@hammond-ltd.co.uk

www.hammond-ltd.co.uk

© Hammond Architectural Limited 2023
Figured dimensions must be taken in preference to scaled dimensions and any discrepancies are to be referred to Hammond Architectural Ltd. Contractors, subcontractors and suppliers must verify all dimensions on site before commencing any work or making any workshop drawings.