

Boundary Treatments Layout :

Wolf's Castle, Llanishen  
Cardiff County Council



BOUNDARY TREATMENTS KEY :

- 1.8m high Facing Brick Screen Wall  
...to match that of Dwellings
- 1.8m high Repurposed Stone Wall  
(subject to material conditions and availability)
- 1.8m high Close Boarded Timber Fence
- 1.1m high Vertical Metal Railings to front boundary
- 0.45m high Knee Rail

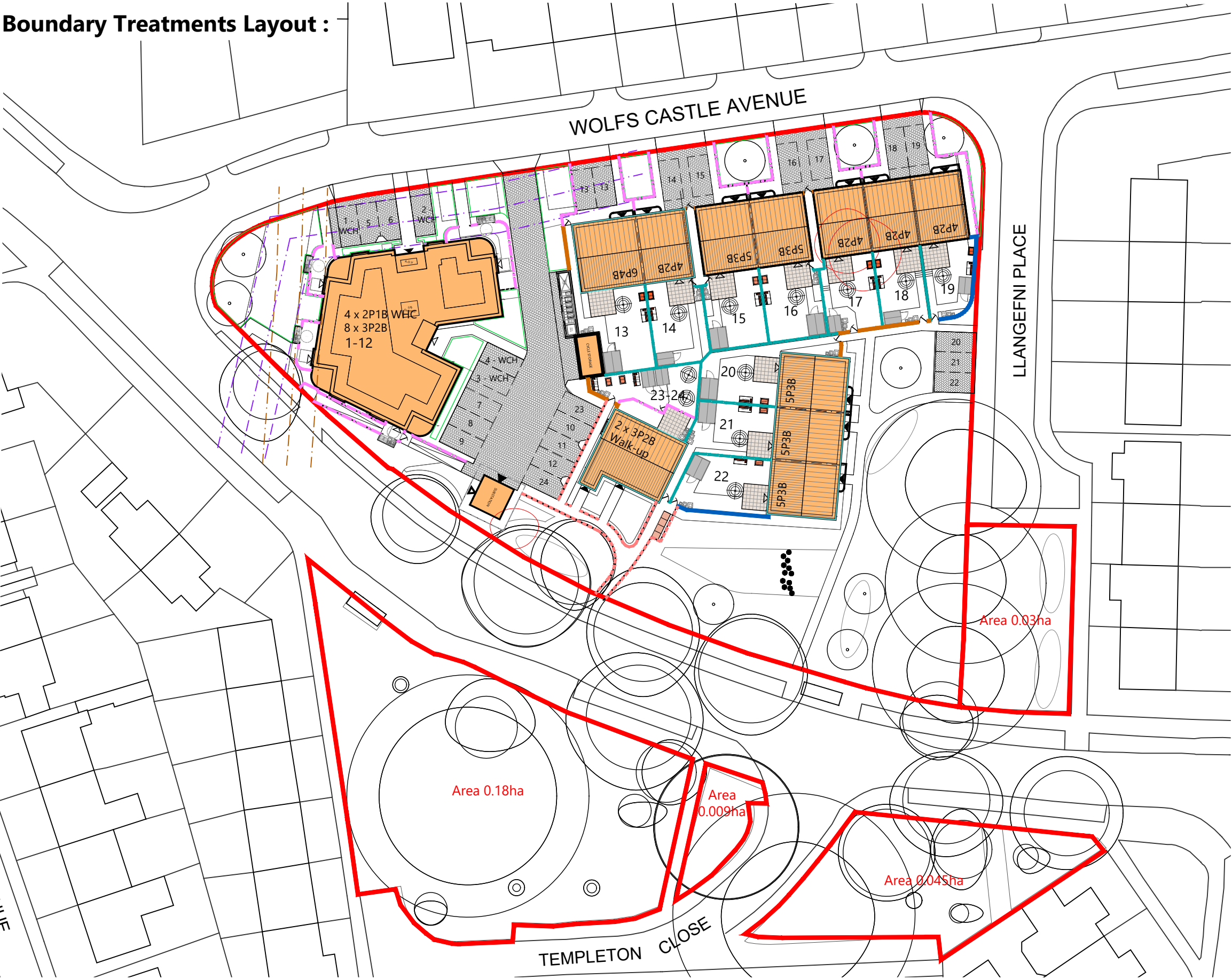
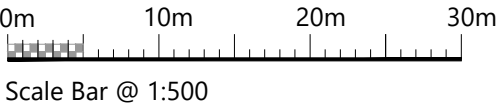

Figured dimensions and levels to be used.  
Any inaccuracies must be notified to the architect.  
Detail drawings and large scale drawings take precedence over smaller drawings.

Rev:	A	Updated to reflect amended site layout	art/TP 18.12.25
	B	Repurposed Stone wall included in key	AJC 06.01.25

Rev:			
Rev:			

PRELIMINARY	✓
PLANNING	
DESIGN	
TENDER	
CONSTRUCTION	

**powelldobson**  
ARCHITECTS

Cardiff Office: Suite 3F, Building One, Eastern Business Park, Wern Fawr Lane, Old St Mellons, Cardiff CF3 5EA  
Tel: +44 (0)33 33 201 001 Fax: +44 (0)29 2079 1212 email: cardiff@powelldobson.com

Contract: Cardiff Council  
Wolf's Castle  
Title: Boundary Treatments Layout

Drawing No. Rev.  
24040 (05) 109 B

Scale: 1:500 @ A3  
Date: April 25  
Drawn: art  
Checked: -