

Demolition Plan :

Wolf's Castle :  
Cardiff County Council



DEMOLITION KEY :

Buildings to be demolished

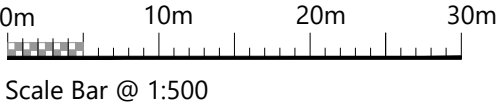
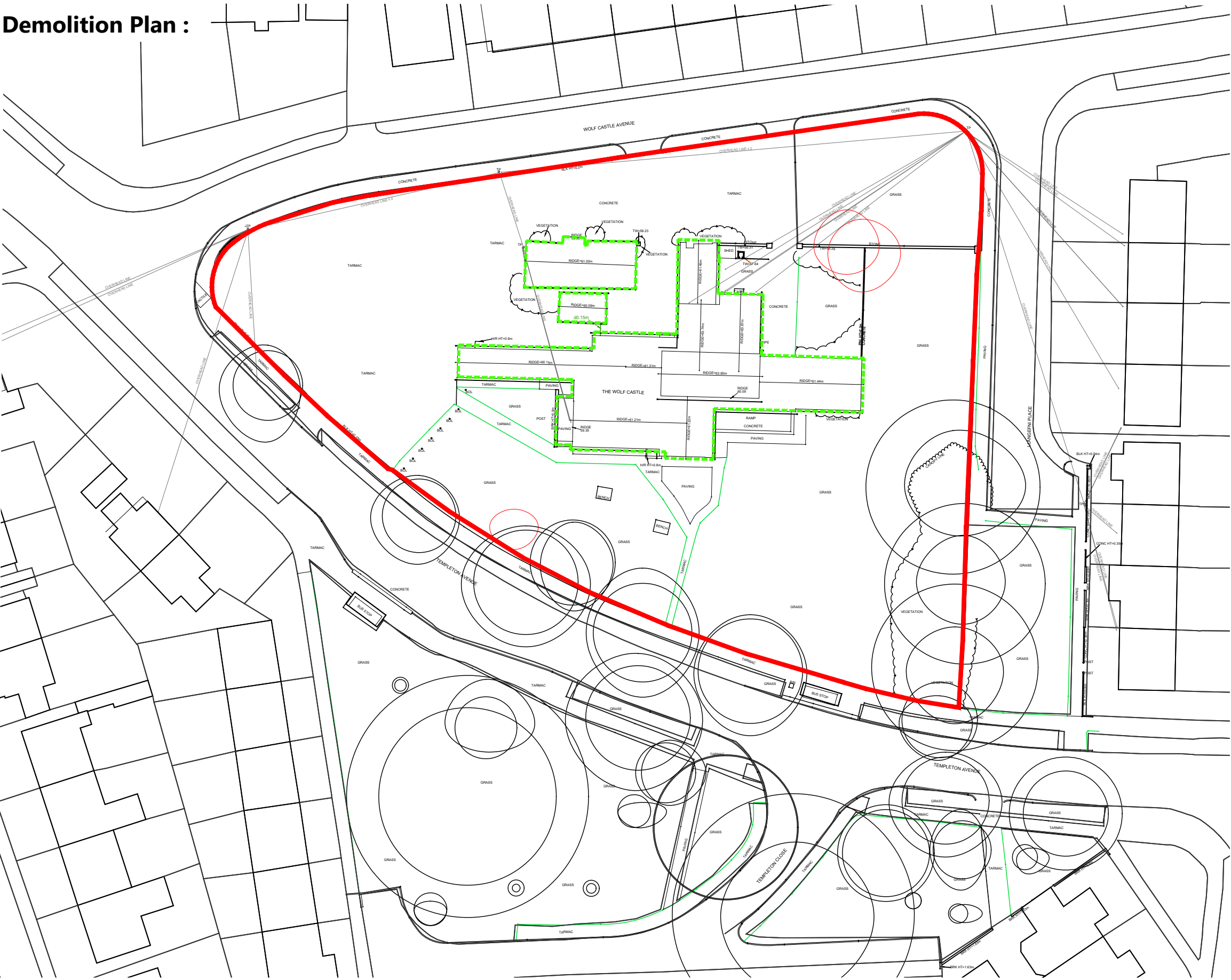

Figured dimensions and levels to be used.  
Any inaccuracies must be notified to the architect.  
Detail drawings and large scale drawings take precedence over smaller drawings.

Rev:	-	-

Rev:		

Rev:		

Rev:		

PRELIMINARY	✓
PLANNING	
DESIGN	
TENDER	
CONSTRUCTION	

**powelldobson**  
**ARCHITECTS**

Cardiff Office: Suite 1F, Building One, Eastern Business Park, Wern Fawr Lane, Old St Mellons, Cardiff CF3 5EA  
Tel: +44 (0)33 33 201 001 Fax: +44 (0)29 2079 1212 email: cardiff@powelldobson.com

Contract: Cardiff Council  
Wolf's Castle  
Title: Demolition Plan

Drawing No. Rev.  
24040 (05) 103 -

Scale: 1:500 @ A3  
Date: April 25  
Drawn: art  
Checked: -