



Front Elevation 1:100

Right Side Elevation 1:100

Rear Elevation 1:100

Left Side Elevation 1:100

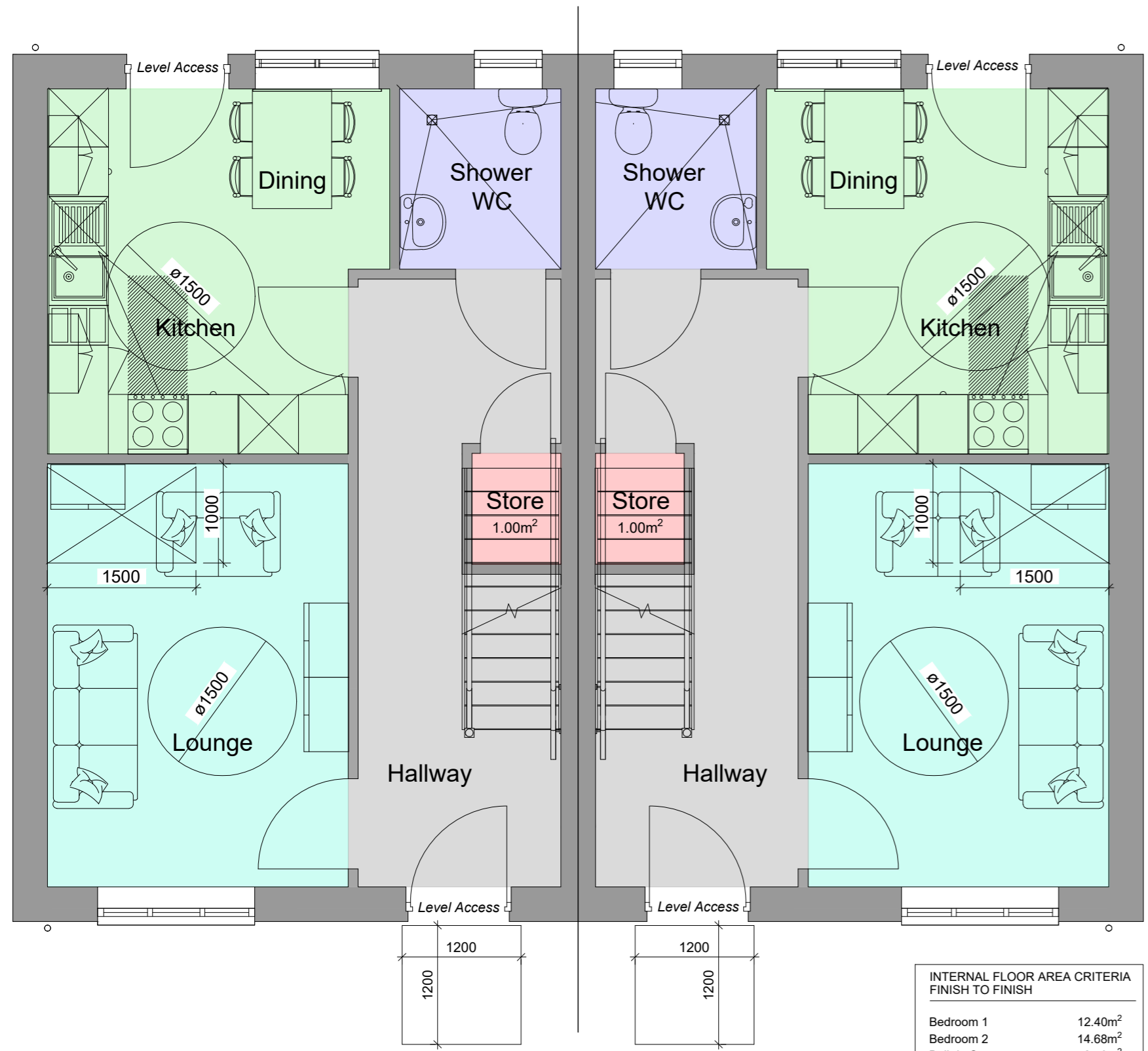

Ground Floor Plan 1:50

| INTERNAL FLOOR AREA CRITERIA FINISH TO FINISH | |
|--|---------------------|
| Bedroom 1 | 12.40m ² |
| Bedroom 2 | 14.68m ² |
| Built-in Storage | 2.50m ² |

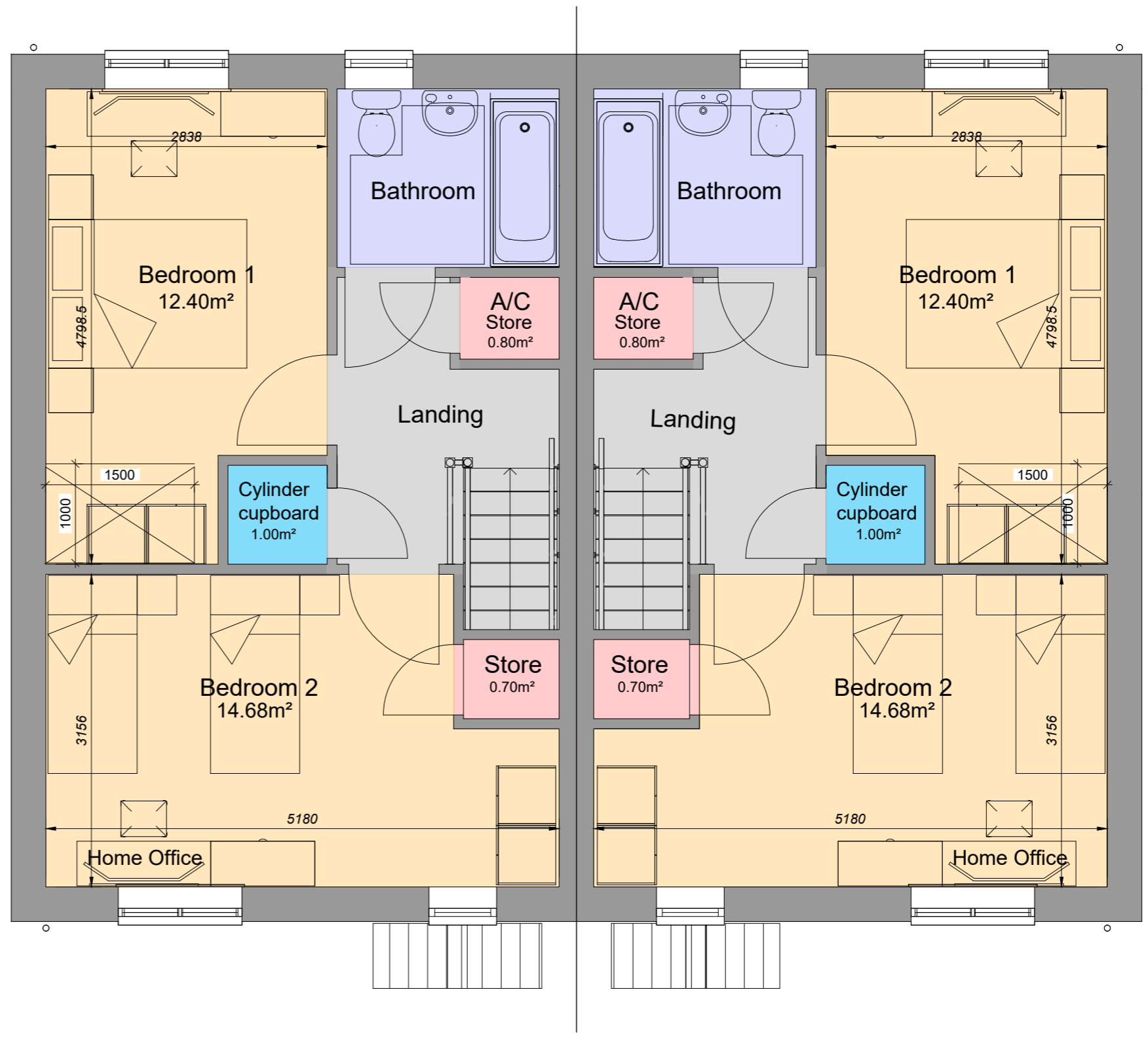

First Floor Plan 1:50

| REV. | DESCRIPTION | DATE |
|--|--------------|----------|
| CLIENT Wales & West HA | | |
| JOB TITLE New Mill Road | | |
| DRAWING TITLE 2B-4P WDQR House [SEMI] Floor Plans Elevations | | |
| SCALE @ A2 | DATE | DRAWN BY |
| 1:100/1:50 | May '23 | Hal |
| JOB NO. | DRAWING NO. | REVISION |
| 2316 | 2B4P-WDQR-01 | - |

Plots
3, 4, 24, 25, 26, 27, 34,
35, 36, 37.

| HOUSE TYPE AREA | |
|---|----------------------|
| M ² = 83.44 | F ² = 898 |
| Measured to finished plasterboard face | |

hammond
Architectural Ltd

10 Gold Tops
Newport
NP20 4PH

t. 01633 844970
e. info@hammond-ltd.co.uk

www.hammond-ltd.co.uk

© Hammond Architectural Limited 2023
Figured dimensions must be taken in preference to scaled dimensions and any discrepancies are to be referred to Hammond Architectural Ltd. Contractors, subcontractors and suppliers must verify all dimensions on site before commencing any work or making any workshop drawings.