

FOR PLANNING PURPOSES ONLY

THESE DRAWINGS HAVE BEEN PREPARED FOR RETROSPECTIVE PLANNING PURPOSES ONLY. DRAWINGS TO BE READ IN CONJUNCTION WITH AGREEMENT OF LEASE DOCUMENT WITH CARDIFF COUNTY COUNCIL DATED 17.09.2021- REF RT/9257 AND NETWORK RAIL DATED 17.02.2024 - REF 210022571.1

PROPOSED FINISHES LEGEND
Containers - corrugated corten steel.

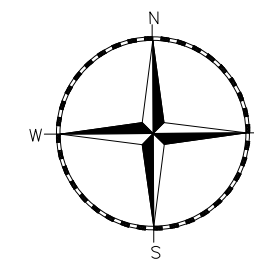

THE DRAWINGS RELATE TO THE PROPOSED RETROSPECTIVE PLANNING APPLICATION AT SLOPER ROAD, CARDIFF, CF11 8AB.

FOR STRUCTURAL / DRAINAGE DETAILS PLEASE REFER TO CLIENT APPOINTED STRUCTURAL ENGINEERS DESIGN AND FULL SPECIFICATION.

THE DRAWING HAS BEEN PRODUCED FOR PLANNING PURPOSES ONLY.

CONTRACTOR TO CHECK ALL DIMENSIONS ON SITE, PLEASE NOTE CHECK DIMENSIONS HAVE BEEN TAKEN ON SITE WITH TRADITIONAL MEASURING TAPE.



SECTIONAL ELEVATION A/A

Scale 1:100@A1

ALL DIMENSIONS INDICATED TO BE CHECKED ON SITE



SECTIONAL ELEVATION B/B

Scale 1:100@A1

ALL DIMENSIONS INDICATED TO BE CHECKED ON SITE

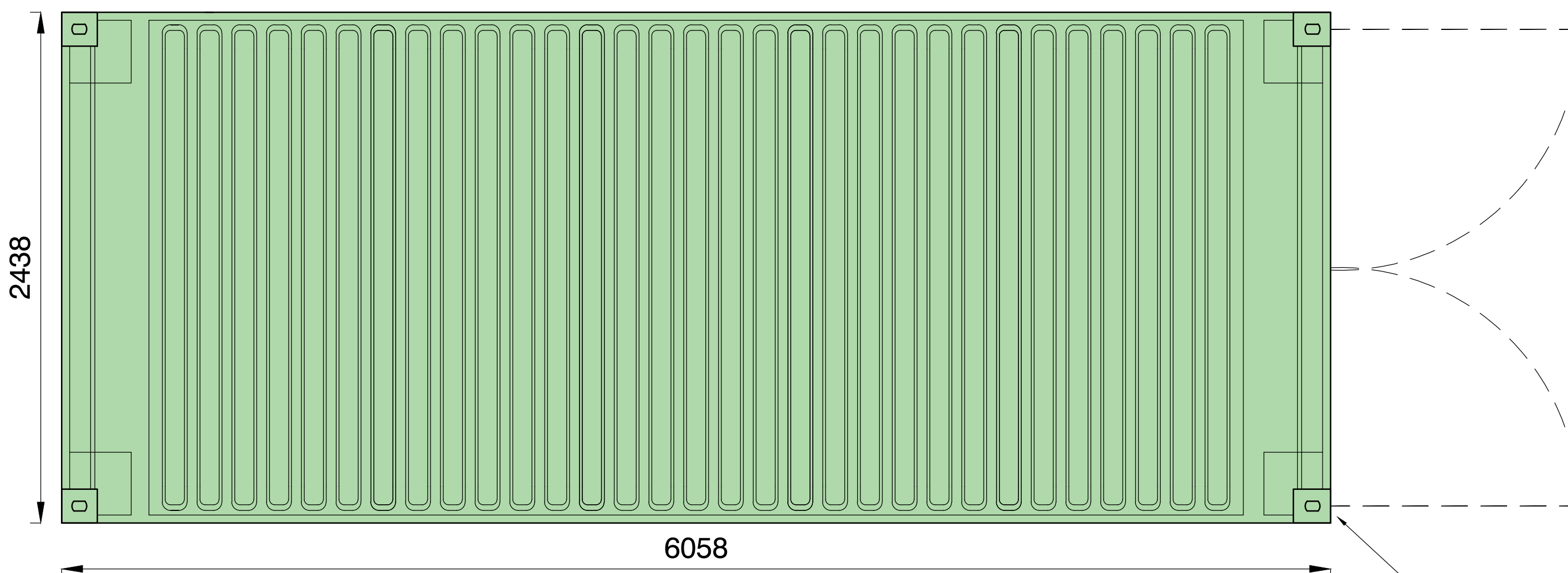

CONTAINER PLAN

Scale 1:20@A1

ALL DIMENSIONS INDICATED TO BE CHECKED ON SITE

6058 x 2438 corrugated steel container in colour green with usable capacity of 32.6m3.

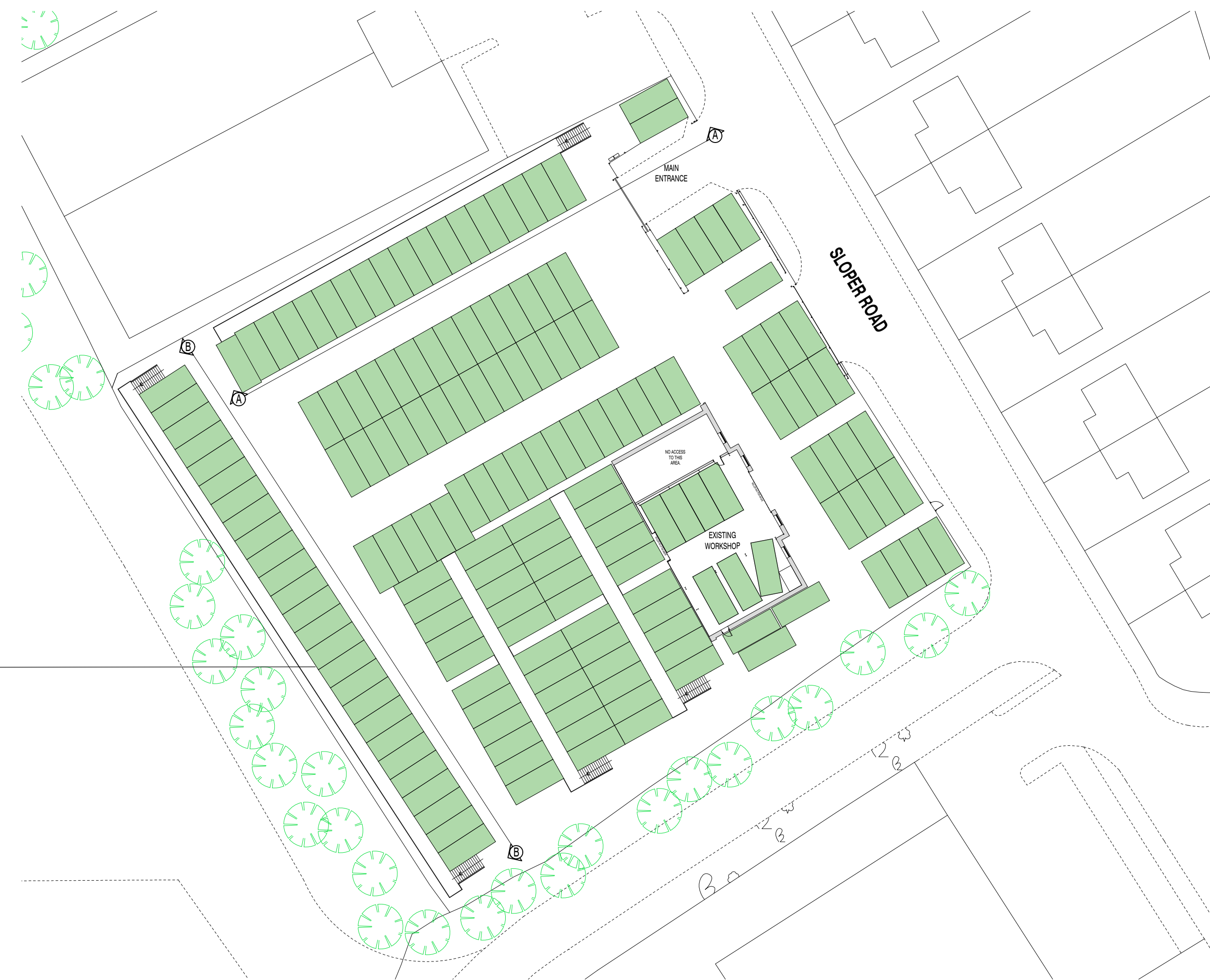

SITE PLAN

Scale 1:400@A1

ALL DIMENSIONS INDICATED TO BE CHECKED ON SITE

REVISION NOTE:

DRAWING STATUS:
PLANNING

CLIENT:
PINK SELF STORAGE

PROJECT:
SLOPER ROAD
CARDIFF CF11 8AB

franks + toms
ARCHITECTS

DRAWING TITLE:
SECTIONAL ELEVATIONS AND
CONTAINER PLAN

JOB NUMBER: 4236	BY: AC	CHK: SF	DATE: OCT 2024
DRAWING NUMBER: (23) 110	REV: *	SCALE: 1:100 / 20 @ A1	

Franks and Toms Architects Limited
Office 8 St Andrews Crescent, Cardiff, CF10 3DD.
T 02920 390099 E info@franksandtoms.com
www.franksandtoms.com