

This drawing is intended to be viewed in colour-- a monochrome copy should not be relied upon.

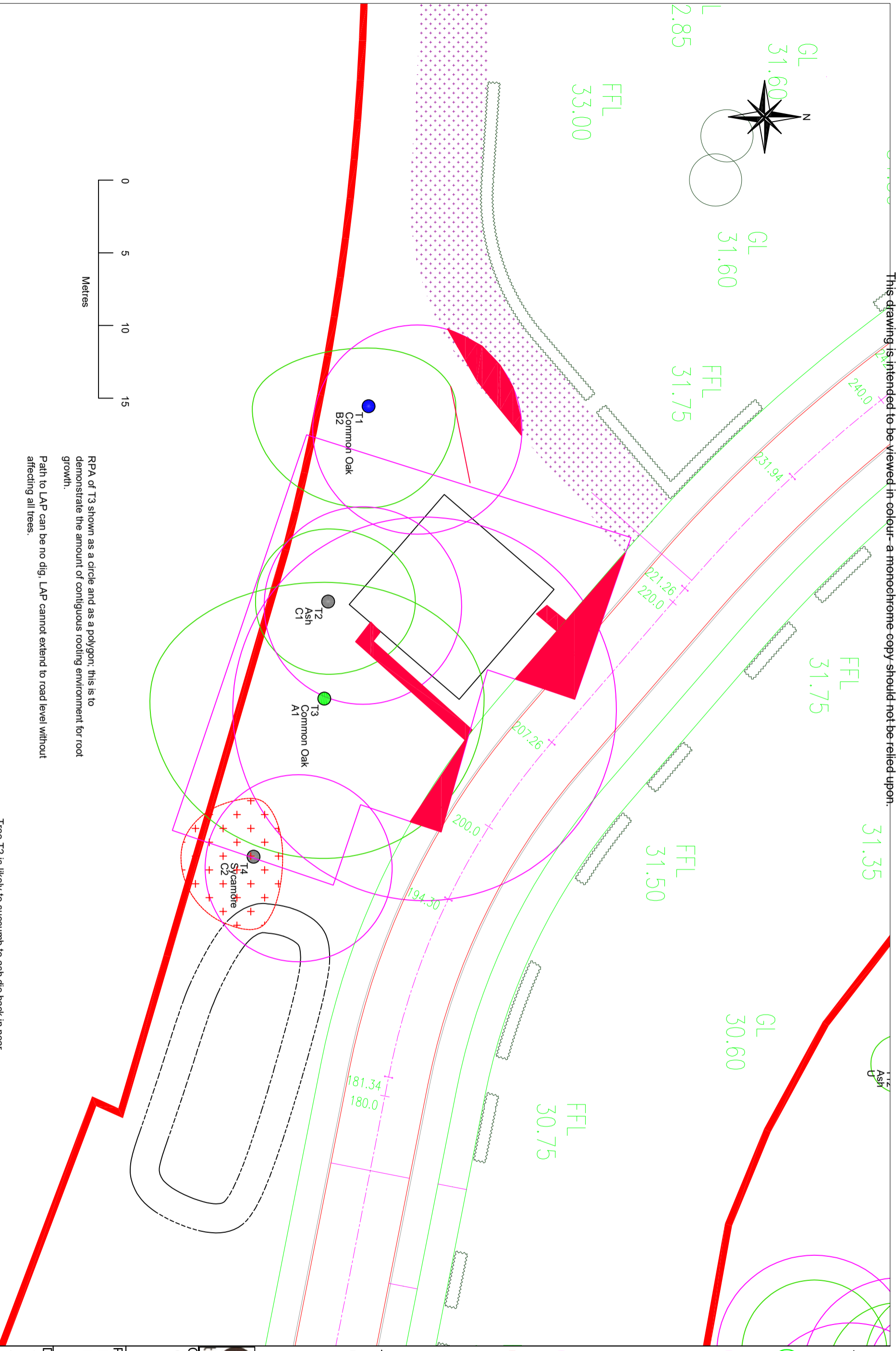

RPA of T3 shown as a circle and as a polygon, this is to demonstrate the amount of contiguous rooting environment for root growth.
 Path to LAP can be no dig, LAP cannot extend to road level without affecting all trees.

Tree T2 is likely to succumb to ash die back in near future but at present is only affected slightly.
 T4 is a poor specimen that will be affected by the proposed attenuation basin; therefore its removal is recommended.

KEY:

- T12 Tree number (T)
- Tree or (G) Group
- Canopy outline
- Root Protection Area (RPA)
- Category U tree centre
- Category A tree centre
- Category B tree centre
- Category C tree centre
- Incursion into root protection area
- Tree to be removed to facilitate development.

Revisions
 RevA: Layout updated

tree consultancy
 CLIENT: Obsidian Homes

PROJECT:
 Land adjacent to Brynheulog St Clears

DRAWING TITLE:
 Tree Location and Arboricultural Impact Assessment

DRAWING NO.:
 ARW1116:02

DATE:
 14/11/2021

SCALE:
 1:250@A3

This drawing is intended to be viewed in colour-- a monochrome copy should not be relied upon.