

This drawing is intended to be viewed in colour - a monochrome copy should not be relied upon.

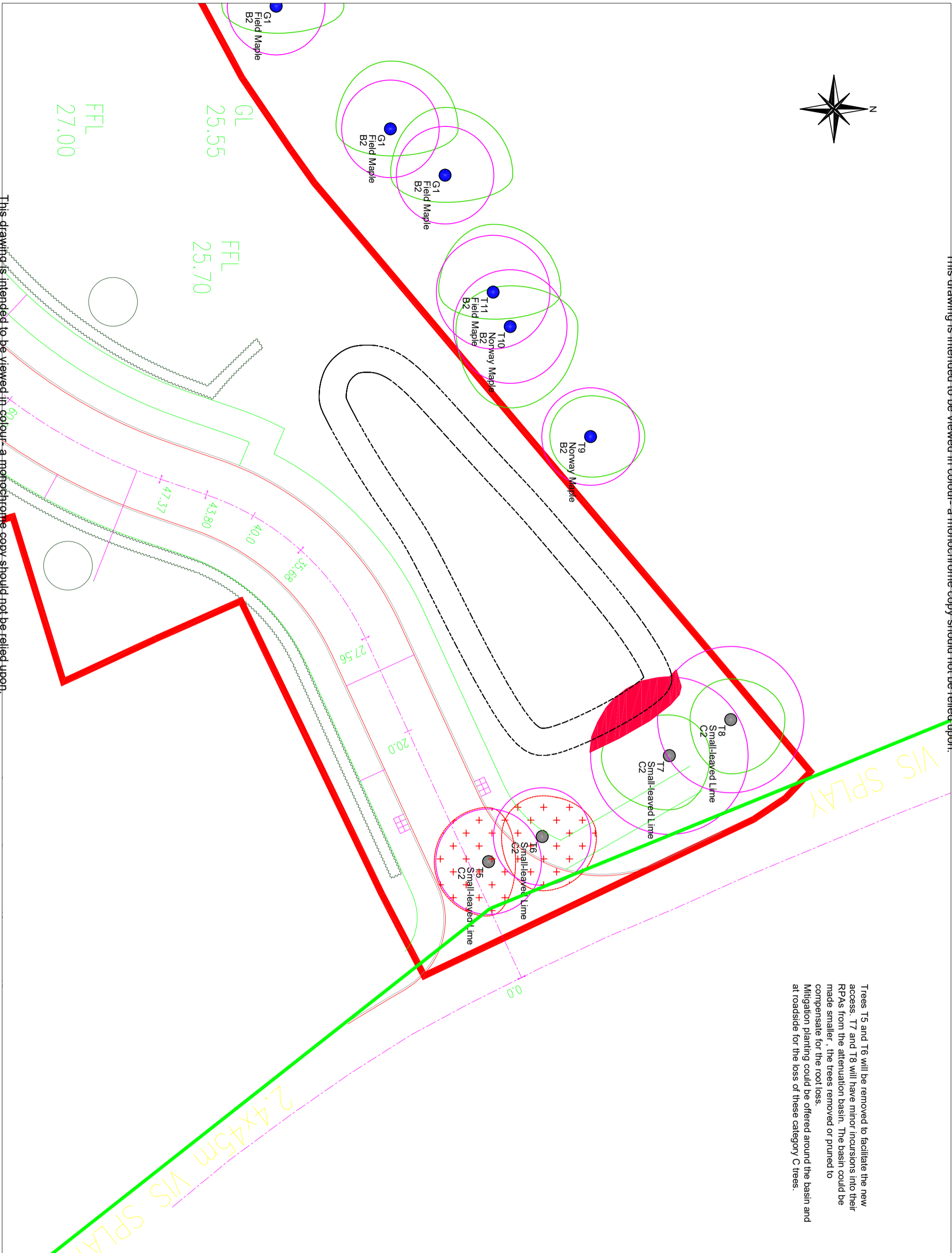

Trees T5 and T6 will be removed to facilitate the new access. T7 and T8 will have minor incursions into their RPAs from the attenuation basin. The basin could be made smaller, the trees removed or pruned to compensate for the root loss. Mitigation planting could be offered around the basin and at roadside for the loss of these category C trees.

**KEY:**

- T12 Tree number (T)
- Tree or (G) Group
- Canopy outline
- Root Protection Area (RPA)
- Category U tree centre
- Category A tree centre
- Category B tree centre
- Category C tree centre
- Incursion into root protection area
- Tree to be removed to facilitate development.

**Revisions**

Reva: Layout updated



CLIENT: Obsidian Homes

PROJECT: Land adjacent to Brynheulog St Clears

DRAWING TITLE: Tree Location and Arboricultural Impact Assessment

DRAWING NO: ARW1116:03

DATE: 14/11/2021

SCALE: 1:250@A3

This drawing is intended to be viewed in colour - a monochrome copy should not be relied upon.

GL  
25.55  
FFL  
27.00

FFL  
25.70

47.37

43.80

40.0

35.68

27.56

20.0

00

VIS SPLAY

2.4x45m VIS SPLAY