



SKYREACH
Skyreach Group Inc.

Lift & Sliding Patio Door

Skyreach 1500 lift and sliding door combines intelligent function with premium design. The revolutionary lift-slide action is achieved by simply turning the ergonomic lever handle to engage the roller carriages under the door panel. The carriages then lift the door off its weather seal, allowing the panel to slide effortlessly along the frame. Even the largest panels slide with ease. Available in a number of configurations, this beautifully engineered door provides a stylish and functional entry to your next project.

The design of heavy-duty lift-and-slide doors offers exceptional high-wind and water resistance for designing oversized sliding door projects.



112A Snidercroft Road
Concord, ON L4K 2K1

Tel: 905-761-9988
Fax: 905-761-8801

www.skyreachgroupinc.com

Benefits

- Lift and slide opening mechanism provides excellent sealing performance air tightness.
- Utilizes 6063-T6 ultra-high precision aluminum profiles, manufactured with ultra-high precision production techniques, offering high strength and accuracy.
- Features thermal break and rubber strip sealing to enhance overall air/water-tightness, thermal performance, and prevents dust intrusion.
- The insulation strip cavity filled with thermal insulation foam cotton effectively improves heat convection and radiation phenomena inside the insulation strip cavity.
- Suitable for oversized opening designs with the leaf bearing capacity of up to 400kg.
- Excellent water tightness performance with Combination of pressure-treated drainage holes and waterproof sealing blocks.
- **Noise reduction:** They have superior sealing capabilities and the presence of an insulating barrier within the frame, which disrupts sound waves.
- **Multi-cavity sealing rubber strips.** Frame and sash feature multi-channel sealing design, employing EPDM foam co-extruded rubber strips, providing excellent sealing performance and improved sound insulation.
- **Innovative design of arched glass supporting plate.** Increased load-bearing capacity avoids water accumulation in the gap between profiles and glass, achieving planned drainage.
- Three-seal design Enhances the overall window airtightness, watertightness, and insulation performance while preventing dust from entering
- **Screen options:** fiberglass and stainless steel mesh
- **Available configuration:**
 - OX/XO/XX
 - OXO, XOO, OOX
 - Transom & sidelite

Features

Aluminum	
Frame depth options	152mm (6")
Aluminum finish	Anodized Powder Coating / Duracron PVDF
Glass	
Double IG	6mmLoE+16A+6mmClr, Argon 90
Triple IG	6LoE+12A+6Clr+12A+6Clr, Argon 90
Spacer	Black warm edge
Size Limit	
Frame Width	1800-6000mm (70 7/8" - 236 1/4")
Frame Height	2100-2800mm (82 5/8" - 110 1/4")
Max. Panel Size	3000*2800 (118 1/8"*110 1/4")
Max. Panel Weight	400Kg
Window Performance	
Air	A3 (CW)
Water	PG30 (CW)
Structural	PG30 (CW)
U-Value	2.4W/m ² ·K (Double IG) 1.8W/m ² ·K (Triple IG)

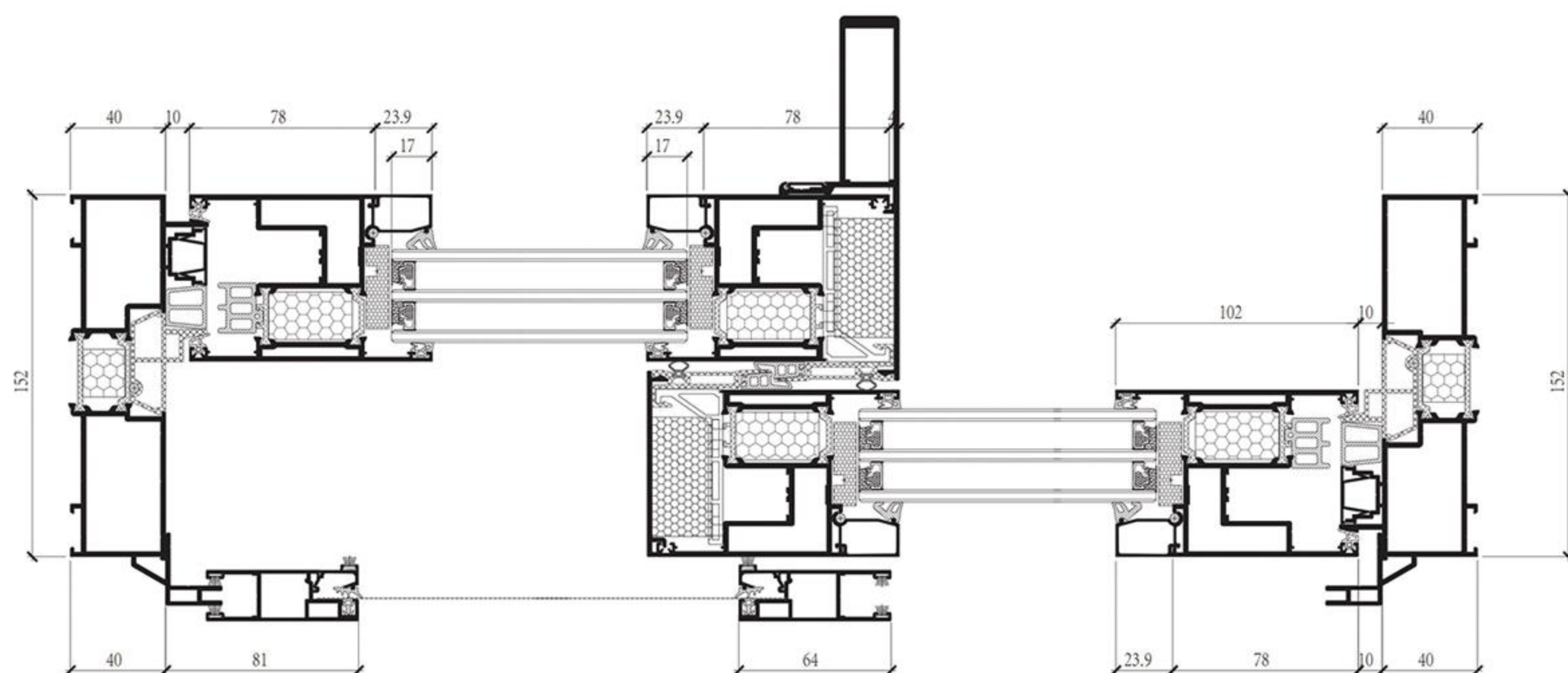

▼ The adhesive injection corner assembly technique

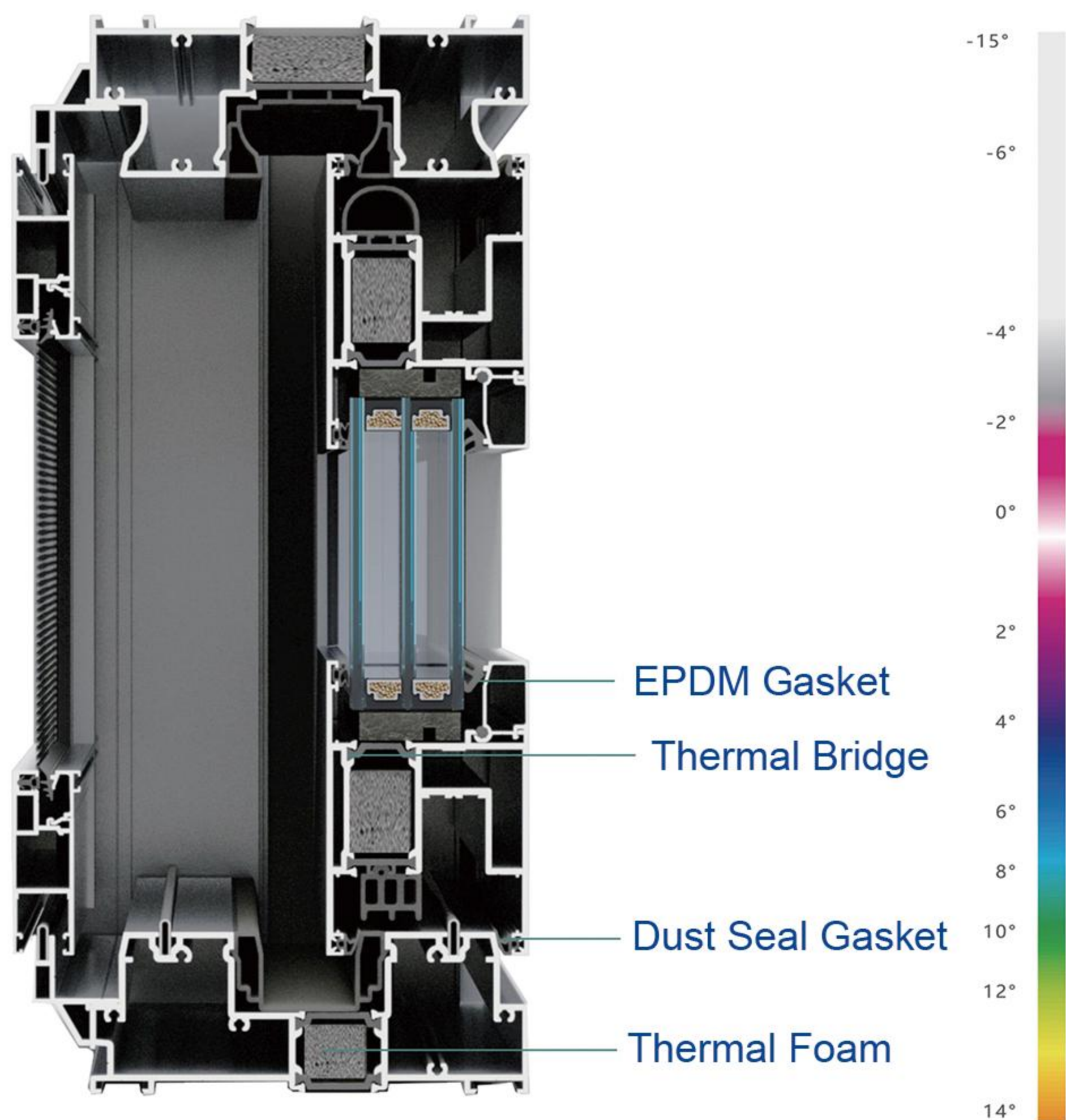
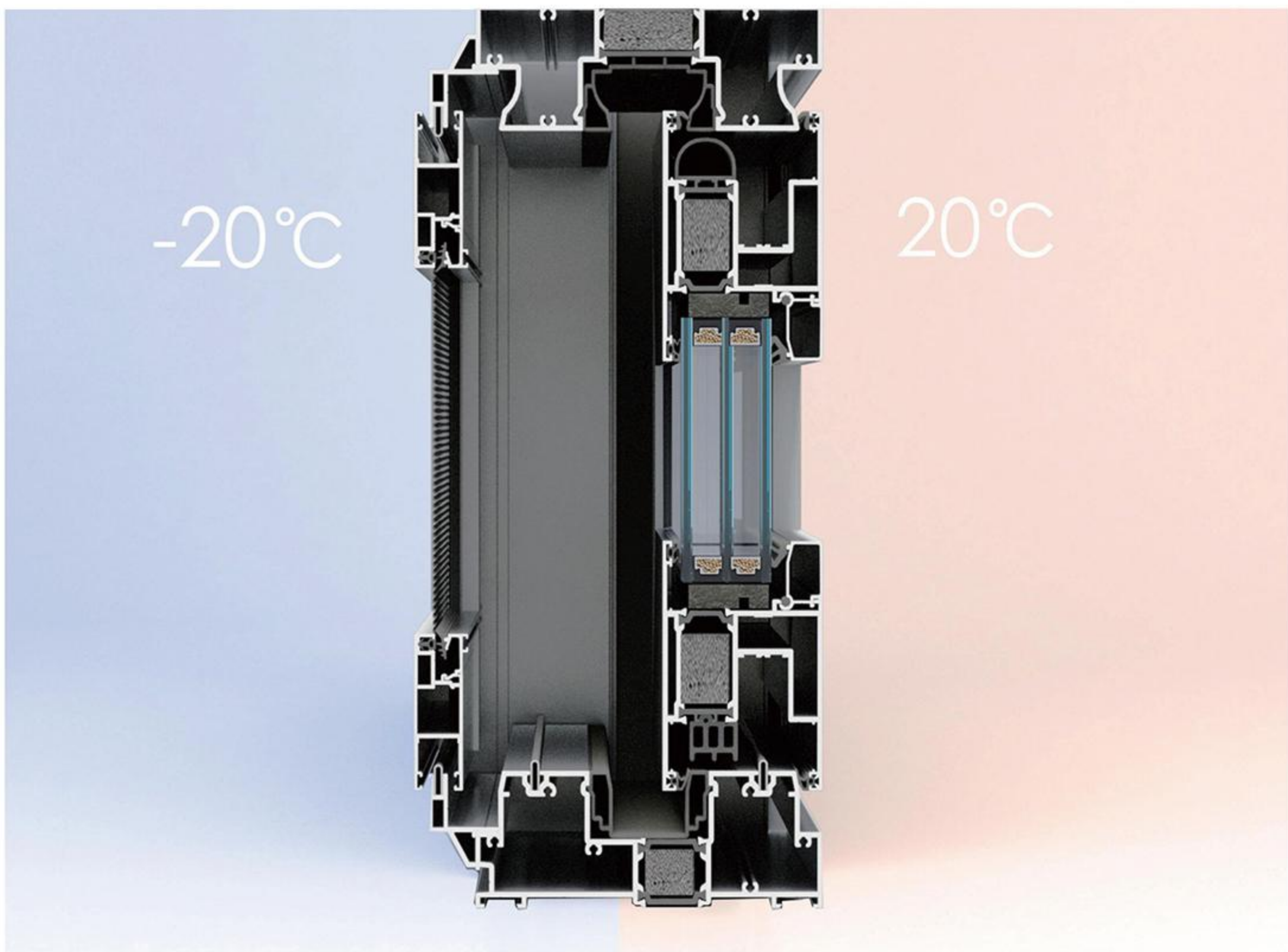
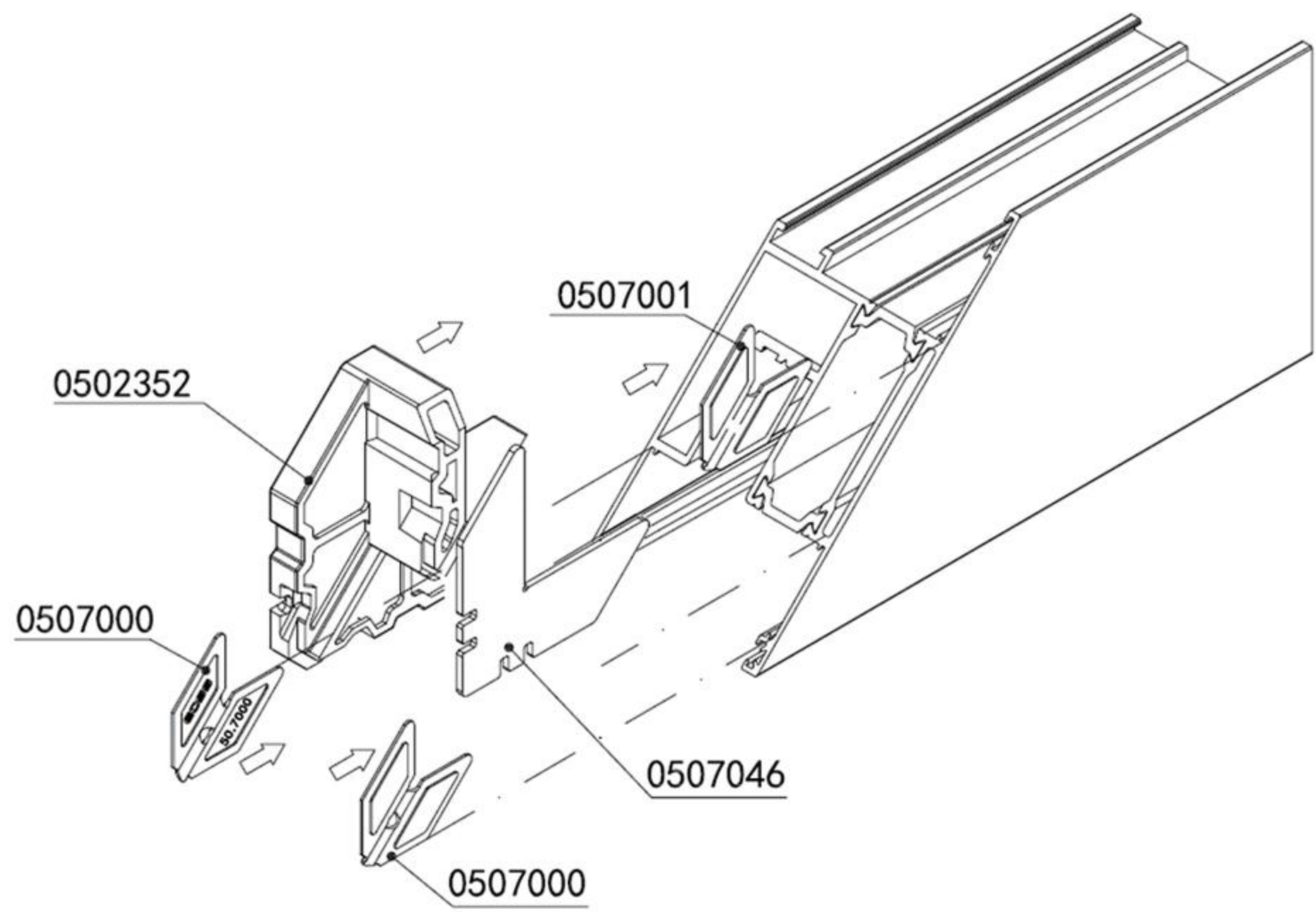

CERTIFICATIONS AND MEMBERSHIPS

