

2

1

Gorilla Manufacturing LLC
 19525 Wied Rd
 Suite 450
 Spring, TX 77388
 281-705-9701
 281-705-9702

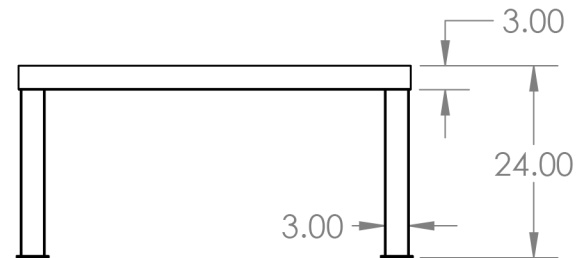
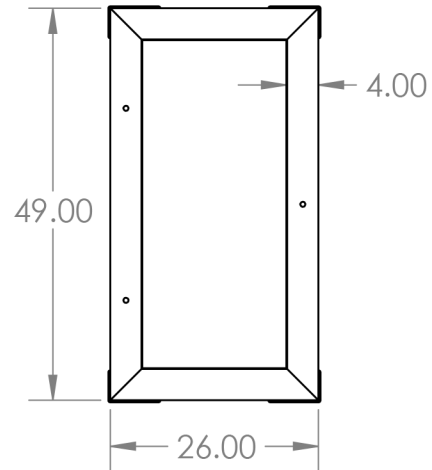
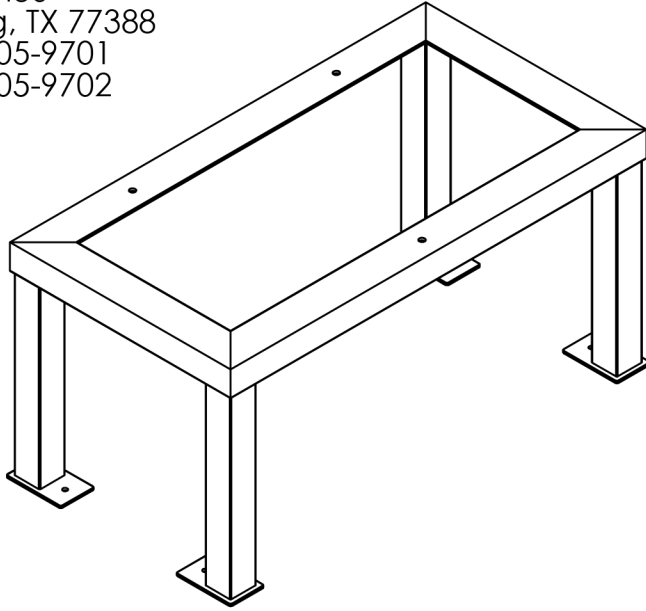

24" stand shown. 12-30" models share the same design, the only difference is height.

Sized to fit both Generac and Kohler air cooled units. Fully MIG welded one piece construction speeds installation and makes the stands unbelievably sturdy.

A painted finish is standard, upgrades to powder coat or hot dip galvanized finishes are available. (Note, finish upgrades may increase delivery time).

Top support frames are 4X3X0.25" angle. All models use 3x3x0.187" square tubular legs. Leg mounting pads are 6.5x4x0.25" with a pre-drilled hole for 1/2" hold down hardware. Mounting holes to match factory hold down locations for Generac and Kohler are pre-drilled.

Welding complies with AWS D1.1 Electrodes used are E70XX

Steel plates are A36, Grade 36 or higher. Angle members are ASTM A36. HSS (square) members are ASTM A500 grade B (46KSI).

Stands have been load tested in excess of 3400lbs. Stands have been designed to withstand 180mph wind loads.

All specifications are subject to change.

11/11/2021

General Specifications for
 Gorilla Manufacturing
 Generator Stands

SIZE A	DWG. NO. 24in Generator Stand	REV. A
SCALE:1:24 WEIGHT:		SHEET 1 OF 1

PROPRIETARY AND CONFIDENTIAL
 THE INFORMATION CONTAINED IN THIS
 DRAWING IS THE SOLE PROPERTY OF
 GORILLA MANUFACTURING. ANY
 REPRODUCTION IN PART OR AS A WHOLE
 WITHOUT THE WRITTEN PERMISSION OF
 GORILLA MANUFACTURING IS PROHIBITED.
 DIMENSIONS ARE IN INCHES

2

1