

Minnesota Microscopy Society

Local affiliate of the Microscopy Society of America
and the Microbeam Analysis Society



Newsletter

January 2010

Tour of Boston Scientific Corporation, CRM* Division

*Cardiac Rhythm Management

**Boston
Scientific**
Delivering what's next.™

Date: Thursday, February 18, 2010

Schedule: 5:00pm Check-in
6:30pm Dinner

Location: CRM Division – Boston Scientific
4100 Hamline Avenue
Arden Hills, MN 55112

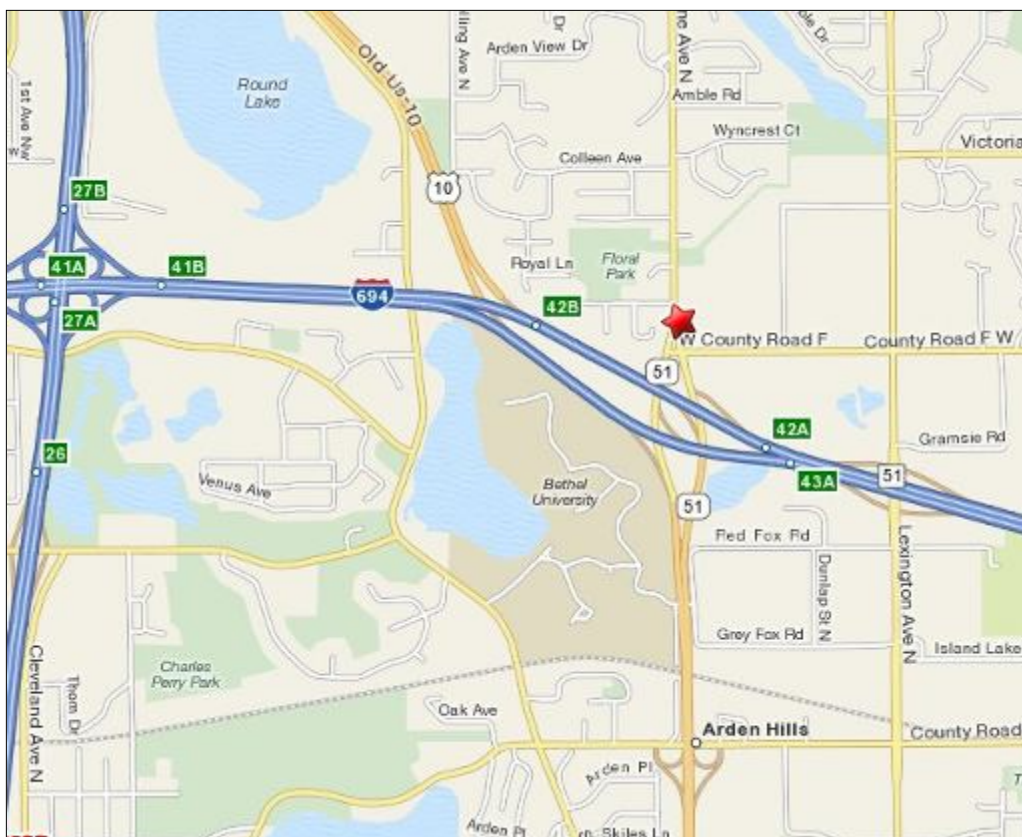

Special Notes

- We are at the **ARDEN HILLS** location!
- Lab areas and visitor entrance will be in building 4100A.
- There is a large parking lot next to the circle in front of 4100A.

Registration:

The cost of the meeting will be \$10, which will cover dinner catered by Marinos (www.eatmarinos.com). The registration deadline is end-of-day, **Monday, Feb. 15th**. Register by contacting Bede Willenbring via email at reservations@mnmicroscopy.org (preferred), or phone at 651-236-5470. Please include your name, company and contact information with your reservation.

Upcoming Events

February 18

Boston Scientific Tour
(former Guidant in Arden Hills)

March 18

MinnTS, Medtronic

March 28-April 1

32nd Annual International Cement Microscopy Association (ICMA)
Conference, New Orleans (www.cemmicro.org)

May 7th

MMS Spring Symposium, Science Museum

May 19

JEOL /Thermo Users meeting at Medtronic

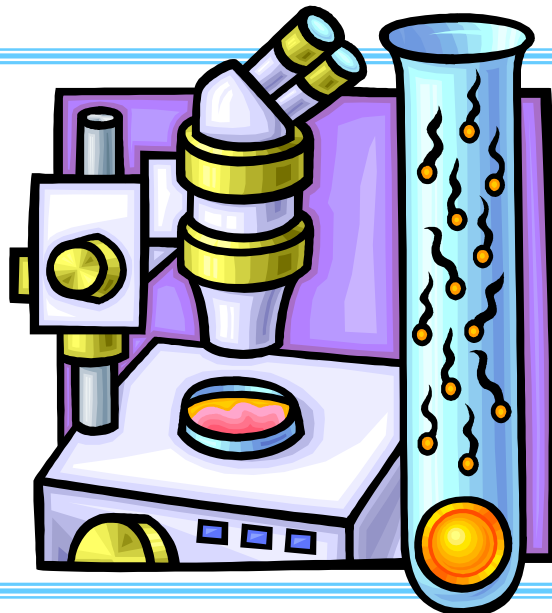
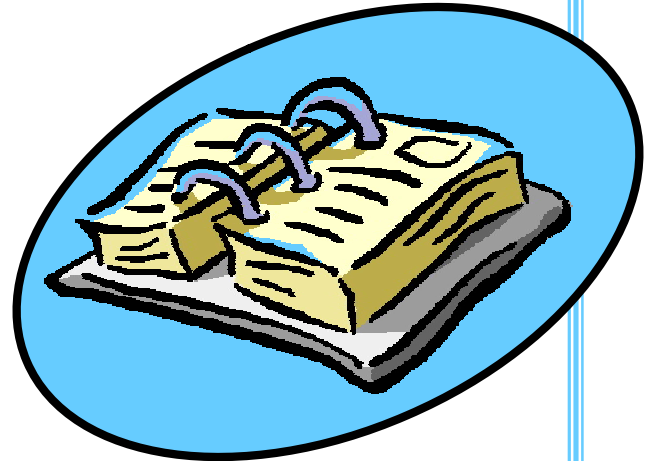

Vendor Announcements:

If you are a local vendor with information to share, please contact either Jason Heffelfinger (jason.r.heffelfinger@medtronic.com) or Kathy Hough (katiu@frontiernet.net) for deadline and content guidelines.



**Minnesota Microscopy Society
Treasurer's Report
01/01/09 Through 12/31/09**

INCOME

Dues	3,764.00
Interest Income	307.78
MinnTS Registrations	5,468.99
MMS Meeting registrations	3,500.00
Spring Symposium 2009 Income	<u>3,830.00</u>

TOTAL INCOME

16,870.77

EXPENSES

Credit Card Fees	466.78
Meeting Expenses	4,584.90
MinnTS Expenses	5,543.00
Miscellaneous	139.28
Newsletter	12.81
Project Micro	275.48
Spring Symposium 2009 Expense	4,092.97
Spring Symposium 2010 (room deposit)	<u>550.00</u>

TOTAL EXPENSES

15,665.22

OVERALL TOTAL

1,205.55





Sustaining Members

Sustaining members are the backbone of financial support for the Society. These members make it possible for the Society to support Project Micro and to cover many expenses of the regular meetings and the Spring Symposium. We greatly appreciate the continued support of these individuals and corporations. To become a Sustaining Member, complete and return the MMS membership form at the end of the newsletter.

Joel Ash	Focus Precision Instruments	952-380-3696
John Benson	Thermo Fisher Scientific	608-826-9049
Mike Boykin	Mager Scientific, Inc.	734-426-3885
Laurie Carlone	EDAX	312-238-0260
Bill Chauvin	Oxford Instruments USA	608-831-0760
Mike Coscio	Medtronic Inc.	763-505-4561
Melissa Dubitsky	Tousimis Research Corp	301-881-2450
Chris Frethem	University of Minnesota	612-624-4652
Jeff Gschwend	Hitachi HTA	847-816-6098
Larry Hanke	Materials Evaluation & Engineering, Inc.	763-449-8870
Gary Hawkinson	FEI Company	608-291-0157
Brad Johnson	North Central Instruments, Inc. / Leica	763-559-3008
Mark Kelsey	Bruker AXS Microanalysis	708-386-9684
Stacie Kirsch	Electron Microscopy Sciences / Diatome	215-412-8400
Peter McSwiggen	McSwiggen & Associates	612-781-2282
Robert Mierzwa	JEOL USA, Inc.	920-803-8945
Eugene Rodek	SPI Supplies	610-436-5400
Jean Schlosser	Crane Engineering	763-557-9090
Steven Skorich	Medtronic, Inc.	763-514-1335
Jim Smith	Carl Zeiss SMT, Inc.	260-387-6923
Chad Tabatt	Gatan, Inc.	888-778-7933
Nicole Ulseth	Imation	651-704-4738
Jack Vermeulen	Ted Pella, Inc.	530-243-2200
Ted Weldon	Leeds Precision Instruments	612-546-8575

If any Sustaining Members are missing from this list, *please* contact either:

Jason Heffelfinger (763-514-1021, jason.r.heffelfinger@medtronic.com)

or Kathy Hough (651-353-8458, katiu@frontiernet.net).



MMS Patron Members

The Minnesota Microscopy Society would like to express sincere thanks to our Patron Members. These members provide financial support to the organization above the standard membership fee. This additional support makes it possible for MMS to maintain its financial well being. To become a Patron Member, complete and return the MMS membership form at the end of the newsletter.

Gib Ahlstrand	Imation Center, U of M, St. Paul	Robert Peterson	3M Company, St. Paul
Tony Anderson	Surmodics Inc., Eden Prairie	Oanh Pham	3M Maple Grove
Paul Baker	Medtronic, Inc., Mpls	Paul Resler	3M Company, St. Paul
Dale Case	Imation, St. Paul	Alice Ressler	University of Minnesota, Mpls
Carolyn Casoria	Honeywell, Mpls	Ryan Stromberg	Hysitron, Mpls
Ellery Frahm	University of Minnesota, Mpls	Mary Swierczek	3M Company, St. Paul
Rick Freiberg	Seagate Technology, Richfield	Jerry Tangen	JEOL USA, Inc., Monticello
Robert Hafner	University of Minnesota, Mpls	Travis Tenner	University of Minnesota, Mpls
Greg Haugstad	University of Minnesota, Mpls	Joseph Tersteeg	ARC Technologies, White Bear
Lori LaVanier	Evans Analytical Group, Chanhassen	Jeff Thole	Macalester College, St. Paul
Robert Lundquist	Boston Scientific, Mpls	Ozan Ugurlu	University of Minnesota, Mpls
Stuart McKernan	3M Company, St. Paul	Bede Willenbring	H.B. Fuller Co., St. Paul
Richard Nay	Hysitron, Mpls	Mark Windland	Honeywell, Plymouth
Susan Okerstrom	Medtronic Inc., Brooklyn Center	Klaus Wormuth	SurModics, Eden Prairie
Ev Osten	3M Company (Retired)	Mike Wroge	Cymbet Corp., Elk River
Ann Palmer	University of Minnesota, Mpls	Elizabeth Wurdak	St. John's Univ., Collegeville
Jeff Payne	3M Company, St. Paul	Chris Wurst	ARC Technologies, White Bear

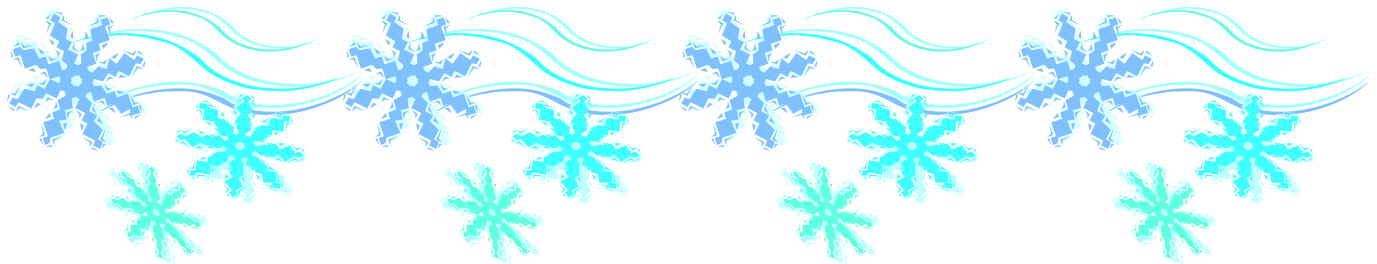

MMS BOARD and OFFICERS 2009-2010

President: Nicole Ulseth, Imation Corp.,
Discovery 1D-25, 1 Imation Way,
Oakdale, MN 55128; (651) 704-4738,
nulseth@imation.com

Past-President: Klaus Wormuth, SurModics, Inc.
9924 West 74th Street, Eden Prairie, MN 55344
(952) 947-8652; kwormuth@surmodics.com

President-Elect: Ozan Ugurlu, Univ. of Minnesota,
55 Shepherd Labs, 100 Union St. S.E., Minneapolis,
MN 55455; (612) 626-3613, ozan@umn.edu

Secretary: Patricia Sanft, H.B. Fuller Co.,
P.O. Box 64683, St. Paul, MN 55164;
(651) 236-5384, patricia.sanft@hbfuller.com

Treasurer: Bede Willenbring, H.B. Fuller Co.,
St. Paul, MN; (651) 236-5470;
treasurer@mnmicroscopy.org

MAS Representative: Michael Coscio, Medtronic
Inc., 710 Medtronic Parkway, Minneapolis, MN
55432-5604; (763) 505-4561;
mike.coscio@medtronic.com

ProjectMICRO Director: Jeff Payne, 3M Center,
Bldg. 201-BE-16, St. Paul, MN 55144-1000;
(651) 733-2352; jjpayne@mmm.com

Corporate Liaison: Jason Heffelfinger, Medtronic
Inc., 6700 Shingle Creek Parkway, Brooklyn Center,
MN 55350; (763) 514-1021;
jason.r.heffelfinger@medtronic.com

Webmaster: Stuart McKernan, 3M Center,
Bldg. 201-BE-16, St. Paul, MN 55144-1000
(651) 736-5993; smckernan@mmm.com

Newsletter Editor: Kathy Hough,
Pace Analytical Services, MN;
(651) 353-8458, katiu@frontiernet.net

Other Board Members

Paul Baker, Medtronic Inc., Minneapolis, MN;
 (763) 514-4519; paul.baker@medtronic.com
 Steve Block, JEOL USA, Inc., s-block@comcast.net
 Dwight Erickson, 3M Center, St. Paul, MN;
 (651) 736-2830; dderickson3@mmm.com
 Robert Lundquist, Boston Scientific, Maple Grove, MN
 (763) 494-7945; robltt@juno.com
 Peter McSwiggen, McSwiggen & Associates
 St. Anthony, MN, PMcS@McSwiggen.com

Sue Okerstrom, Medtronic Inc., Brooklyn Center, MN
 (763) 526-0225; sue.okerstrom@medtronic.com
 Ev Osten, Woodbury, MN; efosten@gmail.com
 Ann Palmer, University of Minnesota
 Dept. of Pediatrics, Mpls, MN; palme003@umn.edu
 Ky Pham, Medtronic Inc., Minneapolis, MN;
 (612) 514-4705; ky.pham@medtronic.com
 Mary Swierczek, 3M Center, St. Paul, MN;
 (651) 736-5087; mswierczek@mmm.com



Reminder: Membership in MMS runs from January through December.
2010 dues are now due!

Please visit the MMS website, www.MNmicroscopy.org, for a fill-and-print pdf version of the membership form...

Minnesota Microscopy Society – Membership Form

All microscopists are urged to support their Society at one of the membership levels offered below. Often, supervisors will support MMS memberships out of their project budget because they recognize that it is a very inexpensive way to maintain and increase the skills of their microscopists. If you have been a member over the years and recognize the value of MMS to the community of microscopists it serves, consider upgrading your membership this year to the patron or sustaining level. Thank you.

Name _____ Dr _____ Mr _____ Ms _____ Phone (_____) _____

Affiliation _____ Position _____

Address _____ ZIP _____

E-mail address _____

***A legible e-mail address is critical for delivery of your newsletter.
 Newsletters are sent via email only.**

Check here _____ if you do NOT want your name and address to appear in the Society directory.

Are you an MSA member? _____ MAS Member? _____ Other Professional groups? _____

Student (\$5) _____ Basic (\$10-\$24) _____ Patron (\$25-\$99) _____ Corporate Sustaining (\$100-) _____

Payment: _____ Check _____ Visa _____ MasterCard _____ American Express _____

Credit Card Number: _____ - _____ - _____ - _____ Exp. Date: _____ / _____

Signature (for credit card payment): _____

Make checks payable to MMS and mail to our Treasurer:

Bede Willenbring, MMS Treasurer, 4763 Decatur Ave. North, New Hope, MN 55428-4402