

# 'Ehiku (Plan F)

TWO ROOMS, TWO BATHS | 691 SQ. FT.

**HALEKALAE**  
CONDOMINIUMS 7000 HAWAII KAI

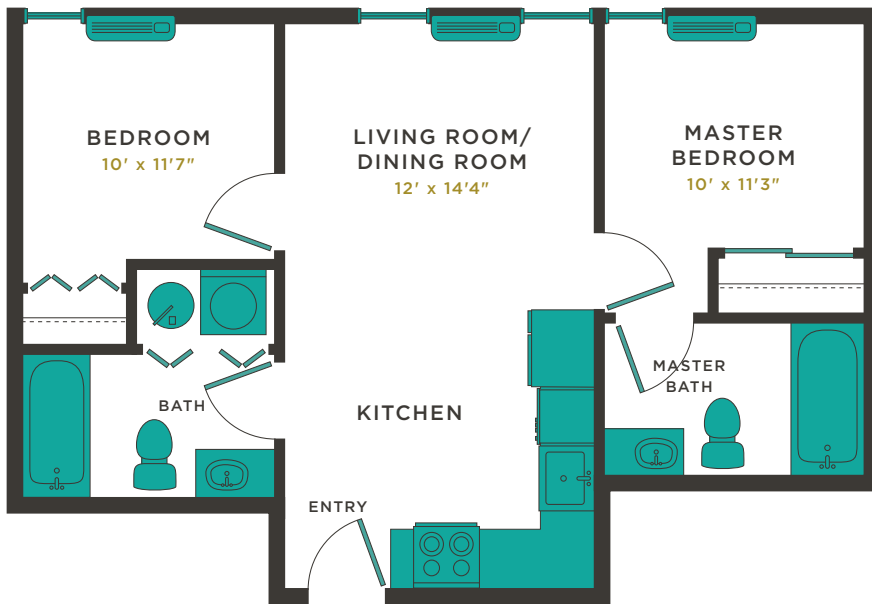

## FEATURES

- Air-conditioning in every unit
- Energy-efficient appliances
- GE dishwasher
- GE 24" washer/dryer, stacked
- GE smooth-top range/oven
- GE micro/hood combo
- GE 25 cu ft side-by-side refrigerator
- Garbage disposal
- Grohe bathroom fixtures
- Easy-clean floors
- Double-pane tinted windows
- Low maintenance fees
- Separately metered units
- Philpotts-designed model units

## PROPERTY MAP

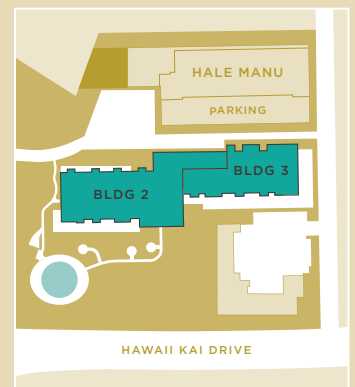

## FLOOR MAP

Units available on all floors unless noted.

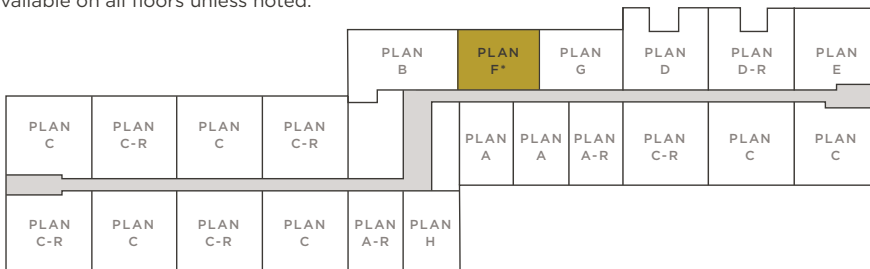

\*Available on floors 2-10 only

This is an artist's depiction of Developer's current proposed development concepts for the Project, which concepts continue to evolve and are subject to change without notice. All dimensions and square footage calculations are approximate and subject to change. Furnishings are represented for illustration purposes only. Units are not furnished. Any renderings, photos, drawings or other representations as to units or other elements that are delivered or shown to prospective purchasers may not accurately portray such units and other elements, and do not constitute a representation by Developer. Prices are subject to change without notice.

© 2018 Avalon Development. All rights reserved.

## FOR MORE INFORMATION

808.369.1136  
sales@halekalae.com

7000 Hawaii Kai Drive  
Honolulu, HI 96825

www.halekalae.com

# 'Ehiku (Plan F)

TWO ROOMS, TWO BATHS | 691 SQ. FT.

**HALEKALAE**  
CONDOMINIUMS 7000 HAWAII KAI

