

FILED
 CLERK OF COURT
 PARISH OF LIVINGSTON
 I CERTIFY THIS INSTRUMENT WAS FILED
 RECORDED 10/09/2001 AT 10:12:19
 RECORDED IN BOOK
 00477767 OF 1 Pgs
 B. J. Webb
 REPUTY CLERK

Entry # 00477767

PLAT ONLY

THE ISLAND
 PHASE II - RIVER PINES PLANTATION
 A SURVEY AND SUBDIVISION OF A PARCEL OF LAND
 LOCATED IN SECTION 36, T8S, R6E, LIVINGSTON PARISH,
 LOUISIANA.

DESIGNED: J.L.B.			DATE: APRIL 3, 1979		
DRAWN: J.A.B.			SCALE: 1" = 50'		
CHECKED: J.L.B.			APPROVED: W.J.B.		
PROJECT NO. 1036			SHEET NO.		
RIVER PINES PLANTATION			TITLE		
A DEVELOPMENT OF R.P.P. CORP.			LAYOUT OF RIVER PINES PLANTATION - PHASE II		
BODIN AND WEBB, INC.					
CONSULTING ENGINEERS					
HAMMOND, LOUISIANA					
DATE	BY	REVISION	DATE	BY	REVISION

NOTES:
 1. LOTS 95 THRU 131, PROPERTY LINES EXTEND
 5' BEYOND SET IP TO WATERS EDGE.

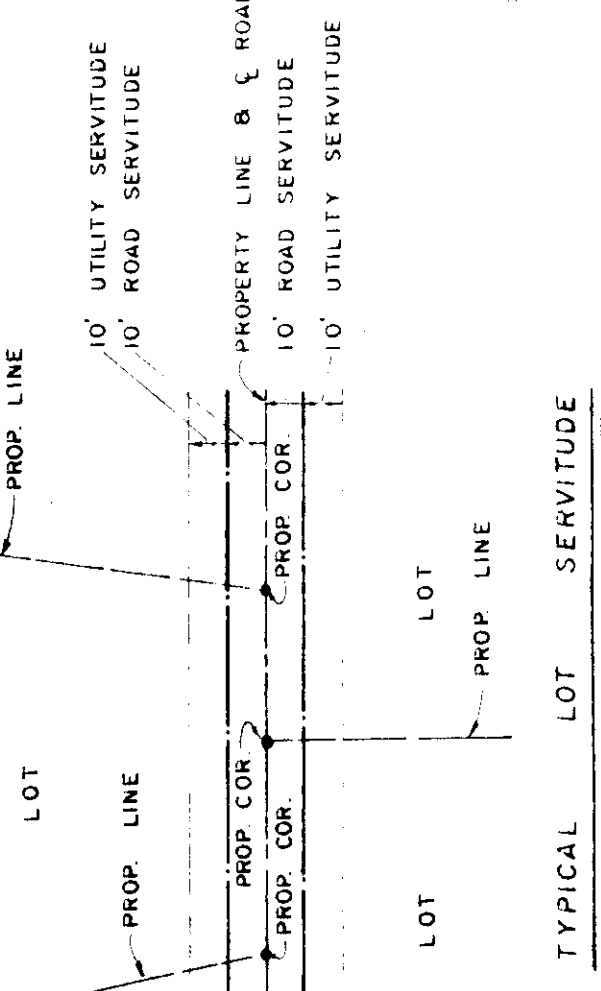

P.O.B. IS 3018.9' SOUTH
 AND 6618.4' EAST OF
 THE N.E. CORNER OF SEC. 3
 T8S, R6E, LIVINGSTON
 PARISH, LA.

#477767
 10/9/01