

# Evaluation of Existing Conditions Recap

Review of Code, Structure, Building Systems, Civil/Landscape, etc.

- // **no** classroom storage, amenities, or tech
- // **no** small group collaboration space
- // years of indoor air quality **troubleshooting**
- // science classrooms **do not** meet guidelines
- // classrooms **without** windows/ventilation
- // **limited** special education space
- // **poor** acoustics in academic areas & beyond
- // **no** outdoor learning spaces

- // **deteriorating** interior finishes
- // **does not** meet current energy code
- // **does not** meet seismic structural code
- // **does not** meet accessibility requirements
- // **does not** meet egress requirements
- // **unorganized** & impractical layout
- // **inefficient** artificial lighting
- // **outdated** mechanical systems

- // **inefficient** & problematic exterior envelope
- // thermally **uncomfortable** interior
- // **poorly** distributed HVAC systems
- // unit ventilators **noisy** and unreliable
- // **poor** on site vehicular/bus circulation
- // **ineffective** stormwater retention system
- // **oversaturated** recreational fields
- // **does not** support a modern education

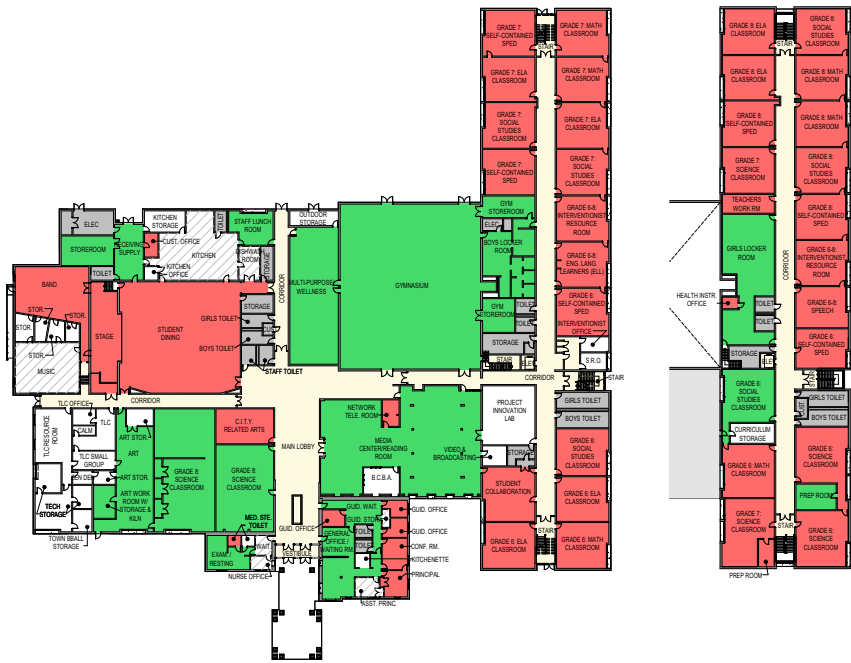

All general classrooms of existing school are **undersized** per MSBA guidelines



Plumbing fixtures not compliant per ADA (old!)



Years of water infiltration at the exterior envelope



HVAC systems at end of useful service life

# Educational Visioning Recap

## Session 01 - Students

### WHAT they SAID...

*in no particular order*

- // floor to ceiling **windows**
- // **natural light** and views
- // exposed ceilings/ structure
- // simple colors w/ natural elements
- // mezzanines or **bridges** for **visibility**
- // **flexibility** for group work
- // murals or museum-like **displays**
- // stools/ **furniture** to support fidgeting

- // school "living room" or **commons**
- // **write-able wall** surfaces
- // individual work zones/ **nooks**
- // a covered **outdoor** classroom
- // a dedicated **news media room**
- // different surface textures
- // places to foster **collaboration**
- // exterior **courtyards** with plantings

- // theater/ **auditorium**
- // **fields** and parks (skate park!)
- // spaces for specialized classes
- // sliding or **overhead doors** to **outside**
- // kiln for pottery and ceramics
- // **planetarium/ aquarium/ greenhouse**
- // **quiet spaces/ lounge / big library**
- // spaces to go when they feel **sad**

Whitman Middle School - Session 01

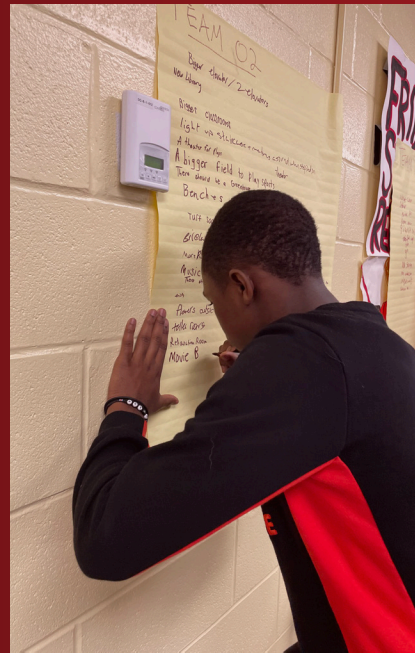

Conley & Duval Elementary Schools



**Grades 6-8**

Inspirational Ideas: Open Discussion

→ "Brain Dash!" Activity w/ Prioritization

→ "Ready, Set, Draw" Activity

**Grade 5**

"Brain Dash!" Activity w/ Prioritization

→ "Ready, Set, Draw" Activity

# Educational Visioning Recap

## Sessions 02 & 03 - Staff & Educators

### WHAT they SAID...

*in no  
particular  
order*

- // auditorium
- // courtyards and/or outdoor spaces
- // natural light and big windows
- // nature/plants throughout
- // learning pods
- // sinks in all classrooms
- // modern teacher lounge
- // group counseling space

- // interactive classroom/lab
- // amphitheater
- // fitness center w/ running track
- // water feature/fountain
- // a net-zero energy building
- // news/media broadcasting space
- // game room
- // zen-den for adults

- // a student resource center
- // 3D printer, wifi, and huddle stations
- // open-shelved storage
- // foreign language classrooms/labs
- // library gardens
- // wetlands discovery path
- // spaces for project-based learning
- // views to the sky

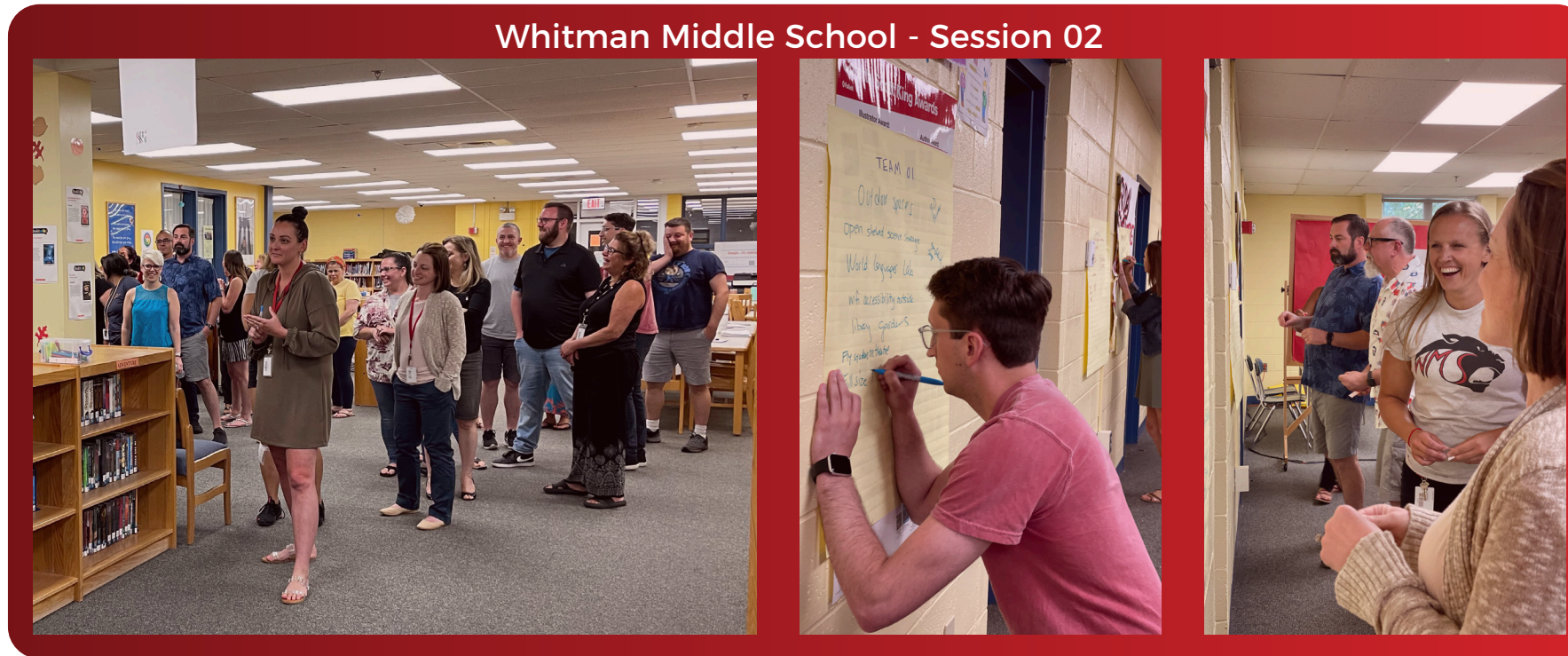

**Session 02**

S.C.O.G. Analysis Group Activity

→ 21st C. Design Patterns Interactive Poll

→ "Brain Dash!" w/ Prioritization

**Session 03**

Review of Session 02 Results/Responses

→ 3D "Ready, Set, Draw" using pieces