



# Whitman Middle School

School Building Committee // February 14, 2023

## Agenda

- // Project Schedule Overview
- // PSR Activities & Milestones
- // Summary of Preferred Option
- // **VOTE** of Approval to submit PSR to MSBA
- // Next Steps

# WMS Project Schedule Overview

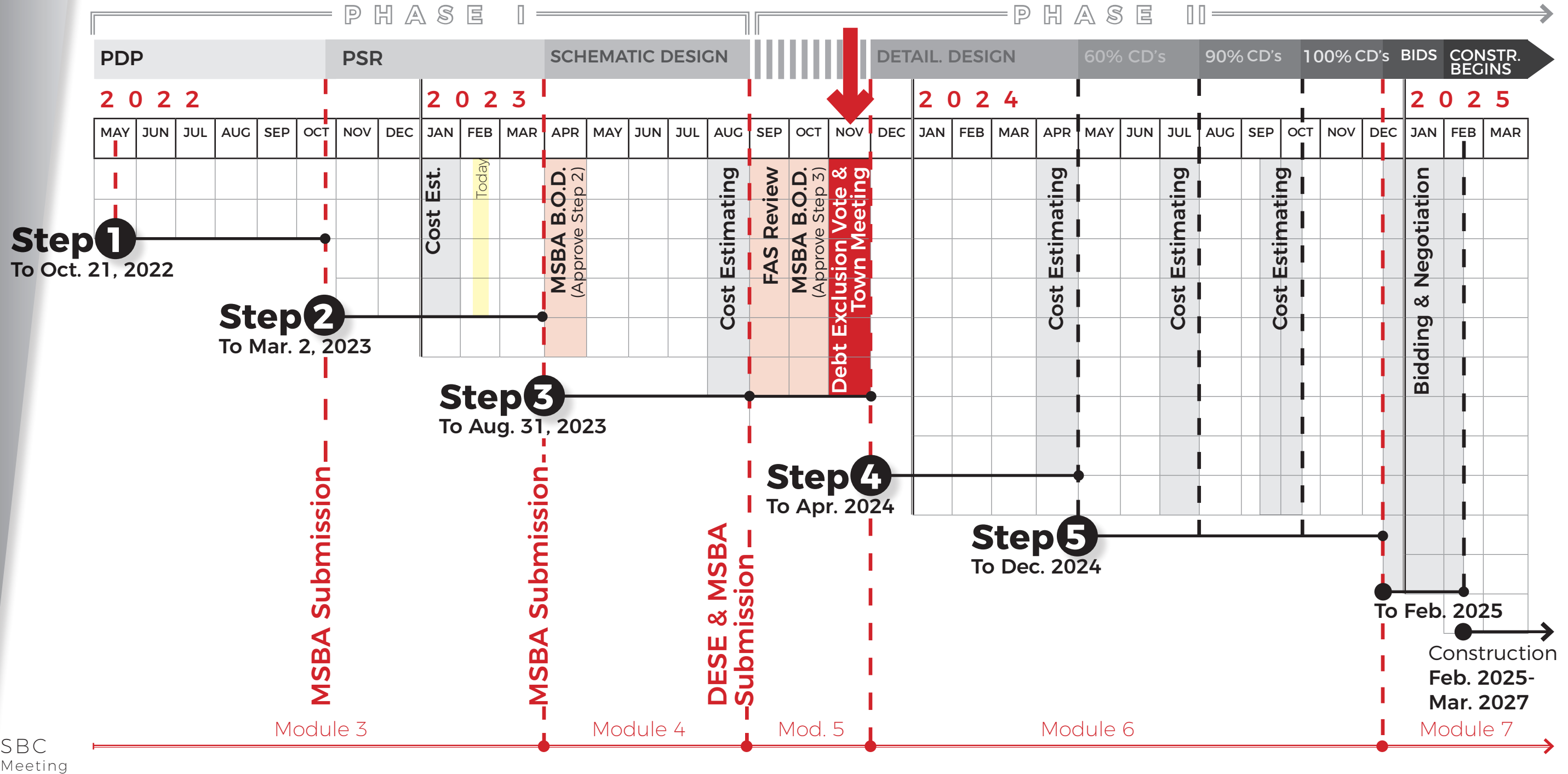

# Step 2 Preferred Schematic Report (PSR)

Oct - Mar 2023

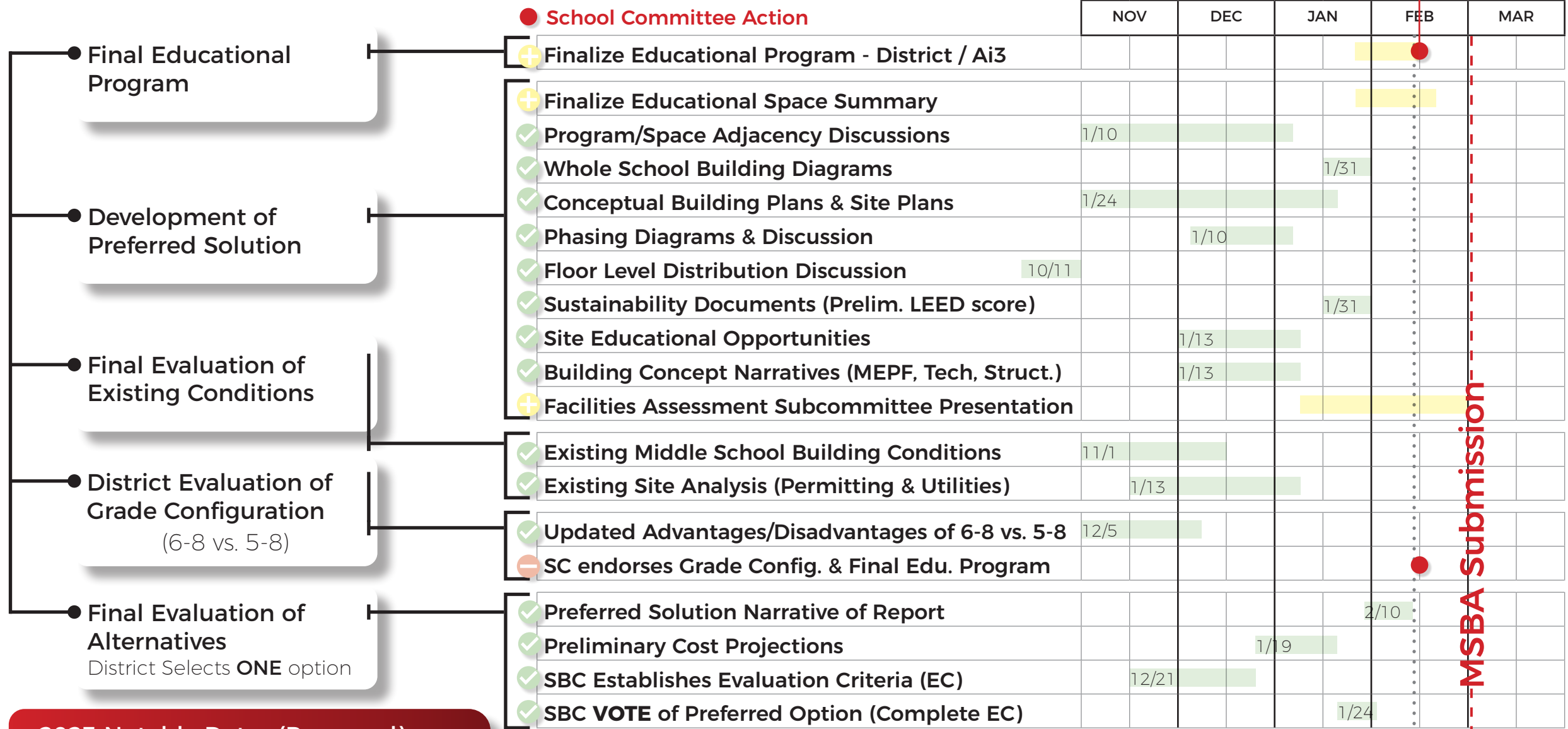

SC Vote to Approve Edu. Prog. (Feb. 15)

MSBA Submission

Today (Feb. 14) ● Mar. 02 ●

**2023 Notable Dates (Proposed):**

- Apr. 25 // SBC Meeting
- Mar. 21 // SBC Meeting
- Mar. 06 // Community Forum #4
- Mar. 02 // Submit PSR to MSBA**
- Feb. 28 // Optional SBC Meeting
- Feb. 15 // SC VOTE of Edu. Program
- Feb. 14 // SBC VOTE to submit PSR

- Completed ✓
- Initiated +
- Pending -

# Upcoming Milestone: PSR Submission to MSBA

Thursday MAR. 2, 2023

Nearly 500 pages!



**Whitman Middle School**  
Module 3: Preferred Schematic Report

March 2, 2023



**Whitman-Hanson Regional School District**  
Jeffrey Szymaniak  
610 Franklin Street  
Whitman, MA 02382

**Ai3 Architects, LLC**

### CONTENTS

<b>3.3.1 // INTRODUCTION</b>	
1	Overview of Process
7	Project Directory
11	Updated Project Schedule
15	Summary of Final Evaluation of Existing Conditions
17	Summary of Final Evaluation of Alternatives
23	Summary of the District's Preferred Solution
25	MSBA Review & District Response to PDP Report
<b>3.3.2 // EVALUATION OF EXISTING CONDITIONS</b>	
45	Existing Conditions Evaluations & Floor Plans
51	Existing Site Analysis
54	Existing Electric Service
64	Existing Gas Service
72	Existing Communications Service
78	Existing Landscape Plan
82	Existing Site Aerial Survey
<b>3.3.3 // FINAL EVALUATION OF ALTERNATIVES</b>	
95	Overview
97	Option 3a: Addition/Renovation // Grades 6-8 (w/ Auditorium) 2-Story
98	Conceptual Site Plan
100	Conceptual Floor Plans
102	Conceptual Phasing
103	Site & Utilities Analysis
104	Structural Systems Narrative
106	Major Building Systems Narratives
119	Preliminary Cost Estimates
121	Option 7a: Addition/Renovation // Grades 5-8 (w/ Auditorium) 2-Story
122	Conceptual Site Plan
124	Conceptual Floor Plans
126	Conceptual Phasing
127	Site & Utilities Analysis
128	Structural Systems Narrative
130	Major Building Systems Narratives
143	Preliminary Cost Estimates
145	Option 4b: New Construction // Grades 6-8 (NO Auditorium) 3-Story
146	Conceptual Site Plan
148	Conceptual Floor Plans
150	Conceptual Phasing
151	Site & Utilities Analysis
152	Structural Systems Narrative
154	Major Building Systems Narratives
166	Preliminary Cost Estimates
167	Option 5b: New Construction // Grades 6-8 (w/ Auditorium) 3-Story
168	Conceptual Site Plan
170	Conceptual Floor Plans
172	Conceptual Phasing
173	Site & Utilities Analysis
174	Structural Systems Narrative
176	Major Building Systems Narrative
188	Preliminary Cost Estimates
189	Option 8b: New Construction // Grades 5-8 (NO Auditorium) 3-Story
190	Conceptual Site Plan
192	Conceptual Floor Plans
194	Conceptual Phasing
195	Site & Utilities Analysis
196	Structural Systems Narrative
198	Major Building Systems Narrative
210	Preliminary Cost Estimates
211	Option 9b: New Construction // Grades 5-8 (w/ Auditorium) 3-Story
212	Conceptual Site Plan
214	Conceptual Floor Plans
216	Conceptual Phasing
217	Site & Utilities Analysis
218	Structural Systems Narrative
220	Major Building Systems Narrative
232	Preliminary Cost Estimates
233	Permitting Requirements - All Options
235	Construction Cost Estimates - All Options
301	Summary of Preliminary Design Pricing
<b>3.3.4 // PREFERRED SOLUTION</b>	
303	Updated Educational Program
363	Grade Configuration
369	Architectural Response to Educational Program
369	Option 9b: New Construction // Grades 5-8 (w/ Auditorium) 3-Story
372	Conceptual Diagrams
374	Conceptual Floor Plans
376	Conceptual Site Plan
379	Conceptual Site Sections
380	Site Plan Diagrams
382	Space Summary
388	Sustainability Documents
391	Budget - Construction & Total Project Cost
393	Budget Statement
394	Project Schedule for Preferred Solution
<b>3.3.5 // LOCAL ACTIONS &amp; APPROVAL CERTIFICATION</b>	
397	Local Actions and Approvals Letter
399	School Building Committee Agendas & Minutes
401	School Committee Agendas & Minutes

*End of Report*

Denotes items in progress

# Summary of Preferred Option



# How the Preferred Schematic Option aligns with the Educational Program:

- // Conceptual floor plan organization accounts for **flexibility & adaptability**
- // Creates environments to support **collaboration**
- // Organizes grade-levels into **academic neighborhoods**

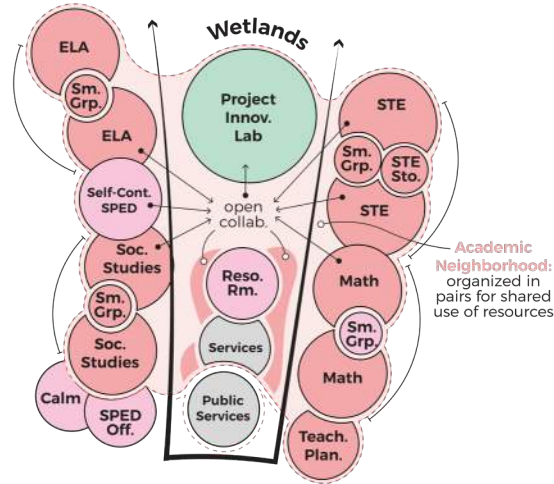

- // Offers separation of grade-levels without isolation
- // **Integrates special education** into the general learning areas
- // Classrooms within the academic neighborhoods are paired
- // Supports interdisciplinary instruction with hands-on, **project-based learning**
- // Small group rooms between classroom pairs in academic neighborhoods

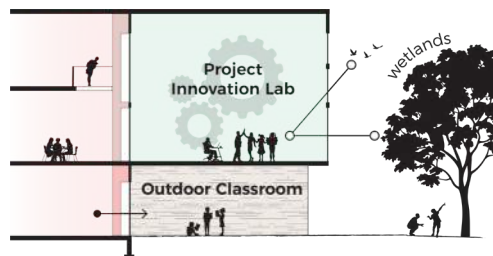

- // **Open collaboration** spaces are central to each academic neighborhood
- // Science classrooms are nearest to the **wetlands** for direct correlation
- // Includes a **teacher planning/collaboration** space per grade-level
- // Makes use of corridor spaces within neighborhoods so that they aren't narrow, solid and disconnected

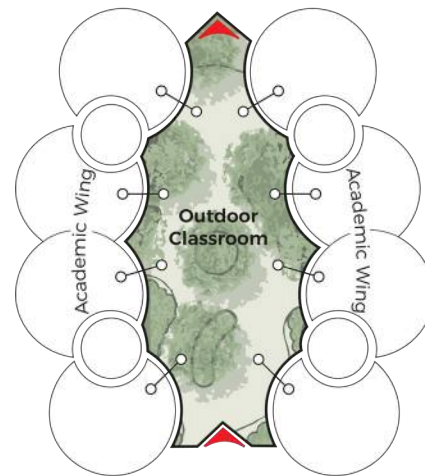
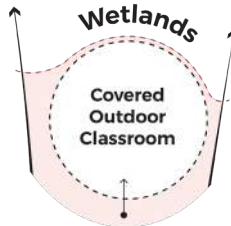

- // Conceptual floor and site plans create **strong connections to the outdoors** and biophilic design
- // Art classroom could have outdoor access by use of a green roof

- // Building organization **promotes community use** by placing shared/public spaces at the front of the building for access and oversight
- // Strong **indoor/outdoor connections** through direct access, transparency, natural daylight, and views
- // **Related arts wing** created so students of different grade levels don't have to access another neighborhood regularly

- // Administration, guidance, and nurse centrally located to provide **campus oversight**
- // Concept of **"Main Street"** and a linear layout for clear circulation
- // Centrally located **student commons** with direct access to student services, like guidance

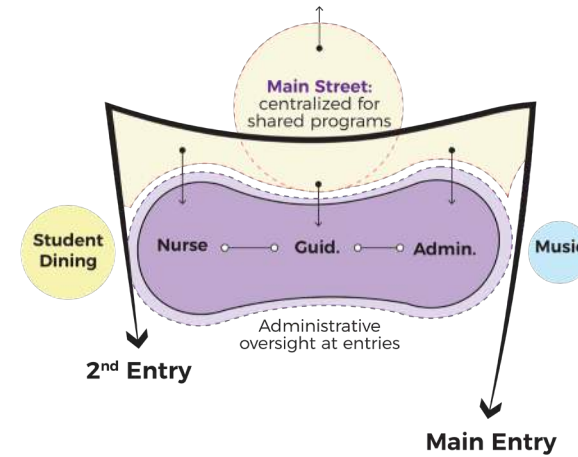
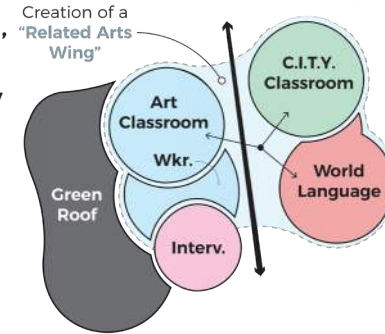

- // Library/Media Center represents center of the school and agencies create an **"innovation hub"**
- // Includes an **auditorium** to support performance and drama programs
- // There is an overlapping of academic spaces such as **views** from dining into project innovation lab to put project-based **learning on display**

- // Building organization promotes community use with clear separation between shared spaces and academics
- // Overall **compact footprint** for conservation of site green space
- // **Access to outdoors** from gym, multipurpose room, and commons

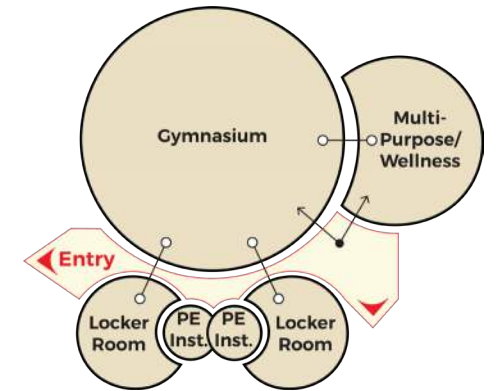

- // Plan includes a health classroom with close proximity to the gym
- // Site plan replicates existing number of **recreational fields**
- // Music and band at building front for **after-hours use** with access to outdoors

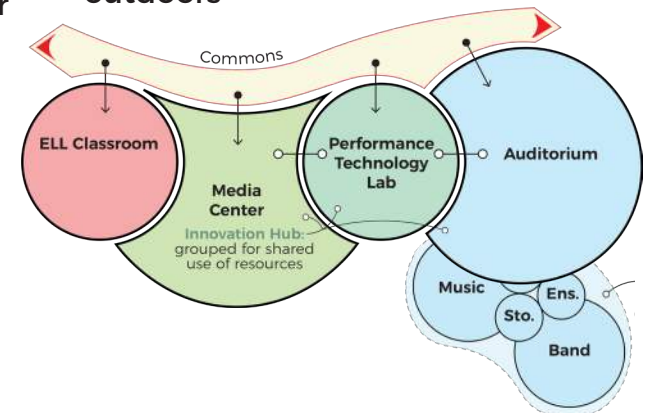

# Space Summary Updates

## Ongoing Coordination with the Educational Program

A	B	C	D	E	F
Space Summary Category	Area per PDP Submission	Proposed Area per PSR Submission	Category Difference PDP vs. PSR (C-B)	Allowable Area per MSBA	Difference Proposed vs. MSBA (C-E)
<b>CORE ACADEMIC SPACES</b>	<b>39,850 sf</b>	<b>39,150 sf</b>	<b>- 700 sf</b>	<b>32,670 sf</b>	<b>6,480 sf</b>
Gr. 5-6 English Language Learners (ELL)	Not Included	850 sf	+ 850 sf		
Gr. 7-8 English Language Learners (ELL)	Not Included	850 sf	+ 850 sf		
Student Collaboration	2,400 sf	0 sf	- 2,400 sf		
<b>SPECIAL EDUCATION</b>	<b>7,845 sf</b>	<b>10,475 sf</b>	<b>2,630 sf</b>	<b>7,550 sf</b>	<b>2,925 sf</b>
Self-Contained SPED Toilet	240 sf	0 sf	- 240 sf		
TLC Resource Room	425 sf	850 sf	+ 425 sf		
TLC Toilet	Not Included	60 sf	+ 60 sf		
Calm	150 sf	200 sf	+ 50 sf		
Sensory Room / OT	Not Included	425 sf	+ 425 sf		
Autism Spectrum Disorder (ASD) Classroom	Not Included	850 sf	+ 850 sf		
Autism Spectrum Disorder (ASD) Toilet	Not Included	60 sf	+ 60 sf		
ELA Grade 5-8: Intervention Classroom	Not Included	500 sf	+ 500 sf		
Math Grade 5-8: Intervention Classroom	Not Included	500 sf	+ 500 sf		

**700 sf decrease** in "Core Academic"

**2,630 sf increase** in "Special Education"

# Space Summary Updates (cont.)

## Ongoing Coordination with the Educational Program

<b>ART &amp; MUSIC</b>	<b>4,150 sf</b>	<b>4,150 sf</b>	<b>0 sf</b>	<b>3,250 sf</b>	<b>900 sf</b>
Music	1,200 sf	900 sf	- 300 sf		
Storage	Not Included	300 sf	+ 300 sf		
<b>VOCATIONS &amp; TECHNOLOGY</b>	<b>3,840 sf</b>	<b>3,250 sf</b>	<b>- 590 sf</b>	<b>4,320 sf</b>	<b>- 1,070 sf</b>
C.I.T.Y. Related Arts	1,200 sf	850 sf	- 350 sf		
Performance Tech. Lab	1,440 sf	1,200 sf	- 240 sf		
<b>HEALTH &amp; PHYSICAL EDU.</b>	<b>11,650 sf</b>	<b>11,100 sf</b>	<b>- 550 sf</b>	<b>8,400 sf</b>	<b>2,700 sf</b>
Gym Storeroom	150 sf	500 sf	+ 350 sf		
Health Instructor's Office	500 sf	300 sf	- 200 sf		
Multipurpose/Well. Room	3,000 sf	2,300 sf	- 700 sf		
<b>OTHER</b>	<b>6,000 sf</b>	<b>6,620 sf</b>	<b>520 sf</b>	<b>0 sf</b>	<b>6,620 sf</b>
Toilet/Changing Rooms	Not Included	120 sf	+ 120 sf		
Outdoor Storage	Not Included	250 sf	+ 250 sf		
Town Basketball Storage	Not Included	150 sf	+ 150 sf		

0 sf change in  
"Art & Music"

590 sf decrease in  
"Vocations & Tech."

550 sf decrease in  
"Health & Phys. Ed."

520 sf increase in  
"Other"

<b>TOTAL NET FLOOR AREA</b>	<b>91,663 sf</b>	<b>92,973 sf</b>	<b>1,310 sf</b>	<b>76,017 sf</b>	<b>16,956 sf</b>
<b>TOTAL GROSS AREA (GSF)</b>	<b>137,949 sf</b>	<b>139,459 sf</b>	<b>1,965 sf</b>	<b>112,339 sf</b>	<b>27,120 sf</b>

3,150 sf total increase  
1,840 sf total decrease  
1,310 sf total change  
x 1.5 grossing factor  
**1,965 sf total change**

19.4%





**Whitman MS  
Preferred  
Schematic**

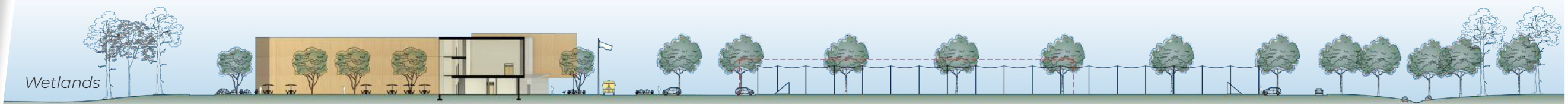

- Add-Alternate Scope
- Outline of Existing
- Emergency Access
- Parent Drop-off
- Bus Drop-off
- Main Entry

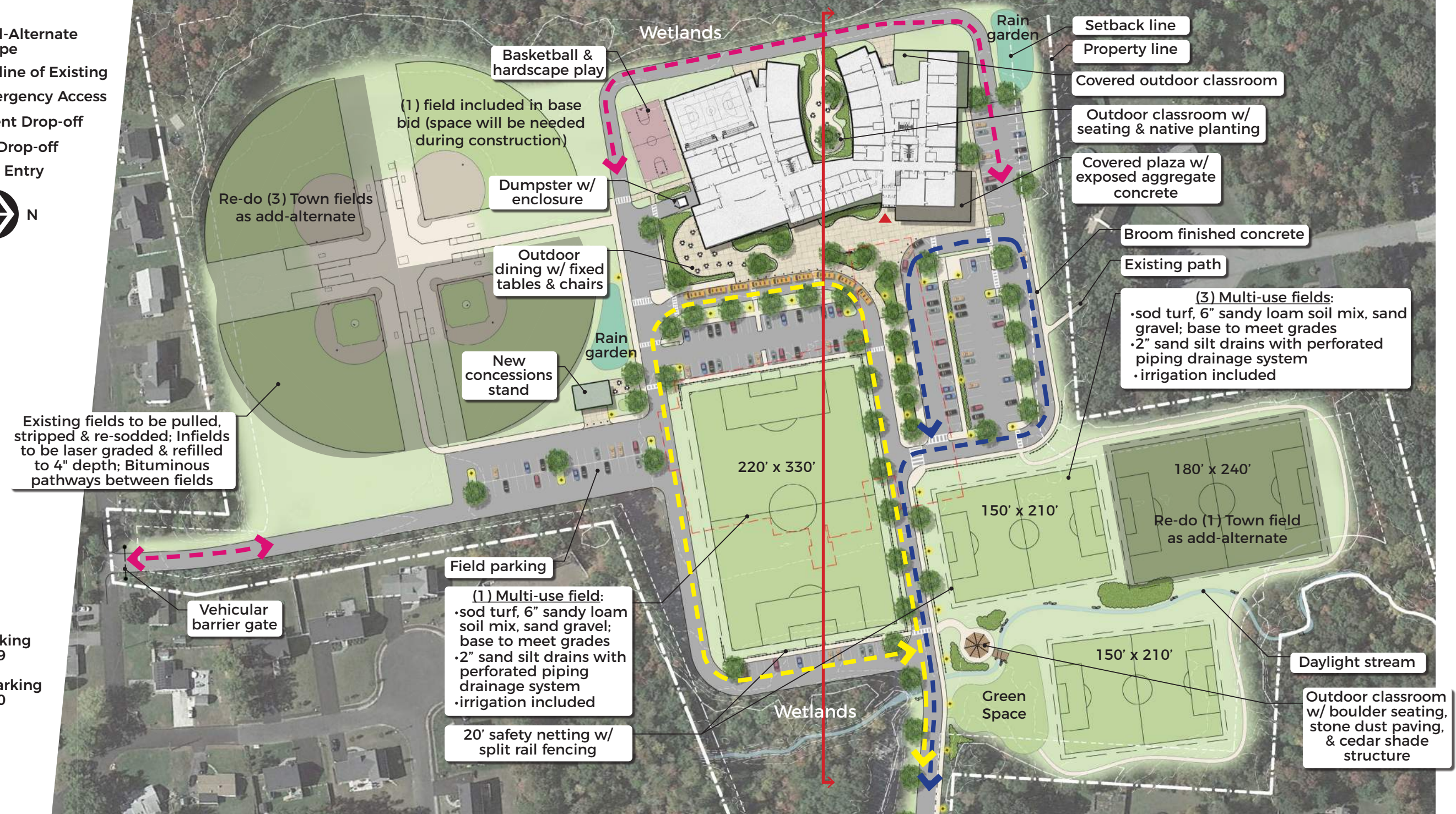

Existing Parking Spaces = 159  
Proposed Parking Spaces = 180

**Wetlands**

Basketball & hardscape play

(1) field included in base bid (space will be needed during construction)

Re-do (3) Town fields as add-alternate

Dumpster w/ enclosure

Outdoor dining w/ fixed tables & chairs

New concessions stand

Rain garden

Existing fields to be pulled, stripped & re-sodded; Infields to be laser graded & refilled to 4" depth; Bituminous pathways between fields

220' x 330'

Field parking

(1) Multi-use field:  
•sod turf, 6" sandy loam soil mix, sand gravel; base to meet grades  
•2" sand silt drains with perforated piping drainage system  
•irrigation included

20' safety netting w/ split rail fencing

Wetlands

150' x 210'

180' x 240'

Re-do (1) Town field as add-alternate

150' x 210'

Green Space

Daylight stream

Rain garden

Setback line

Property line

Covered outdoor classroom

Outdoor classroom w/ seating & native planting

Covered plaza w/ exposed aggregate concrete

Broom finished concrete

Existing path

(3) Multi-use fields:  
•sod turf, 6" sandy loam soil mix, sand gravel; base to meet grades  
•2" sand silt drains with perforated piping drainage system  
•irrigation included

Outdoor classroom w/ boulder seating, stone dust paving, & cedar shade structure

Vehicular barrier gate

# Preferred Option 9b

## New Construction // Grades 5-8 w/ Auditorium

# Floor Plan 1



Discovery High School  
Lawrenceville, GA



Braintree East Middle School,  
Braintree, MA

Examples of protected outdoor learning environments.



Linde Center for Music & Learning  
Lenox, MA

Example of direct outdoor connection for music/arts programs.



# Preferred Option 9b

## New Construction // Grades 5-8 w/ Auditorium

# Floor Plan 2



Examples of built-in open collaboration areas within academic neighborhoods.

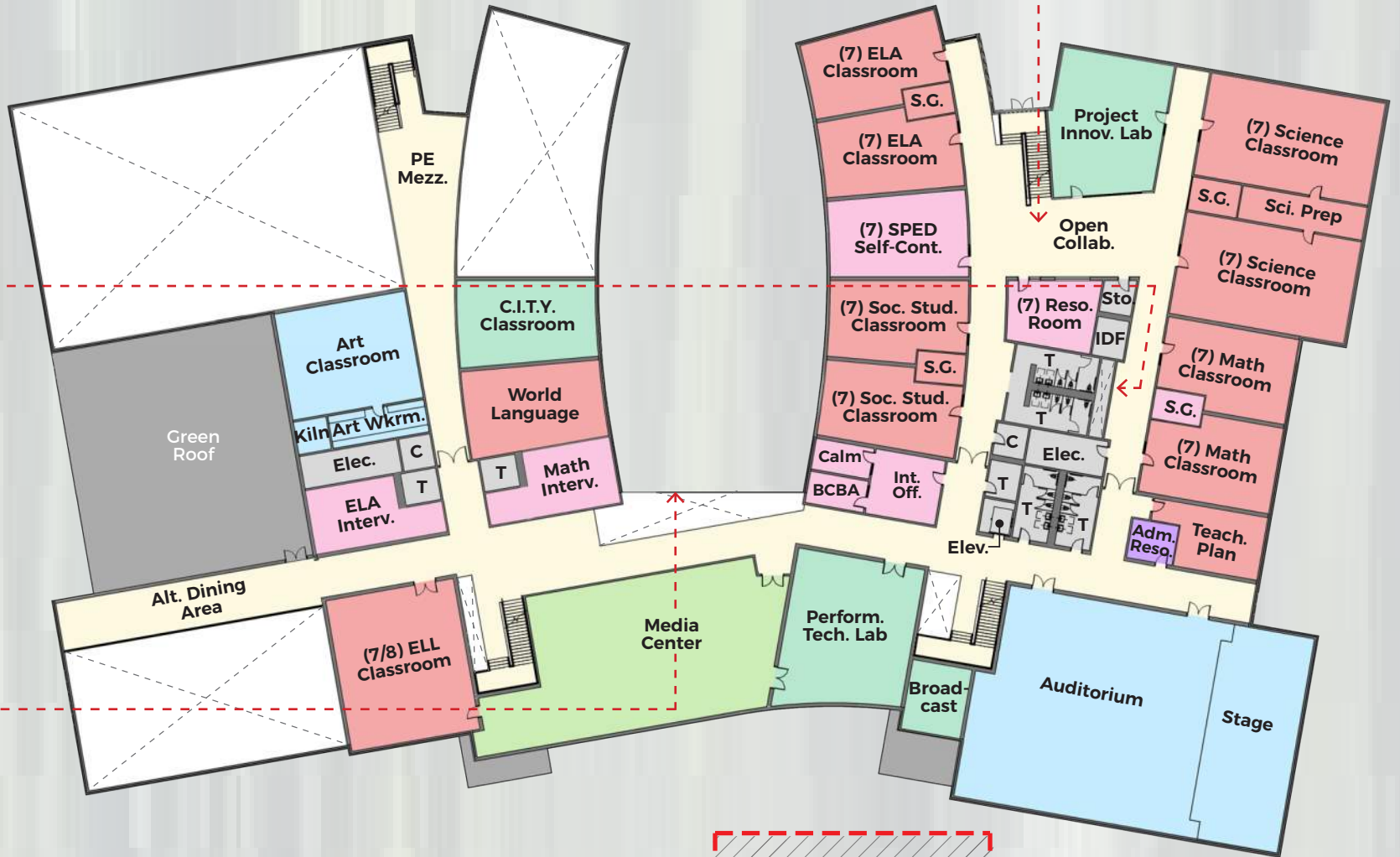

# Preferred Option 9b

## New Construction // Grades 5-8 w/ Auditorium

# Floor Plan 3

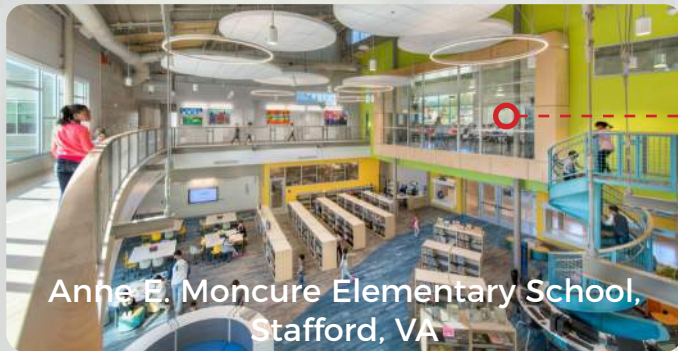

Examples of visual connections, like into the media center or centralized resource rooms.



Presence and shared use of dining plaza at building corner

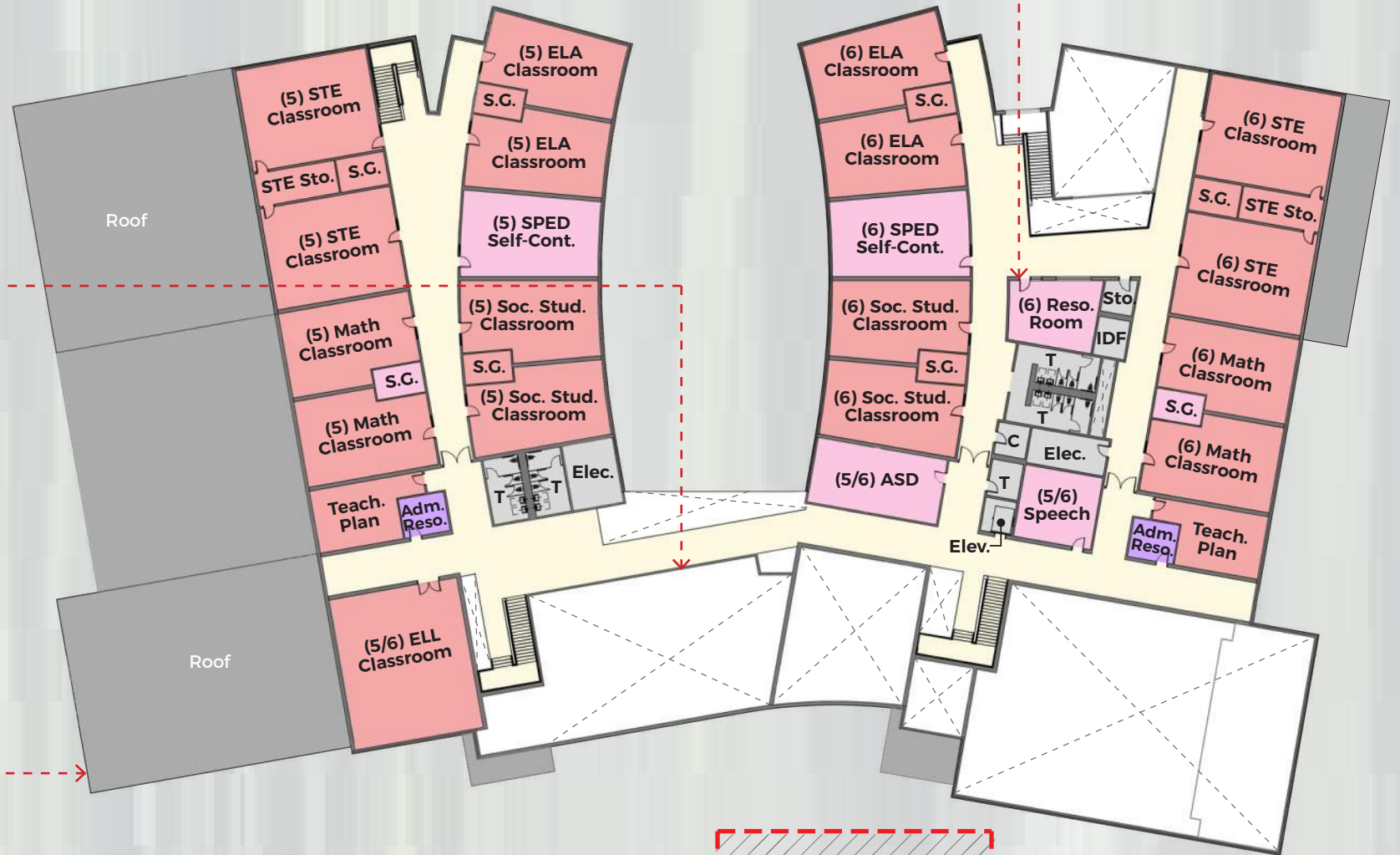

# Preferred Option 9b

The Preferred Option promotes sustainability by...



add-alt. =  
optional  
addition to  
project

On-Site  
Renew.  
Energy



Protect  
Existing  
Wetlands



Stormwater  
Control/  
Bioretention



Green  
Roof  
Area



Solar  
Roof  
Area



Energy  
Efficient  
Orientation



Reduced  
Heat  
Island



Outdoor  
Learning  
Areas



Restore  
Natural  
Features



# Preferred Schematic Report (PSR) Submission

Module 3, Phase II Approvals for Submission

Approval to  
continue the  
Process

What is the School Building Committee being asked to **APPROVE**?

**VOTE** to approve and authorize the Owner's Project Manager to submit the Feasibility Study Preferred Schematic Report (PSR) to the MSBA for consideration.

**DOES NOT INCLUDE:**

- // Specific building drawings or designs, at this point
- // Specific site drawings or designs, at this point

# Upcoming Actions & Votes

SC = School Committee  
SBC = School Building Committee

	OCT 2022	NOV 2022	DEC 2022	JAN 2022	FEB 2022	MAR 2022
PRELIMINARY DESIGN PROGRAM (PDP)	✓ 1 SC <b>vote</b> to approve educational program for both enrollment options ✓ 2 SBC <b>vote</b> to submit PDP ✓ 3 <b>PDP Submission</b> to MSBA					
	ENROLLMENT	✓ 4 SC & SBC <b>discuss</b> enrollment options ✓ 5 <b>Community Forum #2</b> (Presenting plans from PDP, Grade Configuration, & Auditorium vs. Caf)	✓ 7 SC & SBC <b>discuss</b> enrollment options, including the impact to elementary schools if grade 5 moved ✓ 8 <b>Community Forum #3</b> (Refined presentation of plans, Grade Configuration, & Auditorium vs. Caf)	✓ 10 SBC <b>discuss/review</b> grade-level configuration ✓ 11 SC & SBC <b>vote</b> on enrollment option in JAN		
PREFERRED SCHEMATIC REPORT (PSR)	✓ 6 SBC <b>discuss/establish</b> evaluation criteria	✓ 9 SBC <b>establish</b> option selection criteria and matrix	✓ 12 SBC use criteria matrix to <b>rank/select</b> preferred option, including cost info ✓ 13 SBC <b>decision</b> to include auditorium or cafeteria	✓ 14 SBC <b>vote</b> to submit PSR (optional SBC meeting on Feb. 28) ✓ 15 SC <b>endorse</b> preferred option & Educational Program	✓ 16 <b>PSR Submission</b> to MSBA ✓ 17 <b>Community Forum #4</b> Present preferred option for submission	





# Upcoming Milestones

## Dates & Content

### PSR Submission

THURSDAY  
**MAR 2, 2023**  
Report Due to MSBA

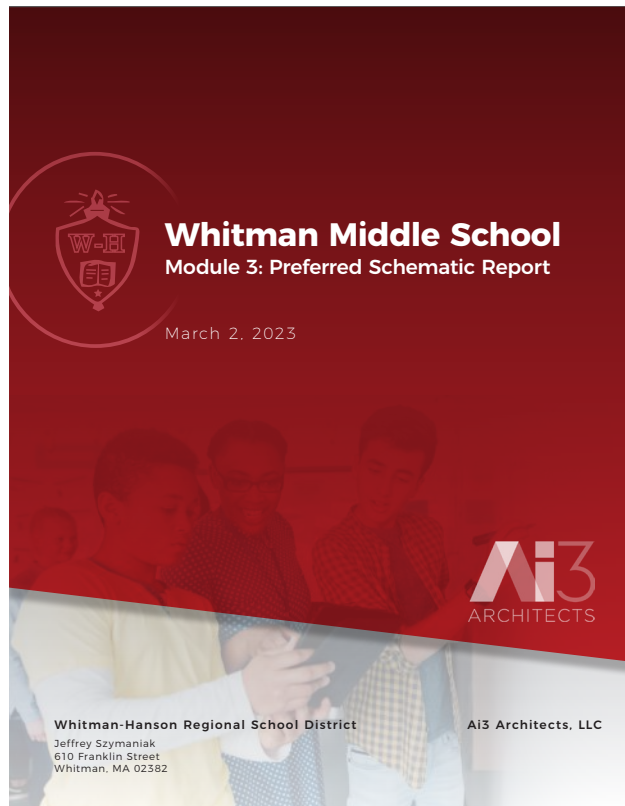

Submission of the PSR (Preferred Schematic Report)

### Community Forum #4

MONDAY  
**MAR 6, 2023**  
Whitman Middle School  
Cafeteria @ 6:30 pm

[For all interested Community Members]

Visit [WHRSD.org](http://WHRSD.org) and the **feasibility study** page to continue to stay informed

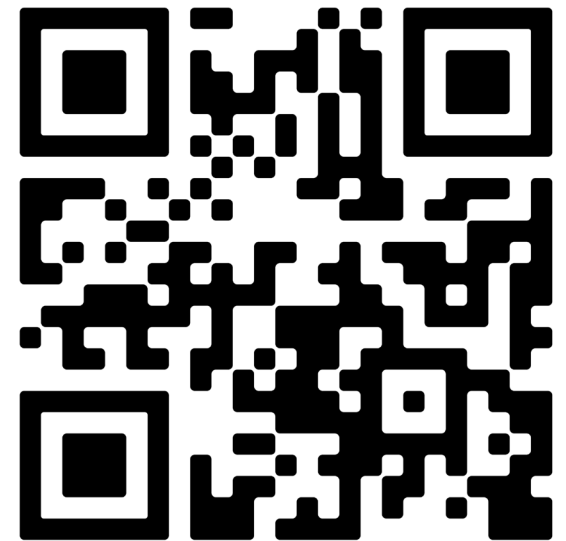



# Questions?

Thank you