



## **KAWASAKI**

**Vulcan 900 CLASSIC- CLASSIC LT  
AND CUSTOM MODELS 2006-CURRENT**

# **Electric Reverse Installation Instructions**

Revised 1 - 2016

**California Sidecar Parts & Technical Support  
434.263.8866**

## Warnings and considerations:

1. **Disclaimer** - These instructions assume a level of understanding of motorcycle repair and maintenance beyond that of a “beginner” and/or “novice” and California Sidecar cannot be liable for an installer’s failure to understand or follow these instructions as written. Likewise, California Sidecar cannot be responsible if any of the steps are omitted or shortcuts are taken, or parts other than those supplied by California Sidecar, are used in installing this trike kit.
2. **“WARNINGS”** are all printed in bold type and capitalized. They mean to use extreme care in a given step so as not to damage the part, motorcycle, and/or yourself.
3. **Always** wear safety glasses when using hand and/or power tools.
4. When working in and around the fuel system, **always** work in a well-ventilated area, free from sparks and open flames.
5. All directional references to the “right side” and the “left side” are as you were seated on the motorcycle.
6. All directional references to “forward” mean to the front of the motorcycle while “back” means the rear of the motorcycle unless otherwise stated.
7. Please consult the appropriate Service Manual for your motorcycle if further detail is necessary.

**INSTALL REVERSE AND ALL ITS PARTS DURING INSTALLATION AND BEFORE THE BODY IS INSTALLED.**

**Assembly:**

1. Once 23.5 MM and 50 MM belts are tensioned and all clamping bolts are tightened.
2. Check the Tension of the Reverse belt.
3. Sonic Tension Meter specs:  
MASS 004.7  
WIDTH 021.0  
SPAN 0176
4. Reverse Belt Tension:  
SINGLE SPAN TENSION: 49-55 lbs.

**Secure Reverse Module with two 8-32 X 1/2 BHSCS with the wire harness connectors pointing forward as shown.**

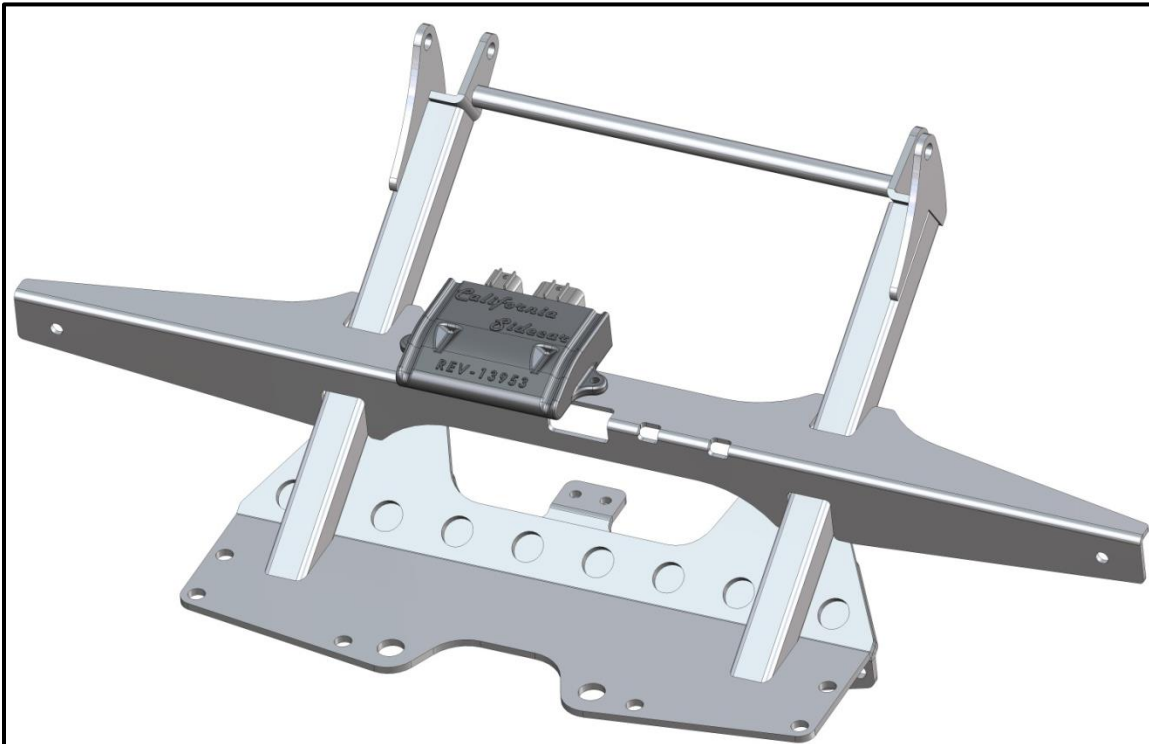

# Wiring

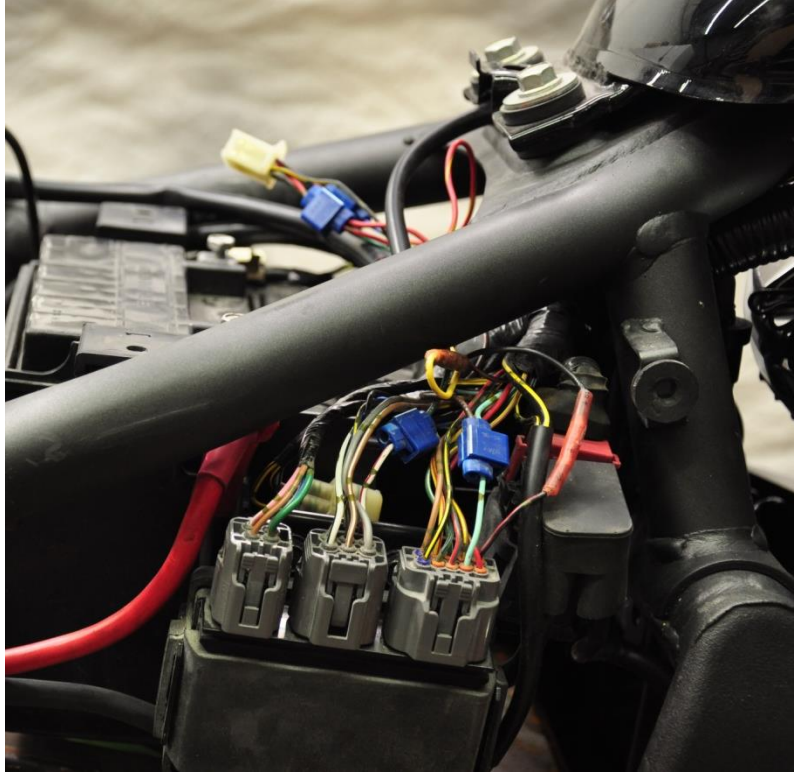

- 1. Locate the ECU (the 3 plug box) behind the RT side cover**
- 2. Route the reverse harness forward to this area. Pull the yellow, black, and brown wires out of the loom where the green wire already exits. Position that slit in the loom at the front of the ECU.**
- 3. Locate the white wire with red tracer at the ECU (Fuel pump wire) connect it to the green wire using a scotch lock connector.**
- 4. Locate the black wire with red tracer at the ECU (Start button wire) and cut it.**
- 5. Connect that black wire with red tracer at the junction box to the black wire with a butt connector.**
- 6. Connect the other end of that black wire with red tracer that goes to the harness to the yellow wire with a butt connector.**
- 7. Locate the light green wire. Connect the light green wire (Neutral wire) to the brown wire with a scotch lock connector.**

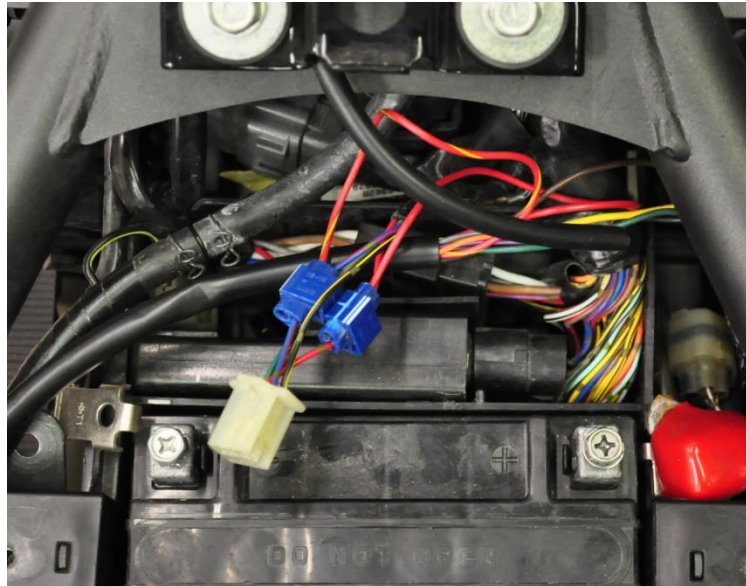

- 8. Locate the blue wire (brake light) under the seat at the fender plug. Using a scotch lock, connect to the red/yellow wire.**
- 9. Locate the red wire (tail light) also in the fender plug and connect the red wire using a scotch lock connector.**
- 10. Route the blue and white wires to the Reverse motor.**
- 11. Install terminal boot onto red positive cable.**
- 12. Connect the red positive cable to the stud on the Reverse motor solenoid.**
- 13. Using provided cable tie, secure the positive cable to the Reverse motor.**
- 14. Install the black negative cable and white wire to the lower long mounting bolt on the Reverse motor. Route the negative cable to the Ground wire bolt under the ECU.**
- 15. Connect the blue wire to the male spade on the Reverse motor.**
- 16. Connect the red cable to the positive battery terminal.**
- 17. Remove left side Chrome Cover.**



- 18. Drill a 1/2 hole for the reverse switch as shown.**
- 19. Ensure the rubber washer is on the Reverse switch, then insert the wire thru the cover and install nut and tighten.**
- 20. Connect the harness to the Reverse switch and secure wires with cable ties.**
- 21. Ensure that all wires and miscellaneous components are secured to the frame with cable ties.**

### **Operating the Electric Reverse:**

- 1. With the Trike in neutral. Start the engine.**
- 2. Depress the reverse switch and the red LED will light up.**
- 3. Press the start button and the trike will then back up.**
- 4. If the brakes are applied the reverse will pause until the brakes are no longer being used.**

**From all of us at California Sidecar.  
Enjoy the ride!**