

# RENTING THE ARTS CENTER

Each rental option includes day-before setup, where you drop off items, decorate, and prepare the space for your event. Day-before setup is based on CACCC's availability and must happen during CACCC operational hours to avoid additional charges. Saturday, Sunday and weeknight rental upcharges are in effect when CACCC is not open during regular operational hours. Tables and chairs are included in the rental price, and will be arranged prior to your arrival.

\*A maintenance fee is added to all rental prices and this amount will change depending on what your total rental price is. Storage in the kitchen or use of CACCC utensils is a \$25 fee and requires a credit card on file for any incidentals to missing items from CACCC's inventory. Incidentals will be addressed within 7 days of your rental.

**\*Membership is not required to rent!  
Please inquire for non-member prices.**

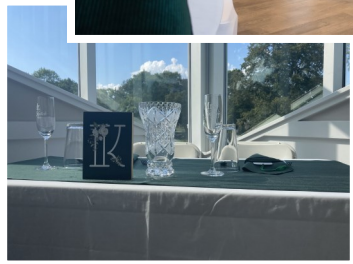

## WEDDING & RECEPTION PACKAGES ARE AVAILABLE!

ranging from \$600—\$5,500

Packages do not operate hourly but are considered "all-day events." Actual arrival and departure times will need to be agreed upon and honored by those utilizing the space. Any additional hours you may need will incur additional costs, if not indicated on contracted time.

## CHOOSE YOUR

2023 Rental Brochure

# COMMUNITY ARTS CENTER OF CAMBRIA COUNTY

## FOR YOUR NEXT EVENT!



1217 MENOHER BLVD. JOHNSTOWN, PA 15905

CACCC.ORG | 814-255-6515 | INFO@CACCC.ORG



## STUDIO

**MEMBER RATE** Business Hours: \$75/hour | Weekend/Weeknight: \$85/hour

**STUDIO, INCLUDING THE DRAWING ROOM:**

**MEMBER RATE** Business Hours: \$85/hour | Weekend/Weeknight: \$95/hour



## GALLERY

**MEMBER RATE** Business Hours: \$60/hour | Weekend/Weeknight: \$70/hour



## PONAS DOLL MUSEUM

**MEMBER RATE** Business Hours: \$55/hour | Weekend/Weeknight: \$65/hour



## LOG HOUSE

**MEMBER RATE** Business Hours: \$45/hour | Weekend/Weeknight: \$65/hour

## NEW RENTAL SPACES!

We've recently completed a 5,549 square foot addition in 2021, which means more opportunities for the perfect rental space! The M. Josephine Paul Family Museum connects to the Goldhaber-Fend Fine Arts Center building and features a gallery & black box theatre space on the first floor and our "atelier" event space on the second floor.



## M. JOSEPHINE PAUL FAMILY MUSEUM

**MEMBER RATE** Business Hours: \$75/hour | Weekend/Weeknight: \$85/hour



## ATELIER

**MEMBER RATE** Business Hours: \$85/hour | Weekend/Weeknight: \$95/hour

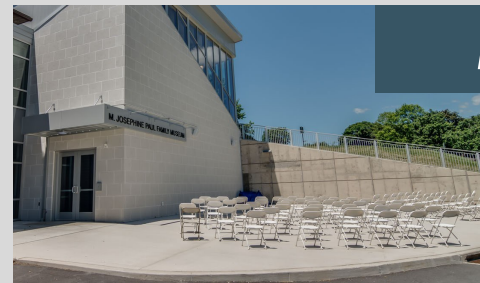

## AMPHITHEATRE

**MEMBER RATE**

Business Hours: \$85/hour  
Weekend/Weeknight: \$95/hour

\*Membership is not required to rent!  
Please inquire for non-member prices.