



New TapeChek 8600

Professional ¾" Tape Cleaner, Winder, Rejuvenator, Evaluator



A new U-Matic TapeChek, replacing obsolete machines, the TapeChek 8600 features new, modern electronics and sophisticated tape handling features.

For all U-Matic formats



Fully Automatic

TapeChek™ 8600

Features and workflow

Fully Automatic, just insert the cassette, large or small, and the TapeChek 8600 takes it from there, handling the tape under smooth constant tension. The tape is ejected automatically at the end of the cycle, fully rewound.

The 8600 is designed to be used, if required, in an automated cart or robotic cassette loading device. The TapeChek 8600 is an essential element of any tape digitization, rejuvenation & preservation workflow.

Little operator training is needed and the TapeChek optionally inspects for serious physical tape defects, exercises & rejuvenates the tape in one pass.

The TapeChek 8600 removes loose and embedded particles, dust and debris, it uses 1 sapphire polishing blade and 3 automatic, vacuum assisted specially designed cleaning tissues.

Running costs are low. The model 8600 replaces older RTI TapeChek VT3100 models which have obsolete electronics, are expensive to repair or replace. The TapeChek 8600 is a fast, seamless way to prepare your tapes for digitization, with the added benefit of greatly reducing costly VTR head clogging.

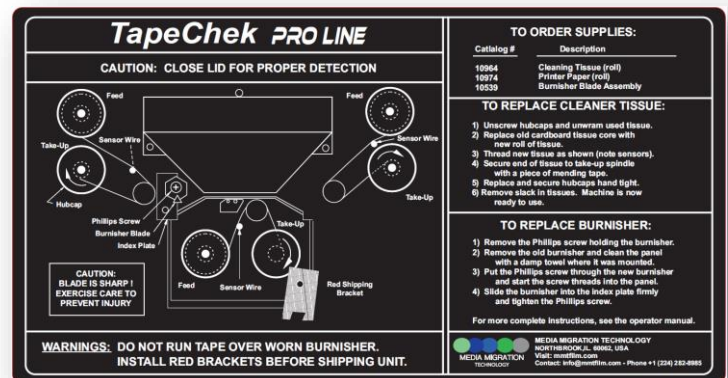



TapeChek 8600 Specifications

Cassette size:	Automatically senses standard or large U-Matic cassettes.
U-Matic types:	U-Matic, U-Matic S
Tape speed:	Up to 10 times standard play speed.
Cleaning system:	Three vacuum assisted, advancing cleaning tissues – two on the recording side and one on the back side. Using proprietary, specially formulated wiping tissues that safely remove loose particles, dust and other debris before and after polishing.
Burnishing:	Burnishing, or „polishing”, is a critical element of the ability of the TapeChek to rejuvenate older tapes. One precision sapphire burnishing posts polish the recording side in both forward & rewind directions.
Construction:	Sturdy, long-lasting metal cabinet and base plate construction. May be mounted in a 19” rack.
Optional Defect Counter:	Locates physical tape damage and provides a report of the location of tape defects in minutes and seconds.
Electronics:	Modern current generation electronics and controls replace obsolete electronics in prior TapeChek models. Clear, easy to read displays with simple user interface.
Tape transport:	Sensors continuously monitor tape speed and tension to ensure gentle tape handling.
Catalog number:	10310 - TapeChek 8600 Machine
Optional Extras:	10685: Automatic Defect Detector to simultaneously inspect tape for physical damage. 10686: Printer output port. 10544: PAL timing. LCU 1282: Professional packing with inserts & brackets.
Electrical supply:	110v, 60Hz or 220v, 50Hz. Please specify.
Dimensions:	Approx. 13 x 18 x 21 inches (33 x 45 x 55 cm). Weight 75lbs (34kg).
Shipping box:	Approx: 20 x 30 x 30 inches (50 x 76 x 76 cm). Weight 85lbs (40kg).



Northbrook, IL, 60062, USA
Phone: +1-224-282-8985

Sekocin Stary, (Warsaw), 05090, Poland
Phone: +48-662-042-079

E-mail: info@mmtfilm.com

www.mmtfilm.com