



SHADY ACRES



JOB#: F3129 A2.1  
 LEVEL ONE: 393  
 LEVEL TWO: 848  
 LEVEL THREE: 825  
 TOTAL LIVING: 2066  
 TOTAL COVERED: 2560  
 WIDTH: 23'-9"  
 DEPTH: 45'-0"  
 OVERALL DEPTH: 48'-0"  
 HEIGHT: 45'-7 1/2"  
 1st FLOOR CLG: 9'-1"U.O.N.  
 2nd FLOOR CLG: 10'-1"U.O.N.  
 3rd FLOOR CLG: 10'-1"U.O.N.



# 2221 Bevis Street

HOUSTON, TX 77008

 3  2.5  2  2,066 SQFT

Rustic charm meets mid-century modern in the heart of Shady Acres! This stunning home offers a limited opportunity for pre-finished pricing and customization. The chef's kitchen boasts an oversized quartz island and a premium stainless appliance package, while exceptional craftsmanship shines through with 8-inch wide plank French oak floors, designer lighting, exposed wood beams, interior barn doors, and black vinyl double-pane windows. The board & batten exterior comes with a 50-year warranty for peace of mind.

The primary suite features soaring 13' vaulted ceilings, a luxurious ensuite with double sinks, two walk-in closets, a soaking tub, and a separate shower. Enjoy a fenced backyard, oversized garage, and a prime location—walk to Heights H-E-B and top restaurants like Crisp, Cedar Creek, Rainbow Lodge, and McIntyre's. Plus, you're just steps from Wright-Bembry Park with pickleball, tennis, and a playground.

**Move-in ready by March 2025—don't miss out on this one-of-a-kind home!**

MICHELLE RAINWATER

(325) 668-4350 • RAINWATER@NEWLEAFRE.COM • IG: MRAINWATER.REALTOR • WWW.NEWLEAFRE.COM

*For informational use only. All information contained herein should be independently verified.*

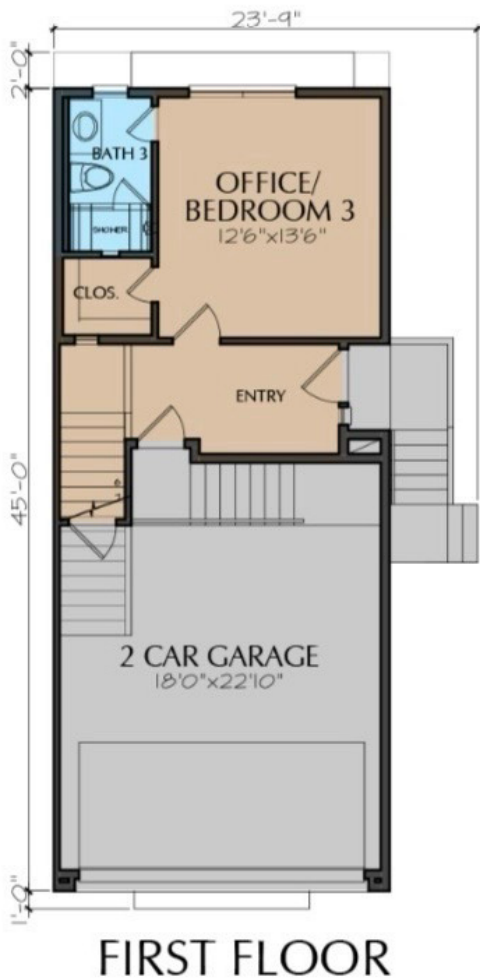

**Square Feet:** 2,066

**Stories:** 3

**Lot Size:** 1,969

**Year Built:** 2025

**Living Room:** 18 x 16, 2nd

**Dining Room:** 14 x 14, 2nd

**Kitchen:** 13 x 16, 2nd

**Primary Bedroom:** 18 x 14, 3rd

**Bedroom:** 13 x 14, 1st

**Bedroom:** 13 x 11, 3rd

**Countertops:** Quartz

**Floors:** Carpet, Tile, Wood

**Garage:** 2-Car, Attached

**Subdivision:** Shady Acres



**MICHELLE RAINWATER**

(325) 668-4350 • RAINWATER@NEWLEAFRE.COM • IG: MRAINWATER.REALTOR • WWW.NEWLEAFRE.COM

*For informational use only. All information contained herein should be independently verified.*