

## Install instructions for -5 Hitachi

### Step 1:

Disconnect batteries and locate the maf sensor which is typically located behind the air filter on the 4hk1 and 6hk1.

On 6wg1 and 6uz1 the sensor is located on the intake horn to the engine. The sensor is a 5 pin sensor.

It has to be in good working order to be used with this product.

### 4hk1 and 6hk1:

Figure 1:



Figure 2:



### 6wg1 and 6uz1:

Figure 3:



Figure 4:



\* this kit does not fix engine codes not related to anything but a plugged muffler filter.

\*\* if you have engine codes you will have to repair them immediately or it could throw false codes for the muffler filter when the issue is actually another engine issue.

**Step 2:**

Remove the guards around muffler assembly. After you remove the guards you will see three sensors that are applicable to the after-treatment system:

1. Inlet doc temp sender
2. Outlet temp sender
3. Differential pressure sensor.

You will need to disconnect all of them from the main harness and the sensors get replaced with your Def Link. We only utilize the one inlet doc temp sender which is the first temp sender in the circuit and this temp sender needs to be in good working order. When you plug in your Def Link some of the locating tabs on the temp senders may need to be removed with a utility knife to fit your style of plug. Make sure you have installed plugs far enough so they are locked on. Follow the provided schematic for plug locations.

Figure 5:



\* this kit does not fix engine codes not related to anything but a plugged muffler filter.

\*\* if you have engine codes you will have to repair them immediately or it could throw false codes for the muffler filter when the issue is actually another engine issue.

Figure 6:

## INSTALLATION DIAGRAM

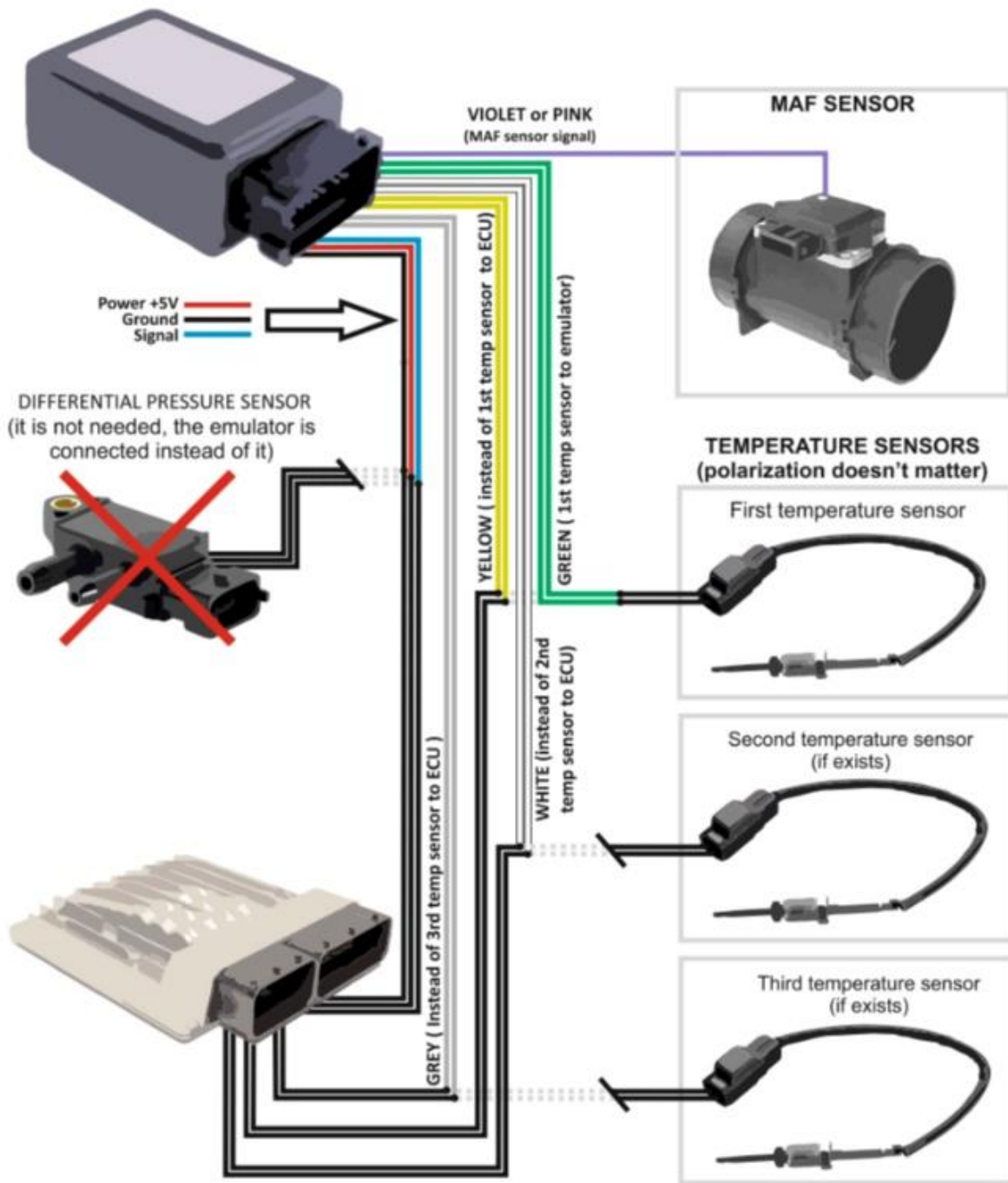

\* this kit does not fix engine codes not related to anything but a plugged muffler filter.

\*\* if you have engine codes you will have to repair them immediately or it could throw false codes for the muffler filter when the issue is actually another engine issue.

**Step 3:**

Go back to the maf sensor (Figure 1,2,3 & 4 ) and locate the signal wire, it is usually the center wire and can be verified by running the machine before hand and hooking a multimeter and seeing that voltage goes up with engine rpm.

Tie in the wire as per the schematic.(Figure 6)

This is the only wire that will need to tie into factory harness.

**Step 4:**

Find an appropriate location that you would like to mount the box. We recommend mounting in an area where sensitive electronics are mounted already, we mounted this one above the air cleaner.

**Step 5:**

We recommend after this point to run machine for 4hours to verify machine does not have any faults and the device is working as it should.

**Step 6:**

After you have verified it is working by running the machine, you can remove the dpf filter. Remove the internals and leave the doc in place it is very simple to remove the inside.

Figure 7:



Reinstall empty dpf (Figure 7) on the machine and enjoy.

After your install is complete, your machine should never do a regen again. On some models, the temp light may come on signaling that a regen is started but it will not inject fuel because a regen is not needed, as it senses the filter is clean.

\* this kit does not fix engine codes not related to anything but a plugged muffler filter.

\*\* if you have engine codes you will have to repair them immediately or it could throw false codes for the muffler filter when the issue is actually another engine issue.