

- LEGEND:**
- Site boundary
 - Proposed building
 - Hardstanding - Pedestrian route
 - Hardstanding - Vehicle route
 - Soft landscaping - refer to Landscape Designers info for further details
 - Pedestrian crossing - blister paving

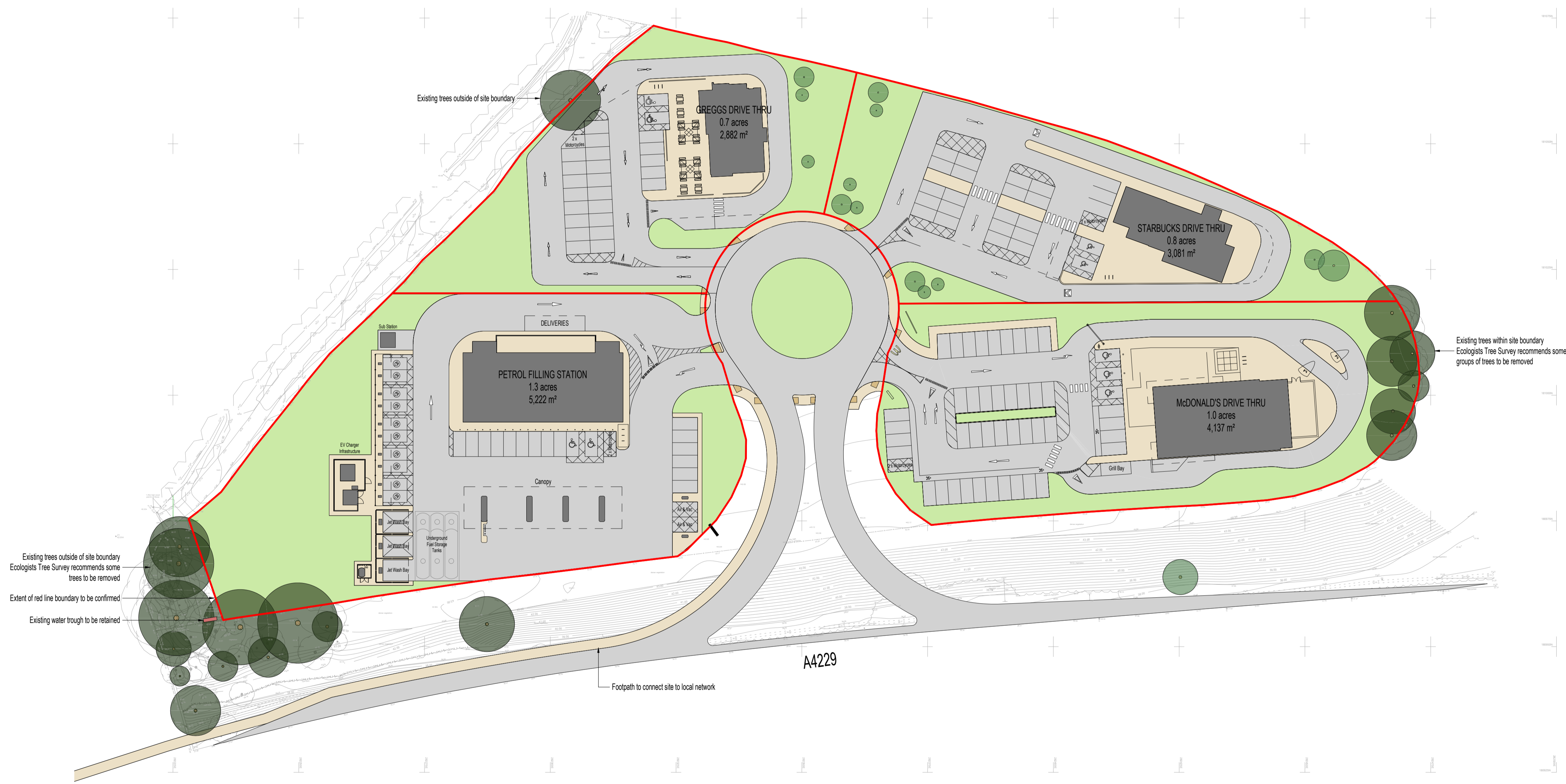

P8	Sib Station added RE MWR MWR	24/01/2024
P7	Kerb lines and footway to McDonald's site entrance amended as per Transport Planners comments RE MWR MWR	27/11/2023
P6	Merge and diverge lanes added RE MWR MWR	13/11/2023
P5	Parking provision for Greggs and Starbucks amended in line with Transport Planners comments. Footway width reduced to 2 meters RE MWR MWR	10/11/2023
P4	Footpath / Cycleway added. Footpath added around roundabout. Footpath between McDonald's and Starbucks omitted RE MWR MWR	06/11/2023
P3	Site amendments to suit Highway Engineers comments. Revisions Clouded RE MWR MWR	28/09/2023
P2	Filling Station Layout updated LF RE MWR	24/07/2023
P1	Issue of coordination LF RE MWR	12/07/2023
P0	First Issue. Issued for Client and Design Team review RE MWR MWR	13/04/2023

REV	DESCRIPTION DRAWN BY CHECKED BY APPROVED BY	DATE
RIBA PLAN OF WORK WORKSTAGE		LEVEL OF MODEL DEFINITION (LOD)
Stage 3 - Spatial Coordination		LOD 3 - Approximate Model

PURPOSE OF ISSUE - SUITABLE FOR... STATUS or SUITABILITY
 Design Intent Only Status S1 - Delivery Team Coordination

01 - Proposed Site Plan
 1 : 500



CARDIFF 029 2052 8140
 LONDON 0207 138 3560
 WREXHAM 01978 357 887
 www.lawray.co.uk
 CLIENT
 Draycott Group

PROJECT TITLE
 Junction 37 Motorway Services

DRAWING TITLE
 Proposed Site Plan

PROJECT No 19804 SCALE @ A1 1:500

DRAWING No	1192	Project	Originator	Volume	Level	Type	Revision	Number
18/11/2023	1980	Project	Originator	Functional	Spatial	Form	Discipline	Number
18/11/2023								

DO NOT SCALE Any discrepancy or query concerning this drawing should be referred to the Architect. Registered Office: Greenmeadow Springs, 1, Cae Gwynedd, Tongwynlais, CARDIFF CF15 7AB Reg. Co. No. 2724118. VAT Reg No. 134 2146 06