

- 1 Fabrico Marker Green Apple (sub - Inktense Green Apple)
- 2 Fabrico Marker Pea Pod (sub - Inktense Felt Green)
- 3 Fabrico Marker Pine (sub - Inktense Beech Green)
- 4 Inktense Sun Yellow or Cadmium Yellow
- 5 Inktense Sienna Gold
- 6 Inktense Tangerine or Cadmium Orange
- 7 Inktense Poppy Red or Hot Rod Red
- 8 Inktense Chili Red
- 9 Inktense Bright Blue, Deep Blue or Fabrico Baby Blue
- 10 Inktense Lagoon, Peacock Blue or Fabrico Cerulean Blue
- 11 Inktense Violet, Deep Violet or Thistle
- 12 Inktense Carmine Pink
- 13 Inktense Fuchsia Or Fabrico Cherry Pink or Lipstick Pink
- 14 Inktense Sherbert Lemon

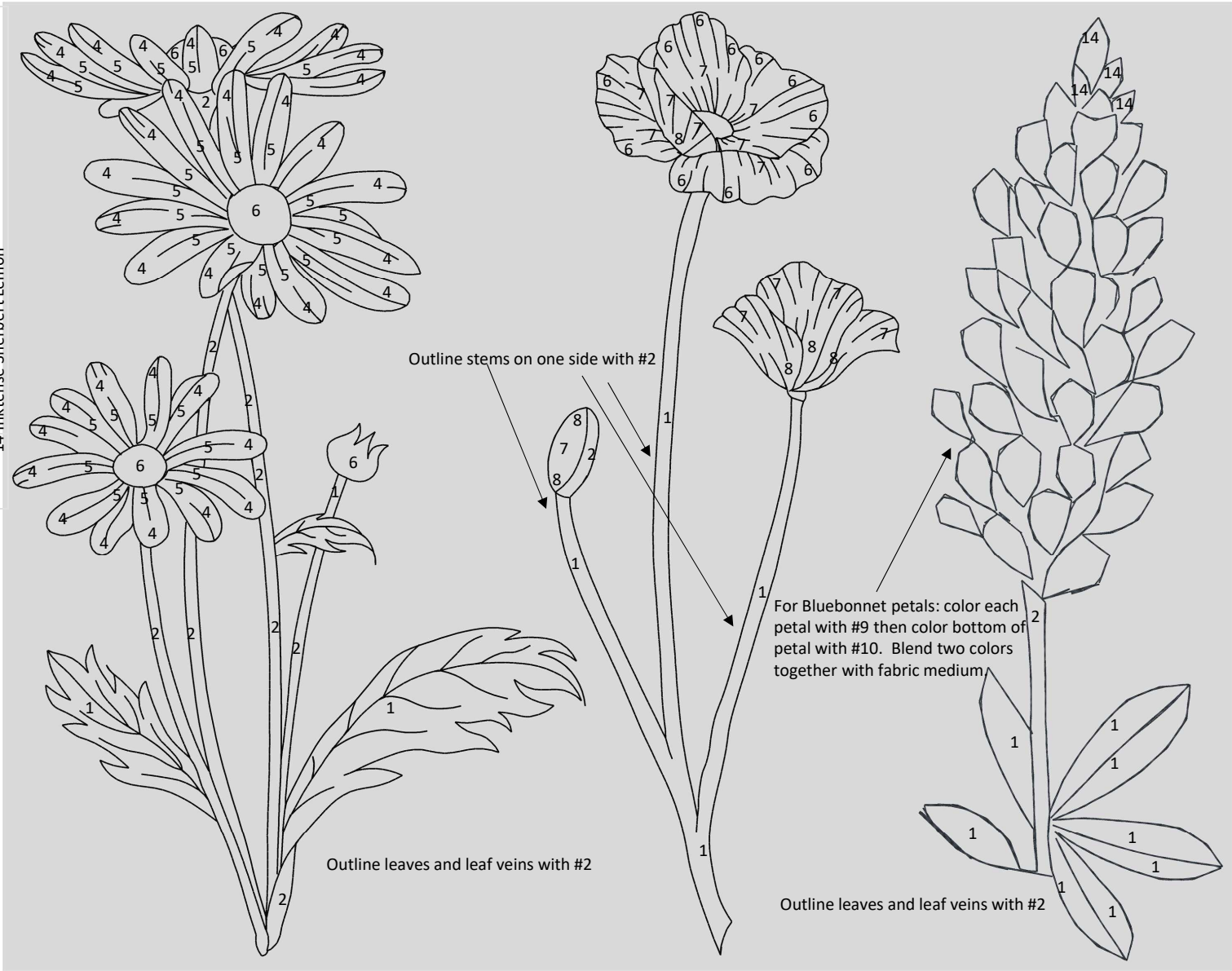

Outline stems on one side with #2

For Bluebonnet petals: color each petal with #9 then color bottom of petal with #10. Blend two colors together with fabric medium

Outline leaves and leaf veins with #2

Outline leaves and leaf veins with #2

- 1 Fabrico Marker Green Apple (sub - Inktense Green Apple)
- 2 Fabrico Marker Pea Pod (sub - Inktense Felt Green)
- 3 Fabrico Marker Pine (sub - Inktense Beech Green)
- 4 Inktense Sun Yellow or Cadmium Yellow
- 5 Inktense Sienna Gold
- 6 Inktense Tangerine or Cadmium Orange
- 7 Inktense Poppy Red or Hot Rod Red
- 8 Inktense Chili Red
- 9 Inktense Bright Blue, Deep Blue or Fabrico Baby Blue
- 10 Inktense Lagoon, Peacock Blue or Fabrico Cerulean Blue
- 11 Inktense Violet, Deep Violet or Thistle
- 12 Inktense Carmine Pink
- 13 Inktense Fuchsia Or Fabrico Cherry Pink or Lipstick Pink
- 14 Inktense Sherbert Lemon

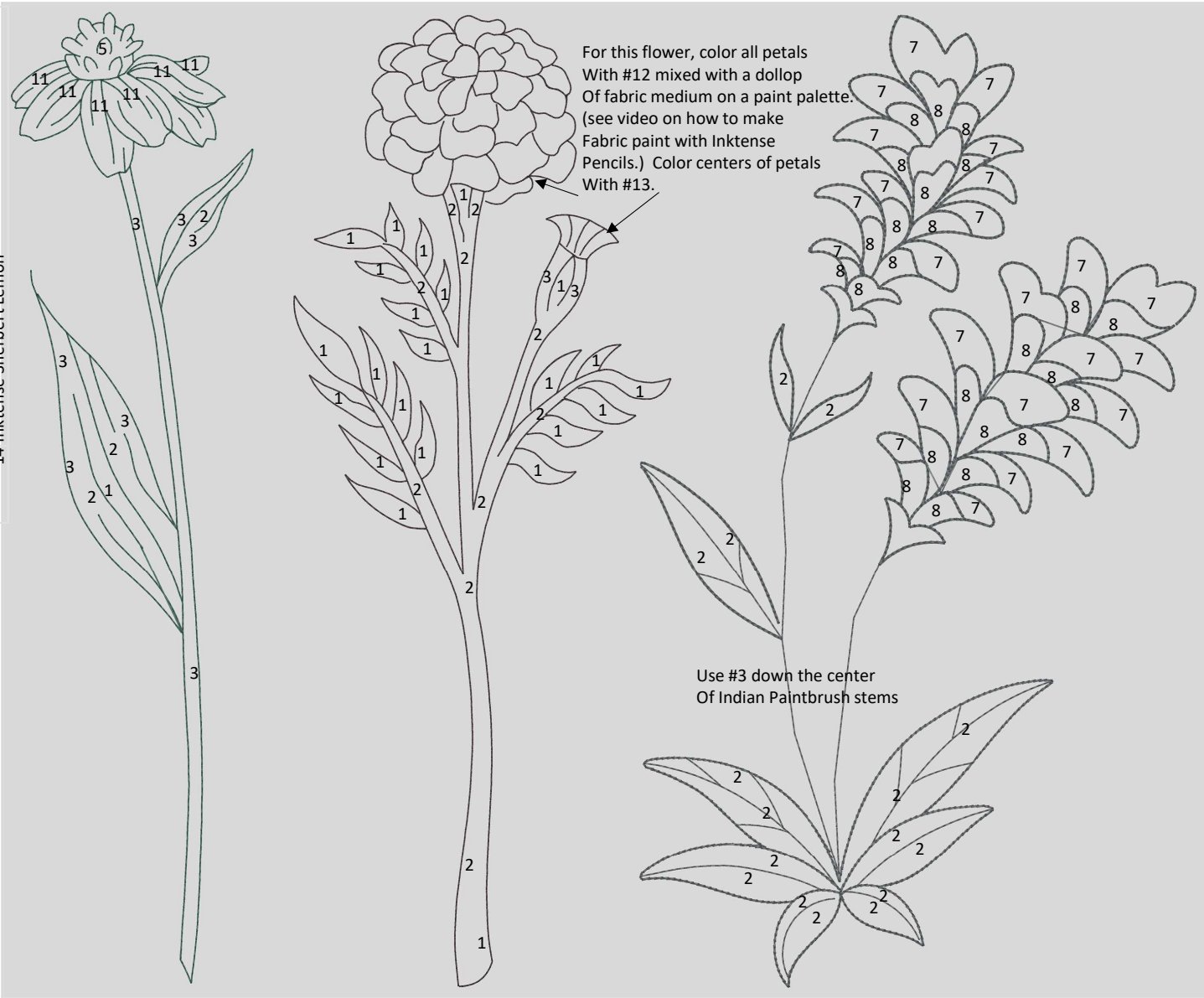

- 1 Fabrico Marker Green Apple (sub - Inktense Green Apple)
- 2 Fabrico Marker Pea Pod (sub - Inktense Felt Green)
- 3 Fabrico Marker Pine (sub - Inktense Beech Green)
- 4 Inktense Sun Yellow or Cadmium Yellow
- 5 Inktense Sienna Gold
- 6 Inktense Tangerine or Cadmium Orange
- 7 Inktense Poppy Red or Hot Rod Red
- 8 Inktense Chili Red
- 9 Inktense Bright Blue, Deep Blue or Fabrico Baby Blue
- 10 Inktense Lagoon, Peacock Blue or Fabrico Cerulean Blue
- 11 Inktense Violet, Deep Violet or Thistle
- 12 Inktense Carmine Pink
- 13 Inktense Fuchsia Or Fabrico Cherry Pink or Lipstick Pink
- 14 Inktense Sherbert Lemon

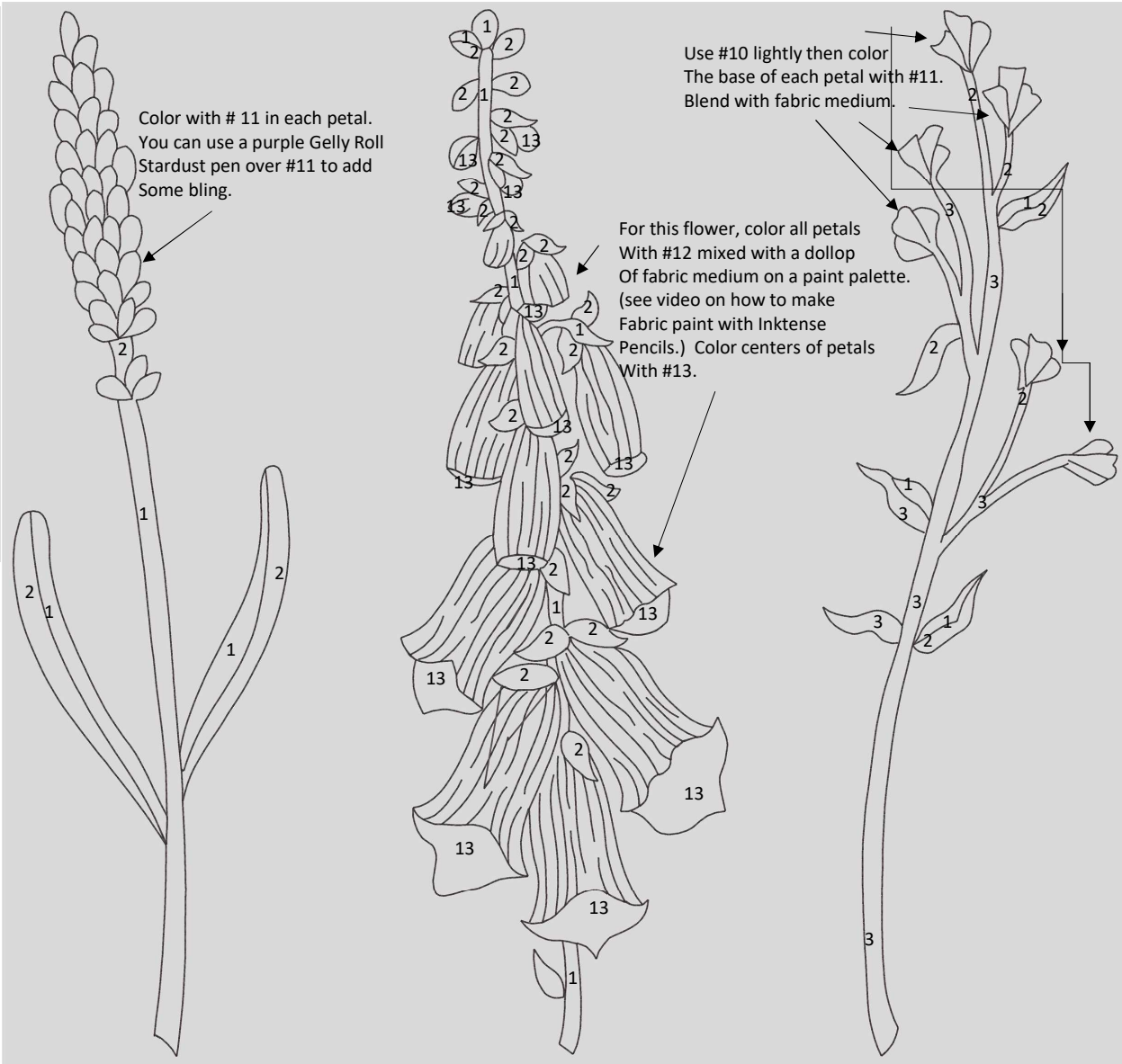

Supplies for Floral Table runner Series - 4 blocks

- 1 Fabrico Marker Green Apple (sub - Inktense Green Apple)
- 2 Fabrico Marker Pea Pod (sub - Inktense Felt Green)
- 3 Fabrico Marker Pine (sub - Inktense Beech Green)
- 4 Inktense Sun Yellow or Cadmium Yellow
- 5 Inktense Sienna Gold
- 6 Inktense Tangerine or Cadmium Orange
- 7 Inktense Poppy Red or Hot Rod Red
- 8 Inktense Chili Red
- 9 Inktense Bright Blue, Deep Blue or Fabrico Baby Blue
- 10 Inktense Lagoon, Peacock Blue or Fabrico Cerulean Blue
- 11 Inktense Violet, Deep Violet or Thistle
- 12 Inktense Carmine Pink
- 13 Inktense Fuchsia Or Fabrico Cherry Pink or Lipstick Pink
- 14 Inktense Sherbert Lemon

