

CREATE VALUE FOR CUSTOMERS

# PRODUCT CATALOGUE

JIATAI LASER PRODUCT CATALOGUE



Jt@cn-laser.com  
Jt-intl@cn-laser.com

**Zhejiang Jiatai Laser Science and Technology Co., Ltd.**

No. 467, Jinhai 3rd Road, Binhai Economic and  
Technological Development Zone, Wenzhou City

**JIATAI LASER INTELLIGENT EQUIPMENT (SUQIAN) CO., LTD.**

Building No. 2, Kechuang South Road, Suqian City, Jiangsu Province

**JIATAI LASER JINAN FOREIGN TRADE OFFICE**

Room 505, Building 5, A3 Area, Hanyu Jingu, Jinan City

**JIASHENG LASER INTELLIGENT EQUIPMENT (JIANGSU) CO., LTD.**

Phase IV of Optoelectronic Complex, Sucheng Economic Development  
Zone, Suqian City, Jiangsu Province





# GLOBAL SERVICE NETWORK



**45000<sup>+</sup>**  
Machines

**350<sup>+</sup>**  
Service centers

MAKE THE DREAM GREATER MAKE THE FAITH NOBLER





Zhejiang Jiatai Laser Science and Technology Co., Ltd. was established in 2002 and is headquartered in Jinhai Park, Wenzhou Economic and Technological Development Zone, Zhejiang, located on the beautiful coast of the East China Sea, covering an area of 30 mu (Chinese acre); Jiangsu Suqian large-scale laser equipment industry chain intelligent manufacturing park covers an area of 280 mu, with a total area of more than 200,000 square meters. In addition, Jiatai has domestic Wuhan Research Institute, Jinan Foreign Trade Office, overseas Turkish and Bulgarian and other branches, and Jiatai is one of the large and powerful laser equipment manufacturers in China.

# Content

## J I A T A I L A S E R

- 01**  
Laser Cutting MachineThor  
K/Y Series
- 03**  
Laser Cutting Machine  
E Series
- 05**  
Laser Cutting Machine Storm  
Z Series
- 07**  
Laser Cutting Machine  
XP Series
- 09**  
Laser Cutting Machine  
XDP Series
- 11**  
Laser Cutting Machine  
XL Series
- 13**  
Laser Cutting Machine Storm  
XZ Series
- 15**  
Laser Pipe Cutting Machine Heavy  
Duty Series (Four Chucks)
- 17**  
Laser Pipe Cutting Machine  
A Series
- 19**  
Plate and Pipe Integrated Laser  
Cutting Machine Series
- 21**  
Three Dimensional Five-axes Laser  
Cutting Machine

- 02**  
Laser Cutting Machine  
C Series
- 04**  
Laser Cutting Machine  
Q Series
- 06**  
Laser Cutting Machine  
A Series
- 08**  
Laser Cutting Machine  
CP Series
- 10**  
Laser Cutting Machine  
XD Series
- 12**  
Laser Cutting Machine  
XQ Series
- 14**  
Laser Cutting Machine  
XA Series
- 16**  
Laser Pipe Cutting Machine Heavy  
Duty Series (Three Chucks)
- 18**  
Laser tube cutter BV series
- 20**  
3D Five-axis H-shape Steel Laser  
Cutting Equipment
- 22**  
Laser Cutting Automatic  
Production Line





# Laser Cutting Machine Thor K/Y Series



- Intelligent process system, one-button operation, equipped with a number of intelligent functions, improve processing efficiency.
- Hollow machine bed with plate welding structure, can be equipped with high-power laser source.
- It has better dynamic performance and better machining accuracy.
- Hydraulic lifting system, table load is larger, and material loading is more convenient.
- Partition dust removal system, safe and zero pollution.

Model Number	JTLC3015K	JTLC4020K	JTLC4025K	JTLC6025K /JTLC6025Y	JTLC8025K/JTLC8025Y
Processing Area	3050*1530mm	4050*2050mm	4050*2550mm	6020*2550mm	8020*2550mm
Laser Power	10KW-40KW (Optional)	10KW-40KW (Optional)	10KW-40KW (Optional)	10KW-40KW (Optional)	10KW-40KW (Optional)
X/Y Axis Maximum Positioning Speed	X:135m/min	X:135m/min	X:135m/min	X:135m/min	X:135m/min
	Y:123m/min	Y:123m/min	Y:123m/min	Y:123m/min	Y:123m/min
X/Y Axis Positioning Accuracy	±0.03mm/m	±0.03mm/m	±0.03mm/m	±0.03mm/m	±0.03mm/m
X/Y Axis Repeated Positioning Accuracy	±0.025mm	±0.025mm	±0.025mm	±0.025mm	±0.025mm
Max. Acceleration	2.5G	2.5G	2.5G	2.5G	2.5G
Hydraulic Lifting Table	Optional	Optional	Optional	Optional	Optional

Machines customization may cause parameters different from above.



# Laser Cutting Machine C Series



- High-power machine with large load
- Gantry dual-drive structure, fast speed and high precision
- Customized control system with intelligent cutting application functions.
- Equipped with a zoned dust removal system.

Model Number	JTLC3015	JTLC4020	JTLC6025	JTLC8025
Processing Area	3050*1530mm	4050*2050mm	6100*2550mm	8100*2550mm
Laser Power	6KW-40KW (Optional)	6KW-40KW (Optional)	6KW-40KW (Optional)	6KW-40KW (Optional)
X/Y Axis Maximum Positioning Speed	X:117m/min	X:117m/min	X:117m/min	X:117m/min
	Y:138m/min	Y:138m/min	Y:138m/min	Y:138m/min
X/Y Axis Positioning Accuracy	±0.03mm/m	±0.03mm/m	±0.03mm/m	±0.03mm/m
X/Y Axis Repeated Positioning Accuracy	±0.025mm	±0.025mm	±0.025mm	±0.025mm
Max. Acceleration	2.0G	2.0G	2.0G	2.0G

Machines customization may cause parameters different from above.





# Laser Cutting Machine E Series

▶▶▶▶

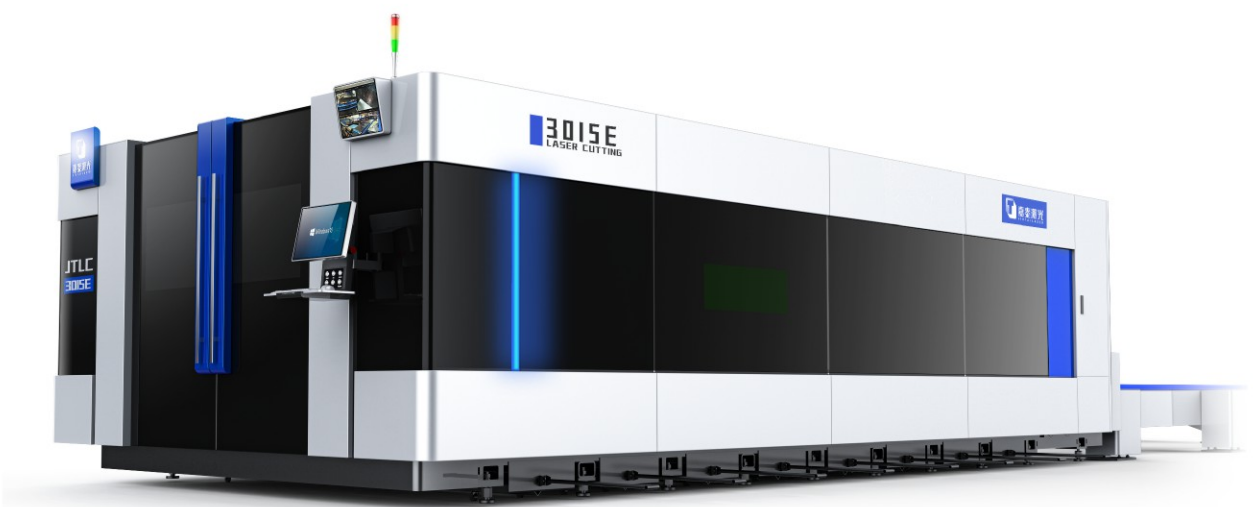

- Intelligent, high-speed, high-precision fiber laser cutting machine
- Compact design and can be loaded into containers, convenient for transportation.
- Hollow machine bed with plate welding structure, can be equipped with high-power laser source.
- Low operating costs and simple maintenance

Model Number	JTLC3015
Processing Area	3050mm*1530mm
Laser Power	≤40KW (Optional)
X/Y Axis Maximum Positioning Speed	X:117m/min
	Y:138m/min
X/Y Axis Positioning Accuracy	±0.03mm/m
X/Y Axis Repeated Positioning Accuracy	±0.03mm
Max. Acceleration	2.0G

Machines customization may cause parameters different from above.



# Laser Cutting Machine Q Series

▶▶▶▶

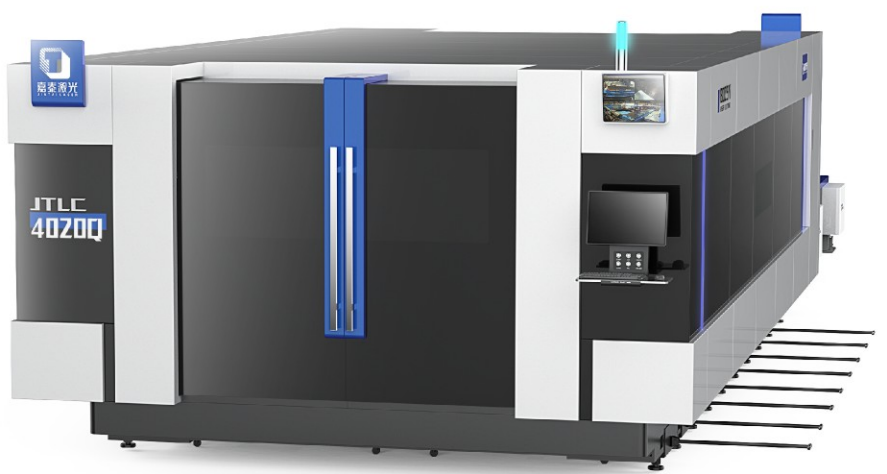

- Industry-specific series, cost-effective!
- Stable performance, easy to learn.
- Integrated design and occupies a small area!
- Low operating costs and easy maintenance!

Model Number	JTLC3015	JTLC4020	JTLC6025	JTLC8025	JTLC10025	JTLC12025	JTLC12526	JTLC13030
Processing Area	3050*1530mm	4050*2050mm	6100*2550mm	8100*2550mm	10100*2550mm	12100*2550mm	12500*2600mm	13100*3050mm
Laser Power	6KW-20KW (Optional)	6KW-20KW (Optional)	6KW-30KW (Optional)	6KW-30KW (Optional)	6KW-30KW (Optional)	6KW-30KW (Optional)	6KW-30KW (Optional)	6KW-30KW (Optional)
X/Y Axis Maximum Positioning Speed	X:117m/min	X:117m/min	X:117m/min	X:117m/min	X:117m/min	X:117m/min	X:117m/min	X:117m/min
	Y:138m/min	Y:138m/min	Y:138m/min	Y:138m/min	Y:138m/min	Y:138m/min	Y:138m/min	Y:138m/min
X/Y Axis Positioning Accuracy	±0.05mm/m	±0.05mm/m	±0.05mm/m	±0.05mm/m	±0.05mm/m	±0.05mm/m	±0.05mm/m	±0.05mm/m
X/Y Axis Repeated Positioning Accuracy	±0.05mm	±0.05mm	±0.05mm	±0.05mm	±0.05mm	±0.05mm	±0.05mm	±0.05mm
Max. Acceleration	2.0G	2.0G	2.0G	2.0G	2.0G	2.0G	2.0G	2.0G

Machines customization may cause parameters different from above.





# Laser Cutting Machine Storm Z Series



- The ultimate personalized product design, superior equipment performance!
- Professional operating system, easy to learn.
- Integrated design and occupies a small area!
- Low operating costs and easy maintenance.

Model Number	JTLC3015	JTLC4020	JTLC6025
Processing Area	3050*1530mm	4050*2050mm	6100*2550mm
Laser Power	1.5KW-6KW (Optional)	1.5KW-6KW (Optional)	1.5KW-6KW (Optional)
X/Y Axis Maximum Positioning Speed	X:74m/min	X:74m/min	X:74m/min
	Y:74m/min	Y:74m/min	Y:74m/min
X/Y Axis Positioning Accuracy	±0.05mm/m	±0.05mm/m	±0.05mm/m
X/Y Axis Repeated Positioning Accuracy	±0.05mm	±0.05mm	±0.05mm
Max. Acceleration	1.4G	1.4G	1.4G

Machines customization may cause parameters different from above.



# Laser Cutting Machine A Series

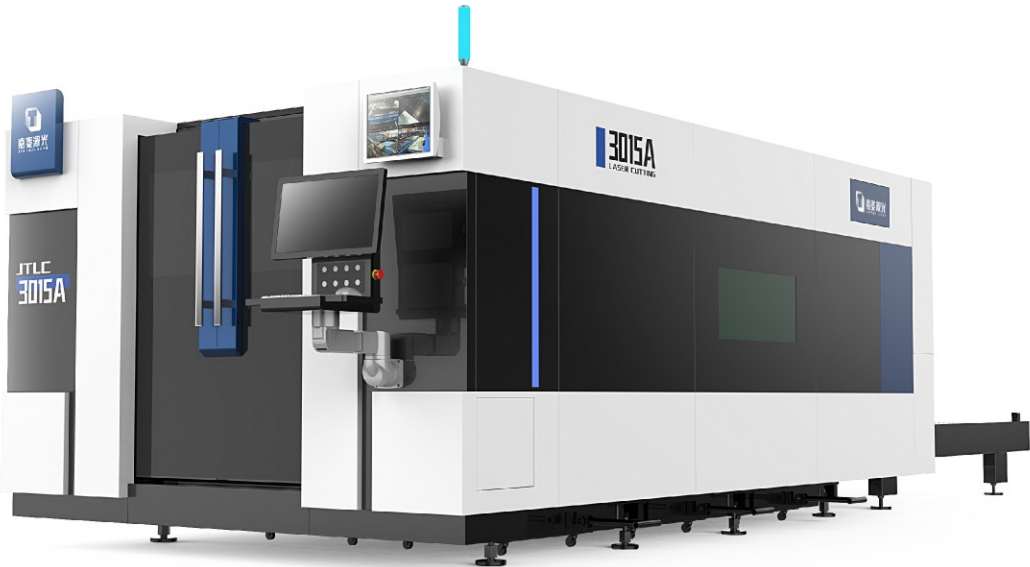

- Focus on thin plate cutting, fast speed and high precision.
- Compact design and can be loaded into containers, convenient for transportation.
- The machine is equipped with a new transmission structure with better dynamic performance.
- Aluminum beam structure, light weight and good rigidity.
- The table surface can be exchanged to improve processing efficiency.

Model Number	JTLC3015	JTLC4020
Processing Area	3050mm*1530mm	4050mm*2050mm
Laser Power	1.5KW-6KW(Optional)	1.5KW-6KW(Optional)
X/Y Axis Maximum Positioning Speed	X:111m/min	X:111m/min
	Y:111m/min	Y:111m/min
X/Y Axis Positioning Accuracy	±0.05mm/m	±0.05mm/m
X/Y Axis Repeated Positioning Accuracy	±0.05mm	±0.05mm
Max. Acceleration	1.2G	1.2G

Machines customization may cause parameters different from above.





# Laser Cutting Machine XP Series



- High-power open platform structure
- A bevel cutting function can be equipped, can realize the application of V, I, X, Y, K, gradient and other bevels, realize visual calibration, and automatically correct errors.
- Perpendicularity compensation can be realized according to the plate placement and cutting.
- Intelligent process system, one-button operation, equipped with various intelligent functions, improve processing efficiency.
- Integrated design, simple and convenient to install!

Model Number	JTLC12030	JTLC14030	JTLC14035
Processing Area	12000*3050mm	14000*3050mm	14000*3550mm
Bevel cutting format	11000*1650mm	13000*1650mm	13000*2150mm
Laser Power	6KW-60KW (Optional)	6KW-60KW (Optional)	6KW-60KW (Optional)
X/Y Axis Maximum Positioning Speed	X:117m/min	X:117m/min	X:117m/min
	Y:95m/min	Y:95m/min	Y:95m/min
X/Y Axis Positioning Accuracy	±0.05mm/m	±0.05mm/m	±0.05mm/m
X/Y Axis Repeated Positioning Accuracy	±0.05mm	±0.05mm	±0.05mm
B5 axis positioning accuracy	±0.1°	±0.1°	±0.1°
Max. Acceleration	1.4G	1.4G	1.4G

Machines customization may cause parameters different from above.



# Laser Cutting Machine CP Series



- High-power machine with large load
- Gantry dual-drive structure, fast speed and high precision
- Customized control system with intelligent cutting application functions.
- Equipped with a zoned dust removal system.
- A bevel cutting function can be equipped.

Model Number	JTLC6025	JTLC8025
Processing Area	5700mm*2500mm	7700mm*2500mm
Bevel cutting format	5000mm*1100mm	7000mm*1100mm
Laser Power	6KW-40KW (Optional)	6KW-40KW (Optional)
X/Y Axis Maximum Positioning Speed	X: 80m/min	X: 80m/min
	Y: 80m/min	Y: 80m/min
X/Y Axis Positioning Accuracy	±0.03mm/m	±0.03mm/m
X/Y Axis Repeated Positioning Accuracy	±0.025mm	±0.025mm
Max. Acceleration	1.2G	1.2G

Machines customization may cause parameters different from above.





# Laser Cutting Machine XDP Series



- The modular bed structure design can freely customize the cutting format according to the needs.
- The platform and bed are separated from the structure design so the loading capacity is larger.
- The beam is equipped with an adaptive adjustment mechanism, an independent dust removal module, and an intelligent cutting system and intelligent cutting head.
- It supports bevel cutting, and can realize V, I, X, Y, K, gradient and other bevel applications, can realize visual calibration, and automatically correct errors.
- The machines can be disassembled and fit into 40HC containers.

Model Number	JTLC14030	JTLC26030	Others
Processing Area	14500mm*3080mm	26500mm*3080mm	The processing format can be customized
Bevel cutting format	13200mm*2200mm	25200mm*2200mm	It varies according to the processing format
Laser Power	6KW-60KW (Optional)	6KW-60KW (Optional)	6KW-60KW (Optional)
X/Y Axis Maximum Positioning Speed	X:90m/min	X:90m/min	X:90m/min
	Y:105m/min	Y:105m/min	Y:105m/min
X/Y Axis Positioning Accuracy	X:±0.03mm/m Y:±0.05mm/m	X:±0.03mm/m Y:±0.05mm/m	X:±0.03mm/m Y:±0.05mm/m
X/Y Axis Repeated Positioning Accuracy	±0.05mm	±0.05mm	±0.05mm
Max. Acceleration	X:1.0G Y:0.75G	X:1.0G Y:0.75G	X:1.0G Y:0.75G

Machines customization may cause parameters different from above.



# Laser Cutting Machine XD Series



- The modular bed structure design can freely customize the cutting format according to the needs.
- The platform and bed are separated from the structure design so the loading capacity is larger.
- The beam is equipped with an adaptive adjustment mechanism, an independent dust removal module, and an intelligent cutting system and intelligent cutting head.
- Supports ultra-high power up to 120KW.
- The machines can be disassembled and fit into 40HC containers.

Model Number	JTLC26030	Others
Processing Area	26500*3100mm	The processing format can be customized
Laser Power	6KW-120KW (Optional)	6KW-120KW (Optional)
X/Y Axis Maximum Positioning Speed	X:131m/min	X:131m/min
	Y:105m/min	Y:105m/min
X/Y Axis Positioning Accuracy	X:±0.05mm/10m Y:±0.05mm/10m	X:±0.05mm/10m Y:±0.05mm/10m
X/Y Axis Repeated Positioning Accuracy	X:±0.05mm Y:±0.06mm	X:±0.05mm Y:±0.06mm
Max. Acceleration	X:1.2G Y:0.8G	X:1.2G Y:0.8G

Machines customization may cause parameters different from above.





# Laser Cutting Machine XL Series



- High-power open platform structure.
- Equipped with intelligent control system and intelligent function application to improve processing efficiency.
- Professional operating system, easy to learn.
- Integrated design, simple and convenient to install!
- Low operating costs and easy maintenance!

Model Number	JTLC6025	JTLC8025	JTLC10025	JTLC12025	JTLC12030	JTLC14030	JTLC14035
Processing Area	6100*2580mm	8100*2580mm	10100*2580mm	12100*2580mm	12100*3080mm	14100*3080mm	14100*3580mm
Laser Power	6KW-120KW (Optional)	6KW-120KW (Optional)	6KW-120KW (Optional)	6KW-120KW (Optional)	6KW-120KW (Optional)	6KW-120KW (Optional)	6KW-120KW (Optional)
X/Y Axis Maximum Positioning Speed	X:117m/min	X:117m/min	X:117m/min	X:117m/min	X:117m/min	X:117m/min	X:117m/min
	Y:95m/min	Y:95m/min	Y:95m/min	Y:95m/min	Y:95m/min	Y:95m/min	Y:95m/min
X/Y Axis Positioning Accuracy	±0.03mm/m	±0.03mm/m	±0.03mm/m	±0.03mm/m	±0.03mm/m	±0.03mm/m	±0.03mm/m
X/Y Axis Repeated Positioning Accuracy	±0.03mm	±0.03mm	±0.03mm	±0.03mm	±0.03mm	±0.03mm	±0.03mm
B5 axis positioning accuracy	±0.1°	±0.1°	±0.1°	±0.1°	±0.1°	±0.1°	±0.1°
Max. Acceleration	1.4G	1.4G	1.4G	1.4G	1.4G	1.4G	1.4G

Machines customization may cause parameters different from above.



# Laser Cutting Machine XQ Series



- Open platform structure, extremely cost-effective!
- The performance is stable and the operation is simple and easy to learn.
- Integrated design and occupies a small area!
- Low operating costs and easy maintenance!

Model Number	JTLC3015	JTLC4015	JTLC4020	JTLC6020	JTLC6025	JTLC8025
Processing Area	3050*1530mm	4050*1530mm	4050*2030mm	6100*2030mm	6100*2030mm	8100*2030mm
Laser Power	≤12KW	≤12KW	≤12KW	≤12KW	≤12KW	≤12KW
X/Y Axis Maximum Positioning Speed	X:74m/min	X:74m/min	X:74m/min	X:74m/min	X:74m/min	X:74m/min
	Y:74m/min	Y:74m/min	Y:74m/min	Y:74m/min	Y:74m/min	Y:74m/min
X/Y Axis Positioning Accuracy	±0.03mm/m	±0.03mm/m	±0.03mm/m	±0.03mm/m	±0.03mm/m	±0.03mm/m
X/Y Axis Repeated Positioning Accuracy	±0.03mm	±0.03mm	±0.03mm	±0.03mm	±0.03mm	±0.03mm
Max. Acceleration	1.4G	1.4G	1.4G	1.4G	1.4G	1.4G

Machines customization may cause parameters different from above.





# Laser Cutting Machine Storm XZ Series



- Open platform structure, extremely cost-effective!
- The performance is stable and the operation is simple and easy to learn.
- Integrated design and occupies a small area!
- Low operating costs and easy maintenance!

Model Number	JTLC3015	JTLC4020	JTLC6025
Processing Area	3020mm*1520mm	4050mm*2050mm	6050mm*2520mm
Laser Power	1.5KW-12KW (Optional)	1.5KW-12KW (Optional)	1.5KW-12KW (Optional)
X/Y Axis Maximum Positioning Speed	X: 111m/min	X: 111m/min	X: 111m/min
	Y: 111m/min	Y: 111m/min	Y: 111m/min
X/Y Axis Positioning Accuracy	±0.03mm/m	±0.03mm/m	±0.03mm/m
X/Y Axis Repeated Positioning Accuracy	±0.03mm	±0.03mm	±0.03mm
Max. Acceleration	1.2G	1.2G	1.2G

Machines customization may cause parameters different from above.



# Laser Cutting Machine XA Series

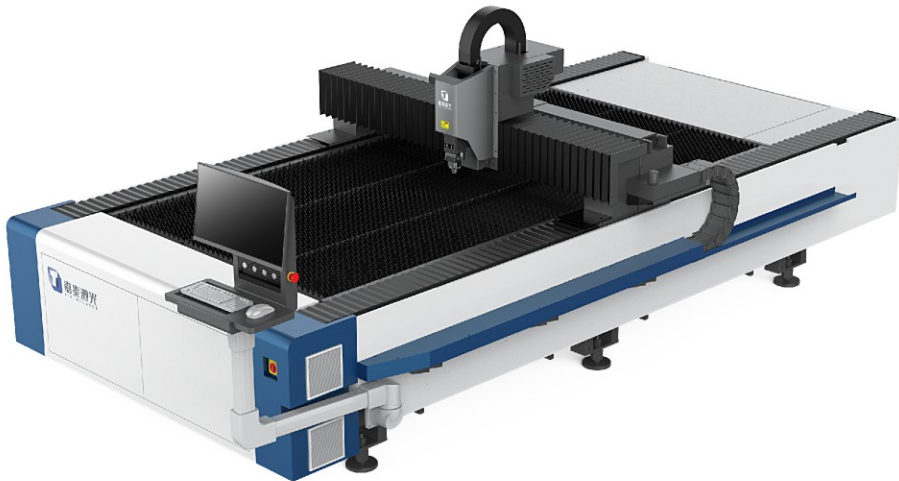

- Focus on thin plate cutting, fast speed and high precision.
- Compact design and can be loaded into containers, convenient for transportation.
- The machine is equipped with a new transmission structure with better dynamic performance.
- Aluminum beam structure, light weight and good rigidity.

Model Number	JTLC3015	JTLC4020
Processing Area	3050mm*1520mm	4050mm*2020mm
Laser Power	1.5KW-6KW	1.5KW-6KW
X/Y Axis Maximum Positioning Speed	X:111m/min	X:111m/min
	Y:111m/min	Y:111m/min
X/Y Axis Positioning Accuracy	±0.05mm/m	±0.05mm/m
X/Y Axis Repeated Positioning Accuracy	±0.05mm	±0.05mm
Max. Acceleration	1.2G	1.2G

Machines customization may cause parameters different from above.





Laser Pipe Cutting Machine Heavy  
Duty Series (Four Chucks)▶▶▶▶



- Four-chuck design, easy clamping of overweight tubes, man-machine loading and unloading separation
- Modular bed structure, strong functional expandability, easy transportation.
- Equipped with semi-automatic loading and unloading as standard, supports automatic pipe centering and material head detection.
- It can realize zero tailings processing, center-seeking and correction, multi-pipe type cutting and other functional applications.
- A bevel cutting function can be equipped.

Model Number	JTLG12052A5	JTLG12052F5
Tube Dimension	Round Tube ø80mm-508mm*12200mm Square Tube 80mm*80mm-350mm*350mm*12200mm	Round Tube ø80mm-508mm*12200mm Square Tube 80mm*80mm-500mm*500mm*12200mm
Laser Power	6KW-20KW (Optional)	6KW-20KW (Optional)
X/Y Axis Maximum Positioning Speed	50m/min	50m/min
X/Y Axis Max. Acceleration	0.5G	0.5G
W-Axis Maximum Speed	50rpm	50rpm
Bevel cutting available or not/ Available	Optional	Optional
Loading Weight	2000KG	2000KG

Machines customization may cause parameters different from above.



Laser Pipe Cutting Machine Heavy  
Duty Series (Three Chucks)▶▶▶▶



- Three-chuck design, easy clamping of overweight tubes, man-machine loading and unloading separation
- Modular bed structure, strong functional expandability, easy transportation.
- Equipped with semi-automatic loading and unloading as standard, supports automatic pipe centering and material head detection.
- It can realize zero tailings processing, center-seeking and correction, multi-pipe type cutting and other functional applications.
- A bevel cutting function can be equipped.

Model Number	JTLG9035	JTLG12035
Tube Dimension	Round Tube: ø30-350mm*9100mm; Square Tube: 30*30-250*250mm*9100mm	Round Tube: ø30-350mm*12000mm; Square Tube: 30*30-250*250mm*12000mm
Laser Power	3KW-12KW (Optional)	3KW-12KW (Optional)
X/Y Axis Maximum Positioning Speed	80m/min	80m/min
Max. Acceleration	0.5G	0.5G
Chuck Construction	Pneumatic chucks	Pneumatic chucks
Number of Chucks	3	3
Chuck Rotation Speed	80r/min	80r/min
Loading Weight	600kg	600kg

Machines customization may cause parameters different from above.





## Laser Pipe Cutting Machine A Series



- Customized medium-sized chuck high-speed, high-precision laser tube cutting machine.
- The high-quality control system supports the diversified processing functions of multiple types of pipes.
- It can be matched with the loading and unloading device of the bundle pipe.

Model Number	JTLG6012	JTLG6022	JTLG6035
Tube Dimension	Round Tube: $\phi 10$ -120mm*6100mm; Square Tube: 10*10-80*80mm*6100mm	Round Tube: $\phi 20$ -220mm*6100mm; Square Tube: 20*20-150*150mm*6100mm	Round Tube: $\phi 30$ -350mm*6100mm; Square Tube: 30*30-250*250mm*6100mm
Laser Power	1.5KW-6KW (Optional)	1.5KW-6KW (Optional)	1.5KW-6KW (Optional)
X/Y Axis Maximum Positioning Speed	107m/min	120m/min	108m/min
X/Y Axis Max. Acceleration	1.0G	1.0G	0.8G
W Axis Maximum Speed	225rpm	160rpm	90rpm
Loading Weight	50kg	200kg	600kg

Machines customization may cause parameters different from above.



## Laser tube cutter BV series

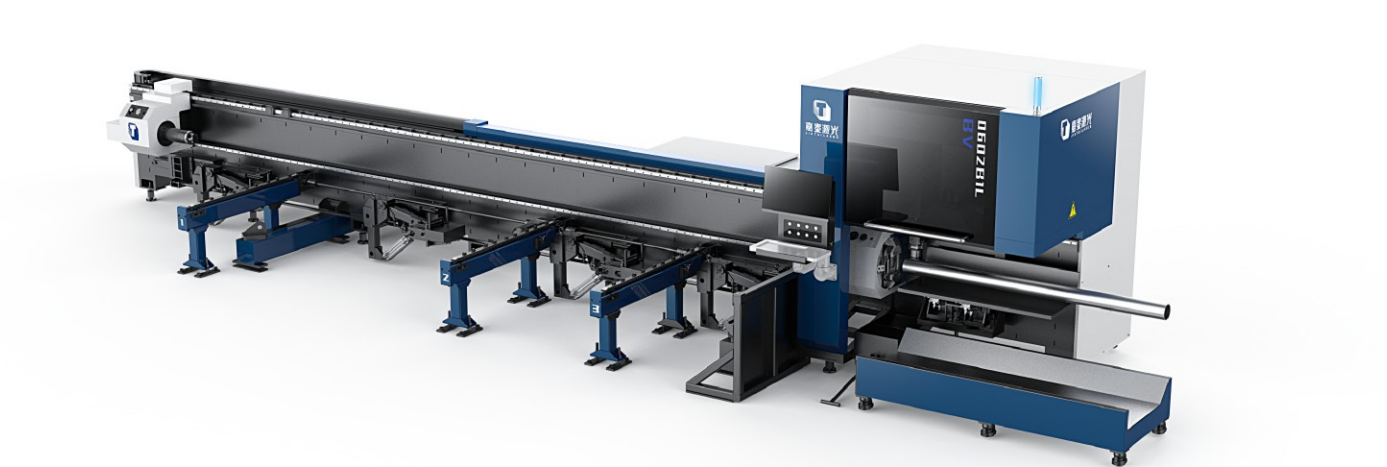

- Side-hanging structure, with the offside cutting function
- Compatible with all kinds of tube cutting, including square tube, elliptical tube and other tubes.
- For the thin tube processing optimization, the speed is significantly improved.
- Equipped with semi-automatic feeding table, servo tracking, and pneumatic support function.
- Special chucks for BV series laser cutting tube with the rear chuck in place detection device, effectively avoid empty clamping after automatic loading.(optional)

Model Number	JTBV060212	JTBV060224	JTBV060236
Tube processing diameter	Round tube: $\phi 10$ - $\phi 120$ mm Max. rectangular tube: 50 * 100mm Square tube: $\square 10$ - $\square 80$ mm	Round tube: $\phi 10$ - $\phi 230$ mm Maximum square tube: 230 * 230mm The outer circle is less than: $\phi 230$ mm I-shaped steel / channel steel: #20 maximum	Round tube: $\phi 20$ - $\phi 360$ mm Maximum square tube: 360 * 360mm The outer circle is less than: $\phi 360$ mm I-steel / channel steel: #32 maximum
Laser power	3KW、6KW	3KW、6KW	3KW
X-axis maximum positioning speed	132m/min	110m/min	70m/min
Maximum Y-axis positioning speed	132m/min	132m/min	90m/min
X / Y axis maximum acceleration	1.5G	1.0G	1.0G
W-axis maximum rotation speed	100rpm	100rpm	60rpm
Single maximum weight	120kg	260kg	800kg

Machines customization may cause parameters different from above.





## Plate and Pipe Integrated Laser Cutting Machine Series

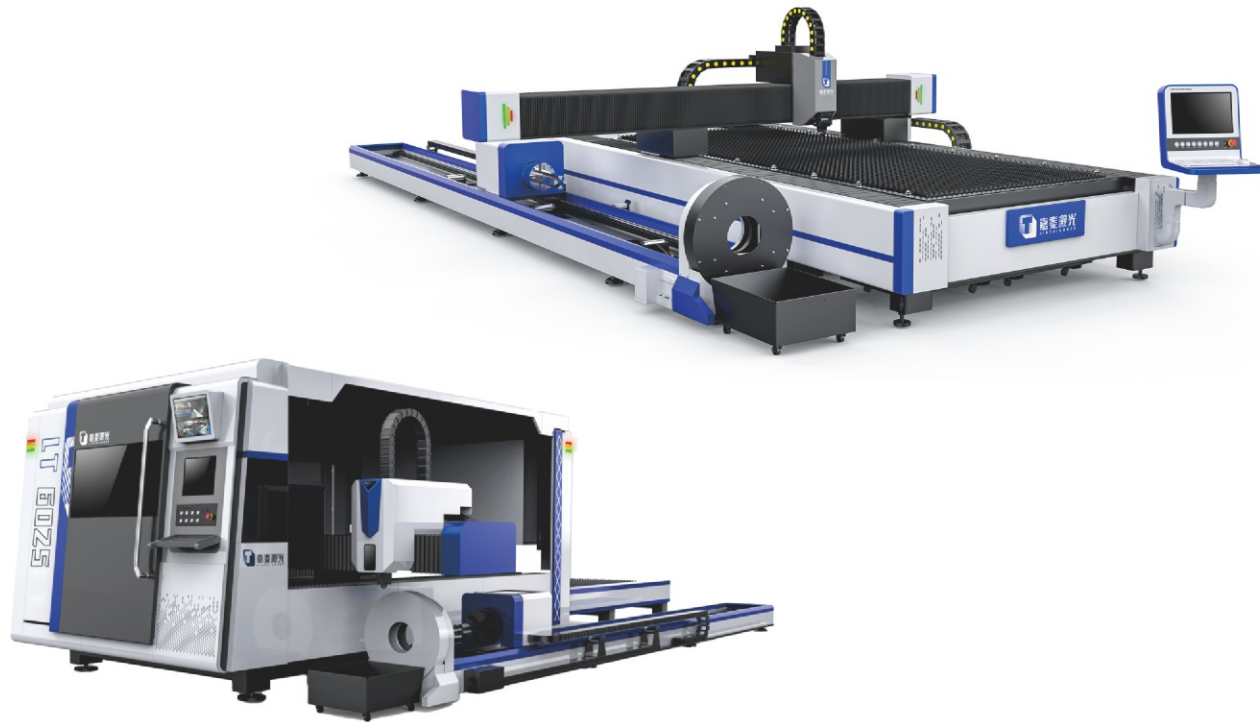

- Tube and sheet dual-purpose, small footprint.
- Plane and tube cutting dual system switching, flexible processing, easy operation.
- Stable performance, simple operation and easy to learn
- Low operating costs and easy maintenance!

Model Number	JTLT3015		JTLT4020		JTLT6025	
	Plane Cutting Parameters	Tube Cutting Parameters	Plane Cutting Parameters	Tube Cutting Parameters	Plane Cutting Parameters	Tube Cutting Parameters
Processing Area	3050*1530mm	Round Tube Φ20-Φ220*6100mm Square Tube □20-□150*6100mm	4000*2550mm	Round Tube Φ20-Φ220*6100mm Square Tube □20-□150*6100mm	6100*2550mm	Round Tube Φ20-Φ220*6100mm Square Tube □20-□150*6100mm
Laser Power	1.5KW-6KW (Optional)		1.5KW-12KW (Optional)		1.5KW-12KW (Optional)	
X Axis Travel	1500mm	350mm	2000mm	350mm	2500mm	350mm
Y Axis Travel	3000mm	6100mm	4000mm	6100mm	6000mm	6100mm
X/Y Axis Maximum Positioning Speed	X:88m/min Y:74m/min	50m/min	X:88m/min Y:74m/min	50m/min	X:88m/min Y:74m/min	50m/min
X/Y Axis Positioning Accuracy	±0.05mm/m	/	±0.05mm/m	/	±0.05mm/m	/
X/Y Axis Repeated Positioning Accuracy	±0.05mm	/	±0.05mm	/	±0.05mm	/
Max. Acceleration	0.5G		0.5G		0.5G	

Machines customization may cause parameters different from above.



## 3D Five-axis H-shape Steel Laser Cutting Equipment

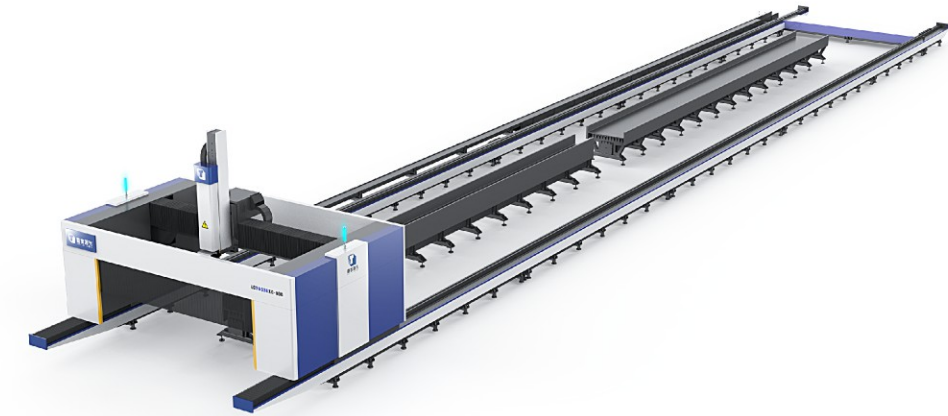

- Gantry enclosing structure, double worktable switching, multi-scene processing can be applied.
- BCW contour scanning, real-time compensation for deformation areas.
- Professional nesting software, simple operation, high nesting utilization, compatible with Tekla software.
- RTCP visual calibration, high precision, short time-consuming.

Model Number	LC26030XC
Working Area	Width H≤1200mm (Optional)
	Height B≤600mm (Optional)
	Length L≤12500mm
Laser Power	12KW、20KW
X/Y/Z Axis Travel	3000mm/26000mm/1200mm
A-axis (Rotary Axis)	±50°
B-axis (Rotary Axis)	±100°
X/Y Axis Positioning Accuracy	±0.06mm/m
X/Y Axis Repeated Positioning Accuracy	±0.05mm
X/Y Axis Maximum Positioning Speed	50m/min
X/Y Axis Max. Acceleration	0.5G

Machines customization may cause parameters different from above.





# Three Dimensional Five-axes Laser Cutting Machine



- A full range of RTCP laser point space control, including a variety of different mechanical structure types of five-axis linkage data models.
- The expert database system only needs to enter the cutting thickness and material, and the cutting parameters can be automatically generated.
- The machine tool has a fault self-diagnosis function to quickly find faults.
- It supports automatic cutting of a variety of corners.

Model Number	JT cell 3015	JT cell 4020
Working Area	3000mm*1500mm	4000mm*2000mm
Maximum Three-dimensional Cutting Range	3000*1500*620mm	4000mm*2000mm*620mm
Laser Power	3KW-6KW (Optional)	3KW-6KW (Optional)
X/Y/Z/C/B/W Axis Travel	3010mm/ 1510mm/ 625mm/ Unlimited Spins/ ±135°/ ±12mm	4020mm/2020mm/625mm/ Unlimited Spins/±135°/±12mm
X/Y/Z Axis Positioning Accuracy	±0.05mm/m	±0.05mm/m
X/Y/Z Axis Repeated Positioning Accuracy	±0.05mm	±0.05mm
X/Y/Z Axis Maximum Positioning Speed	Single axis: 100m/min Linkage: 156m/min	Single axis: 100m/min Linkage: 156m/min
Max. Acceleration	1.0G	1.2G

Machines customization may cause parameters different from above.



# Laser Cutting Automatic Production Line

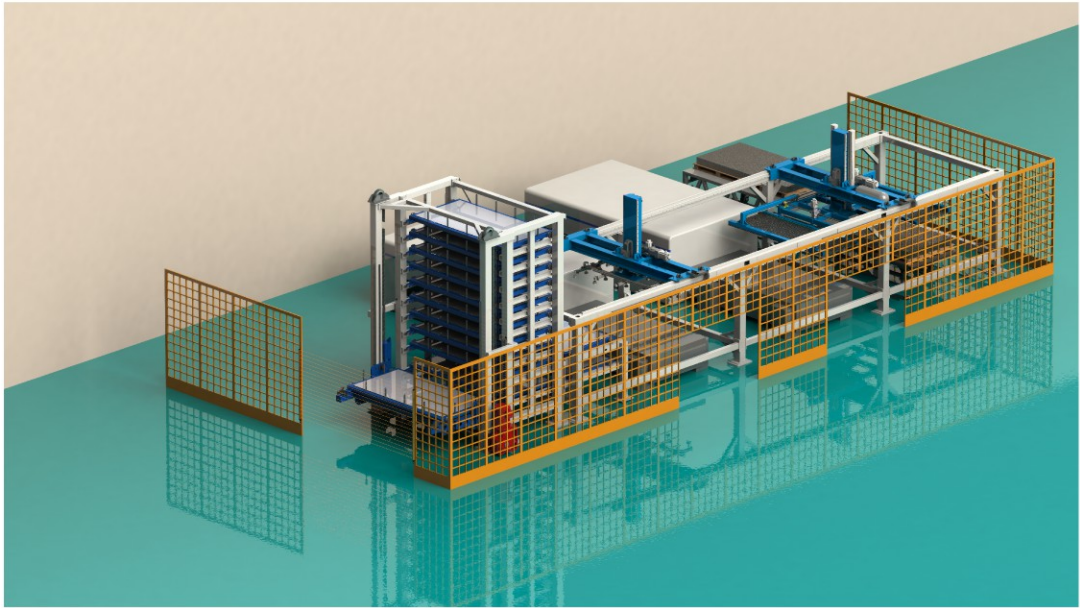

- Interfacing host computer information to achieve fully automated production.
- Improve production efficiency and reduce production costs.
- It can be matched with one library and multiple machines to improve product utilization.
- Intelligent management can be realized, and unattended functions can be realized.

Model Number	Jtlc4020yts Magazine Parameters	Model Number	Jtlc4020yts Loading and Unloading Parameters
Handle Sheet Size	Min: 1200*1200mm	Maximum Sheet Size	4000*2000mm
	Max: 4000*2000mm		
Sheet Thickness	1-5mm	Sheet Thickness	1-5mm
Max. Loading Height (Including Pallets)	280mm	Maximum Weight Of A Single Sheet	300kg
Layers	6	Horizontal Maximum Movement Speed	30m/min
Maximum Weight Per Block	3t	Vertical Maximum Movement Speed	15m/min
Feeder Speed	15m/min	Maximum Speed Of The Trolley	10m/min
Discharge Speed	15m/min	The Maximum Load Of The Trolley	3000kg
Lift Speed	15m/min	The Maximum Stacking Height Of The Trolley	400mm (with tray)

Machines customization may cause parameters different from above.

Machines customization may cause parameters different from above.