

**TWO-STAGE SCREW REFRIGERATION COMPRESSOR**

**SRT218 ~ 415 SERIES**

**TWO-STAGE SCREW  
REFRIGERATION COMPRESSOR**

**SRT218 ~ 415 SERIES**

R22 EVAPORATING TEMP.: -25°C~-60°C

R404A EVAPORATING TEMP.: -25°C~-65°C



**FOOD IQF PROCESS**



**MEAT IQF  
AND STORAGE**



**PHARMACEUTICAL  
FREEZING AND DRYING**



**OFFSHORE  
FISHERIES REFRIGERATION**



**LOW TEMPERATURE  
PETROCHEMICAL INDUSTRY**



**FISHERIES  
PROCESSING AND FREEZING**

# COMPRESSOR SPECIFICATIONS

		MODEL	SRT218	SRT314	SRT321	SRT324	SRT413	SRT415
EVAPORATING TEMP.		°C	-60°C~-25°C(R22)/ -65°C~-25°C(R404A/R507)					
FREQUENCY		Hz	50/60					
COMPRESSOR	SPEED	rpm	2950/3550					
	DISP. 1ST STAGE	m³/h	120/144	222/267	320/384	430/516	530/636	630/759
	DISP. 2ND STAGE	m³/h	50/60	106/127	143/172	167/200	210/252	250/300
REFRIGERANT		-	R22、R404A、R507					
MOTOR	POWER SUPPLY	V	380~415/220、380、440、460			380~415/380、440、460		
	STARTING METHOD	-	Y-Δ OR DIRECT-ON-LINE START-UP					
	RATED POWER	kW	25/30	41/50	62/75	83/100	104/125	125/150
HP		33/40	58/70	83/100	108/130	142/170	167/200	
DIMENSION OF SUCTION PORT		Inch(mm)	2-5/8"(67)			4"(105)		
DIMENSION OF DISCHARGE PORT		Inch(mm)	1-5/8"(42)			2-5/8"(67)		3-1/8"(79)
CAPACITY CONTROL		%	50%、100%	STEP CAPACITY CONTROL (25%、50%、100%) OR LINEAR CAPACITY CONTROL (25%~100%)				
LUBRICATION			OIL PRESSURE DIFFERENTIAL					

## OPERATION LIMITS

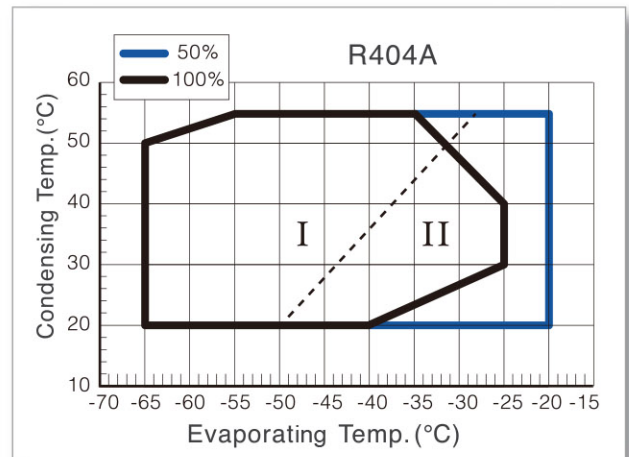
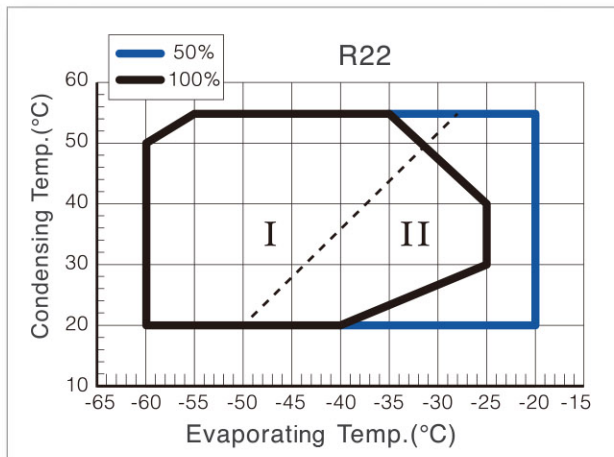

REGION I : NEED TO OPERATE WITH LIQUID INJECTION AND OIL COOLING  
 REGION II : NEED TO OPERATE WITH LIQUID INJECTION OR OIL COOLING(INCLUDING BLUE LINE AREA)

## STRUCTURE

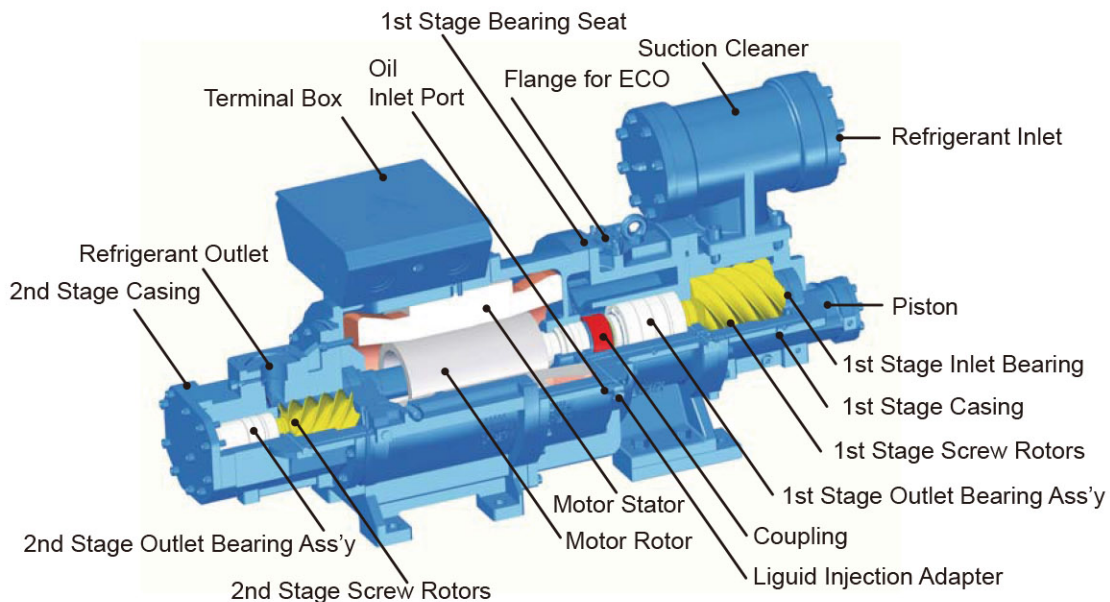

# COMPRESSOR EFFICIENCY COMPARISON

## COP COMPARISON BETWEEN TWO-STAGE AND SINGLE STAGE SCREW COMPRESSORS WITH R404A

CONDENSING TEMPERATURE 40°C	EVAPORATING TEMPERATURE		
	-30°C	-35°C	-40°C
TWO-STAGE SCREW COMPRESSOR	1.83	1.68	1.52
SINGLE STAGE SCREW COMPRESSOR	1.49	1.21	0.99
DIFFERENCE	23%	39%	54%

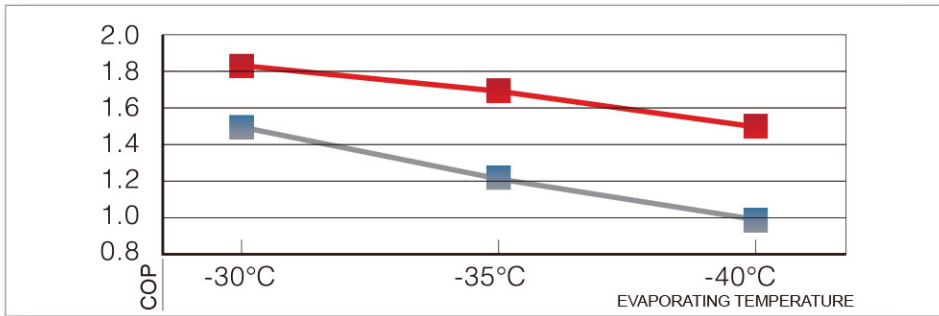

## COP COMPARISON BETWEEN TWO-STAGE SCREW AND PISTON COMPRESSORS WITH R404A

CONDENSING TEMPERATURE 40°C	EVAPORATING TEMPERATURE					
	-35°C	-40°C	-45°C	-50°C	-55°C	-60°C
TWO-STAGE SCREW COMPRESSOR	1.68	1.52	1.36	1.19	1.02	0.85
TWO-STAGE PISTON COMPRESSOR	1.33	1.21	1.10	0.98	0.87	0.76
DIFFERENCE	26%	26%	23%	21%	17%	12%

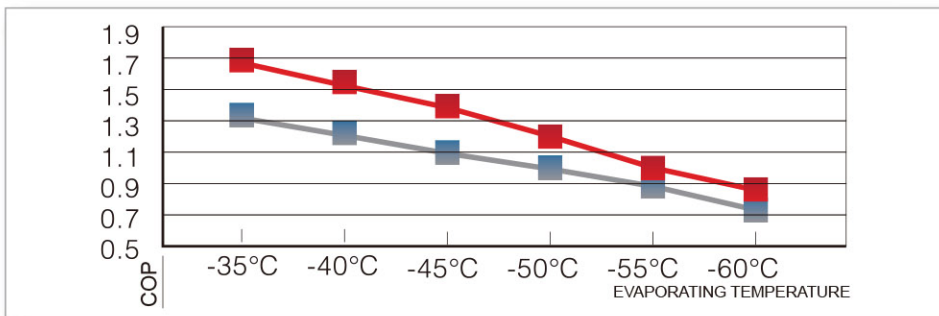

## COP COMPARISON FOR DIFFERENT COMPRESSORS WITH R404A

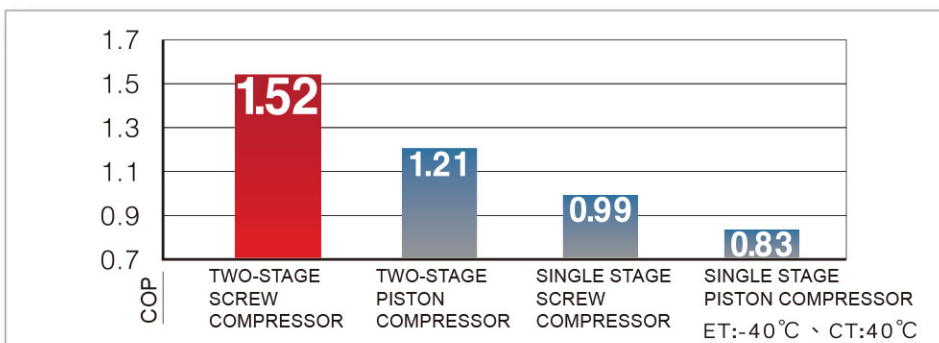

TWO-STAGE SCREW COMPRESSOR IS **25%** MORE EFFICIENT. TWO-STAGE PISTON COMPRESSOR.

## FEATURES

- MULTIPLE COMPRESSORS CAN BE COMBINED INTO A UNIT TO MEET THE DEMAND FOR BIG CAPACITY
- ENERGY EFFICIENCY IS 30% HIGHER COMPARED TO A SINGLE STAGE SCREW COMPRESSOR.  
IN LOW TEMPERATURE APPLICATION
- LOW NOISE LEVEL AND HIGH RESISTANCE TO LIQUID COMPRESSION
- NO NEED TO INSTALL FLEXIBLE ANTI-VIBRATION PIPE
- THE SIMPLICITY OF TWO-STAGE STRUCTURE LEADS TO DRAMATIC REDUCTION ON CONTROL COST
- THE EVAPORATING TEMPERATURE CAN REACH AS LOW AS -60°C (R22) / -65°C (R404A)

## OUTLINE DIMENSIONS

SRT218

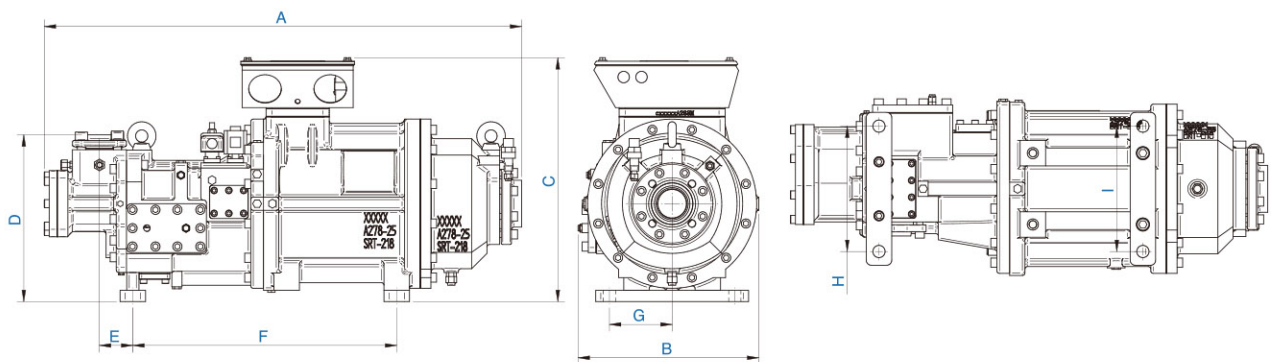

SRT314~SRT415

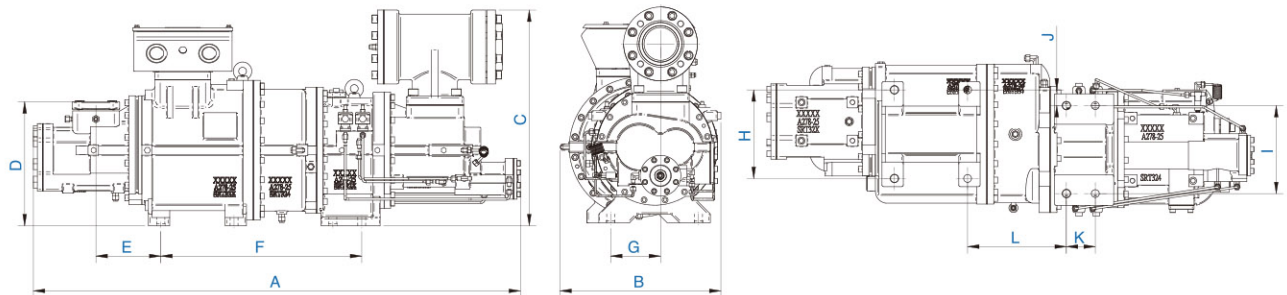

UNIT : mm

MODEL	A	B	C	D	E	F	G	H	I	J	K	L
218	937	355	479	327	66	518	123	246	246	—	—	—
314	1274	408	570	323	173	527	123	246	224	50	79	241
321(S)	1380	490	645	380	178	583	152	270	268	48	88	272
324	1485	560	645	380	198	706	152	270	268	48	88	310
413	1518	547	710	410	208	592	186	290	270	35	88	124
415	1582	547	710	410	208	592	186	290	270	35	88	124



## **FUSHENG INDUSTRIAL CO., LTD**

### **HEAD OFFICE**

No.172, Sec. 2, Nanjing E. Rd., Zhongshan Dist.,  
Taipei City 104, Taiwan (R.O.C.)  
TEL : +886-2-2507-2211 FAX : +886-2-2504-7870

### **FACTORY(SALES OFFICE)**

No.60, Sec. 2, Guangfu Rd., Sanchong Dist., New Taipei City 241,  
Taiwan (R.O.C.)  
TEL : +886-2-2995-1411 FAX : +886-2-2995-7925

Web site : [www.fusheng.com](http://www.fusheng.com)

E-Mail : [machinery.sc@fusheng.com](mailto:machinery.sc@fusheng.com)

Customer Service:0800-088-1953

Distributor/Sales Representative

SRT218~415-10606-112A000-E2