



T150

SECTIONAL INSULATED STEEL DOOR SPECIFICATIONS



Utilizing the latest in polyurethane technology, we've attained the highest 'R' value per inch of all competitive insulations, as well as providing superior adhesion and structural integrity.

Schedules

Door Height	Sections High
7'1" thru 8'1"	4
8'2" thru 10'1"	5
10'2" thru 12'1"	6
12'2" thru 14'1"	7
14'2" thru 16'1"	8
16'2" thru 18'1"	9

Door Opening Width	Number of Windows
8' - 9'	2
9'1"-12'2"	3
12'3" -16'2"	4

Sectional Details

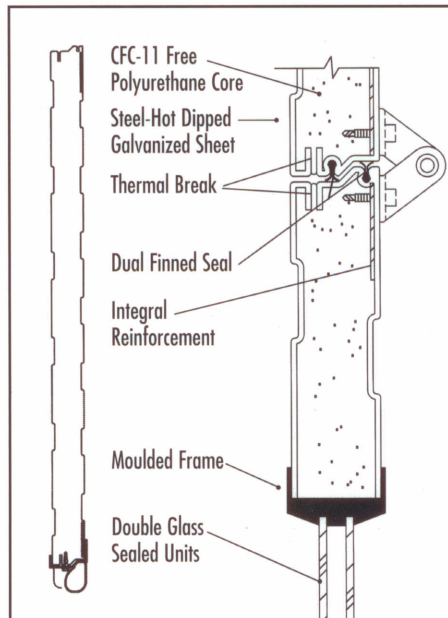

Sections:

- Insulated sections fabricated from prepainted, hot dip galvanized, steel sheet; with rigid polyurethane insulation core, CFC-11 free, face sheet stucco embossed and rib reinforced.
- Sections thermally broken, steel-polyurethane-steel sandwich formed by continuous process.
- Sections formed with shiplapped joint.
- 16mm (16ga) galvanized steel endcaps.
- Face sheet thickness: 0.40mm (0.016")
- Section thickness: 38mm (1 1/2")
- Thermal values of sections: RSI=2.51 (R=14.25);
USI=0.40 (U=0.07)
K=0.0151 (0.105)

Reinforcement:

- Continuous internal reinforcement for hardware mounting.

Weatherstripping:

- Neoprene bulb weatherstrip with continuous retainer full width of bottom of door.
- Two dual-finned seals between sections.

Finish:

- Two coat, baked-on paint system on exterior side, primer and polyester finish coat (White) (Brown).

Hardware:

- Refer to hardware article.

Design:

- Door design to meet industry-standard windload.

Full Vision

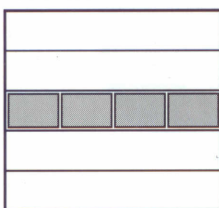

Full vision glazing section with 12.7mm (1/2") thick insulating glass, finish white aluminum.

Type D

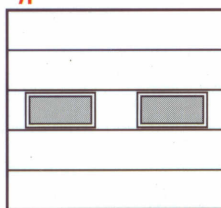

Custom size 864 x 407mm (34" x 16") sealed glass unit set in moulded frame.

Type E

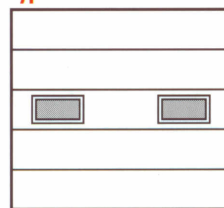

610 x 305mm (24" x 12") clear float glass sealed unit set in moulded frame.

Type B & CPL

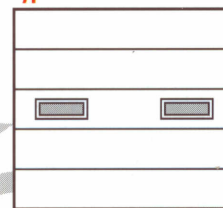

B- 610 x 152mm (24" x 6")
CPL- 610 x 203mm (24" x 8")
clear float glass sealed unit set in moulded frame.

OPTIONS FOR THERMATITE

Glazing:

- Full vision glazing section with 12.7mm (1/2") thick insulating glass, finish white aluminum.
- Custom size 864 x 407mm (34" x 16") sealed glass unit set in moulded frame.
- 610 x 305mm (24" x 12") clear float glass sealed unit set in moulded frame.
- B- 610 x 152mm (24" x 6")
CPL- 610 x 203mm (24" x 8") clear float glass sealed unit set in moulded frame.

OTHER OPTIONS

- Combination PVC step plate and lift handle
- Exhaust port 75mm (3"), 100mm (4") diameter
- Neoprene top weatherstrip for full width of door
- Full height thermal break and anti-friction strip for galvanized endcaps.

Richards-Wilcox Canada

Head Office

5100 Timberlea Blvd.
Mississauga, Ontario L4W 2S5
Tel: (905) 625-0037
Fax: (905) 625-0057
Web Site: www.rwdoors.com
E-mail: rwdoors@rwdoors.com

Distributed by:

SINCE 1912

Richards-Wilcox Canada

Thermatite T150



Very rigid, energy saving and long-lasting door system.

High strength to weight ratio.

Qualifies for a range of applications.

Produced on a continuous polyurethane production line utilizing the latest in rigid foam technology.

The thermatite product line is stocked in seventy door system manufacturing centers in North America.

Door system manufacturing centers support door system engineering and manufacturing.

Door system manufacturing centers provide immediate delivery for new installations, retrofit and individual door section replacements of any size.

A well established network of installing and servicing dealer distributors.

"With Thermatite, Richards-Wilcox has become a proven leader in the North American energy efficient industrial and commercial sectional overhead door industry."

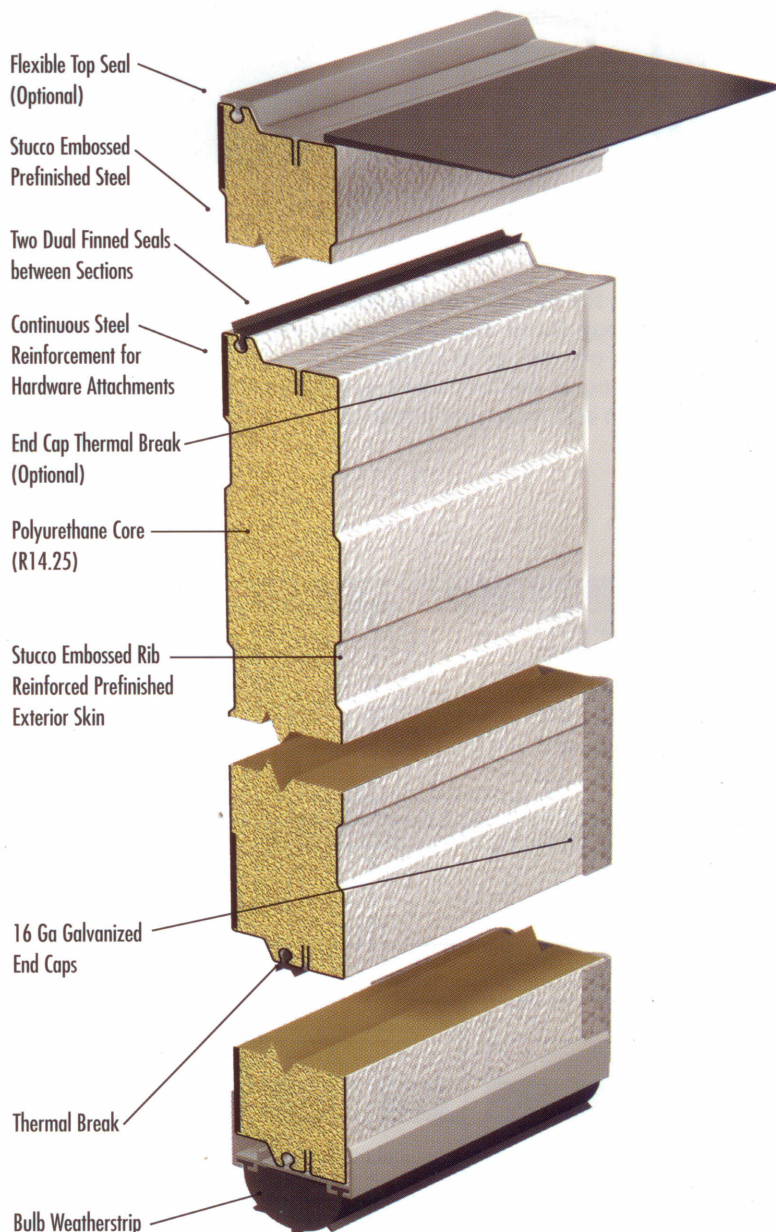

Comparative Chart for This and Relative Products

Comparative Chart for This and Relative Products		Car Wash	Service Stations	Muffler & Lube Shops	Commercial & Multi-Tenanted	Firehall	Ambulance	Industrial Warehousing & Manufacturing	Transit Facilities	Truck Terminals	Uninsulated	Storage Facilities	Mining	Pulp & Paper	Underground Parking	High Security	Refrigeration	Door Characteristics									
																		Insulated	R Value*	Standard Finishes			Appearance			Recomm.	
																				White	Brown	Ribbed	Flush	Paneled	Max Width	Max. Ft²	
T175				●	●	●	●				●	●	●	●	●	●	●	16.4	●	●	●			36'-2"	576	LEGEND ● Suitable ● Standard ● Optional	
T175-20						●	●	●			●	●	●	●	●			16.4	●			●		24'-2"	336		
T-150				●	●	●	●	●	●									14.2	●	●	●	●		16'-2"	288		
ADV200				●	●	●	●	●	●			●	●	●	●	●	●	18.5	●		●			36'-2"	576		

LEGEND

● Suitable

● Standard

● Optional

*"R" value and "U" values are based on testing to the ASTM C518 standard.

RICHARDS-WILCOX can custom engineer doors to sizes greater than the above chart. Please contact your nearest RICHARDS-WILCOX DISTRIBUTOR or the customer service department at (905) 625-0037 for product recommendations