

# Richards-Wilcox Canada

## Thermatite

### T175



- Very rigid, energy saving and long-lasting door system.
- High strength to weight ratio.
- Qualifies for a range of applications with spans of up to 36' without a center post.
- Produced on a continuous polyurethane production line utilizing the latest in rigid foam technology.
- The thermatite product line is stocked in seventy door system manufacturing centers in North America.
- Door system manufacturing centers support door system engineering and manufacturing.
- Door system manufacturing centers provide immediate delivery for new installations, retrofit and individual door section replacements of any size.
- A well established network of installing and servicing dealer distributors.

"With Thermatite, Richards-Wilcox has become a proven leader in the North American energy efficient industrial and commercial sectional overhead door industry."

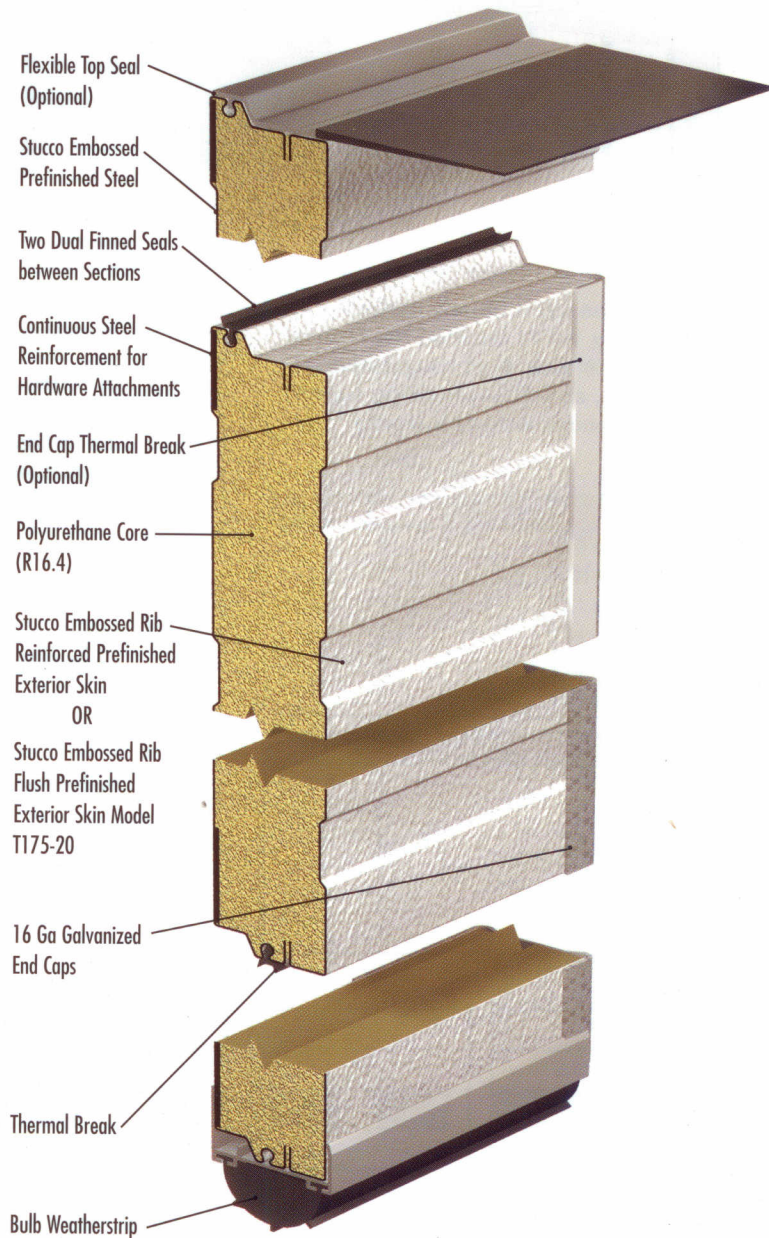

Comparative Chart  
for This and  
Relative  
Products

Comparative Chart for This and Relative Products	Car Wash	Service Stations Muffler & Lube Shops	Commercial & Multi-Tenanted	Firehall	Ambulance	Industrial Warehousing & Manufacturing	Transit Facilities	Truck Terminals	Uninsulated Storage Facilities	Mining	Pulp & Paper	Underground Parking	High Security	Refrigeration	Door Characteristics								
															Standard Finishes				Appearance		Recomm.		
															Insulated	R' Value*	White	Brown	Ribbed	Flush	Paneled	Max Width	Max. Ft²
T175			●	●	●	●			●	●	●		●	16.4	●	●	●			36'-2"	576	LEGEND ● Suitable ● Standard ● Optional	
T175-20					●	●		●	●	●			●	16.4	●			●		24'-2"	336		
T-150			●	●	●	●							●	14.2	●	●	●			16'-2"	288		
ADV200			●	●	●	●		●	●	●	●	●	●	18.5	●		●			36'-2"	576		

LEGEND  
 ● Suitable  
 ● Standard  
 ● Optional

\*\*"R" value and "U" values are based on testing to the ASTM C518 standard.

RICHARDS-WILCOX can custom engineer doors to sizes greater than the above chart. Please contact your nearest RICHARDS-WILCOX DISTRIBUTOR or the customer service department at (905) 625-0037 for product recommendations





# T175

## SECTIONAL INSULATED STEEL DOOR SPECIFICATIONS



Utilizing the latest in polyurethane technology, we've attained the highest 'R' value per inch of all competitive insulations, as well as providing superior adhesion and structural integrity.

### Schedules

Door Height	Sections High
7'1" thru 8'1"	4
8'2" thru 10'1"	5
10'2" thru 12'1"	6
12'2" thru 14'1"	7
14'2" thru 16'1"	8
16'2" thru 18'1"	9

Door Opening Width	Number of Windows
8' - 9'	2
9'1" - 12'2"	3
12'3" - 16'2"	4
16'3" - 19'2"	5
19'3" - 24'2"	6
24'3" - 25'2"	7

### Sectional Details

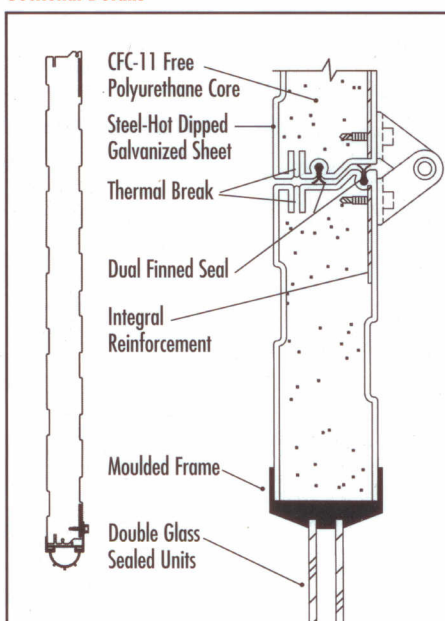

### Sections:

- Insulated sections fabricated from preainted, hot dip galvanized, steel sheet; with rigid polyurethane insulation core, CFC-11 free, face sheet stucco embossed and rib reinforced.
- Sections thermally broken, steel-polyurethane-steel sandwich formed by continuous process.
- Sections formed with shiplapped joint.
- 16mm (16ga) galvanized steel endcaps.
- Face sheet thickness: 0.48mm (0.019")
- Section thickness: 45mm (1 3/4")
- Thermal values of sections: RSI=2.84 (R=16.4); USI=0.34 (U=0.06) K=0.0154 (0.107)

### Reinforcement:

- Continuous internal reinforcement for hardware mounting.

### Weatherstripping:

- Neoprene bulb weatherstrip with continuous retainer full width of bottom of door.
- Two dual-finned seals between sections.

### Finish:

- Two coat, baked-on paint system on exterior side, primer and polyester finish coat (White) (Brown).

### Hardware:

- Refer to hardware article.

### Design:

- Door design to meet industry-standard windload.

### Full Vision

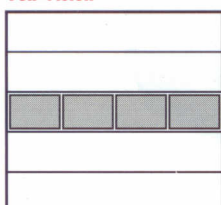

Full vision glazing section with 12.7mm (1/2") thick insulating glass, finish white aluminum.

### Type D

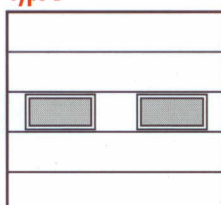

Custom size 864 x 407mm (34" x 16") sealed glass unit set in moulded frame.

### Type E

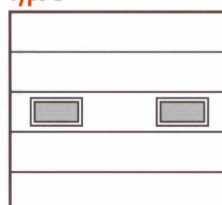

610 x 305mm (24" x 12") clear float glass sealed unit set in moulded frame.

### Type B & CPL

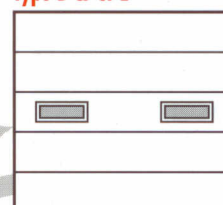

B- 610 x 152mm (24" x 6")  
CPL- 610 x 203mm (24" x 8")  
clear float glass sealed unit set in moulded frame.

### OPTIONS FOR THERMATITE

#### Glazing:

- Full vision glazing section with 12.7mm (1/2") thick insulating glass, finish white aluminum.
- Custom size 864 x 407mm (34" x 16") sealed glass unit set in moulded frame.
- 610 x 305mm (24" x 12") clear float glass sealed unit set in moulded frame.
- B- 610 x 152mm (24" x 6")  
CPL- 610 x 203mm (24" x 8") clear float glass sealed unit set in moulded frame.

#### OTHER OPTIONS

- Combination PVC step plate and lift handle.
- Exhaust port 75mm (3"), 100mm (4") diameter.
- Neoprene top weatherstrip for full width of door.
- Full height thermal break and anti-friction strip for galvanized endcaps.
- Aluminum end stiles with full height jamb seal.
- Pass doors: 813mm x 2032mm (32" x 80") Four section pass door available in doors up to 4623mm (16' 2") wide.

# Richards-Wilcox Canada

### Head Office

5100 Timberlea Blvd.  
Mississauga, Ontario L4W 2S5  
Tel: (905) 625-0037  
Fax: (905) 625-0057  
Web Site: [www.rwdoors.com](http://www.rwdoors.com)  
E-mail: [rwdoors@rwdoors.com](mailto:rwdoors@rwdoors.com)

Distributed by:

SINCE 1912