

Universal Oven Assembly Instructions

Glue is recommended for structural integrity.
 Build the TOP and BOTTOM ASSEMBLIES first.
 Before assembly, install hardware to parts as shown.

FIRST tasks

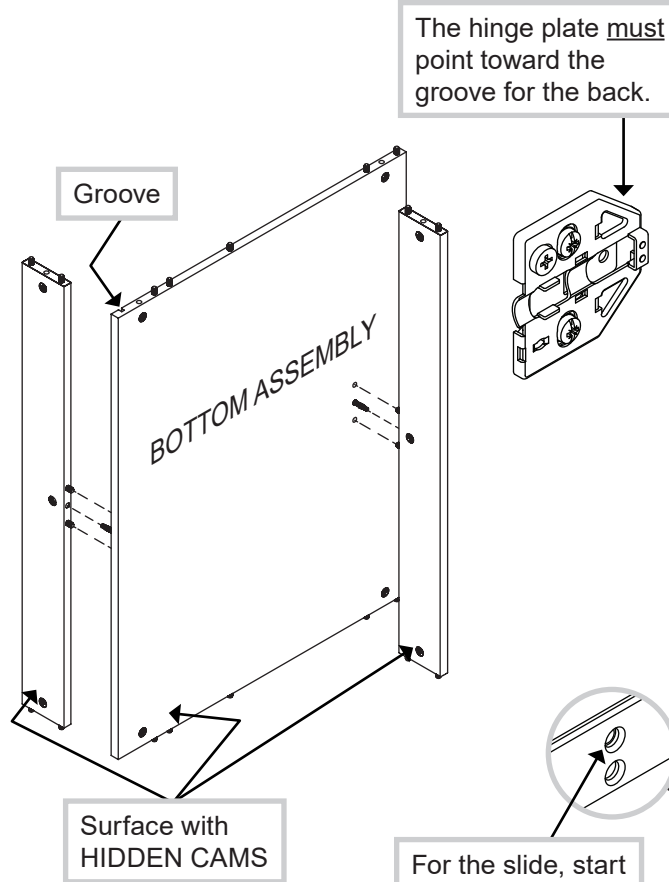
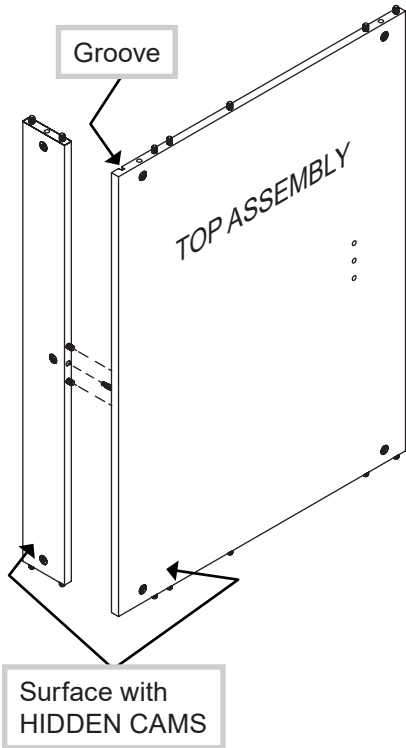

For the slide, start with this hole.

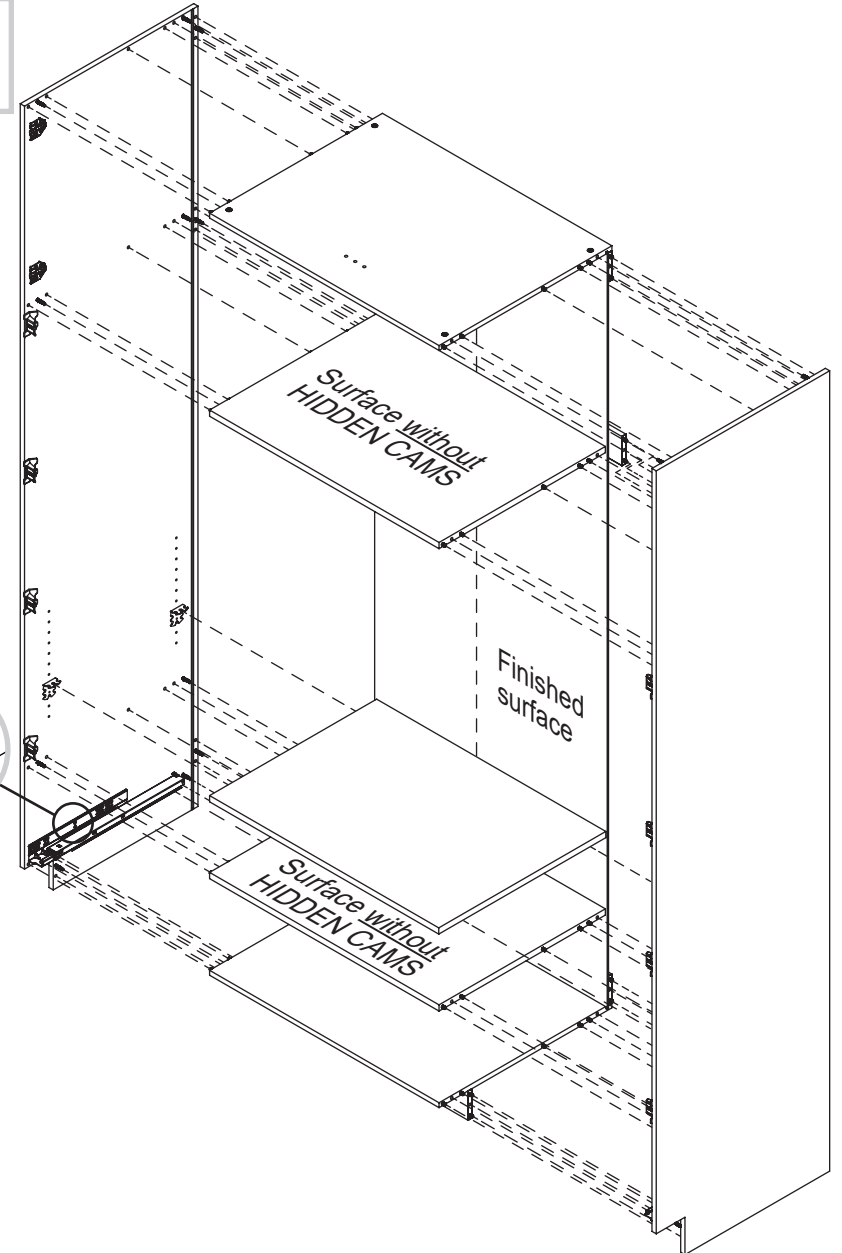

Completely Tighten

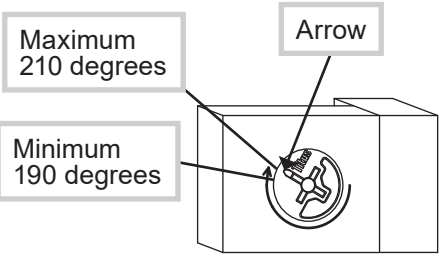

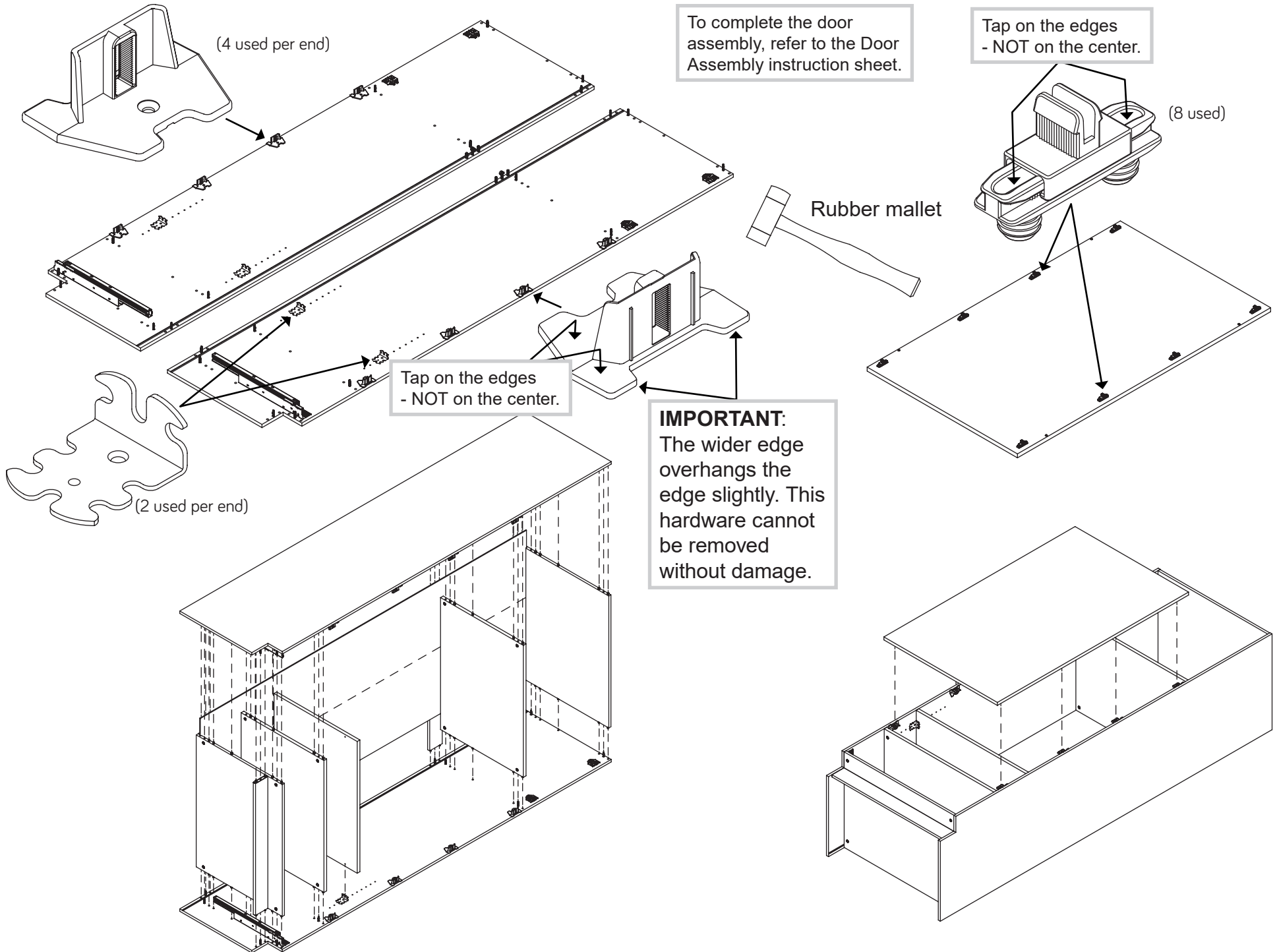

(4 used per end)

To complete the door assembly, refer to the Door Assembly instruction sheet.

Tap on the edges - NOT on the center.

(8 used)

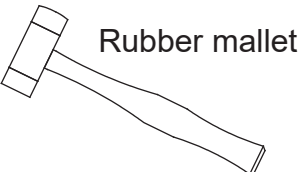

Rubber mallet

Tap on the edges - NOT on the center.

IMPORTANT:
The wider edge overhangs the edge slightly. This hardware cannot be removed without damage.

(2 used per end)

