

P/N: C-286-1827A

2385-B LOCKOFF FILTER FILTER AND O-RING REPLACEMENT INSTRUCTIONS



All installations, conversions and repairs of LPG equipment must conform to guidelines in NFPA #58, Code of Federal Regulation #40-CFR-86 and Canada CGA-B-149.2 M86,

INSTRUCTIONS

1. Turn off service valve on LPG fuel tank.
2. Start engine and idle until it depletes all fuel in hoses. When engine stalls, try to restart to ensure depletion of fuel.
3. Disconnect Battery.
4. Carefully relieve fuel pressure in the LP Fuel line leading to and from the bulkhead filter.
5. Disconnect inlet and outlet fuel hoses from the bulkhead filter.
6. Remove lockoff filter from the vehicle.
7. Scribe or pencil in alignment marks from the inlet cover to the outlet cover.
8. Remove the six inlet cover screws. CAUTION: Inlet cover is subjected to spring pressure. Hold the cover down while removing the last screw and remove the cover slowly.
9. Remove and clean the magnet and spring.
10. Discard the filter and o-ring.
11. Clean and inspect the o-ring groove, inlet cover mating surface, magnet and spring.
12. Lightly Lubricate the new o-ring and install into outlet cover groove.
13. Install the filter, spring and magnet. Be certain the o-ring is not folded over, cut or pinched before proceeding to the next step.
14. Align top cover and outlet cover scribe marks and secure with screws. PLEASE NOTE: When tightening screws, use a cross pattern sequence (with the inlet fittings at 12 and 6 o'clock, respectively, tighten screws 1+7, 9+3, 5+11) and torque to 25-35 inch pounds.
15. Install lockoff filter on vehicle. Torque mounting nut to 38-42 foot pounds.
16. Connect inlet and outlet hoses. Be sure to use pipe sealant or Teflon tape on all pipe threads.
17. Slowly turn on LPG tank service valve.
18. Leak test all connections.

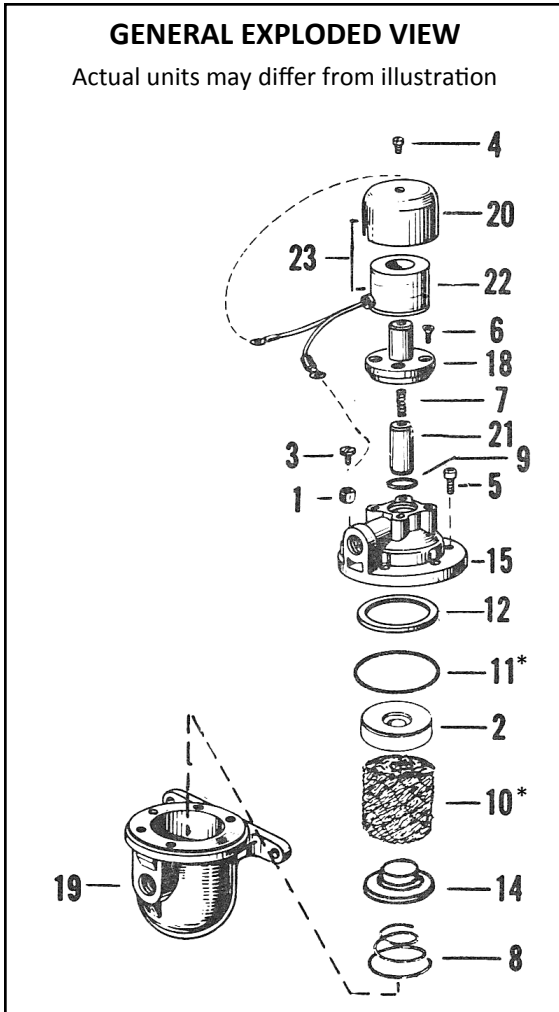

1.	C-11-66	Insert-Terminal Magnet
2.	C-11-78	Screw—8-32 x 5/16"
3.	C-15-285	Screw—10-24 x 1/4"
4.	C-15A-349	Screw—10-24 x 1/2" (6)
5.	US-S1-3	Screw—10-24 x 1/2" (4)
6.	C-15A-351	Spring—Plunger
7.	C-24A-215	Spring—Filter Retainer
8.	C-24-B87	O-Ring—Plunger Housing
9.	C-44-147	*Filter Element
10.	C-44-180	*O-Ring—Filter Bowl
11.	C-44-253	Retainer Insert—Cover
12.	C-55-429	Retainer—Filter Spring
14.	C-55-A129	Cover Assy.
15.	C-91B-53-MA	Plunger Housing
18.	C-154-526	Base & Plug Assy.
19.	C-159-85-MA	Cap—Fuellock
20.	C-184-79	Plunger Assy.
21.	C-194-667	Coil Assy. (Red)
22.	C-323-526	Cap & Coil Assy.
23.	C-323-529	

Included in Repair Kit P/N C-286-1827A

*C-44-180 (Filter Element)

*C-44-253 (O-Ring—Filter Bowl)