

HORIZONSCAN

RISK - RESILIENCE - READINESS

Art for Art's Sake –

Protecting Irreplaceable Assets

BANG Meeting,
Wed 27th May
2015



Key Messages

- When it's gone, it's gone
- Know what you've got
- Risk Management
- First Aid
- Liaise, Plan, Practice
- Questions

Hazards

- Fire
- Smoke
- Firefighting Water
- Internal Floods (burst tanks)
- External Floods (rivers, etc)
- Power (lack of)
- Wind damage (trees)
- Temperature (excess + / -)





What is an Irreplaceable Asset?





What is an Uninsurable Asset?

When It's Gone It's Gone . . .

- * Paintings
- * Sculpture
- * Books
- * Furniture
- * Carpet
- * Wallpaper
- * ?



How heavy
is this bust?



Spot the difference in the way these two pictures are hung









Know What You've Got

- * Asset Register
- * Pick List
- * Resources
- * Plans/Layout
- * Access Routes
- * Limitations

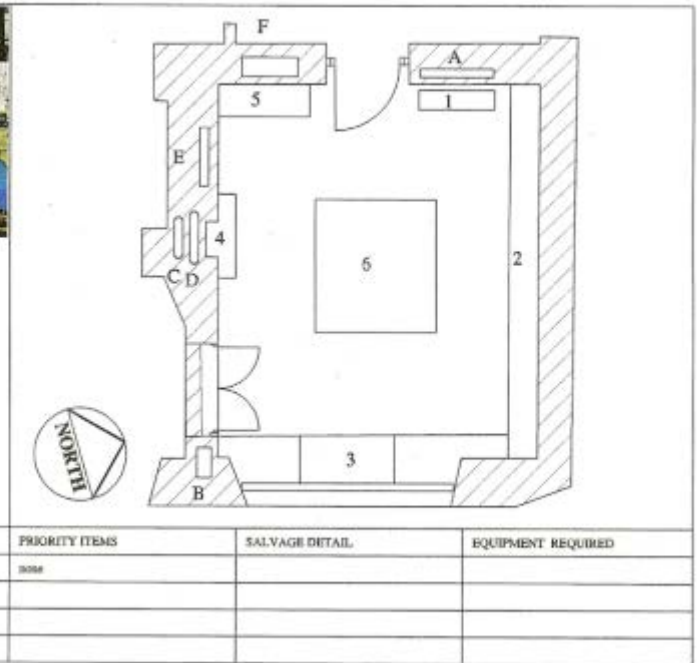

| |
|--|
| known hazards: Cleaning products toxic gas when hot. Flammable goods in cupboard 1 |
| keys required: none |
| card no. G.25 |

| PRIORITY ITEMS | SALVAGE DETAIL | EQUIPMENT REQUIRED |
|----------------|----------------|--------------------|
| none | | |
| | | |
| | | |

Risk Management

- * Distribute Assets if possible
(minimise exposure)
- * Move or protect in-place
- * Containment and Diversion
- * Pre-planned response





First Aid

- * Salvage Trolley
- * Plastic Bins (lots of them)
- * Containment and Diversion
- * Pre-planned response

Salvage Trolley

The trolley is mounted in a frame that has two fixed wheels and two castored wheels. Moving the trolley requires care - it cannot be pushed sideways.

Dimensions of Trolley:

Height: 90cm

Length: 120cm

Width: 76cm



Salvage Trolley Open



Small Tool Box Contents



Liaise, Plan & Practice

- * Establish who are the stakeholders?
- * Confirm expectations
- * Plan, check, plan, check
- * Are responders competent
The ladder question ?
- * Training



Questions?