



PRODUCT MANUAL



**DETAIL 01**

### Professional Equipment Support

Multiple processing and production equipment, complete mechanized production process, rigorous all-weather production of high-quality products

**DETAIL 02**

### Mature and Perfect Technology

Equipped with laser cutting, welding, bending, powder spraying and other process equipment

**DETAIL 03**

### Quality Control

Strict quality checks at every level, stable structure, standardized production and processing



# Table of Contents

**1.0 Pickup Canopy Systems ..... p.6** 

**2.0 Adventure & Camping Series ..... p.14** 

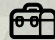
**3.0 Storage Solutions ..... p.18** 

**4.0 Vehicle Protection ..... p.21** 

**5.0 External Carrying Systems ..... p.25** 

**6.0 Compatibility Overview ..... p.27** 

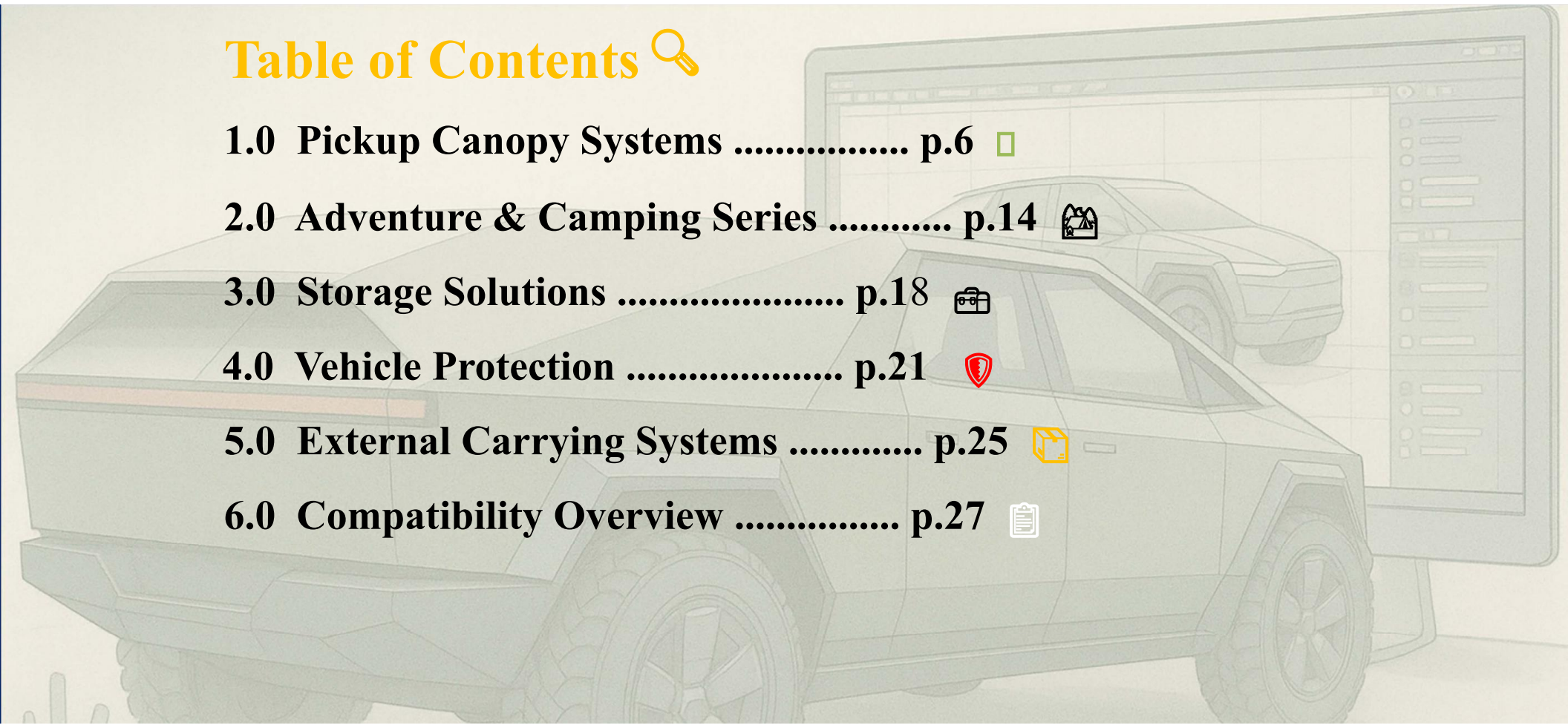

# 1.0 PICKUP TRAY CANOPY SERAIL

## 1).Integrated Type-----→

With a sleek appearance and solid structure, this type offers excellent protection and waterproof performance. It is the most common traditional solution, ideal for users who prefer a seamless look with the vehicle and long-term fixed use.



## 2).Modular / Detachable Type

To facilitate long-distance transportation and on-site assembly, this type divides the entire high-cover structure into five separate components. Once installed, the structure is solid and provides the same user experience as the integrated type. It is especially suitable for export shipping or scenarios with limited installation conditions.

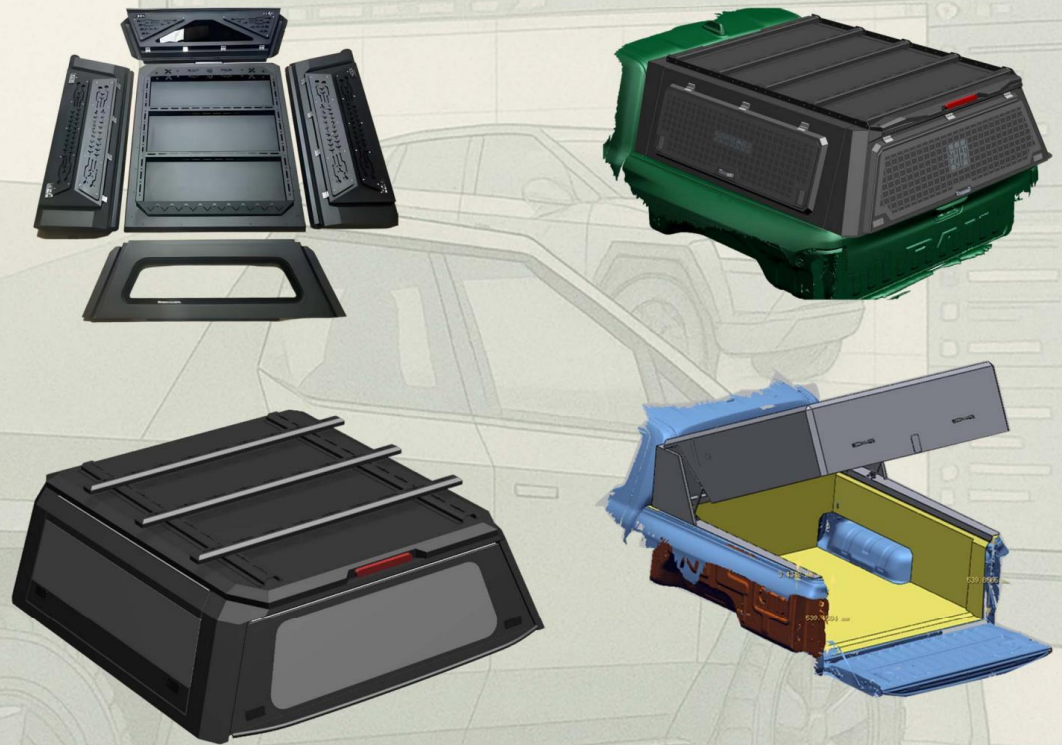

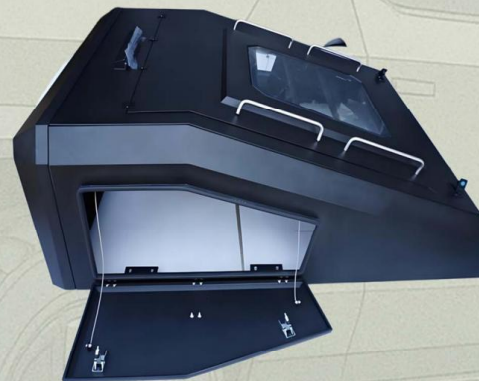

### 3).Roof Tent & Canopy Integrated Type

This design integrates the roof tent with the canopy into a single structure, offering a convenient all-in-one solution for camping enthusiasts. It is ideal for users who frequently venture outdoors and seek quick, ready-to-use functionality.



## 4). Personalized Customization – From Standard to Unique

At Chuangsheng Century, we understand that your pickup truck is a reflection of your personality. Our comprehensive customization service is designed to turn your unique ideas into reality—creating a vehicle that is truly yours.

### Visual Customization:

**Precision Color Matching:** Seamlessly blends with your original factory paint for a flawless visual integration.

**Exclusive Finishes:** Choose from matte, metallic, or textured coatings to showcase a refined, distinctive style.

### Functional Customization:

**Side Window Styles:** Select from sliding windows (for ventilation), flip-up windows (for easy access), or fully sealed panels to suit your needs.

**Integrated Lighting:** Includes seamlessly built-in high-mount brake lights, with optional smart interior LED lighting system.

### Interior Customization:

**Premium Lining:** Choose between durable carpet or high-grade leather lining, offering both protection and a quiet, upscale interior feel.

**Power Outlets:** Equipped with 12V and USB ports, transforming your truck bed into a mobile power station.

**Expansion Options:**

**Load-Carrying Systems:** Optional heavy-duty roof racks and mounts for outdoor gear like bikes or skis.

**Modular Interfaces:** Standardized mounting points make it easy to add storage solutions or industry-specific equipment.

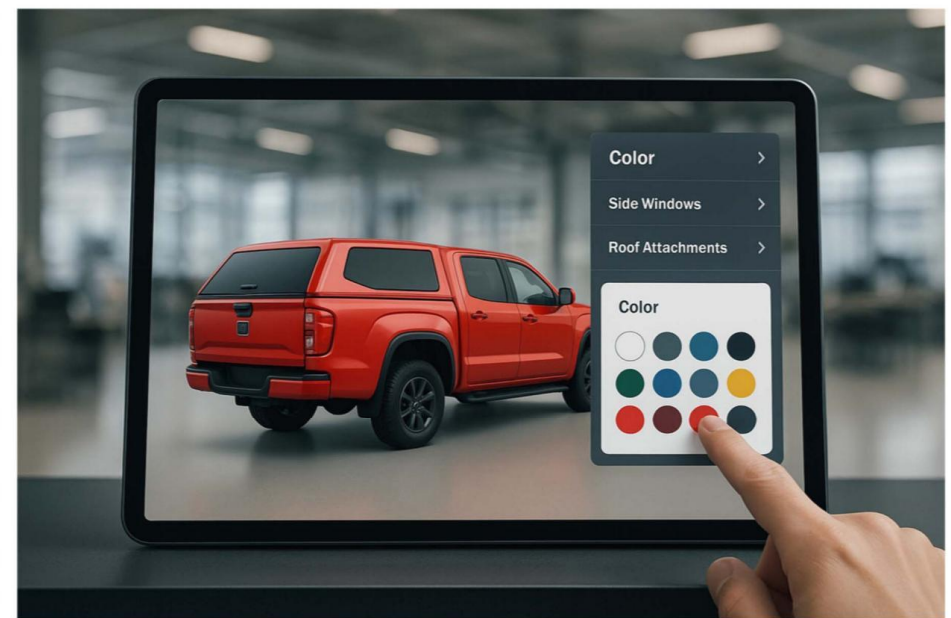

## 5).Professional Customization: Empowering Industries

### Core Message:

It's more than just a canopy — it's a mobile work platform. We provide modular solutions tailored to the rigorous demands of various industries, transforming your pickup into a high-efficiency, reliable productivity tool.

### Reinforced Load-Bearing & Mounting Systems

Customized heavy-duty ladder racks, side ladders, and mounting points designed for construction, engineering, and other industrial sectors.

### Modular Storage Solutions

Integrated secure toolboxes, drawer systems, and internal pegboards to keep tools organized and protected.

### Professional-Grade Power Integration

Pre-wired setups compatible with inverters, auxiliary batteries, and multifunction power panels — turning your truck into a mobile power station.

### Industry-Specific Equipment Interfaces

Stable and standardized mounting bases for specialized gear used in exploration, emergency response, telecommunications, and more.

### One-Line Summary:

Upgrade your pickup into the ultimate frontline operational asset.



## 2.0 Adventure & Camping Series

**Core Concept:** Transform your pickup from a means of transportation into a mobile base for exploring the world.

Based on the depth and intensity of adventure, this series is divided into three levels—each representing a unique lifestyle.



# 1. Explorer Series

**Positioning:** Weekend getaways and light camping enthusiasts

**Slogan:** Travel light, enjoy the weekend

Designed for users looking to escape the city on weekends and enjoy quality time with family or nature, the Explorer Series focuses on **space** and **convenience**.

**Key Features:**

**Maximized Storage Capacity:**

Offers spacious interior volume to easily store all camping essentials such as tents, grills, folding tables and chairs, and portable coolers.

**Basic Protection & Lighting:**

Comes standard with full interior lining to protect gear from bumps and scratches, along with built-in LED lighting for nighttime accessibility.

**Ventilated Panoramic Side Windows:**

Large sliding side windows ensure proper airflow and allow family members or pets to enjoy the view while on the road.

**Lightweight Roof Rack (Optional):**

Optional basic roof rack for securing lightweight items like sleeping bags and moisture-proof mats.

**Target Users:**

Families, fishing enthusiasts, and city dwellers who occasionally camp at established sites.





## 2. Adventurer Series

**Positioning:** All-terrain travel for serious overlanders

**Slogan:** Unlock every terrain, explore without limits

Designed for enthusiasts who seek deep off-road adventures and unpaved challenges, the Adventurer Series focuses on **durability** and **expandability**.

**Key Features:**

**Reinforced Structure & Load Capacity**

Heavy-duty frame and roof rack support rooftop tents (RTTs), kayaks, and other bulky gear.

**Side Access Gullwing Door**

Signature lift-up side doors allow easy access to gear from the truck's side—no need to climb into the bed.

**Modular Mounting System**

Pre-installed MOLLE panels or grid boards for attaching tools like axes, shovels, first-aid kits, and more.

**Integrated Power Ports**

Built-in 12V and USB outlets to power navigation devices, drones, portable fridges, and other electronics.

**Target Users:**

Overlanding enthusiasts, mountain bikers, off-road motorcyclists, and outdoor photographers.

## Expedition Series

**Positioning:** Long-range travel & extreme environment survival  
**Slogan:** A mobile fortress — where the world ends, your journey begins

Designed as our flagship model, the Expedition Series is a fully integrated mobile survival platform for hardcore explorers embarking on long-distance, cross-region, or even international expeditions. Its core strength lies in **self-sufficiency**.

### Key Features:

**Integrated living module:** Optional slide-out kitchen with stove, sink, and clean/grey water tanks for outdoor cooking freedom

**Independent power system:** Dual-battery setup with inverter and solar charging for off-grid energy security

**All-weather adaptability:** Optional heated rear window and insulated interior for extreme heat or cold

**External mounting points:** For jerry cans, recovery gear, and high-gain antennas

**Ideal for:** Global travelers, field researchers, and off-grid survivalists

# (Expedition)



## 3.0 Storage Solutions

### Unlock Full Utility · Organize Smarter · Travel Further

Our high-rise canopies transform your pickup into a secure, weatherproof cargo space — ideal for both daily use and extended adventures. Designed with modular storage in mind, they offer a perfect balance of **capacity, accessibility, and protection.**

**Maximized vertical space** for loading camping gear, tools, and bulky items  
**Optional sliding drawers, shelves, and side compartments** to keep everything organized and within reach

**Weather-sealed design** to protect your cargo from dust, rain, and heat

**Lockable access points** ensure security for valuable equipment

**Custom fitment** for various pickup models, with optional roof racks and accessory mounts

**Perfect for:** Overlanders, field professionals, outdoor enthusiasts, and anyone who needs more than just a truck bed.



### 3.1 Loading & Unloading Efficiency (High-Performance Operation · Rapid Deployment)

Boost operational efficiency — built to handle both heavy-duty loading and effortless unloading.

#### Product Examples:

**Heavy-Duty Slide-Out Base Platform** (Full-bed extension system for pickup trucks)

**Tool-Free Quick-Release Tray Module**

#### From Transport to Deployment — One Smooth Slide.

Built with high-strength industrial-grade sliding rails, operable by a single person with ease. Supports rapid loading and unloading of heavy toolboxes, generators, camping gear, and more. Significantly reduces operation time and physical labor, enhancing field efficiency.



## 3.2 Drawer System

### Efficient, Organized, Weather-Ready

Installed under the truck bed, ideal for storing tools, camping gear, and daily essentials.

Smooth slide-out operation, easy for one person

Weatherproof design — dust & water resistant

Multiple compartments for organized storage

Perfect for work, travel, and everyday use.

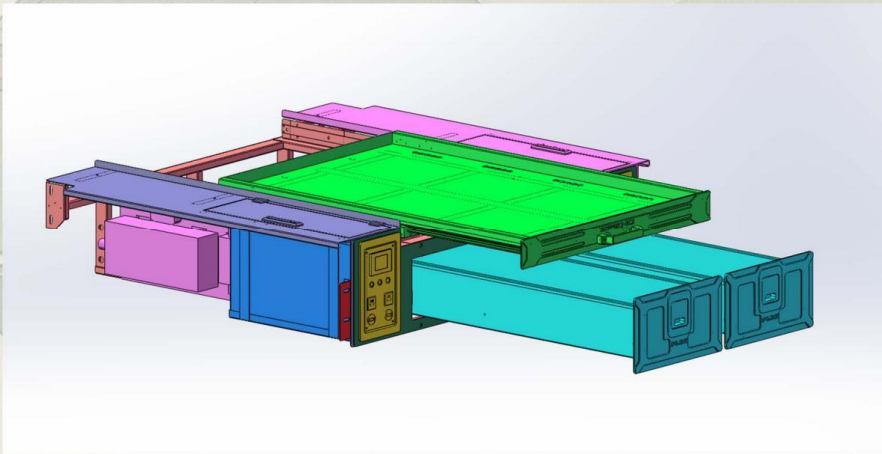

# 4.0 Vehicle Protection Series

*Full-coverage body reinforcement from front to rear*

## Front Bumper · Key Features

**Heavy-duty steel construction** for superior impact resistance and off-road durability.

**Winch and auxiliary light mounts** for enhanced off-road capability.

**Aggressive styling** that reinforces the vehicle's rugged off-road presence.

**Bolt-on design** for easy installation with original mounting points.

**Anti-rust coating**, ideal for harsh environments and long-term use.

### Recommended Applications:

Perfect for off-road expeditions, forestry patrols, mining operations, and emergency response vehicles requiring reinforced front-end protection and expansion options.

## Rear Bumper · Key Features

**Heavy-duty steel construction** protects the tailgate and rear lights from impact.

**Tow hook & hitch ready**, ideal for towing and trailer use.

**Integrated step** for easy access to the truck bed.

**Sleek, rugged design** matches the vehicle's tough styling.

**Sensor & camera mount compatible** for smart driving support.

### Perfect for:

Logistics, utility fleets, construction teams, and outdoor adventurers needing strong, reliable rear protection.



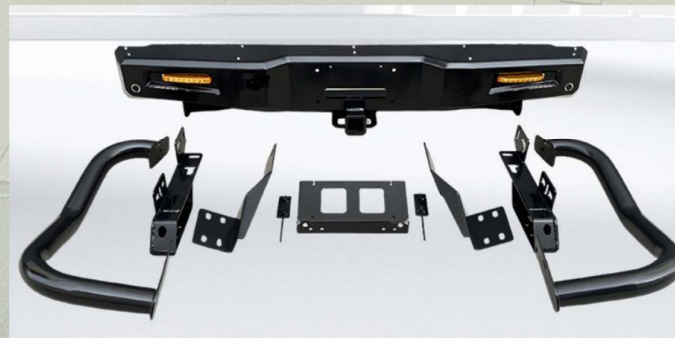
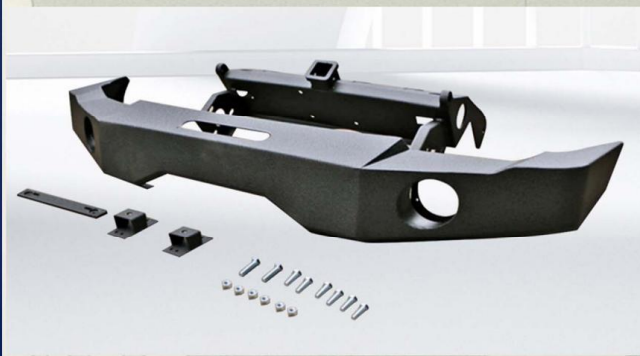









# 5.0 External Carrying System

Specifically designed to expand loading capacity for large or heavy items such as luggage and equipment.

 **Roof Rack**  
A multi-bar structure for securing cargo boxes, skis, camping gear, and more.  
*Enhances vertical storage without compromising interior space.*

 **Tent Platform**  
A heavy-duty platform engineered for rooftop tents.  
*Provides stable support, ideal for camping and overland travel.*

 **Solar Panel Frame**  
A sturdy mounting frame for solar panels.  
*Supports reliable off-grid energy supply in remote environments.*

 **Fuel & Water Can Mount**  
Secure brackets for auxiliary fuel or water containers.  
*Improves range and survival capability for long-distance or wilderness trips.*

## EXTERNAL CARRYING SYSTEM

**ROOF RACK**  
Multi-bar rack for securing luggage, skis, camping gear, and more



**TENT PLATFORM**  
Heavy-duty base for rooftop tents, ideal for overland camping

**SOLAR PANEL FRAME**  
Mounting frame for solar panels, supporting off-grid power systems



**FUEL & WATER CAN MOUNT**  
Holders for fuel or water cans – boost range and survival readiness





# 6.0 Modular Platform Canopy System — Redefining Pickup Freedom

The new generation of pickup canopy products is evolving into a truly modular platform, featuring interchangeable roof modules, side panels, expansion interfaces, and accessory systems. It is more than just a canopy — it is a reconfigurable mobile workspace and lifestyle platform that adapts to different usage scenarios, offering users unprecedented flexibility and upgrade potential.

Modular Platform Canopy System — Redefining Pickup Freedom

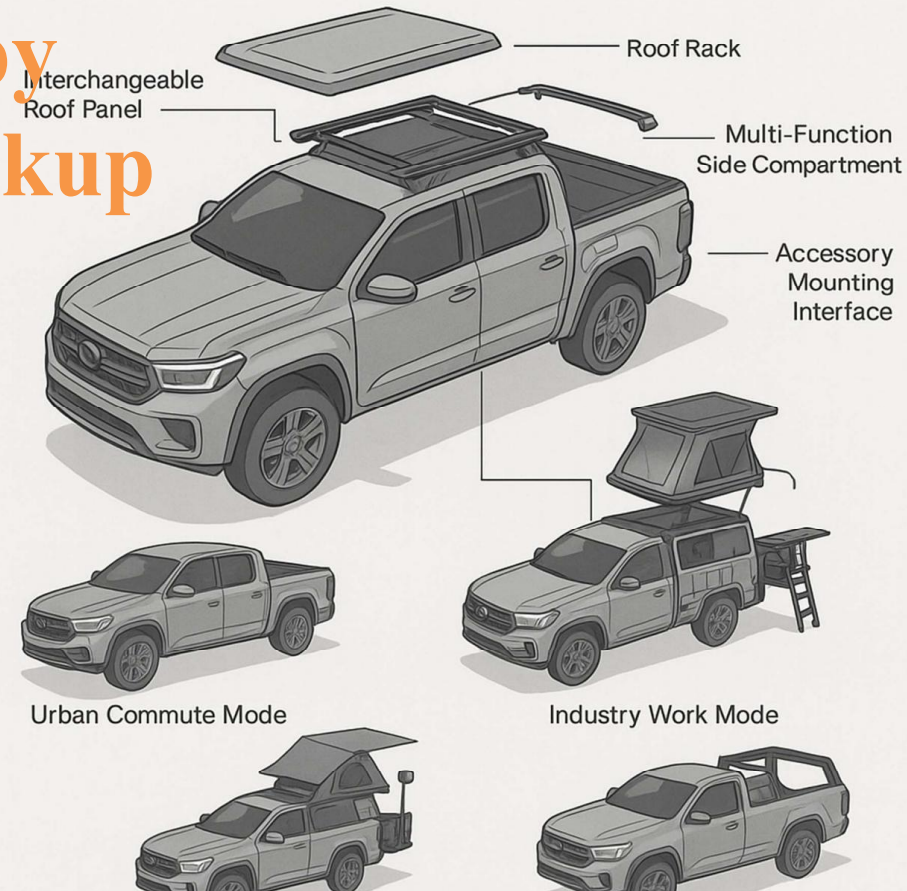

# 7.0 Full Vehicle Compatibility for All Product Lines

## Modular Fit · Multi-Model Coverage · Seamless Integration

From **canopies**, **roof tents**, and **slide-out ladders**, to **cargo bed trays**, our products are engineered to fit a wide range of pickup models with precision.

**Canopies:** Custom-fit designs with optional lift-up side windows, tailgate linkage, and multiple height styles

**Roof Tents:** Compatible with factory or custom racks, enabling fast deployment of mobile living space

**Slide-Out Ladders & Bed Trays:** Sized to various bed lengths and depths, streamlining loading and tool organization

**Multi-Brand Fitment:** Compatible with Ford Ranger, Hilux, D-MAX, Great Wall, Navara, Tunland, JAC, and more

**Non-Invasive Mounting:** Uses original vehicle points for quick, secure, and damage-free installation

**Perfect fit. Maximum function. Designed to go wherever your truck takes you.**







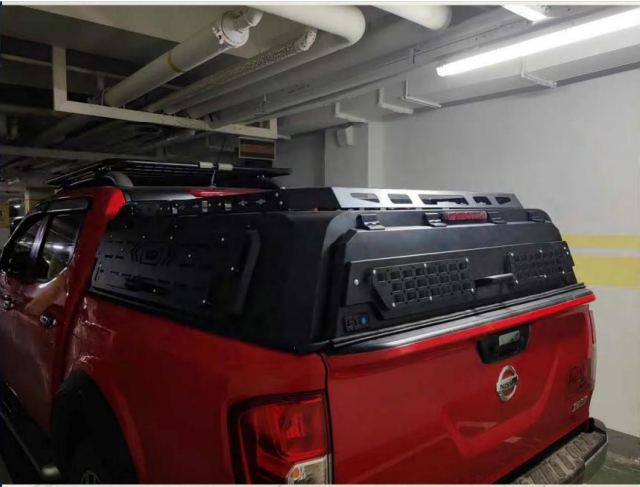



00 HUAWEI P40 Pro 5G  
Ultra Vision LEICA Dual Camera









