

Coulee Crest Herefords

Farm Gate Timed Auction
Online Heifer Sale
December 9, 2023

Selling: 30 Bred Hereford Heifers



**COULEE
CREST
Herefords**

Breeding Quality
Hereford Cattle
Since 1944

For info call:

Randy Radau: 403-227-2259 or 403-588-6160

Luke Radau: 403-506-6295

Website: couleecrest.ca

Email: couleecrestfarm@gmail.com

Welcome to our second online heifer sale!

After the success of our first online heifer sale we are pleased to present to you our bred heifer sale group in 2023. This years sale group is probably the best set of bred heifers we have ever offered for sale. Their quality and maternal strength is second to none. They should make excellent cows.

The heifers are bred to some new top calving ease sires that should leave outstanding calves.

We welcome your visit anytime before the sale close-out on December 9 to come see the heifers in person.

If you are unable to leave home we can send cell phone videos of the heifers upon request. We look forward to your visit.

Randy, Sandra & Luke and Jessica Radau

Why buy from Coulee Crest?

Time Tested

Our breeding program is backed by almost 80 years of continuously raising the best quality Hereford cattle possible.

Low Maintenance & Highly Selected

Our purebred cow herd is run like most commercial herds with stringent selection for fertility, fleshing ability, and outstanding feet and udders.

Bred & Fed for Longevity

Our heifers are fed their first winter a high forage, low grain backgrounding ration that ensures their fertility and longevity. They have never been on creep feed.

Geared for Success

Every part of our management and breeding program is geared towards our customer's success with our heifers.

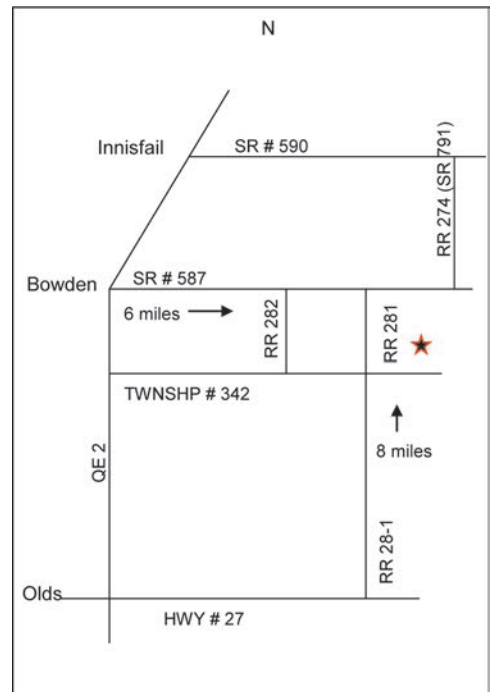

LOCATION: MAIN FARM

From Bowden underpass

- 7 mi east to Range Rd 281,
- 2 mi south,
- 1/2 mi east (Randy & Sandra's yard)

~ 28050 TWNSHP RD 342 ~
Red Deer County

Find us on Google or Apple Maps by searching Coulee Crest Farms.



Jessica, Luke, Sandra, Randy Radau

DLMS FARM GATE TIMED AUCTION

www.farmgatetimedauctions.com

**Sale opens, December 9, 2023 at
8:00am MST**

**Racehorse style close-out starts on
December 9 at 7:00pm MST**

How to Participate in the DLMS Farm Gate Timed Auction with Extended Bidding

1. Visit www.dlms.ca, scroll down sale list to find the sale you are interested in bidding on. Click on the sale listing and you will be taken to the Farm Gate Timed Auction Sale page.
2. After you are at the Farm Gate Timed Auction site - farmgatetimedauctions.ca, click the LOGIN/REGISTRATION button.

FIRST TIME FARM GATE USERS:

- First time users will select the REGISTER button from this page. Fill out the registration form to sign up for a free user account and it allows you to select a username and password for use on all Farm Gate Timed auctions. (please note due to some of the text notification features the Farm Gate Time Auction site requires a new account separate from your DLMS Live sale site)
- After you create your Farm Gate account you will receive a text message with a pin code to verify your account.
- On your first log in to Farm Gate Timed auctions we recommend you go to your profile and confirm your notifications are set to YES. This allows the site to send you text and/or email notifications when you are out bid and if there is activity on your favourite lots.

RETURNING FARM GATE USERS:

- If you have used Farm Gate Timed auctions in the past simply enter your user name and password to continue. After you have logged in you are able to browse the timed auctions on DLMS Farm Gate Timed Auctions.

3. How to Bid

Now that you are logged in and your account phone number/ email is verified you are able to bid on an upcoming sale. Simply find the lot you are interested in bidding on. After you have found the lot there are 2 options for bidding on the lot.

- Place Next Bid - to place the next bid on the item, you see the amount in the first box, you simply click the "Place Bid" button and after you review the bid and agree to the terms and conditions your bid will be placed.
- Max Bid Amount - to place a max bid you put your max bid in the second box listed as "Max Bid" on the item, and then click the "Place Bid" button and after you review the bid and agree to the terms and conditions your bid will be placed as the next bid. With the Max Bid placed the computer will then keep you as the high bidder to the max amount you have placed. This can be a great feature if you are not able to give 100% attention to the sale close out and protect your interest so you do not miss out on any lots you want to purchase. The Max Bid amount is completely confidential from the seller during the sale process.

Example of How the Max Bid Works - If the lot has a \$2000 bid on it and you place a proxy bid of \$3500 into the system, the computer will bid \$2100 for you but if some one else bids \$2200, the computer will again bid for you, this time at \$2300. The system will look after your interest to a maximum of \$3500. If another bidder is on at \$3600, your proxy will no longer be effective and you will no longer have the winning bid on this lot without once again logging in and bidding again or moving your attention to a second lot of interest. Please note that in some cases a lot value can change very quickly if 2 max bids are placed on the same lot competing against each other.

4. Watch List Feature

If you have items in multiple auctions or only a few from the same auction that you want to watch with out having to scroll through the entire list you can add the lots to your watch list. On each lot you will see the "eye" button beside the bid button, by clicking this "watchlist" Icon that item is added to your personal watch list for easy viewing of just your favorite lots in this sale or on the entire site.

5. Sale Ending / Closeout

Most Farm Gate Timed Auction sales close racehorse style with extended bidding.

What is Racehorse Style Close?

Racehorse style sale close is when the entire sale stays open in extended bidding. This type of sale allows you as the bidder to change to a different lot within the same sale if the bidding has gone in to extended bidding.

How will Extended Bidding works?

When we get to the close out end time the clock for close extends with any bid placed with less than 5 min on the clock. This type of extended bidding turns the end time to more of a soft time. Extended bidding allows bidders to compete in lots like a real auction and give all bidders the same time to make a decision. Always follow the clock to see how much time remains in the sale you are interested in.

6. Bidding Close & Follow-up

After the clock has gone to "ENDED" and no bidding has occurred for 5 minutes, the computer will declare the sale finished.

Following the close typically within 24 hours of the sale close Coulee Crest will contact all winning bidders to arrange payment, transfer of pedigrees and deliver /pick up of your lot. Or as the winning bidder you can contact Coulee Crest to confirm payment instructions.

Please make sure that your account info is up-to-date and correct if you are the winning bidder of a lot as this is how the billing is sent to Coulee Crest.

For more info and assistance with bidding contact;

DLMS Farm Gate Timed Auctions~ Mark Shologan Ph: 780-699-5082



BAR-RZ 70B DAWSON 47D

BAR-RZ 59T MR BOJANGLES 70B BBSF 13P TERRORIST ET 59T
BAR-RZ 32J REGINA 89R

BAR-RZ 56X MISS SPARKLE 79Z BAR-RZ 85U ROLEX 56X
BAR-RZ 49S ROXANNE 14X

A landmark sire! Dawson is a eight time Trait Leader including calving ease, birth weight and ribeye. He has the unique ability to reduce birth weight and increase performance. His sons are some of our best. We really like his excellent uddered daughters.

EPD's	CE	BW	WW	YW	M	TM
	+13.6	-1.7	+52.4	+84.5	+25.2	+51.4



LRD SCRIPT COMMANDER 15D

FA SCRIPT BRITISHER 128Z SR SCRIPT 187
FA 71S BRITISHER LADY 9U

LRD ANNIE 48A CH 56M RIFLE 20R
LRD 33 COMMAND LASS 3P

Our pick of Edgar's top Calgary Bull Sale string. His dam was the leadoff cow in the LRD dispersal. His progeny have lots of performance and tremendous dispositions. He is a weaning weight trait leader. He has left us both outstanding bulls and heifers.

EPD's	CE	BW	WW	YW	M	TM
	-2.4	+6.3	+70.4	+101.3	+19.5	+54.7



LAMPORT'S 33D FORMULA 8F

LAMPORT'S Y12 DOZER 33D MOUNT DIFFICULT FELLIS Y12
LAMPORT'S VICTOR LASS 32B

TCF KLR 8Z SHE'S A DIME 424B JVJ TCF 719T SURE BET 8Z
TCF-KLR 3S SOUTHERN BELLE 1X

Our outcross sire from Lamport's that is loaded with style and muscle. He is smooth topped with extra loin and quarter and is passing that on to his calves. His grandsire is considered to be one of Australia's top carcass sires. He is a ribeye trait leader.

EPD's	CE	BW	WW	YW	M	TM
	+5.4	+2.9	+58.7	+95.1	+20.2	+49.6



CC 3C EASY 1F

CC 20X EASY 3C JEN 195T KAP 20X
CC 25X PRINCESS 63A

CC 41Z DAPHNE 62D GLENLEES 719T BARON 41Z
CC 13S DAPHNE 11W

An outstanding calving ease sire with extra eye pigment. He comes from the JEN 195T Kap 20X sire line that has set the standard here for calving ease for years. His daughters are moderate in size and very maternal.

EPD's	CE	BW	WW	YW	M	TM
	+11.3	+0.2	+55.3	+80.6	+22.5	+50.2



CC 47D EASY 3G

BAR-RZ 70B DAWSON 47D BAR-RZ 59T MR BOJANGLES 70B
BAR-RZ 56X MISS SPARKLE 79Z

CC 25X JESSICA 13A LCI 107R STONEWALL 25X
CC 83D JESSICA 49M

A tremendous Dawson son that had a light birth weight (67 lbs), but was number one on weaning performance (778 lbs 205 wt). He is stout and deep and left us a top sire group of calves.



EPD's	CE	BW	WW	YW	M	TM
	+1.8	+4.2	+59.7	+98.2	+28.0	+57.9

COPPERTONE 72C GENESIS 8G

NJW 79Z 22Z HEAVY DUTY 72C ET NJW 67U 28M BIG MAX 22Z
BW 91H 100W RITA 79Z ET

COPPERTONE 164X KASHMIR 14Z TH 104U 719T VICTOR 164X
BBSF 52U KASHMIR 62X

"Platinum Patty" was purchased at Williams Lake Bull Sale from Coppertone Farms, Abbotsford. He has been a trouble free, calving ease sire and is now one of our top bulls in the main cowherd. His milk EPD is in the top 1% of the breed.



EPD's	CE	BW	WW	YW	M	TM
	+10.5	+0.6	+59.9	+92.4	+46.5	+76.5

FCI 646D GAME ON 35G

CHURCHILL ROCK 646D ET NJW 98S R117 RIBEYE 88X ET
SR CCC LADYSPORT 2205 Z ET

FCI MISS SENSATION 40Z CHURCHILL SENSATION 028X
FCI SERENADE 18W

Our powerful new sire from FCI Herefords, Quebec. This son of Churchill Rock has been very popular with our visitors. He is a long, free moving bull with extra style and thickness.



EPD's	CE	BW	WW	YW	M	TM
	-7.0	+7.3	+57.4	+92.3	+28.6	+57.3

LAMPOR'T'S 49E HARVEST 111H

LAMPOR'T'S 82W CHALLENGER 49E BAR-H CHALLENGER 82W
LAMPOR'T'S 87N VICTORIA 46T

LAMPOR'T'S 23X SARA 112A BAR-RZ 59T TRIPLE X 23X
LAMPOR'T'S 28M SARA 133T

A tremendous young sire from Lamports that left us a great group of calves in his first crop. They have good growth and pigment and his daughters look like they will make excellent cows.



EPD's	CE	BW	WW	YW	M	TM
	-4.7	+6.5	+61.8	+94.5	+25.9	+56.8

CC 8F EASY 131J

LAMPORT'S 33D FORMULA 8F LAMPORT'S Y12 DOZER 33D
TCF KLR 8Z SHE'S A DIME 424B

CC 20X BRANDI 24C JEN 195T KAP 20X
CC 25X BRANDI 146A

A tremendous, proven calving ease sire on heifers. He has extra pigment, style and maternal. His calves from heifers in 2023 averaged 73 lbs for bull calves and heifer calves 67 lbs.

EPD's	CE	BW	WW	YW	M	TM
	+9.7	+0.3	+55.2	+88.9	+25.0	+52.6



CRITT OPTION 28K

SHF HORIZON D287 H022 ET SHF DAYBREAK Y02 D287 ET
SHF TIME 001A D81

GHC C5 MISS LEGEND ET 2E KCF BENNETT IMPACT B451
GHC MISS UNIQUE 25Z

Option was the high selling bull in the LonePine/Airriess sale in 2022. His sire is a trait leader for birth weight, calving ease and marbling. His dam is one of Crittenden's best cows and was successfully embryo transplanted this past year. BW 76 lbs.

EPD's	CE	BW	WW	YW	M	TM
	+10.8	-1.0	+54.6	+90.5	+28.3	+55.6



PCI 901 KENTUCKY GENT 7K

CSC 701 BOLDER 901 TH 22R 16S LAMBEAU 17Y
CSC 502 LADY DEW 701

PCL 6153 REAL LADY 27H BOYD 31Z BLUEPRINT 6153
PCL 23B REAL LADY ET 61E

Kentucky Gent was selected out of of the Phantom Creek dispersal for use on heifers. His sire, Bolder 901, is a widely used, proven AI sire that is a birth weight, calving ease and milk trait leader. Kentucky Gent has a tremendous disposition and should leave outstanding females. BW 75 lbs.

EPD's	CE	BW	WW	YW	M	TM
	+9.8	+0.4	+54.1	+90.8	+32.9	+60.0



3K

CC 1F DAPHNE 3K

Polled Born: March 22, 2022
 CC 3C EASY 1F CC 20X EASY 3C
 CC 41Z DAPHNE 62D
 CC 47D DAPHNE 20H BAR-RZ 70B DAWSON 47D
 CC 41Z DAPHNE 31C



EPD's					
CE	BW	WW	YW	M	TM
+11.0	-0.1	+52.9	+75.7	+22.8	+49.3

Exposed to Critt Option 28K from June 21 to September 4, 2023.

9K

CC 8F LYDIA 9K

Polled Born: March 29, 2022
 LAMPORT'S 33D FORMULA 8F LAMPORT'S Y12 DOZER 33D
 TCF KLR 8Z SHE'S A DIME 424B
 CC 85X LYDIA 59C HARVIE TRAVELER 85X
 CC 146U LYDIA 26X



EPD's					
CE	BW	WW	YW	M	TM
+3.7	+4.5	+56.0	+89.0	+20.7	+48.7

Exposed to Critt Option 28K from June 21 to September 4, 2023.

16K

CC 47D JULIANA 16K

Polled Born: March 31, 2022
 BAR-RZ 70B DAWSON 47D BAR-RZ 59T MR BOJANGLES 70B
 BAR-RZ 56X MISS SPARKLE 79Z
 CC 3C JULIANA 87E CC 20X EASY 3C
 CC 25X JULIANA 170C



EPD's					
CE	BW	WW	YW	M	TM
+14.5	-0.9	+50.3	+84.3	+21.7	+46.9

Exposed to CC 8F Easy 131J from June 21 to September 4, 2023.

18K

CC 3G PRINCESS 18K

Polled Born: March 31, 2022
 CC 47D EASY 3G BAR-RZ 70B DAWSON 47D
 CC 25X JESSICA 13A
 CC 41Z PRINCESS 9F GLENLEES 719T BARON 41Z
 CC 14Z PRINCESS 73B



EPD's					
CE	BW	WW	YW	M	TM
-4.8	+7.5	+65.8	+102.4	+25.8	+58.7

Exposed to Critt Option 28K from June 21 to September 4, 2023.

35K

CC 47D MARION 35K

Polled Born: April 2, 2022

BAR-RZ 70B DAWSON 47D BAR-RZ 59T MR BOJANGLES 70B
BAR-RZ 56X MISS SPARKLE 79Z

CC 41Z MARION 72E GLENLEES 719T BARON 41Z
CC 16W MARION 87A



EPD's					
CE	BW	WW	YW	M	TM
+9.2	+1.4	+49.0	+87.0	+15.8	+40.3

Exposed to PCL 901 Kentucky Gent 7K from June 21 to September 4, 2023.

36K

CC 8F NICOLE 36K

Polled Born: April 2, 2022

LAMPORT'S 33D FORMULA 8F LAMPORT'S Y12 DOZER 33D
TCF KLR 8Z SHE'S A DIME 424B

CC 80Z NICOLE 130B LCI 8116 RANGER 80Z
CC 42S NICOLE 172W



EPD's					
CE	BW	WW	YW	M	TM
+4.2	+3.5	+51.8	+84.7	+20.7	+46.6

Exposed to Critt Option 28K from June 21 to September 4, 2023.

49K

CC 35G NICOLE 49K

Polled Born: April 4, 2022

FCI 646D GAME ON 35G CHURCHILL ROCK 646D ET
FCI MISS SENSATION 40Z

CC 82E NICOLE 44G STANDARD-HILL 4Y MATER 82E
CC 3C NICOLE 13E



EPD's					
CE	BW	WW	YW	M	TM
+0.5	+4.5	+49.3	+78.8	+22.7	+47.4

Exposed to Critt Option 28K from June 21 to September 4, 2023.

52K

CC 3G JEWEL 52K

Polled Born: April 4, 2022

CC 47D EASY 3G BAR-RZ 70B DAWSON 47D
CC 25X JESSICA 13A

CC 25Y JEWEL 78A CC 281W FREIGHTLINER 25Y
CC 206P JEWEL 47X



EPD's					
CE	BW	WW	YW	M	TM
+0.2	+4.7	+51.1	+84.8	+25.3	+50.9

Exposed to Critt Option 28K from June 21 to September 4, 2023.

55K

CC 35G JEWEL 55K

Horned Born: April 4, 2022

FCI 646D GAME ON 35G

CHURCHILL ROCK 646D ET
FCI MISS SENSATION 40Z

CC 82E JEWEL 61G

STANDARD-HILL 4Y MATER 82E
CC 97B JEWEL 137E



EPD's					
CE	BW	WW	YW	M	TM
-6.5	+8.0	+55.2	+87.0	+25.5	+53.1

Exposed to Critt Option 28K from June 21 to September 4, 2023.

65K

CC 15D WENDY 65K

Horned Born: April 6, 2022

LRD SCRIPT COMMANDER 15D

FA SCRIPT BRITISHER 128Z
LRD ANNIE 48A

CC 47D WENDY 168F

BAR-RZ 70B DAWSON 47D
CC 20X WENDY 5C



EPD's					
CE	BW	WW	YW	M	TM
+10.3	+0.5	+54.8	+77.9	+23.5	+50.9

Exposed to PCL 901 Kentucky Gent 7K from June 21 to September 4, 2023.

66K

CC 35G KALLIE 66K

Polled Born: April 6, 2022

FCI 646D GAME ON 35G

CHURCHILL ROCK 646D ET
FCI MISS SENSATION 40Z

CC 23A KALLIE 81G

MCCOY 70Y LANDSCAPE 23A
CC 25X KALLIE 32A



EPD's					
CE	BW	WW	YW	M	TM
-6.3	+6.7	+60.4	+97.0	+22.1	+52.3

Exposed to Critt Option 28K from June 21 to September 4, 2023.

74K

CC 8F WENDY 74K

Polled Born: April 7, 2022

LAMPORT'S 33D FORMULA 8F

LAMPORT'S Y12 DOZER 33D
TCF KLR 8Z SHE'S A DIME 424B

CC 85X WENDY 135A

HARVIE TRAVELER 85X
CC 403P WENDY 30T



EPD's					
CE	BW	WW	YW	M	TM
-2.4	+7.3	+65.5	+106.4	+17.8	+50.6

Exposed to Critt Option 28K from June 21 to September 4, 2023.

78K

CC 47D JESSICA 78K

Polled Born: April 7, 2022

BAR-RZ 70B DAWSON 47D BAR-RZ 59T MR BOJANGLES 70B
BAR-RZ 56X MISS SPARKLE 79Z

CC 20X JESSICA 2C JEN 195T KAP 20X
CC 25X JESSICA 13A



EPD's					
CE	BW	WW	YW	M	TM
+10.4	+1.4	+55.2	+89.3	+24.3	+51.9

Exposed to CC 8F Easy 131J from June 21 to September 4, 2023.

79K

CC 1F LEAH 79K

Polled Born: April 7, 2022

CC 3C EASY 1F CC 20X EASY 3C
CC 41Z DAPHNE 62D

CC 47D LEAH 50H BAR-RZ 70B DAWSON 47D
CC 25X LEAH 43B



EPD's					
CE	BW	WW	YW	M	TM
+10.7	+0.3	+47.3	+76.8	+22.9	+46.6

Exposed to PCL 901 Kentucky Gent 7K from June 21 to September 4, 2023.

88K

CC 15D JESSICA 88K

Polled Born: April 8, 2022

LRD SCRIPT COMMANDER 15D FA SCRIPT BRITISHER 128Z
LRD ANNIE 48A

CC 82E JESSICA 7G STANDARD-HILL 4Y MATER 82E
CC 18B JESSICA 100E



EPD's					
CE	BW	WW	YW	M	TM
+0.6	+4.8	+57.1	+81.8	+19.1	+47.7

Exposed to CC 8F Easy 131J from June 21 to September 4, 2023.

101K

CC 35G LEAH 101K

Horned Born: April 11, 2022

FCI 646D GAME ON 35G CHURCHILL ROCK 646D ET
FCI MISS SENSATION 40Z

CC 3C LEAH 10G CC 20X EASY 3C
CC 23A LEAH 104E



EPD's					
CE	BW	WW	YW	M	TM
+5.2	+2.3	+48.5	+79.6	+23.3	+47.6

Exposed to Critt Option 28K from June 21 to September 4, 2023.

107K

CC 1F PEARL 107K

Polled Born: April 12, 2022
 CC 3C EASY 1F CC 20X EASY 3C
 CC 41Z DAPHNE 62D
 CC 50F PEARL 122H DONORAH 203A LUX LADD 50F
 CC 23A PEARL 70C



EPD's					
CE	BW	WW	YW	M	TM
+6.6	+1.6	+53.6	+80.9	+24.8	+51.6

Exposed to CC 8F Easy 131J from June 21 to September 4, 2023.

109K

CC 15D JEWEL 109K

Horned Born: April 12, 2022
 LRD SCRIPT COMMANDER 15D FA SCRIPT BRITISHER 128Z
 LRD ANNIE 48A
 CC 41Z JEWEL 59E GLENLEES 719T BARON 41Z
 CC 14N JEWEL 327U



EPD's					
CE	BW	WW	YW	M	TM
+0.2	+4.8	+58.6	+87.9	+22.0	+51.3

Exposed to PCL 901 Kentucky Gent 7K from June 21 to September 4, 2023.

115K

CC 8F JULIANA 115K

Polled Born: April 13, 2022
 LAMPORT'S 33D FORMULA 8F LAMPORT'S Y12 DOZER 33D
 TCF KLR 8Z SHE'S A DIME 424B
 CC 25X JULIANA 158B LCI 107R STONEWALL 25X
 CC 13S JULIANA 51U



EPD's					
CE	BW	WW	YW	M	TM
-1.8	+5.1	+55.5	+90.3	+24.2	+52.0

Exposed to Critt Option 28K from June 21 to September 4, 2023.

120K

CC 3G LYDIA 120K

Horned Born: April 14, 2022
 CC 47D EASY 3G BAR-RZ 70B DAWSON 47D
 CC 25X JESSICA 13A
 CC 25Y LYDIA 123A CC 281W FREIGHTLINER 25Y
 CC 146U LYDIA 26X



EPD's					
CE	BW	WW	YW	M	TM
-4.8	+7.0	+54.5	+86.5	+28.7	+56.0

Exposed to Critt Option 28K from June 21 to September 4, 2023.

121K

CC 15D NICOLE 121K

Polled Born: April 14, 2022

LRD SCRIPT COMMANDER 15D FA SCRIPT BRITISHER 128Z
LRD ANNIE 48A

CC 23A NICOLE 33G MCCOY 70Y LANDSCAPE 23A
CC 80Z NICOLE 104C



EPD's					
CE	BW	WW	YW	M	TM
-0.3	+5.1	+65.3	+105.1	+15.5	+48.2

Exposed to PCL 901 Kentucky Gent 7K from June 21 to September 4, 2023.

139K

CC 35G PRINCESS 139K

Polled Born: April 17, 2022

FCI 646D GAME ON 35G CHURCHILL ROCK 646D ET
FCI MISS SENSATION 40Z

CC 15D PRINCESS 60G LRD SCRIPT COMMANDER 15D
CC 23A PRINCESS 95D



EPD's					
CE	BW	WW	YW	M	TM
-7.0	+8.0	+64.5	+99.1	+21.8	+54.1

Exposed to Critt Option 28K from June 21 to September 4, 2023.

140K

CC 8F NICOLE 140K

Polled Born: April 17, 2022

LAMPORT'S 33D FORMULA 8F LAMPORT'S Y12 DOZER 33D
TCF KLR 8Z SHE'S A DIME 424B

CC 16W NICOLE 58A CC 268P PATHFINDER 16W
CC 129D NICOLE 159K



EPD's					
CE	BW	WW	YW	M	TM
+9.0	+2.3	+47.1	+78.7	+18.6	+42.2

Exposed to Critt Option 28K from June 21 to September 4, 2023.

149K

CC 3G KALLIE 149K

Polled Born: April 19, 2022

CC 47D EASY 3G BAR-RZ 70B DAWSON 47D
CC 25X JESSICA 13A

CC 23A KALLIE 85D MCCOY 70Y LANDSCAPE 23A
CC 77J KALLIE 20T



EPD's					
CE	BW	WW	YW	M	TM
-2.4	+5.4	+59.2	+98.5	+16.0	+45.6

Exposed to CC 8F Easy 131J from June 21 to September 4, 2023.

168K

CC 8F PAULA 168K

Polled Born: April 27, 2022

LAMPOR'T'S 33D FORMULA 8F LAMPOR'T'S Y12 DOZER 33D
TCF KLR 8Z SHE'S A DIME 424B

CC 14N PAULA 116W SILVER 23K NEON 14N
LCI 157K RIBSTONE GAL 45R



EPD's					
CE	BW	WW	YW	M	TM
+0.1	+5.6	+51.1	+89.3	+23.0	+48.6

Exposed to Critt Option 28K from June 21 to September 4, 2023.

171K

CC 15D LYDIA 171K

Horned Born: April 27, 2022

LRD SCRIPT COMMANDER 15D FA SCRIPT BRITISHER 128Z
LRD ANNIE 48A

CC 41Z LYDIA 34F GLENLEES 719T BARON 41Z
CC 146U LYDIA 26X



EPD's					
CE	BW	WW	YW	M	TM
-2.5	+6.1	+61.8	+91.9	+22.3	+53.2

Exposed to Critt Option 28K from June 21 to September 4, 2023.

173K

CC 3G LEAH 173K

Polled Born: April 28, 2022

CC 47D EASY 3G BAR-RZ 70B DAWSON 47D
CC 25X JESSICA 13A

CC 41Z LEAH 86D GLENLEES 719T BARON 41Z
CC 56M LEAH 82W



EPD's					
CE	BW	WW	YW	M	TM
+4.5	+3.5	+53.5	+92.2	+22.6	+49.4

Exposed to Critt Option 28K from June 21 to September 4, 2023.

175K

CC 47D PRINCESS 175K

Polled Born: April 29, 2022

BAR-RZ 70B DAWSON 47D BAR-RZ 59T MR BOJANGLES 70B
BAR-RZ 56X MISS SPARKLE 79Z

CC 7B PRINCESS 6E HILLS-GALORE 107W RIO 7B
CC 25Y PRINCESS 9C



EPD's					
CE	BW	WW	YW	M	TM
+8.3	+0.8	+48.6	+88.3	+20.3	+44.6

Exposed to PCL 901 Kentucky Gent 7K from June 21 to September 4, 2023.

177K

CC 3G JULIANA 177K

Horned Born: May 1, 2022

CC 47D EASY 3G

BAR-RZ 70B DAWSON 47D
CC 25X JESSICA 13A

CC 85X JULIANA 55Z

HARVIE TRAVELER 85X
CC 56M JULIANA 36T

EPD's					
CE	BW	WW	YW	M	TM
-7.5	+8.0	+70.1	+109.2	+22.2	+57.3

Exposed to CC 8F Easy 131J from June 21 to September 4, 2023.



186K

CC 111H PRINCESS 186K

Polled Born: May 18, 2022

LAMPOR'T'S 49E HARVEST 111H

LAMPOR'T'S 82W CHALLENGER 49E
LAMPOR'T'S 23X SARA 112A

CC 18B PRINCESS 139G

CC 90X EASY 18B
CC 85X PRINCESS 69A

EPD's					
CE	BW	WW	YW	M	TM
-10.7	+10.0	+77.7	+118.9	+22.1	+61.0

Exposed to PCL 901 Kentucky Gent 7K from June 21 to September 4, 2023.



TERMS & CONDITIONS

Sale Time: Sale opens Friday, December 9, 2023 at 8:00 am MST and closes Saturday, December 9 at 7 pm MST on DLMS Farm Gate Timed Auction with a racehorse style close with extended bidding.

Contacts and Phone Bids: If you have questions on how the timed online sale works or would like to bid by phone, contact Randy Radau 403-588-6160 (cell) or 403-227-2259 (home) or Luke Radau 403-506-6295 or Mark Shologan from DLMS 780-699-5082.

Health and Fertility: All heifers were pregnancy tested safe in calf on October 30 and treated with Biomectin. They have been vaccinated with Express 5 and Tasvax 8 before breeding.

Delivery and Pickup: Free delivery on purchases of 5 heifers or more within 300 km of the farm. Buyers are responsible for pickup at the farm of purchases of less than 5 head.

Payment: The winning bidders will be contacted as soon as possible after the sale close. We accept cheque or e-transfer as payment.







**BETTER
YOUR BEEF**

HEREFORD