

006207

Book 477

840

RESTRICTIVE COVENANTS APPLYING TO THE SUBDIVISION NAMED KEENELAND,
SECTION I, EIGHTEENTH CIVIL DISTRICT OF RUTHERFORD COUNTY, TENNESSEE

Keeneland Limited Partnership, being the owner in fee simple of the real estate that has been subdivided and named Keeneland, Section I, according to a survey and plat of same made by W. Henry Huddleston, III, Civil Engineer, which plat is of record in Plat Book 15 page 81, Register's Office of Rutherford County, Tennessee, and which plat is made a part hereof by reference, does hereby agree and bind itself, its successors and assigns, that the following restrictions, limitations and covenants shall be binding on all purchasers of lots in said Keeneland, Section I, their heirs and assigns, as follows:

LOT USAGE

1. No lot may be used for any purpose except for the construction and maintenance of a residential building, and no such residential structure on any such lot shall be designed, constructed or used for more than one family.
2. No lot shall be resubdivided, but shall remain as shown on the recorded plat and not more than one residence building may be constructed or maintained on any one lot. A slight variance in the property lines may be made by adjacent owners, but not for the purpose of subdividing into more lots.
3. No noxious or offensive operations shall be conducted or maintained on any lot and nothing shall be constructed, reconstructed or kept on any lot which may constitute an annoyance or nuisance to the neighborhood.
4. No animals or livestock of any kind shall be allowed or maintained on any lot, except that dogs, domestic cats, or other household domestic pets may be kept, provided that they are not kept for commercial purposes. No poultry of any kind or description shall be allowed or maintained on any lot at any time for any purpose.
5. No trailer, basement house, tent, garage, barn, or other outbuilding shall be erected or used as either a temporary or permanent residence.
6. The developers of this subdivision, or their assigns, or the Architectural Review Committee, or its designees, reserve the right to enter upon any lot for the purpose of cutting grass, trimming trees and shrubs or generally cleaning up such lot if the same reasonably requires, charging the expense thereof to the owner thereof, which shall become a lien on the lot.
7. No sign of any kind shall be displayed on any lot except one non-illuminated sign of not more than four square feet advertising the property for sale or rent.

This instrument was prepared by:
JURFREE, COPE & MOORE, ATTORNEYS
Murfreesboro, Tennessee
From Information Furnished by the Parties

8. All yard areas and landscape easements must be maintained in a neat and orderly fashion.

LOT IMPROVEMENTS

9. The minimum square feet of living area in one-story dwellings shall be 1600 square feet; provided however there must be an attached garage under roof.

One and one-half (1 1/2) story, two (2) story or split level dwellings shall contain a minimum of 1800 square feet of living area; provided however there must be an attached garage under roof and further provided, the minimum ground floor living area shall contain 900 square feet.

10. Also, dwellings must be at least 75% brick, stucco, or drivit exterior finish with said masonry extending to grade level. All garage doors must be of the highest aesthetic quality and design and the owner shall be required to install and maintain an operational garage door opener), and all garage doors shall remain closed, except for actual ingress or egress therein. There shall be no detached garages or other accessory buildings constructed or located on the premises without written approval from Architectural Review Committee (other than one dog house if same receives unanimous approval of the committee).

11. Any structure which is preassembled or already constructed and which a lot owner desires to move onto a lot covered by these restrictions must receive the prior unanimous approval of the Architectural Review Committee (sometimes hereinafter and the hereinabove referred to as "the Committee"), which approval may be withheld on the subjective grounds that the structure does not conform to the character and general atmosphere of the subdivision, even though said structure may meet all minimum square footage and other requirements.

12. A. No building shall be constructed or maintained on any lot (i) in any reserved drainage utility or landscape easement area; or (ii) closer to the street than the setback line as shown on the recorded plat; unless authorized by Architectural Review Committee and Board of Zoning Appeals where applicable.

B. Once construction has commenced, it shall proceed diligently. Owner is responsible for maintaining a neat and orderly construction site.

13. A. The only fences which shall be permitted on lots shall be those erected with the express prior written approval of the Committee, which is charged to ensure that said fences conform to the general character and atmosphere of the neighborhood. The Committee may require, as a condition of approval, the use of hedges or other greenery as screening for

the fence. All fences must be maintained in good repair, and landowners agree to abide by reasonable requests for repairs and maintenance as may be made by the Architectural Review Committee.

B. On all lots except corner lots, no fence shall be permitted between the front building or setback line and the street. However, the use of hedges, shrubbery or evergreens as a fence, or in lieu of a fence, and extending to the front or sides of any lot is permitted, PROVIDED such hedges, shrubbery or evergreens shall not be permitted to be in excess of forty-two (42) inches in height. On all corner lots, no fence shall be permitted between either building or setback line and either street. In the event a landowner incorporates any utility, landscape or drainage easement shown on the recorded plat of Keeneland, Section I, within the boundaries of a fence, the inclusion of this area shall be done in such a manner so as not to interfere with any drainage on or other use of said easement.

14. All driveway entrances from the street to each lot shall conform to the following standards: The entrances from the street to each lot shall be sixteen (16) feet in width with concrete apron running back three (3) feet from the entrance at street and tapering back to no less than twelve (12) feet in width to garage entry. The driveway including any turn around area must be constructed of concrete. A temporary gravel drive shall be constructed from the street to the side of the proposed dwelling before or at the time construction of said dwelling is commenced.

15. No dwelling shall be constructed on any lot closer than ten (10) feet to either side of lot line.

16. All dwellings constructed on any lot shall have a full masonry foundation.

17. All exterior chimneys shall be of brick, stucco, or drivet.

18. All mail boxes shall be of same design in the subdivision. The Architectural Review Committee shall designate the design of the mail boxes and recommend a source for the selected mailboxes.

*Architectural Review Committee shall have the right to attach a lien to the lot for failure of maintenance fee payments.

19. Swimming pools shall be no nearer than fifteen (15) feet to any lot line and must be located to the rear, side or enclosed within the main dwelling. All swimming pools shall be fenced for safety.

20. Incinerators for garbage, trash, or other refuse shall not be used or permitted to be erected or placed on any lot. All equipment, coolers and garbage cans shall be walled or

otherwise suitably screened, to conceal the same from the view of the neighboring lots, roads, streets and open areas.

21. No lot owner may construct or place any dwelling, outbuilding, clothes line, satellite dish, fence or any other structure, pen or enclosure, (specifically excluding basketball goals as long as the goal is placed in the backyard only), on the lot owner's property without the prior written approval by the Architectural Review Committee of the elevation or exterior design, colors, location and building material. It is the intent of these restrictions that this committee shall insure a uniform, aesthetically pleasing subdivision without the utilization of garish colors or architectural designs. The Architectural Review Committee is empowered to waive provision of these restrictions for good cause shown; provided, however, that this power shall not extend to reducing the minimum square footage as specified in paragraph 9 hereof.

ARCHITECTURAL REVIEW COMMITTEE

22. There is hereby appointed an Architectural Review Committee to be comprised of three individuals. The initial committee shall be composed of John Harney, Bob Parks, and Fred Lovelace. Each committee member shall serve a three-year term, with the initial terms expiring on the following dates: Fred Lovelace (December 31, 1992); Bob Parks (December 31, 1993); and John Harney (December 31, 1994). As each member's term expires, or if a member resigns or leaves the subdivision, a new committee member shall be chosen by the two remaining members to serve a three-year term or complete the present term. No member shall serve more than two full successive terms. All members other than those above named must own, in their own name or jointly with their spouse, a subdivided lot in Keeneland Subdivision, regardless of the section.

23. The operation, care, beautification, upkeep and landscape maintenance of the dedicated entrance areas, walls and fences of the subdivision are initially charged to and the responsibility of the Architectural Review Committee. The Architectural Review Committee is hereby specifically authorized to charge and collect a maintenance fee from all lot owners in order to pay the expenses of said operation, care, beautification, upkeep and maintenance. This maintenance fee as charged shall be the same amount for each lot in Section I, regardless of size or sales price.*

24. It is expressly covenanted and agreed that the Architectural Review Committee shall have the jurisdiction and authority to determine the existence of noxious or offensive operations or an annoyance or nuisance, but only after an opportunity for a hearing before the

Committee is given for the persons or individuals charged with conducting a noxious or offensive operation or an annoyance or nuisance to the neighborhood. All lot owners shall be notified of the time and place of the hearing and will be allowed an opportunity to express their opinion. Refusal to abide by the decision of the Committee shall be deemed a breach of these covenants and shall authorize any lot owner or the Committee to proceed in a court of competent jurisdiction to obtain such protective orders and damages as are appropriate under the circumstances then and there existing.

25. The members of the Architectural Review Committee shall not be liable to lot owners for any mistake of judgment, negligence or otherwise, except for their individual and willful misconduct or bad faith. The members of the Architectural Review Committee shall not receive any compensation for their services thereon.

EASEMENTS

26. A perpetual easement is reserved on each lot five (5) feet in width contiguous and parallel to each side lot line and twenty (20) feet contiguous and parallel to each rear lot line for the construction and maintenance of utilities, such as drainage, electricity, gas, water main, sewage, etc., and no structure of any kind shall be erected or maintained upon or over said easement.

27. A thirty (30) foot landscape berm and/or fencing easement is expressly reserved contiguous to and parallel with certain rear lot lines as per the recorded plat for the protection and screening of lots, and no structure of any kind shall be erected or maintained upon or over said easement without the consent of the Architectural Review Committee.

28. It is understood and agreed that all easements granted herein, or by deed, or identified in the recorded plat of Keeneland, Section I, may be used to service additional subdivision sections within all sections of Keeneland.

TERMINATION, EXPIRATION, AND AMENDMENT

29. If any of the provisions of this instrument are at any time declared void or inoperative by any Court of competent jurisdiction, the remaining provisions shall continue in full force and effect and shall not be otherwise affected.

30. The above covenants running with the land shall expire thirty (30) years from the date of recording of this instrument; but shall be deemed automatically renewed for an additional fifteen (15) years unless over 50% of the lot owners in this Section I agree in writing that the automatic renewal shall not occur.

31. These restrictions may be amended at any time by 51% of all Section I lot owners if a unanimous recommendation for the proposed amendment is made by the Architectural Review Committee, or 75% of all Section I lot owners otherwise.

IN WITNESS WHEREOF, said Bob Parks has caused this instrument to be executed this the 11th day of March, 1992.

KEENELAND LIMITED PARTNERSHIP

By: [Signature]
BOB PARKS, General Partner

STATE OF TENNESSEE
COUNTY OF RUTHERFORD

Before me, the undersigned authority, a Notary Public in and for the State and County aforesaid, BOB PARKS, with whom I am personally acquainted (or proved to me on the basis of satisfactory evidence), and who, upon his oath, acknowledged himself to be the General Partner of KEENELAND LIMITED PARTNERSHIP, the within named bargainor, a partnership, and he as such partner, being authorized so to do, executed the foregoing instrument (RESTRICTIVE COVENANTS APPLYING TO THE SUBDIVISION NAMED KEENELAND, SECTION I) for the purposes therein contained by signing the name of the partnership by himself as such partner.

WITNESS MY HAND and official seal at my office on this the 11th day of March, 1992.

[Signature]
Notary Public



My commission expires: 12-12-94

BART YEARGAN, REGISTER RUTHERFORD COUNTY, TENNESSEE	
Received	<u>March 13</u> 19 <u>92</u>
Time	<u>8:01</u> <u>A.</u> M.
Notebook	<u>41</u> Page <u>58</u>
Deed	BOOK <u>477</u> PAGE <u>840</u>
Deputy	<u>Martha E. Wright</u>

RECORDING FEE	<u>24.00</u>
STATE TAX	<u>-</u>
REGISTER'S FEE	<u>-</u>
TOTAL PAID	<u>24.00</u>
RECEIPT NO.	<u>43000</u>

006134

Black Box Elementary

Bench Mark
Top of Fire Hydrant
Elev. 620.48

Kensington
Sec. II
93

MTSU Foundation

MANCHESTER SITE

LOCATION MAP
N.T.S.

006134

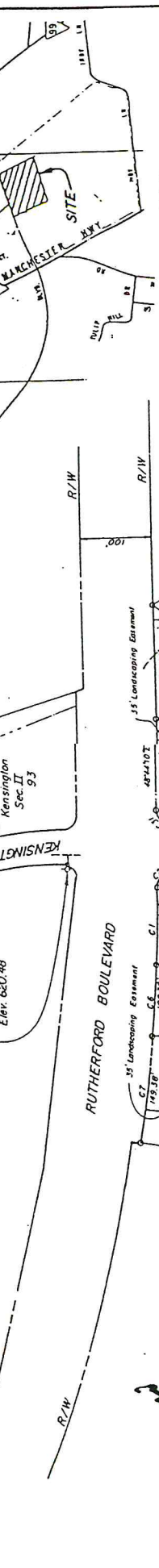

006134

006134

006134

006134

006134

006134

006134

006134

006134

006134

006134

006134

006134

006134

006134

006134

006134

006134

006134

006134

006134

006134

006134

006134

006134



Loi Calculations & Field Staking by:
FRANCIS-STEELE ASSOCIATES

- NOTES:
1. No driveways will be permitted along Rutherford Boulevard on lots 1-3 and 18-20.
 2. Floor elevation certification will be required for lots 19-27.
 3. NO FILL CERTIFICATION by a registered engineer will be required of developers, builders, contractors and individuals, however, bonds or release of certificates of occupancy for lots 19-27 provided, however, fill may be placed below the 100-year flood line if accompanied by an engineer registered in the State of Tennessee. Any disturbances on individual lots will require erosion and siltation control as per the City's standards.

CURVE DATA		
No.	Radius	Length
C1	100.00'	110.18'
C2	100.00'	110.18'
C3	100.00'	110.18'
C4	100.00'	110.18'
C5	100.00'	110.18'
C6	100.00'	110.18'
C7	100.00'	110.18'
C8	100.00'	110.18'
C9	100.00'	110.18'
C10	100.00'	110.18'
C11	100.00'	110.18'
C12	100.00'	110.18'
C13	100.00'	110.18'
C14	100.00'	110.18'
C15	100.00'	110.18'
C16	100.00'	110.18'
C17	100.00'	110.18'
C18	100.00'	110.18'
C19	100.00'	110.18'
C20	100.00'	110.18'
C21	100.00'	110.18'
C22	100.00'	110.18'
C23	100.00'	110.18'
C24	100.00'	110.18'
C25	100.00'	110.18'
C26	100.00'	110.18'
C27	100.00'	110.18'
C28	100.00'	110.18'
C29	100.00'	110.18'
C30	100.00'	110.18'
C31	100.00'	110.18'
C32	100.00'	110.18'
C33	100.00'	110.18'

BART YARHAM, REGISTERED
RUTHERFORD COUNTY, TENNESSEE
Received March 13, 1992
Time 8:00 Page 54
PLAT BOOK 15 PAGE 81
Deputy Matthew W. Wray

RS 12 Zoning	
Min. Bldg. Setback Lines	Min. Floor Elev.
Front 35'	Lot No. 19-27
Side 10'	Elev. 616.0
Rear 30'	

100' 0' 100'
Steel Pin
27 LOTS-126 AC.

Developer: Bob Parks
1535 W. Northfield Blvd.
Memphis, TN, 37129
Tax Map: 112
Parcel: 3.00
Flood Map: 47063-0105B
Zone: C



18th Civil District • Rutherford County • Tennessee
DATE May, 1991 SCALE 1"=100' SHEET 1 OF 1

SECTION I

PLAT BK: 15 PAGE: 81