

POST DRIVERS

Montana Post Driver

750R: \$6,200

1000E: \$8,300

1500E: \$10,500

10 **FREE** Brace  
Rails with  
Purchase

Redi  
Driver  
Classic

T-Rex Post  
Driver



CATTLE HANDLING

Head Catch: \$895

Maternity  
Pen: \$4,920

Portable  
alleyway, tub,  
and headgate

Portable Panel  
Trailer: \$2,200

Portable  
Loading  
Chute

LIVESTOCK  
EQUIPMENT



Heavy Duty Hay  
Feeders

Calf Shelters  
8-ft x23-ft  
\$2,800



Portable  
Buildings

12x24-ft All  
steel portable  
buildings use  
for horse sheds, calving sheds,  
storage, etc.



Guardrail  
Portable  
Windbreaks  
\$1,275

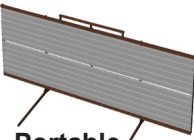

Portable  
Windbreaks \$875

Rubber Tire  
Water Tanks:  
12.5-ft &  
1,725-gal



Mineral  
Feeders

Feedbunks 20-ft x 38-  
in x 12-in (constructed  
with 10ga & heavy tube legs) other  
sizes & bottomless available



Cattle Guards

Constructed with all new  
material.  
10-ft \$1,625  
12-ft \$1,875  
16-ft \$2,225  
Cattle guard kits with  
used pipe available



10-ft \$940  
12-ft \$1,050  
16-ft \$1,395

Portable Panels All panels are  
constructed with 12 & 14ga 1.66" OD  
tubing 10-ft heavy portable panels, 12-ft  
standard portable panels (Will latch to  
Winkel panels)

FENCING

Suspension Fencing -

A more durable &  
lower  
maintenance  
alternative with  
Polyethylene  
Superstays and  
Superconnector  
Posts



Continuous Fence

6-rail 1-1/4" 14ga.  
20-ft long \$108  
6-rail 1.66" 14 ga  
20-ft long \$132



SuperSteel / Steel

Decking 36"x24' 22ga  
Prime galvanized Super  
Steel Use for  
windbreaks,  
corrals, etc.  
\$108 by the



Bolt together fence  
brace kits



Brace rail with  
hardware \$29  
Complete brace  
with 8-ft posts \$59 |  
Wire gate latches  
for 2-7/8 posts \$18

POSTS 2-7/8" x 6-ft \$11  
2-7/8" x 8-ft \$15.50  
2-7/8" x 10-ft \$19  
5-in galvanized octagon 9'9" posts \$26  
Pipe posts can be cut to length.

Used guardrail 2-rail & 3-rail

Guardrail  
Galvanized  
I-Beam Posts  
9-ft \$25



GATES

All gates are constructed  
with 12 & 14 ga 1.66"  
OD tubing  
10-ft bow gates \$295  
12-ft bow gates \$330  
Corral gates - 6-bar  
8-ft \$180  
10-ft \$190  
12-ft \$210  
14-ft 230  
16-ft \$250

# HEDMAN INC

## AG & STEEL SUPPLY

406.390.1110

CALL US FOR ALL YOUR STEEL NEEDS!

STEEL

Pipe, Tubing (Round & Square) & Angle Iron



5" Galvanized octagon tubing (39-ft

Used 2-7/8 pipe

Semi load  
quantities of used  
2-7/8 pipe  
available -  
Call for delivered  
prices!



1.25" 14ga round tubing  
1.66" 14ga round tubing



3-1/2" used pipe 31-ft

Pipe Caps in  
various sizes

Secondary  
Square Tubing  
Various sizes  
available

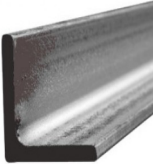

Angle  
Iron  
2x2x.120 &  
2x3x.250 20-  
ft lengths  
\$0.56/lb

A lot more steel...too  
much to list - Call us  
for details!

ATTACHMENTS



Pallet Forks



Bale spears



Box

MISCELLANEOUS



Shipping  
Containers 40-ft  
New \$8,300

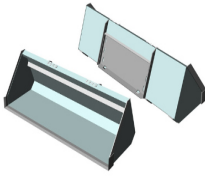

Skidsteer SNOW  
Buckets (constructed  
with 3/16-in plate) 8-ft:  
\$1,150 & 10-ft: \$1,350

2.5-gal Water Fire  
Extinguishers: \$120

Extinguisher Mount: \$120



Buckhorn  
Centerflow  
Seed Boxes

Bale Spears: \$85

2"x27' Ratchet Strap: \$13

5/16" Grade 70 Transport Chain:  
20' @ \$36.50



Diablo Metal &  
Wood Cutting  
Saw Blades



3/8" Grade 70 Transport Chain: 20'  
@ \$50

Lever Chain Binders 5/16-3/8": \$25

Ratchet Chain Binders 5/16-3/8": \$30



Gopher Poison  
& Mouse  
Poison +



Poly DEF & Fuel Tanks



Tow Ropes:  
Various sizes up to  
200,000-lb  
breaking strength



Knipex Tools!

ESAB Wire Flux Core .045 \$4.30/lb

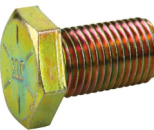

BOLTS \$2.77/lb Grade  
5 & \$4.40/lb Grade 8 |  
Metric bolt assortment  
with 72-hole bin \$680

Harrow  
6'x6'x5/8: \$630  
Drawbar: \$180



Steel Work  
Benches  
8-ft \$295



BATTERIES  
Stocking Heavy  
Equipment to 1/2-  
Ton Pickup  
Batteries



406.390.1110