

Download the IAqualink App., set up an account or login, then hit the + button in the top right corner. There is an "invite code." Once you do that, click the top button to add an RS system. It will take you to a screen that requires a number. The number is found on your Pool Maintenance sheet at the bottom where it says WIFI#. Enter that and name it whatever you want. BE SURE TO BE ON YOUR HOME NETWORK WHEN SETTING THIS UP FOR THE FIRST TIME.

### CONTROLLING THE POOL THROUGH THE IAQUALINK APP

This app is how you control and program all features of your pool. You can put it on any Ipad or device and use it as a remote.

1. Open the App to the HOME SCREEN – There are three buttons on the bottom – Home, Onetouch, and Equipment and there is one button on the top right called Web.

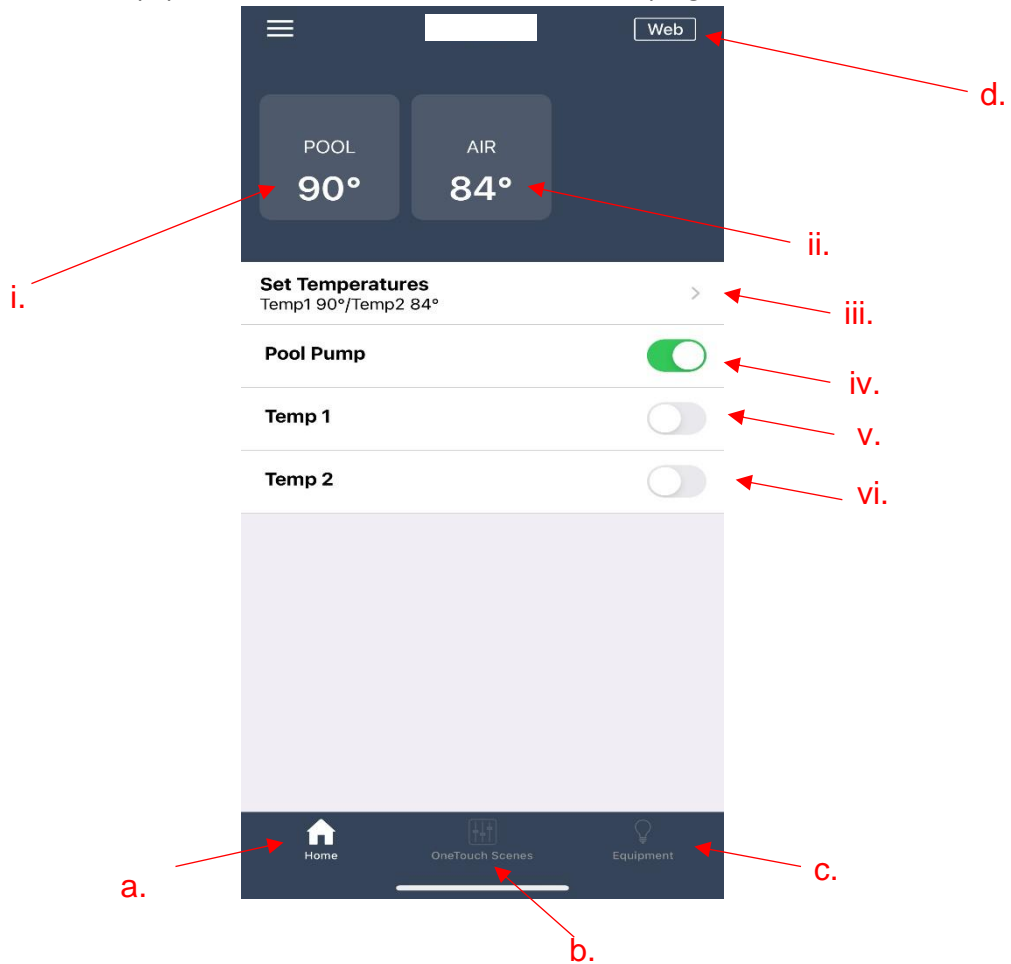

## 2. HOME

### a. HOME

- i. Pool Temperature – What the pool is currently at
- ii. Air Temperature – What the air temp is at the sensor near the equipment (not always what the temp is in you yard)
- iii. Set Temperatures
  1. Click the arrow to set your temp 1 or temp 2
- iv. Pool Pump – Should be on whenever the schedule is set (green means on)
- v. Temp 1 – Turn on to turn on the heater to this temp. The heater turns off once the pool reaches this temperature
  1. Pre-set temp that is easy to turn on
- vi. Temp 2 - Turn on to turn on the heater to this temp. The heater turns off once the pool reaches this temperature
  1. Pre-set temp that is easy to turn

### b. ONETOUCH – N/A

### c. EQUIPMENT – Go here to control the following (green means on):

- i. Lights
  - ii. Deck Jets
  - iii. Bubbler
  - iv. Bench Jets
- d. **Web** – Go here to change and/or see the following on the system (sometimes it takes a minute or two or five to load. Be patient...):



ii.

i.

- i. Status- Bottom right. Tells you what is on and what your salt count is in Parts Per Million (PPM)
- ii. Menu – Second from the left. Go here to change the following:
  1. Schedule – When the pump turns on and off. Go to Schedule and change the start and stop times. Your system should run approximately 8-10 hours per day everyday or more.
  2. Set Aquapure – Go here to change the salt Pool salt %.
    - a. Click the word “Pool” and then change the % of salt produced. Lower the % as needed (if you test the water and it is high in chlorine and you have not added any liquid chlorine, your salt cell is producing more chlorine than needed so lower the %.
    - b. If you need a quick boost of chlorine, click “Quick Boost”