

Architect -
 Civil Eng -
 Mech Eng -
 Interior -

GENERAL NOTES

- All dimensions in millimetres (mm)
- Verify all dimensions
- Do not scale drawings
- Check drawings against specifications
- Use the latest revised drawings only
- Report any discrepancies to the Landscape Architect before proceeding
- Drawings and specifications are the property of the Landscape Architect, and must be returned upon completion of the work

LEGEND - PAVING

	Pedestrian strength Unit Paving - Running bond Industria Smooth by Techo-Bloc® Size - 300mm x 100mm Color - Beige Cream SRI - 32	1 300
	Heavy-duty Unit Paving - Hearing bond pattern Industria Smooth by Techo-Bloc® Size - 300mm x 100mm Color - Grayed Nickel SRI - 35	2 300
	P.I.P. Concrete sidewalk Broom finish	3 300
	Tactile walking surface indicator	6 300
	Heavy-duty asphalt paving	5
	Heavy-duty concrete paving	7 300

PLANT SCHEDULE

DECIDUOUS TREES	QTY	BOTANICAL NAME	COMMON NAME	CONT	CAL	NATIVE	REMARKS	
AC	1	Acer x freemanii	Freeman Maple	W.B	70 mm	Native		
QR	3	Quercus rubra	Red Oak	W.B.	70 mm	Native		
DECIDUOUS SHRUBS	QTY	BOTANICAL NAME	COMMON NAME	CONT	SIZE	DROUGHT TOL.	REMARKS	
SP	3	Salix purpurea 'Nana'	Dwarf Arctic Willow	1 gal		Yes		
GRASSES	QTY	BOTANICAL NAME	COMMON NAME	CONT	SIZE	DROUGHT TOL.	SPACING	REMARKS
dec	34	Deschampsia cespitosa	Tufted Hair Grass	1 gal		Yes	750mm	

NOTE : IRRIGATION SYSTEM SHALL USE NON-POTABLE WATER

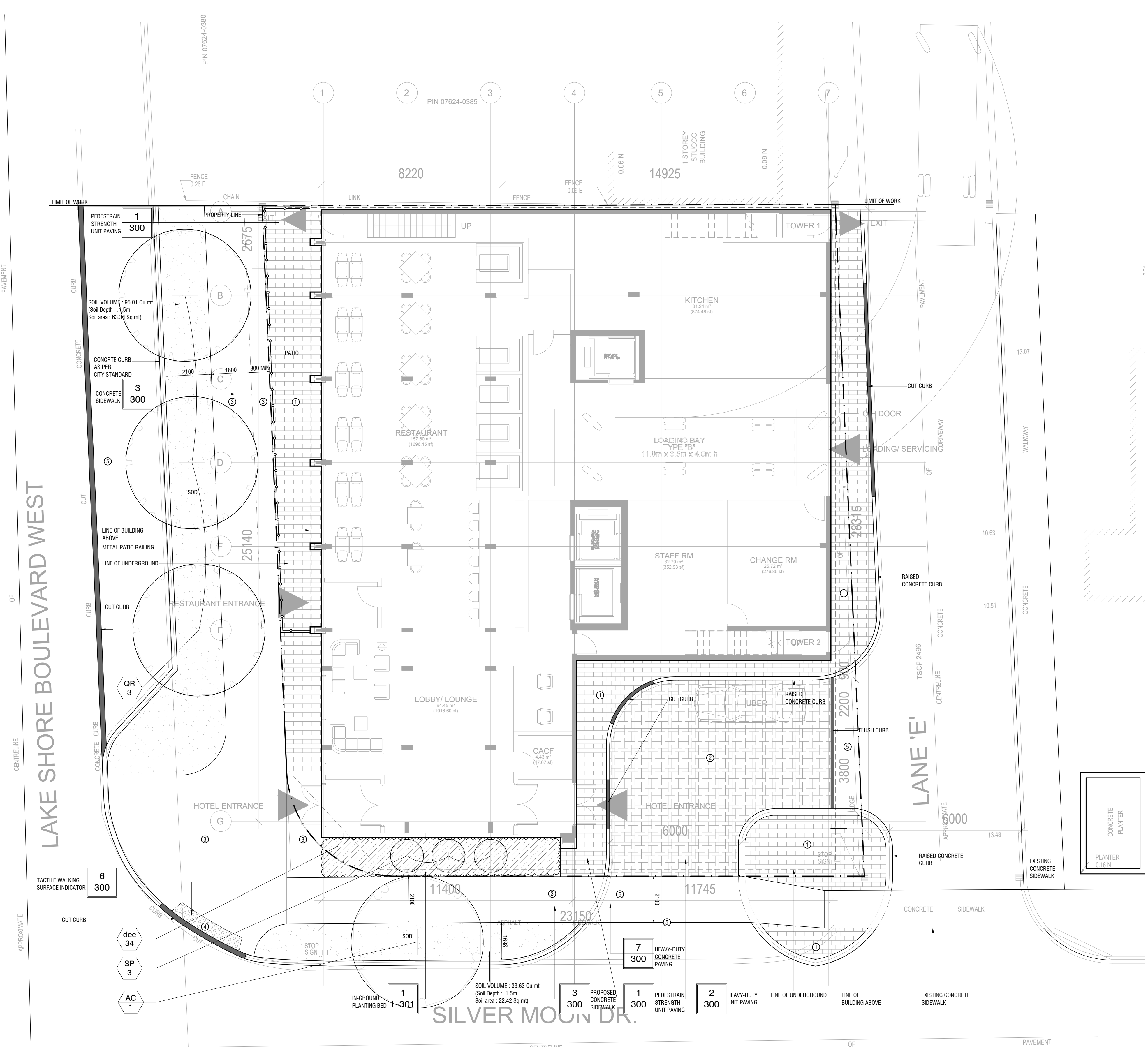

REV	DATE	DESCRIPTION	INITIAL
1	FEB.07.2020	Rezoning Submission -1	JSC/PYP

LANDSCAPE AND PLANTING PLAN

DRAWN BY: PYP
 CHECKED BY: JWV
 PRINT DATE: Feb.05.2020

L-100

2157 LAKESHORE BLVD W

LOCATION ALL CAPS
 CLIENT ALL CAPS

LAD-378
 12.10.2019

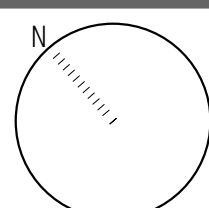

1:100

Architect -
Civil Eng -
Mech Eng -
Interior -

GENERAL NOTES

1. All dimensions in millimetres (mm)
2. Verify all dimensions
3. Do not scale drawings
4. Check drawings against specifications
5. Use the latest revised drawings only
6. Report any discrepancies to the Landscape Architect before proceeding
7. Drawings and specifications are the property of the Landscape Architect, and must be returned upon completion of the work

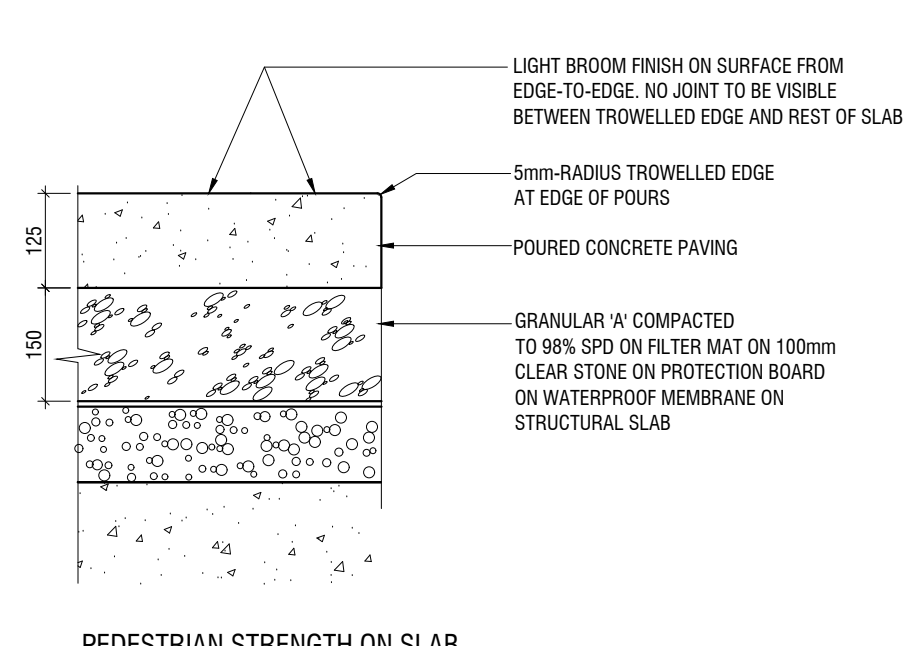
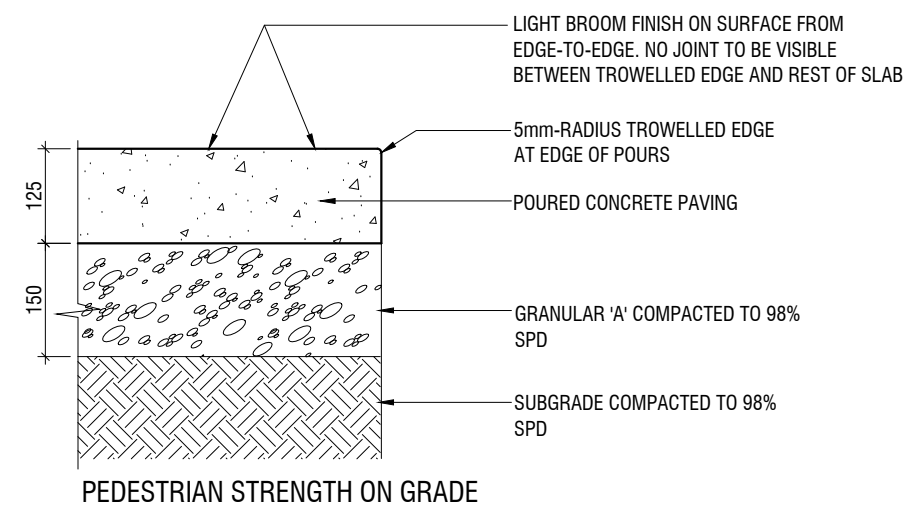
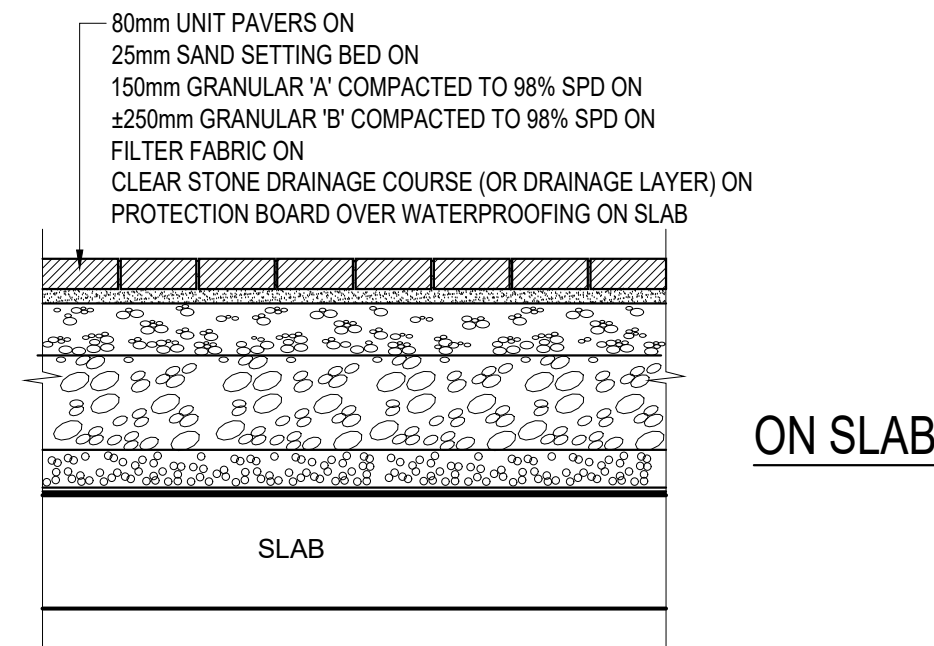
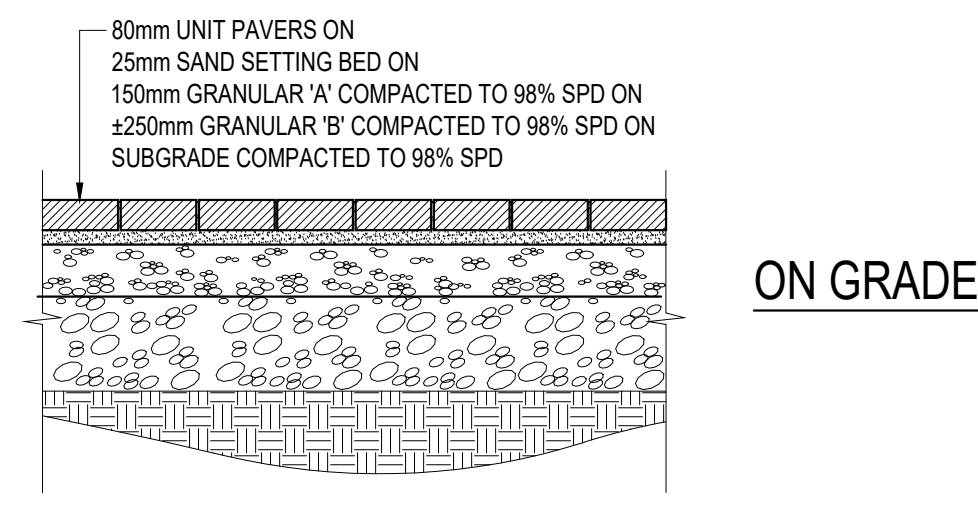
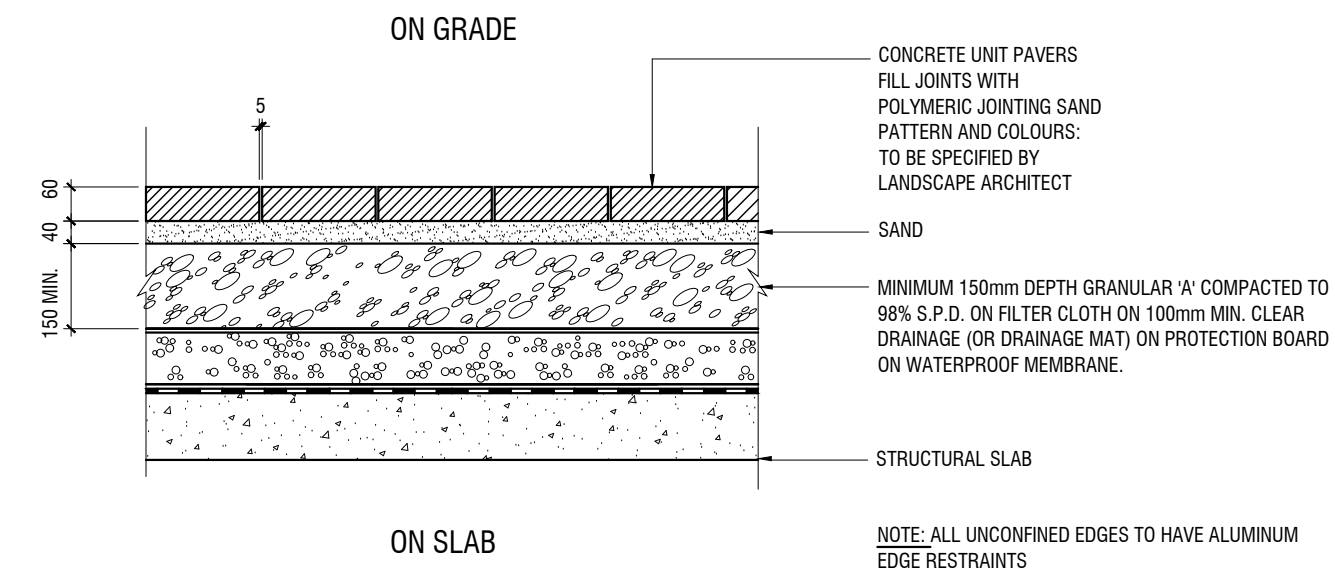
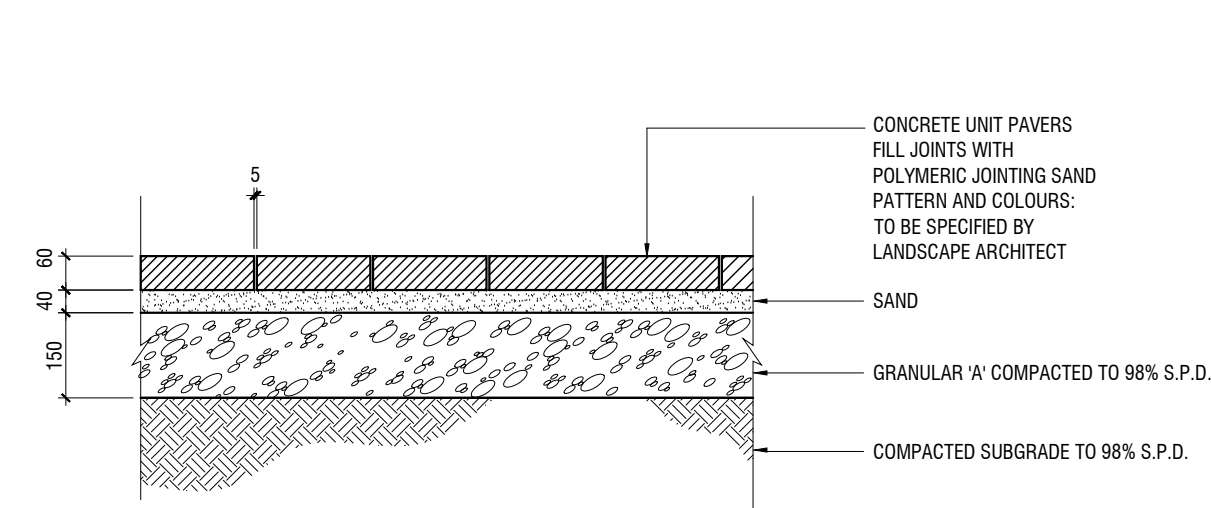

1
300 UNIT PAVING
N.T.S.

2
300 HEAVY-DUTY UNIT PAVING
1:20 321401-01

3
300 PEDESTRIAN STRENGTH CONCRETE
1:10 321313.01-03

NOTE:
CONTRACTOR TO MOCK-UP IN-PLACE SAMPLE FOR APPROVAL.
SAMPLE TO BE 2m²m OR AS SPECIFIED BY LANDSCAPE ARCHITECT

NEENAH
FOUNDRY

Detectable Warning Plates

Regulatory-compliant cast iron Detectable Warning Plates from Neenah Foundry offer appealing aesthetics, exceptional longevity and freedom from maintenance. By using Neenah's Detectable Warning Plates, specifiers can be confident that the critical warning message will be delivered for the lifetime of the installation.

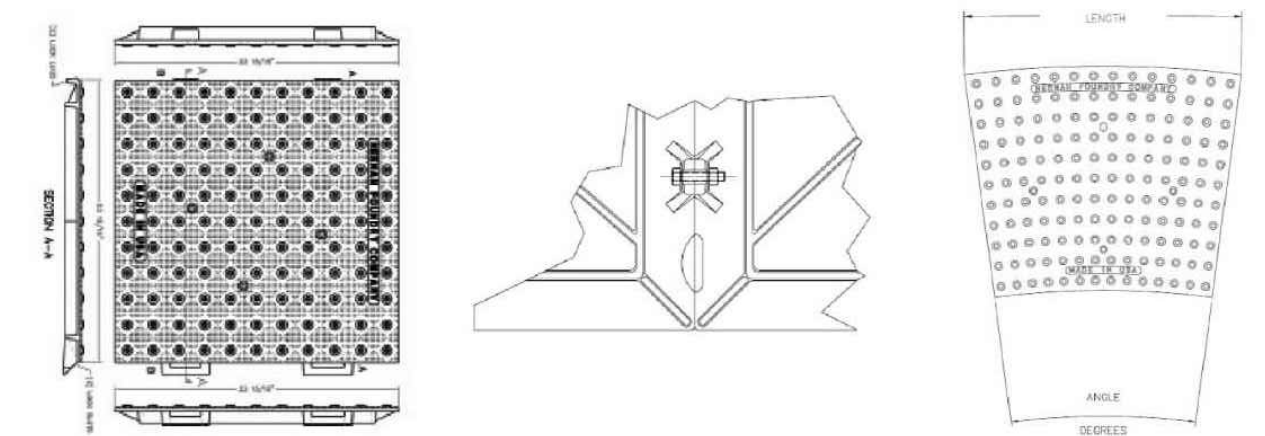

Quick Connect Plates Bolted Plates Radius Plates

Quick Connect Plates

Depth x Width	Catalog No.
24" x 24"	4984-24Q
24" x 30"	4984-30Q
24" x 36"	4984-36Q

Bolted Plates

- Lasting form and function — we have never had one fail
- Installations with natural finish are maintenance-free
- Highly resistant to snow plow and shovel damage
- Lasting non-skid properties
- Excellent cast iron to concrete adhesion properties
- No need for replacement features — our plates are permanent
- 5-yr limited warranty
- Vent holes release gasses and air for maximum concrete contact
- Furnished lifting brackets simplify installation
- Can cover long runs using radius or straight sections

Bolted Plates

Depth x Width	Catalog No.
24" x 24"	4984-24B
24" x 30"	4984-30B
24" x 36"	4984-36B

Radius Plates

Depth	Radius	Catalog No.
24"	9" R	4984-9-5R
24"	15"	4984-15R
24"	20"	4984-20R
24"	25"	4984-25R
24"	35"	4984-35R

Guidelines for Accessible Rights-of-Way

The ADA and ABA have specific guidelines that refer to numerous issues concerning detectable warning. Neenah Foundry's Detectable Warning Plates help you meet these requirements.

Neenah recommends that specifiers review prevailing national, state and local guidelines to ensure full compliance.

© 2014 Neenah Foundry, all rights reserved.

NOTE: ALL PAVING TO HAVE ALUMINUM EDGE RESTRAINTS WHEN AGAINST:
- SODDED AREAS
- PLANTING BEDS
- OTHER SOFT SURFACES OR WHEN:
- NOT CONFINED BY OTHER PAVING, CURBS, OR HARD SURFACES
- NOTED ON PLAN

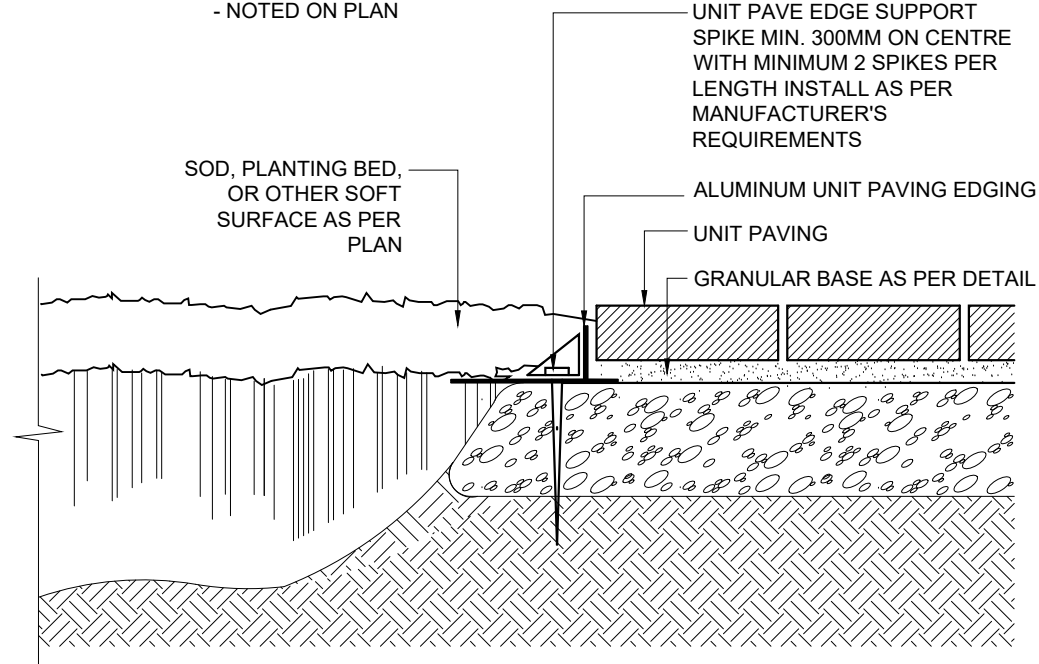

4
300 EDGE RESTRAINTS FOR UNIT PAVING
N.T.S. 321401-02

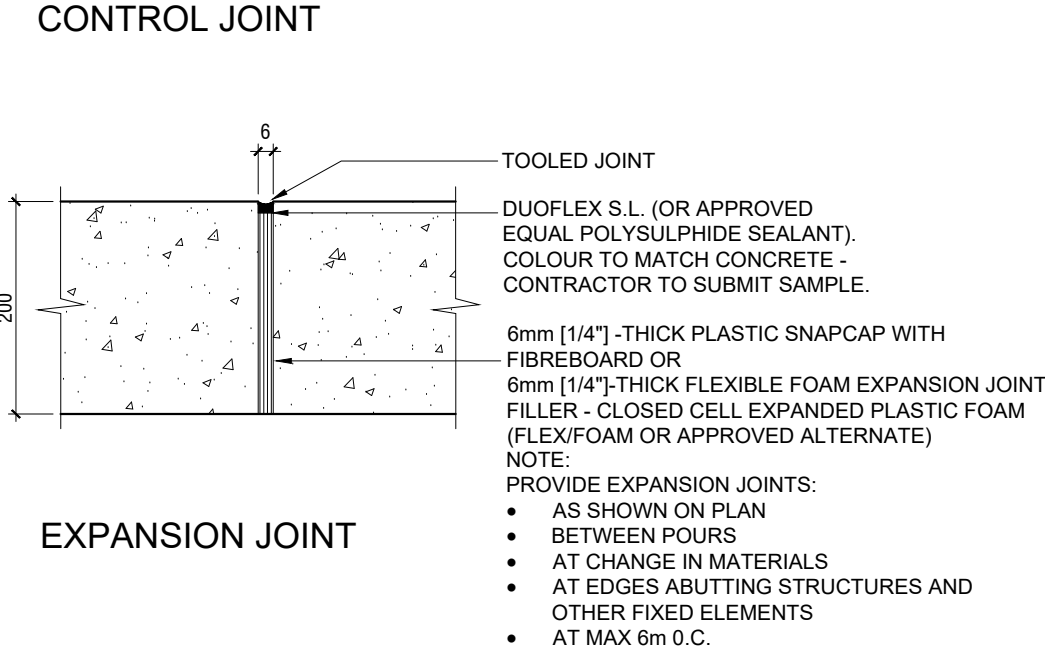
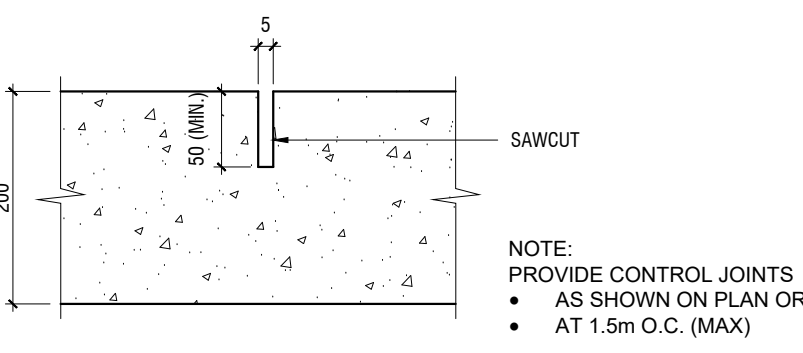

5
300 CONTROL AND EXPANSION JOINTS
N.T.S. 32 1313.01-20

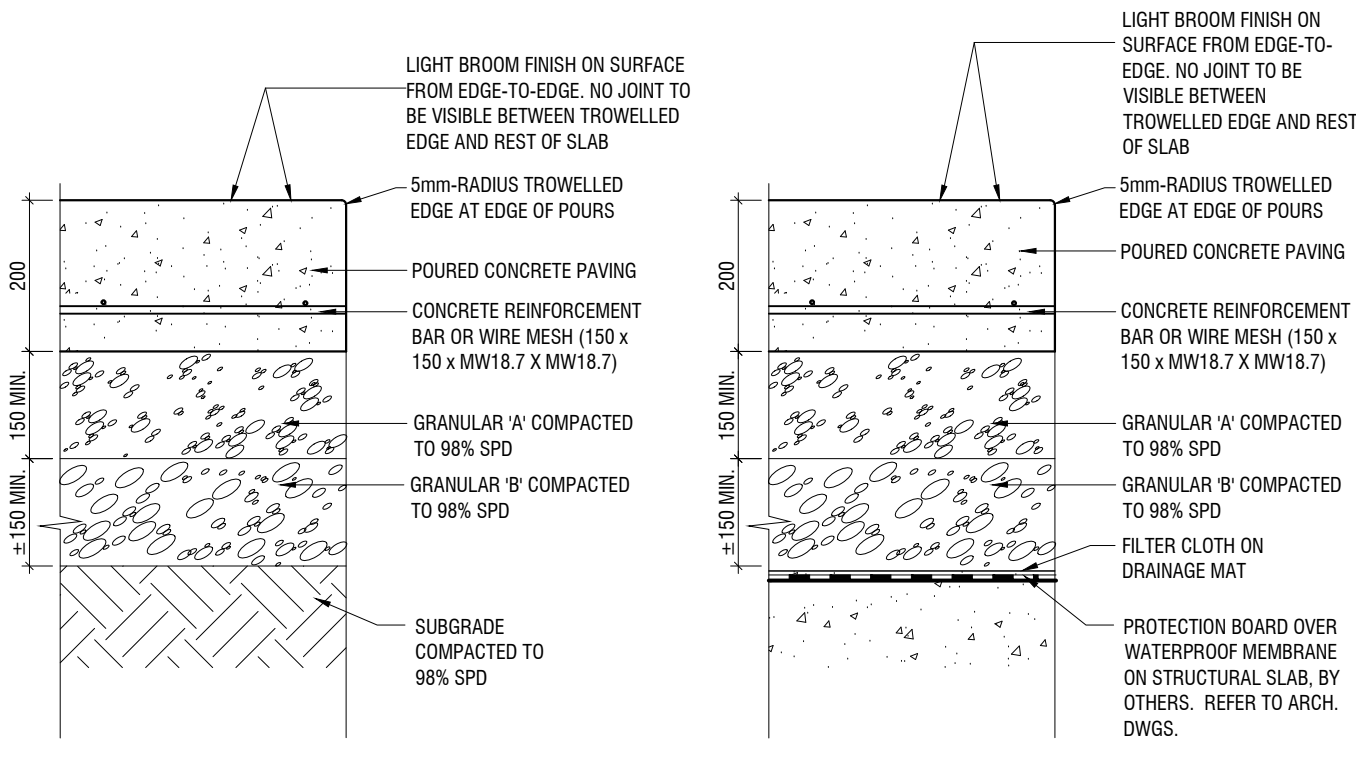

7
300 HEAVY DUTY CONCRETE
1:10 321313.01-13

6
300 TACTILE WALKING SURFACE INDICATOR
N.T.S. 321730.50-50

PAVING DETAILS

DRAWN BY: PYP
CHECKED BY: JWV
PRINT DATE: Feb.05.2020

L-300

2157 LAKESHORE BLVD W

LOCATION ALL CAPS
CLIENT ALL CAPS

LAD-378
12.10.2019

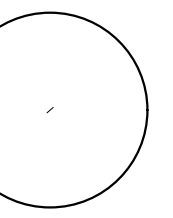

SCALE

Architect -
Civil Eng -
Mech Eng -
Interior -

GENERAL NOTES

1. All dimensions in millimetres (mm)
2. Verify all dimensions
3. Do not scale drawings
4. Check drawings against specifications
5. Use the latest revised drawings only
6. Report any discrepancies to the Landscape Architect before proceeding
7. Drawings and specifications are the property of the Landscape Architect, and must be returned upon completion of the work

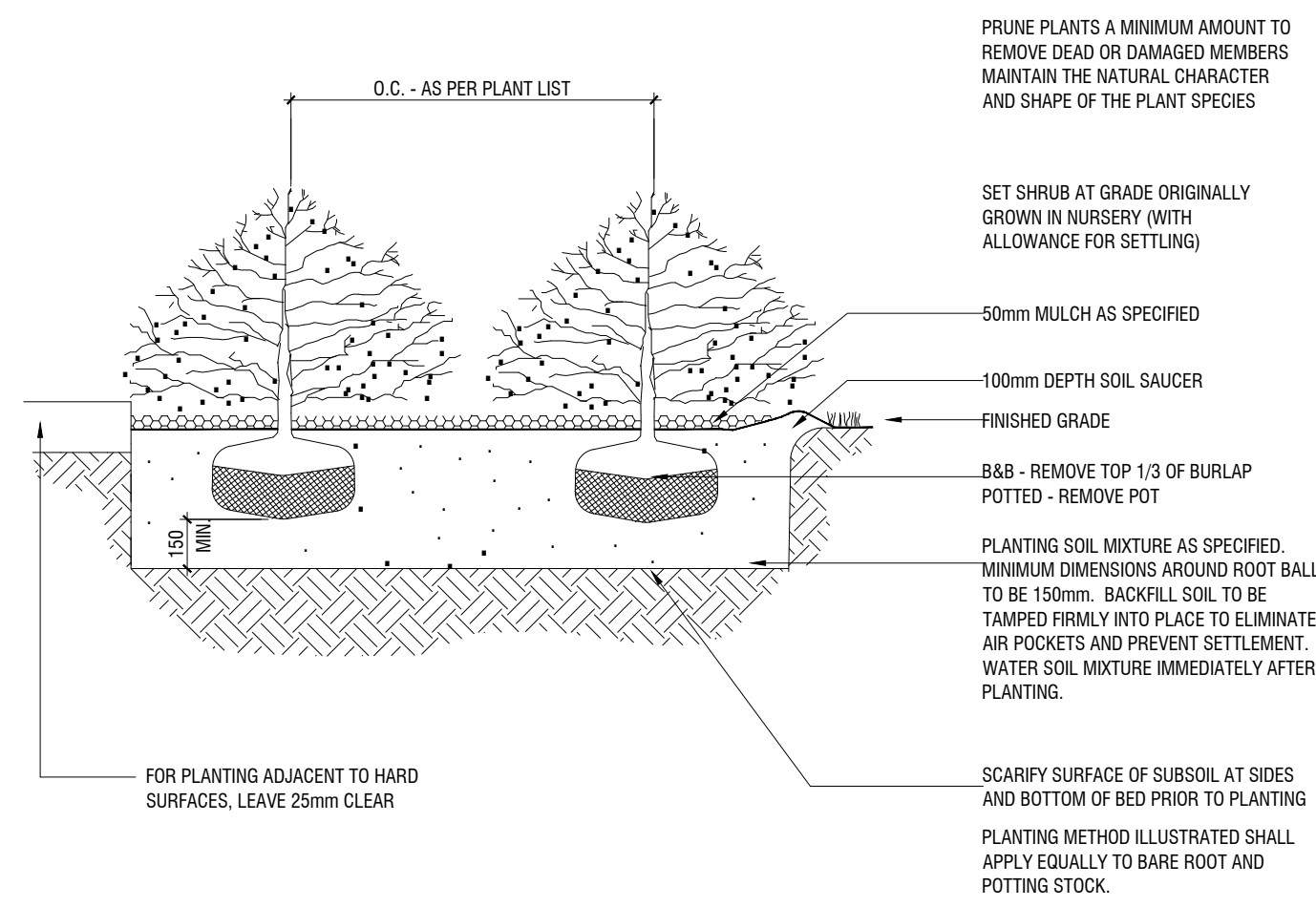

1 SHRUB PLANTING ON GRADE

L-301

N.T.S.

329333.01-10

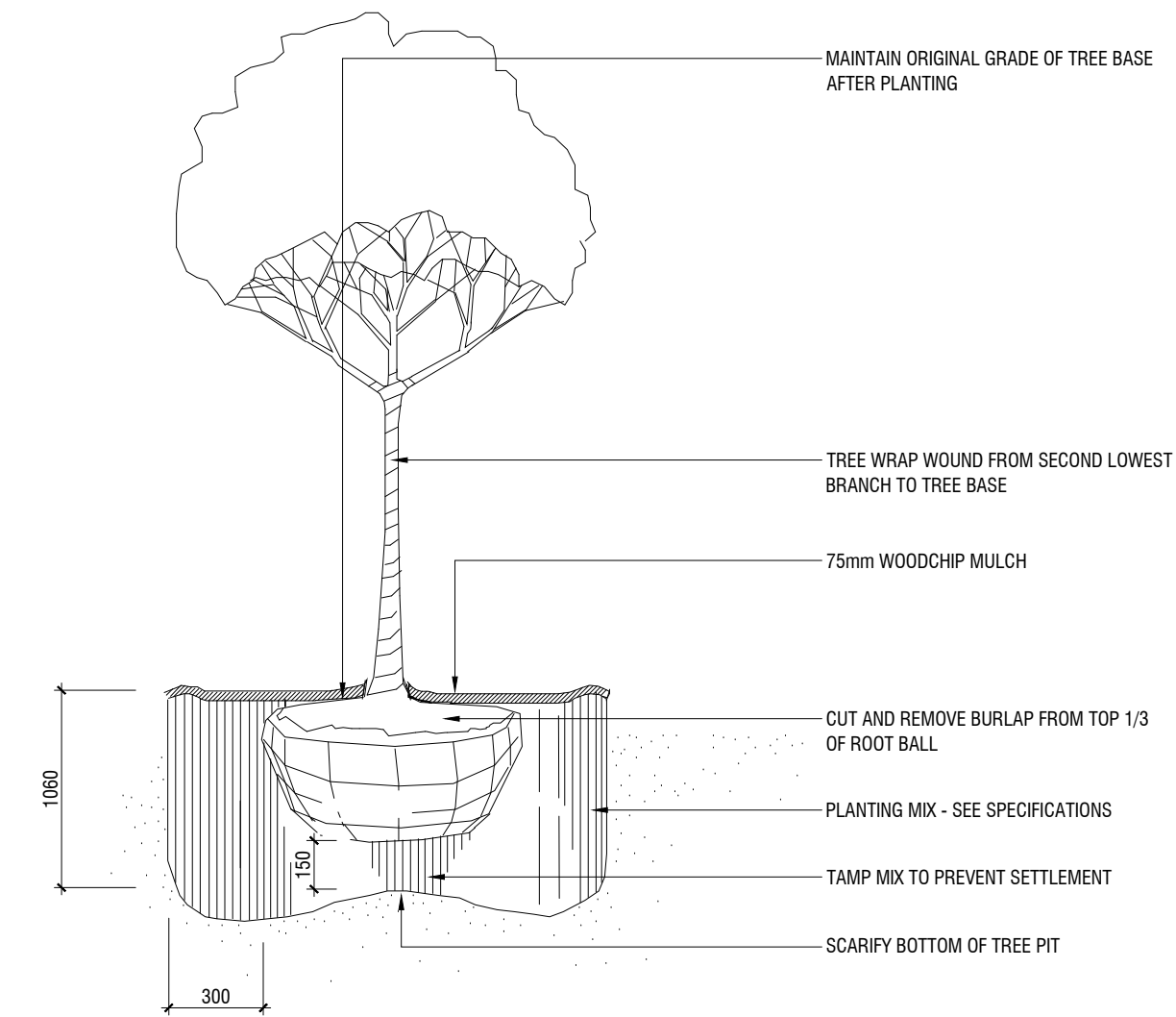

2 DECIDUOUS TREE PLANTING ON GRADE

L-301

N.T.S.

329343.01-07

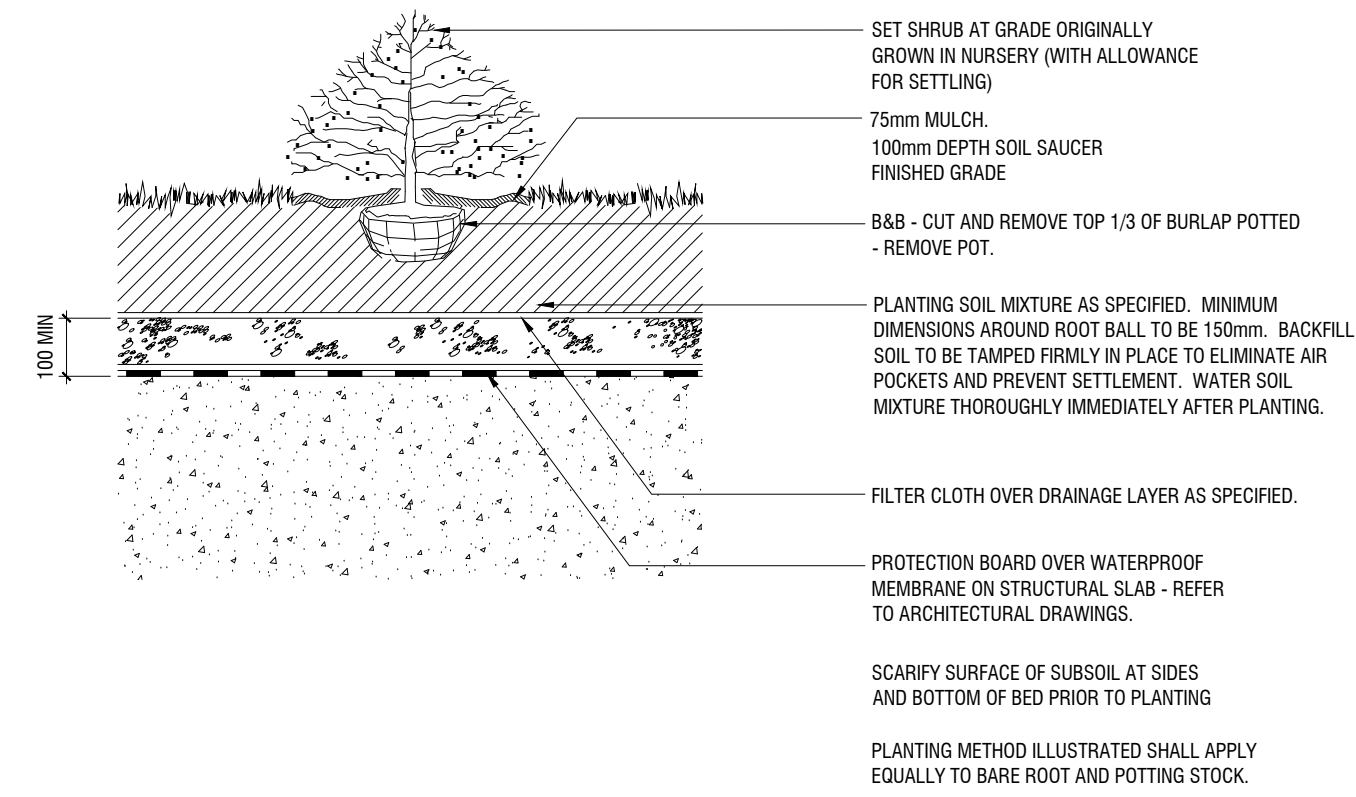

3 SHRUB PLANTING ON SLAB

L-301

N.T.S.

329343.01-11

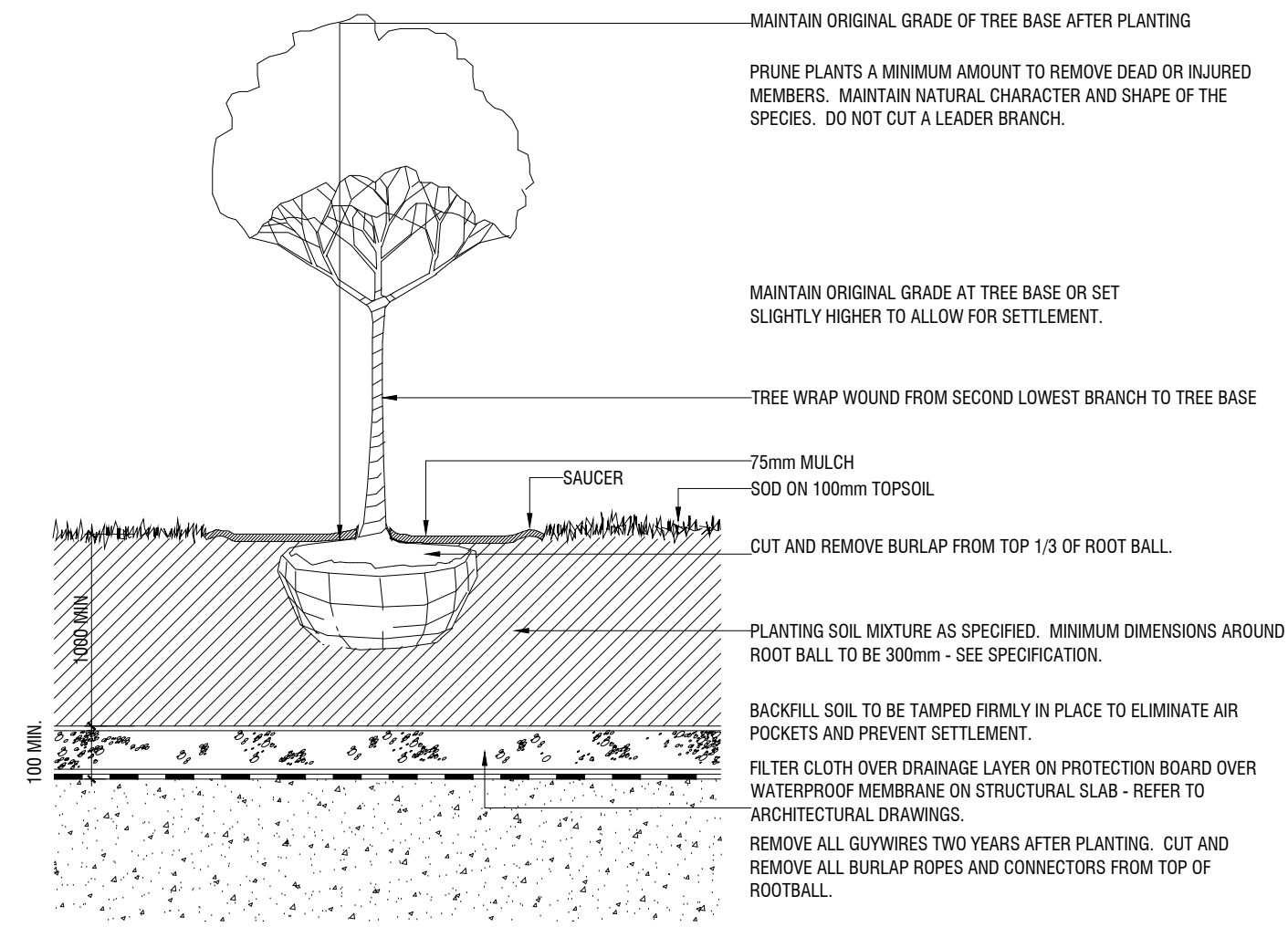

4 DECIDUOUS TREE PLANTING ON SLAB

L-301

N.T.S.

329343.01-33

1 FEB.07.2020 Rezoning Submission -1 JSC/PYP

REV DATE DESCRIPTION INITIAL

PLANTING DETAILS

DRAWN BY: PYP
CHECKED BY: JWV
PRINT DATE: Feb.05.2020

L-301

2157 LAKESHORE BLVD W

LOCATION ALL CAPS
CLIENT ALL CAPS

LAD-378
12.10.2019

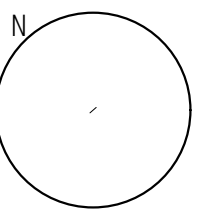

1:100

Architect -
Civil Eng -
Mech Eng -
Interior -

GENERAL NOTES

1. All dimensions in millimetres (mm)
2. Verify all dimensions
3. Do not scale drawings
4. Check drawings against specifications
5. Use the latest revised drawings only
6. Report any discrepancies to the Landscape Architect before proceeding
7. Drawings and specifications are the property of the Landscape Architect, and must be returned upon completion of the work

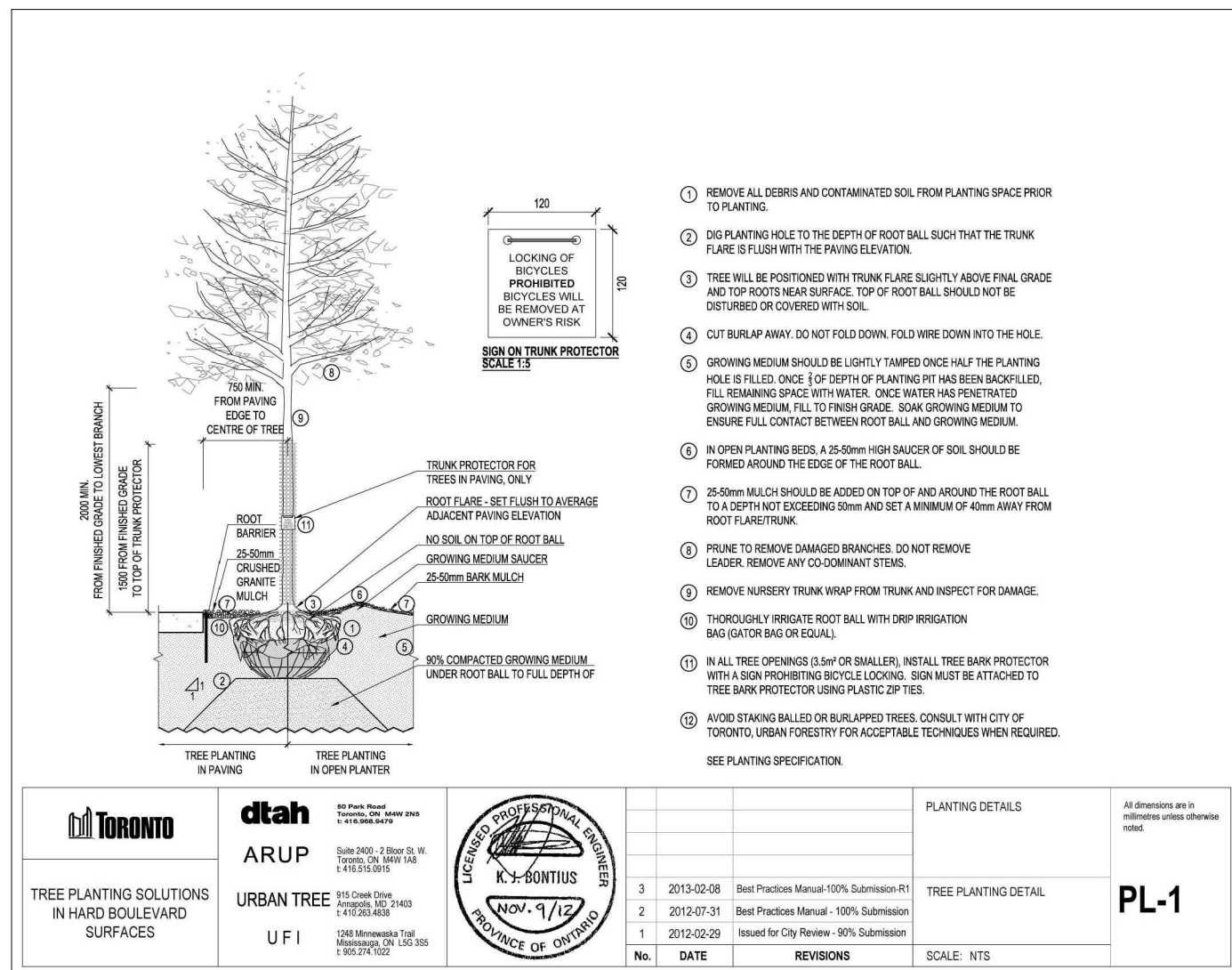

Toronto	dtah	ARUP	K-CONTINUS	PLANTING DETAILS	All dimensions are in millimetres unless otherwise specified.
TREE PLANTING SOLUTIONS IN HARD BOULEVARD SURFACES	URBAN TREE	URBAN TREE	URBAN TREE	TREE PLANTING DETAIL	PL-1
UFI	UFI	UFI	UFI	SCALE: NTS	
No.	DATE	REVISIONS	SCALE: NTS		

1 PL-1 PLANTING DETAILS - TREE PLANTING
L-302 N.T.S. 320101.20-61

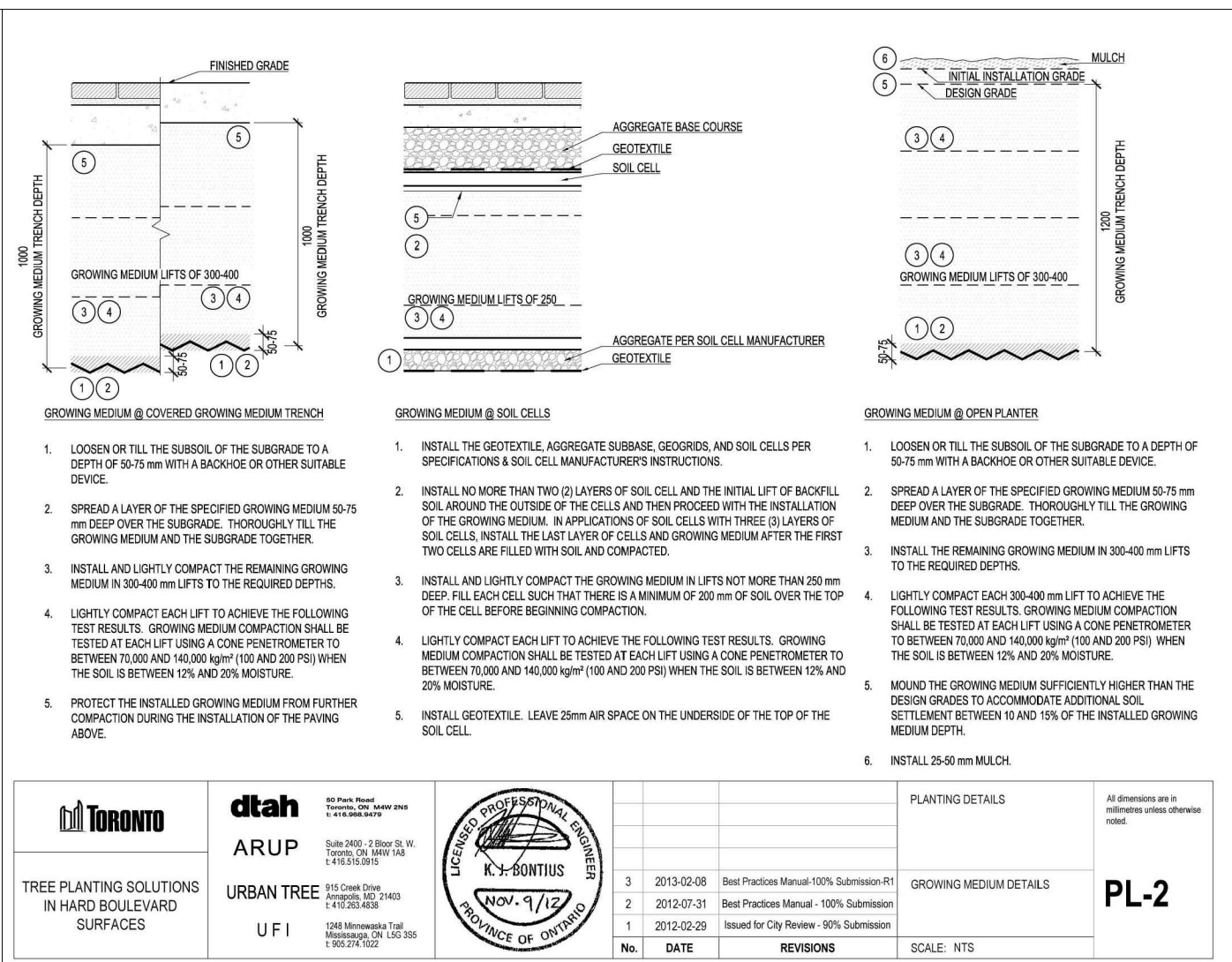

Toronto	dtah	ARUP	K-CONTINUS	PLANTING DETAILS	All dimensions are in millimetres unless otherwise specified.
TREE PLANTING SOLUTIONS IN HARD BOULEVARD SURFACES	URBAN TREE	URBAN TREE	URBAN TREE	GROWING MEDIUM DETAILS	PL-2
UFI	UFI	UFI	UFI	SCALE: NTS	
No.	DATE	REVISIONS	SCALE: NTS		

2 PL-2 PLANTING DETAILS - GROWING MEDIUM
L-302 N.T.S. 320101.20-62

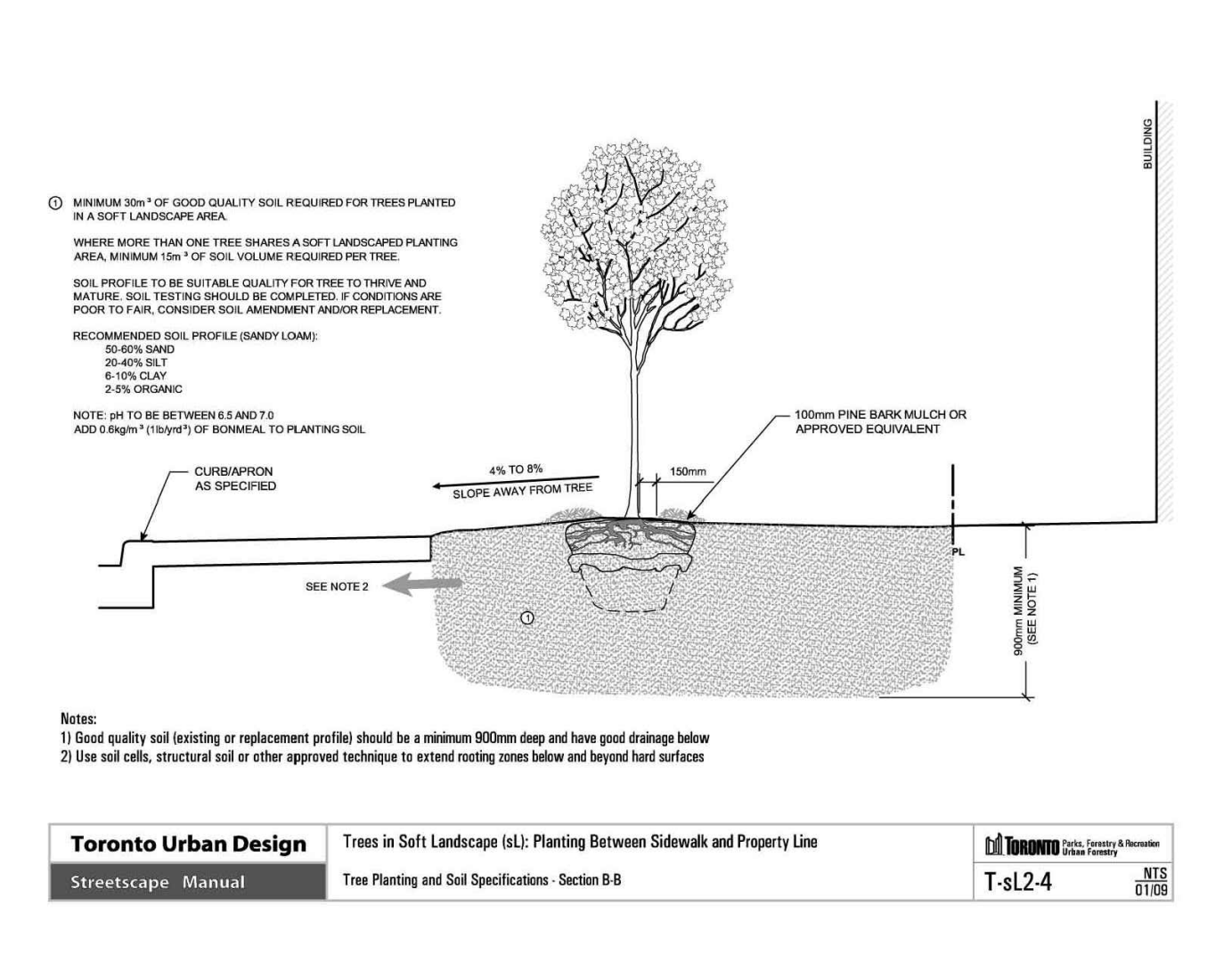

Toronto Urban Design	Trees in Soft Landscape (SL): Planting Between Sidewalk and Property Line	T-SL2-4	NTS
Streetscape Manual	Tree Planting and Soil Specifications: Section B.8		01/08

3 T-SL2-4 TREE IN SOFT LANDSCAPE - B/W SW+PL
L-302 N.T.S. 320101-54

1	FEB.07.2020	Rezoning Submission -1	JSC/PYP
REV	DATE	DESCRIPTION	INITIAL

CITY OF TORONTO STANDARD DETAILS

DRAWN BY: PYP
CHECKED BY: JWV
PRINT DATE: Feb.05.2020

L-302

2157 LAKESHORE BLVD W

LOCATION ALL CAPS
CLIENT ALL CAPS

LAD-378
12.10.2019

