

**GUIDE FOR ESTIMATING AND PLANTING**

Inches Apart	32 Plants	64 Plants	100 Plants
6"	8 sq. ft.	16 sq. ft.	25 sq. ft.
8"	14 sq. ft.	28 sq. ft.	44 sq. ft.
10"	22.5 sq. ft.	45 sq. ft.	70 sq. ft.
12"	32 sq. ft.	64 sq. ft.	100 sq. ft.
15"	50 sq. ft.	100 sq. ft.	156 sq. ft.
18"	72 sq. ft.	144 sq. ft.	225 sq. ft.
24"	128 sq. ft.	256 sq. ft.	400 sq. ft.

**FORMULAS TO DETERMINE SQUARE FEET**

Circles: Area=Diameter squared X 0.7854  
 Triangles: Area=1/2 X Height  
 Rectangle: Area=Base X Height

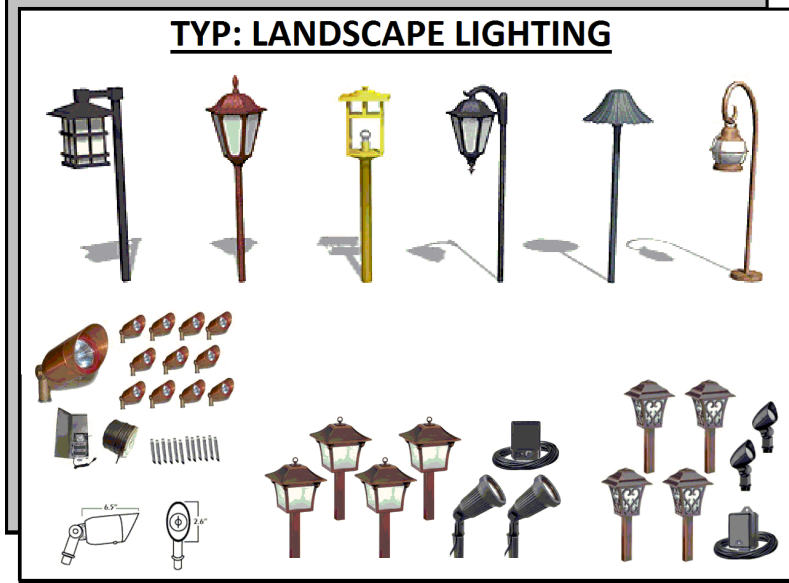

**GENERAL PLANTING GUIDELINES**

- All plants must be healthy, vigorous material, free of pests & diseases & Florida #1 grade or better, unless otherwise indicated.
- All plants must be container grown or balled & burlapped (B&B) as indicated in the plant list.
- All trees must be straight trunked, full-headed & meet all requirements specified.
- All plants are subject to approval of the landscape designer & property owner before, during, & after installation until the date of the final acceptance.
- All trees are to be girdled or staked as instructed by designer from Master Landscape Plan indicates.
- All plants & planting areas must be completely mulched to a minimum depth of 3" using Chocolate Shredded Mulch, (existing Pine Straw Beds surrounding Pine Trees to remain Pine Straw)
- Prior to construction, the landscape contractor shall be responsible for locating all underground utilities, structures, site appearances, etc. that is or could be affected by the landscape construction.
- The landscape contractor is responsible for verifying all quantities shown on these plans.
- The landscape contractor is responsible for maintaining all plantings including, but not limited to watering, spraying, mulching, fertilizing, etc. of planting areas and trees until the work is accepted in total by the landscape designer and/or the property owner.
- Any plant material which dies, runs brown or defoliate prior to total acceptance of the work shall be promptly removed from the site and replaced with material of the same species, quantity, size, and meeting the plant specifications. Normal plant material shall be warranted for a period of 3 months after completion. Pines and trees shall be warranted for (1) year. Warranty period starts after latest replacement is accepted.
- All disturbed areas of existing soil shall be re-soiled, soil type to be 5% Augustine floridanum if existing soil cannot be determined. Contractor to notify property owner of all soil replacement and species.
- Landscape contractor shall verify the plant quantities. Plant symbols on the landscape construction plan supersede quantities in the plant list.
- In size grading B&B trees, caliper shall take precedence over height.
- In size grading multi-stem trees, height shall take precedence over caliper.
- All mulch (Chocolate Shredded Mulch) to be approved by the landscape designer and the owner. Provide samples to the landscape designer for review and approval prior to installation of mulch. Mulch shall be free of foreign debris or deleterious material. Mulch shall not be treated with any compound harmful to plants or wildlife.
- All existing plant material not shown on this landscape plan is subject to removal and to be included in services of the landscape contractor. All existing plant material to be salvaged will be established during the preliminary walkthrough with the landscape designer and/or owner representative. All unwanted plant material to be removed by landscape contractor and included in bid. Approval of all existing vegetation to be removed is required by the landscape designer and/or property owner representative prior to removal.
- Plant legend indicates if plant material is to be planted inside the container or removed and planted directly in the ground. Please use the last column (notes) of the plant legend.
- Excessive plant material shown on plan and not installed shall be deducted from final invoice and promptly removed from the property.
- Work performed shall comply with the following: A. These General Notes and Construction Documents and Specifications. B. All applicable local, state and Federal codes, ordinances and regulations. All codes listed in Specifications and Drawings shall be inclusive of all codes, regulations and requirements adopted by the state of Florida, including all amendments.
- Source of base information is Dameron Designs and is assumed to be correct. Report any discrepancies immediately to the property Owner's representative.
- Specify locations of pertinent site improvements installed under other contracts. If any part of this plan cannot be followed due to site conditions, contact Dameron Designs' representative and/or property owner for instructions prior to commencing work.
- Contact local underground utility services for utility location and identification, prior to commencing work.
- Perform excavation in the vicinity of underground utilities with care and to hand. If necessary, the contractor bears full responsibility of this work and the disruption of damage to utilities shall be repaired immediately and at no expense to the property owner or designer.
- Soil in 1/2" soil must be free of foreign debris and good clean 10 dirt, to promote a healthy plant life and growing conditions.

**SPECIAL NOTES:**

**SITE DEMOLITION NOTES:**

- All plant material shall remain unless designated for removal. Remove designated items shown on the plan to the full depth of their construction unless otherwise noted.
- Verify the location and dimensions of the items to be removed prior to the commencement of the work.
- All concrete and asphalt removed shall be saw cut. Edge of material to remain shall be shored up and protected during construction to preserve edge intact. Repairs to damaged edges to be done with care and at no cost to the property owner. (If applicable)
- Items encountered below grade and shown on the drawings shall be brought to the attention of the landscape designer. Landscape contractor to be responsible for the removal of all unwanted materials, found below grade.
- Salvage existing materials as indicated on plans. Remove (if necessary) salvaged materials as indicated with care and store on site clean all debris and construction material from salvaged items: reuse as directed by landscape designer.
- Remove demolished materials from site. Disposed by burning and/or burying is prohibited.
- Contact the local underground service update for utility location and identification prior to demolition.
- The location of existing utilities as shown on the plans may vary in relation to actual conditions.

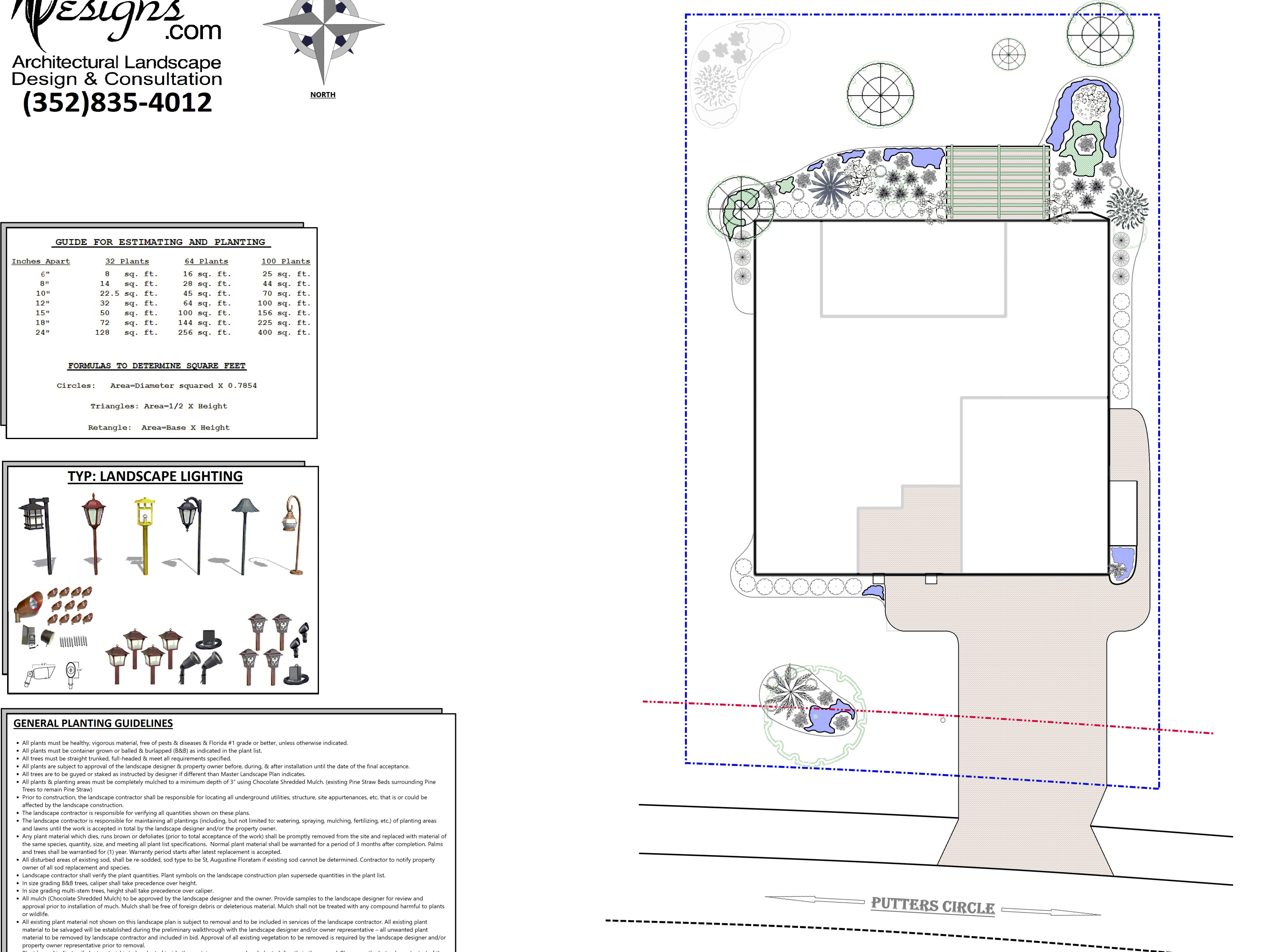
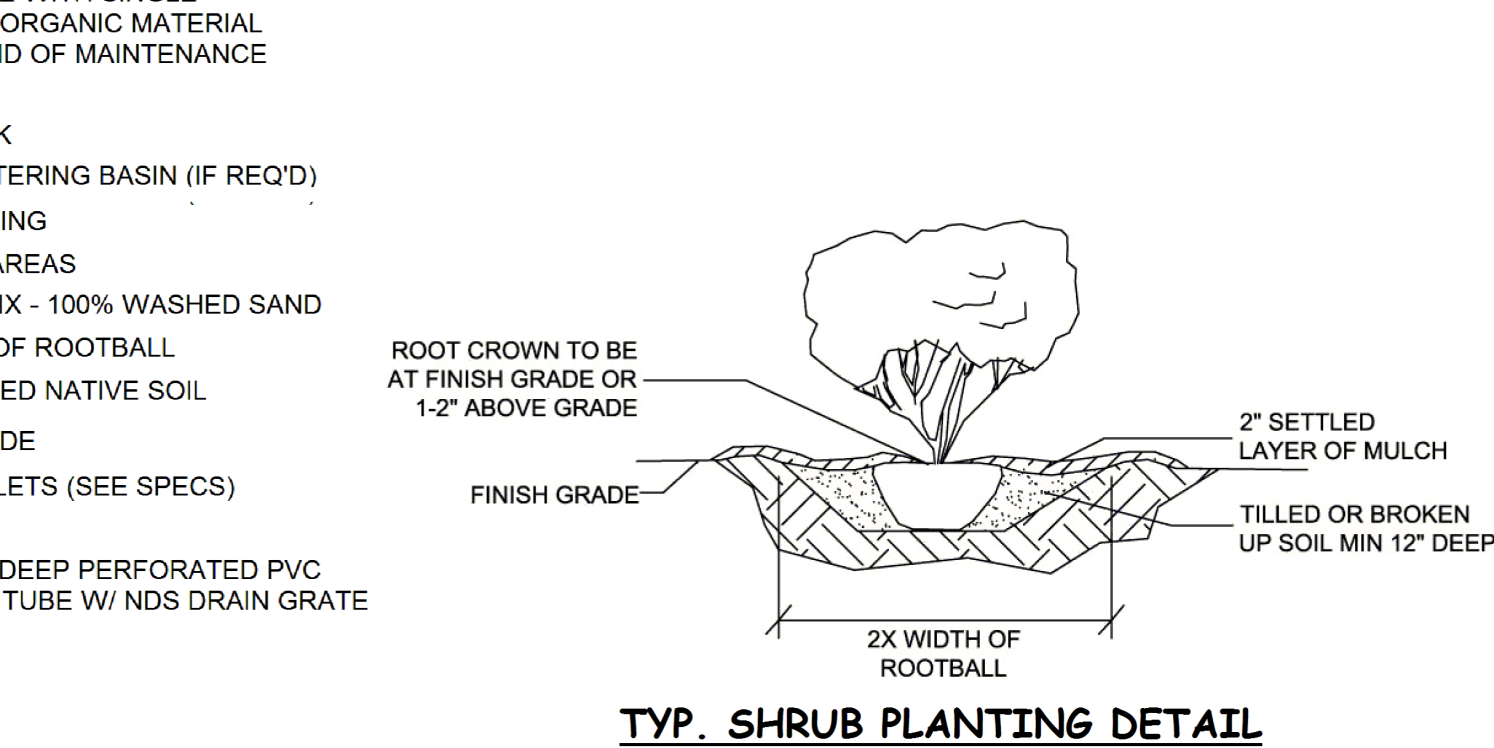
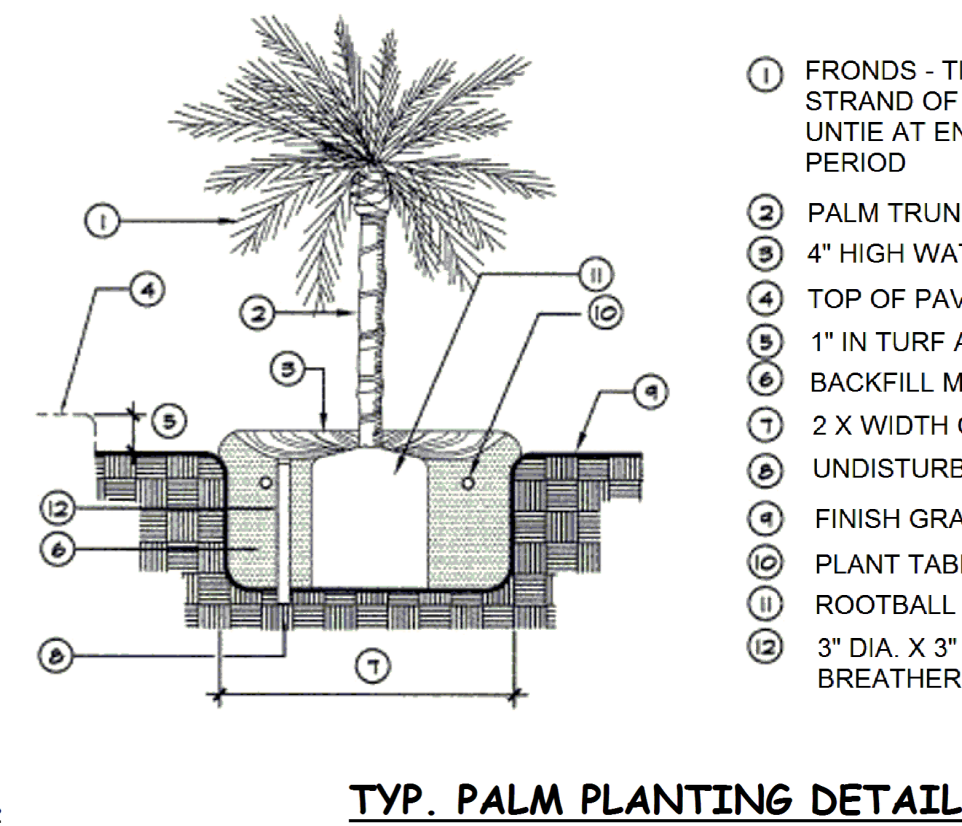
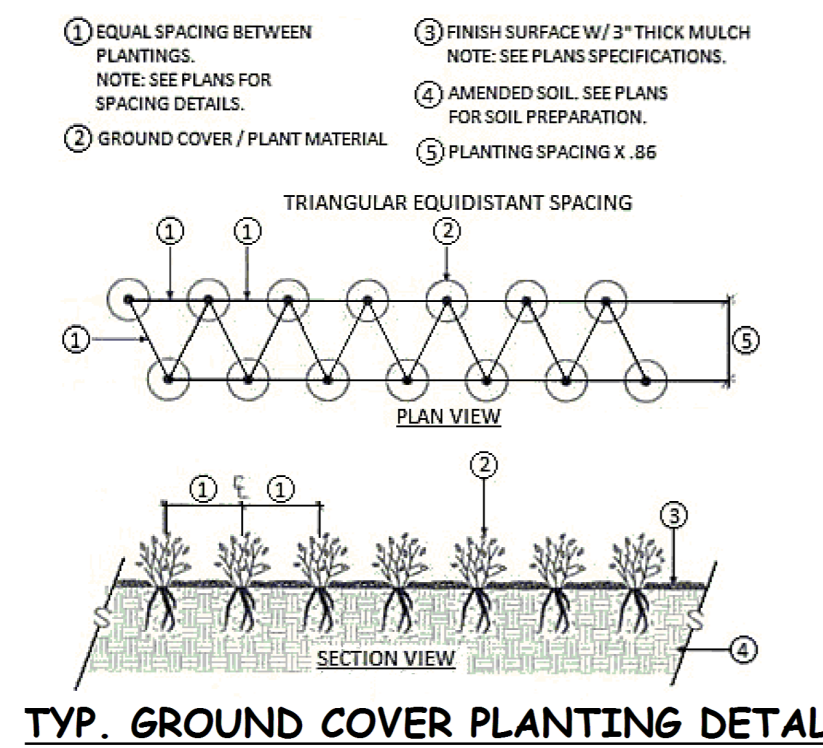
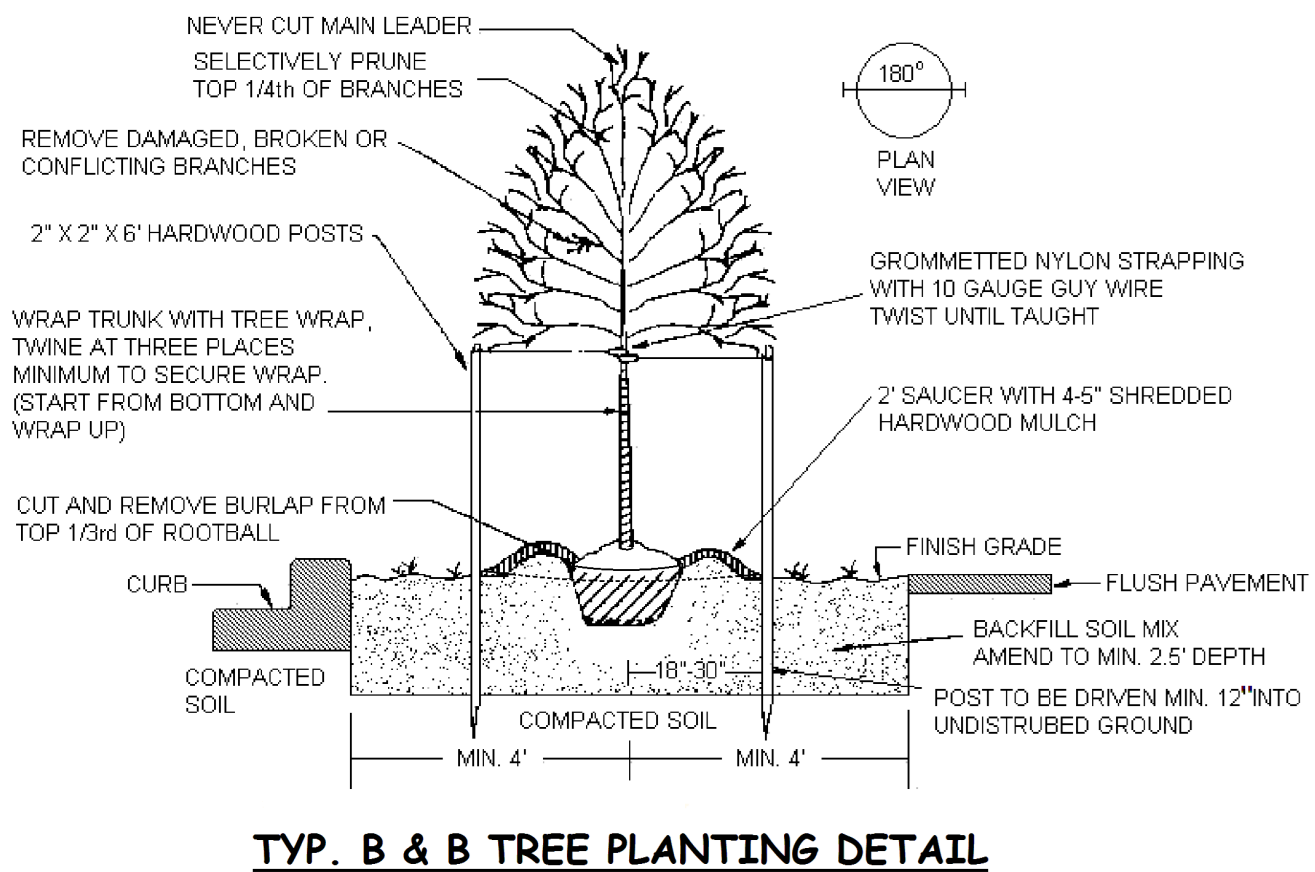

SYMBOL	SYM	QTY	BOTANICAL NAME / COMMON NAME	SIZE	COMMENTS	NOTES
	AF	8	Cordylone Fruticosa / Ti Plant	3 gal.	24" O.C.	
	BB	2	Bougainvillea brasiliensis galabra / Purple Queen Bougainvillea	15 gal.	As Shown	
	CJ	6	Camellia japonica 'In The Pink' / Pink Camellia	3 gal.	36" O.C.	
	CK	1	Lagerstroemia indica 'Muskogee' / Lavender Crape Myrtle	30 gal.	As Shown	
	CV	9	Codiaeum variegatum 'Petra' / Petra Croton	3 gal.	As Shown	
	DP	1	Brunfelsia pauciflora / Yesterday, Today & Tomorrow	15 gal.	As Shown	Special
	EN	48	Evolvulus nuttallianus / Blue Daze	1 gal.	12" O.C.	
	FV	1	Melaleuca viminalis / Weeping Bottlebrush	30 gal.	As Shown	
	HP	8	Hamelia patens 'Compacta' / Dwarf Firebush	3 gal.	As Shown	
	LM	28	Liriope muscari / Liriope Lilyturf	Transplant	12" O.C.	Special
	ND	1	Nandina domestica / Heavenly Bamboo	7 gal.	As Shown	Special
	RP	1	Sabal palmetto / Palmetto Bush	Transplant	As Shown	Special
	SA	23	Rhododendron spp. / Azalea (homeowner choice)	3 gal.	36" O.C.	
	TB	1	Thaumatococcus bipinnatifidum / Philodendron Selloum	Transplant	As Shown	Special
	X	2 CY	Front Yard Soil (2 CY Max)			
	XX	N/A	Existing Plant and/or tree to be removed			
	XXX	N/A	Existing Plant and/or tree to remain			

**HERNANDO COUNTY, FLORIDA**  
**PROPERTY RECORD CARD**

2024 FINAL TAX ROLL RECERTIFICATION AFTER V.A.B.

October 2024 BILLING OF TAXES: January 2025 BILLING OF TAXES

PROPERTY: 1000951322 | PARCEL ID: 142135252 | TARGET: 21

OWNER: [REDACTED] | MAILING: [REDACTED]

ADDRESS: [REDACTED]

BUILDING FEATURES:

TYPE	DESCRIPTION	AREA	VALUE	PERCENTAGE	CONTRIBUTION
RESIDENTIAL	RESIDENTIAL	1200	1200	100%	1200
POOL	POOL	100	100	100%	100
DRIVEWAY	DRIVEWAY	100	100	100%	100
SCREENED PORCH	SCREENED PORCH	100	100	100%	100
SCREENED PATIO	SCREENED PATIO	100	100	100%	100
SCREENED ENCLOSURE	SCREENED ENCLOSURE	100	100	100%	100
SCREENED PERGOLA	SCREENED PERGOLA	100	100	100%	100
SCREENED PORCH	SCREENED PORCH	100	100	100%	100
SCREENED PATIO	SCREENED PATIO	100	100	100%	100
SCREENED ENCLOSURE	SCREENED ENCLOSURE	100	100	100%	100
SCREENED PERGOLA	SCREENED PERGOLA	100	100	100%	100

BUSINESS ON PROPERTY: [REDACTED] | BUSINESS ON PROPERTY: [REDACTED]

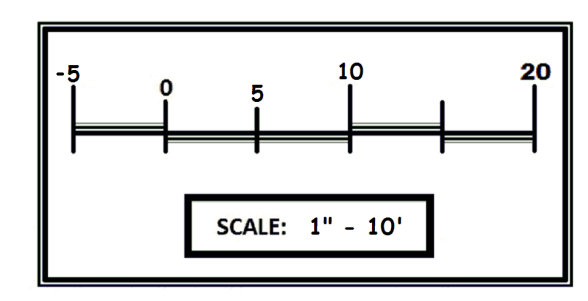

CALL 48 HOURS BEFORE YOU DIG  
 It's the Law!  
 1-800-432-4770  
 SUNSHINE STATE ONE CALL OF FLORIDA, INC.

**REVISIONS**

NO.	DATE	BY
1	D. BREHM 4.14.2025	DD

**MASTER LANDSCAPE PLAN**  
**BREHM RESIDENCE**  
 6380 PUTTERS CIRCLE, SPRING HILL, FL. 34606



**Dameron Designs .com**  
 Architectural Landscape Design & Consultation  
 (352)835-4012

**ARCHITECT**  
**D. DAMERON**

CHECKED: N.D.  
 DATE: 4/2/2025  
 SCALE: 1" = 10'  
 JOB NO.: 25-009  
 SHEET NO.: [REDACTED]

OF [REDACTED] SHEETS

