



FUME HOOD AND LAB FURNITURE MANUFACTURER



☎ **+91 9363341662**

✉ **mshls@hlseng.in**

🌐 **<https://hlseng.in>**



WHO WE ARE

HARJI LAB SYSTEMS is an organization with growing team started in 2022, which is equipping the market of Laboratory designing and engineering to support lab users to deliver the best by providing comfortable and safe environment.

STRATEGIC STRENGTH

- Extreme Flexibility
- Customer Centric
- More Innovative
- HLS - with qualified engineers and science graduates, we understands the assistance and support needed for the execution of customers needs.

ABOUT US

WE OFFER OUR PROFESSIONAL EXPERIENCE IN SETTING UP

- Laboratory case works / Lab Furniture's, Fume Hoods : Spot Extractors, Fume Extraction / Exhaust Ducting System, Gas Distribution System (GDS), Electrical, Plumping, Heat Vacuum and Air Conditioning (HVAC) System, Laboratory Planning & Designing, Pollution Control Systems - Wet Scrubber and Dry Scrubbers.
- Uplifting Laboratory needs to innovative designs and ideas.
- Providing all types of laboratory project with customized approach
- Third Party servicing of existing fume hoods and lab furniture

PRODUCTS

- Fume Hoods
- Case Works / Lab Furniture's
- Exhaust / Fume Extraction System
- Accessories & Maintenance of Labs
- School Laboratory Furniture's
- Storage and Safety Cabinets
- Spot Extraction Systems
- Lab Planning and Designing
- Pollution Control System - Wet & Dry Scrubber

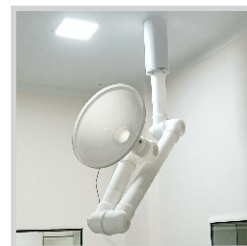



BASIC ARCHITECTURAL DESIGN CONSIDERATIONS FOR LABORATORIES

LAB CLASSIFICATION

- Broadly laboratories are classified into wet or dry labs. In Wet labs chemicals are used for reactions. In dry labs instruments and very small amounts of chemicals are used for analyses.
- Wet labs require chemical resistance work surface and cabinets to avoid corrosion. In addition to this fume hoods, storage cabinets for chemicals and glassware are significant factor in space planning.
- Dry labs / Analytical labs require lot of work surface to mount equipment on counter at comfortable operating height.

LAB PLANNING CONCEPTS

The laboratory module is the key unit in any lab facility. A well thought of and well designed module will have flexibility and expansions as these are two most important benefits. It is absolutely critical to identify the lab and non-lab areas in the initial stage itself.

WAYS TO PLAN AND ORGANIZE THE LAB SPACE

- Single Corridor with the multiple options is the most adopted one.
- Single Corridor lab design with labs and offices adjacent to each other
- Single corridor with office clustered at the end of the main labs
- Single Corridor with office clusters directly accessing the main labs

LAB FURNITURE

PLINTH BASED LAB FURNITURE SYSTEM

- Plinth type lab furniture systems are one of the robust and classic lab furniture architectural type
- In this system case works are supported by the in-built metal plinth which give good aesthetic appearance and stability for the casework
- This system offers the end user modularity and flexibility

C FRAME BASED LAB FURNITURE SYSTEM

- c frame type lab furniture systems are most flexible type lab furniture architectural type
- In this system, case works are supported by the C frame which give good aesthetic appearance and the casework are suspended on the C frame
- This system offers the end user more modularity and flexibility



TYPE OF COUNTER TOPS

EPOXY

Suitable for high corrosive environment

TRESPA TOP

Suitable for most of the chemical applications and has Anti fungal Activity

CERAMIC TOP

Suitable for acid and alkali applications

GLASS

Suitable for acid and alkali applications but brittle in nature. Not suitable for HF acid

SS 304/316L

Suitable for medical, radioisotopes and food applications

JET BLACK GRANITE

Suitable for general chemistry usage, very economical & has above average life time

TYPE OF CASEWORK

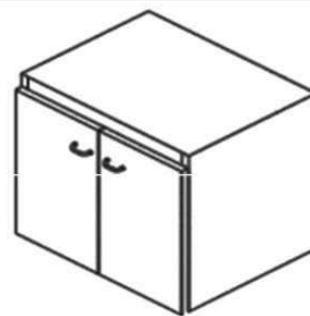

2 SHUTTER MODULE

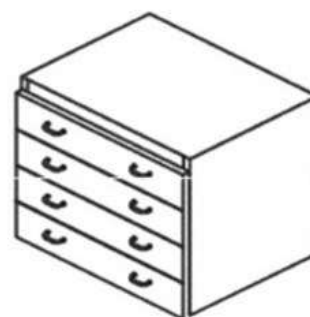

4 DRAWER MODULE

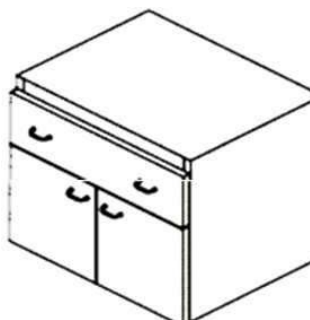

1 DRAWER WITH 2 SHUTTER MODULE

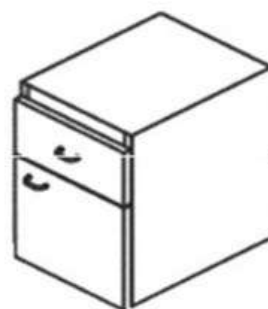

1 DRAWER WITH 2 SHUTTER MODLE



FUME HOODS DESIGN TYPE



STANDARD BENCH TOP

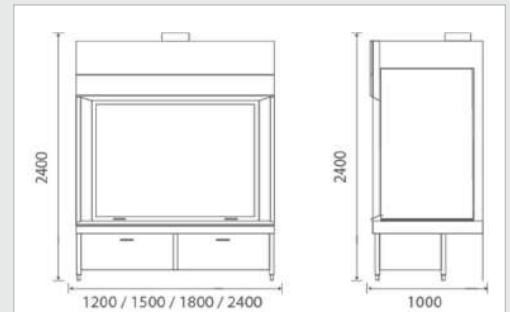

LOW BENCH TOP

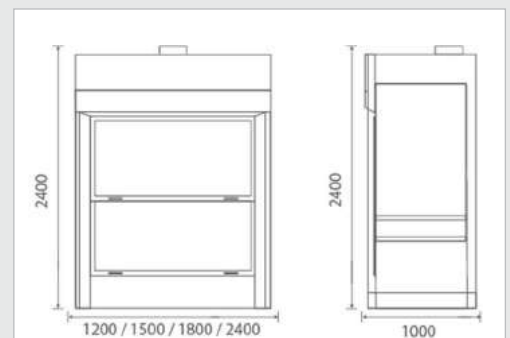

WALK IN TYPE

FUME HOODS

- 1 Front service panel Heavy Duty GI Panel Construction
- 2 In Built Starter for blower with NO/ NC Switch
- 3 Electrical Sockets Pre-Wired
- 4 Utility line nozzle tapered for use with different size flexible hoses
- 5 Utility line Valve Confirms to DIN standard, Remotely operated with color code



TRANSFORMING SPACES INTO HIGH-PERFORMANCE LABORATORIES

At HLS we offer comprehensive turnkey solutions for setting up state-of-the-art Quality Control (QC) and Research & Development (R&D) laboratories. From the drawing board to project delivery, we bring your lab vision to life—seamlessly, safely, and with full regulatory compliance.

OUR TURNKEY SCOPE INCLUDES

1. Design & Visualization

- 2D & 3D Layout Development – Optimized lab layouts for space, safety, and workflow
- Architectural Renderings – Realistic previews of your future lab
- Virtual Walkthroughs – Immersive previews for planning and approvals

2. Civil & Interior Works

- Partitioning & Zoning – Cleanroom-compatible and GMP-compliant materials
- False Ceiling Work – Modular, easy-maintenance designs for controlled environments
- Flooring Solutions – Anti-static, chemical-resistant finishes

3. Utility & Technical Services

- Gas Distribution Systems – Safe, leak-proof installations with clear labelling and control
- Electrical & Networking – Lab-specific panels, cabling, and automation-ready setups
- HVAC Systems – Precise climate control to support sensitive lab operations

4. Lab Infrastructure & Equipment

- Modular Lab Furniture – Ergonomic, durable, and fully customizable
- Fume Hoods & Exhaust Systems – High-efficiency extraction for operator safety
- Spot Extractors – Targeted ventilation for localized emission control
- Chemical Storage Systems – Secure, ventilated, and segregated for hazardous substances



5. Safety & Compliance

- Fire Extinguisher Systems – Class-specific extinguishers with compliance signage
- Public Health Engineering (PHE) – Water supply, drainage & plumbing per standards
- Public Address System (PAS) – Integrated emergency and announcement systems

TAILORED FOR EVERY INDUSTRY

- Pharmaceuticals & Life Sciences
- Food & Beverages
- Chemicals & Petrochemicals
- Environmental Testing Labs
- Universities & Research Institutes

WHY CHOOSE HARJI LAB SYSTEMS ?

- End-to-end turnkey execution under one roof
- Certified expertise in lab design and engineering
- Precision planning with minimal downtime
- On-time, budget-friendly delivery
- Full regulatory compliance (GMP, NABL, FDA, etc.)

PROJECT PHOTOS



LET US BUILD YOUR FUTURE - READY LABORATORY



CORPORATE OFFICE & FACTORY :

📍 51/1 , Villarasampatti, Erode

☎ +91 9363341662

✉ mshls@hlseng.in

🌐 <https://hlseng.in>