

# Cabinet Lines

Our **Premier Series** offers distinctive touches and superb craftsmanship, satisfying either the traditional or modern design palette with a look to fit any lifestyle.



## Premier Series



SHAKER  
SAND  
(SS)



SHAKER  
DESIGNER  
WHITE SLAB  
(SW)



SHAKER  
DESIGNER  
WHITE 5PC  
(SW)

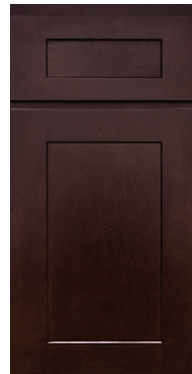

SHAKER  
ESPRESSO  
(SE)

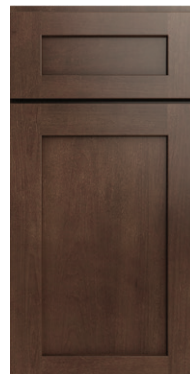

SHAKER  
KODIAK  
(SK)



BROOKLYN  
MODERN  
GRAY  
(BG)



BROOKLYN  
FAWN  
(BF)



BROOKLYN  
SLATE  
(BS)



BROOKLYN  
MIDNIGHT  
(BM)



BROOKLYN  
BRIGHT  
WHITE  
(BW)

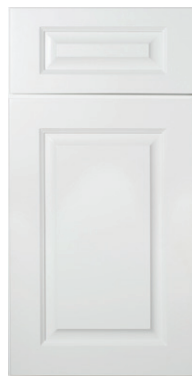

NAPA  
WHITE  
(NW)







# Shaker

Classic, crisp, and modern, this cabinet has a versatile appeal. The design incorporates the architectural shaker style with pleasing proportions. Shaker White is available with a slab or 5-piece drawer front yielding a contemporary or classic display.

- Full overlay doors provide a seamless aesthetic
- Soft-close doors and drawers prevent slamming
- Dovetail drawer craftsman construction
- Full extension drawers ensure easy access
- Durable solid wood cabinet box and drawers
- Premium Sherwin-Williams® finish delivers a lifetime of beauty
- Full line of accessories and upgrades available



Shaker Designer White

\*Slab



Shaker Designer White

\*5 Piece



Shaker Sand



Shaker Kodiak

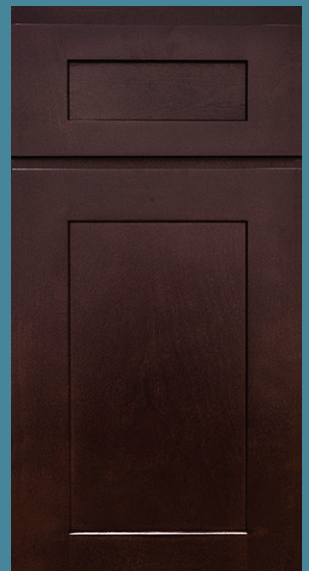

Shaker Espresso







# Brooklyn

This transitional door complements a range of style from modern to vintage to traditional. The selection of color options within the Brooklyn line offers a solution for many design needs. Find modern charm in Brooklyn Gray or install a Fawn, Slate or Midnight island for the perfect kitchen accent that your guests will love. Brooklyn's classic Bright White finish provides a timeless backdrop for a space that will become a gathering spot for years to come.

- Full overlay doors provide a seamless aesthetic
- Soft-close doors and drawers prevent slamming
- Dovetail drawer craftsman construction
- Full extension drawers ensure easy access
- Solid wood cabinet box and drawers provide exceptional durability
- Premium Sherwin-Williams® finish delivers a lifetime of beauty
- Available with a full line of accessories and upgrades



Brooklyn Bright White



Brooklyn Modern Gray

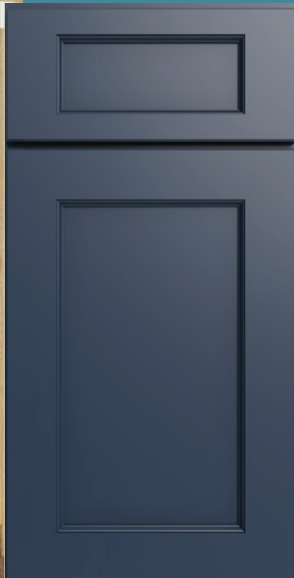

Brooklyn Midnight



Brooklyn Slate



Brooklyn Fawn







# Napa

The Napa White line is an adaptable option that adds dimension and elegance. The bright white finish and raised center panel provide a charming and traditional feel that is perfect for any home.

- Full overlay doors provide a seamless aesthetic
- Soft-close doors and drawers prevent slamming
- Dovetail drawer craftsman construction
- Full extension drawers ensure easy access
- Solid wood cabinet box and drawers provide exceptional durability
- Sherwin-Williams® finish delivers a lifetime of beauty
- Available with a full line of accessories and upgrades that add style and function



Napa White









# Essential

If your design style includes a time-honored look or a contemporary touch then the Builder Series is a great choice for any room. Imagine, your new favorite space, affordably priced.

- Offered in Gray and White to complement many decors.
- Full or partial overlays give you the option to match your current style
- Broad selection of SKU's and moldings will give you functionality and unique touches
- Our Perfect Pairings Decorative Hardware brings it all together

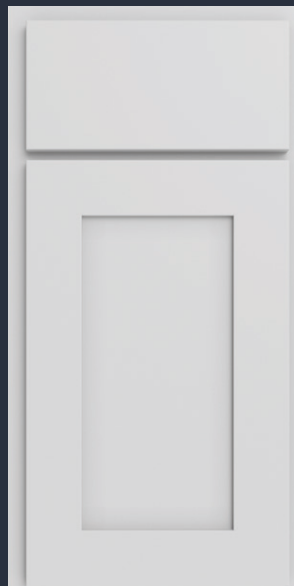

Essential White



Essential Gray







## Wall Cabinet Coding

### Standard (12" Deep)

| W            | 30            | 36             |
|--------------|---------------|----------------|
| CABINET CODE | CABINET WIDTH | CABINET HEIGHT |

### Refrigerator

| W            | 36            | 18             | 24            |
|--------------|---------------|----------------|---------------|
| CABINET CODE | CABINET WIDTH | CABINET HEIGHT | CABINET DEPTH |

#### Notes:

- Standard wall cabinets are 12" deep. Refrigerator cabinets are 24" deep.
- Add door thickness for total cabinet depth.
- Please refer to the Products by Cabinet Line chart to determine which products are carried for each cabinet line.

## 12" - 21" High Double Door Wall

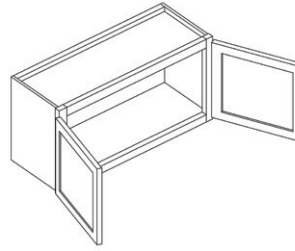

| Item Code | Outer Dimensions |    |    |   |   |
|-----------|------------------|----|----|---|---|
|           | W                | H  | D  | P | B |
| W3012     | 30               | 12 | 12 | • | • |
| W3612     | 36               | 12 | 12 | • | • |
| W3015     | 30               | 15 | 12 | • | • |
| W3312     | 33               | 12 | 12 | • | - |
| W3315     | 33               | 15 | 12 | • | • |
| W3615     | 36               | 15 | 12 | • | • |
| W3018     | 30               | 18 | 12 | • | • |
| W3318     | 33               | 18 | 12 | • | - |
| W3618     | 36               | 18 | 12 | • | • |
| W3021     | 30               | 21 | 12 | • | - |

\*Premier line drawing shown.  
Builder is a partial overlay.

## 15" Wall Stacking Cabinets with Glass

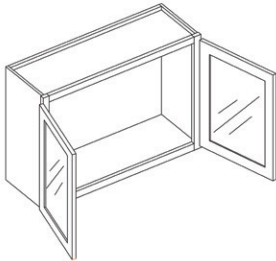

| Item Code | Outer Dimensions |    |    |   |   |
|-----------|------------------|----|----|---|---|
|           | W                | H  | D  | P | B |
| WS2415-2  | 24               | 15 | 12 | • | - |
| WS2715-2  | 27               | 15 | 12 | • | - |
| WS3015-2  | 30               | 15 | 12 | • | - |
| WS3315-2  | 33               | 15 | 12 | • | - |
| WS3615-2  | 36               | 15 | 12 | • | - |

\*Door comes pre-routed with glass insert and finished interior

## 24" High Double Door Wall

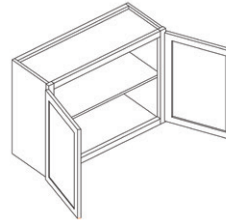

| Item Code | Outer Dimensions |    |    |   |   |
|-----------|------------------|----|----|---|---|
|           | W                | H  | D  | P | B |
| W3024     | 30               | 24 | 12 | • | • |
| W3324     | 33               | 24 | 12 | • | - |
| W3624     | 36               | 24 | 12 | • | • |

\*Premier line drawing shown.  
Builder is a partial overlay.

## 15" Wall Stacking Cabinets with Glass

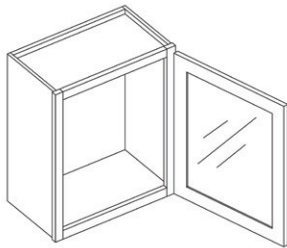

| Item Code | Outer Dimensions |    |    |   |   |
|-----------|------------------|----|----|---|---|
|           | W                | H  | D  | P | B |
| WS1215    | 12               | 15 | 12 | • | - |
| WS1515    | 15               | 15 | 12 | • | - |
| WS1815    | 18               | 15 | 12 | • | - |
| WS2115    | 21               | 15 | 12 | • | - |

\*Door comes pre-routed with glass insert and finished interior

## 24" Deep Wall (Refrigerator Cabinet)

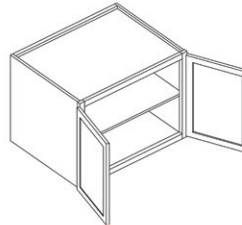

| Item Code | Outer Dimensions |    |    |   |   |
|-----------|------------------|----|----|---|---|
|           | W                | H  | D  | P | B |
| W331824   | 33               | 18 | 24 | • | - |
| W332424   | 33               | 24 | 24 | • | - |
| W361824   | 36               | 18 | 24 | • | • |
| W362424   | 36               | 24 | 24 | • | • |

\*Premier line drawing shown.  
Builder is a partial overlay.

\*331824 and 361824 do not have a shelf

## 15" Corner Wall Stacking Cabinet with Glass

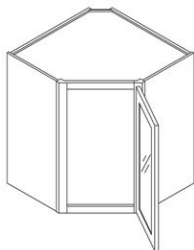

| Item Code | Outer Dimensions |    |    |   |   |
|-----------|------------------|----|----|---|---|
|           | W                | H  | D  | P | B |
| CWS2415   | 24               | 15 | 12 | • | - |
| CWS2715   | 27               | 15 | 12 | • | - |

\*Door comes pre-routed with glass insert and finished interior

## 30" - 36" High Single Door Wall

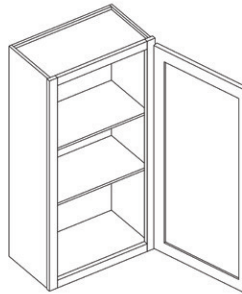

| Item Code | Outer Dimensions |    |    |   |   |
|-----------|------------------|----|----|---|---|
|           | W                | H  | D  | P | B |
| W930      | 9                | 30 | 12 | • | • |
| W1230     | 12               | 30 | 12 | • | • |
| W1530     | 15               | 30 | 12 | • | • |
| W1830     | 18               | 30 | 12 | • | • |
| W2130     | 21               | 30 | 12 | • | • |
| W936      | 9                | 36 | 12 | • | • |
| W1236     | 12               | 36 | 12 | • | • |
| W1536     | 15               | 36 | 12 | • | • |
| W1836     | 18               | 36 | 12 | • | • |
| W2136     | 21               | 36 | 12 | • | • |

\*Premier line drawing shown.  
Builder is a partial overlay.

## Corner Wall Cabinet

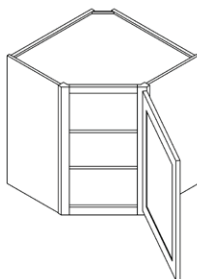

| Item Code | Outer Dimensions |    |    |   |   |
|-----------|------------------|----|----|---|---|
|           | W                | H  | D  | P | B |
| CW2430    | 24               | 30 | 12 | • | • |
| CW2436    | 24               | 36 | 12 | • | • |
| CW2442    | 24               | 42 | 12 | • | • |
| CW2736    | 27               | 36 | 12 | • | • |
| CW2742    | 27               | 42 | 12 | • | • |

## 30" - 36" High Double Door Wall

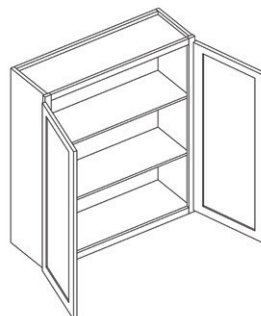

| Item Code | Outer Dimensions |    |    |   |   |
|-----------|------------------|----|----|---|---|
|           | W                | H  | D  | P | B |
| W2430-2   | 39               | 18 | 12 | • | • |
| W2730     | 39               | 24 | 12 | • | • |
| W2430-2   | 24               | 30 | 12 | • | • |
| W2730     | 27               | 30 | 12 | • | • |
| W3030     | 30               | 30 | 12 | • | • |
| W3330     | 33               | 30 | 12 | • | • |
| W3630     | 36               | 30 | 12 | • | • |
| W3930     | 39               | 30 | 12 | • | • |
| W2436-2   | 24               | 36 | 12 | • | • |
| W2736     | 27               | 36 | 12 | • | • |
| W3036     | 30               | 36 | 12 | • | • |
| W3336     | 33               | 36 | 12 | • | • |
| W3636     | 36               | 36 | 12 | • | • |
| W3936     | 39               | 36 | 12 | • | • |

\*Premier line drawing shown.  
Builder is a partial overlay.





### 30" Microwave Wall Cabinet

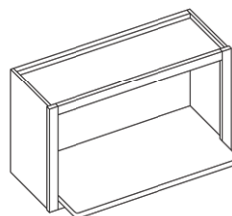

| Item Code | Outer Dimensions |    |    |   |   |
|-----------|------------------|----|----|---|---|
|           | W                | H  | D  | P | B |
| MWC3018   | 30               | 18 | 12 | ● | - |

### 30" - 36" High Double Door with Center Stile

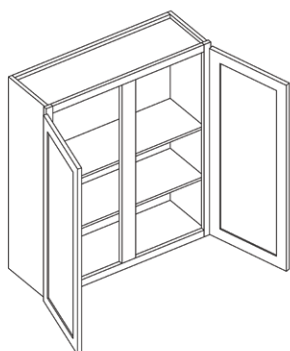

| Item Code | Outer Dimensions |    |    |   |   |
|-----------|------------------|----|----|---|---|
|           | W                | H  | D  | P | B |
| W4230     | 42               | 30 | 12 | ● | ● |
| W4236     | 42               | 36 | 12 | ● | ● |

### 42" High Double Door Wall

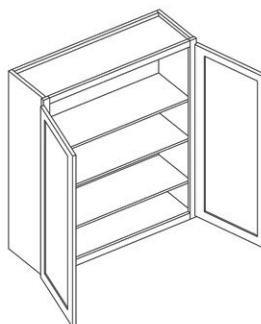

| Item Code | Outer Dimensions |    |    |   |   |
|-----------|------------------|----|----|---|---|
|           | W                | H  | D  | P | B |
| W2442-2   | 24               | 42 | 12 | ● | ● |
| W2742     | 27               | 42 | 12 | ● | ● |
| W3042     | 30               | 42 | 12 | ● | ● |
| W3342     | 33               | 42 | 12 | ● | ● |
| W3642     | 36               | 42 | 12 | ● | ● |
| W3942     | 39               | 42 | 12 | ● | ● |

### 30" - 36" High Corner Wall

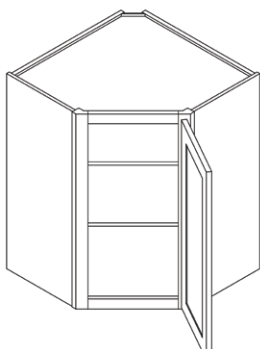

| Item Code | Outer Dimensions |    |    |   |   |
|-----------|------------------|----|----|---|---|
|           | W                | H  | D  | P | B |
| CW2430    | 24               | 30 | 12 | ● | ● |
| CW2436    | 24               | 36 | 12 | ● | ● |
| CW2736    | 27               | 36 | 15 | ● | ● |

### 42" High Single Door Wall

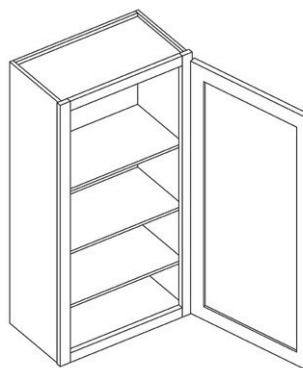

| Item Code | Outer Dimensions |    |    |   |   |
|-----------|------------------|----|----|---|---|
|           | W                | H  | D  | P | B |
| W942      | 9                | 42 | 12 | ● | ● |
| W1242     | 12               | 42 | 12 | ● | ● |
| W1542     | 15               | 42 | 12 | ● | ● |
| W1842     | 18               | 42 | 12 | ● | ● |
| W2142     | 21               | 42 | 12 | ● | ● |

### 42" High Double Door Wall with Center Stile

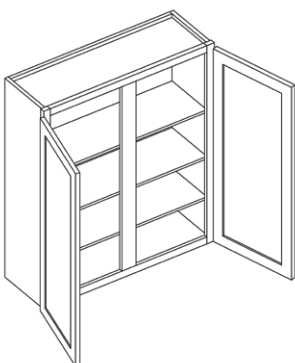

| Item Code | Outer Dimensions |    |    |   |   |
|-----------|------------------|----|----|---|---|
|           | W                | H  | D  | P | B |
| W4242     | 42               | 42 | 12 | ● | ● |

### 42" High Corner Wall

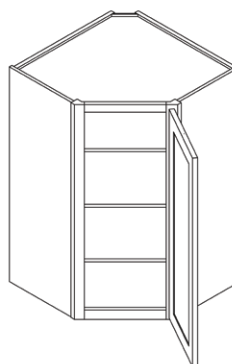

| Item Code | Outer Dimensions |    |    |   |   |
|-----------|------------------|----|----|---|---|
|           | W                | H  | D  | P | B |
| CW2442    | 24               | 42 | 12 | ● | ● |
| CW2742    | 27               | 42 | 15 | ● | ● |



## Installing a Blind Wall Cabinet

Proper installation ensures that the doors will open and show correct reveal

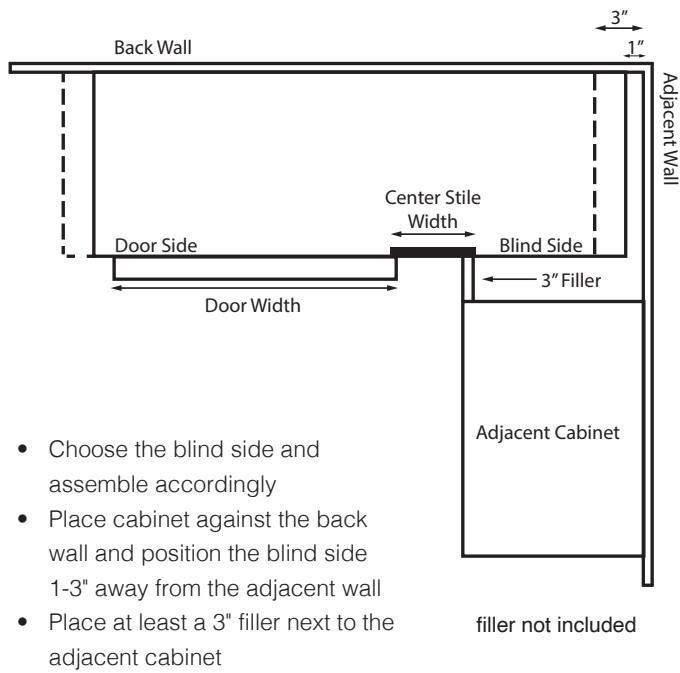

## Wall Tower with 3 Drawers

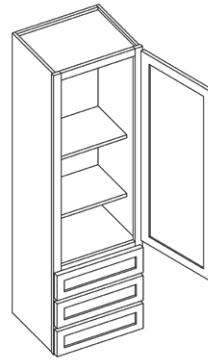

| Item Code | Outer Dimensions |    |    |   |   |
|-----------|------------------|----|----|---|---|
|           | W                | H  | D  | P | B |
| DWR1548   | 15               | 48 | 15 | • | - |
| DWR1554   | 15               | 54 | 15 | • | - |
| DWR1560   | 15               | 60 | 15 | • | - |

\*Works great with a vanity

## Wine Rack

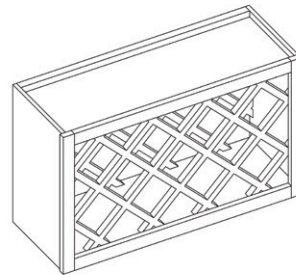

| Item Code | Outer Dimensions |    |    |   |   |
|-----------|------------------|----|----|---|---|
|           | W                | H  | D  | P | B |
| WR3018    | 30               | 18 | 12 | • | • |

## Wall Easy Reach

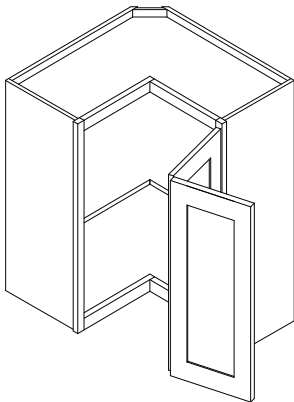

| Item Code | Outer Dimensions |    |    |   |   |
|-----------|------------------|----|----|---|---|
|           | W                | H  | D  | P | B |
| WER2430   | 24               | 30 | 12 | • | • |
| WER2436   | 24               | 36 | 12 | • | • |
| WER2442   | 24               | 42 | 12 | • | • |

\*Image shown is hinge left

## 30" - 36" High Blind Wall

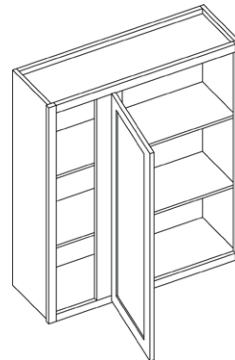

| Item Code | Outer Dimensions |    |    |   |   |
|-----------|------------------|----|----|---|---|
|           | W                | H  | D  | P | B |
| BW2430    | 24               | 30 | 12 | • | - |
| BW3030    | 30               | 30 | 12 | • | • |
| BW3630    | 36               | 30 | 12 | • | • |
| BW3036    | 30               | 36 | 12 | • | - |
| BW3636    | 36               | 36 | 12 | • | • |

\*Image shown is hinge left

## 42" High Blind Wall

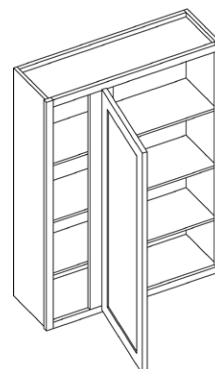

| Item Code | Outer Dimensions |    |    |   |   |
|-----------|------------------|----|----|---|---|
|           | W                | H  | D  | P | B |
| BW3042    | 30               | 42 | 12 | • | - |
| BW3642    | 36               | 42 | 12 | • | • |

\*Image shown is hinge left





### Base Cabinet Coding

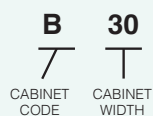

#### Notes:

- Standard base cabinets are 24" deep and 34.5" high.
- Add door thickness for total cabinet depth.
- Please refer to the Products by Cabinet Line chart to determine which products are carried for each cabinet line.
- Napa White has a single drawer on all sizes.

### Double Door Standard Base with Center Stile

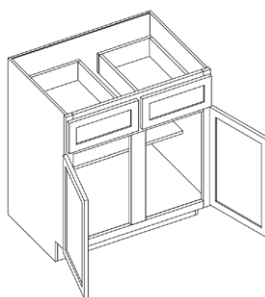

| Item Code | Outer Dimensions |      |    |   |   |
|-----------|------------------|------|----|---|---|
|           | W                | H    | D  | P | B |
| B42       | 42               | 34.5 | 24 | • | • |

### Microwave Base Cabinet

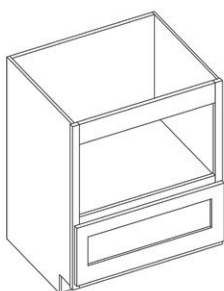

| Item Code | Outer Dimensions |      |    |   |   |
|-----------|------------------|------|----|---|---|
|           | W                | H    | D  | P | B |
| MBC30     | 30               | 34.5 | 24 | • | - |

\*Finished interior

### Double Door Standard Base

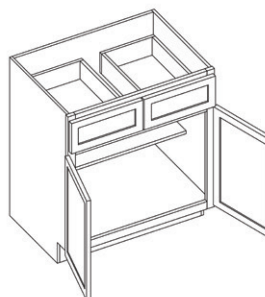

| Item Code | Outer Dimensions |      |    |   |   |
|-----------|------------------|------|----|---|---|
|           | W                | H    | D  | P | B |
| B24-2*    | 24               | 34.5 | 24 | • | • |
| B27       | 27               | 34.5 | 24 | • | • |
| B30       | 30               | 34.5 | 24 | • | • |
| B33       | 33               | 34.5 | 24 | • | • |
| B36       | 36               | 34.5 | 24 | • | • |
| B39       | 39               | 34.5 | 24 | • | • |

\*B24-2 has one drawer and two doors

\*Napa White has a single drawer front on all sizes.

Note: Builder has slab front drawers

### Single Door Full Height Base

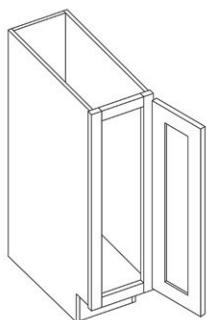

| Item Code | Outer Dimensions |      |    |   |   |
|-----------|------------------|------|----|---|---|
|           | W                | H    | D  | P | B |
| B09       | 9                | 34.5 | 24 | • | • |

### Easy Reach

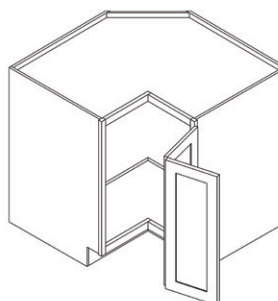

| Item Code | Outer Dimensions |      |    |   |   |
|-----------|------------------|------|----|---|---|
|           | W                | H    | D  | P | B |
| ER33      | 33               | 34.5 | 24 | • | - |
| ER36      | 36               | 34.5 | 24 | • | • |

### Single Door Standard Base

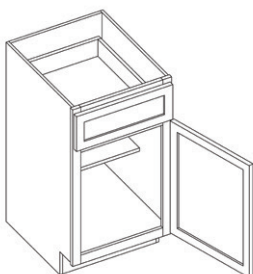

| Item Code | Outer Dimensions |      |    |   |   |
|-----------|------------------|------|----|---|---|
|           | W                | H    | D  | P | B |
| B12       | 12               | 34.5 | 24 | • | • |
| B15       | 15               | 34.5 | 24 | • | • |
| B18       | 18               | 34.5 | 24 | • | • |
| B21       | 21               | 34.5 | 24 | • | • |

Note: Builder has slab front drawers

### Trash Can Base (Full Height)

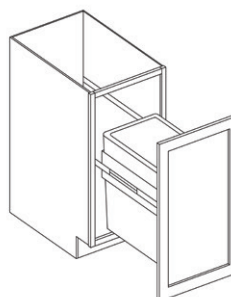

| Item Code | Outer Dimensions |      |    |   |   |
|-----------|------------------|------|----|---|---|
|           | W                | H    | D  | P | B |
| TRB-1*    | 18               | 34.5 | 24 | • | - |
| TRB-2**   | 18               | 34.5 | 24 | • | - |

\*Includes one 50 QT can

\*\*Includes two 35 QT cans



## Sink Base

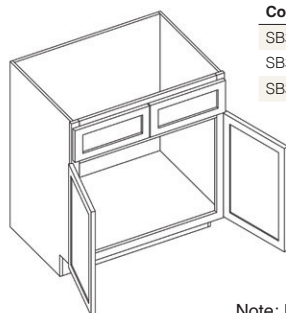

| Item Code | Outer Dimensions |      |    |   |   |
|-----------|------------------|------|----|---|---|
|           | W                | H    | D  | P | B |
| SB30      | 30               | 34.5 | 24 | ● | ● |
| SB33      | 33               | 34.5 | 24 | ● | ● |
| SB36      | 36               | 34.5 | 24 | ● | ● |

Note: Builder has slab front drawers



## Desk Drawer Base

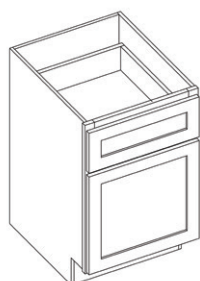

| Item Code | Outer Dimensions |      |    |   |   |
|-----------|------------------|------|----|---|---|
|           | W                | H    | D  | P | B |
| DDB18     | 18               | 29.5 | 24 | ● | - |

## Sink Base with Center Stile

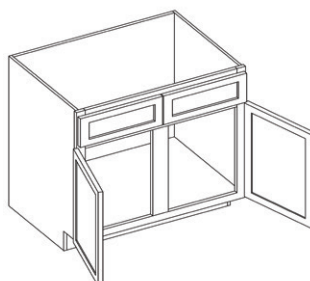

| Item Code | Outer Dimensions |      |    |   |   |
|-----------|------------------|------|----|---|---|
|           | W                | H    | D  | P | B |
| SB42      | 42               | 34.5 | 24 | ● | ● |
| SB48      | 48               | 34.5 | 24 | ● | - |

Note: Builder has slab front drawers

## Cooking Center

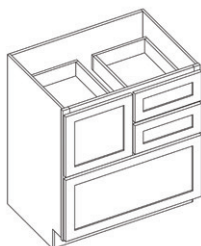

| Item Code | Outer Dimensions |      |    |   |   |
|-----------|------------------|------|----|---|---|
|           | W                | H    | D  | P | B |
| CC30      | 30               | 34.5 | 24 | ● | - |

## 36" Farm Sink Base

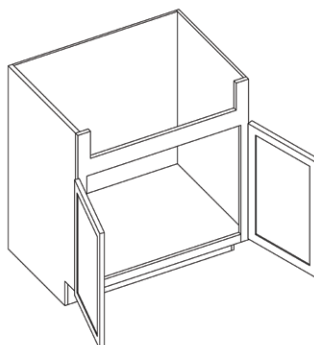

| Item Code | Outer Dimensions |      |    |   |   |
|-----------|------------------|------|----|---|---|
|           | W                | H    | D  | P | B |
| FSB36     | 36               | 34.5 | 24 | ● | - |

\*Height of sink inset is 13.5"

## Drawer Base



| Item Code | Outer Dimensions |      |    |   |   |
|-----------|------------------|------|----|---|---|
|           | W                | H    | D  | P | B |
| DB12-3    | 12               | 34.5 | 24 | ● | ● |
| DB15-3    | 15               | 34.5 | 24 | ● | ● |
| DB18-3    | 18               | 34.5 | 24 | ● | ● |
| DB21-3    | 21               | 34.5 | 24 | ● | ● |
| DB24-3    | 24               | 34.5 | 24 | ● | ● |
| DB27-3    | 27               | 34.5 | 24 | ● | - |
| DB30-3    | 30               | 34.5 | 24 | ● | - |
| DB33-3    | 33               | 34.5 | 24 | ● | - |
| DB36-3    | 36               | 34.5 | 24 | ● | - |

Note: Builder has slab front drawers

## Corner Sink Front

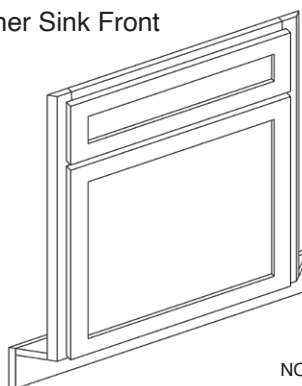

| Item Code  | Outer Dimensions |      |    |   |   |
|------------|------------------|------|----|---|---|
|            | W                | H    | D  | P | B |
| CSF42      | 27               | 34.5 | 2  | ● | ● |
| CSF-FLOOR* | 48               | 0.5  | 48 | ● | ● |

\*Sink floor not pictured and sold separately

\*Back of face frame measures 27" wide

NOTE: Hinges not included, to use as a workable door corner hinges are recommended.

Builder comes with slab false drawer

## Drawer Base - 2 Drawer

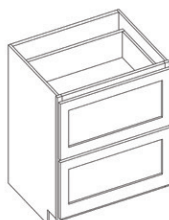

| Item Code | Outer Dimensions |      |    |   |   |
|-----------|------------------|------|----|---|---|
|           | W                | H    | D  | P | B |
| DB30-2    | 30               | 34.5 | 24 | ● | - |
| DB36-2    | 36               | 34.5 | 24 | ● | - |

### 36" Blind Base

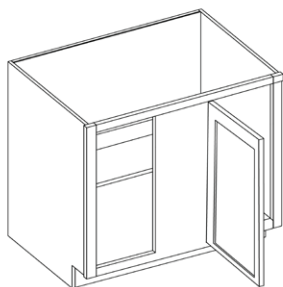

| Item Code | Outer Dimensions |      |    |   |   |
|-----------|------------------|------|----|---|---|
|           | W                | H    | D  | P | B |
| BB36      | 30               | 34.5 | 24 | • | • |

\*Image shown is hinge left

### 42" - 48" Blind Base

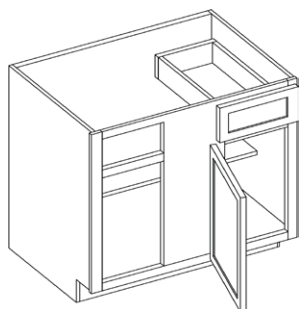

| Item Code | Outer Dimensions |      |    |   |   |
|-----------|------------------|------|----|---|---|
|           | W                | H    | D  | P | B |
| BB42      | 36               | 34.5 | 24 | • | • |
| BB48      | 48               | 34.5 | 24 | • | • |

\*Image shown is hinge left  
Note: Builder has slab front drawers

### Installing a Blind Base Cabinet

Proper installation ensures that the drawer will clear hardware, and doors will open, and show correct reveal

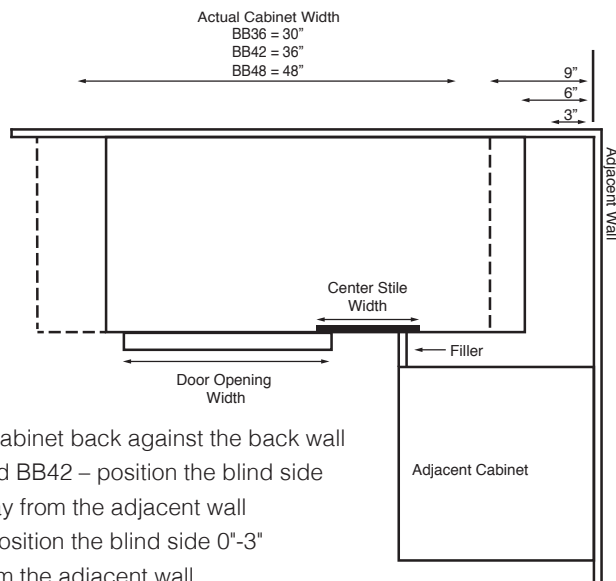

- Place the cabinet back against the back wall
  - BB36 and BB42 – position the blind side 6"-9" away from the adjacent wall
  - BB48 - position the blind side 0"-3" away from the adjacent wall
- Place at least a 3" filler next to adjacent cabinet

\*Filler not included









### Tall Cabinet Coding

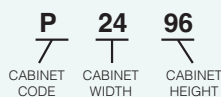

#### Notes:

- Standard tall cabinets are 24" deep.
- Add door thickness for total cabinet depth.
- Please refer to the Products by Cabinet Line chart to determine which products are carried for each cabinet line.

### Single Door Pantry

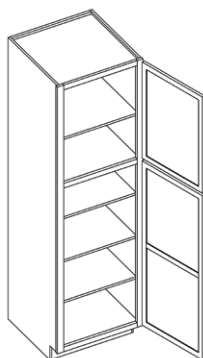

| Item Code | Outer Dimensions |    |    |   |   |
|-----------|------------------|----|----|---|---|
|           | W                | H  | D  | P | B |
| P1884*    | 18               | 84 | 24 | • | • |
| P1890*    | 18               | 90 | 24 | • | • |
| P1896**   | 18               | 96 | 24 | • | • |

\*Includes four shelves

\*\*Includes five shelves

### 24" and 30" Double Door Pantry

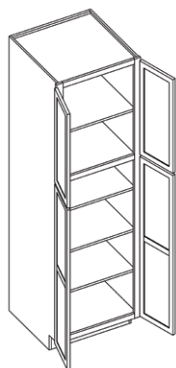

| Item Code | Outer Dimensions |    |    |   |   |
|-----------|------------------|----|----|---|---|
|           | W                | H  | D  | P | B |
| P2484*    | 24               | 84 | 24 | • | - |
| P2490*    | 24               | 90 | 24 | • | - |
| P2496**   | 24               | 96 | 24 | • | - |
| P3090*    | 30               | 90 | 24 | • | - |
| P3096**   | 30               | 96 | 24 | • | - |

\*Includes four shelves

\*\*Includes five shelves

### Oven Cabinet (Includes One Drawer)

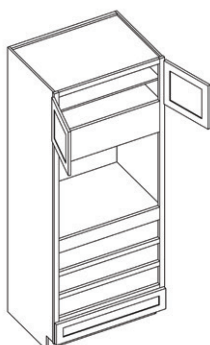

| Item Code | Outer Dimensions |    |    |   |   |
|-----------|------------------|----|----|---|---|
|           | W                | H  | D  | P | B |
| OC3390    | 33               | 90 | 24 | • | • |
| OC3396    | 33               | 96 | 24 | • | • |

\*Includes one drawer

\*Finished interior

### Oven Cabinet Drawer

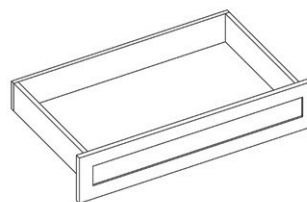

| Item Code | Outer Dimensions |      |    |   |   |
|-----------|------------------|------|----|---|---|
|           | W                | H    | D  | P | B |
| OCD337    | 32.5             | 6.75 | 24 | • | • |

Note: Builder has slab front drawers

### Oven Cabinet Overlay Panel

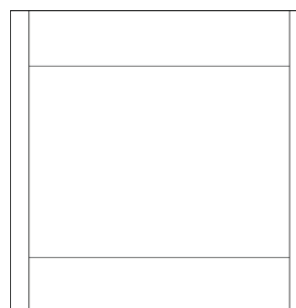

| Item Code | Outer Dimensions |    |      |   |   |
|-----------|------------------|----|------|---|---|
|           | W                | H  | D    | P | B |
| OP3353    | 32.5             | 53 | 0.75 | • | • |





## Vanity Cabinet Coding

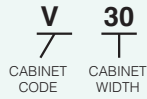

### Notes:

- Standard vanity cabinets are 21" deep.
- Add door thickness for total cabinet depth.
- Please refer to the Products by Cabinet Line chart to determine which products are carried for each cabinet line.
- Napa White has a single drawer on all sizes.



## Vanity Combo Cabinet 36"

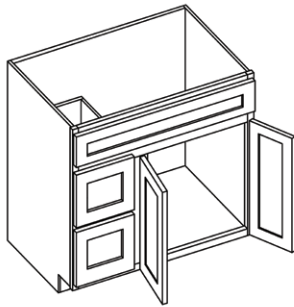

| Item Code | Outer Dimensions |      |    |   |   |
|-----------|------------------|------|----|---|---|
|           | W                | H    | D  | P | B |
| VSBDR36   | 36               | 34.5 | 21 | • | - |
| VSBDL36   | 36               | 34.5 | 21 | • | - |

\*Pictured is the VSBDL36

## Vanity Combo Cabinet 30"

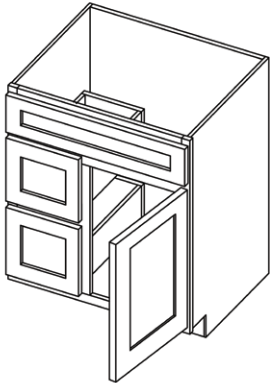

| Item Code | Outer Dimensions |      |    |   |   |
|-----------|------------------|------|----|---|---|
|           | W                | H    | D  | P | B |
| VSBDR30   | 30               | 34.5 | 21 | • | - |
| VSBDL30   | 30               | 34.5 | 21 | • | - |

\*Pictured is the VSBDL30

## 36" Open Shelf Vanity Sink Base

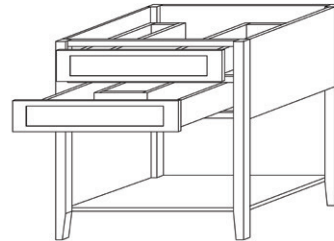

| Item Code | Outer Dimensions |      |    |   |   |
|-----------|------------------|------|----|---|---|
|           | W                | H    | D  | P | B |
| VSBOS36   | 36               | 34.5 | 21 | • | - |

\*Includes adjustable feet

\*Total height does not account for adjustable foot height

## Single Door Vanity

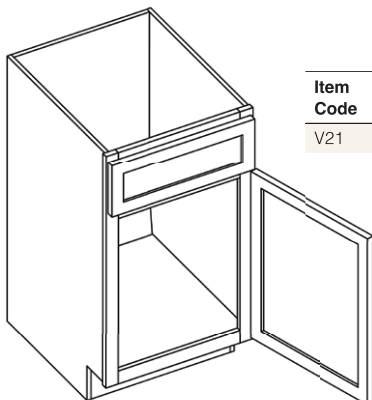

| Item Code | Outer Dimensions |      |    |   |   |
|-----------|------------------|------|----|---|---|
|           | W                | H    | D  | P | B |
| V21       | 21               | 34.5 | 21 | • | - |

## Double Door Vanity

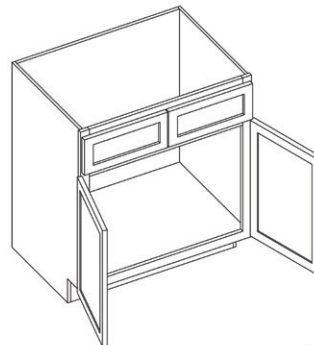

| Item Code | Outer Dimensions |      |    |   |   |
|-----------|------------------|------|----|---|---|
|           | W                | H    | D  | P | B |
| V24-2*    | 24               | 34.5 | 21 | • | • |
| V27       | 27               | 34.5 | 21 | • | • |
| V30       | 30               | 34.5 | 21 | • | • |
| V33       | 33               | 34.5 | 21 | • | • |
| V36       | 36               | 34.5 | 21 | • | • |

\*Has a single drawer front.

Note: Napa White has a single drawer front on all sizes.

Note: Builder has slab front drawers

### Vanity Drawer Base

| Item Code | Outer Dimensions |      |    |   |   |
|-----------|------------------|------|----|---|---|
|           | W                | H    | D  | P | B |
| VDB12     | 12               | 34.5 | 21 | • | • |
| VDB15     | 15               | 34.5 | 21 | • | • |
| VDB18     | 18               | 34.5 | 21 | • | • |
| VDB21     | 21               | 34.5 | 21 | - | • |
| VDB24     | 24               | 34.5 | 21 | • | • |



Note: Builder has slab front drawers

### Vanity Sink Base

| Item Code | Outer Dimensions |      |    |   |   |
|-----------|------------------|------|----|---|---|
|           | W                | H    | D  | P | B |
| VSB36     | 36               | 34.5 | 21 | • | • |
| VSB42     | 42               | 34.5 | 21 | • | • |
| VSB48     | 48               | 34.5 | 21 | • | • |

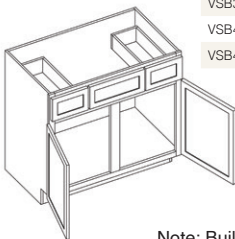

Note: Builder has slab front drawers

### Single Door Vanity Base

| Item Code | Outer Dimensions |      |    |   |   |
|-----------|------------------|------|----|---|---|
|           | W                | H    | D  | P | B |
| VB12      | 12               | 34.5 | 21 | • | - |
| VB15      | 15               | 34.5 | 21 | • | - |
| VB18      | 18               | 34.5 | 21 | • | • |

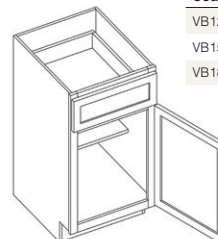

Note: Builder has slab front drawers

### 24" Vanity Drawer

| Item Code | Outer Dimensions |      |    |   |   |
|-----------|------------------|------|----|---|---|
|           | W                | H    | D  | P | B |
| KD24      | 23.5             | 4.75 | 21 | • | - |

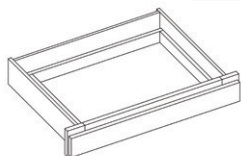

\*Drawer box height is 2"

NOTE: All drawer fronts will have a slab profile.

### 36" Vanity Drawer

| Item Code | Outer Dimensions |      |    |   |   |
|-----------|------------------|------|----|---|---|
|           | W                | H    | D  | P | B |
| KD36      | 29.5             | 4.75 | 21 | • | - |

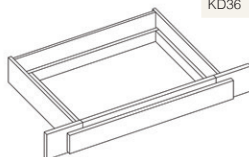

\*Drawer box height is 2"

\*Sides Trimmable to 30"

NOTE: All drawer fronts will have a slab profile.





Toe Kick - TKS8

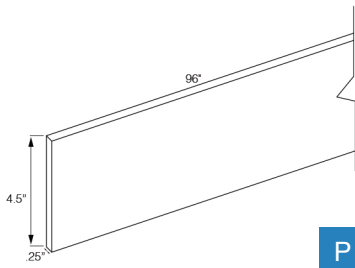

P B

Large Crown Molding - BCM8

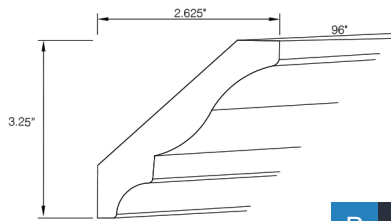

P B

Outside Corner Molding - OCM8

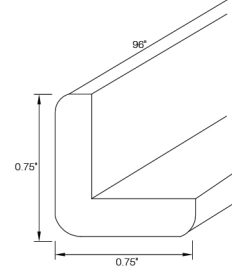

P B

Scribe - SCRIBE

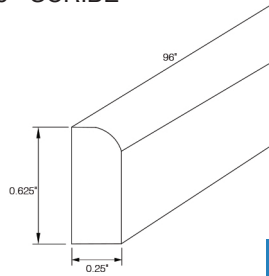

P B

Royal Crown Molding - RCM8

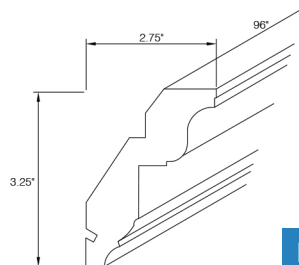

P B

Traditional Light Rail Molding - LRM8

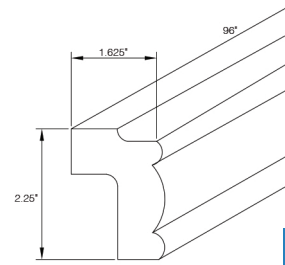

P B

Shoe - SHOE

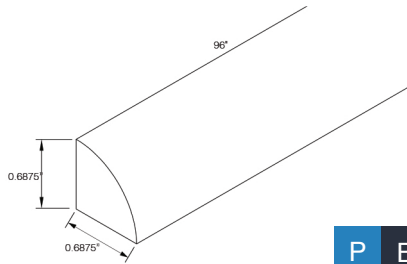

P B

Shaker Crown Molding - SCM8

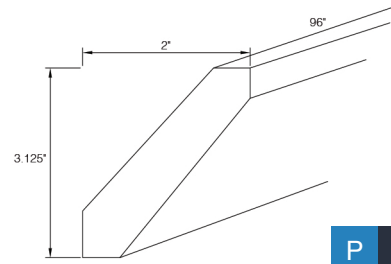

P B

Bottom Edge Molding - BEM8

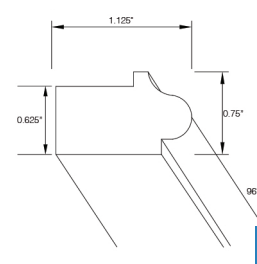

P B

Furniture Base Molding - FBM8

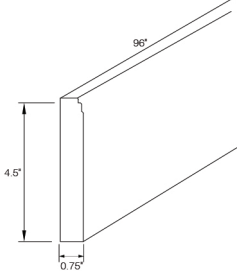

P B

Cove Crown Molding - COM8

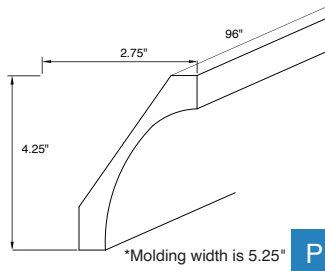

P B

Traditional Crown Molding - CM8

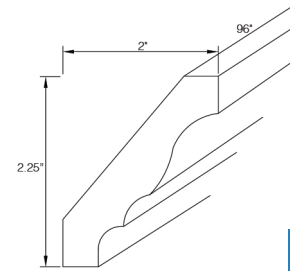

P B

Batten Molding - BAM8

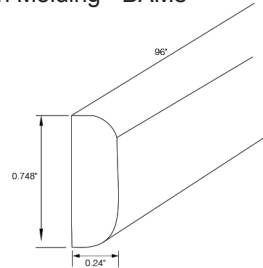

P B





### 1/2" Thick Finished Plywood Panel

P B



| Item Code | Outer Dimensions |    |     |
|-----------|------------------|----|-----|
|           | W                | H  | D   |
| PSP4896   | 96               | 48 | 0.5 |

\*Finished one side, natural UV back

### Back Panel - Long Grain Plywood

P B

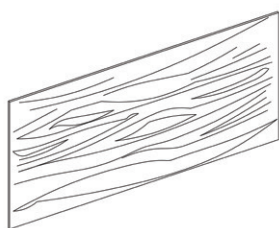

| Item Code | Outer Dimensions |    |      |
|-----------|------------------|----|------|
|           | W                | H  | D    |
| BPLG4896  | 48               | 96 | 0.25 |

\*Finished one side, raw back

### Bead Board

P B

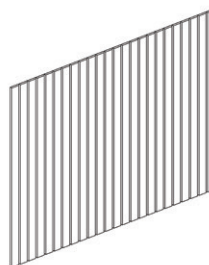

| Item Code | Outer Dimensions |    |      |
|-----------|------------------|----|------|
|           | W                | H  | D    |
| BBP4842   | 48               | 42 | 0.25 |

\*Finished one side, raw back

### Filler

P B



| Item Code | Outer Dimensions |    |      |
|-----------|------------------|----|------|
|           | W                | H  | D    |
| F396      | 3                | 96 | 0.75 |
| F696      | 6                | 96 | 0.75 |

\*All four edges finished

### Overlay Filler

P B



| Item Code | Outer Dimensions |       |      |
|-----------|------------------|-------|------|
|           | W                | H     | D    |
| OLF330    | 2.5              | 28.75 | 0.75 |
| OLF336    | 2.5              | 34.75 | 0.75 |
| OLF342    | 2.5              | 40.75 | 0.75 |
| OLF630    | 5.5              | 28.75 | 0.75 |

\*All four edges finished  
NOTE: Sizes do not measure true.

### Fluted Filler

P B



| Item Code | Outer Dimensions |    |      |
|-----------|------------------|----|------|
|           | W                | H  | D    |
| FF396     | 3                | 96 | 0.75 |

\*All four edges finished

### Dishwasher End Panel

P B



| Item Code | Outer Dimensions |      |    |
|-----------|------------------|------|----|
|           | W                | H    | D  |
| DWR3      | 3                | 34.5 | 24 |

\*0.5" panel thickness  
\*Finished one side, natural UV back

### Tall End Panel

P B



| Item Code | Outer Dimensions |    |    |
|-----------|------------------|----|----|
|           | W                | H  | D  |
| TEP3096   | 1.5              | 96 | 30 |

\*0.5" panel thickness  
\*Finished one side, natural UV back

### Bookcase End

P B



| Item Code | Outer Dimensions |    |    |
|-----------|------------------|----|----|
|           | W                | H  | D  |
| BCE1596   | 1.5              | 96 | 15 |

\*Requires shelf  
\*Shelf clips available  
\*0.5" panel thickness

### Shelf

P B

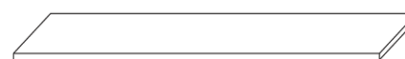

| Item Code    | Outer Dimensions |       |    |
|--------------|------------------|-------|----|
|              | W                | H     | D  |
| **SHELF1296  | 96               | 0.625 | 12 |
| ***SHELF2496 | 96               | 0.625 | 24 |

\*3/4" plywood construction  
\*\*Available in natural or painted  
\*\*\*Available in natural only



## Corbel - Basic Medium P B

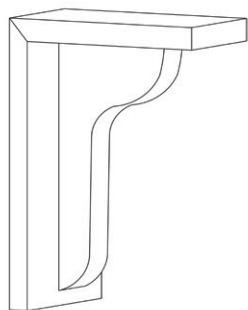

| Item Code | Outer Dimensions |      |     |
|-----------|------------------|------|-----|
|           | W                | H    | D   |
| CORSM     | 3                | 10.5 | 7.5 |

## Corbel - Transitional P B

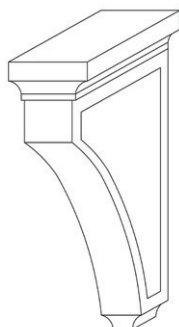

| Item Code | Outer Dimensions |      |   |
|-----------|------------------|------|---|
|           | W                | H    | D |
| CORT      | 3.5              | 10.5 | 7 |

## Turned Post P B

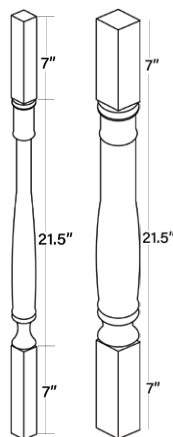

| Item Code | Outer Dimensions |      |   |
|-----------|------------------|------|---|
|           | W                | H    | D |
| TPOSTP3   | 3                | 35.5 | 3 |
| TPOSTP5   | 5                | 35.5 | 5 |

## Bunfoot - Transitional P B

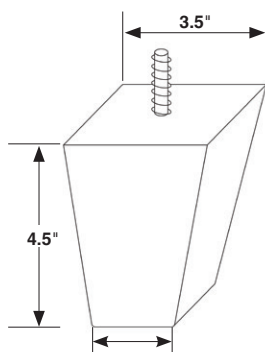

| Item Code | Outer Dimensions |     |        |
|-----------|------------------|-----|--------|
|           | H                | Top | Bottom |
| TBUNFOOT2 | 4.5              | 3.5 | 2      |

## Bunfoot P B

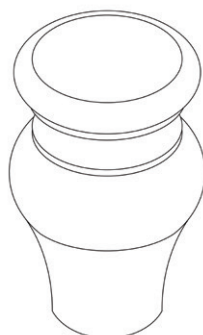

| Item Code | Outer Dimensions |     |   |
|-----------|------------------|-----|---|
|           | W                | H   | D |
| TBUNFOOT  | 3                | 4.5 | 3 |

## Decorative Base/Wall Panels P

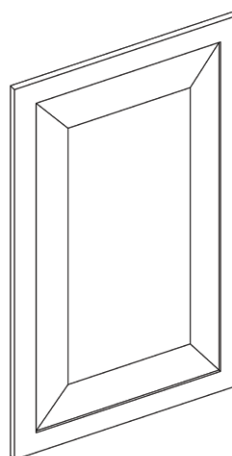

| Item Code | Outer Dimensions |       |      |
|-----------|------------------|-------|------|
|           | W                | H     | D    |
| DWP1215   | 11.5             | 13.75 | 0.75 |
| DWP2415   | 23.5             | 13.75 | 0.75 |
| DWP1230   | 11.5             | 28.75 | 0.75 |
| DWP2430   | 23.5             | 28.75 | 0.75 |
| DWP1236   | 11.5             | 34.75 | 0.75 |
| DWP1242   | 11.5             | 40.75 | 0.75 |

## Furniture Valance P

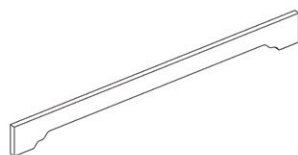

| Item Code | Outer Dimensions |     |      |
|-----------|------------------|-----|------|
|           | W                | H   | D    |
| VFUNR37   | 37               | 4.5 | 0.75 |



### Soft Close Roll Out Tray

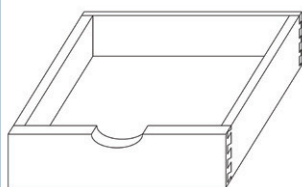

\*Includes two trays & four tracks

| Item Code | Outer Dimensions |   |    |   |   |
|-----------|------------------|---|----|---|---|
|           | W                | H | D  | P | B |
| ROT15-SC  | 10.125           | 4 | 21 | ● | ● |
| ROT18-SC  | 13.125           | 4 | 21 | ● | ● |
| ROT21-SC  | 16.125           | 4 | 21 | ● | ● |
| ROT24-SC  | 19.125           | 4 | 21 | ● | ● |
| ROT27-SC  | 22.125           | 4 | 21 | ● | ● |
| ROT30-SC  | 25.125           | 4 | 21 | ● | ● |
| ROT33-SC  | 28.125           | 4 | 21 | ● | ● |
| ROT36-SC  | 31.125           | 4 | 21 | ● | ● |

### Lazy Susan Kit

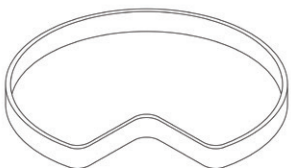

| Item Code | Outer Dimensions |     |    |   |   |
|-----------|------------------|-----|----|---|---|
|           | W                | H   | D  | P | B |
| LSK       | 29               | 1.5 | 29 | ● | ● |

\*Includes two trays for shelf mounting  
\*Birch plywood construction

### Trash Can Insert for B18

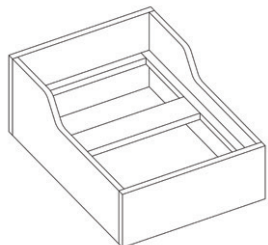

| Item Code | Outer Dimensions |       |       |   |   |
|-----------|------------------|-------|-------|---|---|
|           | W                | H     | D     | P | B |
| TCCK*     | 14.625           | 4.125 | 19.75 | ● | ● |

- Dovetail, solid wood construction
- Undermount, full extension, soft close slides

\*Includes two 35 QT cans

### Spice Rack Insert



| Item Code | Outer Dimensions |    |      |   |   |
|-----------|------------------|----|------|---|---|
|           | W                | H  | D    | P | B |
| SRI9-SC   | 5.75             | 24 | 20.5 | ● | ● |

\*Fits in the B09

### Cutlery Drawer Insert

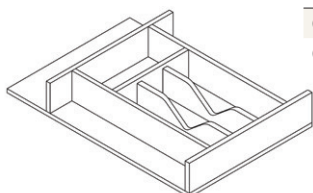

| Item Code | Outer Dimensions |      |       |   |   |
|-----------|------------------|------|-------|---|---|
|           | W                | H    | D     | P | B |
| CDI14     | 13.375           | 2.87 | 19.75 | ● | ● |
| CDI20     | 19.75            | 2.87 | 19.75 | ● | ● |

### Roll Out Tray Usage Guide

| Item Code | Designed to Fit          |
|-----------|--------------------------|
| ROT15-SC  | B15                      |
| ROT18-SC  | B18, P1884, P1890, P1896 |
| ROT21-SC  | B21                      |
| ROT24-SC  | B24, P2484, P2490, P2496 |
| ROT27-SC  | B27                      |
| ROT30-SC  | B30, SB30, P3090, P3096  |
| ROT33-SC  | B33, SB33                |
| ROT36-SC  | B36, SB36                |

### Spice Rack Door Attachment

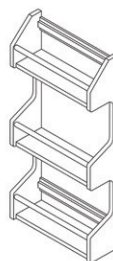

| Item Code | Outer Dimensions |    |   |   |   |
|-----------|------------------|----|---|---|---|
|           | W                | H  | D | P | B |
| SRD12     | 11.5             | 24 | 4 | ● | ● |
| SRD15     | 14.5             | 24 | 4 | ● | ● |

### Spice Tray Insert

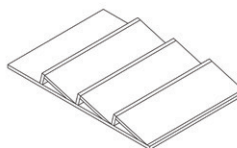

| Item Code | Outer Dimensions |       |       |   |   |
|-----------|------------------|-------|-------|---|---|
|           | W                | H     | D     | P | B |
| STI14     | 13.375           | 1.094 | 19.75 | ● | ● |
| STI20     | 19.75            | 1.094 | 19.75 | ● | ● |

### Stemware Rack

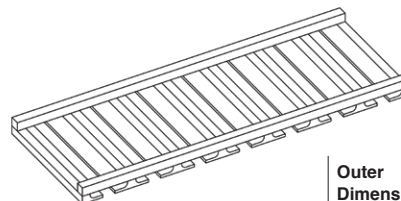

| Item Code | Outer Dimensions |     |      |   |   |
|-----------|------------------|-----|------|---|---|
|           | W                | H   | D    | P | B |
| SWR3012   | 28.5             | 1.5 | 10.5 | ● | ● |











# Floating Shelves



Decorative Hardware Collection offers Floating Shelves for accents to add beauty and function to your kitchen or bathroom.

Choose from three finishes and five different size options with our Floating Shelves. Create the clutter free look giving you the perfect balance of spontaneity and class.



White Oak

## Available Finishes



White Oak



Walnut



Maple



Walnut

## Available Widths

**12", 24", 30", 36", 42"**



Maple

## Brackets



Brackets (2/pkg) included with all floating shelves.

White Oak and Walnut are pre-finished and have a clear coat + 20 sheen. Maple shelves are unfinished.

| Item Code     | Item Description                          | Shaker  | Brooklyn | Napa |  |
|---------------|-------------------------------------------|---------|----------|------|--|
|               |                                           | Premier |          |      |  |
| Wall Cabinets |                                           |         |          |      |  |
| W3012         | Double Door Wall Cabinet - 30" W x 12" H  | ●       | ●        | ●    |  |
| W3312         | Double Door Wall Cabinet - 33" W x 12" H  | ●       | ●        | -    |  |
| W3612         | Double Door Wall Cabinet - 36" W x 12" H  | ●       | ●        | ●    |  |
| CWS2415       | 15" Corner Wall Stacking Cabinets         | ●       | ●        | ●    |  |
| CWS2715       | 15" Corner Wall Stacking Cabinets         | ●       | ●        | ●    |  |
| W3015         | Double Door Wall Cabinet - 30" W x 15" H  | ●       | ●        | ●    |  |
| W3315         | Double Door Wall Cabinet - 33" W x 15" H  | ●       | ●        | ●    |  |
| W3615         | Double Door Wall Cabinet - 36" W x 15" H  | ●       | ●        | ●    |  |
| WS1215        | 15" Wall Stacking Cabinets with Glass     | ●       | ●        | ●    |  |
| WS1515        | 15" Wall Stacking Cabinets with Glass     | ●       | ●        | ●    |  |
| WS1815        | 15" Wall Stacking Cabinets with Glass     | ●       | ●        | ●    |  |
| WS2115        | 15" Wall Stacking Cabinets with Glass     | ●       | ●        | ●    |  |
| WS2415-2      | 15" Wall Stacking Cabinets with Glass     | ●       | ●        | ●    |  |
| WS2715-2      | 15" Wall Stacking Cabinets with Glass     | ●       | ●        | ●    |  |
| WS3015-2      | 15" Wall Stacking Cabinets with Glass     | ●       | ●        | ●    |  |
| WS3315-2      | 15" Wall Stacking Cabinets with Glass     | ●       | ●        | ●    |  |
| WS3615-2      | 15" Wall Stacking Cabinets with Glass     | ●       | ●        | ●    |  |
| W3018         | Double Door Wall Cabinet - 30" W x 18" H  | ●       | ●        | ●    |  |
| W3318         | Double Door Wall Cabinet - 33" W x 18" H  | ●       | ●        | ●    |  |
| W3618         | Double Door Wall Cabinet - 36" W x 18" H  | ●       | ●        | ●    |  |
| W3021         | Double Door Wall Cabinet - 30" W x 21" H  | ●       | ●        | ●    |  |
| W3024         | Double Door Wall Cabinet - 30" W x 24" H  | ●       | ●        | ●    |  |
| W3324         | Double Door Wall Cabinet - 33" W x 24" H  | ●       | ●        | ●    |  |
| W3624         | Double Door Wall Cabinet - 36" W x 24" H  | ●       | ●        | ●    |  |
| W331824       | Deep Wall Cabinet - 33" W x 18" H x 24" D | ●       | ●        | ●    |  |
| W361824       | Deep Wall Cabinet - 36" W x 18" H x 24" D | ●       | ●        | ●    |  |
| W332424       | Deep Wall Cabinet - 33" W x 24" H x 24" D | ●       | ●        | ●    |  |
| W362424       | Deep Wall Cabinet - 36" W x 24" H x 24" D | ●       | ●        | ●    |  |
| W930          | Single Door Wall Cabinet - 9" W x 30" H   | ●       | ●        | ●    |  |
| W1230         | Single Door Wall Cabinet - 12" W x 30" H  | ●       | ●        | ●    |  |
| W1530         | Single Door Wall Cabinet - 15" W x 30" H  | ●       | ●        | ●    |  |
| W1830         | Single Door Wall Cabinet - 18" W x 30" H  | ●       | ●        | ●    |  |
| W2130         | Single Door Wall Cabinet - 21" W x 30" H  | ●       | ●        | ●    |  |
| W2430-2       | Double Door Wall Cabinet - 24" W x 30" H  | ●       | ●        | ●    |  |
| W2730         | Double Door Wall Cabinet - 27" W x 30" H  | ●       | ●        | ●    |  |
| W3030         | Double Door Wall Cabinet - 30" W x 30" H  | ●       | ●        | ●    |  |
| W3330         | Double Door Wall Cabinet - 33" W x 30" H  | ●       | ●        | ●    |  |
| W3630         | Double Door Wall Cabinet - 36" W x 30" H  | ●       | ●        | ●    |  |
| W3930         | Double Door Wall Cabinet - 39" W x 30" H  | ●       | ●        | ●    |  |
| W4230         | Double Door Wall Cabinet - 42" W x 30" H  | ●       | ●        | ●    |  |
| BW2430        | Blind Wall Cabinet - 24" W x 30" H        | ●       | ●        | ●    |  |
| BW3030        | Blind Wall Cabinet - 30" W x 30" H        | ●       | ●        | ●    |  |
| BW3630        | Blind Wall Cabinet - 36" W x 30" H        | ●       | ●        | ●    |  |
| CW2430        | Corner Wall Cabinet - 24" W x 30" H       | ●       | ●        | ●    |  |
| W936          | Single Door Wall Cabinet - 9" W x 36" H   | ●       | ●        | ●    |  |
| W1236         | Single Door Wall Cabinet - 12" W x 36" H  | ●       | ●        | ●    |  |
| W1536         | Single Door Wall Cabinet - 15" W x 36" H  | ●       | ●        | ●    |  |
| W1836         | Single Door Wall Cabinet - 18" W x 36" H  | ●       | ●        | ●    |  |
| W2136         | Single Door Wall Cabinet - 21" W x 36" H  | ●       | ●        | ●    |  |
| W2436-2       | Double Door Wall Cabinet - 24" W x 36" H  | ●       | ●        | ●    |  |
| W2736         | Double Door Wall Cabinet - 27" W x 36" H  | ●       | ●        | ●    |  |



| Item Code     | Item Description                               | Shaker  | Brooklyn | Napa |  |
|---------------|------------------------------------------------|---------|----------|------|--|
|               |                                                | Premier |          |      |  |
| Wall Cabinets |                                                |         |          |      |  |
| W3036         | Double Door Wall Cabinet - 30" W x 36" H       | ●       | ●        | ●    |  |
| W3336         | Double Door Wall Cabinet - 33" W x 36" H       | ●       | ●        | ●    |  |
| W3636         | Double Door Wall Cabinet - 36" W x 36" H       | ●       | ●        | ●    |  |
| W3936         | Double Door Wall Cabinet - 39" W x 36" H       | ●       | ●        | ●    |  |
| W4236         | Double Door Wall Cabinet - 42" W x 36" H       | ●       | ●        | ●    |  |
| BW3036        | Blind Wall Cabinet - 30" W x 36" H             | ●       | ●        | ●    |  |
| BW3636        | Blind Wall Cabinet - 36" W x 36" H             | ●       | ●        | ●    |  |
| CW2436        | Corner Wall Cabinet - 24" W x 36" H            | ●       | ●        | ●    |  |
| CW2736        | Corner Wall Cabinet - 27" W x 36" H            | ●       | ●        | ●    |  |
| W942          | Single Door Wall Cabinet - 9" W x 42" H        | ●       | ●        | ●    |  |
| W1242         | Single Door Wall Cabinet - 12" W x 42" H       | ●       | ●        | ●    |  |
| W1542         | Single Door Wall Cabinet - 15" W x 42" H       | ●       | ●        | ●    |  |
| W1842         | Single Door Wall Cabinet - 18" W x 42" H       | ●       | ●        | ●    |  |
| W2142         | Single Door Wall Cabinet - 21" W x 42" H       | ●       | ●        | ●    |  |
| W2442-2       | Double Door Wall Cabinet - 24" W x 42" H       | ●       | ●        | ●    |  |
| W2742         | Double Door Wall Cabinet - 27" W x 42" H       | ●       | ●        | ●    |  |
| W3042         | Double Door Wall Cabinet - 30" W x 42" H       | ●       | ●        | ●    |  |
| W3342         | Double Door Wall Cabinet - 33" W x 42" H       | ●       | ●        | ●    |  |
| W3642         | Double Door Wall Cabinet - 36" W x 42" H       | ●       | ●        | ●    |  |
| W3942         | Double Door Wall Cabinet - 39" W x 42" H       | ●       | ●        | ●    |  |
| W4242         | Double Door Wall Cabinet - 42" W x 42" H       | ●       | ●        | ●    |  |
| BW3042        | Blind Wall Cabinet - 30" W x 42" H             | ●       | ●        | ●    |  |
| BW3642        | Blind Wall Cabinet - 36" W x 42" H             | ●       | ●        | ●    |  |
| CW2442        | Corner Wall Cabinet - 24" W x 42" H            | ●       | ●        | ●    |  |
| CW2742        | Corner Wall Cabinet - 27" W x 42" H            | ●       | ●        | ●    |  |
| DWR1548       | Wall Twr w/ 3 Drws - 15" W x 48" H x 15" D     | ●+      | ●        | ●    |  |
| DWR1554       | Wall Twr w/ 3 Drws - 15" W x 54" H x 15" D     | ●+      | ●        | ●    |  |
| DWR1560       | Wall Twr w/ 3 Drws - 15" W x 60" H x 15" D     | ●+      | ●        | ●    |  |
| MWC3018       | Microwave Wall Cabinet - 30" W x 18" H x 12" D | ●       | ●        | ●    |  |
| WR3018        | Wine Rack - 30" W x 18" H x 12" D              | ●       | ●        | ●    |  |
| Base Cabinets |                                                |         |          |      |  |
| B09           | Single Door Full Height Base Cabinet - 9" W    | ●       | ●        | ●    |  |
| B12           | Single Door Standard Base Cabinet - 12" W      | ●+      | ●        | ●    |  |
| B15           | Single Door Standard Base Cabinet - 15" W      | ●+      | ●        | ●    |  |
| B18           | Single Door Standard Base Cabinet - 18" W      | ●+      | ●        | ●    |  |
| B21           | Single Door Standard Base Cabinet - 21" W      | ●+      | ●        | ●    |  |
| B24-2         | Double Door Standard Base Cabinet - 24" W      | ●+      | ●        | ●    |  |
| B27           | Double Door Standard Base Cabinet - 27" W      | ●+      | ●        | ●    |  |
| B30           | Double Door Standard Base Cabinet - 30" W      | ●+      | ●        | ●    |  |
| B33           | Double Door Standard Base Cabinet - 33" W      | ●+      | ●        | ●    |  |
| B36           | Double Door Standard Base Cabinet - 36" W      | ●+      | ●        | ●    |  |
| B39           | Double Door Standard Base Cabinet - 39" W      | ●+      | ●        | ●    |  |
| B42           | Double Door Standard Base Cabinet - 42" W      | ●+      | ●        | ●    |  |

| Item Code     | Item Description                                | Shaker  | Brooklyn | Napa |  |
|---------------|-------------------------------------------------|---------|----------|------|--|
|               |                                                 | Premier |          |      |  |
| Base Cabinets |                                                 |         |          |      |  |
| DB12-3        | Drawer Base Cabinet - 12" W                     | ●+      | ●        | ●    |  |
| DB15-3        | Drawer Base Cabinet - 15" W                     | ●+      | ●        | ●    |  |
| DB18-3        | Drawer Base Cabinet - 18" W                     | ●+      | ●        | ●    |  |
| DB21-3        | Drawer Base Cabinet - 21" W                     | ●+      | ●        | ●    |  |
| DB24-3        | Drawer Base Cabinet - 24" W                     | ●+      | ●        | ●    |  |
| DB27-3        | Drawer Base Cabinet - 27" W                     | ●+      | ●        | -    |  |
| DB30-3        | Drawer Base Cabinet - 30" W                     | ●+      | ●        | ●    |  |
| DB33-3        | Drawer Base Cabinet - 33" W                     | ●+      | ●        | -    |  |
| DB36-3        | Drawer Base Cabinet - 36" W                     | ●+      | ●        | ●    |  |
| DB30-2        | 2 Drawer Base Cabinet - 30" W                   | ●+      | ●        | ●    |  |
| DB36-2        | 2 Drawer Base Cabinet - 36" W                   | ●+      | ●        | -    |  |
| CC30          | Cooking Center Base Cabinet - 30" W             | ●+      | ●        | ●    |  |
| FSB36         | Farm Sink Base Cabinet - 36" W                  | ●+      | ●        | ●    |  |
| TRB-1         | Trash Can Base w/ Full Ht Door -18" W           | ●+      | ●        | ●    |  |
| TRB-2         | Trash Can Base w/ Full Ht Door -18" W           | ●+      | ●        | ●    |  |
| SB30          | Sink Base Cabinet - 30" W                       | ●+      | ●        | ●    |  |
| SB33          | Sink Base Cabinet - 33" W                       | ●+      | ●        | ●    |  |
| SB36          | Sink Base Cabinet - 36" W                       | ●+      | ●        | ●    |  |
| SB42          | Sink Base Cabinet w/ CS - 42" W                 | ●+      | ●        | ●    |  |
| SB48          | Sink Base Cabinet w/ CS - 48" W                 | ●+      | ●        | ●    |  |
| CSF42         | Corner Sink Front for 42" Space - 27" W         | ●+      | ●        | ●    |  |
| CSF-FLOOR     | Natural Corner Sink Front Floor 48" x 48"       | ●       | ●        | ●    |  |
| BB36          | Blind Base Cabinet for 36" to 39" Space - 30"W  | ●       | ●        | ●    |  |
| BB42          | Blind Base Cabinet for 42" to 45" Space - 36" W | ●+      | ●        | ●    |  |
| BB48          | Blind Base Cab for 48" to 51" Space - 48" W     | ●+      | ●        | ●    |  |
| ER33          | Easy Reach Base Cabinet - 33" W x 33" D         | ●       | ●        | ●    |  |
| ER36          | Easy Reach Base Cabinet - 36" W x 36" D         | ●       | ●        | ●    |  |
| DDB18         | Desk Drawer Base - 18" W x 29.5" H x 24" D      | ●+      | ●        | ●    |  |
| MBC30         | Microwave Base Cabinet - 30" W                  | ●+      | ●        | ●    |  |
| Tall Cabinets |                                                 |         |          |      |  |
| P1884         | Pantry - 18" W x 84" H                          | ●       | ●        | ●    |  |
| P1890         | Pantry - 18" W x 90" H                          | ●       | ●        | ●    |  |
| P1896         | Pantry - 18" W x 96" H                          | ●       | ●        | ●    |  |
| P2484         | Pantry - 24" W x 84" H                          | ●       | ●        | ●    |  |
| P2490         | Pantry - 24" W x 90" H                          | ●       | ●        | ●    |  |
| P2496         | Pantry - 24" W x 96" H                          | ●       | ●        | ●    |  |
| P3090         | Pantry - 30" W x 90" H                          | ●       | ●        | ●    |  |
| P3096         | Pantry - 30" W x 96" H                          | ●       | ●        | ●    |  |
| OC3390        | Oven Cabinet - 33" W x 90" H                    | ●+      | ●        | ●    |  |
| OC3396        | Oven Cabinet - 33" W x 96" H                    | ●+      | ●        | ●    |  |
| OP3353        | Oven Cabinet Overlay Panel - 33" W x 53" H      | ●       | ●        | ●    |  |
| OCD337        | Oven Cabinet Drawer                             | ●+      | ●        | ●    |  |
| Vanities      |                                                 |         |          |      |  |
| V21           | Single Door Vanity - 21" W                      | ●+      | ●        | -    |  |
| V24-2         | Double Door Vanity - 24" W                      | ●+      | ●        | ●    |  |
| V27           | Double Door Vanity - 27" W                      | ●+      | ●        | ●    |  |
| V30           | Double Door Vanity - 30" W                      | ●+      | ●        | ●    |  |
| V33           | Double Door Vanity - 33" W                      | ●+      | ●        | ●    |  |
| V36           | Double Door Vanity - 36" W                      | ●+      | ●        | ●    |  |
| VB12          | Single Door Base Vanity - 12" W                 | ●+      | ●        | ●    |  |
| VB15          | Single Door Base Vanity - 15" W                 | ●+      | ●        | ●    |  |
| VB18          | Single Door Base Vanity - 18" W                 | ●+      | ●        | ●    |  |



| Item Code          | Item Description                                | Shaker  | Brooklyn | Napa |  |
|--------------------|-------------------------------------------------|---------|----------|------|--|
|                    |                                                 | Premier |          |      |  |
| Vanities           |                                                 |         |          |      |  |
| VDB12              | Vanity Drawer Base - 12" W                      | ●+      | ●        | ●    |  |
| VDB15              | Vanity Drawer Base - 15" W                      | ●+      | ●        | ●    |  |
| VDB18              | Vanity Drawer Base - 18" W                      | ●+      | ●        | ●    |  |
| VDB21              | Vanity Drawer Base - 21" W                      | -       | -        | -    |  |
| VDB24              | Vanity Drawer Base - 24" W                      | ●+      | ●        | ●    |  |
| VS36               | Vanity Sink Base - 36" W                        | ●+      | ●        | ●    |  |
| VS42               | Vanity Sink Base - 42" W                        | ●+      | ●        | ●    |  |
| VS48               | Vanity Sink Base - 48" W                        | ●+      | ●        | ●    |  |
| VSBDR30            | Vanity Sink Drawer Base Right - 30" W           | ●+      | ●        | ●    |  |
| VSBDL30            | Vanity Sink Drawer Base Left - 30" W            | ●+      | ●        | ●    |  |
| VSBDR36            | Vanity Sink Drawer Base Right – 36" W           | ●+      | ●        | ●    |  |
| VSBDL36            | Vanity Sink Drawer Base Left – 36" W            | ●+      | ●        | ●    |  |
| KD24               | Vanity Drawer - 24" W                           | ●       | ●        | ●    |  |
| KD36               | Vanity Drawer - 36" W with Adjustable Sides     | ●       | ●        | ●    |  |
| VS36               | Open Shelf Vanity SB - 36" W                    | ●       | ●        | ●    |  |
| Moldings and Trim  |                                                 |         |          |      |  |
| BAM8               | Batten Molding                                  | ●       | ●        | ●    |  |
| BCM8               | Large Crown Molding                             | -       | ●        | ●    |  |
| BEM8               | Bottom Edge Molding (Narrow Light Rail)         | ●       | ●        | ●    |  |
| CM8                | Traditional Crown Molding                       | -       | ●        | ●    |  |
| COM8               | Cove Crown Molding                              | ●       | ●        | ●    |  |
| FBM8               | Furniture Base Molding                          | ●       | ●        | ●    |  |
| LRM8               | Traditional Light Rail                          | ●       | ●        | ●    |  |
| OCM8               | Outside Corner Molding                          | ●       | ●        | ●    |  |
| RCM8               | Royal Crown Molding                             | ●       | ●        | ●    |  |
| SCM8               | Shaker Crown Molding                            | ●       | -        | -    |  |
| SHOE               | Shoe Molding                                    | ●       | ●        | ●    |  |
| SCRIBE             | Scribe                                          | ●       | ●        | ●    |  |
| TKS8               | Toe Kick                                        | ●       | ●        | ●    |  |
| Fillers and Panels |                                                 |         |          |      |  |
| BBP4842            | Bead Board - 48" W x 42" H x 0.25" D            | ●       | ●        | ●    |  |
| BCE1596            | Book Case End - 1.5" W x 96" H x 15" D          | ●       | ●        | ●    |  |
| BPLG4896           | Back Panel (Long Grain) - 48" W x 96" H         | ●       | ●        | ●    |  |
| DWR3               | Dishwasher End Panel 3" W x 34.5" H x 24" D     | ●       | ●        | ●    |  |
| F396               | Filler - 3" W x 96" H                           | ●       | ●        | ●    |  |
| F696               | Filler - 6" W x 96" H                           | ●       | ●        | ●    |  |
| FF396              | Fluted Filler - 3" W x 96" H                    | -       | ●        | ●    |  |
| OLF330             | Overlay Filler - 3" W x 30" H                   | ●       | ●        | ●    |  |
| OLF336             | Overlay Filler - 3" W x 36" H                   | ●       | ●        | ●    |  |
| OLF342             | Overlay Filler - 3" W x 42" H                   | ●       | ●        | ●    |  |
| OLF630             | Overlay Filler - 6" W x 30" H                   | ●       | ●        | ●    |  |
| PSP4896            | 1/2" Thick Finished Plywood Panel 96" W x 48" H | ●       | ●        | ●    |  |
| TEP3096            | Tall End Panel 1.5" W x 96" H x 30" D           | ●       | ●        | ●    |  |

| Item Code               | Item Description                                                     | Shaker  | Brooklyn | Napa |  |
|-------------------------|----------------------------------------------------------------------|---------|----------|------|--|
|                         |                                                                      | Premier |          |      |  |
| Decorative Accessories  |                                                                      |         |          |      |  |
| CORSM                   | Basic Medium Corbel - 10.5" H                                        | ●       | ●        | ●    |  |
| CORT                    | Transitional Corbel 3.5" W x 10.5" H x 7" D                          | ●       | ●        | ●    |  |
| TBUNFOOT                | Traditional Bunfoot 3" W x 4.5" H x 3" D                             | ●       | ●        | ●    |  |
| TBUNFOOT2               | Transitional Bunfoot 4.5" H x 3.5" T x 2" B                          | ●       | ●        | ●    |  |
| TPOSTP3                 | Turned Post - 3" W x 35.5" H                                         | ●       | ●        | ●    |  |
| TPOSTP5                 | Turned Post - 5" W x 35.5" H                                         | ●       | ●        | ●    |  |
| VFURN37                 | Furniture Valance - 37" W                                            | ●       | ●        | ●    |  |
| VRP42                   | Raised Panel Valance - 42" W                                         | -       | ●        | ●    |  |
| VRP48                   | Raised Panel Valance - 48" W                                         | -       | ●        | ●    |  |
| DWP1215                 | Decorative Wall Panel - 12" W x 15" H                                | ●       | ●        | ●    |  |
| DWP1230                 | Decorative Wall Panel - 12" W x 30" H                                | ●       | ●        | ●    |  |
| DWP1236                 | Decorative Wall Panel - 12" W x 36" H                                | ●       | ●        | ●    |  |
| DWP1242                 | Decorative Wall Panel - 12" W x 42" H                                | ●       | ●        | ●    |  |
| DWP2415                 | Decorative Wall Panel - 24" W x 15" H                                | ●       | ●        | ●    |  |
| DWP2430                 | Decorative Wall Panel - 24" W x 30" H                                | ●       | ●        | ●    |  |
| Attachments and Inserts |                                                                      |         |          |      |  |
| ROT15-SC                | Natural Roll Out Tray for 15" Space (2/pkg)                          | ●       | ●        | ●    |  |
| ROT18-SC                | Natural Roll Out Tray for 18" Space (2/pkg)                          | ●       | ●        | ●    |  |
| ROT21-SC                | Natural Roll Out Tray for 21" Space (2/pkg)                          | ●       | ●        | ●    |  |
| ROT24-SC                | Natural Roll Out Tray for 24" Space (2/pkg)                          | ●       | ●        | ●    |  |
| ROT27-SC                | Natural Roll Out Tray for 27" Space (2/pkg)                          | ●       | ●        | ●    |  |
| ROT30-SC                | Natural Roll Out Tray for 30" Space (2/pkg)                          | ●       | ●        | ●    |  |
| ROT33-SC                | Natural Roll Out Tray for 33" Space (2/pkg)                          | ●       | ●        | ●    |  |
| ROT36-SC                | Natural Roll Out Tray for 36" Space (2/pkg)                          | ●       | ●        | ●    |  |
| LSK                     | Natural Lazy Susan Kit (2/pkg)                                       | ●       | ●        | ●    |  |
| TCKK                    | Trash Can Insert for B18 with 2 35 QT Trash Cans                     | ●       | ●        | ●    |  |
| SRI9                    | Natural Spice Rack Insert for B9 Drawer                              | ●       | ●        | ●    |  |
| CDI14                   | Natural Cutlery Drawer Insert for B15/B18                            | ●       | ●        | ●    |  |
| CDI20                   | Natural Cutlery Drawer Insert for B21/B24                            | ●       | ●        | ●    |  |
| SRD12                   | Natural Spice Rack Door Mount for 18" Door                           | ●       | ●        | ●    |  |
| SRD15                   | Natural Spice Rack Door Mount for 21" Door                           | ●       | ●        | ●    |  |
| STI14                   | Natural Spice Tray Drawer Insert for B15/B18                         | ●       | ●        | ●    |  |
| STI20                   | Natural Spice Tray Drawer Insert for B21/B24                         | ●       | ●        | ●    |  |
| SWR3012                 | Stemware Rack                                                        | ●       | ●        | ●    |  |
| Miscellaneous Parts     |                                                                      |         |          |      |  |
| SHELF1296               | Painted/Stained Shelf - 96" W x 12" D                                | ●       | ●        | ●    |  |
| SHELF2496               | Painted/Stained Shelf - 96" W x 24" D                                | ●       | ●        | ●    |  |
| YN-SHELF1296            | Natural Shelf - 96" W x 12" D                                        | ●       | ●        | ●    |  |
| YN-SHELF2496            | Natural Shelf - 96" W x 24" D                                        | ●       | ●        | ●    |  |
| SPRAYCAN                | Aerosol Spray Can                                                    | ●       | ●        | ●    |  |
| TUKIT                   | Touch Up Kit                                                         | ●       | ●        | ●    |  |
| YN-PAB                  | Plastic Assembly Blocks (100/pkg)                                    | ●       | ●        | ●    |  |
| YN-BRACKETS             | Metal Assembly Bracket (12/pkg)                                      | ●       | ●        | ●    |  |
| YN-SOFTCLOSE            | Soft Close Hinge                                                     | ●       | ●        | ●    |  |
| YN-ERHINGE-SET          | Easy Reach Hinges - Includes 2 frame-to-door & 2 door-to-door hinges | ●       | ●        | ●    |  |
| YN-SOFTCLOSE-CW         | Soft Close Corner Wall Hinge                                         | ●       | ●        | ●    |  |
| YN-BUMPER               | Clear bumpers (50/sheet)                                             | ●       | ●        | ●    |  |
| YN-Drawer Slide-Kitchen | Drawer Slide-Kitchen Pair                                            | ●       | ●        | ●    |  |
| YN-Drawer Slide-Vanity  | Drawer Slide - Vanity Pair                                           | ●       | ●        | ●    |  |
| YN-SHELF CLIP           | Shelf Clip                                                           | ●       | ●        | ●    |  |