

PREMIER

With the highest quality materials and finest attention to detail, our Premier Series offers distinctive touches and superb craftsmanship. Whether you love traditional or modern design, the Premier Series has a look to fit your lifestyle. Features include full overlay doors, plywood boxes, a solid wood dovetail drawer box, as well as a five-piece drawer head and soft close doors and drawers.



SHAKER

DESIGNER WHITE



ESPRESSO



BROOKLYN

MODERN GRAY



BRIGHT WHITE



SLATE



LENOX

COUNTRY LINEN



MOCHA



CANVAS



PREMIER | NEW STYLE

A new addition to our Premier Series, Napa White offers an adaptable option that adds dimension and softness to any style. The bright white finish provides a charming and traditional feel perfect in any home. As part of the Premier Series, Napa features include full overlay doors, plywood boxes, a solid wood dovetail drawer box, as well as a five-piece drawer head and soft close doors and drawers.

WHITE



NAPA



Product Specs

Wall Cabinets

Wall Cabinet Coding

Standard (12" Deep)

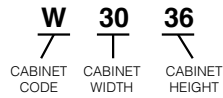

Refrigerator



Notes:

- Standard wall cabinets are 12" deep. Refrigerator cabinets are 24" deep.
- Add door thickness for total cabinet depth.
- Please refer to the Products by Cabinet Line chart to determine which products are carried for each cabinet line.

24" High Double Door Wall

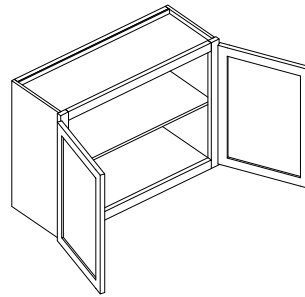

Item Code	Outer Dimensions		
	W	H	D
W3024	30	24	12
W3324	33	24	12
W3624	36	24	12

15" Wall Stacking Cabinets with Glass

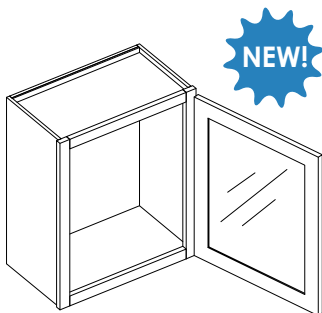

Item Code	Outer Dimensions		
	W	H	D
WS1215	12	15	12
WS1515	15	15	12
WS1815	18	15	12
WS2115	21	15	12

*Door comes pre-routed with glass insert and finished interior

24" Deep Wall (Refrigerator Cabinet)

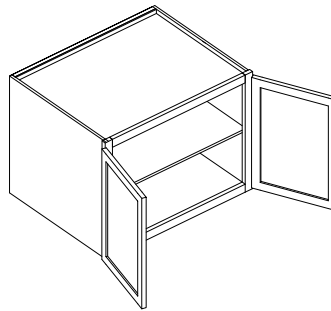

Item Code	Outer Dimensions		
	W	H	D
W361824	36	18	24
W362424	36	24	24

15" Wall Stacking Cabinets with Glass

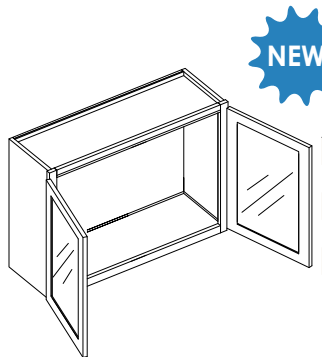

Item Code	Outer Dimensions		
	W	H	D
WS2415-2	24	15	12
WS2715-2	27	15	12
WS3015-2	30	15	12
WS3315-2	33	15	12
WS3615-2	36	15	12

*Door comes pre-routed with glass insert and finished interior

12" - 21" High Double Door Wall

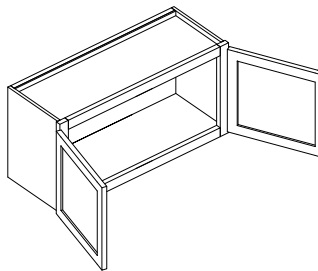

Item Code	Outer Dimensions		
	W	H	D
W3012	30	12	12
W3612	36	12	12
W3015	30	15	12
W3315	33	15	12
W3615	36	15	12
W3018	30	18	12
W3318	33	18	12
W3618	36	18	12
W3021	30	21	12

15" Corner Wall Stacking Cabinet with Glass

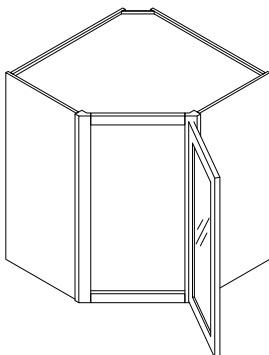

Item Code	Outer Dimensions		
	W	H	D
CWS2415	24	15	12
CWS2715	27	15	15

*Door comes pre-routed with glass insert and finished interior

30" - 36" High Double Door with Center Stile

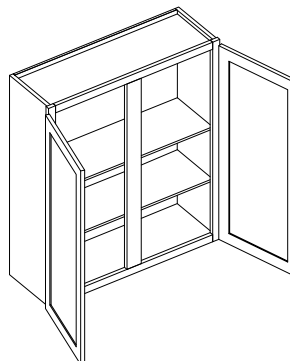

Item Code	Outer Dimensions		
	W	H	D
W4230	42	30	12
W4236	42	36	12

30" - 36" High Single Door Wall

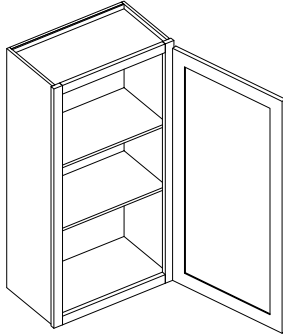

Item Code	Outer Dimensions		
	W	H	D
W930	9	30	12
W1230	12	30	12
W1530	15	30	12
W1830	18	30	12
W2130	21	30	12
W936	9	36	12
W1236	12	36	12
W1536	15	36	12
W1836	18	36	12
W2136	21	36	12

30" - 36" High Corner Wall

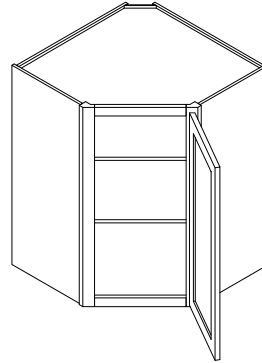

Item Code	Outer Dimensions		
	W	H	D
CW2430	24	30	12
CW2436	24	36	12
CW2736	27	36	15

30" - 36" High Double Door Wall

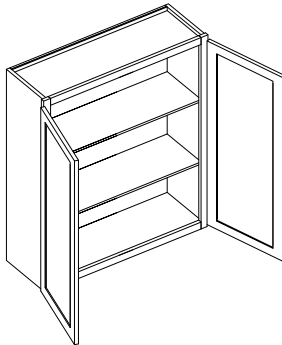

Item Code	Outer Dimensions		
	W	H	D
W2430-2	24	30	12
W2730	27	30	12
W3030	30	30	12
W3330	33	30	12
W3630	36	30	12
W3930	39	30	12
W2436-2	24	36	12
W2736	27	36	12
W3036	30	36	12
W3336	33	36	12
W3636	36	36	12
W3936	39	36	12

42" High Single Door Wall

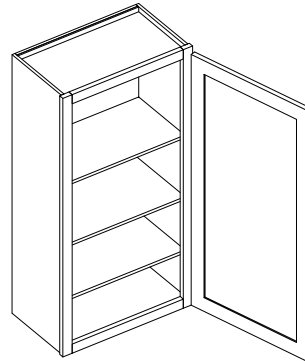

Item Code	Outer Dimensions		
	W	H	D
W942	9	42	12
W1242	12	42	12
W1542	15	42	12
W1842	18	42	12
W2142	21	42	12

30" - 36" High Blind Wall

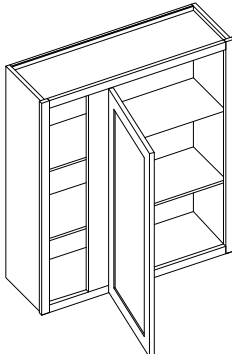

Item Code	Outer Dimensions		
	W	H	D
BW2430	24	30	12
BW3030	30	30	12
BW3630	36	30	12
BW2436	24	36	12
BW3036	30	36	12
BW3636	36	36	12

42" High Double Door Wall

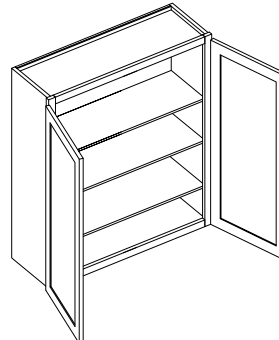

Item Code	Outer Dimensions		
	W	H	D
W2442-2	24	42	12
W2742	27	42	12
W3042	30	42	12
W3342	33	42	12
W3642	36	42	12
W3942	39	42	12

Product Specs

Wall Cabinets

42" High Double Door Wall with Center Stile

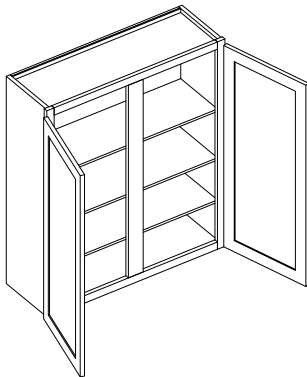

Item Code	Outer Dimensions		
	W	H	D
W4242	42	42	12

Wall Tower with 3 Drawers

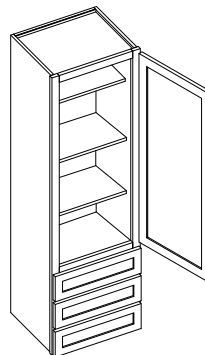

Item Code	Outer Dimensions		
	W	H	D
DWR1548	15	48	15
DWR1554	15	54	15
DWR1560	15	60	15

*Works great with a vanity

42" High Corner Wall

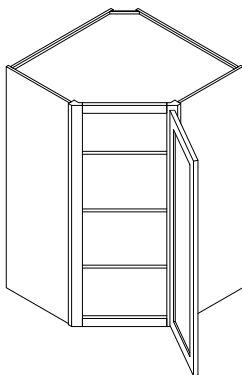

Item Code	Outer Dimensions		
	W	H	D
CW2442	24	42	12
CW2742	27	42	15

Installing a Blind Wall Cabinet

Proper installation ensures that the doors will open and show correct reveal

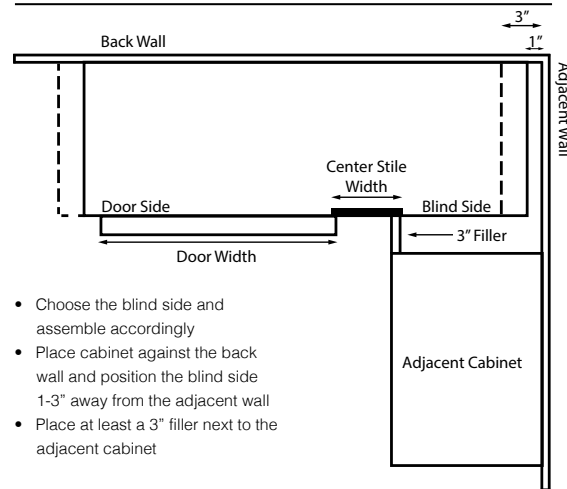

- Choose the blind side and assemble accordingly
- Place cabinet against the back wall and position the blind side 1-3" away from the adjacent wall
- Place at least a 3" filler next to the adjacent cabinet

Wine Rack

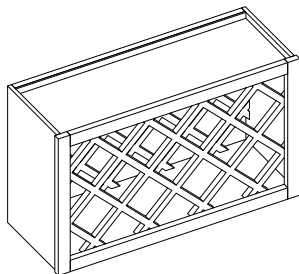

Item Code	Outer Dimensions		
	W	H	D
WR3018	30	18	12

42" High Blind Wall

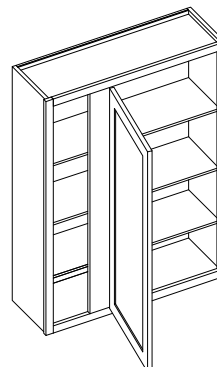

Item Code	Outer Dimensions		
	W	H	D
BW2442	24	42	12
BW3042	30	42	12
BW3642	36	42	12

Base Cabinet Coding

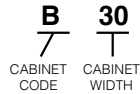

Notes:

- Standard base cabinets are 24" deep and 34.5" high.
- Add door thickness for total cabinet depth.
- Please refer to the Products by Cabinet Line chart to determine which products are carried for each cabinet line.

Double Door Standard Base with Center Stile

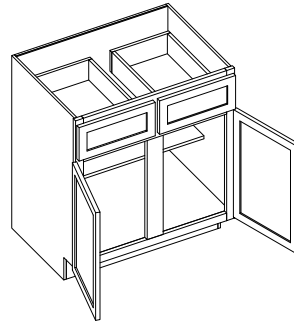

Item Code	Outer Dimensions		
	W	H	D
B42	42	34.5	24

Single Door Full Height Base

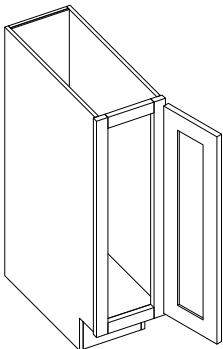

Item Code	Outer Dimensions		
	W	H	D
B09	9	34.5	24

Drawer Base

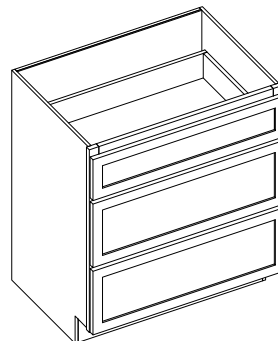

Item Code	Outer Dimensions		
	W	H	D
DB12-3	12	34.5	24
DB15-3	15	34.5	24
DB18-3	18	34.5	24
DB21-3	21	34.5	24
DB24-3	24	34.5	24
DB30-3	30	34.5	24
DB36-3	36	34.5	24

Single Door Standard Base

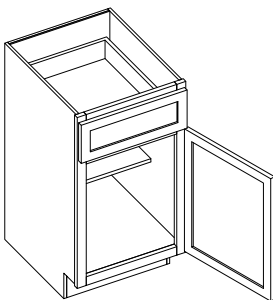

Item Code	Outer Dimensions		
	W	H	D
B12	12	34.5	24
B15	15	34.5	24
B18	18	34.5	24
B21	21	34.5	24

Drawer Base - 2 Drawer

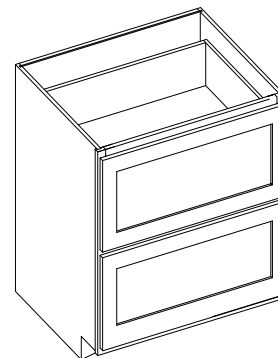

Item Code	Outer Dimensions		
	W	H	D
DB30-2	30	34.5	24

Double Door Standard Base

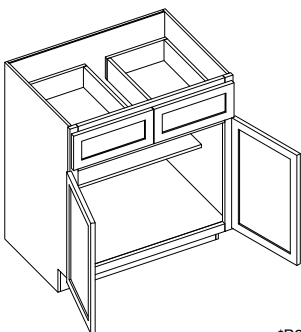

Item Code	Outer Dimensions		
	W	H	D
B24-2*	24	34.5	24
B27	27	34.5	24
B30	30	34.5	24
B33	33	34.5	24
B36	36	34.5	24
B39	39	34.5	24

*B24-2 has one drawer and two doors

Desk Drawer Base

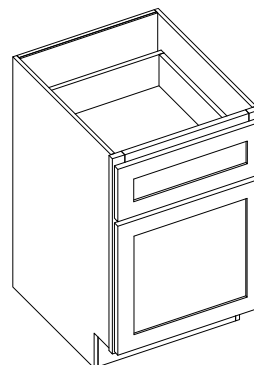

Item Code	Outer Dimensions		
	W	H	D
DDB18	18	29.5	24

Product Specs

Base Cabinets

Sink Base

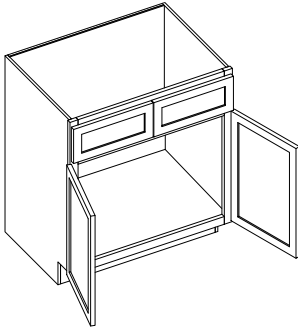

Item Code	Outer Dimensions		
	W	H	D
SB30	30	34.5	24
SB33	33	34.5	24
SB36	36	34.5	24

Sink Base with Center Stile

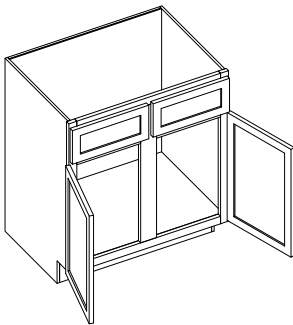

Item Code	Outer Dimensions		
	W	H	D
SB42	42	34.5	24
SB48	48	34.5	24

Corner Sink Front

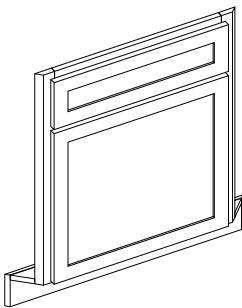

Item Code	Outer Dimensions		
	W	H	D
CSF42	27	34.5	2
CSF-FLOOR*	48	0.5	48

*Sink floor not pictured and sold separately
*Back of face frame measures 27" wide

36" Farm Sink Base

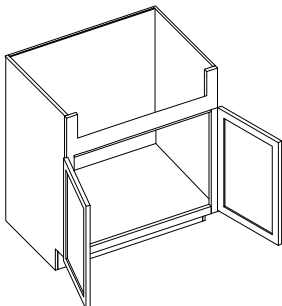

Item Code	Outer Dimensions		
	W	H	D
FSB36	36	34.5	24

*Height of sink inset is 13.5"

Installing a Blind Base Cabinet

Proper installation ensures that the drawer will clear hardware, and doors will open, and show correct reveal

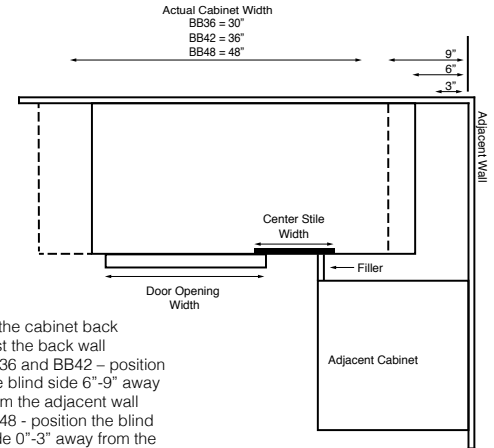

- Place the cabinet back against the back wall
 - BB36 and BB42 - position the blind side 6"-9" away from the adjacent wall
 - BB48 - position the blind side 0"-3" away from the adjacent wall
- Place at least a 3" filler next to adjacent cabinet

36" Blind Base

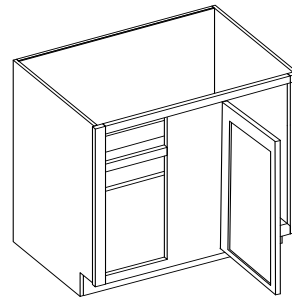

Item Code	Outer Dimensions		
	W	H	D
BB36	30	34.5	24

42" - 48" Blind Base

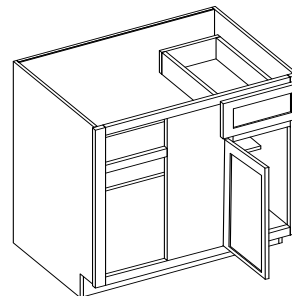

Item Code	Outer Dimensions		
	W	H	D
BB42	42	34.5	24
BB48	48	34.5	24

Cooking Center

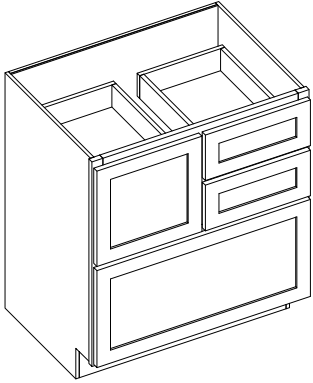

Item Code	Outer Dimensions		
	W	H	D
CC30	30	34.5	24

Microwave Base Cabinet

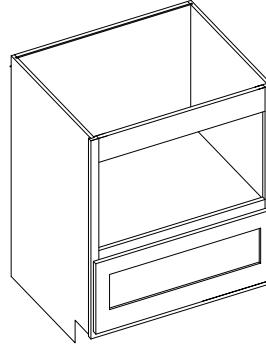

Item Code	Outer Dimensions		
	W	H	D
MBC30	30	34.5	24

*Finished interior

Trash Can Base (Full Height)

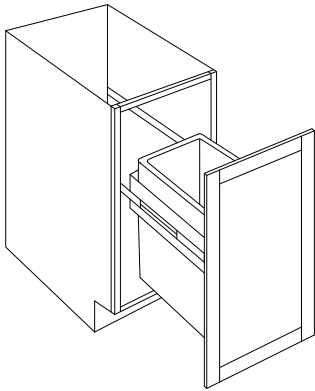

Item Code	Outer Dimensions		
	W	H	D
TRB-1*	18	34.5	24
TRB-2**	18	34.5	24

*Includes one 50 QT can
**Includes two 35 QT cans

● Undermount trash can insert (TCCK) for standard B18 located on pg 19

Easy Reach

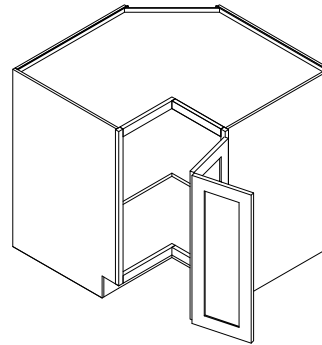

Item Code	Outer Dimensions		
	W	H	D
ER33	33	34.5	24
ER36	36	34.5	24

*Lazy Susan Kit (LSK) sold separately



Product Specs

Tall Cabinets

Tall Cabinet Coding

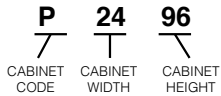

Notes:

- Standard tall cabinets are 24" deep.
- Add door thickness for total cabinet depth.
- Please refer to the Products by Cabinet Line chart to determine which products are carried for each cabinet line.

Oven Cabinet Overlay Panel

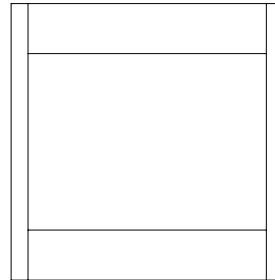

Item Code	Outer Dimensions		
	W	H	D
OP3353	32.5	53	0.75

Single Door Pantry

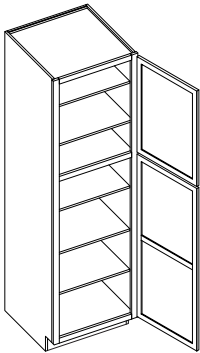

Item Code	Outer Dimensions		
	W	H	D
P1884*	18	84	24
P1890*	18	90	24
P1896**	18	96	24

*Includes four shelves
**Includes five shelves

Oven Cabinet (Includes One Drawer)

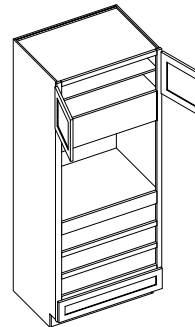

Item Code	Outer Dimensions		
	W	H	D
OC3390	33	90	24
OC3396	33	96	24

*Includes one drawer

24" and 30" Double Door Pantry

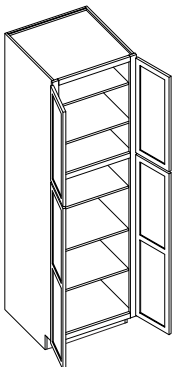

Item Code	Outer Dimensions		
	W	H	D
P2484*	24	84	24
P2490*	24	90	24
P2496**	24	96	24
P3090*	30	90	24
P3096**	30	96	24

*Includes four shelves
**Includes five shelves

Oven Cabinet Drawer

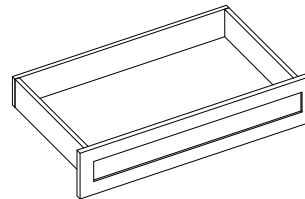

Item Code	Outer Dimensions		
	W	H	D
OCD337	32.5	6.75	24

Vanity Cabinet Coding

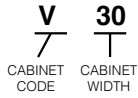

Notes:

- Standard vanity cabinets are 21" deep.
- Add door thickness for total cabinet depth.
- Please refer to the Products by Cabinet Line chart to determine which products are carried for each cabinet line.

Double Vanity Sink Base

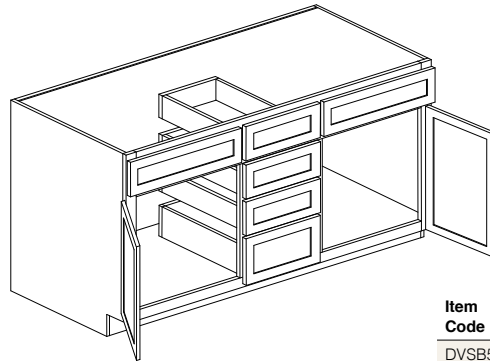

Item Code	Outer Dimensions		
	W	H	D
DVSB54	54	34.5	21
DVSB60	60	34.5	21

*Available in Taylor only

Vanity Combo Cabinet 30"

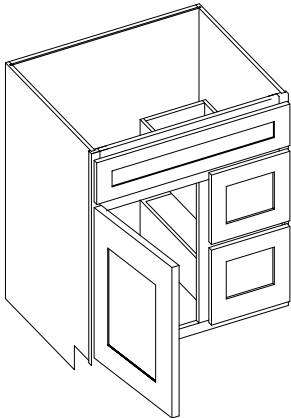

Item Code	Outer Dimensions		
	W	H	D
VSBDR30	30	34.5	21
VSBDL30	30	34.5	21

*Pictured is the VSBDR30

Extended Vanity Sink Base

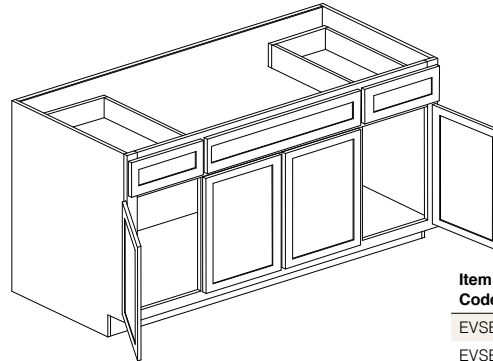

Item Code	Outer Dimensions		
	W	H	D
EVSB54	54	34.5	21
EVSB60	60	34.5	21

*Available in Taylor only

Vanity Combo Cabinet 36"

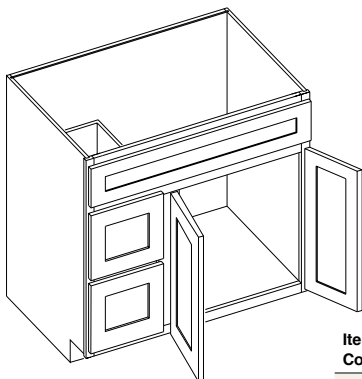

Item Code	Outer Dimensions		
	W	H	D
VSBDR36	36	34.5	21
VSBDL36	36	34.5	21

*Pictured is the VSBDL36

36" Open Shelf Vanity Sink Base

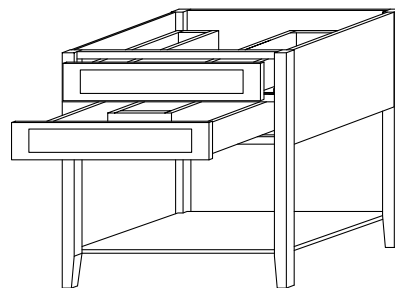

Item Code	Outer Dimensions		
	W	H	D
VSBOS36	36	34.5	21

*Includes adjustable feet

*Height does not include adjustable foot

Product Specs

Vanity Cabinets

Double Door Vanity

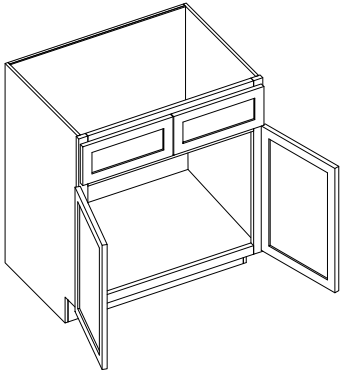

Item Code	Outer Dimensions		
	W	H	D
V24-2	24	34.5	21
V27	27	34.5	21
V30	30	34.5	21
V33	33	34.5	21
V36	36	34.5	21

Vanity Drawer Base

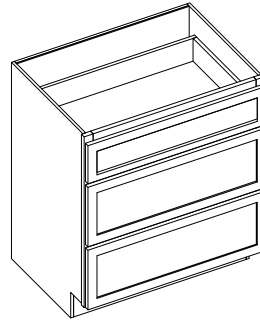

Item Code	Outer Dimensions		
	W	H	D
VDB12	12	34.5	21
VDB15	15	34.5	21
VDB18	18	34.5	21
VDB21	21	34.5	21
VDB24	24	34.5	21

Single Door Vanity Base

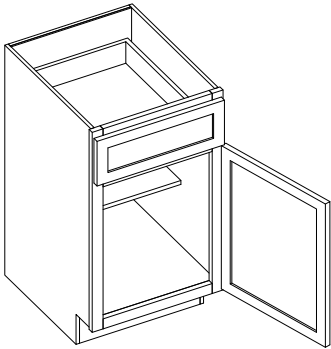

Item Code	Outer Dimensions		
	W	H	D
VB12	12	34.5	21
VB15	15	34.5	21
VB18	18	34.5	21

24" Vanity Drawer

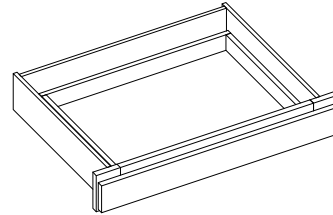

Item Code	Outer Dimensions		
	W	H	D
KD24	23.5	4.75	21

*Drawer box height is 2"

Vanity Sink Base

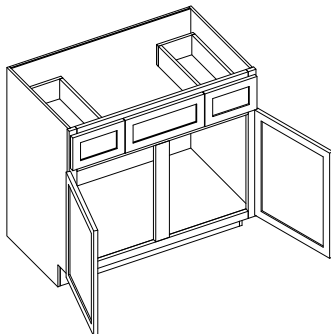

Item Code	Outer Dimensions		
	W	H	D
VSB36	36	34.5	21
VSB42	42	34.5	21
VSB48	48	34.5	21

36" Vanity Drawer

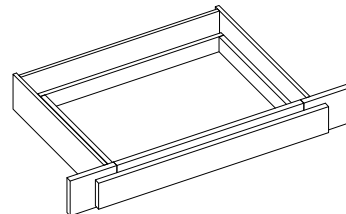

Item Code	Outer Dimensions		
	W	H	D
KD36	29.5	4.75	21

*Adjustable Sides
*Drawer box height is 2"
*Trimable to 30"

Product Specs

Moldings & Trim

Toe Kick - TKS8

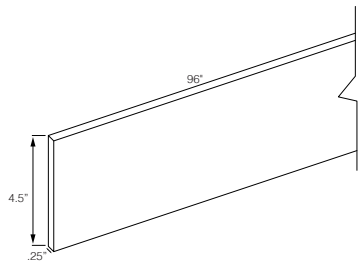

Large Crown Molding - BCM8

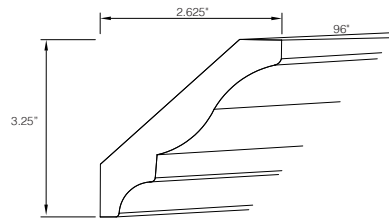

Outside Corner Molding - OCM8

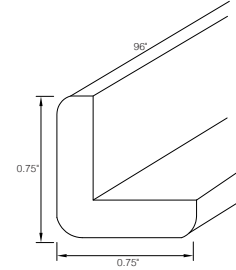

Scribe - SCRIBE

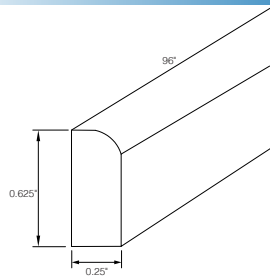

Royal Crown Molding - RCM8

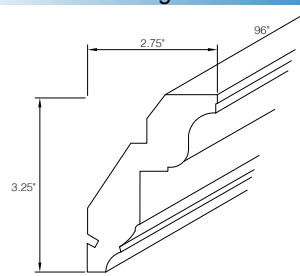

Traditional Light Rail Molding - LRM8

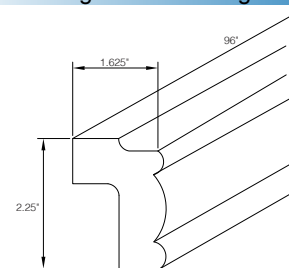

Shoe - SHOE

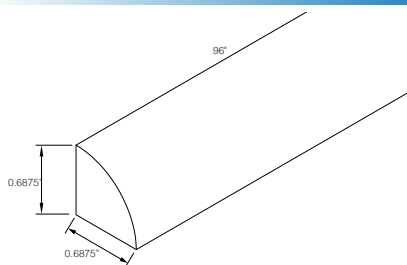

Shaker Crown Molding - SCM8

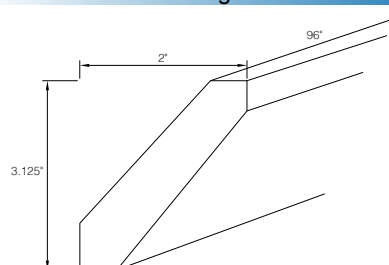

Bottom Edge Molding - BEM8

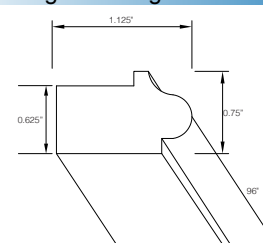

Furniture Base Molding - FBM8

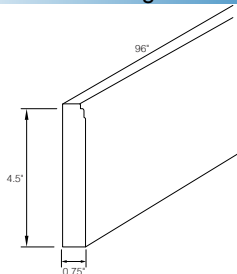

Cove Crown Molding - COM8

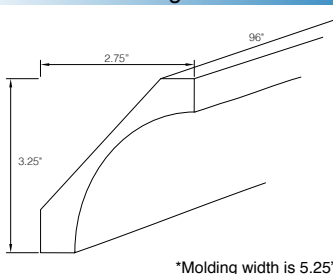

*Molding width is 5.25"

Traditional Crown Molding - CM8

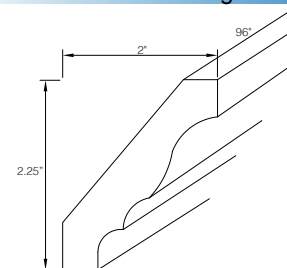

Batton Molding - BAM8

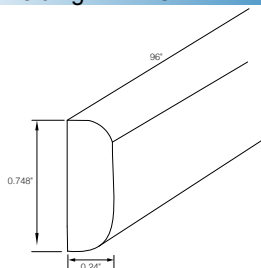

Product Specs

Fillers & Panels

Back Panel - Long Grain Plywood

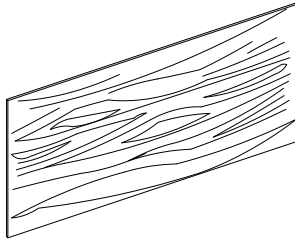

Item Code	Outer Dimensions		
	W	H	D
BPLG4896	48	96	0.25

*Finished one side, raw back

1/2" Thick Finished Plywood Panel

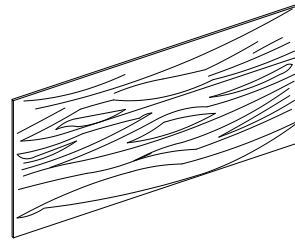

Item Code	Outer Dimensions		
	W	H	D
PSP4896	96	48	0.5

*Finished one side, natural UV back

Back Panel - Short Grain Plywood

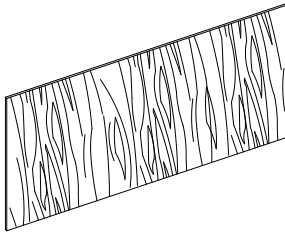

Item Code	Outer Dimensions		
	W	H	D
BPSG9648	96	48	0.25

*Finished one side, raw back

Bead Board

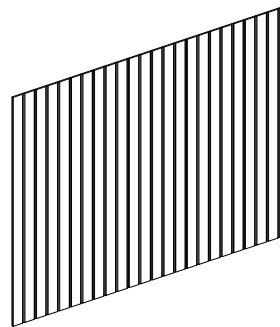

Item Code	Outer Dimensions		
	W	H	D
BBP4842	48	42	0.25

*Finished one side, raw back

Filler



Item Code	Outer Dimensions		
	W	H	D
F396	3	96	0.75
F696	6	96	0.75

*All four edges finished

Overlay Filler



Item Code	Outer Dimensions		
	W	H	D
OLF330	2.5	28.75	0.75
OLF336	2.5	34.75	0.75
OLF342	2.5	40.75	0.75
OLF384	2.5	82.75	0.75
OLF390	2.5	88.75	0.75
OLF396	2.5	94.75	0.75
OLF630**	5.5	28.75	0.75

*All four edges finished
**Available only in Premier

Fluted Filler



Item Code	Outer Dimensions		
	W	H	D
FF396	3	96	0.75

*All four edges finished

Dishwasher End Panel



Item Code	Outer Dimensions		
	W	H	D
DWR3	3	34.5	24

*0.5" panel thickness
*Finished one side, natural UV back
*Value series finished on both sides

Tall End Panel



Item Code	Outer Dimensions		
	W	H	D
TEP3096	1.5	96	30

*0.5" panel thickness
*Finished one side, natural UV back
*Value Series finished on both sides

Bookcase End

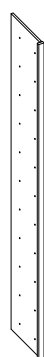

Item Code	Outer Dimensions		
	W	H	D
BCE1596	1.5	96	15

*Requires shelf
*Shelf clips available
*0.5" panel thickness

Shelf

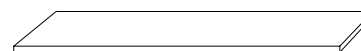

Item Code	Outer Dimensions		
	W	H	D
**SHELF1296	96	0.625	12
***SHELF2496	96	0.625	24

*All sides finished
*3/4" plywood construction
**Available in natural or painted
***Available in natural only

Product Specs

Decorative Accessories

Corbel - Basic Medium

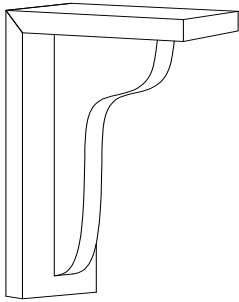

Item Code	Outer Dimensions		
	W	H	D
CORSM	3	10.5	7.5

Corbel - Transitional

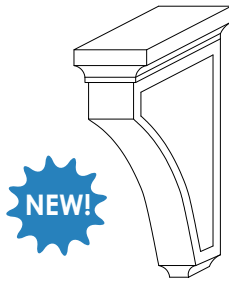

Item Code	Outer Dimensions		
	W	H	D
CORT	3.5	10.5	7

Furniture Valance

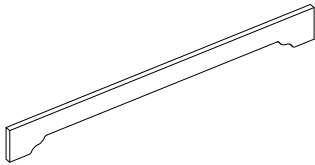

Item Code	Outer Dimensions		
	W	H	D
VFURN37	37	4.5	0.75
VFURN43	43	4.5	0.75

Raised Panel Valance

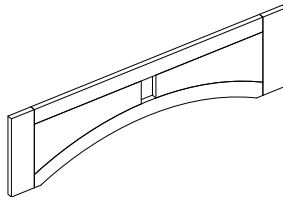

Item Code	Outer Dimensions		
	W	H	D
VRP42	42	12	0.75
VRP48	48	12	0.75

Turned Post



Item Code	Outer Dimensions		
	W	H	D
TPOSTP3	3	35.5	3
TPOSTP5	5	35.5	5

Bunfoot

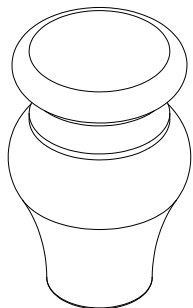

Item Code	Outer Dimensions		
	W	H	D
TBUNFOOT	3	4.5	3

Bunfoot - Transitional

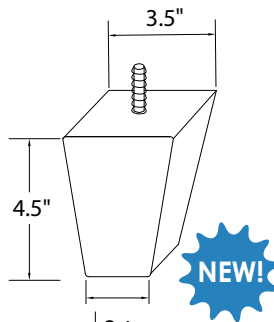

Item Code	Outer Dimensions		
	H	Top	Bottom
TBUNFOOT2	4.5	3.5	2

Decorative Base/Wall Panels

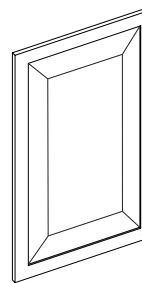

Item Code	Outer Dimensions		
	W	H	D
DWP1215	11.5	13.75	0.75
DWP2415	22.5	13.75	0.75
DWP1230	11.5	28.75	0.75
DWP2430	23.5	28.75	0.75
DWP1236	11.5	34.75	0.75
DWP1242	11.5	40.75	0.75

Product Specs

Attachments & Inserts

Soft Close Roll Out Tray

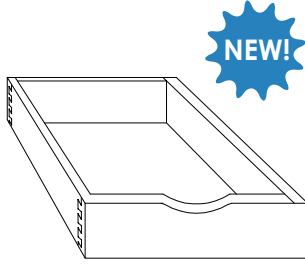

Item Code	Outer Dimensions		
	W	H	D
ROT15-SC	11.4375	4	21
ROT18-SC	14.375	4	21
ROT21-SC	17.4375	4	21
ROT24-SC	20.25	4	21
ROT27-SC	23.125	4	21
ROT30-SC	26.125	4	21
ROT36-SC	32.125	4	21

*Includes two trays & four tracks

Roll Out Tray Usage Guide

Item Code	Designed to Fit
ROT15-SC	B15, VB15
ROT18-SC	B18, P1884, P1890, P1896, VB18
ROT21-SC	B21
ROT24-SC	B24, P2484, P2490, P2496, V24-2
ROT27-SC	B27, V27
ROT30-SC	B30, SB30, P3084, P3090, P3096, V30
ROT36-SC	B36, SB36, V36

Lazy Susan Kit

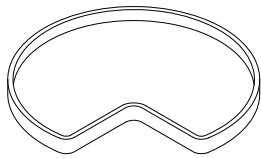

Item Code	Outer Dimensions		
	W	H	D
LSK	29	1.5	29

*Includes two trays for shelf mounting
*Birch plywood construction

Spice Rack Door Attachment

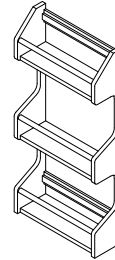

Item Code	Outer Dimensions		
	W	H	D
SRD12	11.5	24	4
SRD15	14.5	24	4

Trash Can Insert for B18

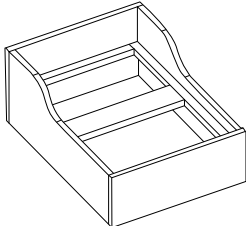

Item Code	Outer Dimensions		
	W	H	D
TCKK*	14.625	4.125	19.75

*Includes two 35 QT cans

- Dovetail, solid wood construction
- Undermount, full extension, soft close slides

Spice Rack Tray Insert

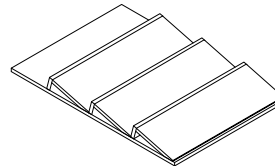

Item Code	Outer Dimensions		
	W	H	D
STI14	13.375	1.094	19.75
STI20	19.75	1.094	19.75

Spice Rack Insert

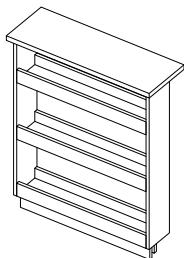

Item Code	Outer Dimensions		
	W	H	D
SRI9	5.75	24	20.5

*Fits in the B09 and W930

Stemware Rack

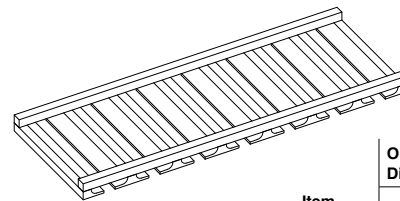

Item Code	Outer Dimensions		
	W	H	D
SWR3012	28.5	1.5	10.5

Cutlery Drawer Insert

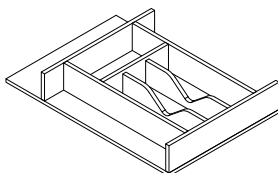

Item Code	Outer Dimensions		
	W	H	D
CDI14	13.375	1.75	19.75
CDI20	19.75	1.75	19.75

Shelf



*All sides finished
**3/4" plywood construction
**Available in natural or painted
***Available in natural only

Item Code	Outer Dimensions		
	W	H	D
**SHELF1296	96	0.625	12
***SHELF2496	96	0.625	24

