

Micro Mobile Homes LLC

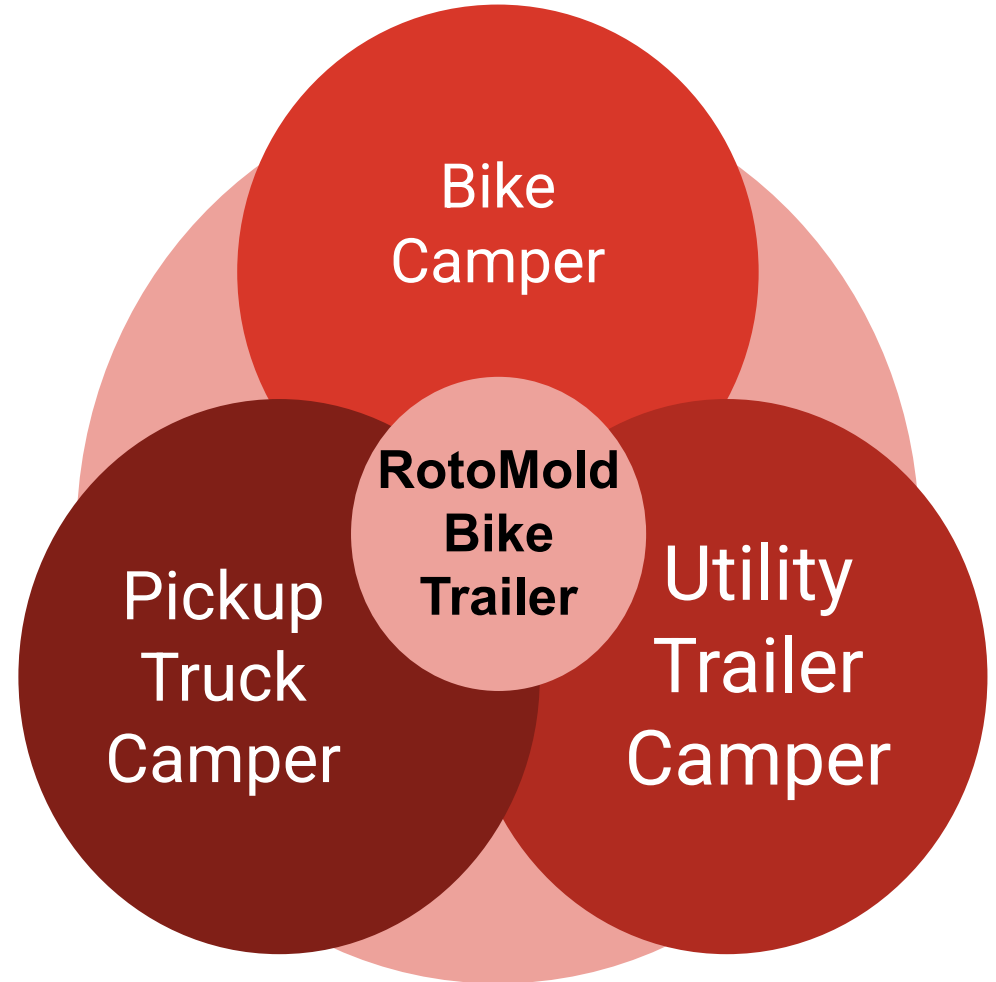

702-272-9650



MMH LLC Project Team

Board of Directors:

- Rickey and Joe Johnson, Co-Founders
- Isaac Johnson-Smiles, Data Scientist
- Mike Giroux, Factory Engineer/Solar
- James Sharpless, Marketing/Sales

UNLV/SBDC: Jeny Zendejas-Chavez

Cal Poly Tech University (R&D):

- Roha Ali, International
- Luke Douglas, Washington State
- Joshua Le, LA
- Yuka Iwashita, SF
- Rick Lasko (Advisor)



Rickey Johnson
Co-Founder/Registered Agent
Micro Mobile Homes LLC

RotoMold Chassis

- Durable, Indestructible Materials.
- Non Flammable.
- Light weight.
- Mass Production.

“RotoMold Plastic can last 10K years!”



Target Market: E-Bikers

Models: Specifications	Entrepreneur 1.0 Bike Utility Trailer	Weekender 2.0 Tent Camper
Tent Size	N/A	1 Person 79"Lx32"Wx66"T
Square feet when open	17 Sq. Ft	17 Sq. Ft.
Style	Bike Trailer	Traditional or Pop-up Tent
Set-up Time	N/A	Pop-up: 15 to 20 seconds
Insulation	N/A	1 or (2 w Pop-up) Layers
List Price	\$2,000	\$2,000
Total Weight Empty	46 lbs. W/O wheels&hitch	56 lbs. W/O wheels&hitch
Chassis Size	83"Lx34"Wx20"T	83"Lx34"Wx20"T
Dry Storage	108 gal.	108 gal.
3 in 1 Conversion	N/A	Good
Quick Release Wheels/Towbar	Yes	Yes

Target: Camping Enthusists

Camper Models: Specifications	Voyager 3.0: 3 in 1 Camper (Cal Poly Tech)	Expedition 4.0 Hardtop Camper
Tent Size Square feet when open Style Set-up Time Insulation List Price	3 Person 80"Lx58"Wx40"T 32 Sq. Ft. Deluxe, Luxury Tent 3-5 Minutes 2 Layers, one is removable \$4,000	1 Person 83"Lx34"Wx36"T 17 Sq. Ft. Hardtop Camper 5 to 10 Seconds R11 in the roof \$5,000
Total Weight Empty Chassis Size Dry Storage Simple 3 in 1 Conversion Quick Release Wheels/Towbar	162 lbs. W/O wheels&hitch 83"Lx34"Wx20"T 108 gal. Best Yes	92 lbs. W/O wheels&hitch 83"Lx34"Wx20"T 108 gal. Better Yes

Entrepreneur 1.0 Trailer

- Easy to handle.
- Quick release wheels/towbar.
- Functions as a utility trailer for hauling & delivery.
- Can build your own business!

“Owner can charge their bike while riding!”



Weekender 2.0 Tent Camper

- Rotational Molding:
 - +Indestructible material
 - +Non-flammable
 - +Mass production!
- Single person tents:
 - + Traditional (tent polls)
 - + Pop-up (no tent polls)
- Lowest cost, lowest weight camping solution.

MicroMobileHomes.com

E-bike Camping, Living, and Adventures!

KEY FEATURES:

For inquiries, email us at: info@MicroMobilHomes.com

Comfortable Sleeping Space:
A cozy retreat for a good night's sleep.

Ample Storage:
Comes with Four quick access Tough Totes.

Spacious Heavy-Duty Tent:
78.8" L x 31.5" W x 65" T, with 12 design options.

Eco-Friendly Power:
Integrated solar panel and power station with various options.

Heating Solutions:
Electric heating blanket options available.

Cool Comfort:
Fans with lights and misting features.

Tech Ready:
Charge phones, computers, and other gadgets effortlessly.

Mobile Bicycle Camper (Retail)
Quick Release Wheels and Axle:
Detach wheels for camper stability.

Social Impact: 10% of every sale goes directly to combat homelessness!

Starter Mobile Home (Homeless)
Secure Design: Fixed to the ground with a locking cover for added safety.

MicroMobileHomes.com
info@MicroMobilHomes.com

the WORLD'S FIRST TWO-LEVEL TWO-MARKET TRAILER HOME



Weekender 2.0 Bike Camper



Voyager 3.0 Luxury Tent Camper

- Quick and easy set-up, no ladder.
 - Access to remote campsites.
 - Camper can use solar power.
 - Developed at Cal Poly Tech.
- “Convenient bed height @ 18”, yeah!



Voyager 3.0: 3in1 Tent Camper

- Two Adults and One child.
 - Works behind a bike, in a pickup, or in a utility trailer.
- “Deluxe, Luxury Tent Camper with Flexible Installations!”

Bicycle Camper



Pickup Truck Camper



Utility-Trailer Camper



Voyager 3.0 Truck Camper

- Quick Install and Set-up, No Poles.
- Low cost truck camper alternative.

“Campers can use truck lights, battery, and extra storage!”



Voyager 3.0 Trailer Camper

- Quick Install and Set-up, No Poles.
- Low cost RV alternative.

“Campers can leave their trailer/Voyager 3.0 at the campsite while riding to town!”



Voyager 3.0 Interior

- Skylights and rope light.
 - Plenty of ventilation and pockets.
 - 2.5" Memory Foam Mattress
- “Sleep in a luxury, not on the ground!”



Ventilation and pockets!

Skylights and Rope Light!



Expedition 4.0 Hardtop Camper

- Quickest Setup.
 - Light Weight, 92 lbs.
 - Unique three levels:
 1. Kitchen Counter
 2. Bedroom/Sitting
 3. Secure Storage
 - R11 Roof Insulation
- “Safe & secure protection against bad weather, bugs, snakes, etc.”



Expedition 4.0 Hardtop Camper

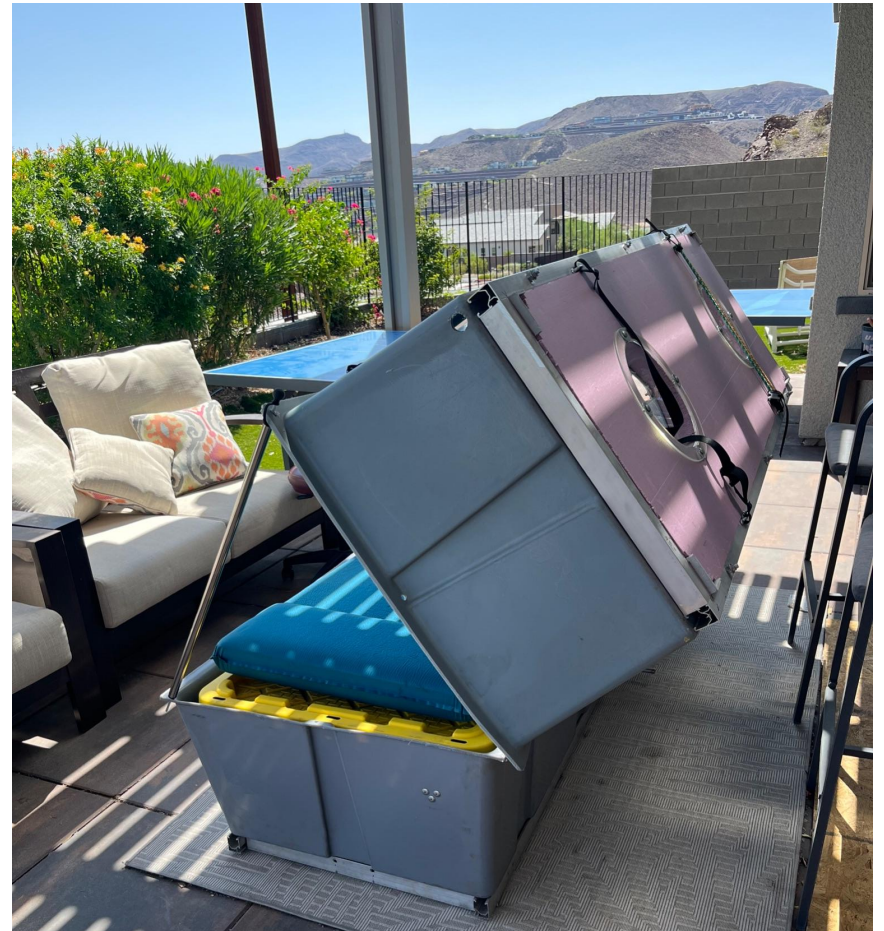

All Models

- Rectangular design frees up space for bikes, boats, beach toys, gear, food, almost anything!
 - Secure, hidden, storage.
- “Can be stored in the backyard!”



Bikes fit alongside campers!

Hidden/lockable Storage!



Competing Retail Products

Camper Model	Competition	Competition Pricing
Bike Trailer* Weekender: \$2,000, Includes containers	Surly Bill Trailer BikesAtWork.com CarlaCargo.de	\$815 plus (frame only) \$1,700 (frame & hitch) \$4,000 (deluxe frame)
Voyager Luxury Bike Camper*: \$4,000	Evolving Market, DIY on YouTube	TBD
Voyager 3.0 in a Pickup Truck*	Many truck campers available.	\$10K - \$40K CAMP365: \$35K
Voyager in a Trailer*	Many RVs available.	\$15K - 70K or more
Expedition 4.0	Many RVs available.	\$25K - \$100K or more

*Note: Bike, Truck and Utility Trailer not included.

2024 Supreme Court Ruling & the Dismantling of Encampments

- HUD CoC (Brick and Mortar): “Housing is a Human Right”
- Shelters (No privacy, No ownership, & Violence).
- Sanctioned Encampments: Provide everyone their own bed, their own storage, and access to bathrooms/other services.
- Wondering the streets/sleeping on the ground.

Bottom Line: “We need new solutions for interim housing”

Success Criteria

- Affordability
- Scalability
- Adaptability
- Cooperation of:
 - Non-profits
 - Municipalities
 - Universities
 - Private Investors

MMH R4: 2025/26, Double tub with solar electric/cooling. Clark County, Non-profits, and UNLV Social Services / Engineering



**Justin Jones -
District F**

[County Commissioner](#)



**James B. Gibson -
District G**

County Commissioners



**Tick Segerblom -
District E**

Chairman



**In the Spotlight: Dr.
Catrina Grigsby-Thedford**

Christopher Stream, Ph.D.

Interim Director



chris.stream@unlv.edu

Rama Venkat, Ph.D.

Dean



rama.venkat@unlv.edu

Mohamed Trabia, Ph.D.

*Associate Dean for Research,
Graduate Studies & Computing*



Mail Code: 4005
Phone: [702-895-0957](tel:702-895-0957)
Fax: [702-895-4059](tel:702-895-4059)
Email:

MORE

Homelessness Solutions

Homelessness	Solution	Product Notes
Has Nothing	Push/Pull Cart	Standard
Has a bicycle/ebike	Bicycle Camper	Standard
Has a Car with hitch	Trailer Option	Standard
Has a Pick-up Truck	Truck Option	Standard
Has a roof rack	RoofNest Products	Roofnest Products

Micro Mobile Homes Parks (Example)

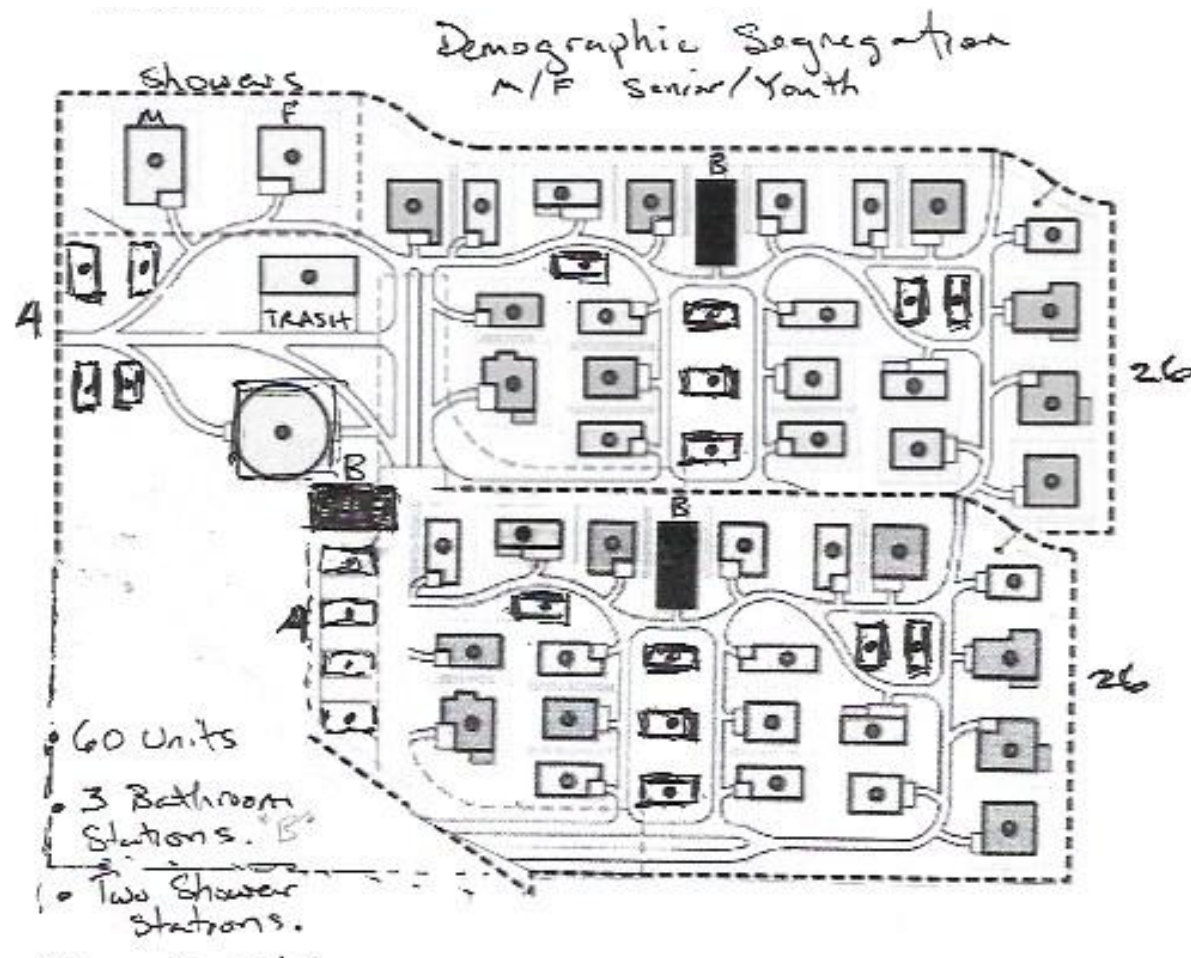

Leveling Up

Level 1: Sanctions encampments/Micro Mobile Home Parks: e.g., Camp Hope, New Mexico / Raphael, Ca.

Level 2: Cooperative arrangement using solar credits and electricity to cover cost.

Level 3: New or Expanded Facilities: Partnerships w Government incentives for Good Sam and KOA.