



AirFit™ N20



Easily fits them and everyone in between

Everyone's face is different. But with our new AirFit™ 20 series, fitting a broad range of patients has never been easier. That's because each mask has been specially-designed to fit all patients regardless of facial profile, taking the constant guesswork out of mask selection. And with a recent international study showing the AirFit N20 fit 99% of patients,¹ you can trust that it will perform for your diverse group of patients.



[ResMed.com/AirFitN20](https://www.ResMed.com/AirFitN20)



AirFit N20 highlights

Plush headgear is specifically designed for extra softness and stability.

InfinitySeal™ cushion features specially-designed loops and varying thickness levels designed to prevent blowout.

Soft and flexible frame sits underneath the eyes and adapts to different facial types, while its integrated padding provides added softness.

Quick-release elbow makes it simple to disconnect from the mask tubing without removing the mask.

Magnetic clips guide the headgear to the frame quickly and easily.

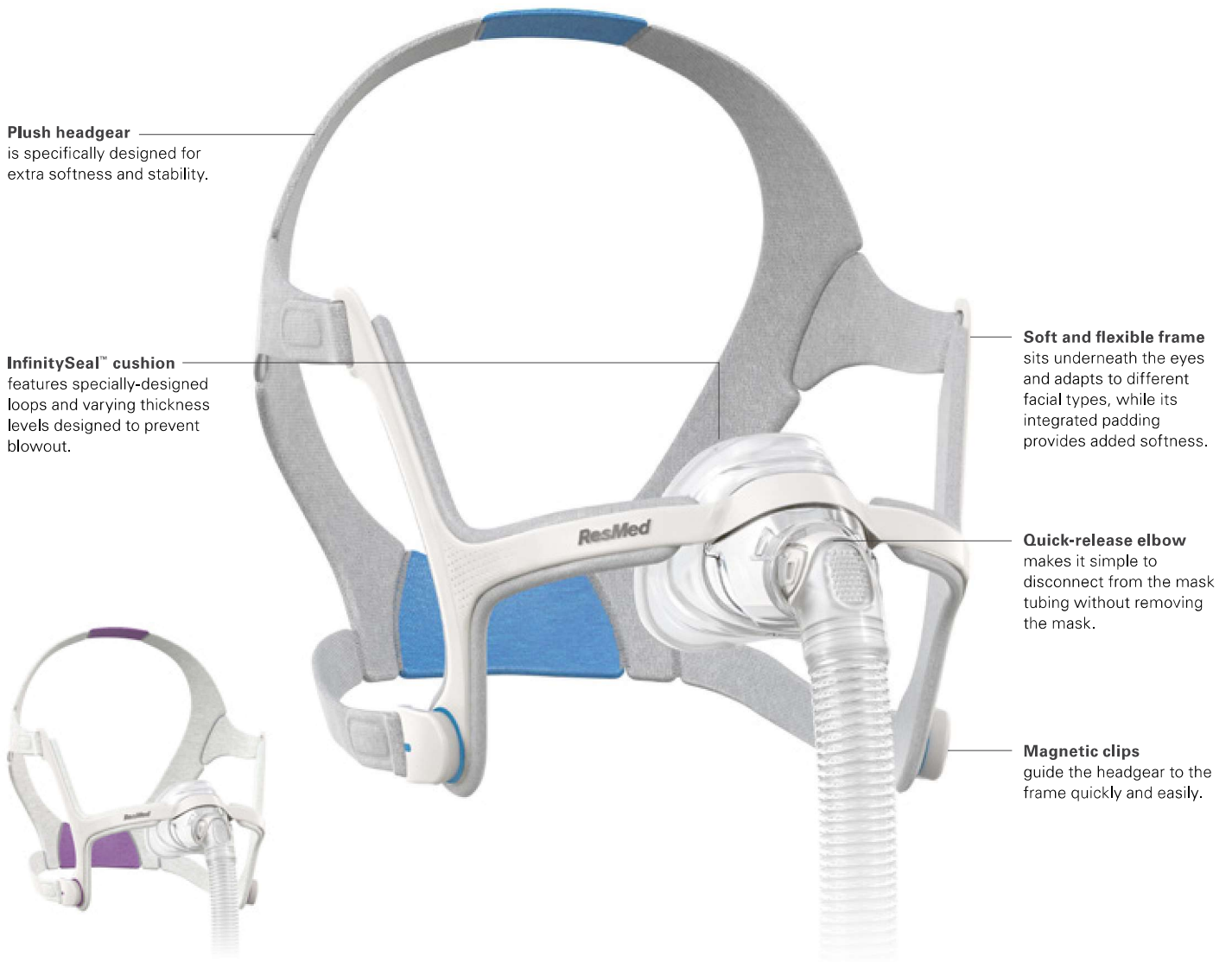

AirFit N20 for Her
Designed specifically for women.

The AirFit N20 fit a remarkable 99% of patients in a recent international fitting study.¹

AirFit N20 components

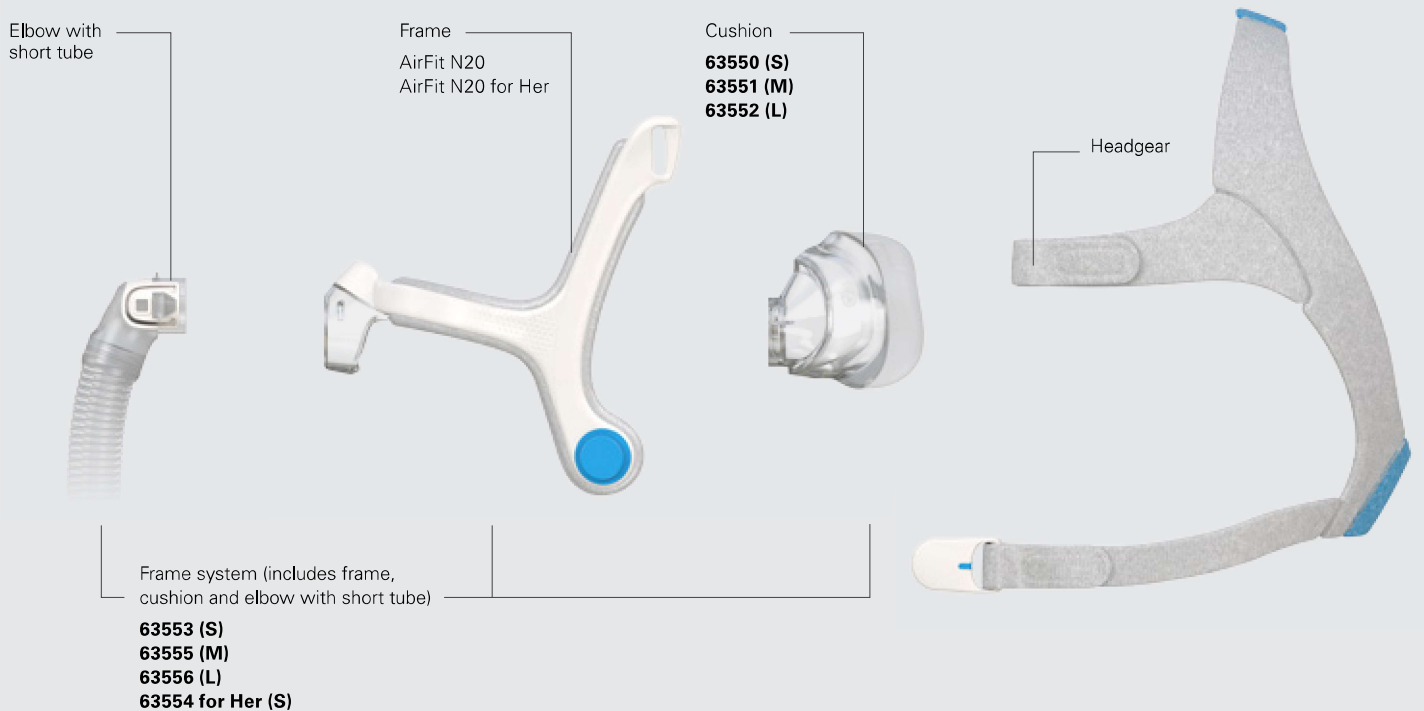

Product codes

Complete mask systems (Includes frame system + headgear)

AirFit N20: Small	63503
AirFit N20: Medium	63501
AirFit N20: Large	63502
AirFit N20 for Her	63500

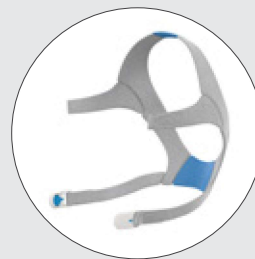

AirFit N20 headgear with headgear clips
63560 (S)
63561 (Std)
63562 (L)



AirFit N20 for Her headgear with headgear clips
63558 (S)



Fitting guide for AirFit N20



- Start by ensuring the magnets on the lower straps are unclipped.
- If they are clipped, detach them by twisting and pulling them away from the frame.



- Pull the headgear over the head, making sure the logo is facing outward.



- Position the lower straps so they both sit below the ears.
- Bring each of the magnets up to meet their corresponding clips on the frame.



- Adjust the fastening tabs on the upper straps until the mask feels even and stable.
- Reattach the fastening tabs.



- Repeat step 4 with the lower straps.
- Reattach the fastening tabs.



- Connect the device's air tube to the elbow, then click the elbow into the front of the mask.
- Start the device.



Refer to the user guide for further instructions and complete labeling information including indications, contraindications, warnings and precautions.

¹ ResMed AirFit N20 internal international fitting study of new and existing CPAP patients, conducted Nov 2015.

Distributed by ResMed Corp, 9001 Spectrum Center Boulevard, San Diego, CA 92123 USA +1 858 836 5000 or 1 800 424 0737 (toll free). See ResMed.com for other ResMed locations worldwide. AirFit and InfinitySeal are trademarks and/or registered trademarks of the ResMed family of companies. Specifications may change without notice. © 2016 ResMed, 1019410/2 2016-10