

**BOARD OF UNION COUNTY COMMISSIONERS
REGULAR MEETING
AGENDA
August 9, 2022**

UNION COUNTY, NM
DOCUMENT #202200693
08/4/22 04:31:50 PM
1 of 1
BY Brenda Green

9:00 a.m.

1. Call to order
2. Pledge of Allegiance
3. Approval of agenda and minutes
4. Hospital Report
5. Discussion/Possible Action Items
 - i. Village of Des Moines Grant Fiscal Agent Request
 - ii. ICIP Workshop
 - iii. Resolution 2023-05 ICIP Acceptance
 - iv. Approval of Bills
 - v. Road Crossing Permits
 - vi. Inventory Items Disposition - Road Department International Water Truck
 - vii. Healthcare Assistance - Approval of Claims
 - viii. County Travel Requests

10:30 a.m. Citizen's Forum

1. Road Superintendents Report
2. Fire Coordinator/Emergency Manager Report
3. County Manager Report
4. Elected Officials Reports

Adjourn

As of 8/4/2022

Next Regular Meeting September 13, 2022

**UNION COUNTY
RESOLUTION NO. 2023-05**

ADOPTING AN INFRASTRUCTURE CAPITAL IMPROVEMENT PLAN (ICIP)

WHEREAS, the County of Union recognizes that the financing of public capital projects has become a major concern in New Mexico and nationally; and

WHEREAS, in times of scarce resources, it is necessary to find new financing mechanisms and maximize the use of existing resources; and

WHEREAS, systemic capital improvements planning is an effective tool for communities to define their development needs, establish priorities and pursue concrete actions to achieve necessary development;

WHEREAS, this process contributes to local and regional efforts in project identification and selection in short- and long-range capital planning efforts.

NOW THEREFORE, BE IT RESOLVED BY THE COUNTY OF UNION that:

1. Union County has adopted the attached Infrastructure Capital Improvement Plan, and
2. It is intended that the Plan be a working document and is the first of many steps toward improving rational, long-term capital planning and budgeting for the County's infrastructure.
3. This resolution supersedes Resolution No. 2022-12

DONE AND RESOLVED this 9th day of August, 2022.

**BOARD OF COUNTY COMMISSIONERS
OF UNION COUNTY, NEW MEXICO**

Justin Bennett, Chairman

ATTEST:

Brenda Green, County Clerk

Clayton Kiesling, Member

Walter Hall, Member

OUTSTANDING INVOICES

INVC#	Name	Description	Line Item	PO#	Amount
S6-2322655	A & I CAR CARE	INV# S6-2322655 ALTERNATOR	402252012	28366	260.82
260.82	TOT\$				
	PAID				
260.82	BAL				

188933	ADVANCED COMMUNICATION	INV# 188933 TRBLST 2 BK RADIOS	410532012	28400	2061.57
2061.57	TOT\$				
	PAID				
2061.57	BAL				

812022	BACA VALLEY TELEPHONE CO.	FIRE ALARM MONITORING #2159	401032025	28298	31.99
775.04	TOT\$	GRENVILLE FD PHONE/NOC #507	411572025	28298	71.50
	PAID	PANIC BUTTON #1966	401032025	28298	86.54
775.04	BAL	CAPULIN FD PHONE/NET/NOC #122	407412025	28298	132.87
	PAID	SHERIFF DEPT SUBSTATION #5184	401082007	28298	71.80
	PAID	EM SUBSTATION #5184	401102007	28298	71.81
	PAID	EMAIL HOSTING #2159	401032025	28298	14.95
	PAID	TOWER LEASE #2159	415682076	28298	293.58

22-C20116	BENNETTS LLC	INV# 22-C20116 CYLINDER RENTAL	414662076	28346	21.68
21.68	TOT\$				
	PAID	P.O. BOX 27			
21.68	BAL	RATON NM 87740			

7062022	BEVERLY REESER	MILEAGE/PER DIEM NEIRS TRAINING	408452010	28342	1701.50
1701.50	TOT\$	100%			
	PAID	731 THOMAS HWY			
1701.50	BAL	CLAYTON NM 88415			

104573	BRADLEY SUPPLY	INV# 104573 COOLER PUMP	401032023	28363	27.99
27.99	TOT\$				
	PAID	102 S. FRONT			
27.99	BAL	CLAYTON NM 88415			

104314	BRADLEY SUPPLY	INV# 104314 FROST FREE/NIPPLE	402252076	28363	196.53
196.53	TOT\$				
	PAID	102 S. FRONT			
196.53	BAL	CLAYTON NM 88415			

8222	BRENDA GREEN	ABQ ELECTION SCHOOL PER DIEM 20%	401052010	28387	72.80
72.80	TOT\$				
	PAID	407 TONEY ROAD			
72.80	BAL	CLAYTON NM 88415			

XA101037848	BRUCKNERS TRUCK SALES AMARILLO	INV# XA101037848:01 VALVE	402252012	28367	122.24
122.24	TOT\$	CORPORATE BILLING LLC			
	PAID	DEPT 100 P.O. BOX 830604			
122.24	BAL	BIRMINGHAM AL 35283			

XA101039199	BRUCKNERS TRUCK SALES AMARILLO	INV# XA101039199:01 ROD/JOINT	402252012	28367	60.28
60.28	TOT\$	CORPORATE BILLING LLC			
	PAID	DEPT 100 P.O. BOX 830604			
60.28	BAL	BIRMINGHAM AL 35283			

10072	CDL TIRE AND AUTO	INV# 10072 TIRES FOR E65	410532012	28350	849.87
849.87	TOT\$				
	PAID	1889 S. WEST AVE			

OUTSTANDING INVOICES

INVC#	Name	Description	Line Item	PO#	Amount
849.87	BAL CLAYTON NM 88415				
2064.69	TOT\$ CDL TIRE AND AUTO	INV# 10073 E62 THERM/SENS/ALTER	410532012	28350	2064.69
2064.69	PAID 1889 S. WEST AVE				
	BAL CLAYTON NM 88415				
765.20	TOT\$ CDL TIRE AND AUTO	INV# 10074 OIL/FILTER COMM2	410532012	28350	765.20
765.20	PAID 1889 S. WEST AVE				
	BAL CLAYTON NM 88415				
6392.28	TOT\$ CDL TIRE AND AUTO	INV# 10075 TRANSMISSION COMM2	410532012	28350	6392.28
6392.28	PAID 1889 S. WEST AVE				
	BAL CLAYTON NM 88415				
162.40	TOT\$ CHERYL GARCIA	PER DIEM GATHERING OF COUNTIES	401022010	28434	162.40
162.40	PAID 416 JEFFERSON ST	ALBUQUERQUE 80%		28434	
	BAL CLAYTON NM 88415				
40.60	TOT\$ CHERYL GARCIA	PER DIEM GATHERING OF COUNTIES	401022010	28434	40.60
40.60	PAID 416 JEFFERSON ST	ALBUQUERQUE 20%			
	BAL CLAYTON NM 88415				
7262022	TOT\$ CURTIS SKAGGS	MILEAGE/PER DIEM SENTINEL	401082010	28365	363.00
363.00	PAID 200 WILSON ST	FIREARMS TRAINING 20%			
	BAL CLAYTON NM 88415				
72.80	TOT\$ DEVIAN FIELDS	ABQ ELECTION SCHOOL PER DIEM 20%	401052010	28386	72.80
72.80	PAID P.O. BOX 33				
	BAL TEXLINE TX 79087				
9102022	TOT\$ ENCHANTED CIRCLE EMS	ENCHANTED CIRCLE EMS CONFERENCE	412612010	28436	70.00
70.00	PAID PO BOX 31				
	BAL RED RIVER NM 87558				
911221-IN	TOT\$ HEIMAN FIRE EQUIPMENT	INV# 0911221-IN WILDLAND GLOVES	410532081	28399	945.15
945.15	PAID 25814 RUDOLPH AVENUE				
	BAL SIOUX FALLS SD 57107				
8142022	TOT\$ JAMES LOBB	PER DIEM AFFILIATE TRAINING 80%	401082010	28410	677.60
677.60	PAID 1 OREGON TRAIL				
	BAL CLAYTON NM 88415				
8292022	TOT\$ JAMES LOBB	PER DIEM AFFILIATE TRAINING 20%	401082010	28410	169.40
169.40	PAID 1 OREGON TRAIL				
	BAL CLAYTON NM 88415				
8232022	TOT\$ KRISTOPHER LAWRENCE	MILEAGE/PER DIEM ICS300 TRAINING	401102010	28418	523.60

OUTSTANDING INVOICES

INVC#	Name	Description	Line Item	PO#	Amount
523.60	TOT\$	LOS ALAMOS 80%		28418	
523.60	PAID	324 CEDAR ST			
523.60	BAL	CLAYTON NM 88415			
130.90	TOT\$	MILEAGE/PER DIEM ICS300 TRAINING 401102010		28418	130.90
130.90	PAID	KRISTOPHER LAWRENCE			
130.90	BAL	CLAYTON NM 88415			
703.50	TOT\$	MILEAGE/PER DIEM HSEEP TRAINING 401102010		28418	703.50
703.50	PAID	KRISTOPHER LAWRENCE			
703.50	BAL	CLAYTON NM 88415			
431.00	TOT\$	REIMBURSE FINGERPRINT EMS LICENS 412612010		28438	44.00
431.00	PAID	KRISTY KAY BENNETT			
431.00	BAL	CLAYTON NM 88415			
4661.00	TOT\$	INV# INV612311 JACKET/PANTS 407412081		28029	4661.00
4661.00	PAID	L.N. CURTIS & SONS			
4661.00	BAL	CLAYTON NM 88415			
2618.56	TOT\$	JULY ATTORNEY SERVICES 401012101		28360	2618.56
2618.56	PAID	LAW OFFICE OF STEPHEN ROSS			
2618.56	BAL	CLAYTON NM 88415			
72.80	TOT\$	ABQ ELECTION SCHOOL PER DIEM 20% 401052010		28385	72.80
72.80	PAID	P.O. BOX 4774			
72.80	BAL	SANTA FE NM 87502 4774			
9220-75385	TOT\$	INV# 9220-75385 FILTERS 402252012		28374	17.28
9220-75385	PAID	MC CLURES BIG J PARTS			
9220-75385	BAL	CLAYTON NM 88415			
9220-75216	TOT\$	INV# 9220-75216 PLUG/FLTR/PAATCH 402252076		28374	150.29
9220-75216	PAID	MC CLURES BIG J PARTS			
9220-75216	BAL	CLAYTON NM 88415			
9142022	TOT\$	PER DIEM GATHERING OF COUNTIES 401082010		28431	162.40
9142022	PAID	MICHELLE N. CALLIS			
9142022	BAL	ALBUQUERQUE 80%			
9152022	TOT\$	PER DIEM GATHERING OF COUNTIES 401082010		28431	40.60
9152022	PAID	MICHELLE N. CALLIS			
9152022	BAL	ALBUQUERQUE 20%			
9367-627482	TOT\$	INV# 9367-627482 BATTERY FOR U26 409492012		28422	196.91
9367-627482	PAID	MISSION AUTO SUPPLY			
9367-627482	BAL	DALHART TX 79022			

INVC#	Name	Description	Line Item	PO#	Amount
9367-627645	MISSION AUTO SUPPLY	INV# 9367-627645 BATTERY FOR U26	409492012	28422	33.00-
33.00- TOT\$					
PAID	615 EAST 7TH				
BAL	DALHART TX 79022				
140629	NAPA AUTO PARTS	INV# 140629 12OZ CAN/STOP LEAK	402252076	28397	140.27
140.27 TOT\$	MAIN STREET AUTO PARTS				
PAID	112 MAIN ST				
BAL	CLAYTON NM 88415				
140432	NAPA AUTO PARTS	INV# 140432 WIPER BLADES	410532076	28414	18.98
18.98 TOT\$	MAIN STREET AUTO PARTS				
PAID	112 MAIN ST				
BAL	CLAYTON NM 88415				
17-000808	NEW MEXICO SHERIFF'S ASSOCIATION	INV# 17-000808 FALL CONF REGIST	401082010	28427	160.00
160.00 TOT\$					
PAID	P.O. BOX 15574				
BAL	RIO RANCHO NM 87174				
1-FY23	NM STATE LIBRARY	INV# 1-FY23 LIBRARY SERVICES	401012086	28420	700.00
700.00 TOT\$	RURAL BOOKMOBILE NORTHEAST	7/1/22 - 6/30/23			
PAID	PO BOX 97				
BAL	CIMARRON NM 87714				
252228719001	OFFICE DEPOT	PRINthead/BATTERIES	401062009	28340	100.76
114.92 TOT\$		INV# 252228719001 STAPLES/LABEL	401022009	28340	14.16
PAID	P.O. BOX 660113				
BAL	DALLAS TX 75266 0113				
252472781001	OFFICE DEPOT	INV# 252472781001 ADAPTOR/CHARGE	401022009	28340	89.96
89.96 TOT\$					
PAID	P.O. BOX 660113				
BAL	DALLAS TX 75266 0113				
252472785001	OFFICE DEPOT	INV# 252472785001 CABLE	401022009	28340	35.98
35.98 TOT\$					
PAID	P.O. BOX 660113				
BAL	DALLAS TX 75266 0113				
254325690001	OFFICE DEPOT	INV# 254325690001 INK	401062009	28340	231.81
231.81 TOT\$					
PAID	P.O. BOX 660113				
BAL	DALLAS TX 75266 0113				
254091079001	OFFICE DEPOT	INV# 254091079001 PPR/TAGS/PEN	401042009	28340	138.29
138.29 TOT\$					
PAID	P.O. BOX 660113				
BAL	DALLAS TX 75266 0113				
254091083001	OFFICE DEPOT	INV# 254091083001 CLIPS	401042009	28340	4.39
4.39 TOT\$					
PAID	P.O. BOX 660113				
BAL	DALLAS TX 75266 0113				
254080694001	OFFICE DEPOT	INV# 254080694001 FLATBED CART	401042009	28340	99.99
99.99 TOT\$					
PAID	P.O. BOX 660113				

OUTSTANDING INVOICES

INVC#	Name	Description	Line Item	PO#	Amount
99.99	BAL DALLAS TX 75266 0113				
7222022	PLATEAU	ACCT# 2134211/2137628 ADMIN BLDG	401022007	28443	621.95
1523.87	TOT\$	ACCT# 2134211 E-911	402252129	28443	49.88
	PAID	ACCT# 2134211 ROAD DEPT	402252007	28443	157.06
1523.87	BAL	ACCT# 2126092 SHERIFF'S DEPT	401082007	28443	299.68
		REFD #008	410532025	28443	117.64
		REFD #743	410532025	28443	118.49
		ACCT# 2216703 AMISTAD/HAYDEN	409492025	28443	44.26
		ACCT# 2123669 SEDAN FD	408452025	28443	114.91
7182022	PNM	OLD REFD #3824	401032025	28430	16.84
3832.26	TOT\$	OLD REFD #1954	401032025	28430	31.44
	PAID	COURTHOUSE	401032025	28430	1517.41
3832.26	BAL	ADMIN BLDG #9738	401032025	28430	75.24
		ADMIN BLDG #7124	401032025	28430	1076.27
		ANNEX	401032025	28430	278.97
		ROAD DEPT	402252025	28430	129.38
		SHERIFF'S DEPT	605932025	28430	686.52
		FIRE COORD	415682076	28430	20.19
812022	PTCI	ACCT# 196023 REFD PHONE	410532025	28348	47.82
47.82	TOT\$				
	PAID				
47.82	BAL	P.O. BOX 1188			
		GUYMON OK 73942 1188			
26378174	QUILL CORPORATION	INV# 26378174 MICROSOFT OFFICE	408452076	28380	149.99
149.99	TOT\$				
	PAID				
149.99	BAL	P.O. BOX 37600			
		PHILADELPHIA PA 19101 0600			
C196895	R.W. ISAACS HARDWARE	INV# C196895 WEED/GRASS KILLER	401032023	28362	33.98
33.98	TOT\$				
	PAID				
33.98	BAL	DRAWER J			
		CLAYTON NM 88415			
C197403	R.W. ISAACS HARDWARE	INV# C197403 BOX FAN	402252076	28362	61.98
61.98	TOT\$				
	PAID				
61.98	BAL	DRAWER J			
		CLAYTON NM 88415			
C197438	R.W. ISAACS HARDWARE	INV# C197438 TRASH BAGS	410532076	28362	49.98
49.98	TOT\$				
	PAID				
49.98	BAL	DRAWER J			
		CLAYTON NM 88415			
722022	RANCH MARKET	GATORADE	410532076	28426	24.15
24.15	TOT\$				
	PAID				
24.15	BAL	300 S. FIRST STREET			
		CLAYTON NM 88415			
742022	RANCH MARKET	ICE	410532076	28426	3.58
3.58	TOT\$				
	PAID				
3.58	BAL	300 S. FIRST STREET			
		CLAYTON NM 88415			

OUTSTANDING INVOICES

INVC#	Name	Description	Line Item	PO#	Amount
36805519	RICOH USA, INC	INV# 36805519 CLERKS LEASE	401042013	28351	188.82
188.82	TOT\$				
	P.O. BOX 660342				
	DALLAS TX 75266				
188.82	BAL				
36803663	RICOH USA, INC	INV# 36803663 ADMIN LEASE	401022013	28351	149.15
342.80	TOT\$				
	P.O. BOX 660342				
	DALLAS TX 75266				
342.80	BAL				
36862436	RICOH USA, INC	INV# 36862436 LATE FEE	401042013	28351	5.40
5.40	TOT\$				
	P.O. BOX 660342				
	DALLAS TX 75266				
5.40	BAL				
36862791	RICOH USA, INC	INV# 36862791 LATE FEE	401022013	28351	6.18
18.53	TOT\$				
	P.O. BOX 660342				
	DALLAS TX 75266				
18.53	BAL				
122	SENTINEL FIREARMS TRAINING LC	INV# 0122 NMDFS HANDGUN	401082010	28359	850.00
850.00	TOT\$				
	1248 SUGAR ROAD SE	INSTRUCTOR COURSE/C. SKAGGS			
	RIO RANCHO NM 87124				
850.00	BAL				
105532	SENTINEL OFFENDER SERVICES	INV# 105532 GPS MONITORING	424772307	28423	1040.85
1040.85	TOT\$				
	PO BOX 8436				
	PASADENA CA 91109 8436				
1040.85	BAL				
13570	SOUTHWESTERN ELECTRIC	INV# 13570 FIRE HOUSE CAP	407412025	28358	138.36
1672.23	TOT\$				
	BOX 369				
	CLAYTON NM 88415				
1672.23	BAL				
3514062691	STAPLES, INC.	INV# 3514062691 FF/ENV/PENS	426752009	28419	85.57
85.57	TOT\$				
	500 STAPLES DRIVE				
	FRAMINGHAM MA 01702				
85.57	BAL				
3514062692	STAPLES, INC.	INV# 3514062692 PAPER	426752009	28419	41.99
41.99	TOT\$				
	500 STAPLES DRIVE				
	FRAMINGHAM MA 01702				
41.99	BAL				
11365	SWAGERTY TRADING CO.	INV# 11365 3/4" SS ST 90	408452076	28415	10.80

OUTSTANDING INVOICES

INVC#	Name	Description	Line Item	PO#	Amount
10.80	TOT\$				
	PAID				
10.80	BAL				
	BOX 88				
	CLAYTON NM 88415				
408.10	TOT\$	ENCHANTED CIRCLE EMS CONF 80%	412612010	28437	408.10
	PAID				
408.10	BAL				
	TAMI STOGSDILL				
	670 KENNEDY RD				
	DES MOINES NM 88418				
9122022	TAMI STOGSDILL	ENCHANTED CIRCLE EMS CONF 20%	412612010	28437	102.03
102.03	TOT\$				
	PAID				
102.03	BAL				
	DES MOINES NM 88418				
406758	THE WESTERN GROUP	INV# 406758 (2) ROLLERS	402252076	28393	287.59
287.59	TOT\$				
	PAID				
287.59	BAL				
	3950 NW ST. HELENS RD				
	PORTLAND OR 97210 1423				
406731	THE WESTERN GROUP	INV# 406731 SQUARE OPENING/WIRE	402252076	28393	352.69
352.69	TOT\$				
	PAID				
352.69	BAL				
	3950 NW ST. HELENS RD				
	PORTLAND OR 97210 1423				
72122	TOWN OF CLAYTON	INV# 072122 BULK WTR 760,500 GAL	402252076	28353	4423.83
4423.83	TOT\$				
	PAID				
4423.83	BAL				
	1 CHESTNUT				
	CLAYTON NM 88415				
7282022	TOWN OF CLAYTON	ROAD DEPT WATER/GARBAGE	402252025	28353	88.38
1442.47	TOT\$				
	PAID				
1442.47	BAL				
	1 CHESTNUT				
	CLAYTON NM 88415				
812022	TRANSMUNION RISK & ALTERNATIVE	STMT ID: 6278812-202207-1	401082036	28312	128.00
128.00	TOT\$				
	PAID				
128.00	BAL				
	DATA SOLUTIONS, INC.				
	P.O. BOX 209047				
	DALLAS TX 75320				
1701755	TRIFADIC	INV# 1701755 APEX DSKTP/INTERFAC	499792013	28352	1194.79
1194.79	TOT\$				
	PAID				
1194.79	BAL				
	P.O. DRAWER 471				
	DEWING NM 88031 0471				
29.14.1	TRIFADIC	INV# 29:14.1 NETWORKING	401022013	28352	1244.21
3879.07	TOT\$				
	PAID				
3879.07	BAL				
	P.O. DRAWER 471				
	DEWING NM 88031 0471				
8332217769	UNIFIRST	INV# 8332217769 RUG SERVICE	401032046	28429	61.80
61.80	TOT\$				
	PAID				
61.80	BAL				
	PO BOX 600				
	WILMINGTON MA 01887				
2850001357	UNIFIRST	INV# 2850001357 RUG SERVICE	401032046	28429	62.10

INVC#	Name	Description	Line Item	PO#	Amount
62.10	TOT\$				
	PO BOX 600				
62.10	PAID				
	WILMINGTON MA 01887				
62.10	BAL				2421.86

S03W0872662	WAGNER EQUIPMENT CO.	INV# S03W0872662 MAINT SOFTWARE	402252012	28373	2421.86
2421.86	TOT\$				
	PAID				
	P.O. BOX 919000				
2421.86	BAL				316.36

P10C0841435	WAGNER EQUIPMENT CO.	INV# P10C0841435 FILTER/ELEMENT	402252076	28373	316.36
316.36	TOT\$				
	PAID				
	P.O. BOX 919000				
316.36	BAL				5898.54

S03W0872700	WAGNER EQUIPMENT CO.	INV# S03W0872700 ENGN FAN REPAIR	402252012	28373	5898.54
5898.54	TOT\$				
	PAID				
	P.O. BOX 919000				
5898.54	BAL				125.00

7192022	WALTER HALL	REIMBURSEMENT ON PORTS TO PLAINS	401012010	28416	125.00
125.00	TOT\$				
	PAID				
	233 BOISE CITY HWY				
125.00	BAL				28416

892022	WALTER HALL	PER DIEM NMSTC MEETING/LAS VEGAS	401012010	28416	368.50
368.50	TOT\$				
	PAID				
	233 BOISE CITY HWY				
368.50	BAL				

TOTAL INVOICING 60741.20

PERMIT NO. 471

This permit is granted on this 9th day of August, 2022, by the Board of Commissioners of Union County, New Mexico, (County) and PLATEAU, (Permittee),

Address: 7111 N. PRINCE STREET CLOVIS, NM 88102

This permit is for the sole purpose of allowing Permittee to lay (pipe or cable) for the purpose of FIBER OPTIC DISTRIBUTION CABLE INSTALLATION

across a certain designated County road lying, situated and being in the County of Union, State of New Mexico, more particularly described as follows:

LEGAL DESCRIPTION

RINKER ROAD

NE4SE4 OF SECTION 12, TOWNSHIP 26, RANGE 36E

This permit is subject to the following provisions: **HORIZONTAL BORE**

- 1. a.) Permittee will ~~dig a trench~~ across the above-described County Road approximately 3 feet deep.
- b.) Pipe and/or cable made of 48 FIBER OPTIC CABLE

- c.) Pipe and/or cable shall be 1.25 inches in diameter and of the type Schedule ORANGE PLASTIC DUCT.

- 2. Permittee will then fill and compact the trench to restore the road to an even level suitable for public traffic. Restoration of the road shall be subject to the inspection and approval of the County Road Supervisor.
- 3. Permittee shall install visible, identifiable markers on site, indicating the location of the pipe.
- 4. Permittee is to perform the construction in such a way as to provide adequate fill on both ends of the road and shall construct any structure that may be necessary or desirable in connection therewith.
- 5. All excavation and construction performed under this permit shall be consistent with all laws, rules and regulations of the State of New Mexico and of the County.
- 6. In the event that the County desires to improve the above-described County Road, the County reserves the right to request from the Permittee, if necessary to remove and/or relocate in order to make such improvements. The County will give Permittee notice in advance of making such improvements.
- 7. Permittee will hold harmless Union County for any damage to third parties resulting from the excavation of fill.
- 8. Permittee shall erect sufficient warning barricades and signs to alert all traffic of the hazard during construction and restoration.
- 9. At least twenty-four (24) hour notice shall be provided to the Union County Road Department Supervisor of the commencement and completion of any construction.

Witness our hands and seals this 9th day of August, 20 22.

SEAL

ATTEST

**BOARD OF COMMISSIONERS
COUNTY OF UNION, NEW MEXICO**

CHAIRMAN

MEMBER

COUNTY CLERK

MEMBER

EXHIBIT A
TEAU FIBER CROSSING

RINKER ROAD

SECTION 12
TOWNSHIP 26N
RANGE 36E

12

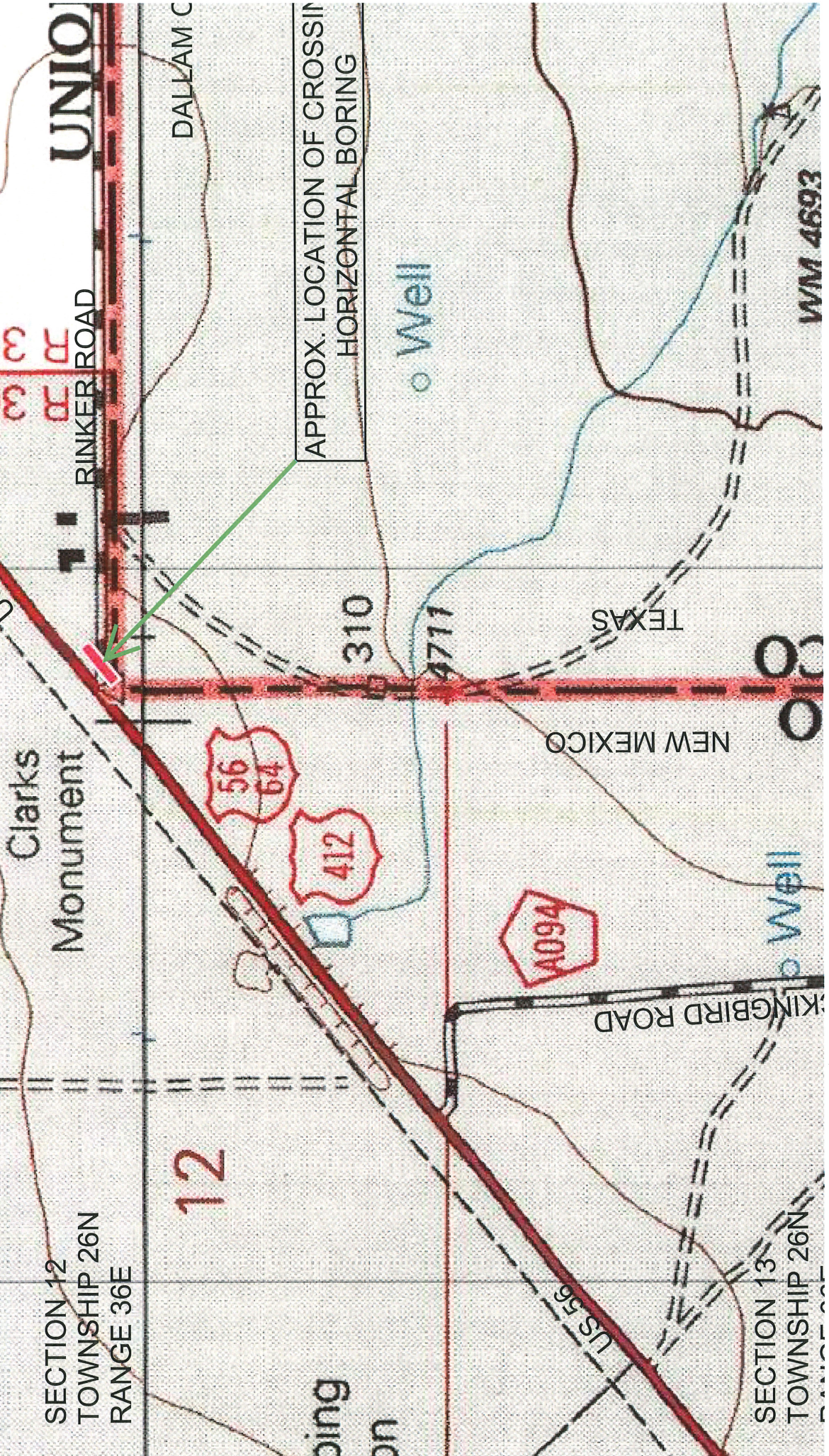

SECTION 12
TOWNSHIP 26N
RANGE 36E

56
64

4725

R 37 E

R 36 E

RINKER ROAD

UNION PACIFIC

DALLAM C

APPROX. LOCATION OF CROSSING
HORIZONTAL BORING

Well

310

4711

TEXAS

NEW MEXICO

56
64

412

A094

KINGBIRD ROAD

Well

SECTION 13
TOWNSHIP 26N
RANGE 36E

W/M 4693

PERMIT NO. 472

This permit is granted on this 9th day of August, 2022, by the Board of Commissioners of Union County, New Mexico, (County) and PLATEAU, (Permittee),

Address: 7111 N. PRINCE STREET CLOVIS, NM 88102

This permit is for the sole purpose of allowing Permittee to lay (pipe or cable) for the purpose of FIBER OPTIC DISTRIBUTION CABLE INSTALLATION

across a certain designated County road lying, situated and being in the County of Union, State of New Mexico, more particularly described as follows:

LEGAL DESCRIPTION

FURLOW ROAD (3)

S2S2SE4 OF SECTION 10, TOWNSHIP 23N, RANGE 35E

This permit is subject to the following provisions: PARALLEL TO

1. a.) Permittee will dig a trench ~~across~~ the above-described County Road approximately 3 feet deep.
- b.) Pipe and/or cable made of 24 FIBER OPTIC CABLE

- c.) Pipe and/or cable shall be 1.25 inches in diameter and of the type Schedule ORANGE PLASTIC DUCT.

2. Permittee will then fill and compact the trench to restore the road to an even level suitable for public traffic. Restoration of the road shall be subject to the inspection and approval of the County Road Supervisor.
3. Permittee shall install visible, identifiable markers on site, indicating the location of the pipe.
4. Permittee is to perform the construction in such a way as to provide adequate fill on both ends of the road and shall construct any structure that may be necessary or desirable in connection therewith.
5. All excavation and construction performed under this permit shall be consistent with all laws, rules and regulations of the State of New Mexico and of the County.
6. In the event that the County desires to improve the above-described County Road, the County reserves the right to request from the Permittee, if necessary to remove and/or relocate in order to make such improvements. The County will give Permittee notice in advance of making such improvements.
7. Permittee will hold harmless Union County for any damage to third parties resulting from the excavation of fill.
8. Permittee shall erect sufficient warning barricades and signs to alert all traffic of the hazard during construction and restoration.
9. At least twenty-four (24) hour notice shall be provided to the Union County Road Department Supervisor of the commencement and completion of any construction.

Witness our hands and seals this 9th day of August, 20 22.

SEAL

ATTEST

**BOARD OF COMMISSIONERS
COUNTY OF UNION, NEW MEXICO**

CHAIRMAN

MEMBER

COUNTY CLERK

MEMBER

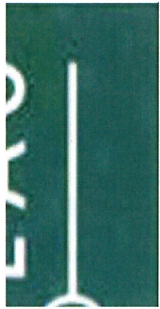

EXHIBIT A
FIBER PARALLEL

FURLOW ROAD (3)

APPROX. LOCATION OF PARALLEL

SECTION 10
TOWNSHIP 23N
RANGE 35E

SECTION 11
TOWNSHIP 23N
RANGE 35E

SECTION 15
TOWNSHIP 23N
RANGE 35E

SECTION 14
TOWNSHIP 23N
RANGE 35E

4769

Grave +

NM 402

FURLOW ROAD

BM 4786

4797

FURLOW ROAD

Well

4770

