

Control Panel (pn: CS0-AC2)

Description:

The Control Panel is used to remotely control (2) devices for auto failover, auto changeover and staging via an analog sensor. Typical applications include automatic start / stop of standby equipment based on a failed state (failover), runtime equalization (changeover) as well as staging based on an analog reading.

- Fans
- Pumps
- Air Conditioners
- Motors

The CS0-AC2 also contains a Modbus and BACnet interface for integration to Building Management Systems (BMS). Supported protocols include: (Note: BACnet protocols are monitoring only.)

- Modbus RTU
- Modbus TCP
- BACnet MSTP
- BACnet IP

The CS0-AC2 is configured via a command-line tool available @ www.pythiatech.com/downloads

Assembly Overview

- ◆ Remotely monitor common alarm conditions from up to 1,000 ft.
- ◆ Relay outputs drive remote start / stop to connected devices.
- ◆ Visual indication with audible alarm.
- ◆ Brother label compatible (1/2") for unit identification
- ◆ Modbus and BACnet communications
- ◆ Type 1 Enclosure, indoor use only

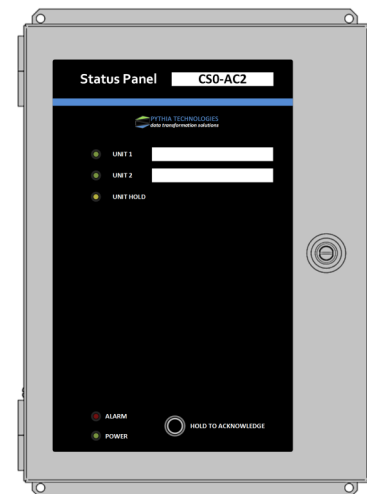

Assembly

CS0-AC2-UL

Dimensions

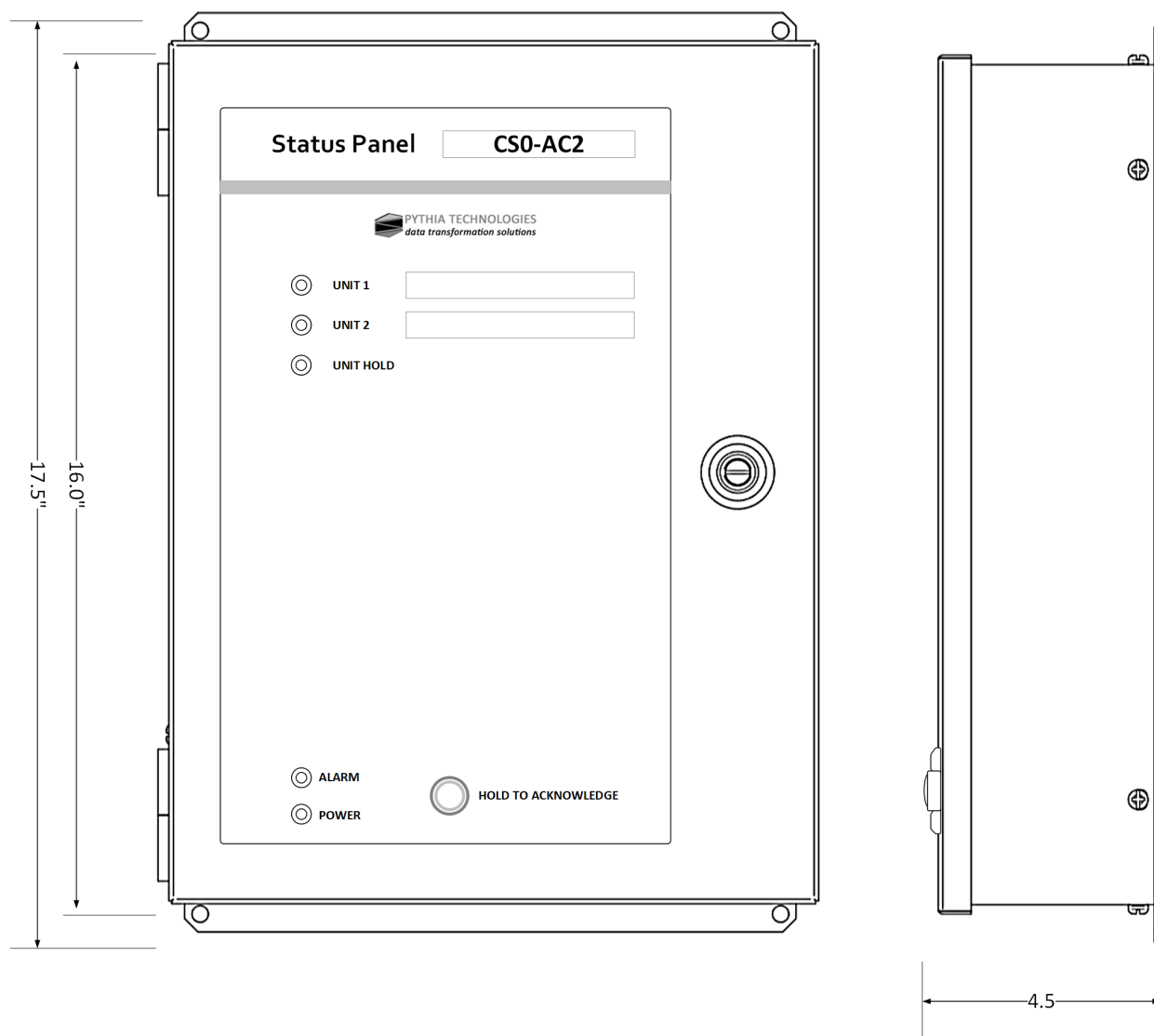

Communications

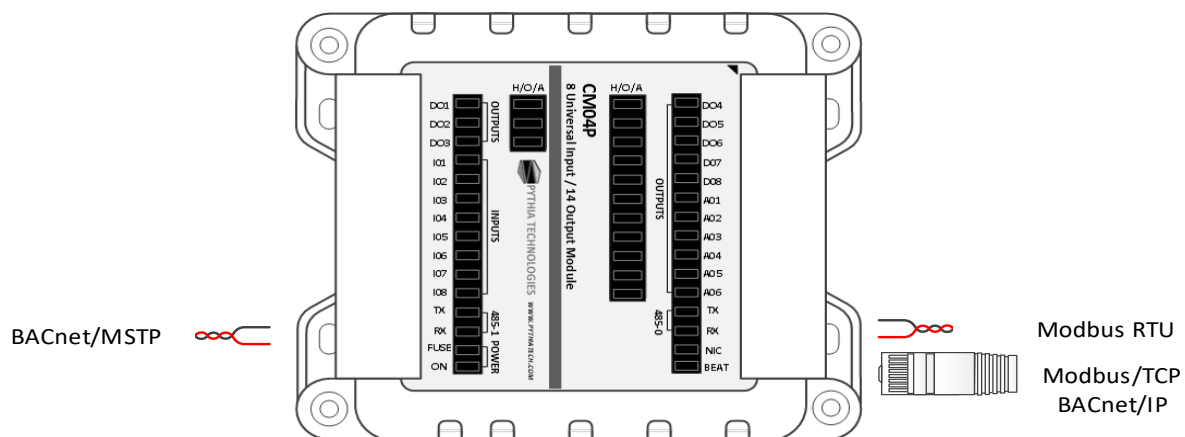

Connections

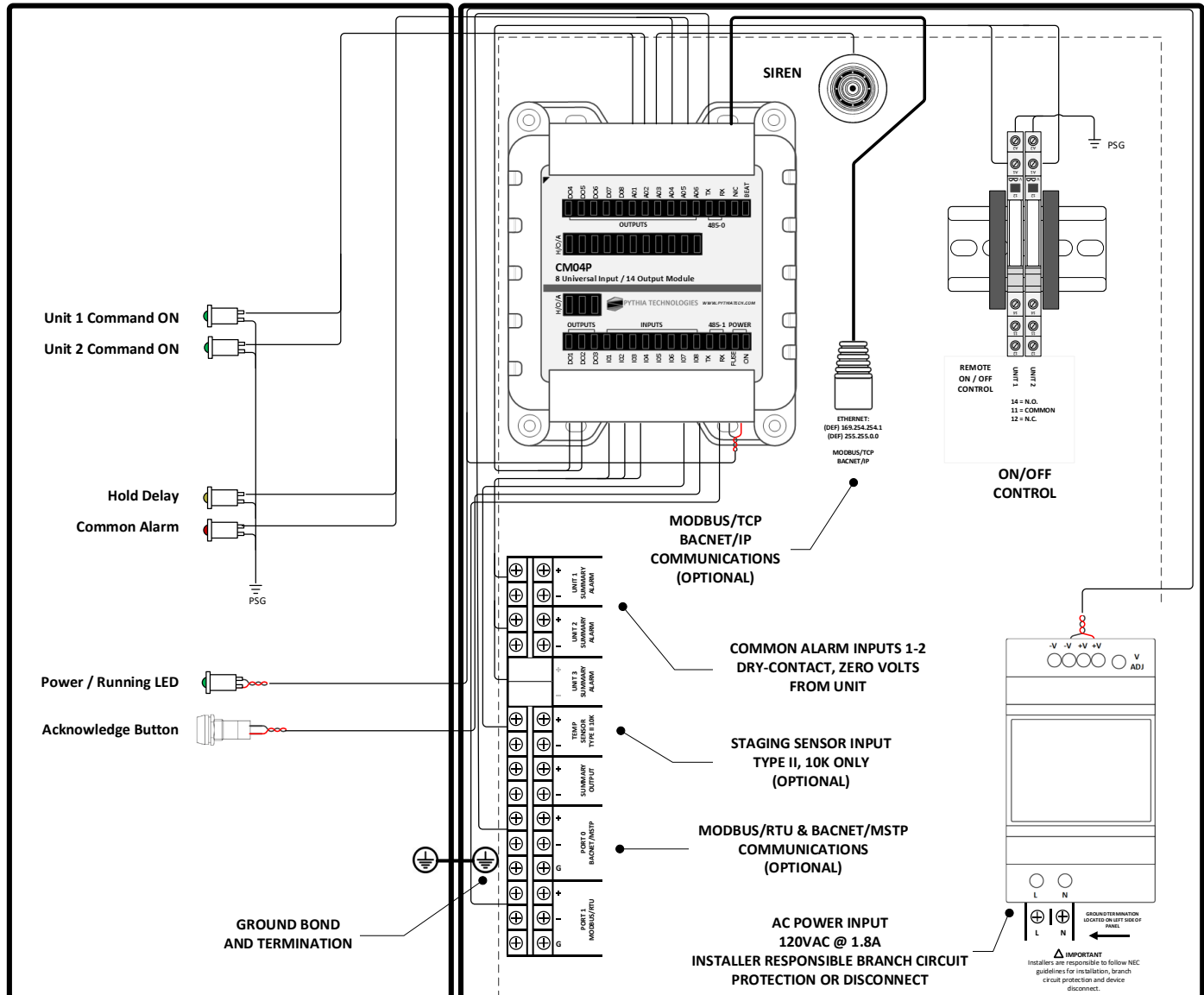

Key Features:

Monitor common alarm status from (2) devices (inputs) and provide fail-over run commands (outputs) through high power output relays

Provides auto-changeover capabilities for runtime equalization.

Provides staging with an optional analog sensor

Modbus and BACnet communications for BMS connectivity

Configuration tool available www.pythiatech.com/downloads

SPECIFICATIONS

Communications	Modbus RTU, Modbus TCP, BACnet MSTP, BACnet IP
Inputs	2
Input Type	Dry-contact only / zero voltage relays or contacts / Normally Open / Closed
Outputs	(2) relay outputs. (Class II, 100VA Circuits only)
Output Type	SPDT relay
Dimensions	17.5" x 12.25" x 4.5"
Weight	15.0lbs
Input Power	120/240 VAC @ 1.8A maximum / 24VAC @ 1.5A maximum
Input labels	Brother 1/2 inch compatible (or similar)
Operating Temperatures / Humidity	32F—115F / 8% - 90% RH non-condensing
Storage Temperature	-40F—158F
Listings	UL-508A Industrial Control Panel Enclosure, Type 1 Enclosure , Indoor use only.

Wiring

Common Alarm Input	18-22 AWG Stranded—Belden 9740 (non Plenum), Belden 89740 (plenum) or equal
Output Control Relay	14-18 AWG Stranded
Common Alarm Output	18-22 AWG Stranded—Belden 9740 (non Plenum), Belden 89740 (plenum) or equal
Input Power	Standard 3-wire 120 VAC - 14 AWG.
RS485 Communications	18-22 AWG twisted-pair, shielded, stranded Belden 88761 or equal
Network Communications	Standard CAT5, CAT6

Ordering

Pn. CS0-AC2-UL

Call for alternative assembly pricing



PYTHIA TECHNOLOGIES
data transformation solutions

175 S. Sandusky Street, Suite 321 Delaware OH 43015 Tel. 740.363.2272

sales@pythiatech.net

© 2020-2022 Pythia Technologies, Inc.

All rights reserved throughout the world.

Specification may change at anytime without notice.

Document #: SPEC_CS0-AC2_007_0422