

Status Panel (pn: CS0-RSP-06)

Description:

The Status Panel is used to remotely monitor up to (6) dry-contacts from any device. The CS0-RSP-06 is wall mounted and can be located up to 1,000 feet from the monitored contact. The panel uses LED's to visually display the monitored point input status. The CS0-RSP-06 also provides an additional set of output relays to mimic the input state. It also has an audible alarm to warn of alarm conditions, along with an alarm silence / acknowledge button.

The CS0-RSP-06 also contains a Modbus and BACnet interface for integration to Building Management Systems (BMS). Supported protocols include:

- Modbus RTU and Modbus TCP
- BACnet MSTP and BACnet IP

Assembly Overview

- ◆ Remotely monitor (6) dry-contacts from up to 1,000 ft.
- ◆ (6) Relay outputs that mimic input state for notifications to another system or status panel.
- ◆ (1) Common alarm output
- ◆ Visual indication with audible alarm.
- ◆ Brother label compatible (1/2")
- ◆ Modbus and BACnet communications



Assembly

CS0-RSP-06

Dimensions

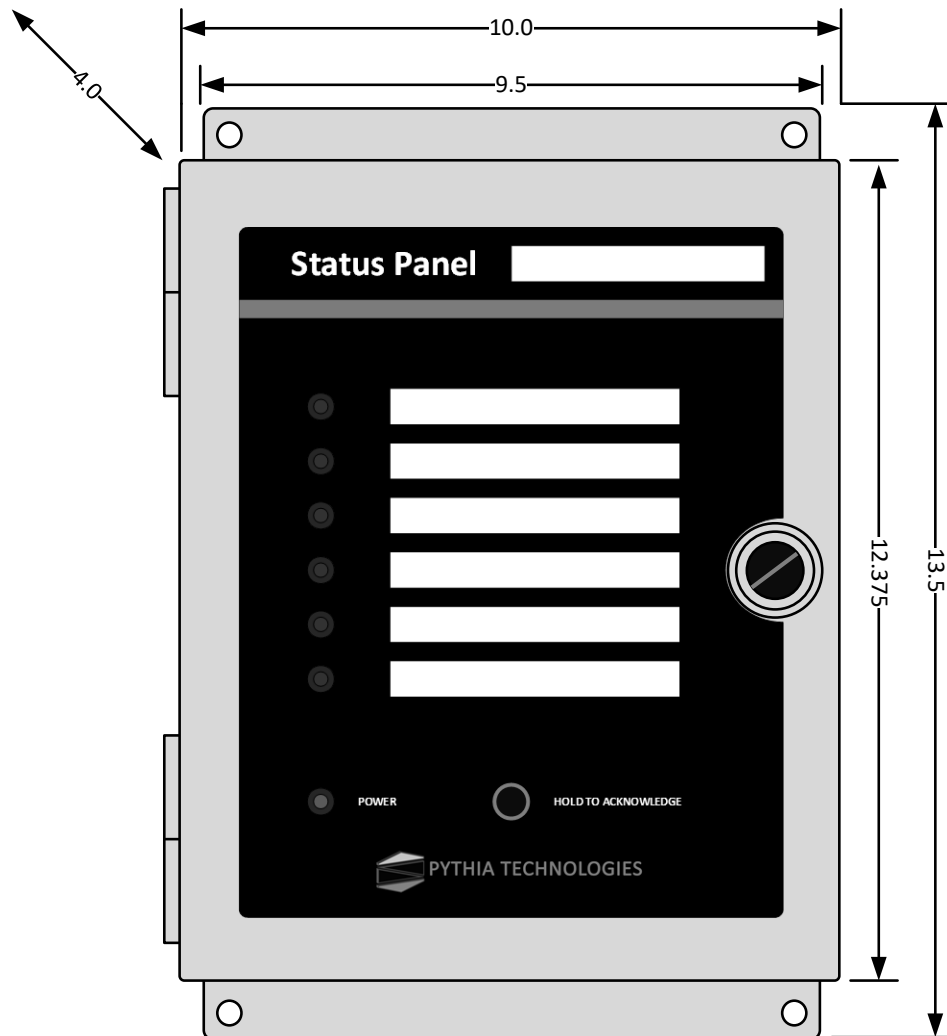

Communications

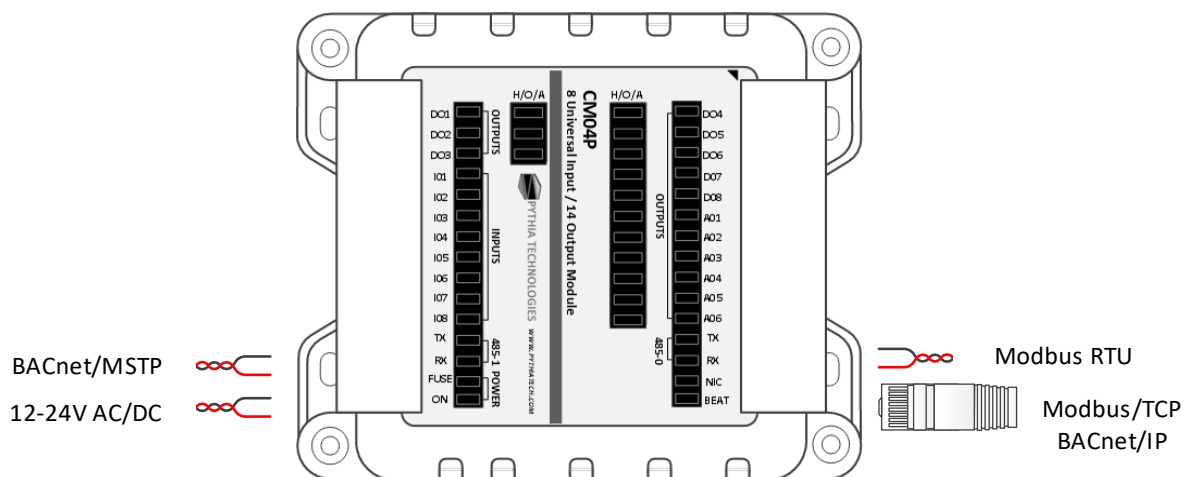

Connections

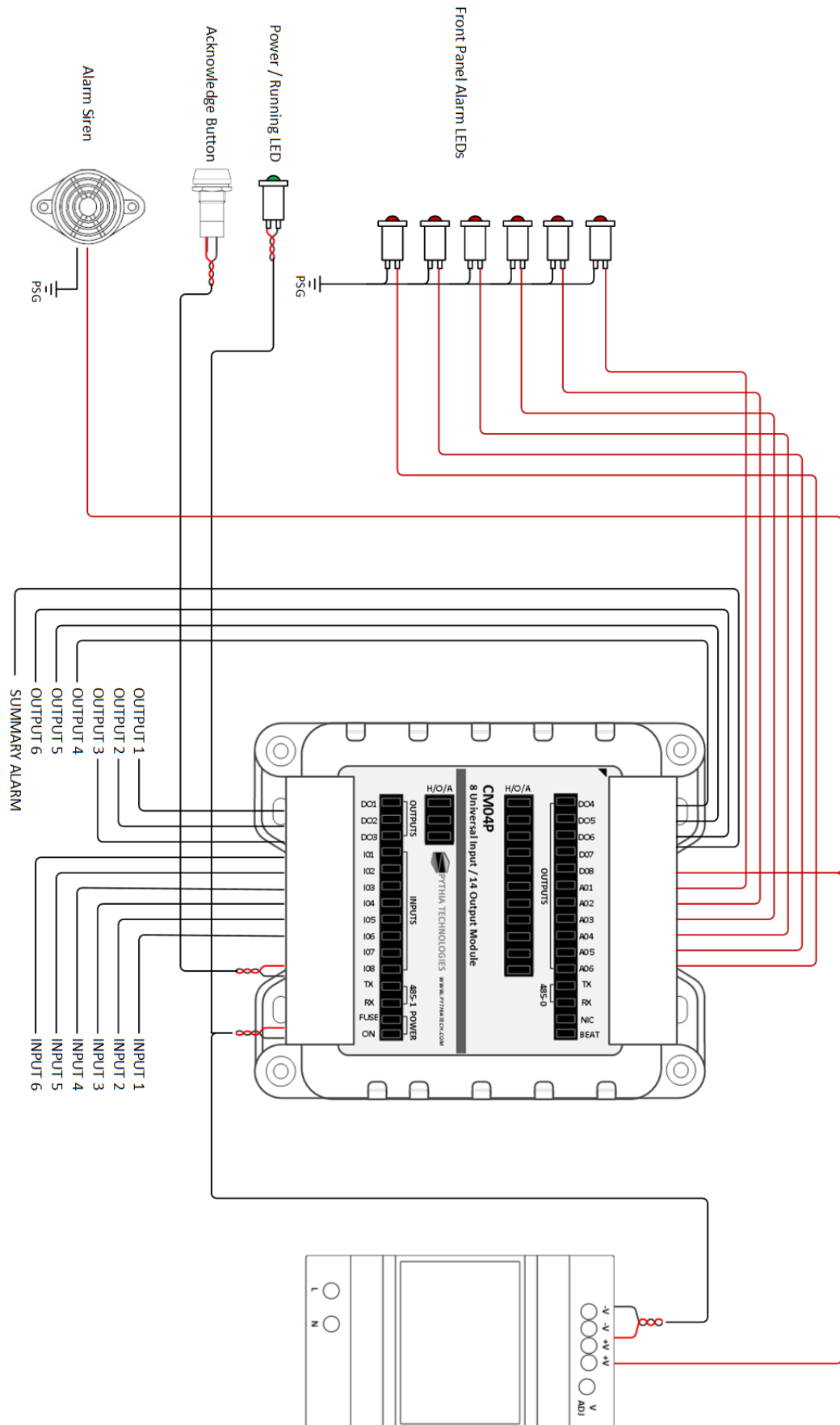

Key Features:

Monitor (6) Normally Open/Closed Dry-Contacts. Remote contacts can be 1000 feet away

(6) relay outputs that mimic input state for notification to other systems, (1) Common Alarm

Modbus and BACnet communications for configuration and BMS connectivity

Audible and Visual indicators of Alarms

NEMA1, powder coated enclosure

SPECIFICATIONS

Communications	Modbus RTU, Modbus TCP, BACnet MSTP, BACnet IP
Inputs	6
Input Type	Dry-contact only / zero voltage relays or contacts / Normally Open / Closed
Outputs	7
Output Type	N.O. Relay rated 3A @ 120VAC
Dimensions	10" x 13.5" x 4.0"
Weight	12.0lbs
Input Power	120/240 VAC @ 1.8A maximum
Input labels	Brother 1/2 inch compatible (or similar)

Other Specifications

none	

Ordering

PN. CS0-RSP-01

Call for alternative assembly pricing



175 S. Sandusky Street, Suite 321 Delaware OH 43015 Tel. 740.363.2272

sales@pythiatech.net

© 2021-2022 Pythia Technologies, Inc.

All rights reserved throughout the world.

Specification may change at anytime without notice.

Document #: SPEC_CS0-RSP-06_001_1122