

TESTIMONIAL OF INVENTION

This Testimonial of Invention form is an important record of your invention. It is a part of your evidence of conception. After you have completed the drawings and description, have two persons who fully understand your invention witness and date this form in the space below.

To Whom It May Concern

BE IT KNOWN THAT MR MRS MS Luther W. Fortinberry
CURRENTLY RESIDING AT 300 South Olive St. Apt 1302
CITY Los Angeles STATE Calif. ZIP 90013
TELEPHONE (213) 687-3713 BUSINESS () _____

HAS CONCEIVED THE INVENTION DESCRIBED AND ILLUSTRATED IN THIS TESTIMONIAL FORM
NAMED AS Devices to modify electrics around the house
AND HAS THIS 2nd DAY OF April 20 02 DISCLOSED TO US THIS
INVENTION AND WE FULLY UNDERSTAND ITS CONSTRUCTION AND USE.

WITNESS _____

WITNESS _____

DATE OF ORIGINAL CONCEPTION 1-1-96

DATE FIRST DISCLOSED TO OTHERS 1-1-99

IS THIS INVENTION PATENTED ? NO IF YES, GIVE DATE OF ISSUE _____

IF UNPATENTED HAS A PATENT SEARCH BEEN CONDUCTED ? _____

DO YOU HAVE A WORKING MODEL OR PROTOTYPE ? _____

DO YOU HAVE ANY MOLDS / DIES OR OTHER TOOLS REGARDING YOUR INVENTION ? NO

IF YES, EXPLAIN _____

SKETCH OF INVENTION

To the best of your ability, sketch your invention or attach a photograph if it depicts your idea accurately. Please be sure to label parts or components.

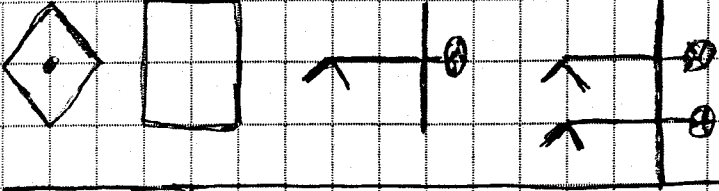

AM - FM CONTINUOUS PLAY
CASSETS DUAL-TAPE RECORD
CD-3 CHANGER-EDITING
VCR-DUAL-DVD-NOCOMERCIAL

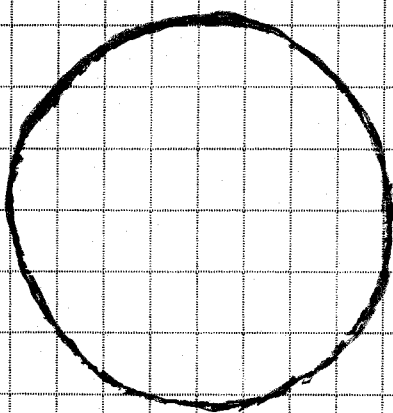
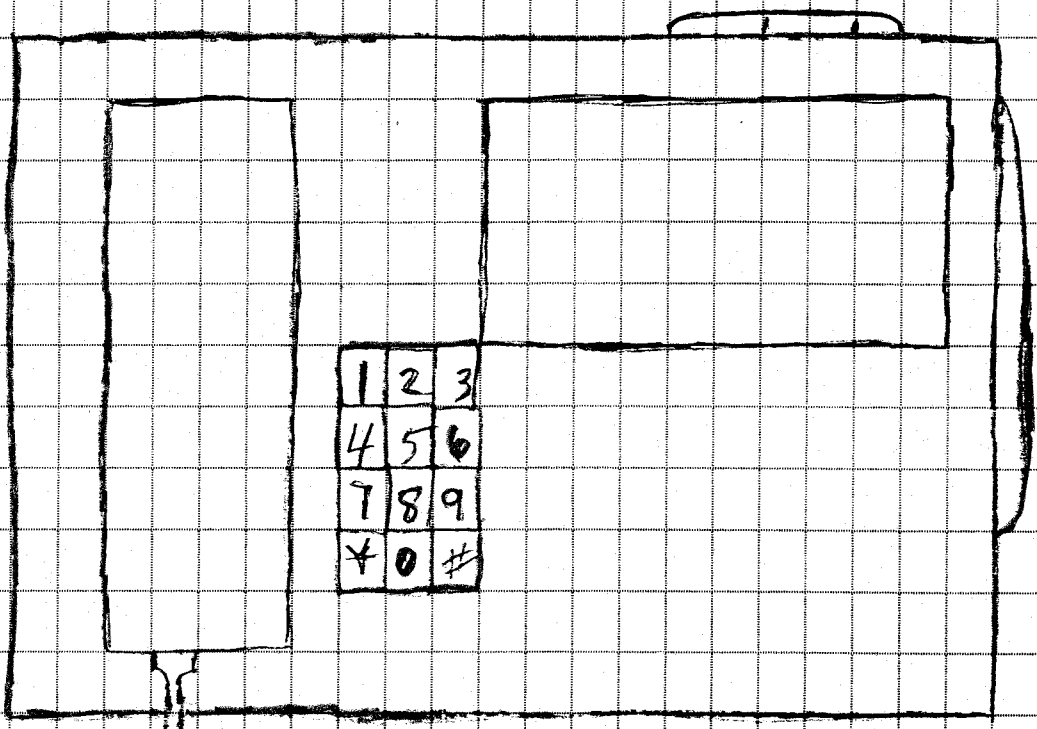

© 1996 BY LUTHER W. FORTINBERRY

FACE LIGHT

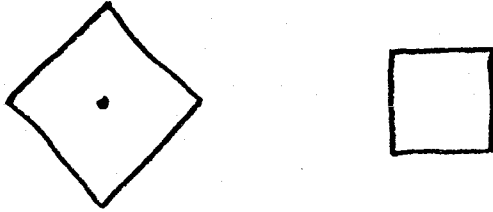

DESIGNED FOR MANUFACTURERS, REASON FOR THIS INSTRUMENT IS TO
REDUCE THE RADIOACTIVITY OF THE UNNECESSARY LIGHT INSTRUMENTS
GIVE OFF TO CONSUMERS IN THEIR HOME. GADGET KNOB TURNS LIGHT
ON AND OFF ADJUST DARKNESS AND LIGHTNESS OF LIGHT, PUSH BUTTON
ADJUST SIZE AND WIDTH OF LETTERS.

In your own words, please answer the following questions. Attach other written material if needed. Please print clearly.

1. Describe the idea. Face light-Multiple on off rotary dial switch with dimmer system - Synchronized stereo - Silent phone - Lamp shade Shaw

2. Describe how it works: All these systems are to reduce the harmful blairing effects of electrical instruments around the house. See attachments for full descriptions.

3. Dimensions and Characteristics

A) Shape _____

B) Measurements... Height or Length +/- _____ Width +/- _____
Depth +/- _____ Circumference (if circular) _____

C) Materials Needed _____

4. What problem does this idea solve? harmful electrical effects around the house.

5. What features make this idea unique and appealing to the end user?

pleasant radioactive electronics around the house.

6. What specific groups of people would use this invention?

all ages

7. How did you develop this idea? Over the years getting burned by different electronics around the house.

8. Are you aware of any products that are similar to this idea? NO

9. Additional Comments If these ideas were put into production for the masses they would really experience much smoother electronics around the house. All of these product design ideas are to reduce harmful and ~~no~~ bothersome radioactivity of electronics around the house.

DECLARATION

I, Luther Winston Fortinberry, being duly
(Print Name)

sworn upon oath, depose and state that I believe myself to be the original, first and sole inventor of the device described herein, and that all dates and statements made in this document are true to the best of my knowledge and belief.

Luther Winston Fortinberry
Signature

State of California County of Los Angeles

Sworn and Subscribed before me this first day of April

20 02

Notary Public [Signature]

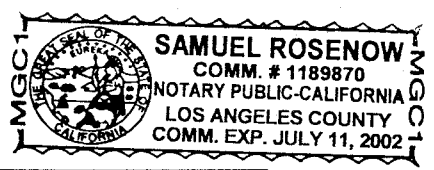

Seal

C 2001 BY LUTHER WINSTON FORTINBERRY

MULTIPLE ON OFF ROTARY DIAL SWITCH WITH DIMMER SYSTEM

TURN DIAL TO RIGHT CLICKS LIGHTS ON ONE AT A TIME ETC. AL .
. . TURN DIAL TO LEFT DIMS ANY LIGHT THAT'S ON TO OFF THEN CLICKS
ALL LIGHTS TO OFF.

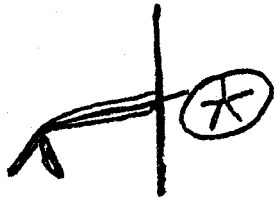

OR

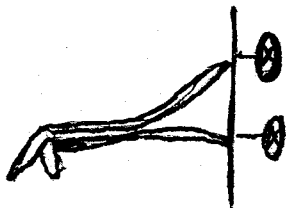

ELECTRONIC TUNER

"SYNCHRONIZED STEREO"

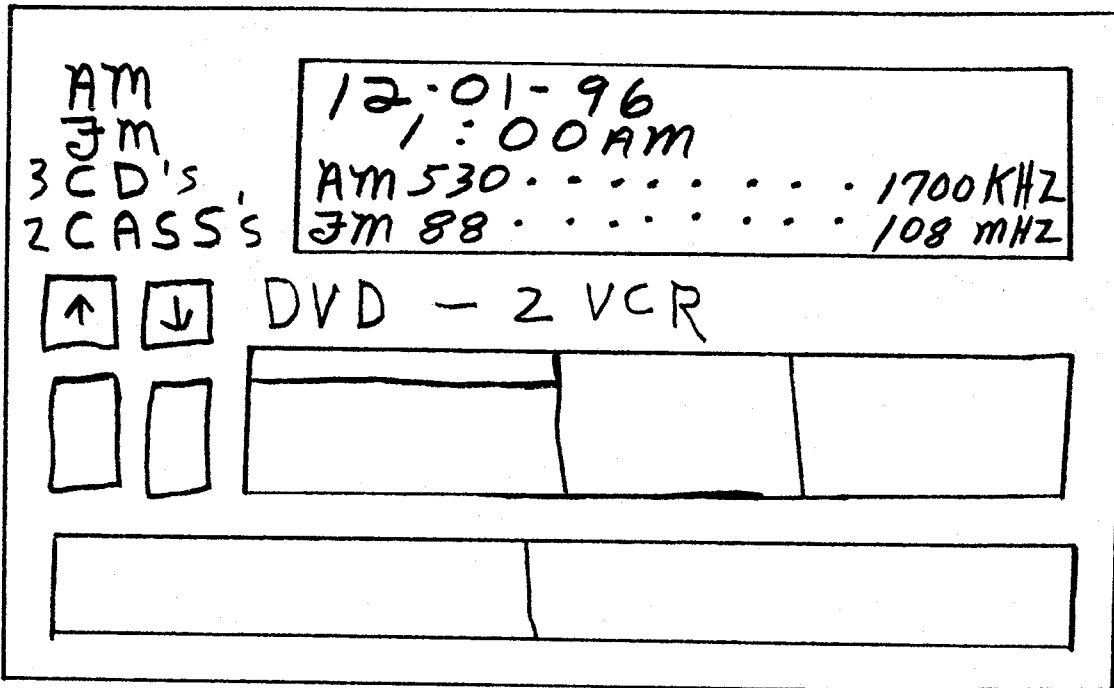

SYNCHRONIZED INSIDE STEREO FM/AM RADIO CD AND CASSETTE SO WHEN STATIC COMES TO THE CHANNEL YOU ARE LISTENING TO IT CHANGES TO THE NEXT MOST CLEAR STATION WITH MUSIC ON IT. IF YOU HAVE ALREADY PROGRAMMED IT WILL TURN INTO YOUR CD OR CASSETTE TO HELP YOU GET OVER STATIC FOR 15 MINUTES. THE MUSIC SOUNDS MOST LIKE WHAT YOU WERE LISTENING TO. IF NOTHING IS PLAYING LIKE THAT YOU GET THE NEXT BEST SOUNDING STATION BROADCASTING. TUNER ALLOWS YOU TO CHOSE WHICH NEXT BEST KINDS OF MUSIC YOU WOULD LIKE TO HEAR. ALLOWS YOUR RADIO TO CHANGE STATIONS ON A TIMELY SCALE. SAY YOU WANT TO LISTEN TO JAZZ FOR TEN MINUTES THEN RHYTHM AND BLUES FOR TEN MINUTES THEN ROCK AND ROLL FOR TEN MINUTES. JUST PROGRAM THE DIGITAL PERSONAL COMPUTER. THE PROGRAMMABLE CLOCK WORKS ON A TWENTY FORE HOUR SCALE, SEVEN DAYS A WEEK, 365 DAYS A YEAR. TUNER DOES NOT CHANGE INTO A ANNOUNCER OR COMMERCIAL BROADCAST UNLESS YOU PROGRAM THE TUNER FOR THAT PURPOSE. YOU TUNE WHAT YOU WANT TO HEAR ANY TIME.

C 1984 BY LUTHER WINSTON FORTINBERRY

"SILENT PHONE"

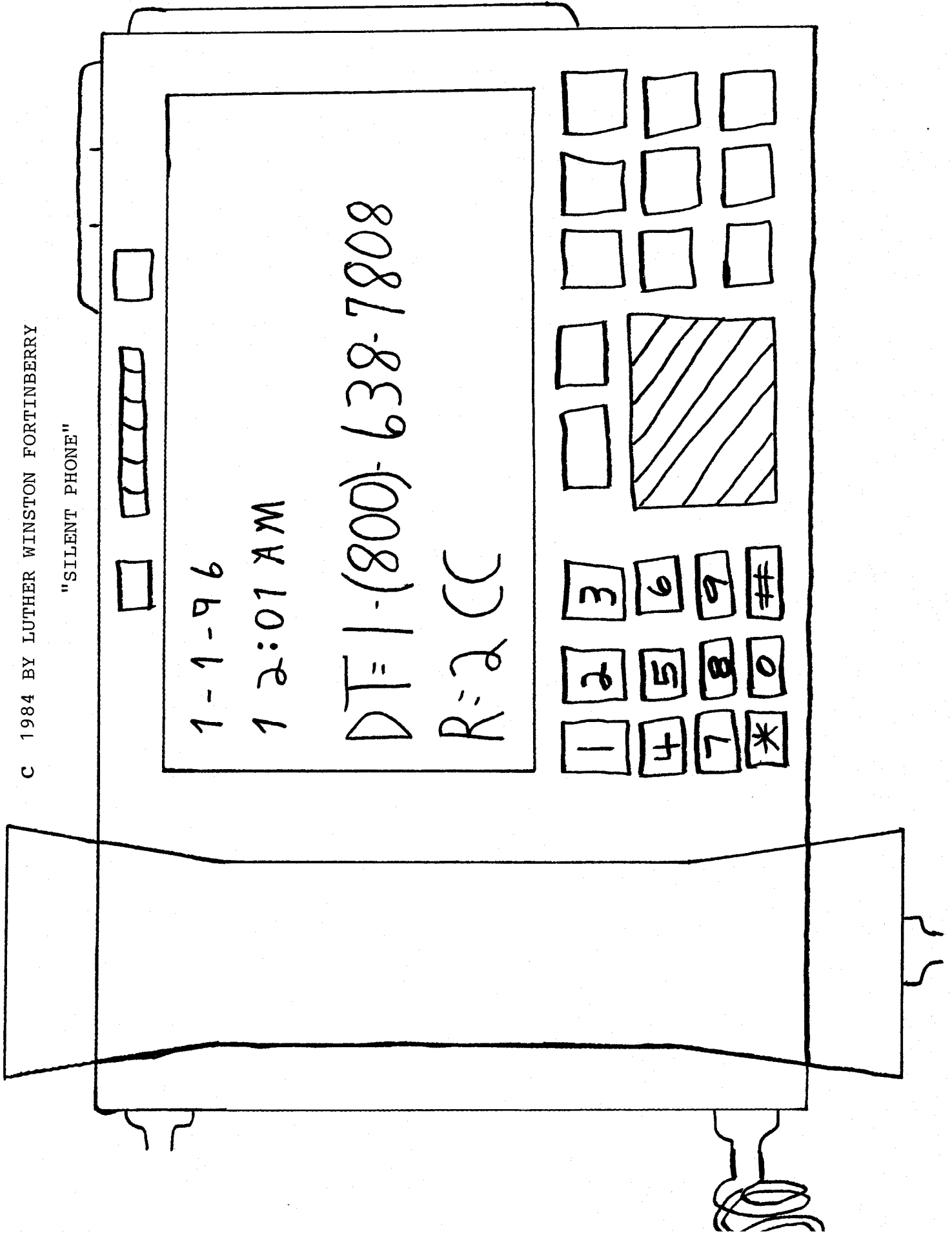

"SILENT PHONE"

THE IDEA IS TO ENJOY A TOTALLY QUIET OPERATING SYSTEM FROM YOUR PHONE AS YOU ARE USING IT. WHEN SOMEONE PICKS UP THE PHONE YOU ONLY HEAR THEIR VOICE. SILENT PHONE HAS A SCREEN ON IT WITH KNOB TO ADJUST SIZE OF SIGNALS THAT LET YOU KNOW HOW YOUR CALL IS PROGRESSING. YOU CAN HOOK IT UP AND TURN IT OFF ANY TIME IF YOU DON'T WANT TO BE BOTHERED BY A SCREEN. TURN IT ON AGAIN IT HAS RECORDED EVERYTHING IN PROGRESS. SILENT PHONE ALSO COMES IN A PORTABLE DESIGN JUST PLUG IT INTO YOUR PHONES RECEIVER AND YOUR PHONES RECEIVER INTO IT. IF YOU HAVE A COMPUTER ITS PORTABLE DESIGN LETS YOU LINK UP WITH THE COMPUTER AND THE SILENT PHONE AND YOUR PHONE. JUST SET IT BESIDE YOUR PHONE WITH ITS OWN INTERNAL OUT FOLDING ATTRACTIVE BRACE AND HOOK IT UP OR USE THE INTERNAL UNIVERSAL EXPANDABLE CLAMPS TO SECURE IT TO YOUR PHONE FOR CONVENIENT PROGRAMMING. EASY TO USE, QUIET AND EFFECTIVE CALL SIGNS TELL YOU WERE YOUR PHONE CALL IS IN PROGRESS COMPLETELY. WHEN YOU PICK UP PHONE YOU SEE **DT** DIAL TONE DIAL NUMBERS, THEY APPEAR IN BOLD ENLARGED SYMBOL'S ON SCREEN. AFTER DIALING NUMBERS YOU SEE **R** FOR RINGING WITH A NUMBER COUNT FOR TIMES NUMBER IS BEING RUNG. YOU DON'T HEAR ANYTHING UNTIL YOUR PARTY PICKS UP THE PHONE THEN YOU GET A MUCH CLEARER RECEPTION WITH A **C C** SIGNAL TO LET YOU KNOW CALL IS COMPLETE. IF YOUR PARTY PUTS YOU ON HOLD YOU SEE **H** ON SCREEN. IF LINE IS BUSY YOU GET A **B** ON SCREEN. YOU GET A PROPER **DC** IF YOUR LINE WAS REALLY DISCONNECTED OR **HU** IF YOUR PARTY JUST HUNG UP. IF SOMEBODY CALLS YOU AND HANGS UP YOU GET A READ OUT ON YOUR SCREEN THE NUMBER THAT HAS JUST CALLED YOU. SILENT PHONES DIGITAL PERSONAL COMPUTER USES DOUBLE SIDED/DOUBLE DENSITY/DOUBLE TRACK AND SINGLE SIDED/DOUBLE DENSITY/DOUBLE TRACK FLOPPY DISK FOR WORD PROCESSOR PROGRAMMING. JUST PUT A *# BEFORE ANY NUMBER ON THE FLOPPY DISK AND SILENT PHONE WILL CALL IT. SILENT PHONE TAKES HIGH DENSITY/DOUBLE TRACK FOR COMPUTER PROGRAMMING IT HAS AND ADDITIONAL COMPUTER LINK WITH A WIRE JACK HOOK UP ALLOWS PHONE CALLS FROM COMPUTERS EXPANSIVE MEMORY. SILENT PHONE HAS ADVANCED SYSTEMS LIKE SPEED DIALING **SD**, CALL RETURN **CR**, CONFERENCE CALL **CC**. ITS MEMORY EASILY PRINTS OUT ON FAX WORD PROCESSOR OR COMPUTER PRINTER CALLS MADE INCOMING AND OUT GOING AND THEIR TIMES AS EXTENSIVE AS YOUR MEMORY ON FAX, FLOPPY DISK, OR COMPUTER MEMORY. IF YOU WANT TO SEE THE TIME AND DATE IT WILL SHOW YOU PRESENT TIME. IT HAS A FUTURISTIC ALARM IN IT FOR APPOINTMENTS, SILENT PHONE CALLS YOU AND LEAVES YOUR PHONE OR FLOPPY DISK OR COMPUTER A MESSAGE FOR YOUR APPOINTMENT. SILENT PHONE HAS A DIGITAL ANSWERING DEVICE ALLOWS A RECORDED GREETING AND TAKES MESSAGES FOR ONE MINUTE TO FIVE MINUTES UP TO AND HOUR. SILENT PHONE WILL CALL YOU AT A CERTAIN # IF SOMEONE CALLS YOU AT HOME. IT WILL LET YOU RETRIEVE MESSAGES THRU PROGRAMMABLE SECRET CODE # WITH MEMO SERVICE. AFTER YOU HOOK UP SILENT PHONE WILL NOT GET IN THE WAY OF ANY OF THE SERVICES YOUR PHONE ALREADY HAS ON IT. SILENT PHONE TAKES MESSAGES FOR FIVE OTHER PARTIES. SILENT PHONE IS A LIE DETECTOR. SILENT PHONE IS A SPEAKER PHONE.

C 1984 BY LUTHER WINSTON FORTINBERRY

"PORTABLE SILENT PHONE"

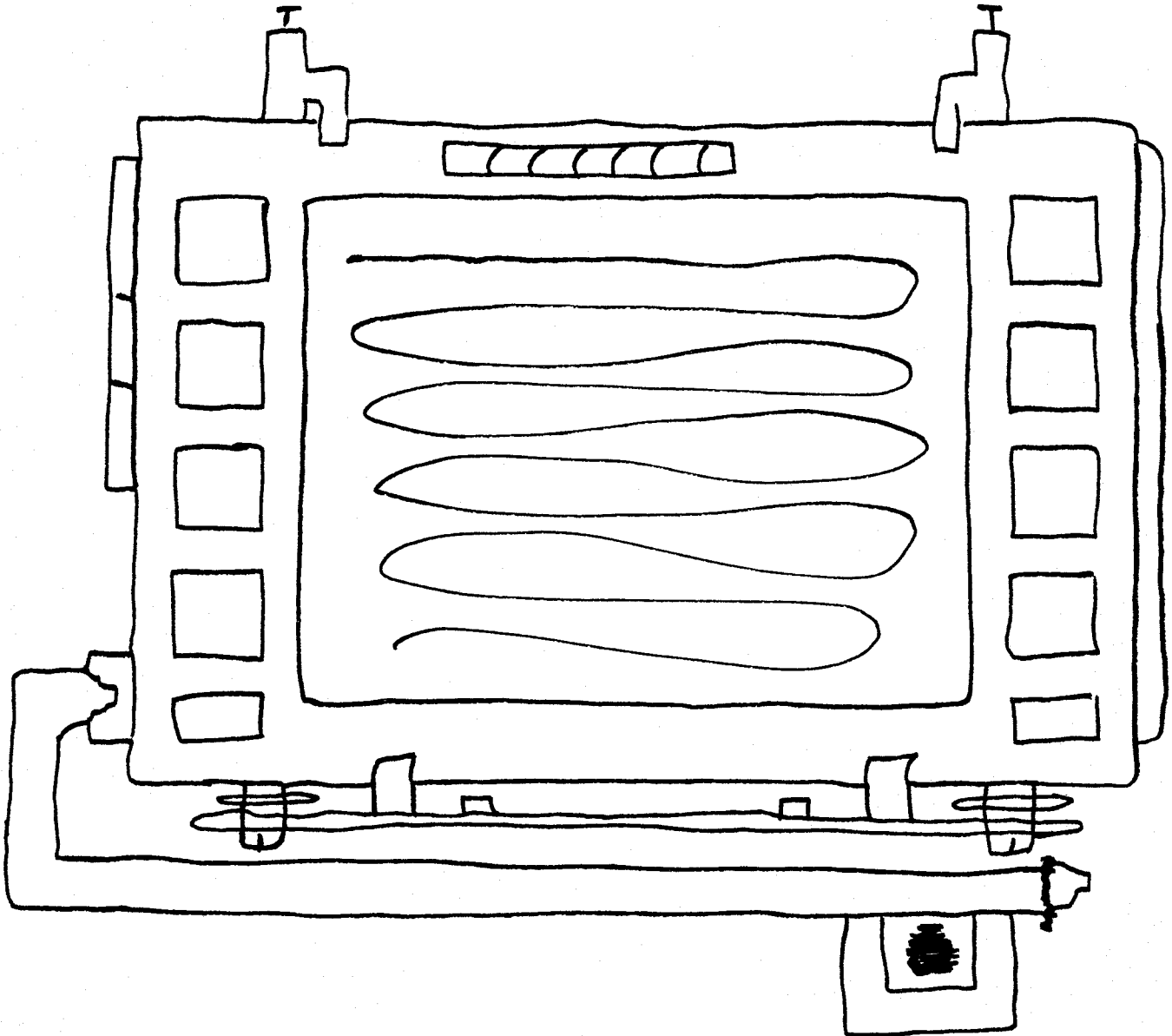

- EXPANDABLE RETRACTABLE BRACE
- INTERNAL ELABORATE STAND
- COMPUTER LINK HOOK UP
- FLOPPY DISK COMPARTMENT
- CHANNEL PROGRAMMING FUNCTIONS
- ADJUST SIZE OF LETTERING AND LIGHT OF SCREEN
- MALE AND FEMALE PLUG IN TO YOUR PHONES RECEIVER

© 2001 by Luther Winston Fortinberry

"Lamp Shade Shaw"

Idea is for Protection from Light Bulb
direct sight over glare from around
some Light shades on Lamps etc. Al...

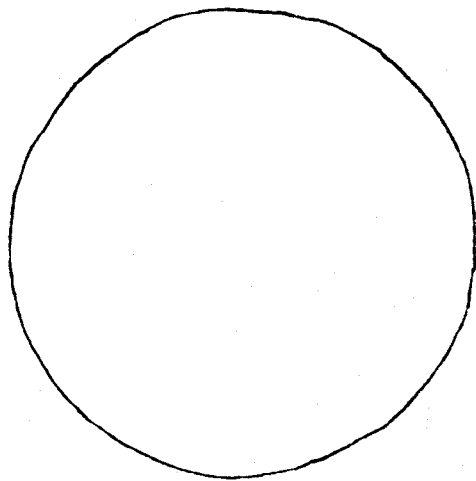

Velcro strip -

- Fits any size shade
Just wrap around
- cloth lets Light thru
Not Light bulb or glare.